

PNAM0611832329

C-103 Received 4-24-2006
DHC No. Assigned 4-27-2006

	Order Number	API Number	Operator	County			
	HOB-0146	30-025-20311	John H. Hendrix Corp.	Lea			
	Order Date	Well Name	Number	Location			
		State Land 15	006	0 UL	16 Sec	215 T (+Dir)	37E R (+Dir)
			Oil %	Gas %			
Pool 1	06660	Blinebry Oil+Gas (Oil)	34%	39%			
Pool 2	60240	Tubb Oil+Gas (Oil)	22%	15%			
Pool 3	19190	Drinkard	44%	46%			
Pool 4							
<div>Comments: Work completed effective _____ Work cancelled effective _____ Supplement _____</div>							

Posted to
RBDML
4-27-2006

⑤

DOWNHOLE COMMINGLE CALCULATIONS:

30-025-20311

OPERATOR: John H. Hendrix Corp.

HOB-0146

PROPERTY NAME: State Land 15'

WNULSTR: 6-0, 16-21-37

SECTION I:

POOL NO. 1 Blinebry Oil+Gas (Oil) ALLOWABLE AMOUNT 107 428 MCF 4000

POOL NO. 2 Tubb Oil+Gas (Oil) 142 284 MCF 2000

POOL NO. 3 Drinkard 142 852 MCF 6000

POOL NO. 4 _____ MCF

POOL TOTALS 391 1564

SECTION II:

POOL NO. 1 Blinebry Oil+Gas (Oil) Oil Gas
34% 39%

POOL NO. 2 Tubb Oil+Gas (Oil) 22% 15%

POOL NO. 3 Drinkard 44% X 391 = 172.04 46%

POOL NO. 4 _____

OIL

GAS

SECTION III:

$107 \div 44\% = 243.18 (244)$

SECTION IV:

$244 \times 34\% = 82.96 (83)$

$244 \times 22\% = 53.68 (54)$

$244 \times 44\% = 107.36 (107)$

Submit 3 Copies To Appropriate District Office
District I
1625 N. French Dr., Hobbs, NM 88240
District II
1301 W. Grand Ave., Artesia, NM 88210
District III
Rio Brazos Rd., Aztec, NM 87410
District IV
1220 S. St. Francis Dr., Santa Fe, NM 87505

State of New Mexico
Energy, Minerals and Natural Resources

Form C-103
May 27, 2004

OIL CONSERVATION DIVISION
1220 South St. Francis Dr.
Santa Fe, NM 87505

WELL API NO.	30-025-20311
5. Indicate Type of Lease	STATE <input checked="" type="checkbox"/> FEE <input type="checkbox"/>
6. State Oil & Gas Lease No.	B-8105
7. Lease Name or Unit Agreement Name	State Land 15
8. Well Number	6
9. OGRID Number	012024
10. Pool name or Wildcat	

SUNDRY NOTICES AND REPORTS ON WELLS (DO NOT USE THIS FORM FOR PROPOSALS TO DRILL OR TO DEEPEN OR PLUG BACK TO A DIFFERENT RESERVOIR USE "APPLICATION FOR PERMIT" (FORM C-101) FOR SUCH PROPOSALS)	
1. Type of Well: Oil Well <input checked="" type="checkbox"/> Gas Well <input type="checkbox"/> Other <input type="checkbox"/>	
2. Name of Operator John H. Hendrix Corporation	
3. Address of Operator P. O. Box 3040 Midland, TX 79702-3040	
4. Well Location Unit Letter <u>O</u> : <u>330</u> feet from the <u>South</u> line and <u>1650</u> feet from the <u>East</u> line Section <u>16</u> Township <u>21S</u> Range <u>37E</u> NMPM County <u>Lea</u>	
11. Elevation (Show whether DR, RKB, RT, GR, etc.)	
Pit or Below-grade Tank Application <input type="checkbox"/> or Closure <input type="checkbox"/>	
Pit type _____ Depth to Groundwater _____ Distance from nearest fresh water well _____ Distance from nearest surface water _____	
Pit Liner Thickness: _____ mil Below-Grade Tank: Volume _____ bbls; Construction Material _____	

12. Check Appropriate Box to Indicate Nature of Notice, Report or Other Data

NOTICE OF INTENTION TO:		SUBSEQUENT REPORT OF:	
PERFORM REMEDIAL WORK <input type="checkbox"/>	PLUG AND ABANDON <input type="checkbox"/>	REMEDIAL WORK <input type="checkbox"/>	ALTERING CASING <input type="checkbox"/>
TEMPORARILY ABANDON <input type="checkbox"/>	CHANGE PLANS <input type="checkbox"/>	COMMENCE DRILLING OPNS. <input type="checkbox"/>	P AND A <input type="checkbox"/>
WELL OR ALTER CASING <input type="checkbox"/>	MULTIPLE COMPL <input type="checkbox"/>	CASING/CEMENT JOB <input type="checkbox"/>	
OTHER: DHC <input checked="" type="checkbox"/>		OTHER: <input type="checkbox"/>	

13. Describe proposed or completed operations. (Clearly state all pertinent details, and give pertinent dates, including estimated date of starting any proposed work). SEE RULE 1103. For Multiple Completions: Attach wellbore diagram of proposed completion or recompletion.

This is a request to DHC Drinkard, Tubbs Oil & Gas and Blinberry Oil & Gas in the subject well. See supporting data on attached sheet.

DHC Order No. HOB-0146

I hereby certify that the information above is true and complete to the best of my knowledge and belief. I further certify that any pit or below-grade tank has been will be constructed or closed according to NMOCD guidelines ☐, a general permit ☐ or an (attached) alternative OCD-approved plan ☐.

SIGNATURE Ronnie H. Westbrook TITLE Vice President DATE 04/19/2006
Type or print name Ronnie H. Westbrook E-mail address: _____ Telephone No. (432)684-6631
For State Use Only PETROLEUM ENGINEER APR 28 2006
APPROVED BY: [Signature] TITLE _____ DATE _____
Conditions of Approval (if any): _____

STATE LAND 15 NO. 6

1. Division order number that established pre-approved pool – Order No. R-11363.
2. Pools to be commingled – Drinkard (19190), Tubb Oil & Gas (60240) and Blinebry Oil & Gas (6660).
3. Blinebry Perfs. – 5571 – 5795'
Drinkard Perfs. – 6394 – 6617'
Tubb Perfs. – 6038 – 6275'
4. All zones are intermediate crude and commingling will not reduce the value of the production.
5. Ownership between the three pools is identical.
6. Allocation is based on producing rates prior to plugging back and current Blinebry producing rate.

Blinebry	4 BO	165 MCF
Tubb	2 BO	55 MCF
Drinkard	3 BO	138 MCF

Drinkard Oil	44%	Drinkard Gas	46%
Tubb Oil	22%	Tubb Gas	15%
Blinebry Oil	34%	Blinebry Gas	39%

District I
1625 N. French Dr., Hobbs, NM 88240

District II
1000 W. Grand Avenue, Artesia, NM 88210

District III
1000 Rio Brazos Rd., Aztec, NM 87410

District IV
1220 S. St. Francis Dr., Santa Fe, NM 87505

State of New Mexico
Energy, Minerals & Natural Resources Department
OIL CONSERVATION DIVISION
1220 South St. Francis Dr.
Santa Fe, NM 87505

Form C-102
Revised October 12, 2005
Submit to Appropriate District Office
State Lease 4 Copies
Fee Lease 3 Copies
☒ AMENDED REPORT

WELL LOCATION AND ACREAGE DEDICATION PLAT

'API Number 30-025-20311		'Pool Code 06660		'Pool Name Blinebry Oil & Gas	
'Property Code 005228		'Property Name State Land 15			'Well Number 6
'OGRID No. 012024		'Operator Name John H. Hendrix Corporation			'Elevation 3440' GR

10 Surface Location

UL or lot no.	Section	Township	Range	Lot Idn	Feet from the	North/South line	Feet from the	East/West line	County
O	16	21S	37E		330	South	1650	East	Lea

11 Bottom Hole Location If Different From Surface

UL or lot no.	Section	Township	Range	Lot Idn	Feet from the	North/South line	Feet from the	East/West line	County

"Dedicated Acres 40	"Joint or Infill	"Consolidation Code	"Order No.
------------------------	------------------	---------------------	------------

No allowable will be assigned to this completion until all interests have been consolidated or a non-standard unit has been approved by the division.

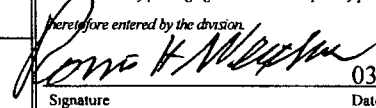
<div style="position: relative; height: 400px;"> <div style="position: absolute; top: 10px; left: 10px; width: 50px; height: 50px; border: 1px solid black; border-radius: 50%;"></div> <div style="position: absolute; bottom: 10px; left: 10px; width: 50px; height: 50px; border: 1px solid black; border-radius: 50%;"></div> <div style="position: absolute; bottom: 100px; left: 300px;"> #2 1650' </div> </div>	17 OPERATOR CERTIFICATION I hereby certify that the information contained herein is true and complete to the best of my knowledge and belief, and that this organization either owns a working interest or unleased mineral interest in the land including the proposed bottom hole location or has a right to drill this well at this location pursuant to a contract with an owner of such a mineral or working interest, or to a voluntary pooling agreement or a compulsory pooling order heretofore entered by the division.  03/15/2006 Signature Date Ronnie H. Westbrook Printed Name
	18 SURVEYOR CERTIFICATION I hereby certify that the well location shown on this plat was plotted from field notes of actual surveys made by me or under my supervision, and that the same is true and correct to the best of my belief Date of Survey Signature and Seal of Professional Surveyor
	Certificate Number

District I
1625 N. French Dr., Hobbs, NM 88240
District II
1201 W. Grand Avenue, Artesia, NM 88210
District III
1000 Rio Brazos Rd., Aztec, NM 87410
District IV
1220 S St Francis Dr., Santa Fe, NM 87505

State of New Mexico
Energy, Minerals & Natural Resources Department
OIL CONSERVATION DIVISION
1220 South St. Francis Dr.
Santa Fe, NM 87505

Form C-102
Revised June 10, 2003
Submit to Appropriate District Office
State Lease - 4 Copies
Fee Lease - 3 Copies
☐ AMENDED REPORT

WELL LOCATION AND ACREAGE DEDICATION PLAT

API Number 30-025-20311		Pool Code 60240	Pool Name Tubb Oil & Gas
Property Code 005228	Property Name State Land 15		Well Number 6
OGRID No. 012024	Operator Name John H. Hendrix Corporation		Elevation 3440' GR

10 Surface Location

UL or lot no O	Section 16	Township 21S	Range 37E	Lot Idn	Feet from the 330	North/South line South	Feet from the 1650	East/West line East	County Lea
-------------------	---------------	-----------------	--------------	---------	----------------------	---------------------------	-----------------------	------------------------	---------------

11 Bottom Hole Location If Different From Surface

UL or lot no	Section	Township	Range	Lot Idn	Feet from the	North/South line	Feet from the	East/West line	County
Dedicated Acres 40		Joint or Infill		Consolidation Code		Order No			

NO ALLOWABLE WILL BE ASSIGNED TO THIS COMPLETION UNTIL ALL INTERESTS HAVE BEEN CONSOLIDATED OR A NON-STANDARD UNIT HAS BEEN APPROVED BY THE DIVISION

16					17 OPERATOR CERTIFICATION I hereby certify that the information contained herein is true and complete to the best of my knowledge and belief. Signature <i>Ronnie H. Westbrook</i> Printed Name Ronnie H. Westbrook Title and E-mail Address 10/20/2005 Date
					18 SURVEYOR CERTIFICATION I hereby certify that the well location shown on this plat was plotted from field notes of actual surveys made by me or under my supervision, and that the same is true and correct to the best of my belief. Date of Survey Signature and Seal of Professional Surveyor. Certificate Number

Handwritten notes on the plat: A well location is marked with a dot and labeled '#6'. A horizontal arrow points from the well location to the right, labeled '1650''. A vertical arrow points from the well location down, labeled '330''. There are also some diagonal lines drawn across the plat.

NEW MEXICO OIL CONSERVATION COMMISSION
WELL LOCATION AND ACREAGE DEDICATION PLAT

Form C-102
Supersedes C-128
Effective 1-1-65

All distances must be from the outer boundaries of the Section.

Operator Sun Oil Company			Lease State Land "15"		Well No. 6
Unit Letter 0	Section 16	Township 21S	Range 37E	County Lea	
Actual Footage Location of Well: 330 feet from the South line and 1650 feet from the East line					
Ground Level Elev. 3549.5	Producing Formation Drinkard	Pool Drinkard	Dedicated Acreage: 40 Acres		

1. Outline the acreage dedicated to the subject well by colored pencil or hachure marks on the plat below.
2. If more than one lease is dedicated to the well, outline each and identify the ownership thereof (both as to working interest and royalty).
3. If more than one lease of different ownership is dedicated to the well, have the interests of all owners been consolidated by communitization, unitization, force-pooling, etc?

☐ Yes ☐ No If answer is "yes," type of consolidation _____

If answer is "no," list the owners and tract descriptions which have actually been consolidated. (Use reverse side of this form if necessary.) _____

No allowable will be assigned to the well until all interests have been consolidated (by communitization, unitization, forced-pooling, or otherwise) or until a non-standard unit, eliminating such interests, has been approved by the Commission.

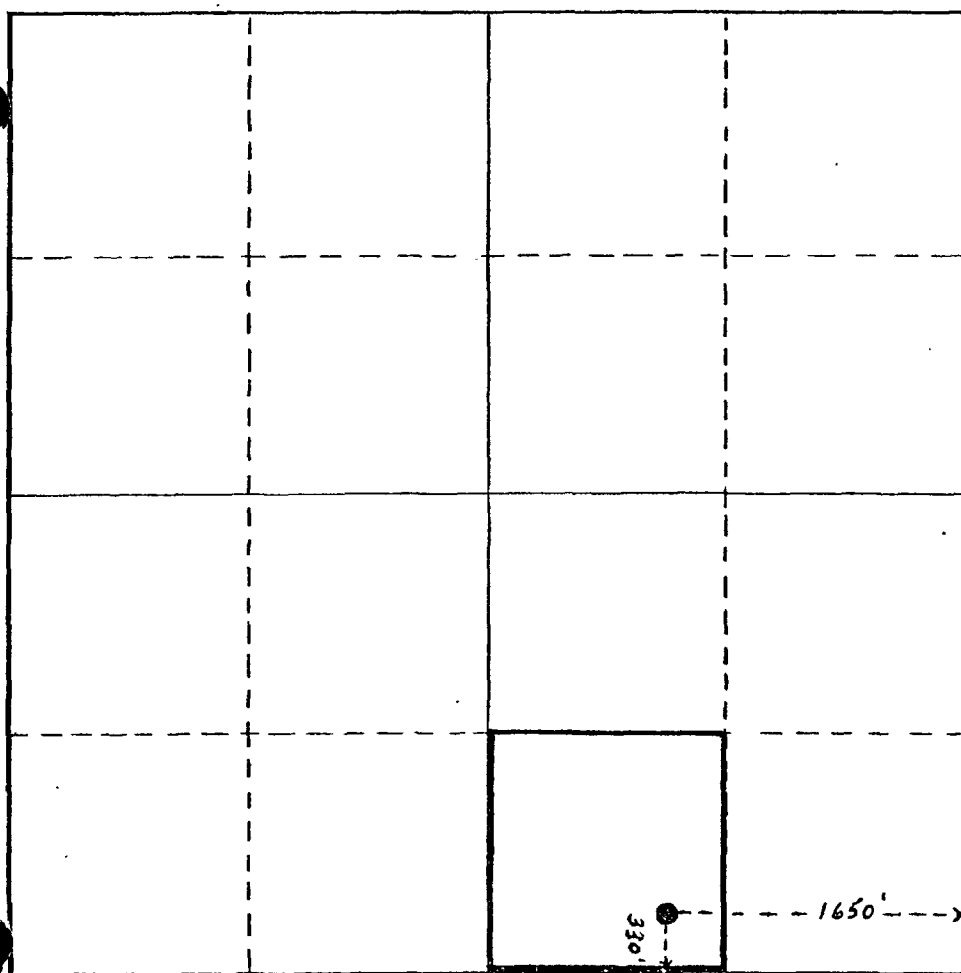

CERTIFICATION

I hereby certify that the information contained herein is true and complete to the best of my knowledge and belief.

Name Charles Gray
Position Proration Clerk

Company Sun Oil Company

Date 2-18-72

I hereby certify that the well location shown on this plat was plotted from field notes of actual surveys made by me or under my supervision, and that the same is true and correct to the best of my knowledge and belief.

Date Surveyed 9-12-63

Registered Professional Engineer and/or Land Surveyor

John W. West

Certificate No. 676