

NSP 11/1/99
SD

SDX RESOURCES, INC.

P.O. BOX 5061
MIDLAND, TEXAS 79704
(915) 685-1761

Sept. 16, 1999

NMOCD
2040 South Pacheco Street
Santa Fe, NM 87505

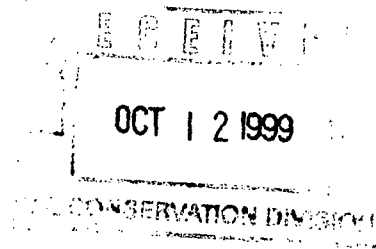

Attention: Mr. Mike Stogner

RE: Wells B5 Fed. # 3
Sec. 5, T25S, R37E
1860 FNL, 660 FEL
Lea County, New Mexico

Standard

Dear Mr. Stogner,

SDX Resources, Inc. is the operator of the Wells B5 Fed. # 1 & 2 wells located in units A & G of sec. 5 T25S R37E of Lea Co., N.M.. These wells are dedicated to a 160 acre non-standard gas proration unit consisting of the NE/4 of sec. 5 created by USGS Communitization Agreement No. 14-08-001-3889 (approved 4-1-57) and approved by NSP 370. A plat detailing the agreement is accompanies this letter. SDX is planning to drill the Wells B5 Fed. # 3 well on the same 160 acre proration unit at the above-mentioned location. SDX request that this letter serve as application to simultaneously dedicate this 160 acre unit to the Wells B5 Fed. # 1, 2 and # 3 wells. BLM form 3160 and OCD form C-102 for the #3 well, an outlined lease map, and other pertinent information is attached to this application. All offset operators have been notified and proof of notification is attached. Your assistance on this is appreciated.

Sincerely,

Chuck Morgan

Enclosures

District I
PO Box 1980, Hobbs, NM 88241-1980
District II
PO Drawer DD, Artesia, NM 88211-0719
District III
1000 Rio Brazos Rd., Aztec, NM 87410
District IV
PO Box 2088, Santa Fe, NM 87504-2088

State of New Mexico
Energy, Minerals & Natural Resources Department

OIL CONSERVATION DIVISION
PO Box 2088
Santa Fe, NM 87504-2088

Form C-102
Revised February 21, 1994
Instructions on back
Submit to Appropriate District Office
State Lease - 4 Copies
Fee Lease - 3 Copies

☐ AMENDED REPORT

WELL LOCATION AND ACREAGE DEDICATION PLAT

1 API Number		2 Pool Code		3 Pool Name	
		79240		Jalmat, TN, YT, 7R	
4 Property Code		5 Property Name			6 Well Number
23983		El Paso Wells Federal			2
7 OGRID No.		8 Operator Name			9 Elevation
020451		SDX Resources, Inc.			3225

10 Surface Location

UL or lot no.	Section	Township	Range	Lot Idn	Feet from the	North/South line	Feet from the	East/West line	County
Lot 3	4	25S	37E		660	North	1980	West	Lea

11 Bottom Hole Location If Different From Surface

UL or lot no.	Section	Township	Range	Lot Idn	Feet from the	North/South line	Feet from the	East/West line	County

12 Dedicated Acres	13 Joint or Infill	14 Consolidation Code	15 Order No.
160			

NO ALLOWABLE WILL BE ASSIGNED TO THIS COMPLETION UNTIL ALL INTERESTS HAVE BEEN CONSOLIDATED
OR A NON-STANDARD UNIT HAS BEEN APPROVED BY THE DIVISION

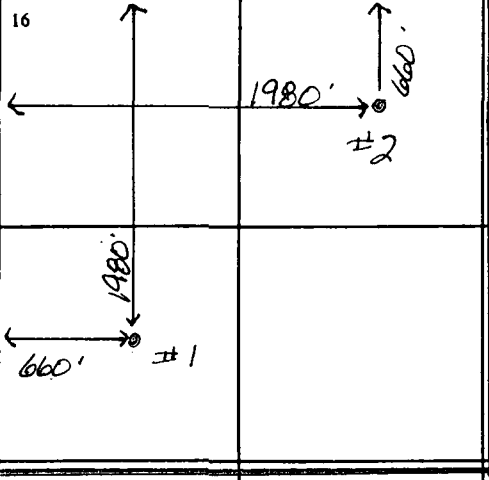
<p>16</p> 				<p>17 OPERATOR CERTIFICATION</p> <p>I hereby certify that the information contained herein is true and complete to the best of my knowledge and belief</p> <p><i>Chuck Morgan</i></p> <p>Signature</p> <p>Chuck Morgan</p> <p>Printed Name</p> <p>Engineer</p> <p>Title</p> <p>May 5, 1999</p> <p>Date</p>			
				<p>18 SURVEYOR CERTIFICATION</p> <p>I hereby certify that the well location shown on this plat was plotted from field notes of actual surveys made by me or under my supervision, and that the same is true and correct to the best of my belief.</p> <p>Date of Survey</p> <p>Signature and Seal of Professional Surveyor:</p> <p>Certificate Number</p>			

UNITED STATES
DEPARTMENT OF THE INTERIOR
BUREAU OF LAND MANAGEMENTSUBMIT IN TRIPLICATE*
(Other instructions on
reverse side)FORM APPROVED
OMB NO. 1004-0136
Expires: February 28, 1995

APPLICATION FOR PERMIT TO DRILL OR DEEPEN

1a. TYPE OF WORK DRILL <input checked="" type="checkbox"/> DEEPEN <input type="checkbox"/>			5. LEASE DESIGNATION AND SERIAL NO. LC-055546 LC052956	
b. TYPE OF WELL OIL WELL <input type="checkbox"/> GAS WELL <input checked="" type="checkbox"/> OTHER <input type="checkbox"/> SINGLE ZONE <input checked="" type="checkbox"/> MULTIPLE ZONE <input type="checkbox"/>			6. IF INDIAN, ALLOTTEE OR TRIBE NAME	
2. NAME OF OPERATOR SDX Resources, Inc.			7. UNIT AGREEMENT NAME 14-08-0001-3889 Com Agmt	
3. ADDRESS AND TELEPHONE NO. PO Box 5061, Midland, TX 79704			8. FARM OR LEASE NAME, WELL NO. Wells B-5 #3	
4. LOCATION OF WELL (Report location clearly and in accordance with any State requirements. *) At surface 1860' FNL & 660' FEL, Unit H At proposed prod. zone Same			9. API WELL NO.	
14. DISTANCE IN MILES AND DIRECTION FROM NEAREST TOWN OR POST OFFICE* 2 miles NE of Jal, NM			10. FIELD AND POOL, OR WILDCAT Jalmat Gas	
15. DISTANCE FROM PROPOSED* LOCATION TO NEAREST PROPERTY OR LEASE LINE, FT (Also to nearest drlg. unit line, if any) 660'			11. SEC., T., R., M., OR BLK. AND SURVEY OR AREA Sec. 5, T25S, R37E	
16. NO. OF ACRES IN LEASE 918			12. COUNTY OR PARISH Lea	
17. NO. OF ACRES ASSIGNED TO THIS WELL 160			13. STATE NM	
18. DISTANCE FROM PROPOSED LOCATION* TO NEAREST WELL, DRILLING, COMPLETED, OR APPLIED FOR, ON THIS LEASE, FT.			20. ROTARY OR CABLE TOOLS Rotary	
19. PROPOSED DEPTH 3200			21. APPROX. DATE WORK WILL START* 10/15/99	
21. ELEVATIONS (Show whether DF, RT, GR, etc.) 3240				

23. PROPOSED CASING AND CEMENTING PROGRAM

SIZE OF HOLE	GRADE, SIZE OF CASING	WEIGHT PER FOOT	SETTING DEPTH	QUANTITY OF CEMENT
12-1/4"	8-5/8"	24#	600'	350 sx
7-7/8"	4-1/2 - 5-1/2"	9.5 - 17#	3200'	400 sx Lite + 200 sx C

Plan to drill 12-1/4" hole to appx 600'. Set 8-5/8" surface csg. Circ Class C cmt. Drill 7-7/8" hole to 3200'. Set 4-1/2" or 5-1/2" csg & circ cmt. Perf Yates gas zone & stimulate as necessary for optimum production.

Specific Program:

- Exhibit #1: BOP Diagram
- Exhibit #2: Survey Plat
- Exhibit #3: Existing & Proposed Road Map
- Exhibit #4: Producing Well Area Map
- Exhibit #5: Drill Site Layout

IN ABOVE SPACE DESCRIBE PROGRAM: If proposal is to deepen, give data on present productive zone and proposed new productive zone. If proposal is to drill or deepen directionally, give pertinent data on subsurface locations and measured and true vertical depths. Give blowout preventer program, if any.

24. SIGNED Bonnie Otwater TITLE Regulatory Tech. DATE 09/23/99
(This space for Federal or State office use)

PERMIT NO. _____ APPROVAL DATE _____

Application approval does not warrant or certify that the applicant holds legal or equitable title to those rights in the subject lease which would entitle the applicant to conduct operations thereon.
CONDITIONS OF APPROVAL, IF ANY:

APPROVED BY _____ TITLE _____ DATE _____

*See Instructions On Reverse Side

Title 18 U.S.C. Section 1001, makes it a crime for any person knowingly and willfully to make to any department or agency of the United States any false, fictitious or fraudulent statements or representations as to any matter within its jurisdiction.

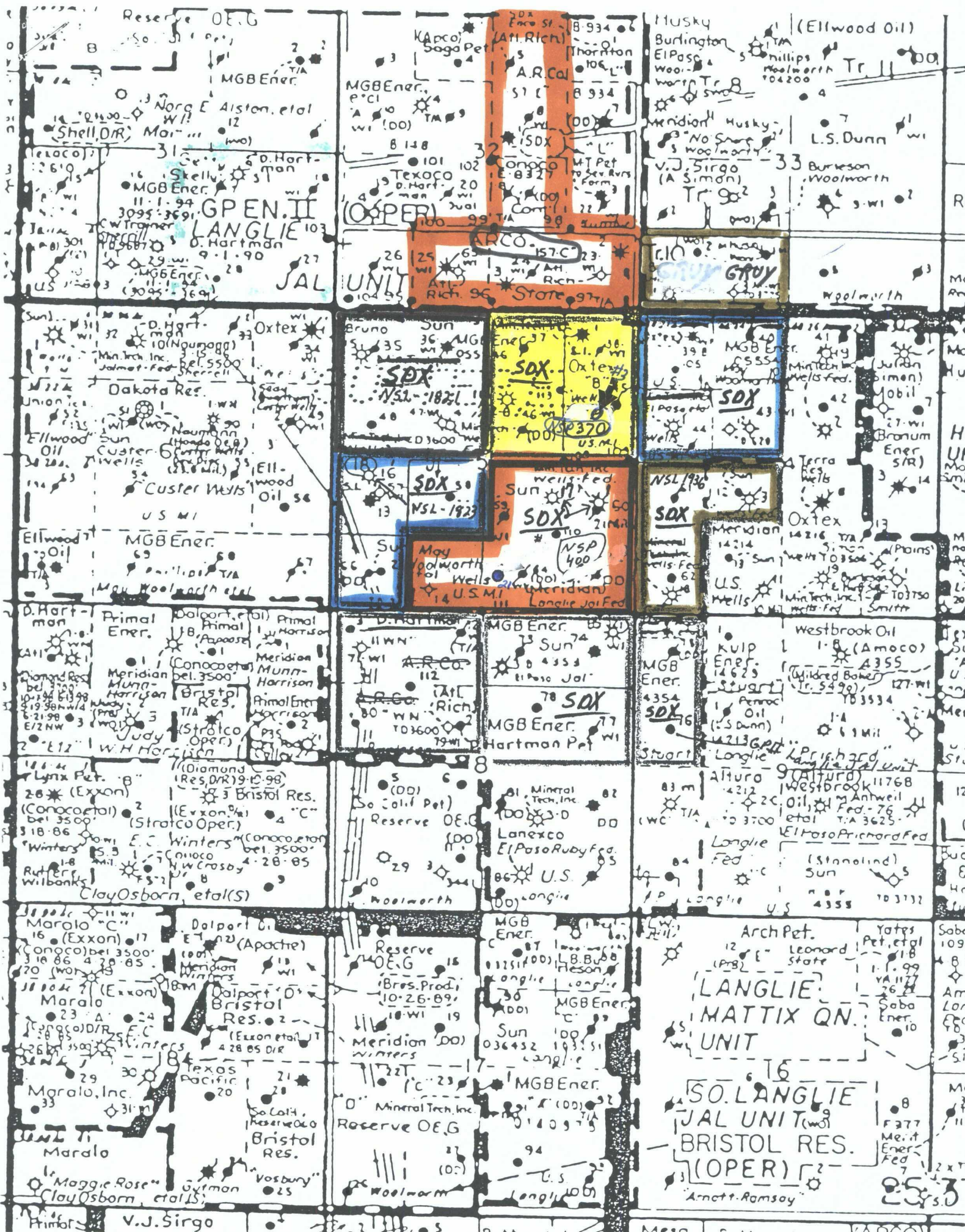

NEW MEXICO OIL CONSERVATION COMMISSION WELL LOCATION AND ACREAGE DEDICATION PLAT

Form No. 1
Supersedes OGC-1
1-1-79

All distances must be from the outer boundaries of the Section

Location DOYLE HARTMAN			Lease WELLS "B5"		Acres 2
Section G	Section 5	Township 25 SOUTH	Range 37 EAST	County LEA	
Distance from Center of Well: 1552 feet from the NORTH line and 2230 feet from the EAST line.					
Ground Level Elev 3249.1	Producing Formation Yates	Pool Jalmat (Gas)	Total Well Acreage 160*		

1. Outline the acreage dedicated to the subject well by colored pencil or hatchure marks on the plat below.
2. If more than one lease is dedicated to the well, outline each and identify the ownership thereof (both as to working interest and royalty).
3. If more than one lease of different ownership is dedicated to the well, have the interests of all owners been consolidated by communitization, unitization, force-pooling, etc?

**Communitization Agreement
(14-08-0001-3889)**

☒ Yes ☐ No If answer is "yes," type of consolidation _____

**** Please see reverse side**

If answer is "no," list the owners and tract descriptions which have actually been consolidated (on reverse side of this form if necessary.) _____

No allowable will be assigned to the well until all interests have been consolidated (by communitization, unitization, forced-pooling, or otherwise) or until a non-standard unit, eliminating such interests, has been approved by the Commission.

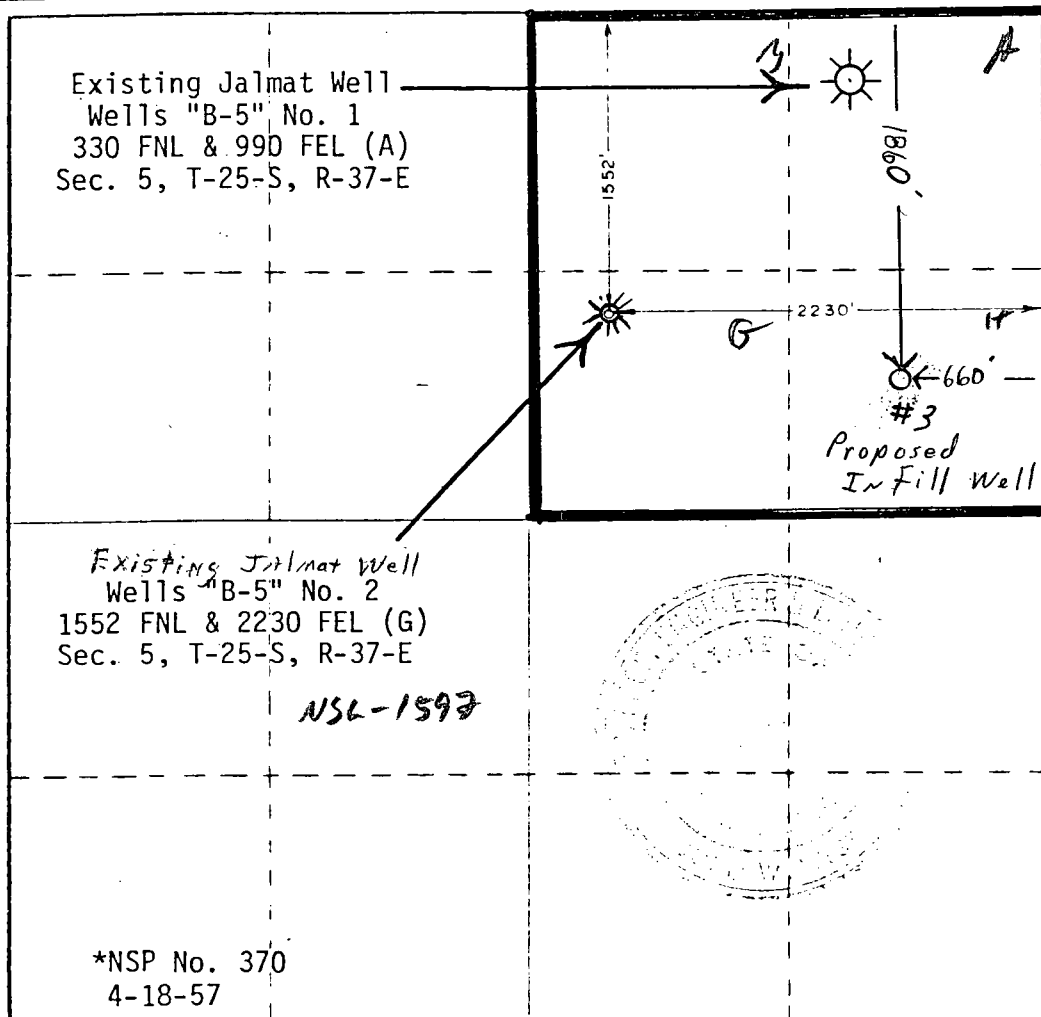

CERTIFICATION

I hereby certify that the information contained herein is true and complete to the best of my knowledge and belief.

Name: Frank A. Romero

Position:

Engineer

For my

Doyle Hartman

Date:

September 8, 1982

I hereby certify that the well location shown on this plat was plotted from field notes of actual surveys made by me or under my supervision, and that the same is true and correct to the best of my knowledge and belief.

Date: _____

10/04/82

Registered Professional Engineer and State Surveyor

Charles W. West

Certificate No. **JOHN W. WEST 676**
PATRICK A. ROMERO 6868
Ronald J. Eidson 3239

District I

1625 N. French Dr., Hobbs, NM 88240

District II

811 South First, Artesia, NM 88210

District III

1000 Rio Brazos Rd., Aztec, NM 87410

District IV

2040 South Pacheco, Santa Fe, NM 87505

State of New Mexico
Energy, Minerals & Natural ResourcesOIL CONSERVATION DIVISION
2040 South Pacheco
Santa Fe, NM 87505Form C-102
Revised March 17, 1999Submit to Appropriate District Office
State Lease - 4 Copies
Fee Lease - 3 Copies☐ AMENDED REPORT

WELL LOCATION AND ACREAGE DEDICATION PLAT

¹ API Number		² Pool Code		³ Pool Name	
⁴ Property Code		⁵ Property Name			⁶ Well Number
		WELLS B-5 FEDERAL			3
⁷ OGRID No.		⁸ Operator Name			⁹ Elevation
		SDX RESOURCES, INC.			3240.

¹⁰ Surface Location

UL or lot no.	Section	Township	Range	Lot Idn	Feet from the	North/South line	Feet from the	East/West line	County
H	5	25-S	37-E		1860	NORTH	660	EAST	LEA

¹¹ Bottom Hole Location If Different From Surface

UL or lot no.	Section	Township	Range	Lot Idn	Feet from the	North/South line	Feet from the	East/West line	County

¹² Dedicated Acres	¹³ Joint or Infill	¹⁴ Consolidation Code	¹⁵ Order No.

NO ALLOWABLE WILL BE ASSIGNED TO THIS COMPLETION UNTIL ALL INTERESTS HAVE BEEN CONSOLIDATED OR A
NON-STANDARD UNIT HAS BEEN APPROVED BY THE DIVISION

<div data-bbox="129 1018 1039 1963"> </div>	¹⁷ OPERATOR CERTIFICATION I hereby certify that the information contained herein is true and complete to the best of my knowledge and belief.
	Signature _____ Printed Name _____ Title _____ Date _____
	¹⁸ SURVEYOR CERTIFICATION I hereby certify that the well location shown on this plat was plotted from field notes of actual surveys made by me or under my supervision, and that the same is true and correct to the best of my belief.
	Date of Survey _____ Signature and Seal of Professional Engineer _____

El Paso Natural Gas Company

El Paso, Texas
April 1, 1957

to Hottel OCC

NSP 370

Due 5-9-57

New Mexico Oil and Conservation Commission
P. O. Box 871
Santa Fe, New Mexico

Attention: Mr. A. L. Porter, Jr.

Re: Application of El Paso Natural Gas Company for Administrative Approval for a 160.25 acre Non-Standard Gas Proration Unit in the Jalmat Gas Pool for the Westates Petroleum Corporation Wells B-5 #1 Gas Well which is located in Lot 1 of Section 5, Township 25 South, Range 37 East, N.M.P.M. Lea County, New Mexico

Gentlemen:

El Paso Natural Gas Company respectfully requests Administrative Approval under the provisions of Rule 5(a) and 5(b) of Order No. R-520 for a Non-Standard Gas Proration Unit of 160.25 acres, more or less, consisting of Lots 1, 2, and the S/2 NE/4 of Section 5, Township 25 South, Range 37 East, N.M.P.M. Jalmat Gas Pool, Lea County, New Mexico, and in support thereof states the following facts:

1. That effective as of April 1, 1957, Lots 1, 2, and the S/2 NE/4 of Section 5, Township 25 South, Range 37 East, N.M.P.M. was communitized in order to form a 160.25 acres, more or less, Non-Standard Proration Unit for the Wells B-5 #1 Gas Well.

2. That El Paso Natural Gas Company is the Operator of said communitized tract.

3. That the Westates Petroleum Corporation Wells B-5 #1 Gas Well was drilled at a location of 330 feet from the North line and 990 feet from the East line of Section 5, Township 25 South, Range 37 East, N.M.P.M. and was completed on February 13, 1939 at a total depth of 3556 feet and was plugged back to 3380 feet. A deliverability test was taken on this well on June 26, 1954 and the well gaged 2,661 M.C.F.

4. That this well was completed and producing from the Yates and Upper Seven Rivers Formations prior to September 1, 1954, which is the effective date of the Special Rules for the Jalmat Gas Pool.

5. That Rule 5(a) of Order No. R-520 pertaining to the Special Rules of the Jalmat Gas Pool grants a maximum tolerance of 330 feet in respect to spacing requirements for wells drilled and producing prior to the effective date of said order.

6. That the acreage to be dedicated to this proposed Non-Standard Gas Proration Unit will substantially comply with the maximum acreage allowed under the Provisions of Rule 5(a) of Order No. R-520 with respect to the well location plus the allowed tolerances.

7. That the proposed Non-Standard Gas Proration Unit will meet the requirements of Rule 5(b) of Order No. R-520 in that the proposed unit consists of contiguous quarter-quarter sections within a single governmental section, that the length or width thereof does not exceed 5280 feet, and that the entire area of the proposed unit lies within the horizontal limits of the Jalmal Gas Pool and may reasonably be presumed to be productive of gas.

8. That by a copy of this Letter of Applicagion, all of the other operators owning an interest in the section in which the proposed Non-Standard Proration Unit is situated and all operators owning an interest within 1500 feet of the well have by registered mail been notified.

9. That a plat showing the acreage to be dedicated to the proposed Non-Standard Gas Proration Unit, the location of the said well, and the offset ownership is attached hereto.

10. El Paso Natural Gas Company intends to use said well as the unit well.

In view of the existence of the facts herein stated and in compliance with the provisions of Rule 5(b) of Order No. R-520, El Paso Natural Gas Company requests Administrative Approval of said proposed 160.25 acre Non-Standard Gas Proration Unit.

Respectfully submitted,

EL PASO NATURAL GAS COMPANY

BY

R. L. Hamblin, Manager
Lease Department

STATE OF TEXAS Y
 Y SS.:
COUNTY OF EL PASO Y

On this 5th day of April, 1957, before me personally appeared R. L. Hamblin, to me known to be the person who executed the foregoing letter and states that the foregoing statements are true to the best of his knowledge and belief.

IN WITNESS WHEREOF, I have hereunto set my hand and seal on this day and year first above written.

My Commission Expires:

June 1, 1957

Registered Mail

cc:

New Mexico Oil Conservation Commission (3)
P. O. Box 871
Santa Fe, New Mexico

First Chicago Corporation
First National Bank Building
Chicago 90, Illinois

Anderson Prichard Oil Corporation
Liberty Bank Building
Oklahoma City, Oklahoma

Indian Petroleum Company
391 Sutter Street
San Francisco 8, California

Co-operative Refinery Association
P. O. Box 2359
Kansas City, Missouri

R. Olsen Oil Company
Liberty Bank Building
Oklahoma City, Oklahoma

Westates Petroleum Corporation
391 Sutter Street
San Francisco 8, California

Plains Production Company
1110 Tower Petroleum Building
Dallas, Texas

Helen Adams
Notary Public in and for El Paso County,
State of Texas

HELEN ADAMS
Notary Public, in and for El Paso County, Texas
My commission expires June 1, 1957

Mr. R. Olsen
Liberty Bank Building
Oklahoma City, Oklahoma

Sinclair Oil and Gas Company
P. O. Box 1470
Midland, Texas

Stanolind Oil and Gas Company
P. O. Box 591
Tulsa, Oklahoma

Western Natural Gas Company
1006 Main Street
Houston, Texas

Langlie Unit Planning Committee
c/o Anderson Prichard Oil Corporation
Liberty Bank Building
Oklahoma City, Oklahoma
Attention: Mr. C. T. McClure

Huskey Oil Company
309 Wilkinson-Foster Building
Midland, Texas

Mr. Julian E. Simon
1025 Fort Worth National Bank Building
Fort Worth, Texas

Plan - Any?
yes

R 37 E

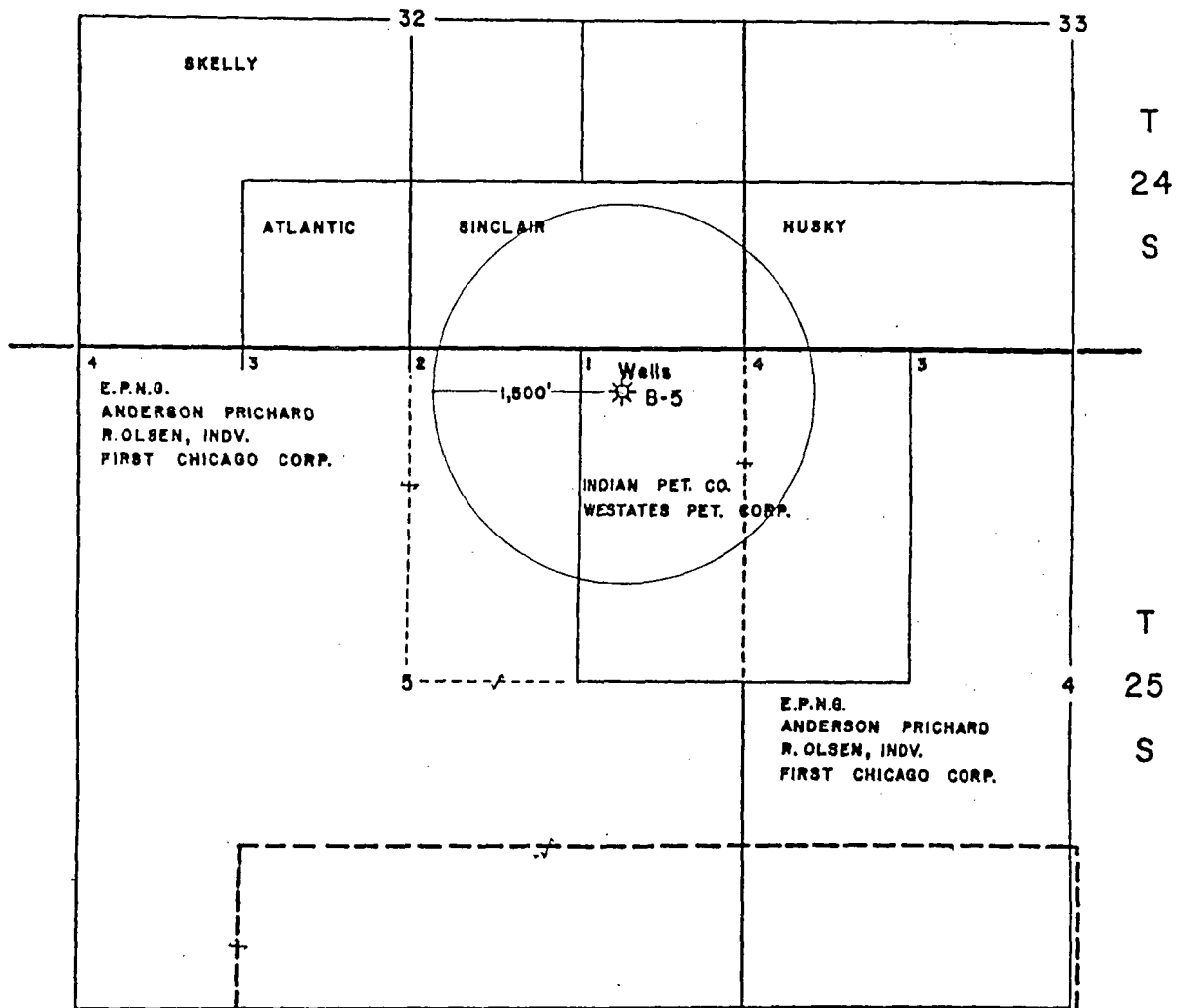

LANGLIE UNIT

NEW MEXICO OIL CONSERVATION COMMISSION
WELL LOCATION AND ACREAGE DEDICATION PLAT

Form C-102
Supersedes C-128
Effective 1-1-65

All distances must be from the outer boundaries of the Section.

Atlantic Richfield Company			Lease <u>State 157-E</u>		Well No. <u>1</u>
Section	Township	Range	County		
<u>32</u>	<u>24S</u>	<u>37E</u>	<u>Lea</u>		

Actual Footage Location of Well:							
2310	feet from the	North	line and	2310	feet from the	East	line
Sound Level Elev.	Producing Formation		Pool		Dedicated Acreage:		
3251'	Yates		Jalmat Gas		240 Acres		

1. Outline the acreage dedicated to the subject well by colored pencil or hachure marks on the plat below.
2. If more than one lease is dedicated to the well, outline each and identify the ownership thereof (both as to working interest and royalty).
3. If more than one lease of different ownership is dedicated to the well, have the interests of all owners been consolidated by communitization, unitization, force-pooling, etc?

☒ Yes ☐ No If answer is "yes," type of consolidation Communitization

If answer is "no," list the owners and tract descriptions which have actually been consolidated. (Use reverse side of this form if necessary.) _____

No allowable will be assigned to the well until all interests have been consolidated (by communitization, unitization, forced-pooling, or otherwise) or until a non-standard unit, eliminating such interests, has been approved by the Commission.

R-37-E

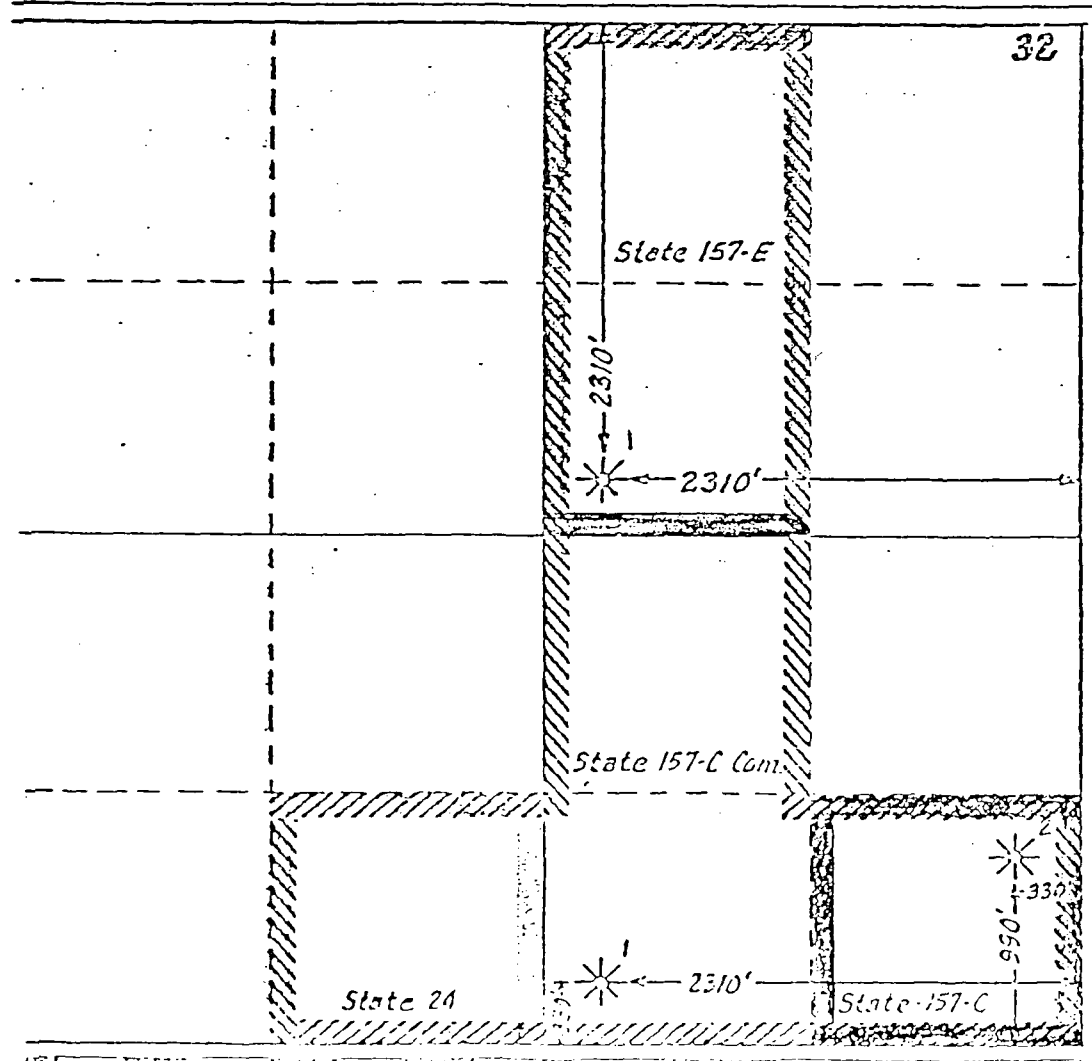

CERTIFICATION	
I hereby certify that the information contained herein is true and complete to the best of my knowledge and belief.	
Name	<u>Louis C. Soderstrom</u>
Position	<u>Engineer</u>
Company	<u>Atlantic Richfield Company</u>
Date	<u>November 1, 1974</u>
I hereby certify that the well location shown on this plat was plotted from field notes of actual surveys made by me or under my supervision, and that the same is true and correct to the best of my knowledge and belief.	
Date Surveyed	
Registered Professional Engineer and/or Land Surveyor	
Certificate No.	

NEW MEXICO OIL CONSERVATION COMMISSION
WELL LOCATION AND ACREAGE DEDICATION PLAT

Form 1-1-2
Supersedes C-128
Effective 1-1-65

All distances must be from the outer boundaries of the Section

Operator Doyle Hartman		Lease Husky		Well No. 1	
Unit Letter M	Section 33	Township 24 South	Range 37 East	County Lea	
Actual Footage Location of Well: 430 feet from the West line and 330 feet from the South line					
Ground Level Elev. 3251.9	Producing Formation Yates-Seven Rivers		Pool Jalmat	Dedicated Acreage 80 Acres	

- Outline the acreage dedicated to the subject well by colored pencil or hachure marks on the plat below.
- If more than one lease is dedicated to the well, outline each and identify the ownership thereof (both as to working interest and royalty).
- If more than one lease of different ownership is dedicated to the well, have the interests of all owners been consolidated by communitization, unitization, force-pooling, etc?

☐ Yes ☐ No If answer is "yes," type of consolidation _____

If answer is "no," list the owners and tract descriptions which have actually been consolidated. (Use reverse side of this form if necessary.) _____

No allowable will be assigned to the well until all interests have been consolidated (by communitization, unitization, forced-pooling, or otherwise) or until a non-standard unit, eliminating such interests, has been approved by the Commission.

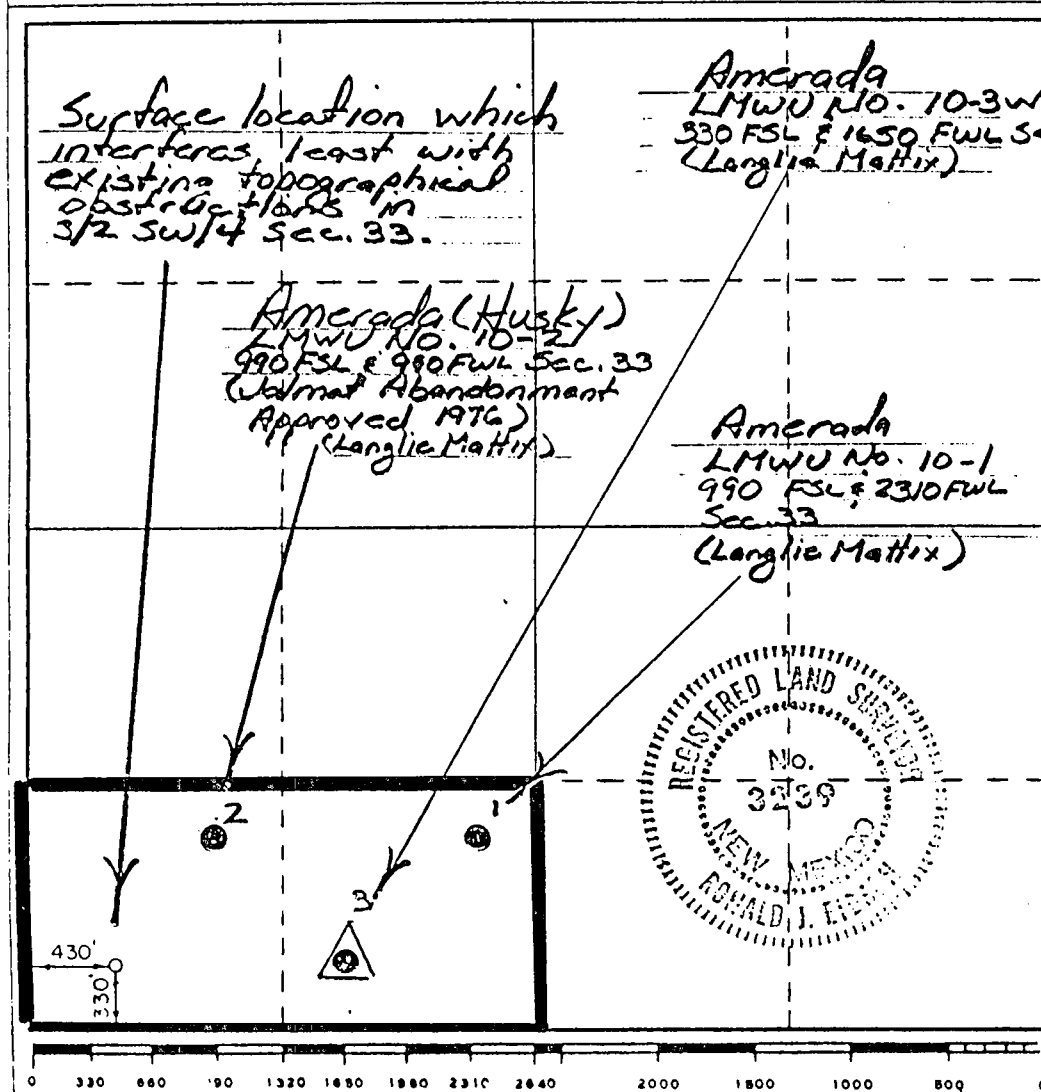

CERTIFICATION

I hereby certify that the information contained herein is true and complete to the best of my knowledge and belief.

Larry A. Nemyr
Name

Larry Nemyr

Petroleum Engineer

Doyle Hartman

August 14, 1981

I hereby certify that the well location shown on this plat was plotted from field notes of actual surveys made by me or under my supervision, and that the same is true and correct to the best of my knowledge and belief.

August 13, 1981

Registered Professional Engineer and/or Land Surveyor

Ronald J. Eidson

Certificate No. JOHN W. WEST 876
PATRICK A. ROMERO 8863
Ronald J. Eidson 3239



NEW MEXICO ENERGY, MINERALS
& NATURAL RESOURCES DEPARTMENT

OIL CONSERVATION DIVISION
2040 South Pacheco Street
Santa Fe, New Mexico 87505
(505) 827-7131

March 12, 1999

SDX Resources, Inc.
P. O. Box 5061
Midland, Texas 79704
Attention: Chuck Morgan

Administrative Order SD-99-4

Dear Mr. Morgan:

Reference is made to your application dated March 5, 1999. SDX Resources, Inc. ("SDX") is hereby authorized to simultaneously dedicate gas production from the Jalmat Gas Pool to the previously approved non-standard 160.45-acre gas spacing and proration unit ("GPU") comprising Lots 3 and 4 and the S/2 NW/4 (NW/4 equivalent) of Section 4, Township 25 South, Range 37 East, NMPM, Lea County, New Mexico (approved by Division Administrative Order NSP-1209, dated August 21, 1980) from the: (i) existing El Paso Wells Federal Well No. 1 (API No. 30-025-26951) located at a standard gas well location 1980 feet from the North line and 660 feet from the West line (Unit E) of Section 4; and (ii) proposed El Paso Wells Federal Well No. 2 to be drilled at a standard gas well location 660 feet from the North line and 1980 feet from the West line (Lot 3/Unit C) of Section 4.

SDX is permitted to produce the allowable assigned this existing non-standard 160-acre GPU from both wells in any proportion.

Sincerely,

Lori Wrotenberg
Director

LW/MES/kv

cc: New Mexico Oil Conservation Division - Hobbs
U. S. Bureau of Land Management - Carlsbad
File: NSP-1209

NE EXICO OIL CONSERVATION COMMISSION
WELL LOCATION AND ACREAGE DEDICATION . LAT

Form C-102
Supersedes C-128
Effective 1-1-65

Now SPX

All distances must be from the outer boundaries of the Section

Operator DOYLE HARTMAN			Lessee WELLS FEDERAL			Well No. 18		
Unit Letter M	Section 4	Township 25 SOUTH	Range 37 EAST	County LEA				
Actual Footage Location of Well: 330 feet from the SOUTH line and 660 feet from the WEST line								
Ground Level Elev. 3189.9	Producing Formation YATES-SEVEN RIVERS			Pool JALMAT (GAS)			Dedicated Acreage: 120 Acres	

1. Outline the acreage dedicated to the subject well by colored pencil or hatchure marks on the plat below.
2. If more than one lease is dedicated to the well, outline each and identify the ownership thereof (both as to working interest and royalty).
3. If more than one lease of different ownership is dedicated to the well, have the interests of all owners been consolidated by communitization, unitization, force-pooling, etc?

☒ Yes ☐ No If answer is "yes," type of consolidation Existing C.A. SW-1147

If answer is "no," list the owners and tract descriptions which have actually been consolidated. (Use reverse side of this form if necessary.)

No allowable will be assigned to the well until all interests have been consolidated (by communitization, unitization, forced-pooling, or otherwise) or until a non-standard unit, eliminating such interests, has been approved by the Commission.

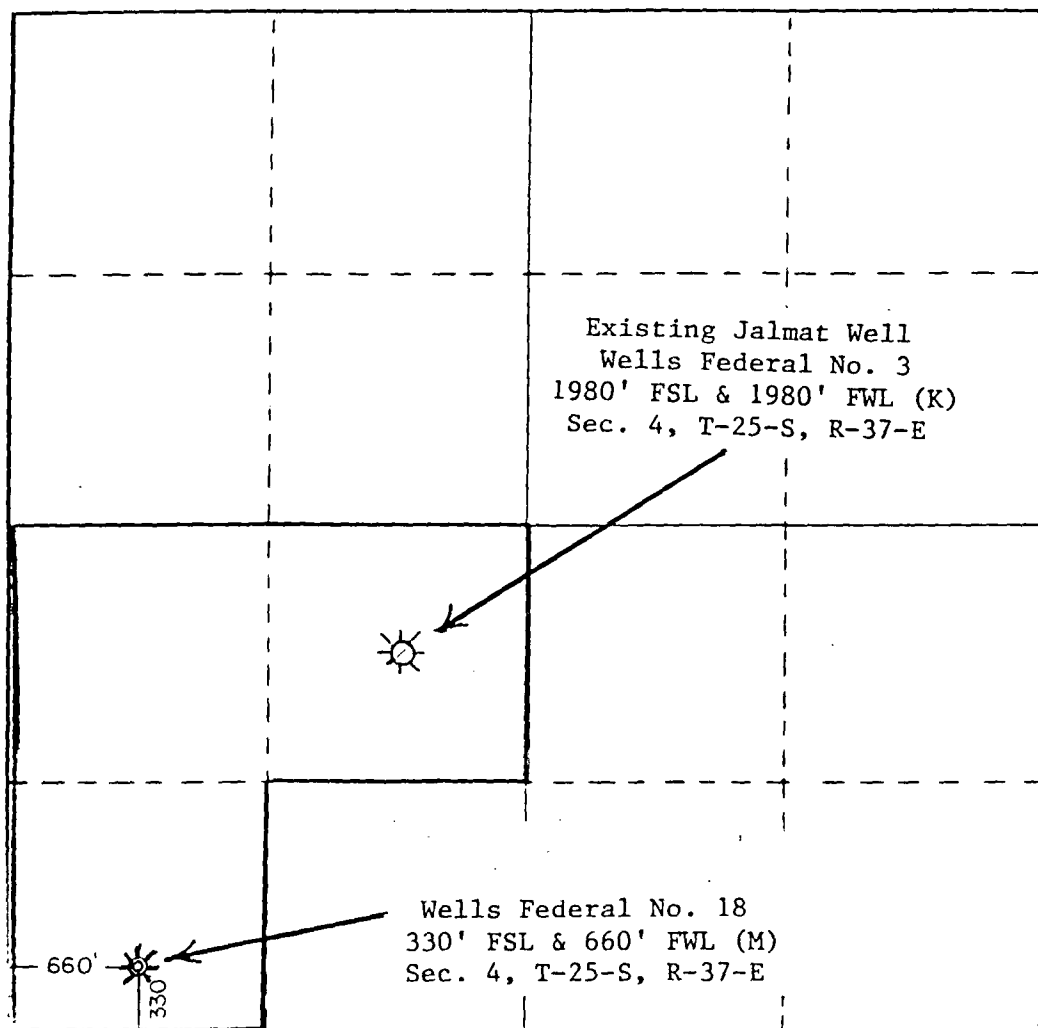

CERTIFICATION

I hereby certify that the information contained herein is true and complete to the best of my knowledge and belief.

Name Larry G. Norman

Position Engineer

Company Doyle Hartman

Date Nov 21, 1984

I hereby certify that the well location shown on this plat was plotted from field notes of actual surveys made by me or under my supervision, and that the same is true and correct to the best of my knowledge and belief.

Date Surveyed OCTOBER 16, 1984

Registered Professional Engineer and/or Land Surveyor

John W. West

Certificate No. JOHN W. WEST, 676
RONALD J. FIDSON 3239

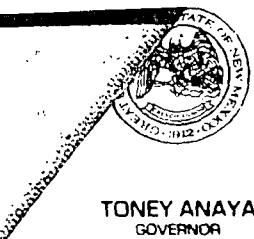

STATE OF NEW MEXICO
ENERGY AND MINERALS DEPARTMENT
OIL CONSERVATION DIVISION

POST OFFICE BOX 2088
STATE LAND OFFICE BUILDING
SANTA FE, NEW MEXICO 87501
(505) 827-5800

December 3, 1984

Doyle Hartman
Oil Operator
P.O. Box 10426
Midland, Texas 79702

Attention: Michelle Hembree

Amended
Administrative Order NSL-1936

Gentlemen:

Reference is made to your application for a non-standard location and simultaneous dedication for your Wells Federal Well No. 18 located 330 feet from the South line and 660 feet from the West line N/2 SW/4 and SW/4 SW/4 of Section 4, Township 25 South, Range 37 East, Jalmat Gas Pool, Lea County, New Mexico.

By authority granted me under the provisions of Rule 104 FI of the Division Rules and Regulations, the above-described unorthodox location is hereby approved, and is to be simultaneously dedicated to the existing 120-acre non-standard gas proration unit comprising the N/2 SW/4 and SW/4 SW/4 of Section 4 with your Wells Federal Well No. 3 located in Unit K of said section, both wells in Township 25 South, Range 37 East, Lea County, New Mexico.

Further, you are hereby permitted to produce the allowable from any of the wells on the proration unit in any proportion.

Sincerely,

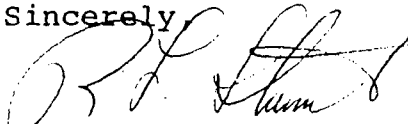

R. L. STAMETS,
Director

RLS/dp

cc: Oil Conservation Division - Aztec
Oil & Gas Engineering Committee - Hobbs
Bureau of Land Management - Farmington

DEC 7 1984

ENERGY AND MINERALS DEPARTMENT
OIL CONSERVATION DIVISIONTONEY ANAYA
GOVERNORPOST OFFICE BOX 2088
STATE LAND OFFICE BUILDING
SANTA FE, NEW MEXICO 87501
(505) 827-5800

November 16, 1984

Doyle Hartman
Oil Operator
P.O. Box 10426
Midland, Texas 79702

Attention: Michelle Hembree

Administrative Order NSL-1936

Gentlemen:

Reference is made to your application for a non-standard location and simultaneous dedication for your Wells Federal Well No. 18 located 330 feet from the South line and 660 feet from the West line N/2 SW/4 and SW/4 SW/4 of Section 5, Township 25 South, Range 37 East, Jalmat Gas Pool, Lea County, New Mexico.

By authority granted me under the provisions of Rule 104 FI of the Division Rules and Regulations, the above-described unorthodox location is hereby approved, and is to be simultaneously dedicated to the existing 120-acre non-standard gas proration unit comprising the N/2 SW/4 and SW/4 SW/4 of Section 5 with your Wells Federal Well No. 3 located in Unit K of said section, both wells in Township 25 South, Range 37 East, Lea County, New Mexico.

Further, you are hereby permitted to produce the allowable from any of the wells on the proration unit in any proportion.

Sincerely,

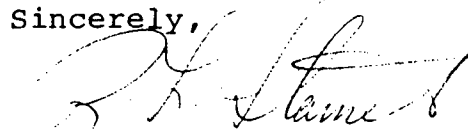
R. L. STAMETS,
Director

RLS/dp

cc: Oil Conservation Division - Aztec
Oil & Gas Engineering Committee - Hobbs
Bureau of Land Mangement - Farmington

NOV 21 1984

District I
PO Box 1980, Hobbs, NM 88241-1980
District II
PO Drawer DD, Artesia, NM 88211-0719
District III
1000 Rio Brazos Rd., Aztec, NM 87410
District IV
PO Box 2088, Santa Fe, NM 87504-2088

State of New Mexico
Energy, Minerals & Natural Resources Department

OIL CONSERVATION DIVISION
PO Box 2088
Santa Fe, NM 87504-2088

MAR 11 1999

Form C-102
Revised February 10, 1994
Instructions on back
Submit to Appropriate District Office
State Lease - 4 Copies
Fee Lease - 3 Copies

☐ AMENDED REPORT

WELL LOCATION AND ACREAGE DEDICATION PLAT

API Number		Pool Code 79240	Pool Name Jalmat Gas
Property Code 23990	Property Name WELLS FEDERAL		Well Number 21
OGRID No. 020451	Operator Name SDX RESOURCES, INC.		Elevation 3205.

¹⁰ Surface Location

UL or lot no.	Section	Township	Range	Lot Idn	Feet from the	North/South line	Feet from the	East/West line	County
0	5	25-S	37-E		660	SOUTH	2310	EAST	LEA

¹¹ Bottom Hole Location If Different From Surface

UL or lot no.	Section	Township	Range	Lot Idn	Feet from the	North/South line	Feet from the	East/West line	County

¹² Dedicated Acres	¹³ Joint or Infill	¹⁴ Consolidation Code	¹⁵ Order No.

NO ALLOWABLE WILL BE ASSIGNED TO THIS COMPLETION UNTIL ALL INTERESTS HAVE BEEN CONSOLIDATED
OR A NON-STANDARD UNIT HAS BEEN APPROVED BY THE DIVISION

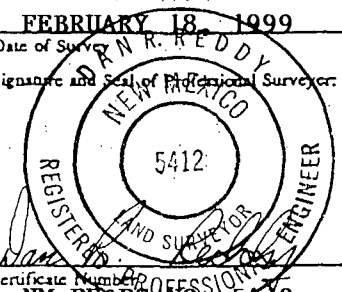
<div style="position: relative; height: 400px;"> <div style="position: absolute; top: 10%; left: 10%;">#17</div> <div style="position: absolute; top: 15%; left: 60%;">#1</div> <div style="position: absolute; bottom: 10%; left: 10%;">Existing Wells</div> <div style="position: absolute; bottom: 10%; left: 10%;">#21</div> <div style="position: absolute; bottom: 10%; left: 50%;">2310'</div> <div style="position: absolute; bottom: 10%; left: 10%;">660'</div> </div>	<p>¹⁷ OPERATOR CERTIFICATION</p> <p>I hereby certify that the information contained herein is true and complete to the best of my knowledge and belief.</p> <p><i>Bonnie Atwater</i> Signature Bonnie Atwater Printed Name Regulatory Tech Title March 4, 1999 Date</p>
	<p>¹⁸ SURVEYOR CERTIFICATION</p> <p>I hereby certify that the well location shown on this plat was plotted from field notes of actual surveys made by me or under my supervision, and that the same is true and correct to the best of my belief.</p> <p>FEBRUARY 18, 1999 Date of Survey Signature and Seal of Professional Surveyor:  </p>

NEW MEXICO OIL CONSERVATION COMMISSION
WELL LOCATION AND ACREAGE DEDICATION PLAT

Form C-102
Supersedes C-12
Effective 1-1-65

All distances must be from the outer boundaries of the Section

Operator DOYLE HARTMAN		Lease WELLS FEDERAL		Well No. 17	
Unit Letter J	Section 5	Township 25S	Range 37E	County LEA	
Actual Footage Location of Well: 1450 feet from the EAST line and 1980 feet from the SOUTH line					
Ground Level Elev. 3229.9	Producing Formation YATES-SEVEN RIVERS		Pool JALMAT (GAS)		Dedicated Acreage: 200 Acres

1. Outline the acreage dedicated to the subject well by colored pencil or hachure marks on the plat below.
2. If more than one lease is dedicated to the well, outline each and identify the ownership thereof (both as to working interest and royalty).
3. If more than one lease of different ownership is dedicated to the well, have the interests of all owners been consolidated by communitization, unitization, force-pooling, etc?

☐ Yes ☐ No If answer is "yes," type of consolidation _____

If answer is "no," list the owners and tract descriptions which have actually been consolidated. (Use reverse side of this form if necessary.) _____

No allowable will be assigned to the well until all interests have been consolidated (by communitization, unitization, forced-pooling, or otherwise) or until a non-standard unit, eliminating such interests, has been approved by the Commission.

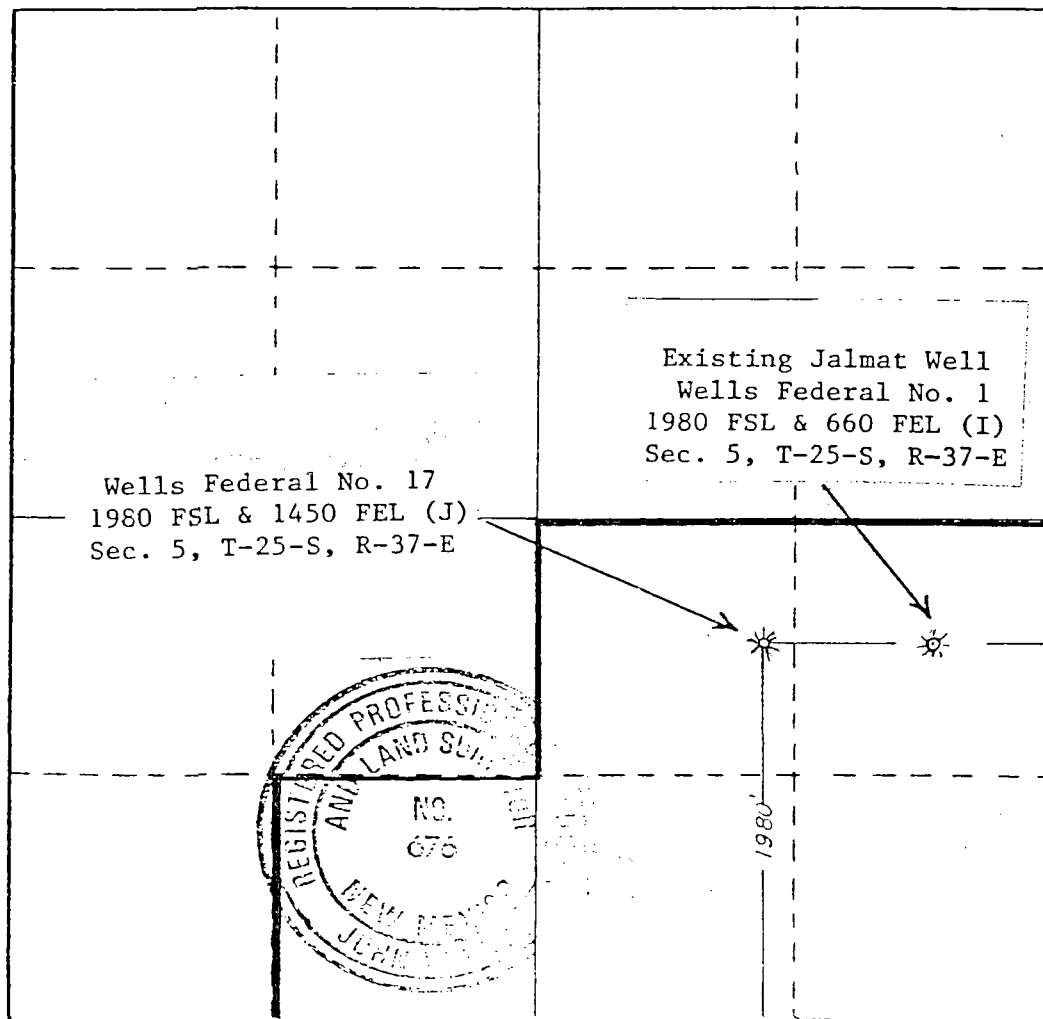

CERTIFICATION

I hereby certify that the information contained herein is true and complete to the best of my knowledge and belief.

Name
Larry A. Nanning

Position
Engineer

Company
Doyle Hartman

Date
JULY 24, 1984

I hereby certify that the well location shown on this plat was plotted from field notes of actual surveys made by me or under my supervision, and that the same is true and correct to the best of my knowledge and belief.

Date Surveyed
4/12/84

Registered Professional Engineer and/or Land Surveyor

John W. West

Certificate No. JOHN W. WEST, 676
RONALD J. EIDSON, 3239

330 440 550 660 770 880 990 1100 1210 1320 1430 1540 1650 1760 1870 1980 2090 2200 2310 2420 2530 2640 2750 2860 2970 3080 3190 3300 3410 3520 3630 3740 3850 3960 4070 4180 4290 4400 4510 4620 4730 4840 4950 5060 5170 5280 5390 5500 5610 5720 5830 5940 6050 6160 6270 6380 6490 6600 6710 6820 6930 7040 7150 7260 7370 7480 7590 7700 7810 7920 8030 8140 8250 8360 8470 8580 8690 8800 8910 9020 9130 9240 9350 9460 9570 9680 9790 9900 10000



NEW MEXICO ENERGY, MINERALS
& NATURAL RESOURCES DEPARTMENT

OIL CONSERVATION DIVISION
2040 South Pacheco Street
Santa Fe, New Mexico 87505
(505) 827-7131

March 31, 1999

SDX Resources, Inc.
P. O. Box 5061
Midland, Texas 79704
Attention: Chuck Morgan

Administrative Order NSL-4248(SD)

Dear Mr. Morgan:

Reference is made to your applications dated March 4, 1999 for two unorthodox Jalmat gas well locations in an existing non-standard 200-acre gas spacing and proration unit ("GPU") for the Jalmat Gas Pool comprising the SE/4 SW/4 and SE/4 of Section 5, Township 25 South, Range 37 East, NMPM, Lea County, New Mexico. This non-standard GPU was established by Division Administrative Order NSP-400, dated November 11, 1957 and had dedicated thereon the Wells Federal Well No. 1 (**API No. 30-025-11462**), located 1980 feet from the South line and 660 feet from the East line (Unit I) of Section 5.

By amendment to Division Administrative Order NSP-400 (L) (SD), dated August 17, 1984, a second well, the Wells Federal Well No. 17 (**API No. 30-025-28850**), located at an unorthodox gas well location 1980 feet from the South line and 1450 feet from the East line (Unit J) of Section 5 was approved for this GPU.

By authority granted me under the provisions of Rule 2(d) of the "*Special Rules and Regulations for the Jalmat Gas Pool*", as promulgated by Division Order No. R-8170, as amended, and Division Rule 104.F (2) the following two wells to be drilled at unorthodox Jalmat gas well locations in Section 5 are hereby approved:

Wells Federal Well No. 20
820' FSL & 1238' FEL (Unit P)

Wells Federal Well No. 21
660' FSL & 2310' FEL (Unit O)

Also, you are hereby authorized to simultaneously dedicate Jalmat gas production from the proposed Wells Federal Wells No. 20 and 21 with the existing Wells Federal Wells No. 1 and 17.

Administrative Order NSL-4248(SD)

SDX Resources, Inc.

March 31, 1999

Page 2

Furthermore, you are hereby permitted to produce the allowable assigned the subject 200-acre GPU from all four wells in any proportion.

Sincerely,

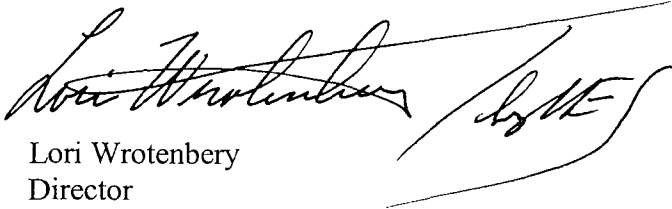
A handwritten signature in black ink, appearing to read "Lori Wrotenbery", followed by a large, stylized flourish or signature mark.

Lori Wrotenbery
Director

LW/MES/kv

cc: New Mexico Oil Conservation Division - Hobbs
U. S. Bureau of Land Management - Carlsbad
File: NSP-400

DOYLE HARTMAN

Lease

E. J. WELLS

Well No.

16

Unit Letter

Section

Township

Range

County

L

5

25 SOUTH

37 EAST

FLA

Actual Footage Location of Well:

2310

feet from the

SOUTH

line and

610

feet from the

EAST

line

Ground Level Elev.

610.7

Producing Formation

YATES-SEVEN RIVERS

Pool

JALMAT (GAS)

Dedicated Acreage:

120

Acres

1. Outline the acreage dedicated to the subject well by colored pencil or hachure marks on the plat below.
2. If more than one lease is dedicated to the well, outline each and identify the ownership thereof (both as to working interest and royalty).
3. If more than one lease of different ownership is dedicated to the well, have the interests of all owners been consolidated by communitization, unitization, force-pooling, etc?

☐ Yes ☐ No If answer is "yes," type of consolidation _____

If answer is "no," list the owners and tract descriptions which have actually been consolidated. (Use reverse side of this form if necessary.) _____

No allowable will be assigned to the well until all interests have been consolidated (by communitization, unitization, forced-pooling, or otherwise) or until a non-standard unit, eliminating such interests, has been approved by the Commission.

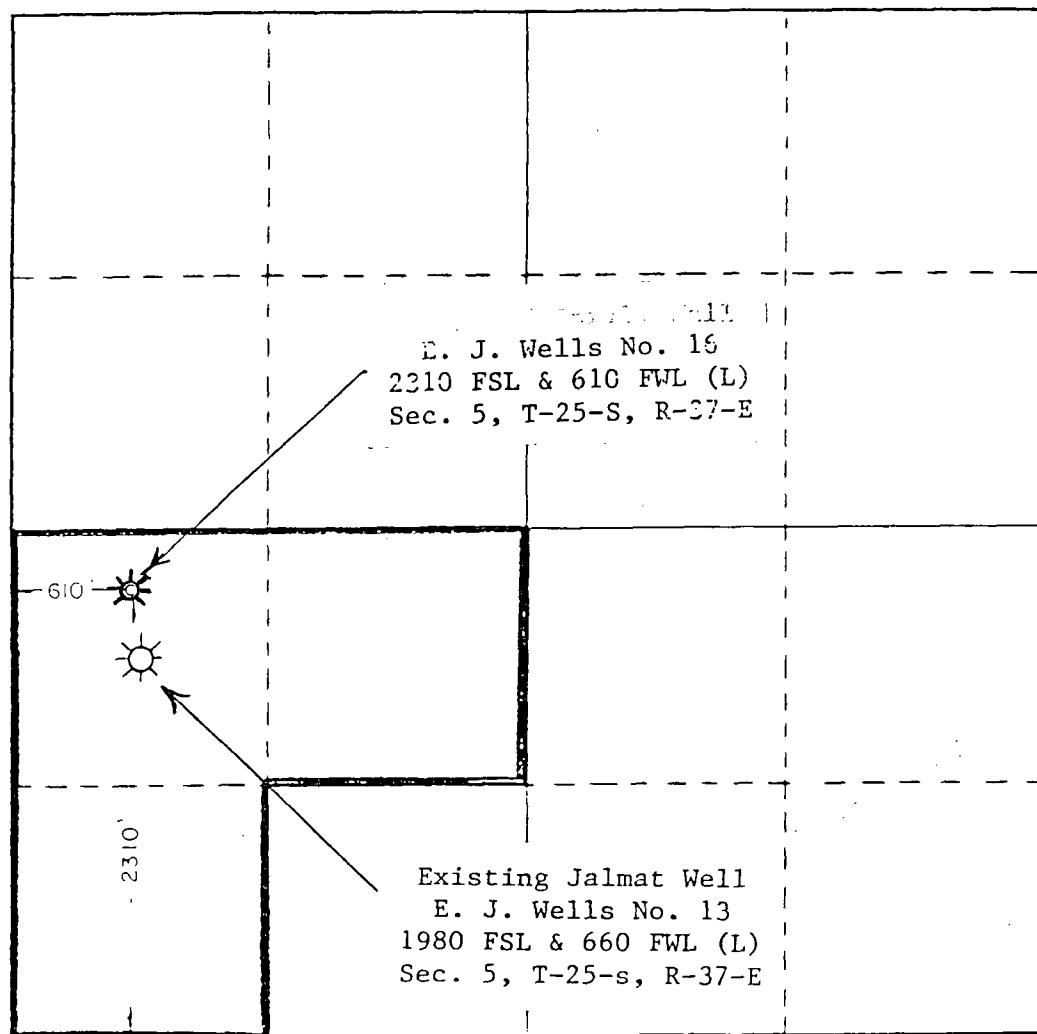

CERTIFICATION

I hereby certify that the information contained herein is true and complete to the best of my knowledge and belief.

Name

Larry A. Norman

Position

Engineer

Company

Doyle Hartman

Date

May 29, 1984

I hereby certify that the well location shown on this plat was plotted from field notes of actual surveys made by me or under my supervision, and that the same is true and correct to the best of my knowledge and belief.

Date Surveyed

MAY 20, 1984

Registered Professional Engineer
and/or Land Surveyor

Certificate No. JOHN W. WEST, 676

RONALD J. EIDSON, 3239

APR 24 1984



STATE OF NEW MEXICO
ENERGY AND MINERALS DEPARTMENT
OIL CONSERVATION DIVISION

TONY ANAYA
GOVERNOR

POST OFFICE BOX 2088
STATE LAND OFFICE BUILDING
SANTA FE, NEW MEXICO 87501
(505) 827-5800

June 22, 1984

Doyle Hartman
Oil Operator
P.O. Box 10426
Midland, Texas 79702

Attention: Michelle Hembree

Administrative Order NSL-1823

Gentlemen:

Reference is made to your application for a non-standard location and simultaneous dedication for your E. J. Well No. 16 located 2310 feet from the South line and 610 feet from the West line of Section 5, Township 25 South, Range 37 East, JaLmat Gas Pool, Lea County, New Mexico.

By authority granted me under the provisions of Rule 3, Section 1 of Division Order No. R-1670, the above-described unorthodox location is hereby approved, and is to be simultaneously dedicated to the existing 120-acre non-standard gas proration unit comprising the W/2 SW/4 and NE/4 SW/4 of Section 5 with your E. J. Well No. 13 located in Unit L of said Section, both wells in Township 25 South, Range 37 East, Lea County, New Mexico.

JUN 28 1984

Further, you are hereby permitted to produce the allowable from any of the wells on the proration unit in any proportion.

Sincerely,

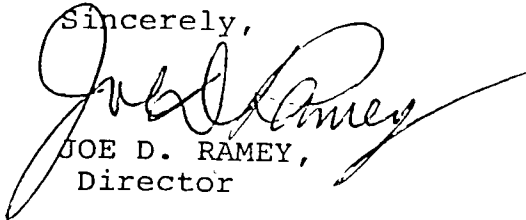
A handwritten signature in cursive script, appearing to read "Joe D. Ramey", written over the typed name and title.

JOE D. RAMEY,
Director

JDR/RLS/dp

cc: Oil Conservation Division - Hobbs
Oil & Gas Engineering Committee - Hobbs
Bureau of Land Management - Hobbs

WELL LOCATION AND ACREAGE DEDICATION PLAT

Supersedes C-128
Effective 1-1-65

Now SDX

All distances must be from the outer boundaries of the Section

Owner DOYLE HARTMAN		Lease WELLS FEDERAL		Well No. 15	
Lot Letter 1	Section 5	Township 25S	Range 37E	County LEA	
Actual Footage Location of Well:					
810 feet from the NORTH line and		460 feet from the WEST line			
Ground Level Elev. 1231.5	Producing Formation YATES-SEVEN RIVERS	Pool JALMAT (GAS)	Dedicated Acreage 160 Acres		

1. Outline the acreage dedicated to the subject well by colored pencil or hatchure marks on the plat below.
2. If more than one lease is dedicated to the well, outline each and identify the ownership thereof (both as to working interest and royalty).
3. If more than one lease of different ownership is dedicated to the well, have the interests of all owners been consolidated by communitization, unitization, force-pooling, etc?

☐ Yes ☐ No If answer is "yes," type of consolidation _____

If answer is "no," list the owners and tract descriptions which have actually been consolidated. (Use reverse side of this form if necessary.) _____

No allowable will be assigned to the well until all interests have been consolidated (by communitization, unitization, forced-pooling, or otherwise) or until a non-standard unit, eliminating such interests, has been approved by the Commission.

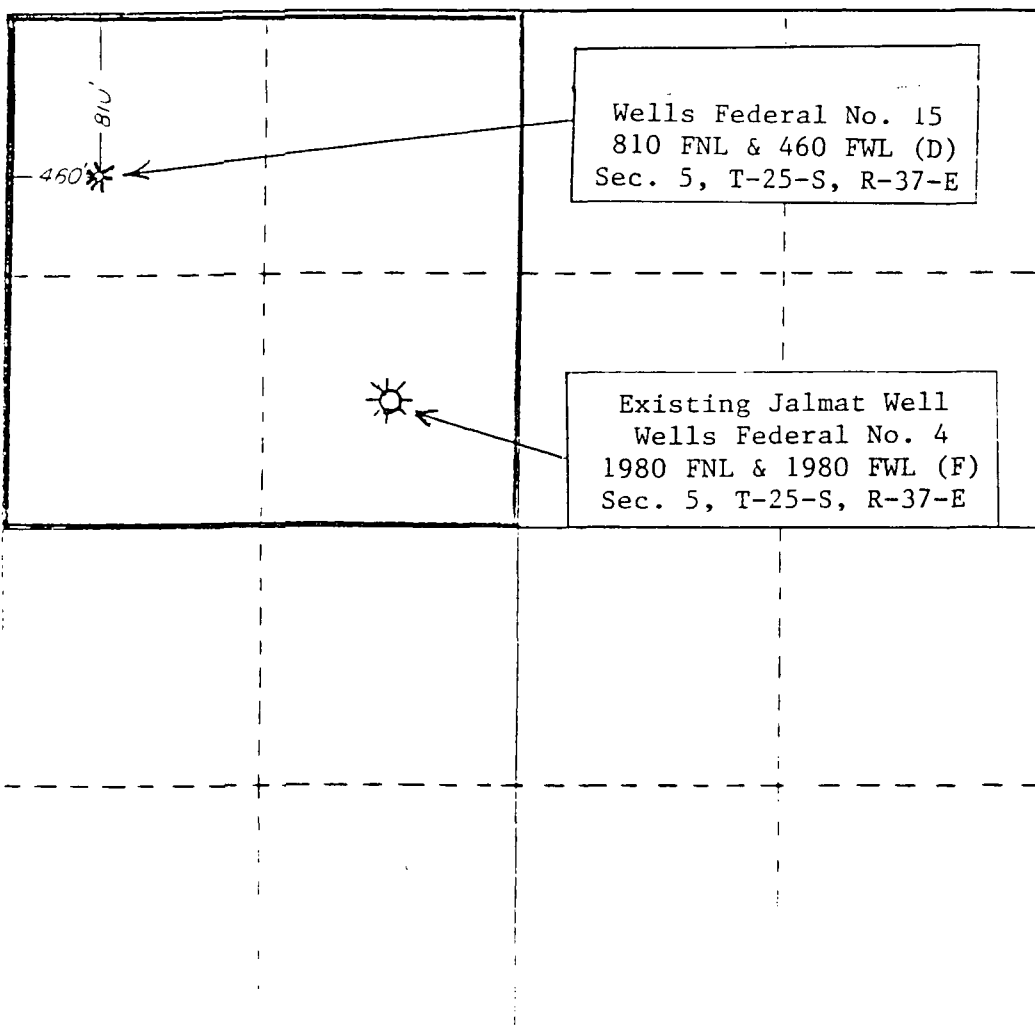

CERTIFICATION

I hereby certify that the information contained herein is true and complete to the best of my knowledge and belief.

Name Larry G. Nemy
 Position Engineer
 Company Doyle Hartman
 Date April 25, 1984

I hereby certify that the well location shown on this plat was plotted from field notes of actual surveys made by me or under my supervision, and that the same is true and correct to the best of my knowledge and belief.

Date Surveyed 4/11/84
 Registered Professional Engineer and Land Surveyor
John W. White



STATE OF NEW MEXICO
ENERGY AND MINERALS DEPARTMENT
OIL CONSERVATION DIVISION

TONY ANAYA
GOVERNOR

POST OFFICE BOX 2088
STATE LAND OFFICE BUILDING
SANTA FE, NEW MEXICO 87501
(505) 827-5800

May 17, 1984

Doyle Hartman
Oil Operator
P. O. BOX 10426
Midland, Texas 79702

Attention: Michelle Hembree, Administrative Assistant

Administrative Order NSL-1821 (SD)

Gentlemen:

Reference is made to your application for a non-standard location and simultaneous dedication for your Wells Federal Well No. 15 located 810 feet from the North line and 460 feet from the West line, NW/4 of Section 5, Township 25 South, Range 37 East, Jalmat Gas Pool, Lea County, New Mexico.

By authority granted me under the provisions of Rule 3, Section 1 of Division Order No. R-1670, the above-described unorthodox location is hereby approved, and is to be simultaneously dedicated to the existing 160-acre non-standard gas proration unit comprising the NW/4 of Section 5 with your Wells Federal Well No. 4 located in Unit F of said section, both wells in Township 25 South, Range 37 East, Lea County, New Mexico.

Further, you are hereby permitted to produce the allowable from any of the wells on the proration unit in any proportion.

Sincerely,

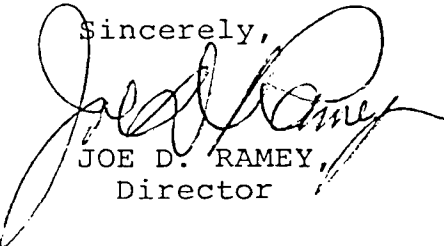

JOE D. RAMEY,
Director

JDR/bok

cc: Oil Conservation Division - Aztec
Oil & Gas Engineering Committee - Hobbs
Bureau of Land Management - Farmington

MAY 24 1984

OFFSET OPERATORS

WELLS B5 FEDERAL #3

Gruy Petroleum
ATTN: Zeno Ferris
PO Box 140907
Irving, TX 75014-0907

Arco
PO Box 1089
Eunice, NM 88231-1089

CMD :
OG5SECTONGARD
INQUIRE LAND BY SECTION11/02/99 17:00:30
OGOMES -TPRI
PAGE NO: 1

Sec : 05 Twp : 25S Rng : 37E Section Type : NORMAL

4 39.94 Federal owned U A A	3 40.01 Federal owned U A	2 40.09 Federal owned U A A	1 40.16 Federal owned U A A
E 40.00 Federal owned U A	F 40.00 Federal owned U A A	G 40.00 Federal owned U A A A	H 40.00 Federal owned U A

PF01 HELP
PF07 BKWDPF02
PF08 FWDPF03 EXIT
PF09 PRINTPF04 GoTo
PF10 SDIVPF05
PF11PF06
PF12

80.09
80.16

160.25

CMD :
OG5SECTONGARD
INQUIRE LAND BY SECTION11/02/99 17:05:46
OGOMES -TPRI
PAGE NO: 2

Sec : 05 Twp : 25S Rng : 37E Section Type : NORMAL

L 40.00 Federal owned U A A A	K 40.00 Federal owned U A	J 40.00 Federal owned U A A A	I 40.00 Federal owned U A A A A A
M 40.00 Federal owned U A	N 40.00 Federal owned U A	O 40.00 Federal owned U A A A	P 40.00 Federal owned U A

PF01 HELP
PF07 BKWDPF02
PF08 FWDPF03 EXIT
PF09 PRINTPF04 GoTo
PF10 SDIVPF05
PF11PF06
PF12

OIL CONSERVATION COMMISSION

P. O. BOX 871

SANTA FE, NEW MEXICO

October 13, 1954

Westates Petroleum Corporation
P. O. Box 1381
JAL, NEW MEXICO

Attention: John G. Benton, Division Superintendent

Gentlemen: Administrative Order NSP-14

Reference is made to your application (received September 13, 1954) for approval of an 80-acre non-standard gas proration unit consisting of E/2 NE/4 of Section 5, Township 25 South, Range 37 East, NMPM, Lea County, New Mexico, said unit to be ascribed to your well B-5, No. 1, located 330 feet from the north line and 990 feet from the east line of Section 5, Township 25 South, Range 37 East.

By authority granted me under provisions of Rule 5, Section (b)-6 of the Special Rules and Regulations for the Jalmat Gas Pool, you are hereby authorized to operate the above-described acreage as a non-standard gas proration unit, with allowable to be assigned thereto in accordance with pool rules.

At the same time, present location of the well is approved under the terms of Rule 2 of the Jalmat Pool rules, which stipulates that any well drilled to and producing from the Jalmat Gas Pool prior to the effective date of Order R-520 at a location conforming to the spacing requirements effective at the time said well was drilled shall be considered located in conformance with the rule.

Very truly yours,

W. B. Macey
Secretary - Director

WBM:nr

cc: Oil Conservation Commission
Hobbs

N. M. Oil & Gas Eng. Committee
Hobbs

OIL CONSERVATION COMMISSION

P. O. BOX 871

SANTA FE, NEW MEXICO

May 9, 1957

El Paso Natural Gas Company
P. O. Box 1492
El Paso, Texas

Attention: Mr. H. L. Hamblin

Administrative Order NMP-370

Gentlemen:

Reference is made to your application for approval of a 160-acre non-standard gas proration unit in the Jalmat Gas Pool consisting of the following acreage:

Township 25 South, Range 37 East
NE/4 of Section 5

It is understood that this unit is to be ascribed to your Wells "B-5" Well No. 1, located 330 feet from the north line and 990 feet from the east line and Lot 1 of Section 5, Township 25 South, Range 37 East, NMPS, Lea County, New Mexico.

By authority granted me under provisions of Rule 3, Section (b)-6 of the Special Rules and Regulations for the Jalmat Gas Pool, as set forth in Order N-520, you are hereby authorized to operate the above described acreage as a non-standard gas proration unit, with allowable to be assigned thereto in accordance with Rule 8 of the pool rules, based upon the unit size of 160 acres after submission of proof of communitization to both the Santa Fe and Hobbs Offices.

Very truly yours,

A. L. PORTER, Jr.
Secretary-Director

WMM:og

cc: Oil Conservation Commission, Hobbs, New Mexico
New Mexico Oil & Gas Engineering Commission, Hobbs, New Mexico
El Paso Natural Gas Co., Jal, New Mexico
El Paso Natural Gas Co., El Paso, Texas
Westates Petroleum Corp., 391 Butter St., San Francisco, 2, Calif.



STATE OF NEW MEXICO
ENERGY AND MINERALS DEPARTMENT
OIL CONSERVATION DIVISION

BRUCE KING
GOVERNOR

November 5, 1982

POST OFFICE BOX 2088
STATE LAND OFFICE BUILDING
SANTA FE, NEW MEXICO 87501
(505) 827-2434

Doyle Hartman
P. O. Box 10426
Midland, Texas 79702

Attention: Larry A. Nermyr

Administrative Order NSL-1597

Gentlemen:

Reference is made to your application for a non-standard location for your Wells "B-5" Well No. 2 to be located 1552 feet from the North line and 2230 feet from the East line of Section 5, Township 25 South, Range 37 East, Jalmat Gas Pool, Lea County, New Mexico. In addition, you are hereby authorized to simultaneously dedicate a previously approved 160 acre proration unit comprising the NE/4 of Section 5, Township 25 South, Range 37 East, NMPM, Lea County, to the above-described well and your Wells "B-5" Well No. 1 located in Unit A of said Section 5. Further, you are hereby permitted to produce the allowable from any of the wells on the proration unit in any proportion.

By authority granted me under the provisions of Rule 3 of Order No. R-1670, the above-described unorthodox location is hereby approved.

Sincerely,

A handwritten signature in dark ink, appearing to read "Joe D. Ramey", written over the typed name and title.

JOE D. RAMEY,
Director

JDR/RLS/dr

cc: Oil Conservation Division - Hobbs
Oil & Gas Engineering Committee - Hobbs
Minerals Management Service - Hobbs