

NW4 - 170
5/27/55

STANOLIND OIL AND GAS COMPANY

Box 487, Farmington, New Mexico

1955 APR 20 AM 8:00

April 11, 1955

File: F-2091-986.51

Subject: Application for Non-Standard
Gas Proration Unit
Fulcher Kutz-Pictured Cliffs Field

Mr. W. B. Macey
New Mexico Oil Conservation Commission
P. O. Box 871
Santa Fe, New Mexico

Dear Sir:

566

In compliance with Order No. R-~~565~~, Rule 6B, Revised, application is hereby made for the approval of the formation of a non-standard gas proration unit, A. R. Hubbell "A" No. 1, 1650' from West and 1850' from South lines of Section 30, T-28-N, R-10-W, San Juan County, New Mexico.

Legal description of the acreage involved is as follows: Lots 3 and 4, E/2 of SW 1/4, Section 30, T-28-N, R-10-W. The entire quarter section consisting of 164.75 acres is under lease to Stanolind Oil and Gas Company.

Attached is a plat showing acreage to be dedicated, well location, and offset ownership. Also attached is a mailing list of all operators notified by registered mail of our intentions to form a non-standard unit in accordance with applicable rules.

I hereby certify that the above and the attached are true and correct to the best of my knowledge, and that they comply with the rules and regulations of the Oil Conservation Commission of New Mexico.

Yours very truly,



L. O. Speer, Jr.
Field Superintendent

CCF:re

Attach.



MAILING LIST OF OPERATORS NOTIFIED BY REGISTERED MAIL OF OUR
INTENTION TO FORM A NON-STANDARD UNIT IN COMPLIANCE WITH
NEW MEXICO OIL CONSERVATION COMMISSION RULES

A. R. Hubbell "A" No. 1:

Angel Peak Oil Company
Burt Building
Dallas, Texas

Aztec Oil and Gas Company
920 Mercantile Sec. Building
Dallas, Texas

Attention: Mr. Van Thompson

Potash Company of America
Carlsbad, New Mexico

El Paso Natural Gas Company
P. O. Box 997
Farmington, New Mexico

Attention: Mr. Truitt Hollis

Denman-Knauff
P. O. Box 1826
Wichita Falls, Texas

R-11-W

R-10-W

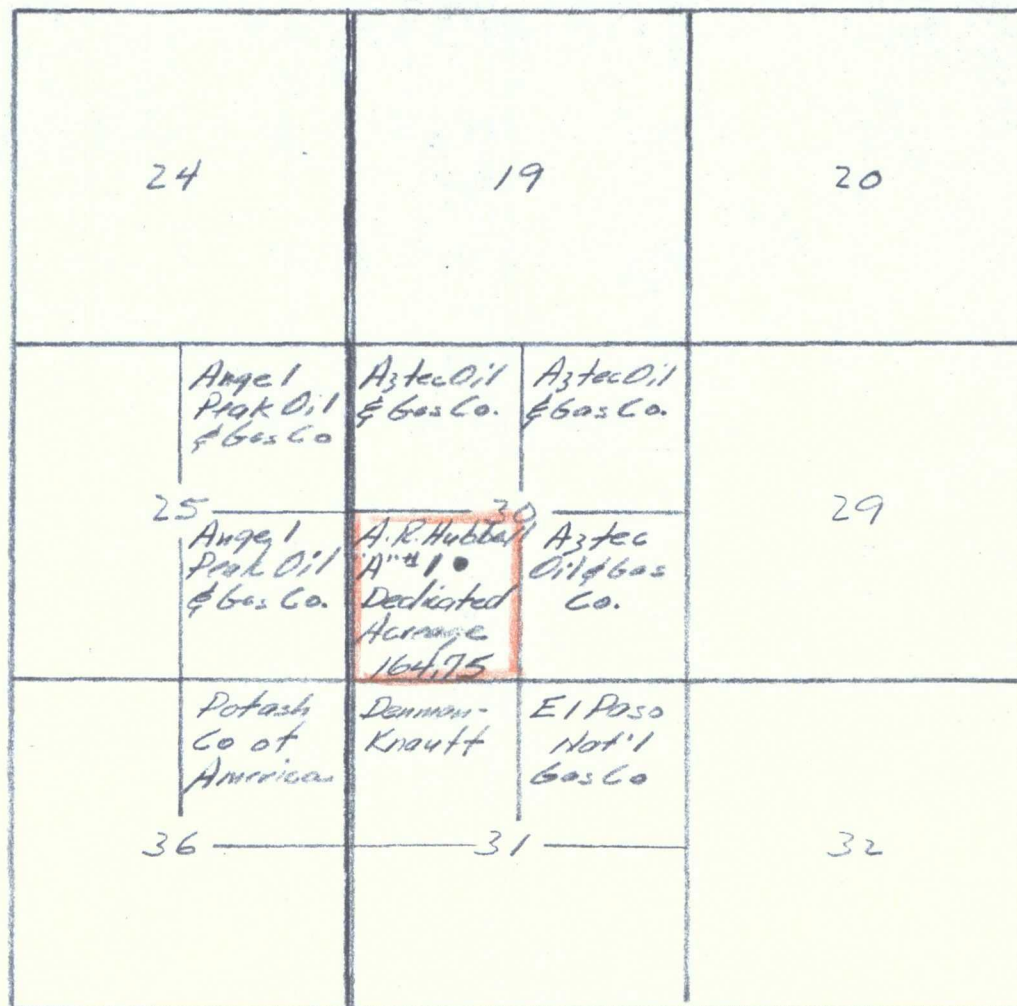

T-28-N

Plat for Application for Unorthodox Unit
A. R. Hubbell "A" No. 1, SW 1/4 Sec. 30, T-28-N, R-10-W
Fulcher Kutz-Pictured Cliffs Field

Scale: 1" = 3,000'