

CHESAPEAKE / OLD INDIAN DRAW Unit FEO 3.01.11

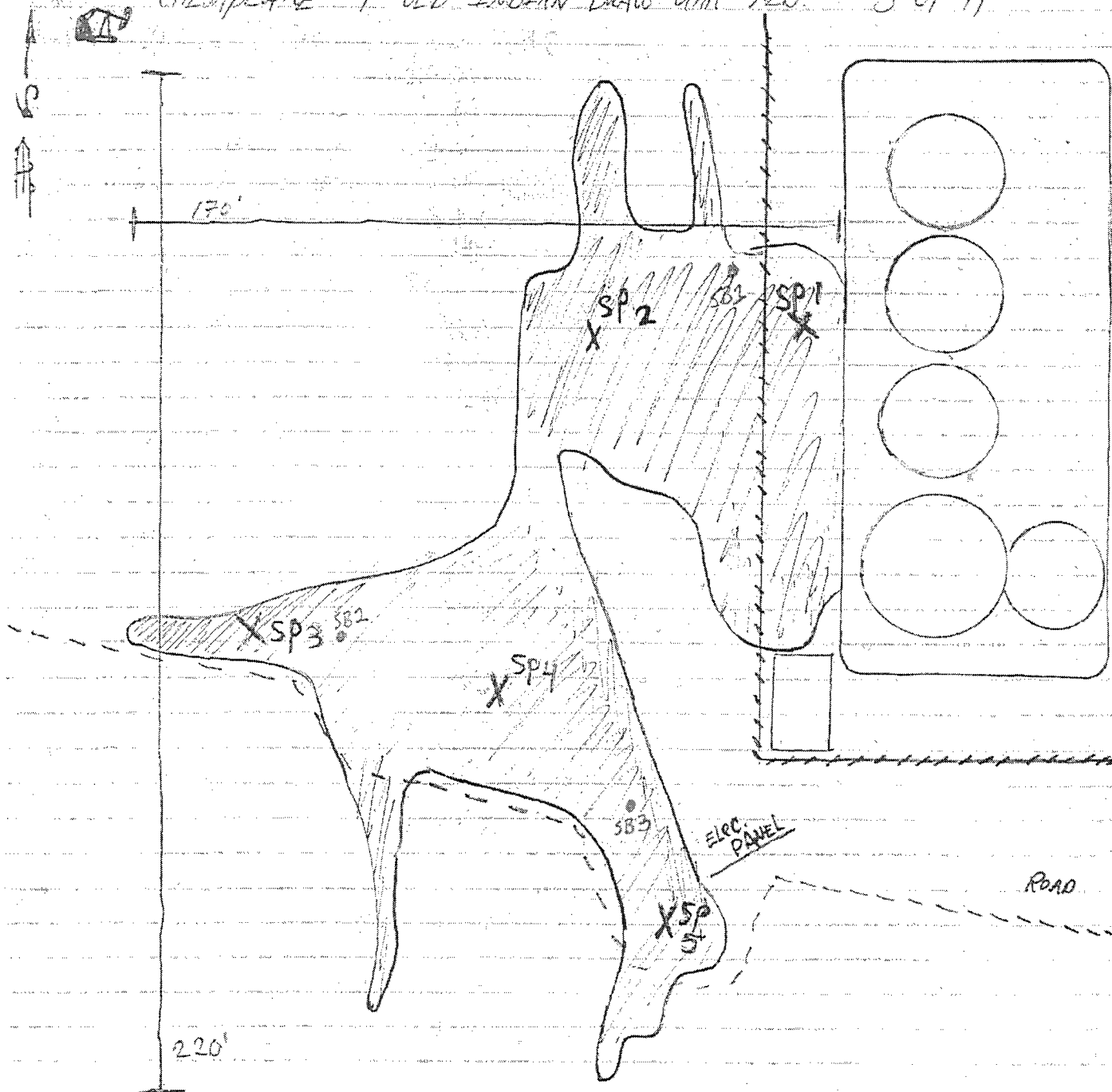

CL-			
Sp 1 @ Surface	OVER 10,000	Sp 2 @ Surface	OVER 10,000
C 4"	OVER 10,000	C 6"	
C 1'	OVER 10,000	C 1'	2200
C 2'	9600	C 2'	3800
C 3'	9600	* Too hard for BH.	
C 4'	6000		
C 5'	7600		
C 6'	7600		
* Too hard for BH			



PHONE (575) 393-2326 • 101 E. MARLAND • HOBBS, NM 88240

March 21, 2011

Cliff Brunson

BBC International, Inc.

P.O. Box 805

Hobbs, NM 88241

RE: OLD INDIAN DRAW UNIT FED.

Enclosed are the results of analyses for samples received by the laboratory on 03/15/11 15:00.

Cardinal Laboratories is accredited through Texas NELAP for:

Method SW-846 8021	Benzene, Toluene, Ethyl Benzene, and Total Xylenes
Method SW-846 8260	Benzene, Toluene, Ethyl Benzene, and Total Xylenes
Method TX 1005	Total Petroleum Hydrocarbons

Certificate number T104704398-08-TX. Accreditation applies to solid and chemical materials and non-potable water matrices.

Cardinal Laboratories is accredited through the State of Colorado Department of Public Health and Environment for:

Method EPA 552.2	Haloacetic Acids (HAA-5)
Method EPA 524.2	Total Trihalomethanes (TTHM)
Method EPA 524.4	Regulated VOCs (V2, V3)

Accreditation applies to public drinking water matrices.

This report meets NELAP requirements and is made up of a cover page, analytical results, and a copy of the original chain-of-custody. If you have any questions concerning this report, please feel free to contact me.

Sincerely,

A handwritten signature in black ink that reads "Hope S. Moreno". The signature is written in a cursive, flowing style.

Hope Moreno

Inorganic Technical Director

Analytical Results For:

BBC International, Inc.
Cliff Brunson
P.O. Box 805
Hobbs NM, 88241
Fax To: (505) 397-0397

Received:	03/15/2011	Sampling Date:	03/10/2011
Reported:	03/21/2011	Sampling Type:	Soil
Project Name:	OLD INDIAN DRAW UNIT FED.	Sampling Condition:	Cool & Intact
Project Number:	NONE GIVEN	Sample Received By:	Jodi Henson
Project Location:	U.S. REFINERY RD.		

Sample ID: SB 1 @ 3' (H100502-01)

BTEX 8021B		mg/kg		Analyzed By: CMS					
Analyte	Result	Reporting Limit	Analyzed	Method Blank	BS	% Recovery	True Value QC	RPD	Qualifier
Benzene*	<0.050	0.050	03/18/2011	ND	1.97	98.6	2.00	6.01	
Toluene*	<0.050	0.050	03/18/2011	ND	2.05	103	2.00	4.73	
Ethylbenzene*	<0.050	0.050	03/18/2011	ND	2.12	106	2.00	4.69	
Total Xylenes*	<0.150	0.150	03/18/2011	ND	6.26	104	6.00	3.51	

Surrogate: 4-Bromofluorobenzene (PIL) 98.2 % 70-130

Chloride, SM4500Cl-B		mg/kg		Analyzed By: HM					
Analyte	Result	Reporting Limit	Analyzed	Method Blank	BS	% Recovery	True Value QC	RPD	Qualifier
Chloride	1390	16.0	03/17/2011	ND	400	100	400	0.00	

TPH 8015M		mg/kg		Analyzed By: CK/					
Analyte	Result	Reporting Limit	Analyzed	Method Blank	BS	% Recovery	True Value QC	RPD	Qualifier
GRO C6-C10	<10.0	10.0	03/16/2011	ND	197	98.4	200	1.44	
DRO >C10-C28	11.4	10.0	03/16/2011	ND	216	108	200	0.185	

Surrogate: 1-Chlorooctane 112 % 70-130

Surrogate: 1-Chlorooctadecane 113 % 70-130

Sample ID: SB 1 @ 5' (H100502-02)

Chloride, SM4500Cl-B		mg/kg		Analyzed By: HM					
Analyte	Result	Reporting Limit	Analyzed	Method Blank	BS	% Recovery	True Value QC	RPD	Qualifier
Chloride	1760	16.0	03/17/2011	ND	400	100	400	0.00	

Cardinal Laboratories

* = Accredited Analyte

PLEASE NOTE: Liability and Damages. Cardinal's liability and client's exclusive remedy for any claim arising, whether based in contract or tort, shall be limited to the amount paid by client for analyses. All claims, including those for negligence and any other cause whatsoever shall be deemed waived unless made in writing and received by Cardinal within thirty (30) days after completion of the applicable service. In no event shall Cardinal be liable for incidental or consequential damages, including, without limitation, business interruptions, loss of use, or loss of profits incurred by client, its subsidiaries, affiliates or successors arising out of or related to the performance of the services hereunder by Cardinal, regardless of whether such claim is based upon any of the above stated reasons or otherwise. Results relate only to the samples identified above. This report shall not be reproduced except in full with written approval of Cardinal Laboratories.

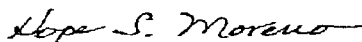

Hope Moreno, Inorganic Technical Director



PHONE (575) 393-2326 • 101 E. MARLAND • HOBBS, NM 88240

Analytical Results For:

BBC International, Inc.
Cliff Brunson
P.O. Box 805
Hobbs NM, 88241
Fax To: (505) 397-0397

Received:	03/15/2011	Sampling Date:	03/10/2011
Reported:	03/21/2011	Sampling Type:	Soil
Project Name:	OLD INDIAN DRAW UNIT FED.	Sampling Condition:	Cool & Intact
Project Number:	NONE GIVEN	Sample Received By:	Jodi Henson
Project Location:	U.S. REFINERY RD.		

Sample ID: SB 1 @ 10' (H100502-03)

Chloride, SM4500CI-B		mg/kg		Analyzed By: HM					
Analyte	Result	Reporting Limit	Analyzed	Method Blank	BS	% Recovery	True Value QC	RPD	Qualifier
Chloride	848	16.0	03/17/2011	ND	400	100	400	0.00	

Sample ID: SB 1 @ 15' (H100502-04)

Chloride, SM4500CI-B		mg/kg		Analyzed By: HM					
Analyte	Result	Reporting Limit	Analyzed	Method Blank	BS	% Recovery	True Value QC	RPD	Qualifier
Chloride	960	16.0	03/17/2011	ND	400	100	400	0.00	

Sample ID: SB 1 @ 20' (H100502-05)

Chloride, SM4500CI-B		mg/kg		Analyzed By: HM					
Analyte	Result	Reporting Limit	Analyzed	Method Blank	BS	% Recovery	True Value QC	RPD	Qualifier
Chloride	608	16.0	03/17/2011	ND	400	100	400	0.00	

Sample ID: SB 1 @ 25' (H100502-06)

Chloride, SM4500CI-B		mg/kg		Analyzed By: HM					
Analyte	Result	Reporting Limit	Analyzed	Method Blank	BS	% Recovery	True Value QC	RPD	Qualifier
Chloride	1730	16.0	03/17/2011	ND	400	100	400	0.00	

Sample ID: SB 1 @ 30' (H100502-07)

Chloride, SM4500CI-B		mg/kg		Analyzed By: HM					
Analyte	Result	Reporting Limit	Analyzed	Method Blank	BS	% Recovery	True Value QC	RPD	Qualifier
Chloride	190	16.0	03/17/2011	ND	400	100	400	0.00	

Cardinal Laboratories

*=Accredited Analyte

PLEASE NOTE: Liability and Damages. Cardinal's liability and client's exclusive remedy for any claim arising, whether issued in contract or tort, shall be limited to the amount paid by client for analyses. All claims, including those for negligence and any other cause whatsoever shall be deemed waived unless made in writing and received by Cardinal within thirty (30) days after completion of the applicable service. In no event shall Cardinal be liable for incidental or consequential damages, including, without limitation, business interruptions, loss of use, or loss of profits incurred by client, its subsidiaries, affiliates or successors arising out of or related to the performance of the services hereunder by Cardinal, regardless of whether such claim is based upon any of the above stated reasons or otherwise. Results relate only to the samples identified above. This report shall not be reproduced except in full with written approval of Cardinal Laboratories.

Hope S. Moreno

Hope Moreno, Inorganic Technical Director

Analytical Results For:

BBC International, Inc.
Cliff Brunson
P.O. Box 805
Hobbs NM, 88241
Fax To: (505) 397-0397

Received:	03/15/2011	Sampling Date:	03/10/2011
Reported:	03/21/2011	Sampling Type:	Soil
Project Name:	OLD INDIAN DRAW UNIT FED.	Sampling Condition:	Cool & Intact
Project Number:	NONE GIVEN	Sample Received By:	Jodi Henson
Project Location:	U.S. REFINERY RD.		

Sample ID: SB 1 @ 35' (H100502-08)

Chloride, SM4500Cl-B			mg/kg		Analyzed By: HM				
Analyte	Result	Reporting Limit	Analyzed	Method Blank	BS	% Recovery	True Value QC	RPD	Qualifier
Chloride	48.0	16.0	03/17/2011	ND	400	100	400	0.00	

Sample ID: SB 2 @ 3' (H100502-09)

BTEX 8021B			mg/kg		Analyzed By: CMS				
Analyte	Result	Reporting Limit	Analyzed	Method Blank	BS	% Recovery	True Value QC	RPD	Qualifier
Benzene*	<0.050	0.050	03/18/2011	ND	1.97	98.6	2.00	6.01	
Toluene*	<0.050	0.050	03/18/2011	ND	2.05	103	2.00	4.73	
Ethylbenzene*	<0.050	0.050	03/18/2011	ND	2.12	106	2.00	4.69	
Total Xylenes*	<0.150	0.150	03/18/2011	ND	6.26	104	6.00	3.51	

Surrogate: 4-Bromofluorobenzene (PIL) 98.2 % 70-130

Chloride, SM4500Cl-B			mg/kg		Analyzed By: HM				
Analyte	Result	Reporting Limit	Analyzed	Method Blank	BS	% Recovery	True Value QC	RPD	Qualifier
Chloride	640	16.0	03/17/2011	ND	400	100	400	0.00	

TPH 8015M			mg/kg		Analyzed By: CK/				
Analyte	Result	Reporting Limit	Analyzed	Method Blank	BS	% Recovery	True Value QC	RPD	Qualifier
GRO C6-C10	<10.0	10.0	03/16/2011	ND	197	98.4	200	1.44	
DRO >C10-C28	<10.0	10.0	03/16/2011	ND	216	108	200	0.185	

Surrogate: 1-Chlorooctane 111 % 70-130

Surrogate: 1-Chlorooctadecane 110 % 70-130

Cardinal Laboratories

*=Accredited Analyte

PLEASE NOTE: Liability and Damages. Cardinal's liability and client's exclusive remedy for any claim arising, whether based in contract or tort, shall be limited to the amount paid by client for analyses. All claims, including those for negligence and any other cause whatsoever shall be deemed waived unless made in writing and received by Cardinal within thirty (30) days after completion of the applicable service. In no event shall Cardinal be liable for incidental or consequential damages, including, without limitation, business interruptions, loss of use, or loss of profits incurred by client, its subsidiaries, affiliates or successors arising out of or related to the performance of the services hereunder by Cardinal, regardless of whether such claim is based upon any of the above stated reasons or otherwise. Results relate only to the samples identified above. This report shall not be reproduced except in full with written approval of Cardinal Laboratories.

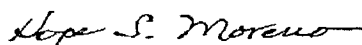

Hope Moreno, Inorganic Technical Director

Analytical Results For:

BBC International, Inc.
Cliff Brunson
P.O. Box 805
Hobbs NM, 88241
Fax To: (505) 397-0397

Received:	03/15/2011	Sampling Date:	03/10/2011
Reported:	03/21/2011	Sampling Type:	Soil
Project Name:	OLD INDIAN DRAW UNIT FED.	Sampling Condition:	Cool & Intact
Project Number:	NONE GIVEN	Sample Received By:	Jodi Henson
Project Location:	U.S. REFINERY RD.		

Sample ID: SB 2 @ 5' (H100502-10)

Chloride, SM4500CI-B		mg/kg		Analyzed By: HM					
Analyte	Result	Reporting Limit	Analyzed	Method Blank	BS	% Recovery	True Value QC	RPD	Qualifier
Chloride	464	16.0	03/17/2011	ND	400	100	400	0.00	

Sample ID: SB 2 @ 10' (H100502-11)

Chloride, SM4500Cl-B		mg/kg		Analyzed By: HM					
Analyte	Result	Reporting Limit	Analyzed	Method Blank	BS	% Recovery	True Value QC	RPD	Qualifier
Chloride	544	16.0	03/17/2011	ND	400	100	400	0.00	

Sample ID: SB 2 @ 15' (H100502-12)

Chloride, SM4500Cl-B		mg/kg		Analyzed By: HM					
Analyte	Result	Reporting Limit	Analyzed	Method Blank	BS	% Recovery	True Value QC	RPD	Qualifier
Chloride	336	16.0	03/17/2011	ND	400	100	400	0.00	

Sample ID: SB 2 @ 20' (H100502-13)

Chloride, SM4500Cl-B		mg/kg		Analyzed By: HM					
Analyte	Result	Reporting Limit	Analyzed	Method Blank	BS	% Recovery	True Value QC	RPD	Qualifier
Chloride	416	16.0	03/17/2011	ND	400	100	400	0.00	

Sample ID: SB 2 @ 25' (H100502-14)

Chloride, SM4500Cl-B		mg/kg		Analyzed By: HM					
Analyte	Result	Reporting Limit	Analyzed	Method Blank	BS	% Recovery	True Value QC	RPD	Qualifier
Chloride	80.0	16.0	03/17/2011	ND	400	100	400	0.00	

Cardinal Laboratories

*=Accredited Analyte

PLEASE NOTE: Liability and Damages. Cardinal's liability and client's exclusive remedy for any claim arising, whether based in contract or tort, shall be limited to the amount paid by client for analyses. All claims, including those for negligence and any other cause whatsoever shall be deemed waived unless made in writing and received by Cardinal within thirty (30) days after completion of the applicable service. In no event shall Cardinal be liable for incidental or consequential damages, including, without limitation, business interruptions, loss of use, or loss of profits incurred by client, its subsidiaries, affiliates or successors arising out of or related to the performance of the services hereunder by Cardinal, regardless of whether such claim is based upon any of the above stated reasons or otherwise. Results relate only to the samples identified above. This report shall not be reproduced except in full with written approval of Cardinal Laboratories.



Hope Moreno, Inorganic Technical Director

Analytical Results For:

BBC International, Inc.
Cliff Brunson
P.O. Box 805
Hobbs NM, 88241
Fax To: (505) 397-0397

Received:	03/15/2011	Sampling Date:	03/10/2011
Reported:	03/21/2011	Sampling Type:	Soil
Project Name:	OLD INDIAN DRAW UNIT FED.	Sampling Condition:	Cool & Intact
Project Number:	NONE GIVEN	Sample Received By:	Jodi Henson
Project Location:	U.S. REFINERY RD.		

Sample ID: SB 2 @ 30' (H100502-15)

Chloride, SM4500Cl-B			mg/kg							Analyzed By: HM
Analyte	Result	Reporting Limit	Analyzed	Method Blank	BS	% Recovery	True Value QC	RPD	Qualifier	
Chloride	32.0	16.0	03/17/2011	ND	400	100	400	0.00		

Sample ID: SB 3 @ 3' (H100502-16)

BTX 8021B			mg/kg							Analyzed By: CMS
Analyte	Result	Reporting Limit	Analyzed	Method Blank	BS	% Recovery	True Value QC	RPD	Qualifier	
Benzene*	<0.050	0.050	03/18/2011	ND	1.97	98.6	2.00	6.01		
Toluene*	<0.050	0.050	03/18/2011	ND	2.05	103	2.00	4.73		
Ethylbenzene*	<0.050	0.050	03/18/2011	ND	2.12	106	2.00	4.69		
Total Xylenes*	<0.150	0.150	03/18/2011	ND	6.26	104	6.00	3.51		

Surrogate: 4-Bromofluorobenzene (PII) 108 % 70-130

Chloride, SM4500Cl-B			mg/kg							Analyzed By: HM
Analyte	Result	Reporting Limit	Analyzed	Method Blank	BS	% Recovery	True Value QC	RPD	Qualifier	
Chloride	80.0	16.0	03/17/2011	ND	400	100	400	0.00		

TPH 8015M			mg/kg							Analyzed By: CK/
Analyte	Result	Reporting Limit	Analyzed	Method Blank	BS	% Recovery	True Value QC	RPD	Qualifier	
GRO C6-C10	<10.0	10.0	03/16/2011	ND	197	98.4	200	1.44		
DRO >C10-C28	<10.0	10.0	03/16/2011	ND	216	108	200	0.185		

Surrogate: 1-Chlorooctane 116 % 70-130

Surrogate: 1-Chlorooctadecane 113 % 70-130

Cardinal Laboratories

*=Accredited Analyte

PLEASE NOTE: Liability and Damages. Cardinal's liability and client's exclusive remedy for any claim arising, whether based in contract or tort, shall be limited to the amount paid by client for analyses. All claims, including those for negligence and any other cause whatsoever shall be deemed waived unless made in writing and received by Cardinal within thirty (30) days after completion of the applicable service. In no event shall Cardinal be liable for incidental or consequential damages, including, without limitation, business interruptions, loss of use, or loss of profits incurred by client, its subsidiaries, affiliates or successors arising out of or related to the performance of the services hereunder by Cardinal, regardless of whether such claim is based upon any of the above stated reasons or otherwise. Results relate only to the samples identified above. This report shall not be reproduced except in full with written approval of Cardinal Laboratories.

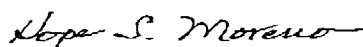

Hope Moreno, Inorganic Technical Director



PHONE (575) 393-2326 • 101 E. MARLAND • HOBBS, NM 88240

Analytical Results For:

BBC International, Inc.
Cliff Brunson
P.O. Box 805
Hobbs NM, 88241
Fax To: (505) 397-0397

Received:	03/15/2011	Sampling Date:	03/10/2011
Reported:	03/21/2011	Sampling Type:	Soil
Project Name:	OLD INDIAN DRAW UNIT FED.	Sampling Condition:	Cool & Intact
Project Number:	NONE GIVEN	Sample Received By:	Jodi Henson
Project Location:	U.S. REFINERY RD.		

Sample ID: SB 3 @ 5' (H100502-17)

Chloride, SM4500Cl-B		mg/kg		Analyzed By: HM					
Analyte	Result	Reporting Limit	Analyzed	Method Blank	BS	% Recovery	True Value QC	RPD	Qualifier
Chloride	304	16.0	03/17/2011	ND	400	100	400	0.00	

Cardinal Laboratories

*=Accredited Analyte

PLEASE NOTE: Liability and Damages. Cardinal's liability and client's exclusive remedy for any claim arising, whether based in contract or tort, shall be limited to the amount paid by client for analyses. All claims, including those for negligence and any other cause whatsoever shall be deemed waived unless made in writing and received by Cardinal within thirty (30) days after completion of the applicable service. In no event shall Cardinal be liable for incidental or consequential damages, including, without limitation, business interruptions, loss of use, or loss of profits incurred by client, its subsidiaries, affiliates or successors arising out of or related to the performance of the services hereunder by Cardinal, regardless of whether such claim is based upon any of the above stated reasons or otherwise. Results relate only to the samples identified above. This report shall not be reproduced except in full with written approval of Cardinal Laboratories.

Hope S. Moreno

Hope Moreno, Inorganic Technical Director

Notes and Definitions

ND	Analyte NOT DETECTED at or above the reporting limit
RPD	Relative Percent Difference
**	Samples not received at proper temperature of 6°C or below.
***	Insufficient time to reach temperature.
-	Chloride by SM4500Cl-B does not require samples be received at or below 6°C Samples reported on an as received basis (wet) unless otherwise noted on report

Cardinal Laboratories

* = Accredited Analyte

PLEASE NOTE: Liability and Damages. Cardinal's liability and client's exclusive remedy for any claim arising, whether based in contract or tort, shall be limited to the amount paid by client for analyses. All claims, including those for negligence and any other cause whatsoever shall be deemed waived unless made in writing and received by Cardinal within thirty (30) days after completion of the applicable service. In no event shall Cardinal be liable for incidental or consequential damages, including, without limitation, business interruptions, loss of use, or loss of profits incurred by client, its subsidiaries, affiliates or successors arising out of or related to the performance of the services hereunder by Cardinal, regardless of whether such claim is based upon any of the above stated reasons or otherwise. Results relate only to the samples identified above. This report shall not be reproduced except in full with written approval of Cardinal Laboratories.

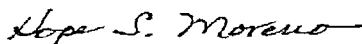

Hope Moreno, Inorganic Technical Director

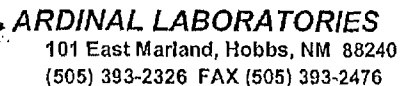

ANALYSIS REQUEST	
ME	
PLING	
TIME	
734	TPH 8015M
839	BTEX
845	CHLORIDE
853	
857	
308	
315	
323	
400	
408	

PLEASE NOTE: Liability and Damages. Cardinal's liability and claims coverage remedy for any claim arising whether stated in contract or tort, shall be limited to the amount paid by the claim for the purchase of the service. Cardinal's liability and claims coverage shall not be extended to cover any claim arising out of the performance of services hereunder by Cardinal regardless of whether such claim is based upon any of the above stated reasons or otherwise. All claims, including those for negligence and any other cause whatsoever that be deemed waived whether made in writing and received by Cardinal within 30 days after completion of the applicable service, in no event shall Cardinal be liable for incidental or consequential damages, including without limitation, business interruptions, loss of use, or loss of profits incurred by client, its subsidiaries, affiliates or successors arising out of or related to the performance of services hereunder by Cardinal regardless of whether such claim is based upon any of the above stated reasons or otherwise.

Relinquished By:		Date:	Received By:	Phone Result:	<input type="checkbox"/> Yes <input type="checkbox"/> No	Add'l Phone #:
<i>[Signature]</i>		Time:	<i>Roger Hernandez</i>	Fax Result:	<input type="checkbox"/> Yes <input type="checkbox"/> No	Add'l Fax #:
Relinquished By:		Date:	Received By:	REMARKS:		
<i>Roger Hernandez</i>		Time:	<i>Joel Hanson</i>			
Delivered By: (Circle One)		Sample Condition		CHECKED BY:		
Sampler - UPS - Bus - Other:		Cool Intact		(Initials)		
5.52		<input type="checkbox"/> Yes <input checked="" type="checkbox"/> No <input type="checkbox"/> Yes <input checked="" type="checkbox"/> No		<i>[Signature]</i>		

† Cardinal cannot accept verbal changes. Please fax written changes to 505-393-2476

#26

CHAIN-OF-CUSTODY AND ANALYSIS REQUEST

Company Name: BBC International, Inc.						BILL TO								ANALYSIS REQUEST									
Project Manager: Cliff Brunson						P.O. #:																	
Address: P.O. Box 805						Company:																	
City: Hobbs State: NM Zip: 88241						Attn:																	
Phone #: 575-397-6388 Fax #: 575-397-0397						Address: SAME																	
Project #: Project Owner: CHESAPEAKE						City:																	
Project Name: OLD INDIAN DRAW FED						State: Zip:																	
Project Location: ILS REMEDIATION CO.						Phone #:																	
Sampler Name: JEFF CAMELAS						Fax #:																	
FOR LAB USE ONLY				MATRIX						PRESERV.		SAMPLING											
Lab I.D.	Sample I.D.	(GRAB OR COMPO.) # CONTAINERS	GROUNDWATER WASTEWATER SOIL OIL SLUDGE OTHER:	ACID/BASE: ICE / COOL OTHER:	DATE	TIME																	
H0050211	S.B 2 @ 10'	G 1	✓	✓	3-10-11	411																	
12	S.B 2 @ 15'	G 1	✓	✓	3-10-11	415																	
13	S.B 2 @ 20'	G 1	✓	✓	3-10-11	419																	
14	S.B 2 @ 25'	G 1	✓	✓	3-10-11	425																	
15	S.B 2 @ 30'	F 1	✓	✓	3-10-11	430																	
16	S.B 3 @ 3'	G 1	✓	✓	3-10-11	444																	
17	5'	G 1	✓	✓	3-10-11	449																	

PLEASE NOTE: Liability and Damages: Cardinal's liability and claim is exclusive remedy for any claim arising while these persons in contact or not, shall be limited to the amount paid by the client for the applicable service. All claims including those for negligence and any other cause whatsoever shall be deemed waived unless made in writing and received by Cardinal within 30 days after completion of the applicable service. In no event shall Cardinal be liable for incidental or consequential damages, including without limitation, business interruptions, loss of use, or loss of profits incurred by client, its subsidiaries, affiliates or successors arising out of or related to the performance of services hereunder by Cardinal. Regardless of whether such claim is based upon any of the above stated persons or otherwise.

Relinquished By: <i>[Signature]</i>		Date: <i>3-15-11</i>	Received By: <i>Robert Hernandez</i>	Phone Result: <input type="checkbox"/> Yes <input type="checkbox"/> No	Add'l Phone #:
Time: <i>8:00</i>				Fax Result: <input type="checkbox"/> Yes <input type="checkbox"/> No	Add'l Fax #:
Relinquished By: <i>Robert Hernandez</i>		Date: <i>3-15-11</i>	Received By: <i>Wendi Henderson</i>	REMARKS:	
Time: <i>3:00</i>					
Delivered By: (Circle One)		Sample Condition	CHECKED BY:		
Sampler - UPS - Bus - Other:		Cool, Intact	(Initials)		
<i>5.50</i>		<input type="checkbox"/> Yes <input checked="" type="checkbox"/> No	<i>WHT</i>		

† Cardinal cannot accept verbal changes. Please fax written changes to 505-393-2476