

CTB 7-19-95

# TAMARACK PETROLEUM COMPANY, INC.



500 WEST TEXAS, SUITE 148E  
MIDLAND, TEXAS 79701

TELEPHONE: 915/683-5474  
FACSIMILE: 915/683-7306

June 20, 1995

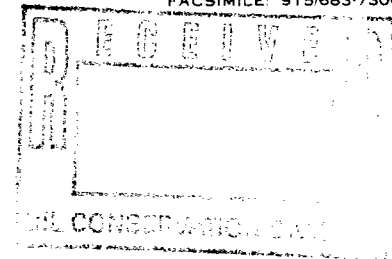

Oil Conservation Division  
P. O. Box 2088  
Santa Fe, New Mexico

Attn: Division Director

This letter is to serve as application for exception to Rule 309-A to permit the surface commingling of all production from the same common source of supply in the following leases to a common tank battery:

## SAUNDERS PERMO UPPER PENN FIELD - LEA COUNTY, NEW MEXICO

010826	Lion State	01-J-09-14S-33E
010827	Lion State -A-	02-P-09-14S-33E
010833	Saunders State	01-N-09-14S-33E
010833	Saunders State	02-E-16-14S-33E
010833	Saunders State	03-O-09-14S-33E

All parties owning an interest in the above leases have been notified in writing of this application to commingle production.

We will take a 24 hour test monthly to accurately determine production from each well and make allocation for reporting monthly production and distribution of sales revenue.

Attached are copies of lease ownerships, well plats, 12 month schedule of production (showing gravity and values) and a diagram of the battery facility. The location of the common tank battery serving these wells will be on the Lion State Lease. If additional information is needed to grant permission to surface commingle, please let me know.

Sincerely,

T. Wayne Green  
Production Agent

cc: Oil Conservation Division  
District Director - Hobbs

# TAMARACK PETROLEUM COMPANY, INC.



500 WEST TEXAS, SUITE 1485  
MIDLAND, TEXAS 79701

TELEPHONE: 915/683-5474  
FACSIMILE: 915/683-7306

June 20, 1995

"Interest Owners"

Re: Surface Commingling  
Lion State, Lion State -A- & Saunders State

Dear Sir or Madam:

Tamarack Petroleum Company, Inc. is seeking permission from the New Mexico Oil Conservation Division to surface commingle production from the above referenced leases.

Tamarack proposes to tie the Lion State No. 1 and Lion State -A- No. 2 into the Saunders State battery. The Lion State and Lion State -A- battery is in need of repair. If Tamarack receives permission from the NMOCD, five wells will be serviced by one battery instead of five wells being serviced by two batteries. Consolidation of batteries will allow the Lion State, Lion State -A- and Saunders State wells to produce economically and reduce operating costs, such that it will extend the life of these leases and increase ultimate recovery from these properties.

If you concur with surface commingling these leases into one central battery and the allocation of production and distribution of sales revenue by a 24 hour test taken monthly, please sign at the bottom and return to Tamarack Petroleum Co., Inc.

Sincerely,

A handwritten signature in cursive script, appearing to read "T. Wayne Green". It is written in black ink and is positioned above the typed name.

T. Wayne Green  
Production Agent

APPROVED:

Name: \_\_\_\_\_

By: \_\_\_\_\_

Date: \_\_\_\_\_

## COMMINGLE PRE-APPLICATION

STATE LAND OFFICE RULES 1.053-1.055 APPLY TO COMMINGLING OIL AND GAS PRODUCTION FROM NEW MEXICO STATE LANDS. PLEASE PROVIDE THE FOLLOWING INFORMATION SO THAT WE CAN DETERMINE WHETHER OR NOT A COMMINGLE APPLICATION PACKAGE SHOULD BE SUBMITTED.

1. BRIEFLY DESCRIBE WHAT YOU PROPOSE TO DO:

Consolidate the two batteries serving the following wells into one common tank battery using existing lines. Commingle Oil & Casinghead gas production from each well and make allocations by 24 hour tests taken monthly.

2. FILL IN THE FOLLOWING INFORMATION FOR EACH WELL.

WELL No.	LEGAL DESCRIPTION	LESSEE OF RECORD	N.M. LEASE NUMBER	FORMATION
1	N-09-14S-33E	Tamarack	E-7353-2	Permo Upper Penn
2	E-16-14S-33E	Tamarack	E-7353-2	Permo Upper Penn
3	O-09-14S-33E	Tamarack	E-7353-2	Permo Upper Penn
1	J-09-14S-33E	Tamarack	E-8334	Permo Upper Penn
2	P-09-14S-33E	Tamarack	E-7353	Permo Upper Penn

Name: T. Wayne Green T. Wayne Green

Company: Tamarack Petroleum Company, Inc.

Phone Number: 915/683-5474

IF YOU HAVE ANY QUESTION, PLEASE CONTACT THE OIL, GAS AND MINERALS DIVISION AT (505) 827-5744.

**DIVISION OF INTEREST - STATEMENT OF LEASE OWNERSHIP****SAUNDERS STATE LEASE E-7353-2**

OWNER NAME	DECIMAL INTEREST	
STATE OF NEW MEXICO P. O. Box 1148 Santa Fe, New Mexico 87504	0.1250000	RI
THE ROBERT B. TRANIER, 1973 TRUST c/o Glenora Co. 777 E. Wisconsin Ave. - Suite 2395 Milwaukee, Wisconsin 53202	0.0038021	ORI
THE ROBERT A UIHLEIN, JR. 1976 TRUST c/o Glenora Co. 777 E. Wisconsin Ave. - Suite 2395 Milwaukee, Wisconsin 53202	0.0025520	ORI
THEODORE S. GARY Marital Trust #02-57177 50 S. La Salle Street Chicago, Illinois 60675-0001	0.0031250	ORI
EST OF ARTHUR D. BRAGG c/o Tamarack Petroleum Co., Inc. 777 E. Wisconsin Ave. - Suite 1920 Milwaukee, Wisconsin 53202	0.0031250	ORI
TAMARACK PETROLEUM COMPANY, INC. 777 E. Wisconsin Ave. - Suite 1920 Milwaukee, Wisconsin 53202	0.8623959	WI
TOTAL	1.0000000	

**DIVISION OF INTEREST - STATEMENT OF LEASE OWNERSHIP**  
**LION STATE (E-8334) & LION STATE -A- (E-7353)**

<i>OWNER NAME</i>	<i>DECIMAL INTEREST</i>	
STATE OF NEW MEXICO P. O. Box 1148 Santa Fe, New Mexico 87504	0.1250000	RI
B. W. CHRONISTER 9722 Losa Dallas, Texas 75218	0.0083333	RI
J. L. EVERSON 1400 Country Club St. Midland, Texas 79701	0.0083333	RI
MARILYN NABER MORDEN EXEX EST. EST. A.D. MORDEN, JR. 5631 Tipperary Lincoln, Nebraska 68512	0.0083333	RI
JOHN C. RICKSEN, MARY B. RICKSEN SAMUEL B. BRECK & HELEN B. BRECK TRUSTEES 1999 Harrison St. - Suite 1700 Oakland, California 94612	0.0187500	RI
TAMARACK PETROLEUM COMPANY, INC. 777 E. Wisconsin Ave. - Suite 1920 Milwaukee, Wisconsin 53202	0.8312501	WI
<b>TOTAL</b>	<b>1.0000000</b>	

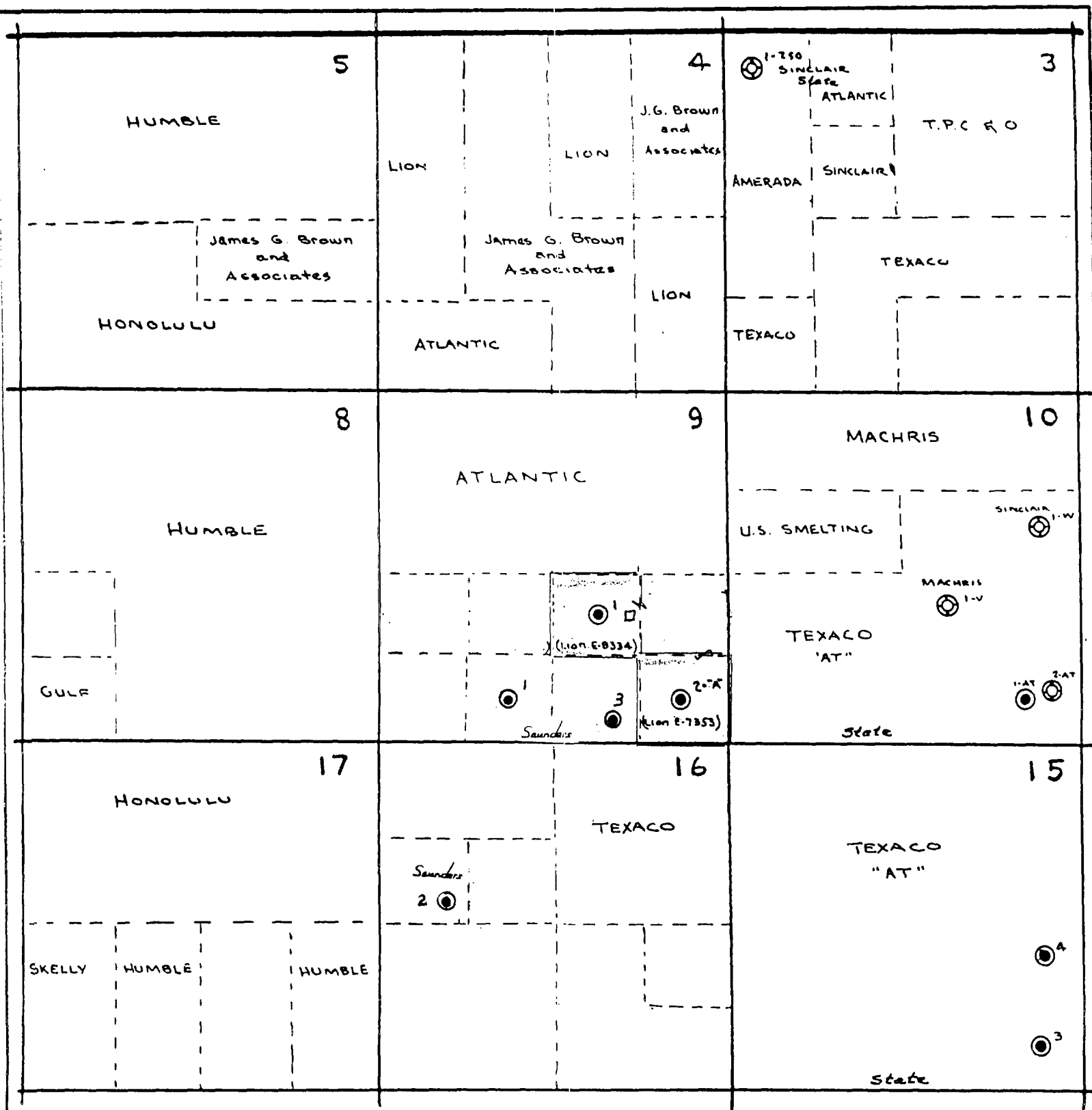

Lea County, New Mexico

T-14 S, R-33-E

Scale: 1 inch equals 2000'

NEW MEXICO OIL CONSERVATION COMMISSION  
WELL LOCATION AND ACREAGE DEDICATION PLAT

Form C-102  
Supersedes C-1  
Effective 1-1-6

All distances must be from the outer boundaries of the Section

Operator <b>Tamarack Petroleum Co.</b>		Lease <b>Saunders State</b>		Well No. <b>1</b>
Tract Letter <b>N</b>	Section <b>9</b>	Township <b>14 South</b>	Range <b>33 East</b>	County <b>Lea County</b>
Actual Footage Location of Well: <b>660</b> feet from the <b>South</b> line and <b>1980</b> feet from the <b>West</b> line				
Ground Level Elev. <b>4228.0</b>	Producing Formation <b>Permo Penn</b>	Pool <b>Saunders</b>	Dedicated Acreage: <b>40</b> Acres	

1. Outline the acreage dedicated to the subject well by colored pencil or hatchure marks on the plat below.
2. If more than one lease is dedicated to the well, outline each and identify the ownership thereof (both as to working interest and royalty).
3. If more than one lease of different ownership is dedicated to the well, have the interests of all owners been consolidated by communitization, unitization, force-pooling, etc?

☐ Yes ☐ No If answer is "yes," type of consolidation \_\_\_\_\_

If answer is "no," list the owners and tract descriptions which have actually been consolidated. (Use reverse side of this form if necessary.) \_\_\_\_\_

No allowable will be assigned to the well until all interests have been consolidated (by communitization, unitization, forced-pooling, or otherwise) or until a non-standard unit, eliminating such interests, has been approved by the Commission.

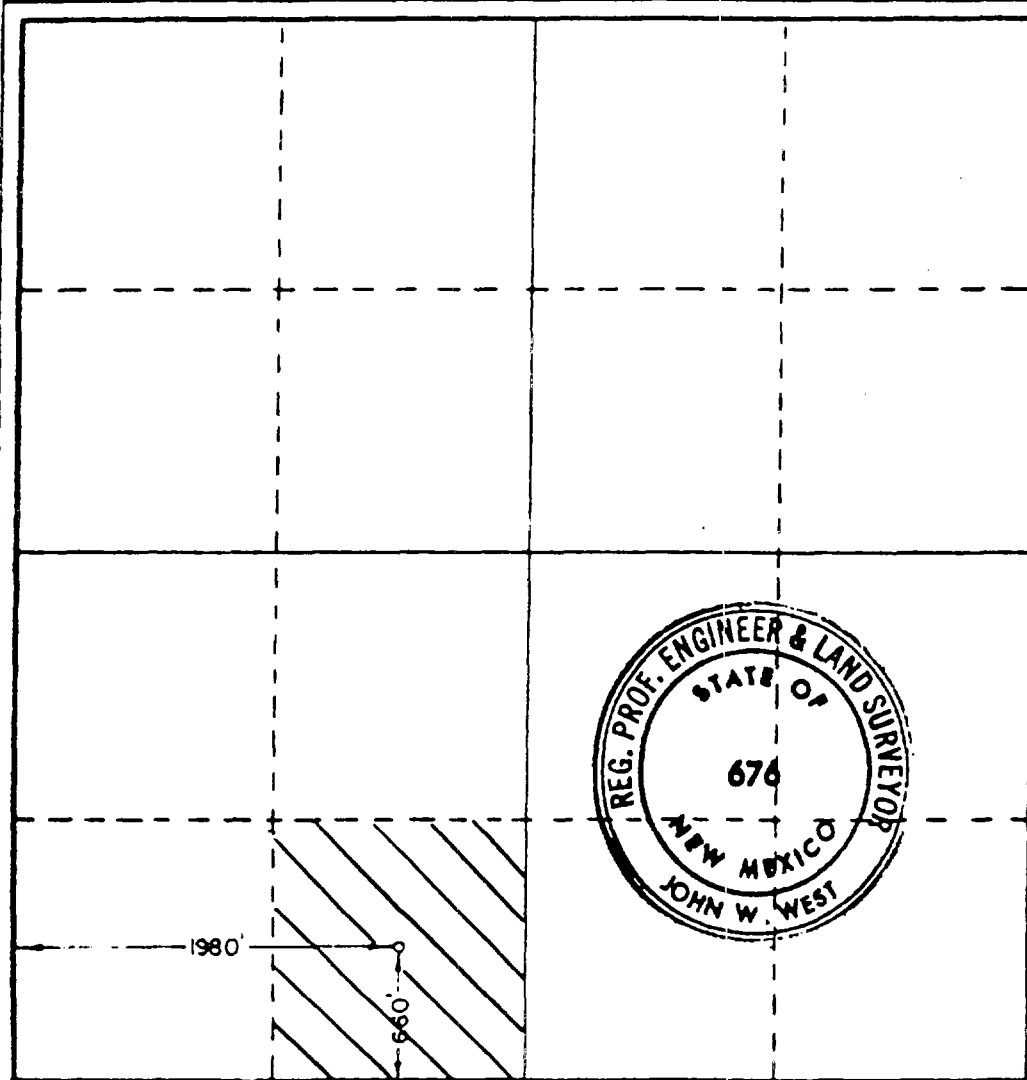

CERTIFICATION

I hereby certify that the information contained herein is true and complete to the best of my knowledge and belief.

Name  
**Randy A. McClay**  
Position  
**Engineer**  
Company  
**Tamarack Petroleum Co., Inc.**  
Date  
**04/26/83**

I hereby certify that the well location shown on this plat was plotted from field notes of actual surveys made by me or under my supervision, and that the same is true and correct to the best of my knowledge and belief.

Date Surveyed  
**April 22, 1983**  
Registered Professional Engineer and/or Land Surveyor

*John W. West*  
Certificate No. \_\_\_\_\_

MEXICO OIL CONSERVATION COMMISS  
WELL LOCATION AND ACREAGE DEDICATION PLAT

Form 7-73  
Supersedes C.  
1-1-75

Distance from the well to the outer boundaries of the Section

TAMARACK PETROLEUM CO., INC.		SAUNDERS ST.		2
E	16	14S	33E	LEA
990 feet from the WEST line and 2310 feet from the NORTH line				
4227.1	Permo Penn	Saunders	40	

1. Outline the acreage dedicated to the subject well by colored pencil or hachure marks on the plat below.
2. If more than one lease is dedicated to the well, outline each and identify the ownership thereof (both as to working interest and royalty).
3. If more than one lease of different ownership is dedicated to the well, have the interests of all owners been consolidated by communitization, unitization, force-pooling, etc?

☐ Yes ☐ No If answer is "yes," type of consolidation \_\_\_\_\_

If answer is "no," list the owners and tract descriptions which have actually been consolidated. (Use reverse side of this form if necessary.) \_\_\_\_\_

No allowable will be assigned to the well until all interests have been consolidated (by communitization, unitization, forced-pooling, or otherwise) or until a non-standard unit, eliminating such interests, has been approved by the Commission.

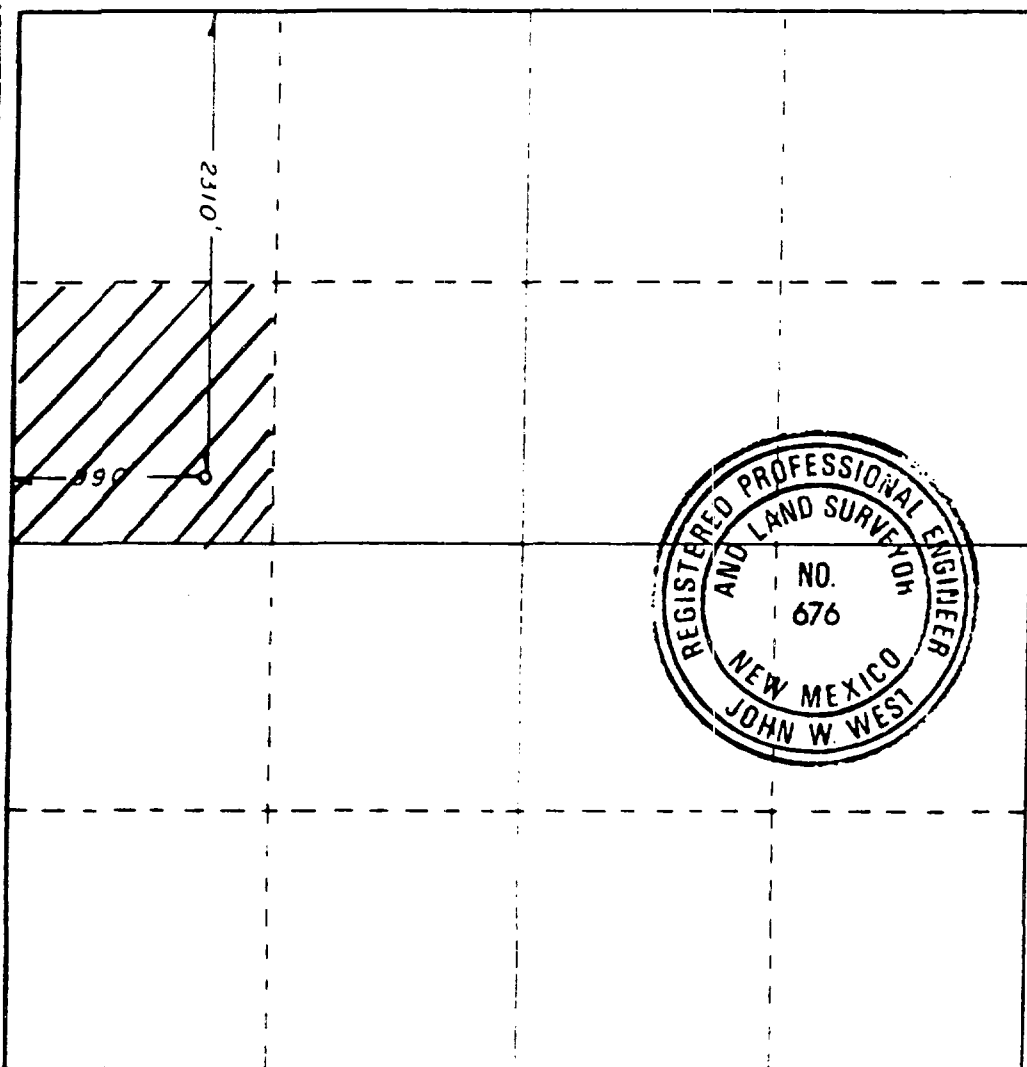

CERTIFICATION

I hereby certify that the information contained herein is true and complete to the best of my knowledge and belief.

Randy A. McClay

Engineer

Tamarack Petroleum Co., Inc.

2/20/84

I hereby certify that the well location shown on this plat was plotted from field notes of actual surveys made by me or under my supervision and that the same is true and correct to the best of my knowledge and belief.

2/16/84

John W. West

John W. West

Certificate No. JOHN W. WEST



## WE. LOCATION AND ACREAGE DEDICATION LAT

Supersedes C  
Effective 1-1-84

All distances must be from the outer boundaries of the Section

Operator <b>TAMARACK PETROLEUM CO., INC.</b>			Lease <b>SAUNDERS STATE</b>		Well No. <b>3</b>
Unit Letter <b>O</b>	Section <b>9</b>	Township <b>14 SOUTH</b>	Range <b>33 EAST</b>	County <b>L.F.A.</b>	
Actual Footage Location of Well: <b>330</b> feet from the <b>SOUTH</b> line and <b>1650</b> feet from the <b>EAST</b> line					
Ground Level Elev. <b>4221.0</b>	Producing Formation <b>(Permo-Penn)</b>		Pool <b>Saunders</b>		Dedicated Acreage: <b>40</b> Acres

1. Outline the acreage dedicated to the subject well by colored pencil or hachure marks on the plat below.
2. If more than one lease is dedicated to the well, outline each and identify the ownership thereof (both as to working interest and royalty).
3. If more than one lease of different ownership is dedicated to the well, have the interests of all owners been consolidated by communitization, unitization, force-pooling, etc?

☐ Yes ☐ No If answer is "yes," type of consolidation \_\_\_\_\_

If answer is "no," list the owners and tract descriptions which have actually been consolidated. (Use reverse side of this form if necessary.) \_\_\_\_\_

No allowable will be assigned to the well until all interests have been consolidated (by communitization, unitization, forced-pooling, or otherwise) or until a non-standard unit, eliminating such interests, has been approved by the Commission.

## CERTIFICATION

I hereby certify that the information contained herein is true and complete to the best of my knowledge and belief.

Name

**Randy A. McClay**

Position

**Engineer**

Company

**Tamarack Petroleum Co.**

Date

**February 28, 1984**

I hereby certify that the well location shown on this plat was plotted from the notes of actual surveys made by me or under my supervision, and that the same is true and correct to the best of my knowledge and belief.

Date Surveyed

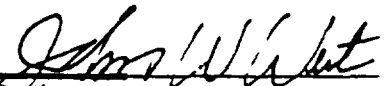
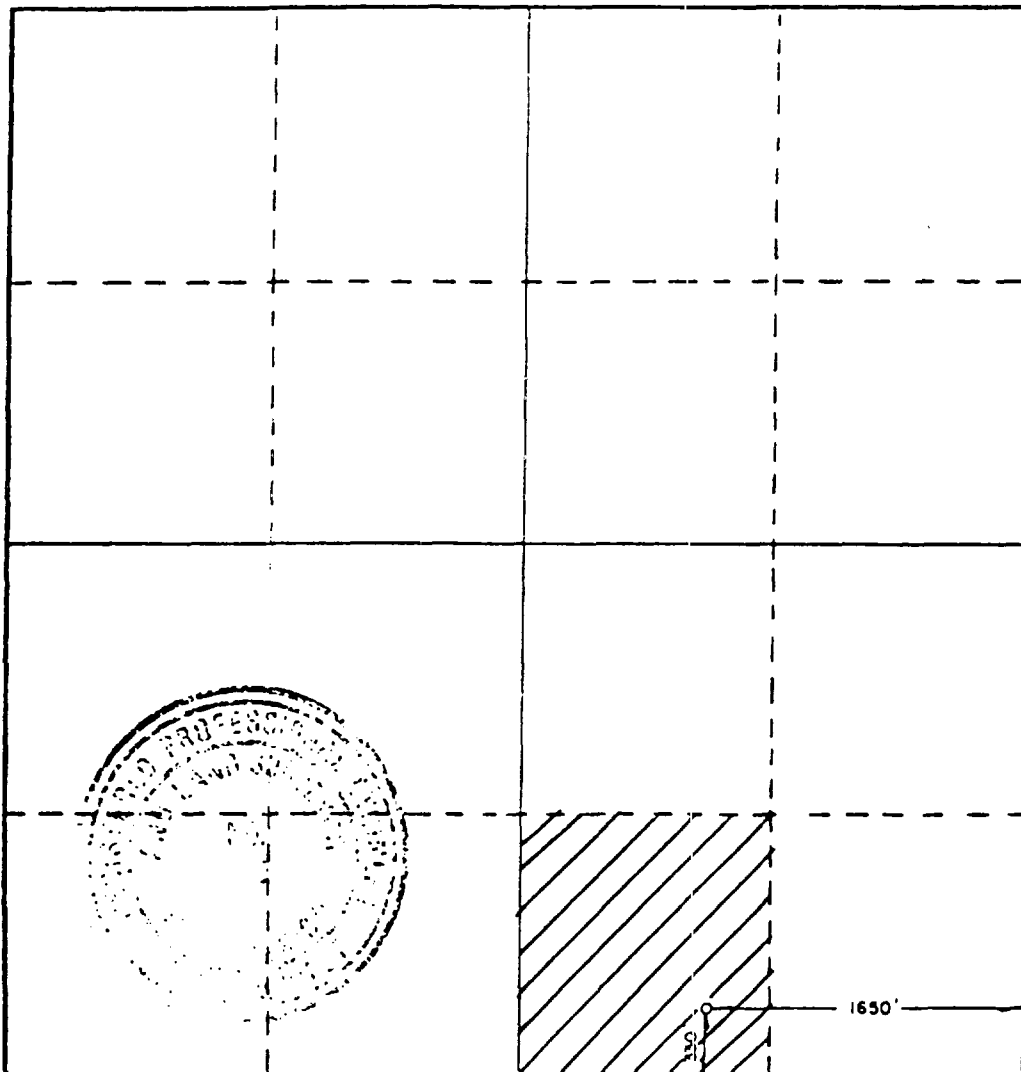
**FEBRUARY 25, 1984**Registered Professional Engineer  
and/or Land SurveyorCertificate No. **JOHN W. WEST,** 6**RONALD J. EIDSON,** 32

0 320 640 960 1280 1600 1920 2240 2560 2880 3200 3520 3840 4160 4480 4800 5120 5440 5760 6080 6400

# TAMARACK PETROLEUM COMPANY, INC.

LEASE: LION STATE				01-J-09-14S-33E			
MONTH	OIL PROD	OIL RUNS	GAS PROD	WATER	GRAVITY	OIL PRICE	GAS PRICE
MAY'94	83	81	264	1168	40.8	\$17.25	\$1.50
JUN	176	183	700	1107	40.3	\$18.00	\$1.56
JUL	188	189	800	211	39.2	\$17.98	\$1.56
AUG	274	246	784	267	39.8	\$15.98	\$1.56
SEP	275	280	925	298	40.0	\$16.00	\$1.58
OCT	295	0	944	326	40.0	\$0.00	\$1.55
NOV	275	306	941	290	40.7	\$16.50	\$1.29
DEC	277	103	933	286	41.1	\$15.25	\$1.31
JAN '95	210	262	832	265	41.3	\$17.00	\$1.31
FEB	113	0	706	165	40.0	\$0.00	\$1.18
MAR	89	146	552	1105	41.2	\$17.25	\$1.20
APR	131	0	1048	957	40.0	\$0.00	\$1.21

LEASE: LION STATE -A-				02-P-09-14S-33E			
MONTH	OIL PROD	OIL RUNS	GAS PROD	WATER	GRAVITY	OIL PRICE	GAS PRICE
MAY'94	98	132	446	229	40.8	\$17.25	\$1.50
JUN	109	0	533	165	40.3	\$18.00	\$1.56
JUL	107	143	548	164	39.2	\$17.98	\$1.56
AUG	189	205	701	325	39.8	\$15.98	\$1.56
SEP	178	0	726	270	40.0	\$16.00	\$1.58
OCT	153	170	463	334	40.0	\$0.00	\$1.55
NOV	18	170	159	371	40.7	\$16.50	\$1.29
DEC	171	191	229	333	41.1	\$15.25	\$1.31
JAN '95	182	0	81	263	41.3	\$17.00	\$1.31
FEB	135	206	564	216	40.0	\$0.00	\$1.18
MAR	118	132	606	233	41.2	\$17.25	\$1.20
APR	120	0	765	242	40.0	\$0.00	\$1.21

New Crude Oil Contract - effective 5-1-95 - Scurlock Permian Corporation  
WTI Posting deemed 40 degrees plus premium \$0.65

# TAMARACK PETROLEUM COMPANY, INC.

LEASE: SAUNDERS STATE 01-N-09-14S-33E

MONTH	OIL PROD	OIL RUNS	GAS PROD	WATER	GRAVITY	OIL PRICE	GAS PRICE
WELL SHUT-IN							

LEASE: SAUNDERS STATE 02-E-16-14S-33E

MONTH	OIL PROD	OIL RUNS	GAS PROD	WATER	GRAVITY	OIL PRICE	GAS PRICE
MAY'94	98	132	1	229	41.4	\$18.10	\$0.00
JUN	109	0	1	165	40.4	\$0.00	\$0.00
JUL	107	143	1	164	40.3	\$19.35	\$0.00
AUG	189	205	1	325	40.4	\$16.60	\$0.00
SEP	178	0	1	270	40.3	\$0.00	\$0.00
OCT	153	170	1	334	41.0	\$17.10	\$0.00
NOV	168	170	1	371	41.1	\$16.35	\$0.00
DEC	171	191	1	333	41.7	\$16.85	\$0.00
JAN '95	182	0	1	263	41.3	\$0.00	\$0.00
FEB	135	206	1	216	41.7	\$17.35	\$0.00
MAR	118	132	1	233	41.6	\$17.85	\$0.00
APR	120	0	1	242	41.0	\$0.00	\$0.00

LEASE: SAUNDERS STATE 03-O-09-14S-33E

MONTH	OIL PROD	OIL RUNS	GAS PROD	WATER	GRAVITY	OIL PRICE	GAS PRICE
MAY'94	239	322	1	481	41.4	\$18.10	\$0.00
JUN	215	0	1	510	40.4	\$0.00	\$0.00
JUL	202	271	1	262	40.3	\$19.35	\$0.00
AUG	230	249	1	264	40.4	\$16.60	\$0.00
SEP	177	0	1	384	40.3	\$0.00	\$0.00
OCT	276	307	1	307	41.0	\$17.10	\$0.00
NOV	237	240	1	273	41.1	\$16.35	\$0.00
DEC	242	270	1	244	41.7	\$16.85	\$0.00
JAN '95	219	0	1	267	41.3	\$0.00	\$0.00
FEB	162	248	1	236	41.7	\$17.35	\$0.00
MAR	152	170	1	255	41.6	\$17.85	\$0.00
APR	131	0	1	261	41.0	\$0.00	\$0.00

New Cruce Oil Contract - effective 5-1-95 - Scurlock Permian Corporation  
WTI Posting deemed 40 degrees plus \$0.65 premium

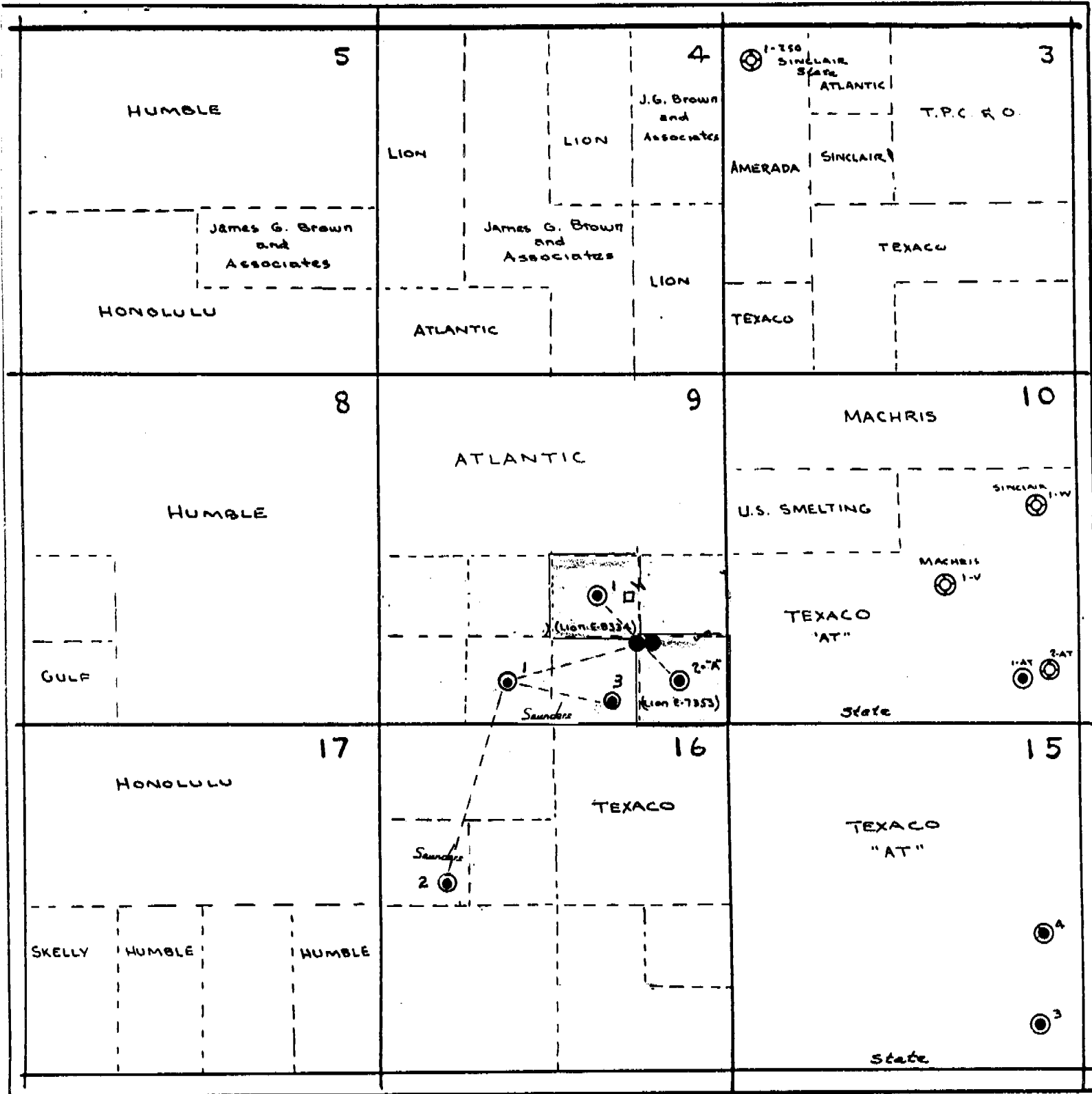

Lea County, New Mexico  
T-14 S, R-33-E

Scale: 1 inch equals 2000'

SAUNDERS STATE & LION STATE BATTERY

TANKS ●  
FLOWLINES ----