

KERSEY & COMPANY
DRILLING AND OIL PRODUCTION
Phone SH 6-3671 • P. O. Box 305 • 808 W. Grand
ARTESIA, NEW MEXICO

March 31, 1961

WEX - 83

Handwritten notes:
Held in hand
New Mexico 18

Oil Conservation Commission
P. O. Box 871
Santa Fe, New Mexico

Re: Application for Administrative
approval to convert two wells to
Water Injection in Red Lake Premier
Sand Unit, Eddy County, New Mexico.

Gentlemen:

In accordance with Commission Rule 701, Kersey &
Company respectively request administrative approval to convert
the following wells to water injection wells.

Lease & Well Number	Location
Welch Reid #3	Unit letter G, Section 20-17-28
Tigner #1	Unit letter L, Section 28-17-28

Following is information concerning the proposed
expansion:

Welch Reid No. 3 is on the edge of the flood pattern
and the production from this well has been negligible, and it
is thought that more oil can be ultimately recovered by making
this well an injection and converting this portion of the flood
to a peripheral pattern.

Tigner No. 1 is on the outside edge of the flood with
no offset production and it is felt that additional oil may be
recovered on the inside of the unit area by making this an in-
jection well, another step toward a peripheral pattern

There is no offset production or other operators that
will be affected by this expansion and the unit area covers the
field.

Tigner No. 1 is cleaned out to bottom, a liner has
been cemented and the zone to be injected in perforated and
fractured.

Oil Conservation Commission
Box 871
Santa Fe, New Mexico

Welch Reid No. 3 is producing through perforations so
no work will be required to make this an injection well.

A plat of the unit area is enclosed.

We will appreciate your consideration in expediting
this request.

Yours very truly,

KERSEY & COMPANY

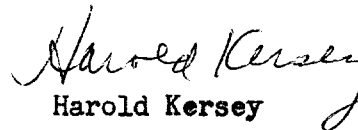
Harold Kersey

HK:cg

CC: Oil Conservation Commission, Artesia, New Mexico
State Engineers Office, Santa Fe, New Mexico
Graridge Corporation, Breckenridge, Texas
Cliff Chapman, Artesia, New Mexico.

NEW MEXICO OIL CONSERVATION COMMISSION

GAS-OIL RATIO REPORT

Red Lake Premier Sand Unit
OPERATOR Kersey & Company POOL Red Lake
ADDRESS Box 316, Artesia, New Mexico MONTH OF January, 19 61
SCHEDULED TEST V COMPLETION TEST _____ SPECIAL TEST _____ (Check One)

Lease	Well No.	Date of Test	Producing Method	Choke Size	Test Hours	Daily Allowable Bbls.	Production During Test			GOR Cu. Ft. Per Bbl.
							Water Bbls.	Oil Bbls.	Gas MCF	
INITIAL PRODUCTION WHEN WELL FIRST DRILLED										
Welch Reid	3	4/23/59	Pump tank	in test	24	12	70	12	TSTM	TSTM
PRESENT PRODUCTION AFTER WATERFLOOD RESPONSE										
Welch Reid	3	3/10/61	Pump tank	in test	24	2	21	2	TSTM	TSTM

No well will be assigned an allowable greater than the amount of oil produced on the official test.

During gas-oil ratio test, each well shall be produced at a rate not exceeding the top unit allowable for the pool in which well is located by more than 25 percent. Operator is encouraged to take advantage of this 25 percent tolerance in order that well can be assigned increased allowables when authorized by the Commission.

Gas volumes must be reported in MCF measured at a pressure base of 15.025 psia and a temperature of 60 degrees F. Specific gravity base will be 0.60.

Mail original and one copy of this report to the district office of the New Mexico Oil Conservation Commission. In accordance with Rule 301 and Appropriate Pool Rules.

(I certify that the information given is true and complete to the best of my knowledge.)

Date April 3, 1961

Kersey & Company
By Harold Kersey
Owner
Title

NEW MEXICO OIL CONSERVATION COMMISSION

GAS-OIL RATIO REPORT

Red Lake Premier Sand Unit
OPERATOR Kersey & Company POOL Red Lake
ADDRESS Box 316, Artesia, New Mexico MONTH OF January, 1961
SCHEDULED TEST V COMPLETION TEST _____ SPECIAL TEST _____ (Check One)

Lease	Well No.	Date of Test	Producing Method	Choke Size	Test Hours	Daily Allowable Bbls.	Production During Test			GOR Cu. Ft. Per Bbl.
							Water Bbls.	Oil Bbls.	Gas MCF	
INITIAL PRODUCTION WHEN WELL FIRST DRILLED										
Tigner	1	9/9/48	Pump in test tank		24	15	0	15	TSTM	TSTM
PRESENT PRODUCTION AFTER WATERFLOOD RESPONSE										
Tigner	1	3/10/61	Pump in test tank		24	3/4	0	3/4	TSTM	TSTM

No well will be assigned an allowable greater than the amount of oil produced on the official test.

During gas-oil ratio test, each well shall be produced at a rate not exceeding the top unit allowable for the pool in which well is located by more than 25 percent. Operator is encouraged to take advantage of this 25 percent tolerance in order that well can be assigned increased allowables when authorized by the Commission.

Gas volumes must be reported in MCF measured at a pressure base of 15.025 psia and a temperature of 60 degrees F. Specific gravity base will be 0.60.

Mail original and one copy of this report to the district office of the New Mexico Oil Conservation Commission. In accordance with Rule 301 and Appropriate Pool Rules.

(I certify that the information given is true and complete to the best of my knowledge.)

Date April 8, 1961.

Kersey & Company
By Harold Kersey
Owner
Title

RED LAKE UNIT AREA

EDDY COUNTY, N.M.

SCALE 1"=2000'

12-12-59

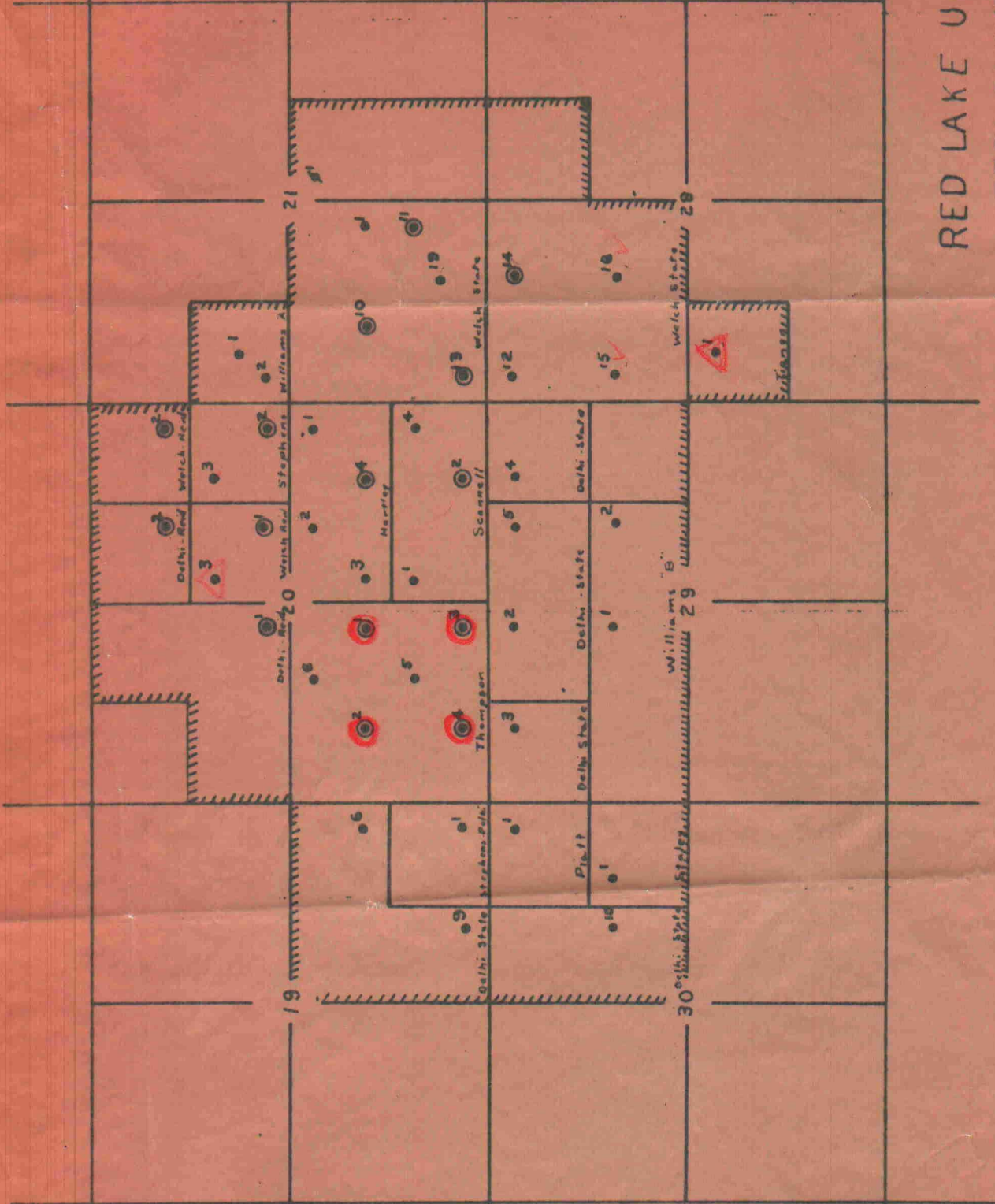

April 7, 1961

Kersey and Company
P. O. Box 305
Artesia, New Mexico

Attn. Mr. Harold Kersey

Dear Mr. Kersey:

Reference is made to your application dated March 31, 1961 to the Oil Conservation Commission seeking administrative approval to convert two wells to water injection wells in Red Lake Premier Sand Unit, Eddy County, New Mexico.

Please furnish me with the following information on each well:

The size, weight and length of each string of casing and the amount of cement used on each string of casing and the top of the cement behind each string of casing, and a statement as to where the perforations occur in each string of casing. Please give me the date the well was drilled and whether or not the casing used in the construction of the well was new at that time. Also state as to whether or not injection will be through tubing and packer, or through the inner string of casing.

Upon receipt of this information, I will review it as quickly as possible and inform the Commission as to the position of this office with respect to the application and forward you a copy of my letter to the Commission.

Very truly yours,

S. E. Reynolds
State Engineer

FHI/ma
cc-F. H. Hennighausen
Oil Conservation Commission

By:
Frank E. Irby
Chief
Water Rights Division



W 7 - 83

STATE OF NEW MEXICO

STATE ENGINEER OFFICE

SANTA FE

S. E. REYNOLDS
STATE ENGINEER

April 24, 1961

ADDRESS CORRESPONDENCE TO:
STATE CAPITOL
SANTA FE, N. M.

Mr. A. L. Porter, Jr.
Secretary-Director
Oil Conservation Commission
Santa Fe, New Mexico

Dear Mr. Porter:

Reference is made to the application of Kersey and Company which seeks administrative approval to convert the following wells to water injection wells:

Welch Reid No. 3, Unit G, Section 20, Township 17 South, Range 28
East and Tigner No. 1, Unit L, Section 28, Township 17 South, Range 28 East.

I discussed this application with Mr. Kapteina on Thursday, April 20, 1961 and in confirmation of my conversation with him state that this office offers no objection to the granting of this application.

Yours truly,

S. E. Reynolds
State Engineer

By: *Frank E. Irby*
Frank E. Irby
Chief
Water Rights Division

FEI/ma
cc-Kersey & Company
F. H. Hennighausen