

ARCHIE M. SPEIR

P. O. DRAWER 40

ARTESIA, NEW MEXICO - 88210

December 21, 1966

10-250

Mr. A. L. Porter, Jr.
Secretary-Director
Oil Conservation Commission
Post Office Box 2088
Santa Fe, New Mexico 87501

Dec 22 PM 1 20

Dear Mr. Porter:

Commission Order No. R-2875 approved the South Red Lake Grayburg Unit. Order No. 2882 approved the Unit waterflood project.

Administrative approval is requested for expansion of the waterflood project by injection of water into Well No. 1, Tract 10 (formerly Martin Yates III No. 1 Dooley-State).

As evidence for approval the following are enclosed:

- (1) Plat showing the unit area; which are all of the wells in the area producing from the unitized formation, formation under flood.
- (2) Well test on Form C-116 of the proposed injection, Well No. 1, Tract 10. One test dated June 20, 1966, the other dated December 20, 1966. Tests on Well No. 4, Tract 9 are dated June 6, 1966 and December 12, 1966. Both wells show a response to the flood.
- (3) Schematic diagram of the present casing and proposed casing in Well No. 1, Tract 10. This is the casing program set out in Order No. 2882.

Injection will be connected to the present system. Water for the project is purchased from Double-Eagle Corporation.

Tract No. 10 was not committed to the Unit on the effective date of the Unit, June 1, 1965. The Unit has purchased all of the working interest of Tract 10. All necessary documents or executed counterports will be filed with the State Land Commissioner and the Oil and Gas Supervisor of the United States Geological Survey to effectively commit Tract 10 to the Unit Agreement at 7:00 A. M.

Mr. A. L. Porter, Jr.

Page II

on January 1, 1967. Your expediting of this request for a minimum delay in conversion of this well after January 1, 1967 will be greatly appreciated.

State Engineer is notified of this application by receipt of one copy of this letter with all enclosures.

Yours very truly,

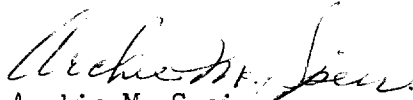

Archie M. Speir
Unit Operator

AMS/tjs

Encl.

cc; Frank Irby
State Engineers Office
State Capital Building
Santa Fe, New Mexico 87501

NEW MEXICO OIL CONSERVATION COMMISSION
GAS-OIL RATIO TESTS

C-116
Revised 1-1-65

Operator Archie M. Speir		Pool Red Lake				County Eddy										
Address Post Office Drawer 40 Artesia, New Mexico						TYPE OF TEST - (X)	Scheduled <input type="checkbox"/>			Completion <input type="checkbox"/>			Special <input checked="" type="checkbox"/>			
LEASE NAME	WELL NO.	LOCATION				DATE OF TEST	STATUS	CHOKE SIZE	TBG. PRESS.	DAILY ALLOWABLE	LENGTH OF TEST HOURS	PROD. DURING TEST				GAS - OIL RATIO CU.FT./BBL
		U	S	T	R							WATER BBLs.	GRAV. OIL	OIL BBLs.	GAS M.C.F.	
South Red Lake Grayburg Unit Tract 9	4	E	36	17	27	6/6/66	P	2"	0	3	24	Trace	33	3	TSTM	No.A.

No well will be assigned an allowable greater than the amount of oil produced on the official test.

During gas-oil ratio test, each well shall be produced at a rate not exceeding the top unit allowable for the pool in which well is located by more than 25 percent. Operator is encouraged to take advantage of this 25 percent tolerance in order that well can be assigned increased allowables when authorized by the Commission.

Gas volumes must be reported in MCF measured at a pressure base of 15.025 psia and a temperature of 60° F. Specific gravity base will be 0.60.

Report casing pressure in lieu of tubing pressure for any well producing through casing.

Mail original and one copy of this report to the district office of the New Mexico Oil Conservation Commission in accordance with Rule 301 and appropriate pool rules.

I hereby certify that the above information is true and complete to the best of my knowledge and belief.

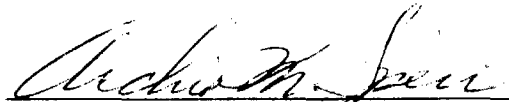
(Signature)

OPERATOR

(Title)

December 21, 1966

(Date)

SOUTH RED LAKE GRAYBURG UNIT
EDDY COUNTY, NEW MEXICO

PROPOSED INJECTION WELL CASING PROGRAM

SRLGU TRACT No. 10 WELL No. 1
2310' FSL & 1650' FWL
SEC. 36, T17S, R27E, NMPM

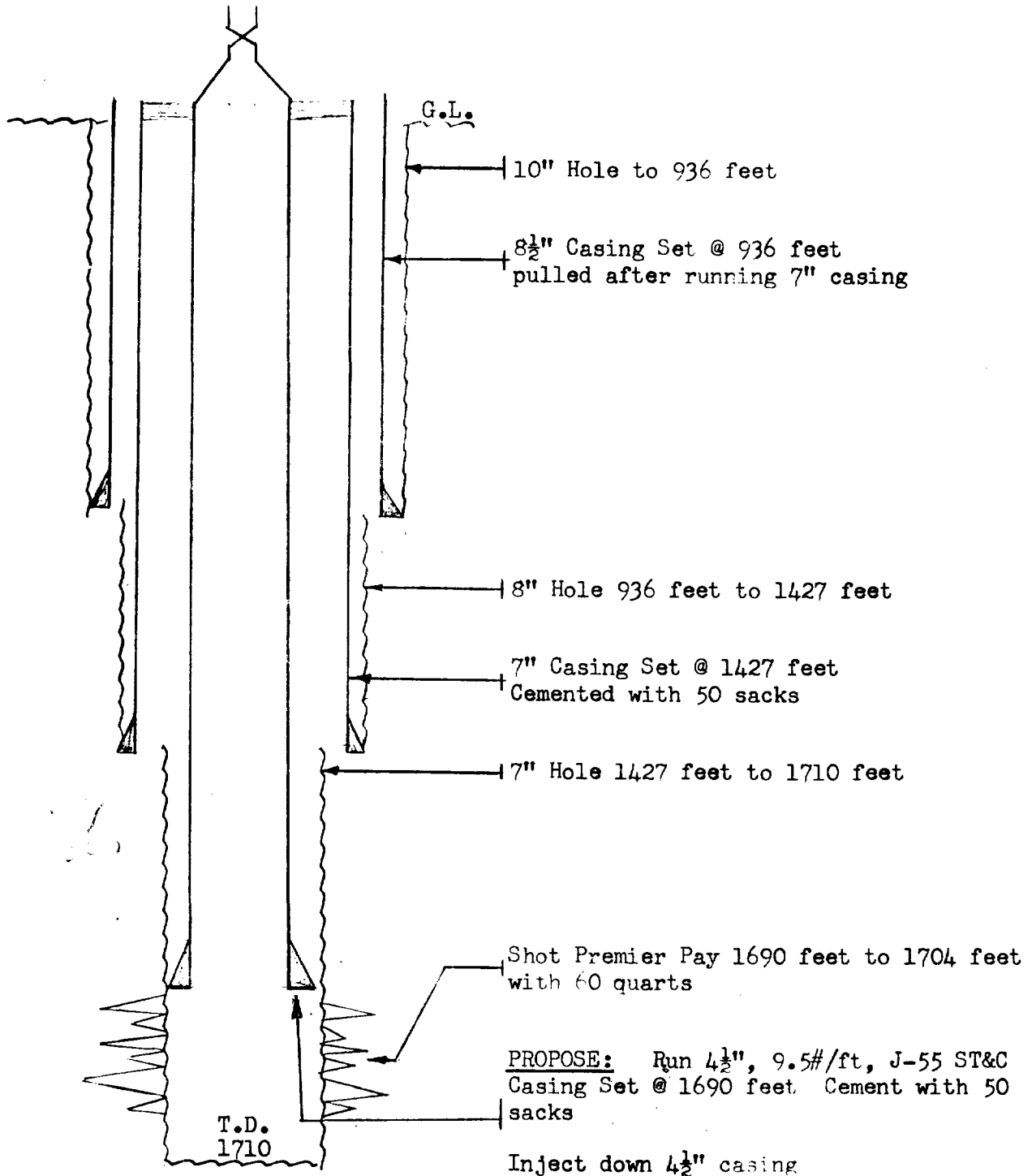

NEW MEXICO OIL CONSERVATION COMMISSION
GAS-OIL RATIO TESTS

C-116
Revised 1-1-65

Operator Archie M. Spair		Pool Red Lake				County Eddy										
Address Post Office Drawer 40 Artesia, New Mexico						TYPE OF TEST - (X)	Scheduled <input type="checkbox"/>			Completion <input type="checkbox"/>			Special <input checked="" type="checkbox"/>			
LEASE NAME	WELL NO.	LOCATION				DATE OF TEST	STATUS	CHOKE SIZE	TBG. PRESS.	DAILY ALLOWABLE	LENGTH OF TEST HOURS	PROD. DURING TEST				GAS - OIL RATIO CU. FT./BBL.
		U	S	T	R							WATER BBL.	GRAV. OIL	OIL BBL.	GAS M.C.F.	
South Red Lake Grayburg Unit Tract 10	1	K	36	17	27	12/20/66	P	2"	0	5	24	2	35	23	TSTM	N.A.

No well will be assigned an allowable greater than the amount of oil produced on the official test.

During gas-oil ratio test, each well shall be produced at a rate not exceeding the top unit allowable for the pool in which well is located by more than 25 percent. Operator is encouraged to take advantage of this 25 percent tolerance in order that well can be assigned increased allowables when authorized by the Commission.

Gas volumes must be reported in MCF measured at a pressure base of 15,025 psia and a temperature of 60° F. Specific gravity base will be 0.60.

Report casing pressure in lieu of tubing pressure for any well producing through casing.

Mail original and one copy of this report to the district office of the New Mexico Oil Conservation Commission in accordance with Rule 301 and appropriate pool rules.

I hereby certify that the above information is true and complete to the best of my knowledge and belief.

(Signature)

OPERATOR

(Title)

December 21, 1966

(Date)

NEW MEXICO OIL CONSERVATION COMMISSION
GAS-OIL RATIO TESTS

C-116
Revised 1-1-65

Operator Archie M. Speir		Pool Red Lake				County Eddy										
Address Post Office Drawer 40 Artesia, New Mexico						TYPE OF TEST - (X)	Scheduled <input type="checkbox"/>			Completion <input type="checkbox"/>			Special <input checked="" type="checkbox"/>			
LEASE NAME	WELL NO.	LOCATION				DATE OF TEST	STATUS	CHOKE SIZE	T.B.G. PRESS.	DAILY ALLOWABLE	LENGTH OF TEST HOURS	PROD. DURING TEST				GAS - OIL RATIO CU. FT./BBL.
		U	S	T	R							WATER BBL.	GRAV. OIL	OIL BBL.	GAS M.C.F.	
South Red Lake Grayburg Unit Tract 10	1	K	36	17	27	6/20/66	P	2	0	1	25	Trace	33	3	TSTM	N.A.

No well will be assigned an allowable greater than the amount of oil produced on the official test.

During gas-oil ratio test, each well shall be produced at a rate not exceeding the top unit allowable for the pool in which well is located by more than 25 percent. Operator is encouraged to take advantage of this 25 percent tolerance in order that well can be assigned increased allowables when authorized by the Commission.

Gas volumes must be reported in MCF measured at a pressure base of 15.025 psia and a temperature of 60° F. Specific gravity base will be 0.60.

Report casing pressure in lieu of tubing pressure for any well producing through casing.

Mail original and one copy of this report to the district office of the New Mexico Oil Conservation Commission in accordance with Rule 301 and appropriate pool rules.

I hereby certify that the above information is true and complete to the best of my knowledge and belief.

Archie M. Speir
(Signature)

OPERATOR
(Title)

December 21, 1966
(Date)

NEW MEXICO OIL CONSERVATION COMMISSION
GAS-OIL RATIO TESTS

C-116
Revised 1-1-65

Operator Archie M. Speir		Pool Red Lake				County Eddy										
Address Post Office Drawer 40 Artesia, New Mexico						TYPE OF TEST - (X)		Scheduled <input type="checkbox"/>		Completion <input type="checkbox"/>		Special <input checked="" type="checkbox"/>				
LEASE NAME	WELL NO.	LOCATION				DATE OF TEST	STATUS	CHOKE SIZE	TBG. PRESS.	DAILY ALLOWABLE	LENGTH OF TEST HOURS	PROD. DURING TEST				GAS - OIL RATIO CU. FT./BBL.
		U	S	T	R							WATER BBLs.	GRAV. OIL	OIL BBLs.	GAS M.C.F.	
South Red Lake Grayburg Unit Tract 9	4	E	36	17	27	12/12/66	P	2"	0	75	24	61	37	32	8.4	272

No well will be assigned an allowable greater than the amount of oil produced on the official test.

During gas-oil ratio test, each well shall be produced at a rate not exceeding the top unit allowable for the pool in which well is located by more than 25 percent. Operator is encouraged to take advantage of this 25 percent tolerance in order that well can be assigned increased allowables when authorized by the Commission.

Gas volumes must be reported in MCF measured at a pressure base of 15.025 psia and a temperature of 60° F. Specific gravity base will be 0.60.

Report casing pressure in lieu of tubing pressure for any well producing through casing.

Mail original and one copy of this report to the district office of the New Mexico Oil Conservation Commission in accordance with Rule 301 and appropriate pool rules.

I hereby certify that the above information is true and complete to the best of my knowledge and belief.

(Signature)

OPERATOR

(Title)

December 21, 1966

(Date)

R 27 E

R 27 E R 28 E

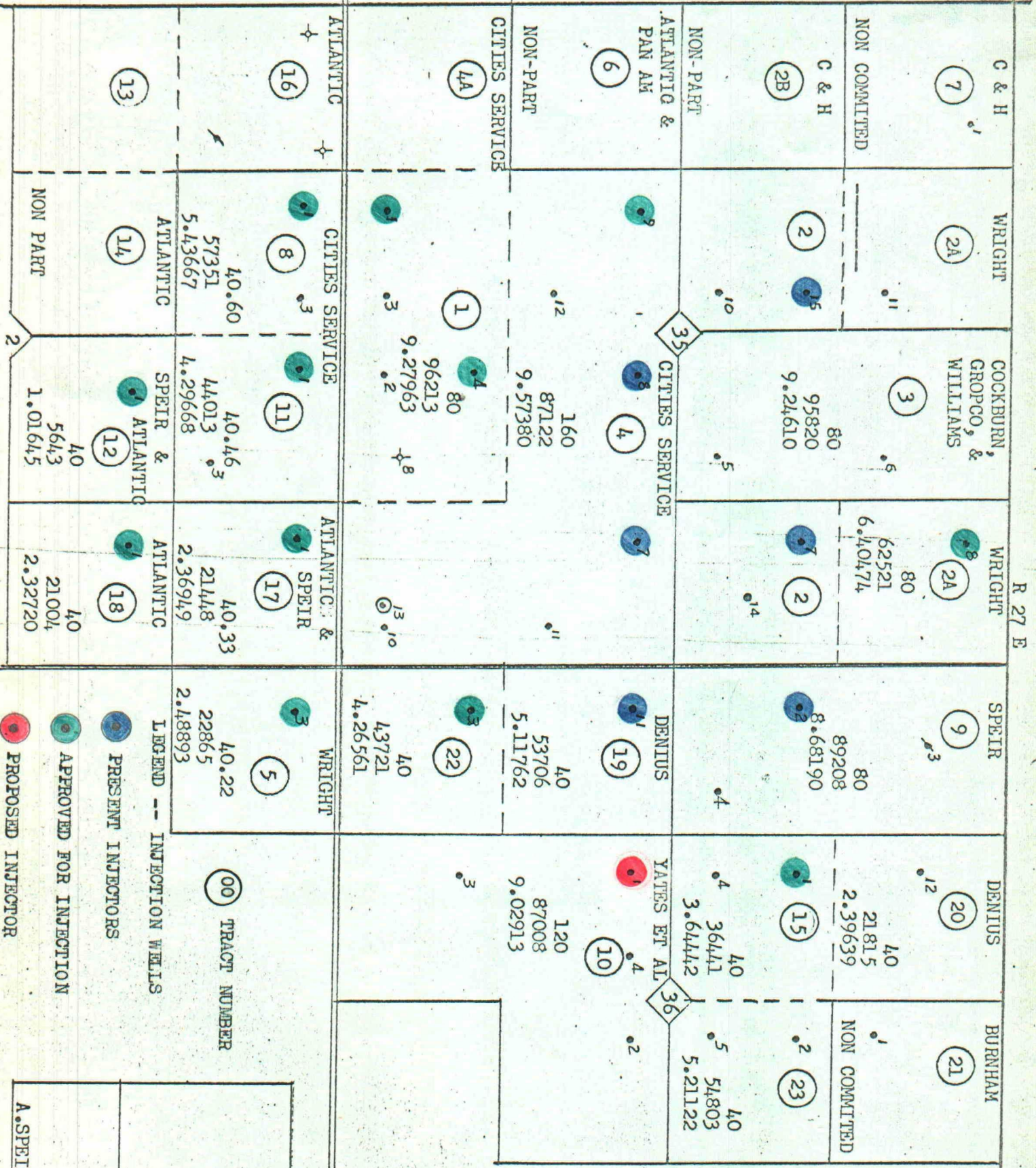

SOUTH RED LAKE GRAYBURG UNIT
 EDDY COUNTY, NEW MEXICO
 PROPOSED ENLARGED AREA
 (YATES)
 SCALE : FEET
 0 2640

LEGEND -- INJECTION WELLS
 PRESENT INJECTORS
 APPROVED FOR INJECTION
 PROPOSED INJECTOR

9/12/66

T 17 S T 18 S

OIL CONSERVATION COMMISSION

P. O. BOX 2088

SANTA FE, NEW MEXICO

ILLEGIBLE

Case 3212

Mr. A. J. Losee
Losee & Stewart
Attorneys at Law
Post Office Box 239
Artesia, New Mexico

April 5, 1965

April 5, 1965

C
O
P
Y

Mr. A. J. Losee, under the name mentioned herein, advised
Losee & Stewart to the Santa Fe office of the Commission
Attorneys at Law, which mentioned office,
Post Office Box 239

Artesia, New Mexico, advised to the Commission that
the Commission should be advised of the proposed project
in order that the Commission may take appropriate action.

Dear Sir: In compliance with Rule 701-E-3, it is hereby
advised that the Commission has approved the proposed project.

Reference is made to Commission Order No. R-2882, recently
entered in Case No. 3212, approving the Archie M. Spear
South Red Lake Grayburg Unit Waterflood Project.

Injection into any of the authorized 18 wells shall not be
commenced until:

- (a) A cemented liner has been set at the top of
the injection zone and pressure-tested to 2000
psi; or
- (b) A string of tubing has been run and set in a
packer immediately above the injection zone;
- (c) Where casing is set through the injection zone,
it shall be pressure tested to 2000 psi, or
injection shall be accomplished as in (b) above.

As to allowable, our calculations indicate that when all of the
18 authorized injection wells have been placed on active injec-
tion, the maximum allowable which this project will be eligible
to receive under the provisions of Rule 701-E-3 is 1162 barrels
per day.

J. K. Kapteina

ARCHIE M. SPEIR
P. O. DRAWER 40
ARTESIA, NEW MEXICO - 88210
December 21, 1966

ILLEGIBLE

66 Dec 22 PM 1 21

Mr. A. L. Porter, Jr.
Secretary-Director
Oil Conservation Commission
Post Office Box 2088
Santa Fe, New Mexico 87501

66 DEC 22 PM 1 21

Dear Mr. Porter:

Commission Order No. B-2875 approved the South Red Lake Grayburg Unit. Order No. 1582 approved the Unit waterflood project.

Administrative approval is requested for expansion of the waterflood project by injection of water into Well No. 1, Tract 10 (formerly Martin Yates III No. 1 Decoy-State).

As evidence for approval the following are enclosed:

- (1) Flat showing the well areas which are all of the wells in the area producing from the unitized formation, formation under flood.
- (2) Well test in Form 1-114 of the proposed injection, Well No. 1, Tract 10. One test dated June 10, 1966, the other dated December 7, 1966. Tests on Well No. 4, Tract 9 are dated June 6, 1966 and December 12, 1966. Both wells show a response to the flood.
- (3) Schematic diagram of the present casing and proposed casing in Well No. 1, Tract 10. This is the casing program set out in Order No. 1582.

Injection will be connected to the present system. Water for the project is purchased from Double-Eagle Corporation.

Tract No. 10 was not committed to the Unit on the effective date of the Unit, June 1, 1965. The Unit has purchased all of the working interest of Tract 10. All necessary documents or executed counterparts will be filed with the State Land Commissioner and the Oil and Gas Supervisor of the United States Geological Survey to effectively commit Tract 10 to the Unit Agreement at 7:00 A. M.

We can find no objection to this WFX application.
Dick



STATE OF NEW MEXICO
STATE ENGINEER OFFICE
SANTA FE

S. E. REYNOLDS
STATE ENGINEER

December 27, 1966

ADDRESS CORRESPONDENCE TO:
STATE CAPITOL
SANTA FE, N. M.

Mr. A. L. Porter, Jr.
Secretary-Director
Oil Conservation Commission
Santa Fe, New Mexico

Dear Mr. Porter:

Reference is made to the application of Archie M. Speir dated December 21, 1966 which seeks administrative approval for expansion of the South Red Lake Grayburg Unit & Waterflood Project by converting his well #1, Tract 10 to water injection.

This office offers no objection to the granting of the application, provided the casing and cementing program for this well is equal to, or better than those required in the Commission's letter of April 5, 1965 pertaining to Order R-2882, which approved the original application for the project.

FEI/ma
cc-A. M. Speir
F. H. Hennighausen

Yours truly,

S. E. Reynolds
State Engineer

By: *Frank E. Irby*
Frank E. Irby
Chief
Water Rights Div.