

27133878

WFX

10/10/00

765

AMERADA HESS CORPORATION

P. O. BOX 840
SEMINOLE, TEXAS 79360
915-758-6700

September 22, 2000

Attn: Lori Wrotenbery
State of New Mexico
Energy, Minerals and Natural Resources Department
Oil Conservation Division
2040 South Pacheco Street
Santa Fe, New Mexico 87505-5472

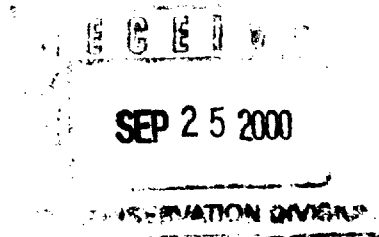

Re: Application for Amended Injection Permit
North Monument Grayburg San Andres Unit
Order No. R-9596

Dear Ms. Wrotenbery,

Amerada Hess Corporation respectfully request administrative amendment to Exhibit "A" of Division Order No. R-9596 on North Monument Grayburg San Andres Unit adding NMGSAU Well No.'s 914, 1402, and 1419 to order.

Enclosed is Form C-108 and supporting documents for your review.

If additional information is needed, please contact me at the above address or phone (915) 758-6707 at your earliest convenience.

Thank you for your consideration in this matter.

Sincerely,

Chad McGehee
Petroleum Engineer

Xc: Mr. Chris Williams – NMOCD, Hobbs Office

APPLICATION FOR AUTHORIZATION TO INJECT

- ✓ I. PURPOSE: X Secondary Recovery Pressure Maintenance Disposal Storage
Application qualifies for administrative approval? X Yes No
- ✓ II. OPERATOR: Amerada Hess Corporation
ADDRESS: P. O. Box 840, Seminole, Texas 79360
CONTACT PARTY: Chad McGehee PHONE: 915 758-6707
- ✓ III. WELL DATA: Complete the data required on the reverse side of this form for each well proposed for injection.
Additional sheets may be attached if necessary.
- ✓ IV. Is this an expansion of an existing project? X Yes No
If yes, give the Division order number authorizing the project: R-9596
- ✓ V. Attach a map that identifies all wells and leases within two miles of any proposed injection well with a one-half mile radius circle drawn around each proposed injection well. This circle identifies the well's area of review.
- VI. Attach a tabulation of data on all wells of public record within the area of review which penetrate the proposed injection zone. Such data shall include a description of each well's type, construction, date drilled, location, depth, record of completion, and a schematic of any plugged well illustrating all plugging detail.
- ✓ VII. Attach data on the proposed operation, including:
1. Proposed average and maximum daily rate and volume of fluids to be injected;
 2. Whether the system is open or closed;
 3. Proposed average and maximum injection pressure;
 4. Sources and an appropriate analysis of injection fluid and compatibility with the receiving formation if other than reinjected produced water; and,
 5. If injection is for disposal purposes into a zone not productive of oil or gas at or within one mile of the proposed well, attach a chemical analysis of the disposal zone formation water (may be measured or inferred from existing literature, studies, nearby wells, etc.).
- ✓ *VIII. Attach appropriate geologic data on the injection zone including appropriate lithologic detail, geologic name, thickness, and depth. Give the geologic name, and depth to bottom of all underground sources of drinking water (aquifers containing waters with total dissolved solids concentrations of 10,000 mg/l or less) overlying the proposed injection zone as well as any such sources known to be immediately underlying the injection interval.
- ✓ IX. Describe the proposed stimulation program, if any.
- ✓ *X. Attach appropriate logging and test data on the well. (If well logs have been filed with the Division, they need not be resubmitted).
- ✓ *XI. Attach a chemical analysis of fresh water from two or more fresh water wells (if available and producing) within one mile of any injection or disposal well showing location of wells and dates samples were taken.
- XII. Applicants for disposal wells must make an affirmative statement that they have examined available geologic and engineering data and find no evidence of open faults or any other hydrologic connection between the disposal zone and any underground sources of drinking water.
- ✓ XIII. Applicants must complete the "Proof of Notice" section on the reverse side of this form.
- XIV. Certification: I hereby certify that the information submitted with this application is true and correct to the best of my knowledge and belief.
- NAME: Chad McGehee TITLE: Petroleum Engineer
SIGNATURE: Chad McGehee DATE: September 22, 2000
- * If the information required under Sections VI, VIII, X, and XI above has been previously submitted, it need not be resubmitted. Please show the date and circumstances of the earlier submittal: August 2, 1991, original C-108 submitted by Amerada Hess Corporation on North Monument Grayburg San Andres Unit.

DISTRIBUTION: Original and one copy to Santa Fe with one copy to the appropriate District Office

III. WELL DATA

A. The following well data must be submitted for each injection well covered by this application. The data must be both in tabular and schematic form and shall include:

- (1) Lease name; Well No.; Location by Section, Township and Range; and footage location within the section.
- (2) Each casing string used with its size, setting depth, sacks of cement used, hole size, top of cement, and how such top was determined.
- (3) A description of the tubing to be used including its size, lining material, and setting depth.
- (4) The name, model, and setting depth of the packer used or a description of any other seal system or assembly used.

Division District Offices have supplies of Well Data Sheets which may be used or which may be used as models for this purpose. Applicants for several identical wells may submit a "typical data sheet" rather than submitting the data for each well.

B. The following must be submitted for each injection well covered by this application. All items must be addressed for the initial well. Responses for additional wells need be shown only when different. Information shown on schematics need not be repeated.

- (1) The name of the injection formation and, if applicable, the field or pool name.
- (2) The injection interval and whether it is perforated or open-hole.
- (3) State if the well was drilled for injection or, if not, the original purpose of the well.
- (4) Give the depths of any other perforated intervals and detail on the sacks of cement or bridge plugs used to seal off such perforations.
- (5) Give the depth to and the name of the next higher and next lower oil or gas zone in the area of the well, if any.

XIV. PROOF OF NOTICE

All applicants must furnish proof that a copy of the application has been furnished, by certified or registered mail, to the owner of the surface of the land on which the well is to be located and to each leasehold operator within one-half mile of the well location.

Where an application is subject to administrative approval, a proof of publication must be submitted. Such proof shall consist of a copy of the legal advertisement which was published in the county in which the well is located. The contents of such advertisement must include:

- (1) The name, address, phone number, and contact party for the applicant;
- (2) The intended purpose of the injection well; with the exact location of single wells or the Section, Township, and Range location of multiple wells;
- (3) The formation name and depth with expected maximum injection rates and pressures; and,
- (4) A notation that interested parties must file objections or requests for hearing with the Oil Conservation Division, 2040 South Pacheco, Santa Fe, New Mexico 87505, within 15 days.

NO ACTION WILL BE TAKEN ON THE APPLICATION UNTIL PROPER PROOF OF NOTICE HAS BEEN SUBMITTED.

NOTICE: Surface owners or offset operators must file any objections or requests for hearing of administrative applications within 15 days from the date this application was mailed to them.

INDEX

C-108 ATTACHMENTS

| Section III – Well Data , Wellbore Schematic | PAGE |
|---|-------------|
| North Monument Grayburg San Andres Unit Well No. 914 | 1 - 3 |
| North Monument Grayburg San Andres Unit Well No. 1402 | 4 - 6 |
| North Monument Grayburg San Andres Unit Well No. 1419 | 7 - 9 |
| Section V – Maps | |
| North Monument Grayburg San Andres Unit Map | 10 |
| North Monument Grayburg San Andres Unit Well No. 914, 1402, & 1419 | 11 |
| Section VI – Tabulation of Wells Penetrating Proposed Injection Zone (Wells not drld. during filing of original C-108) | 12 |
| Section VII – Data on Proposed Operation & Section IX – Stimulation | 13 |
| Section XIII & XIV – Proof of Notice | |
| Surface Owner Listing & Leasehold Operator Listing | 14 |
| Publication | 15 |

Note: Item No's. VI, VIII, & XI were submitted with original C-108 filed August 2, 1991

Item No. X – Logs & test data have previously been submitted.

INJECTION WELL DATA SHEET

OPERATOR: Amerada Hess CorporationWELL NAME & NUMBER: North Monument Grayburg San Andres Unit Blk. 9, Well No. 14 API No. 30-025-04053 State Lse. B-1431-3WELL LOCATION: 660' FSL & 1980' FWL N 25 19S 36E
FOOTAGE LOCATION UNIT LETTER SECTION TOWNSHIP RANGEWELLBORE SCHEMATICWELL CONSTRUCTION DATASurface CasingHole Size: 17-1/2" Casing Size: 12-1/2" 40# @ 208'Cemented with: 150 sx. or ft³Top of Cement: Surface Method Determined: CirculatedIntermediate CasingHole Size: 11" Casing Size: 8-5/8" 28# @ 2484'Cemented with: 500 sx. or ft³Top of Cement: 517' Method Determined: CalculatedProduction CasingHole Size: 7-7/8" Casing Size: (1) 7" 23# fr. 0'-452'
(2) 6-5/8" 20# fr. 452'-3808'Cemented with: 100 sx. or ft³Top of Cement: 2797' Method Determined: CalculatedTotal Depth: 3939'Injection Interval* Open Hole fr. 3808 feet To 3939'

(Perforated or Open Hole; indicate which)

*DECISION MAY BE MADE TO PERF. AS HIGH AS 3780'

INJECTION WELL DATA SHEETTubing Size: 2-3/8" Lining Material: PE or FiberglassType of Packer: 6-5/8" Arrowset 1-XSPacker Setting Depth: 3758'

Other Type of Tubing/Casing Seal (if applicable): _____

Additional Data

1. Is this a new well drilled for injection? _____ Yes X No

If no, for what purpose was the well originally drilled? Grayburg San Andres Producer

2. Name of the Injection Formation: Grayburg San Andres

3. Name of Field or Pool (if applicable): Eunice Monument Grayburg San Andres

4. Has the well ever been perforated in any other zone(s)? List all such perforated intervals and give plugging detail, i.e. sacks of cement or plug(s) used. No

(452' of 6-5/8' csg. was replaced w/7" 23# in 1992 – Passed integrity test to 515#.)

5. Give the name and depths of any oil or gas zones underlying or overlying the proposed injection zone in this area: _____

Higher Gas Zone: Eunmont at +/- 3660'

Lower Oil Zone: Paddock at +/- 4900'

1872

NMGSAU #914

(Formerly AHC State 'T' #1)

660' FSL & 1980' FWL

Section 25, T-19S, R-36E

Lea County, NM

API # 30-025-04053

KB Elevation 3628'

12 1/2" 40# CASING at 208'
Cemented w/ 150 sx
TDC @ Surface (Circulated)
Hole Size 17 1/2"

8-5/8" 28# CASING AT 2484'
Cemented w/ 500 sx
TDC @ 517' (Calculated)
Hole Size 11"

2-3/8" PE-lined Tubing
6-5/8" Arrowset 1-XS
Packer at 3758'

3660'
TOP OF GRAYBURG

7" 23# CASING 0'-452'
6-5/8" 20# CASING 452'-3808'
Cemented w/ 100 sx
TDC @ 2797' (Calculated)
Hole Size 7-7/8"

8-1/2" D.H. fr/ 3808'-3939'

TD 3939'

INJECTION WELL DATA SHEET

OPERATOR: Amerada Hess CorporationWELL NAME & NUMBER: North Monument Grayburg San Andres Unit Blk. 14, Well No. 2 API No. 30-025-12466 State Use. B-1626-1WELL LOCATION: 660' FNL & 1980' FEL B 36 19S 36E
FOOTAGE LOCATION UNIT LETTER SECTION TOWNSHIP RANGEWELLBORE SCHEMATICWELL CONSTRUCTION DATA
Surface CasingHole Size: 17-1/2" Casing Size: 12-1/2" 40# @ 201'Cemented with: 200 sx. or _____ ft³Top of Cement: Surface Method Determined: CalculatedIntermediate CasingHole Size: 11" Casing Size: 8-5/8" 32# @ 2421'Cemented with: 500 sx. or _____ ft³Top of Cement: 454' Method Determined: CalculatedProduction CasingHole Size: 7-7/8" Casing Size: 6-5/8" 20# @ 3798'Cemented with: 100 sx. or _____ ft³Top of Cement: 2920' Method Determined: CBLTotal Depth: 3930' PBD @ 3890'Injection Interval5-7/8" Open Hole fr. 3798 feet To 3930' (PBD @ 3890')

(Perforated or Open Hole; indicate which)

INJECTION WELL DATA SHEETTubing Size: 2-3/8" Lining Material: PE of FiberglassType of Packer: 6-5/8" Arrowset 1-XSPacker Setting Depth: 3748'

Other Type of Tubing/Casing Seal (if applicable): _____

Additional Data

1. Is this a new well drilled for injection? _____ Yes X No

If no, for what purpose was the well originally drilled? Grayburg San Andres Producer

2. Name of the Injection Formation: Grayburg San Andres

3. Name of Field or Pool (if applicable): Eunice Monument Grayburg San Andres

4. Has the well ever been perforated in any other zone(s)? List all such perforated intervals and give plugging detail, i.e. sacks of cement or plug(s) used. Yes

Shot squeeze holes in 6-5/8" csg. at 2910' & 2870' & circ. cement to surface using 350 sks.

5. Give the name and depths of any oil or gas zones underlying or overlying the proposed injection zone in this area: _____

Higher Gas Zone: Eunmont at +/- 3586'

Lower Oil Zone: Paddock at +/- 4900'

NMGSAU #1402

(Formerly AHC State 'V' #2)

660' FNL & 1980' FEL

Section 36, T-19S, R-36E

Lea County, NM

API # 30-025-12466

KB Elevation 3613'

12 1/2" 40# CASING at 201'
Cemented w/ 200 sx
TDC @ Surface (Calculated)
Hole Size 17 1/2"

8-5/8" 32# CASING AT 2421'
Cemented w/ 500 sx
TDC @ 454' (Calculated)
Hole Size 11"

TDC @ 2920'; PERF'D @ 2910' -
COULDN'T PUMP IN AT 1400#.
PERF'D AT 2870' AND CEMENTED W/
350 SX. CIRC'D 21 SX TO PIT.

2-3/8" PE-lined Tubing
6-5/8" Arrowset 1-XS
Packer at 3748'

3586'
TOP OF GRAYBURG

6-5/8" 20# CASING at 3798'
Cemented w/ 100 sx
TDC @ 2920' (93 CBL)
Hole Size 7-7/8"

LYNES INFLATABLE MILLABLE BP
@ 3890'

5-7/8" O.H. fr/ 3798'-3930'

TD 3930'
PBD 3890'

INJECTION WELL DATA SHEET

OPERATOR: Amerada Hess CorporationWELL NAME & NUMBER: North Monument Grayburg San Andres Unit Blk. 14, Well No. 19 API No. 30-025-31587 State Use. B-1167-48WELL LOCATION: 80.5' FNL & 1505' FWL C 36 19S 36E
FOOTAGE LOCATION UNIT LETTER SECTION TOWNSHIP RANGEWELLBORE SCHEMATICWELL CONSTRUCTION DATASurface CasingHole Size: 17-1/2" Casing Size: 13-3/8" 48# @ 1185'Cemented with: 915 sx. or _____ ft³Top of Cement: Surface Method Determined: CirculatedIntermediate CasingHole Size: 12-1/4" Casing Size: 9-5/8" 36# @ 3641'Cemented with: 925 sx. or _____ ft³Top of Cement: 1550' Method Determined: CBLProduction CasingHole Size: 8-3/4" Casing Size: 7" 26# @ 5148'Cemented with: 902 Total sx. or _____ ft³Top of Cement: Surface Method Determined: CirculatedTotal Depth: 5150', PBD @ 3950'Injection IntervalPerfs. fr. 3747 feet to 3943 feet

(Perforated or Open Hole; indicate which)

INJECTION WELL DATA SHEETTubing Size: 2-3/8" Lining Material: PE or FiberglassType of Packer: 7" Arrowset 1-XSPacker Setting Depth: 3697'

Other Type of Tubing/Casing Seal (if applicable): _____

Additional Data

1. Is this a new well drilled for injection? _____ Yes X No

If no, for what purpose was the well originally drilled? Grayburg San Andres Producer

2. Name of the Injection Formation: Grayburg San Andres

3. Name of Field or Pool (if applicable): Eunice Monument Grayburg San Andres

4. Has the well ever been perforated in any other zone(s)? List all such perforated intervals and give plugging detail, i.e. sacks of cement or plug(s) used. No

5. Give the name and depths of any oil or gas zones underlying or overlying the proposed injection zone in this area: _____

Higher Gas Zone: Eunmont at +/- 3613'

Lower Oil Zone: Paddock at +/- 4900'

NMGSAU #1419

80.5' FNL & 1505' FWL

Section 36, T-19S, R-36E

Lea County, NM

API # 30-025-31587

KB Elevation 3627'

Apr 93 Shot squeeze
holes in 9-5/8" casing at
510' and circulated cement
to surface using 250 sx
Class H cement.

13 3/8" 48# CASING at 1185'
Cemented w/ 915 sx
TDC @ Surface (Circulated)
Hole Size 17 1/2"

Apr 93 Ran 7" 26# casing
from 0'-3482'. Circulated
cement to surface using 600
sx cement. Liners connected
with Lindsey TBSN-6 Seal
Nipple with 4 sets of lead
seals. Last pressure test
May 1997.

3613'

TOP OF GRAYBURG

9-5/8" 36# CASING AT 3641'
Cemented w/ 925 sx
OTOC @ 1550' (8-92 CBL)
Hole Size 12-1/4"

2-3/8" PE-lined Tubing
7" Arrowset 1-XS Packer
at 3697'

PERFORATIONS

3747'-3757'

3784'-3794'

3811'-3830'

3843'-3943'

3974'-3994' (Sgz'd)

4050'-4062' (Sgz'd)

CEMENT RETAINER AT 3958'
CEMENT ON TOP TO 3950'

7" 26# CASING 3482'-5148'
Cemented w/ 302 sx
TDC @ 3482' (Calculated)
Hole Size 8-3/4"

11-92 Shot 4 holes at 4090' and
squeezed w/ 75 sx Cl C (MP 2000#)

TD 5150'
PBD 3950'

North Monument Grayburg/San Andres Unit

0 5,139 10,278

FEET

POSTED WELL DATA

Well Number

WELL SYMBOLS

- Abandoned Gas
- Gas (Non-Unit)
- Oil Well
- Location Only
- Abandoned Oil
- Temp Abandoned
- Plugged and Abandoned
- Service Well
- Gas Well

November 9, 1999 6:27 AM

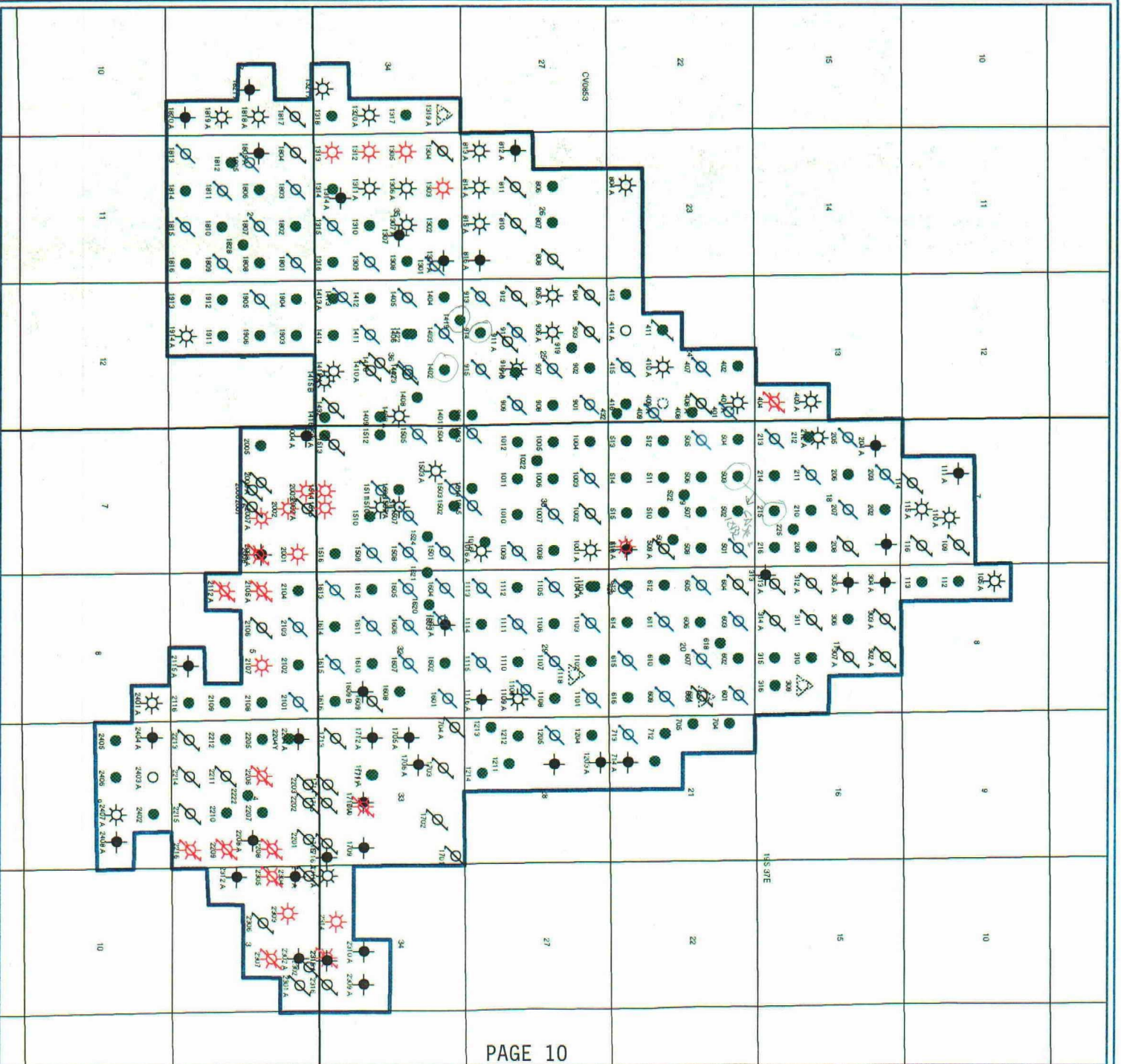

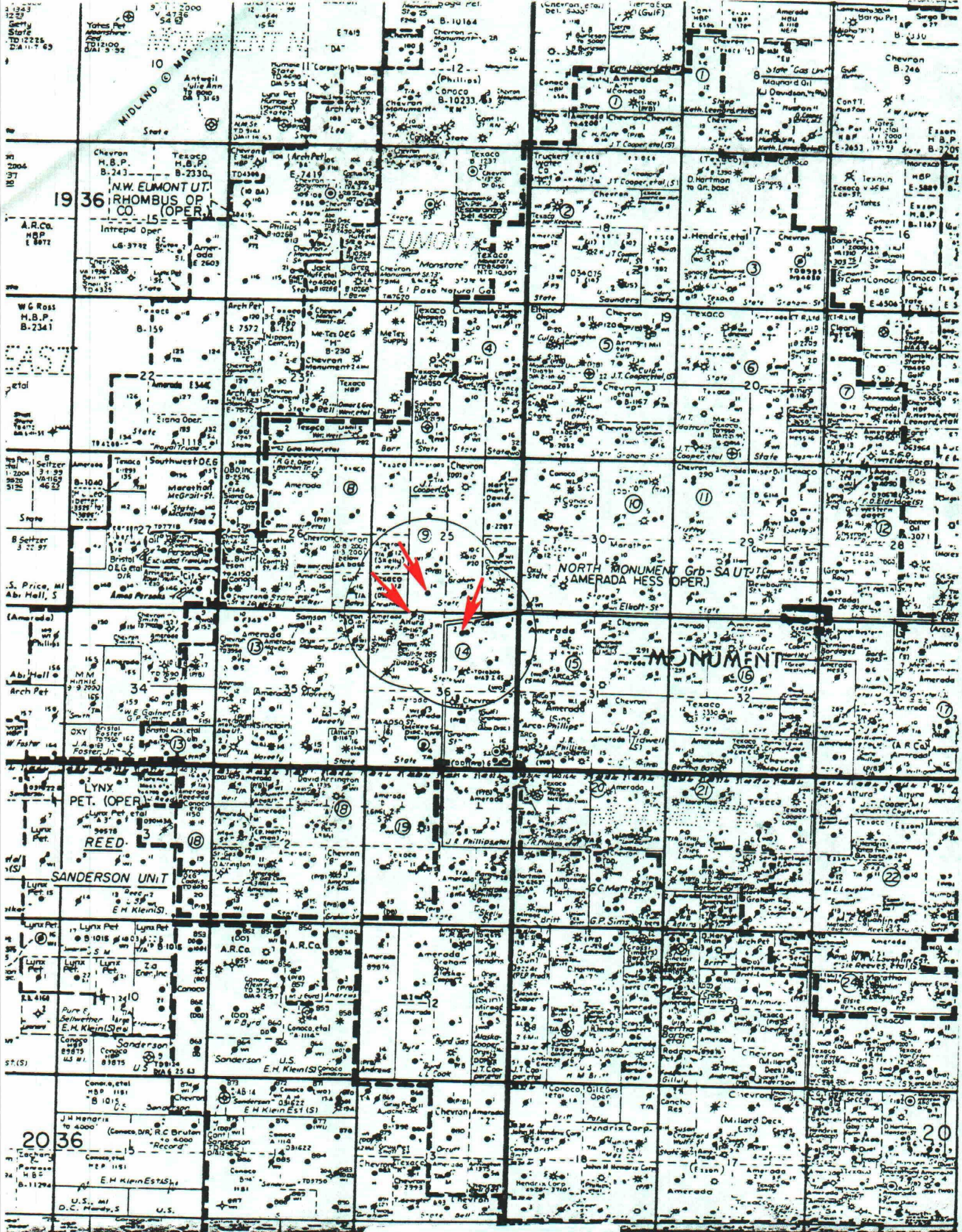

VI. TABULATION OF WELLS PENETRATING PROPOSED INJECTION ZONE

Wells not included in original C-108, within area of review

| WELL NAME / NUMBER | OPERATOR | API | LOCATION | | | | TYPE | FIELD | DATE | | COMPLETION INTERVAL | |
|---------------------|--------------------------|------------|----------|-----|-----|-----|------|-----------------|---------|------|---------------------|--------|
| | | | UNIT | SEC | T | R | | | DRILLED | TD | TOP | BOTTOM |
| NMGSAU #910 | AMERADA HESS CORPORATION | 3002532391 | J | 25 | 19S | 36E | OIL | EUNICE MONUMENT | Mar-94 | 4142 | 3830 | 3995 |
| NMGSAU #285 (#1422) | AMERADA HESS CORPORATION | 3002512481 | F | 36 | 19S | 36E | OIL | EUNICE MONUMENT | Mar-59 | 3930 | 3749 | 3930 |
| SHELL B STATE 1 | HUFF JACK | 3002531593 | C | 36 | 19S | 36E | OIL | EUMONT | May-92 | 3730 | 3380 | 3559 |
| SHELL-STATE 'B' 2 | HUFF JACK | 3002533838 | D | 36 | 19S | 36E | GAS | EUMONT | May-97 | 3800 | 3417 | 3649 |

C-108 ATTACHMENT

A. Section VII – Data on Proposed Operation

1. Proposed Average & Maximum Daily Rate and Volume of Fluids to be Injected:

Average Daily Rate: 750 B.W./D.

Maximum Daily Rate: 2500 B.W./D.

The injection volume is expected to reach 196,000,000 barrels of water at 100% Fillup. This volume may reach 620,000,000 barrels of water by abandonment.

2. Open or Closed System:

Injection system is a closed system.

3. Proposed Average & Maximum* Injection Pressures:

Average injection pressure: 625 PSI

Maximum injection pressure: 720 PSI

*Until a fracture gradient is determined, maximum injection pressure will be based on a .2 PSI/foot gradient.

4. Sources of Appropriate Analysis of Injection Fluid:

The source of injection water will be from San Andres water supply wells and produced water from existing North Monument Grayburg San Andres Unit producers. The San Andres formation is compatible with the produced water from the unit wells.

B. Section IX. Proposed Stimulation Program:

1. NMGSAU Well No. 914

Acidize w/2000 gal. 15% NEFE acid.

2. NMGSAU Well No. 1402

Acidize w/2000 gal. 15% NEFE acid.

3. NMGSAU Well No. 1419

Acidize w/2000 gal. 15% NEFE acid.

AMERADA HESS CORPORATION

P. O. BOX 840
SEMINOLE, TEXAS 79360
915-758-6700

September 22, 2000

Re: Application for Amended Injection Permit
North Monument Grayburg San Andres Unit
Lea County, New Mexico

Dear Sir,

Enclosed, for your information is a copy of Form C-108 and supporting documents filed with State of New Mexico Oil Conservation Division requesting administrative approval to add North Monument Grayburg San Andres Unit Well No.'s 914, 1402, and 1419 as water injection wells to unit.

If additional information is needed, please contact me at your earliest convenience at above address or phone (915) 758-6707.

Sincerely,

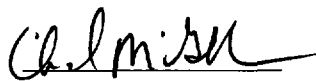

Chad McGehee
Petroleum Engineer

C-108 ATTACHMENT

A. Sections VIII & XIV – Proof of Notice.

1. Surface Owners – Application mailed by Certified Mail to following:
 - New Mexico State Land Office
Commissioner of Public Lands
Ray Powell, M.S., D.V.M.
310 Old Santa Fe Trail
P. O. Box 1148
Santa Fe, New Mexico 87504-1148
 - Byrd Ranch
P. O. Box 32
Monument, New Mexico 88265
 - Jimmie T. Cooper
P. O. Box 55
Monument, New Mexico 88265
 - DLD Resources
P. O. Drawer A
Monument, New Mexico 88265
2. Leasehold Operators within ½ mile of proposed injection wells – application mailed by Certified Mail to following:
 - Altura Energy LTD.
P. O. Box 4294
Houston, Texas 77210
 - Chevron U.S.A., Inc.
P. O. Box 1150
Midland, Texas 79702
 - Jack Huff
P. O. Box 50190
Midland, Texas 79710-0190
 - Kerr McGee Corporation
P. O. Box 1050
Midland, Texas 79702
 - Oryx Energy Company
P. O. Box 2880
Dallas, Texas 75221-2880
 - Owens Petroleum, Inc.
P. O. Box 2911
Midland, Texas 79702
 - OXY U.S.A., Inc.
P. O. Box 50250
Midland, Texas 79710
 - Texaco Exploration & Production, Inc.
P. O. Box 3109
Midland, Texas 79702
3. Publication – (Attached)

AFFIDAVIT OF PUBLICATION

State of New Mexico,
County of Lea.

I, KATHI BEARDEN

Publisher

of the Hobbs News-Sun, a
newspaper published at
Hobbs, New Mexico, do solemnly
swear that the clipping attached
hereto was published once a
week in the regular and entire
issue of said paper, and not a
supplement thereof for a period.

of 1

 weeks.

Beginning with the issue dated

September 17 2000

and ending with the issue dated

September 17 2000

Kathi Bearden

Publisher

Sworn and subscribed to before

me this 18th day of

September 2000

Jodi Benson

Notary Public.

My Commission expires
October 18, 2000
(Seal)

This newspaper is duly qualified
to publish legal notices or adver-
tisements within the meaning of
Section 3, Chapter 167, Laws of
1937, and payment of fees for
said publication has been made.

LEGAL NOTICE

September 17, 2000

Amerada Hess Corporation, operator of record for the North Monument Grayburg San Andres Unit, (NMGSAU), hereby notifies of their desire to inject water into the following three wells: NMGSAU Well No. 914, located in Unit N, Sec. 25, T19S, R36E, NMGSAU Well No. 1402, located in Unit B, Sec. 36, T19S, R36E, and NMGSAU Well No. 1419, located in Unit C, Sec. 36, T19S, R36E, Lea County, N.M. The NMGSAU "Authorization to Inject" is covered under State of New Mexico, Energy, Minerals and Natural Resources Department, Oil Conservation Division Case No. 10252, Division Order No. R-9596. Amerada Hess Corporation hereby gives notice that application has been made for administrative regulatory amendment of Exhibit "A" of said division order to include the aforementioned wells to inject water into Grayburg San Andres formation, Eunice Monument Grayburg San Andres pool through the gross perforated and/or open hole interval from approximately 3747 feet to 3943 feet with a maximum injection pressure of 720 PSI.

Contact Mr. Chad McGehee, Amerada Hess Corporation, P.O. Box 840, Seminole, Texas 79360, Phone 915-758-6707 concerning questions regarding application. Objections or requests for hearing concerning this application should be filed with the State of New Mexico, Energy, Minerals and Natural Resources Department, Oil Conservation Division, 2040 South Pacheco Street, Santa Fe, New Mexico 87505-5472 within 15 days of this publication.

#17623

01100986000

01543634

AMERADA HESS CORPORATION
PO BOX 840
SEMINOLE, TX 79360

Z 437 801 888

US Postal Service

Receipt for Certified Mail

No Insurance Coverage Provided.

Do not use for International Mail (See reverse)

| | |
|---|----------------|
| Sent to <i>Oyrd Ranch</i> | |
| Street & Number <i>P.O. Box 32</i> | |
| Post Office, State, & ZIP Code <i>Monument, N.M. 88265</i> | |
| Postage | \$ <i>.99</i> |
| Certified Fee | <i>1.40</i> |
| Special Delivery Fee | |
| Restricted Delivery Fee | |
| Return Receipt Showing to Whom & Date Delivered | |
| Return Receipt Showing to Whom, Date, & Addressee's Address | |
| TOTAL Postage & Fees | \$ <i>2.39</i> |
| Postmark or Date <i>SEP 22 2000</i> | |

Z 437 801 891

US Postal Service

Receipt for Certified Mail

No Insurance Coverage Provided.

Do not use for International Mail (See reverse)

| | |
|---|----------------|
| Sent to <i>Altura Energy LTD.</i> | |
| Street & Number <i>P.O. Box 4294</i> | |
| Post Office, State, & ZIP Code <i>Houston, TX 77210</i> | |
| Postage | \$ <i>.99</i> |
| Certified Fee | <i>1.40</i> |
| Special Delivery Fee | |
| Restricted Delivery Fee | |
| Return Receipt Showing to Whom & Date Delivered | |
| Return Receipt Showing to Whom, Date, & Addressee's Address | |
| TOTAL Postage & Fees | \$ <i>2.39</i> |
| Postmark or Date <i>SEP 22 2000</i> | |

Z 437 801 887

US Postal Service

Receipt for Certified Mail

No Insurance Coverage Provided.

Do not use for International Mail (See reverse)

| | |
|---|----------------|
| Sent to <i>New Mexico State Land Office</i> | |
| Street & Number <i>310 Old Santa Fe Trail</i> | |
| Post Office, State, & ZIP Code <i>P.O. Box 1148, Santa Fe, N.M. 87504-1148</i> | |
| Postage | \$ <i>.99</i> |
| Certified Fee | <i>1.40</i> |
| Special Delivery Fee | |
| Restricted Delivery Fee | |
| Return Receipt Showing to Whom & Date Delivered | |
| Return Receipt Showing to Whom, Date, & Addressee's Address | |
| TOTAL Postage & Fees | \$ <i>2.39</i> |
| Postmark or Date <i>SEP 22 2000</i> | |

Z 437 801 890

US Postal Service

Receipt for Certified Mail

No Insurance Coverage Provided.

Do not use for International Mail (See reverse)

| | |
|---|----------------|
| Sent to <i>OLD Resources</i> | |
| Street & Number <i>P.O. Drawer A</i> | |
| Post Office, State, & ZIP Code <i>Monument, N.M. 88265</i> | |
| Postage | \$ <i>.99</i> |
| Certified Fee | <i>1.40</i> |
| Special Delivery Fee | |
| Restricted Delivery Fee | |
| Return Receipt Showing to Whom & Date Delivered | |
| Return Receipt Showing to Whom, Date, & Addressee's Address | |
| TOTAL Postage & Fees | \$ <i>2.39</i> |
| Postmark or Date <i>SEP 22 2000</i> | |

Z 437 801 889

US Postal Service

Receipt for Certified Mail

No Insurance Coverage Provided.

Do not use for International Mail (See reverse)

| | |
|---|----------------|
| Sent to <i>Jimmie T. Cooper</i> | |
| Street & Number <i>P.O. Box 55</i> | |
| Post Office, State, & ZIP Code <i>Monument, N.M. 88265</i> | |
| Postage | \$ <i>.99</i> |
| Certified Fee | <i>1.40</i> |
| Special Delivery Fee | |
| Restricted Delivery Fee | |
| Return Receipt Showing to Whom & Date Delivered | |
| Return Receipt Showing to Whom, Date, & Addressee's Address | |
| TOTAL Postage & Fees | \$ <i>2.39</i> |
| Postmark or Date <i>SEP 22 2000</i> | |

Z 437 801 892

US Postal Service

Receipt for Certified Mail

No Insurance Coverage Provided.

Do not use for International Mail (See reverse)

| | |
|---|----------------|
| Sent to <i>Chevron U.S.A. Inc.</i> | |
| Street & Number <i>P.O. Box 1150</i> | |
| Post Office, State, & ZIP Code <i>Midland, Tx. 79702</i> | |
| Postage | \$ <i>.99</i> |
| Certified Fee | <i>1.40</i> |
| Special Delivery Fee | |
| Restricted Delivery Fee | |
| Return Receipt Showing to Whom & Date Delivered | |
| Return Receipt Showing to Whom, Date, & Addressee's Address | |
| TOTAL Postage & Fees | \$ <i>2.39</i> |
| Postmark or Date <i>SEP 22 2000</i> | |

Z 437 801 895

US Postal Service

Receipt for Certified Mail

No Insurance Coverage Provided.

Do not use for International Mail (See reverse)

| | |
|---|------------------------|
| Sent to | Dryx Energy Co. |
| Street & Number | P.O. Box 2880 |
| Post Office, State, & ZIP Code | Dallas, Tx. 75221-2880 |
| Postage | \$.99 |
| Certified Fee | 1.40 |
| Special Delivery Fee | |
| Restricted Delivery Fee | |
| Return Receipt Showing to Whom & Date Delivered | |
| Return Receipt Showing to Whom, Date, & Addressee's Address | |
| TOTAL Postage & Fees | \$ 2.39 |
| Postmark or Date | APR 22 2000 |

Z 437 801 894

US Postal Service

Receipt for Certified Mail

No Insurance Coverage Provided.

Do not use for International Mail (See reverse)

| | |
|---|------------------------|
| Sent to | Kerr McGee Corporation |
| Street & Number | P.O. Box 1050 |
| Post Office, State, & ZIP Code | Midland, Tx. 79702 |
| Postage | \$.99 |
| Certified Fee | 1.40 |
| Special Delivery Fee | |
| Restricted Delivery Fee | |
| Return Receipt Showing to Whom & Date Delivered | |
| Return Receipt Showing to Whom, Date, & Addressee's Address | |
| TOTAL Postage & Fees | \$ 2.39 |
| Postmark or Date | APR 22 2000 |

PS Form 3800, April 1995

Z 437 801 893

US Postal Service

Receipt for Certified Mail

No Insurance Coverage Provided.

Do not use for International Mail (See reverse)

| | |
|---|-----------------------|
| Sent to | Jack Huff |
| Street & Number | P.O. Box 50120 |
| Post Office, State, & ZIP Code | Midland, Tx. 79702-01 |
| Postage | \$.99 |
| Certified Fee | 1.40 |
| Special Delivery Fee | |
| Restricted Delivery Fee | |
| Return Receipt Showing to Whom & Date Delivered | |
| Return Receipt Showing to Whom, Date, & Addressee's Address | |
| TOTAL Postage & Fees | \$ 2.39 |
| Postmark or Date | APR 22 2000 |

PS Form 3800, April 1995

Z 437 801 743

US Postal Service

Receipt for Certified Mail

No Insurance Coverage Provided.

Do not use for International Mail (See reverse)

| | |
|---|--------------------------|
| Sent to | Exaro Expl. & Prod. Inc. |
| Street & Number | P.O. Box 3109 |
| Post Office, State, & ZIP Code | Midland, Tx. 79702 |
| Postage | \$.99 |
| Certified Fee | 1.40 |
| Special Delivery Fee | |
| Restricted Delivery Fee | |
| Return Receipt Showing to Whom & Date Delivered | |
| Return Receipt Showing to Whom, Date, & Addressee's Address | |
| TOTAL Postage & Fees | \$ 2.39 |
| Postmark or Date | APR 22 2000 |

Z 437 801 742

US Postal Service

Receipt for Certified Mail

No Insurance Coverage Provided.

Do not use for International Mail (See reverse)

| | |
|---|--------------------|
| Sent to | OXY U.S.A. Inc. |
| Street & Number | P.O. Box 50250 |
| Post Office, State, & ZIP Code | Midland, Tx. 79702 |
| Postage | \$.99 |
| Certified Fee | 1.40 |
| Special Delivery Fee | |
| Restricted Delivery Fee | |
| Return Receipt Showing to Whom & Date Delivered | |
| Return Receipt Showing to Whom, Date, & Addressee's Address | |
| TOTAL Postage & Fees | \$ 2.39 |
| Postmark or Date | APR 22 2000 |

PS Form 3800, April 1995

Z 437 801 741

US Postal Service

Receipt for Certified Mail

No Insurance Coverage Provided.

Do not use for International Mail (See reverse)

| | |
|---|-----------------------|
| Sent to | Owens Petroleum, Inc. |
| Street & Number | P.O. Box 2911 |
| Post Office, State, & ZIP Code | Midland, Tx. 79702 |
| Postage | \$.99 |
| Certified Fee | 1.40 |
| Special Delivery Fee | |
| Restricted Delivery Fee | |
| Return Receipt Showing to Whom & Date Delivered | |
| Return Receipt Showing to Whom, Date, & Addressee's Address | |
| TOTAL Postage & Fees | \$ 2.39 |
| Postmark or Date | APR 22 2000 |

PS Form 3800, April 1995

4

WFX-763



STATE OF NEW MEXICO
ENERGY, MINERALS AND NATURAL RESOURCES DEPARTMENT
OIL CONSERVATION DIVISION
HOBBS DISTRICT OFFICE

10/3/00

GOVERNOR

POST OFFICE BOX 1980
HOBBS, NEW MEXICO 88241-1980
(505) 393-6161

OIL CONSERVATION DIVISION
P. O. BOX 2088
SANTA FE, NEW MEXICO 87501

RE: Proposed:
MC _____
DHC _____
NSL _____
NSP _____
SWD _____
WFX X _____
PMX _____

14-N-25-19s-3be
2-B-36-19s-3be
19-C-36-19s-3be

Gentlemen:

I have examined the application for the:

Amerada Hess Corp N Monument GB/SA Unit
Operator Lease & Well No. Unit S-T-R

and my recommendations are as follows:

OK

Yours very truly,

Chris Williams

Chris Williams
Supervisor, District 1

/ed