

CTB
CTB

CORPORATION
P.O. Box 317
Wilmington, Texas 79702

June 24, 1983

Phone (915) 684-7151
Telex 743414

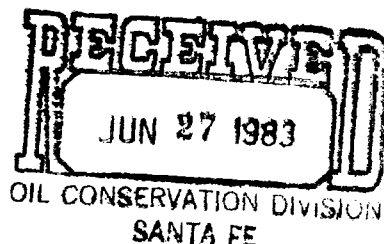

New Mexico Conservation Commission
P. O. Box 2088
Santa Fe, NM 87501

Gentlemen:

Re: Exception to Rule 303-A to Commingle
Production from Warren State & Warren
State "A", Sec. 28, T11S, R33E, Lea
County, New Mexico

Tipperary Oil & Gas Corporation respectfully requests an exception to Statewide Rule 303-A whereby it proposes to commingle production from its Warren State and Warren State "A" leases. Each lease has one well producing from the Pennsylvanian pool. Both these leases produce a 45° gravity pipeline quality crude. I am enclosing a plat along with a schematic of the proposed facilities for this commingling operation. Since there are only two wells involved in this operation, we propose metering production from one of the heater treaters and subtracting that volume from the total volume produced in the stock tanks to determine production from the other well. We also have provided a by-pass downstream of the meter to a separate tank whereby we can periodically check to see that the meter readings are correct.

If you have any questions, please contact me.

Yours very truly,

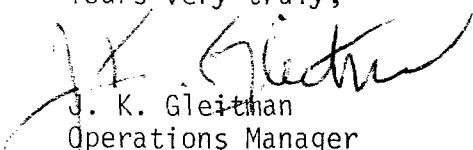
J. K. Gleithan
Operations Manager

JKG:gh

Enclosures: Plat
Schematic diagram

cc: New Mexico Conservation Commission
Box 1980
Hobbs, NM

**NEW MEXICO OIL CONSERVATION COMMISSION
WELL LOCATION AND ACREAGE DEDICATION PLAT**

Form C-102
Supersedes C-128
Effective 1-1-65

All distances must be from the outer boundaries of the Section.

Operator TIPPERARY RESOURCES CORP.			Lease WARREN STATE "A"		Well No. 1
Unit Letter 1	Section 28	Township 11 SOUTH	Range 33 EAST	County LEA	
Actual Footage Location of Well: <div style="display: flex; justify-content: space-between;"> 2125 feet from the SOUTH line and 660 feet from the EAST line </div>					
Ground Level Elev.	Producing Formation		Pool		Dedicated Acreage: Acres

1. Outline the acreage dedicated to the subject well by colored pencil or hatchure marks on the plat below.
2. If more than one lease is dedicated to the well, outline each and identify the ownership thereof (both as to working interest and royalty).
3. If more than one lease of different ownership is dedicated to the well, have the interests of all owners been consolidated by communitization, unitization, force-pooling, etc?

☐ Yes ☐ No If answer is "yes," type of consolidation _____

If answer is "no," list the owners and tract descriptions which have actually been consolidated. (Use reverse side of this form if necessary.) _____

No allowable will be assigned to the well until all interests have been consolidated (by communitization, unitization, forced-pooling, or otherwise) or until a non-standard unit, eliminating such interests, has been approved by the Commission.

RECEIVED
JUN 27 1983

OIL CONSERVATION DIVISION
SANTA FE

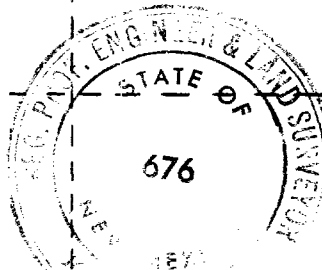

**NOTE: GROUND ELEVATION IS 4.5 FEET LOWER THAN
GROUND AT TIPPERARY AMERADA COM NO. 1 AND
6.8' LOWER THAN TIPPERARY WARREN STATE NO. 1**



CERTIFICATION

I hereby certify that the information contained herein is true and complete to the best of my knowledge and belief.

Name _____

Position _____

Company _____

Date _____

I hereby certify that the well location shown on this plat was plotted from field notes of actual surveys made by me or under my supervision, and that the same is true and correct to the best of my knowledge and belief.

Date Surveyed
OCT. 15, 1969

Registered Professional Engineer
and/or Land Surveyor

Edmund West
Certificate No. **676**



NEW MEXICO OIL CONSERVATION COMMISSION
WELL LOCATION AND ACREAGE DEDICATION PLAT

Form C-102
 Supersedes C-128
 Effective 1-1-65

110385 OFFICE O.C.C.

All distances must be from the outer boundaries of the Section

Operator STOLTZ & CO. - Clark		Lease Warren State JAN 20 1967		Well No. 1
Unit Letter G	Section 28	Township 11 SOUTH	Range 33 EAST	County LEA
Actual Footage Location of Well: 1980 feet from the NORTH line and 1980 feet from the EAST line				
Ground Level Elev.	Producing Formation Upper Penn	Pool Undes. North Bagley	Dedicated Acreage: 80 Acres	

1. Outline the acreage dedicated to the subject well by colored pencil or hachure marks on the plat below.
2. If more than one lease is dedicated to the well, outline each and identify the ownership thereof (both as to working interest and royalty).
3. If more than one lease of different ownership is dedicated to the well, have the interests of all owners been consolidated by communitization, unitization, force-pooling, etc?

☐ Yes ☐ No If answer is "yes," type of consolidation _____

If answer is "no," list the owners and tract descriptions which have actually been consolidated. (Use reverse side of this form if necessary.) _____

No allowable will be assigned to the well until all interests have been consolidated (by communitization, unitization, forced-pooling, or otherwise) or until a non-standard unit, eliminating such interests, has been approved by the Commission.

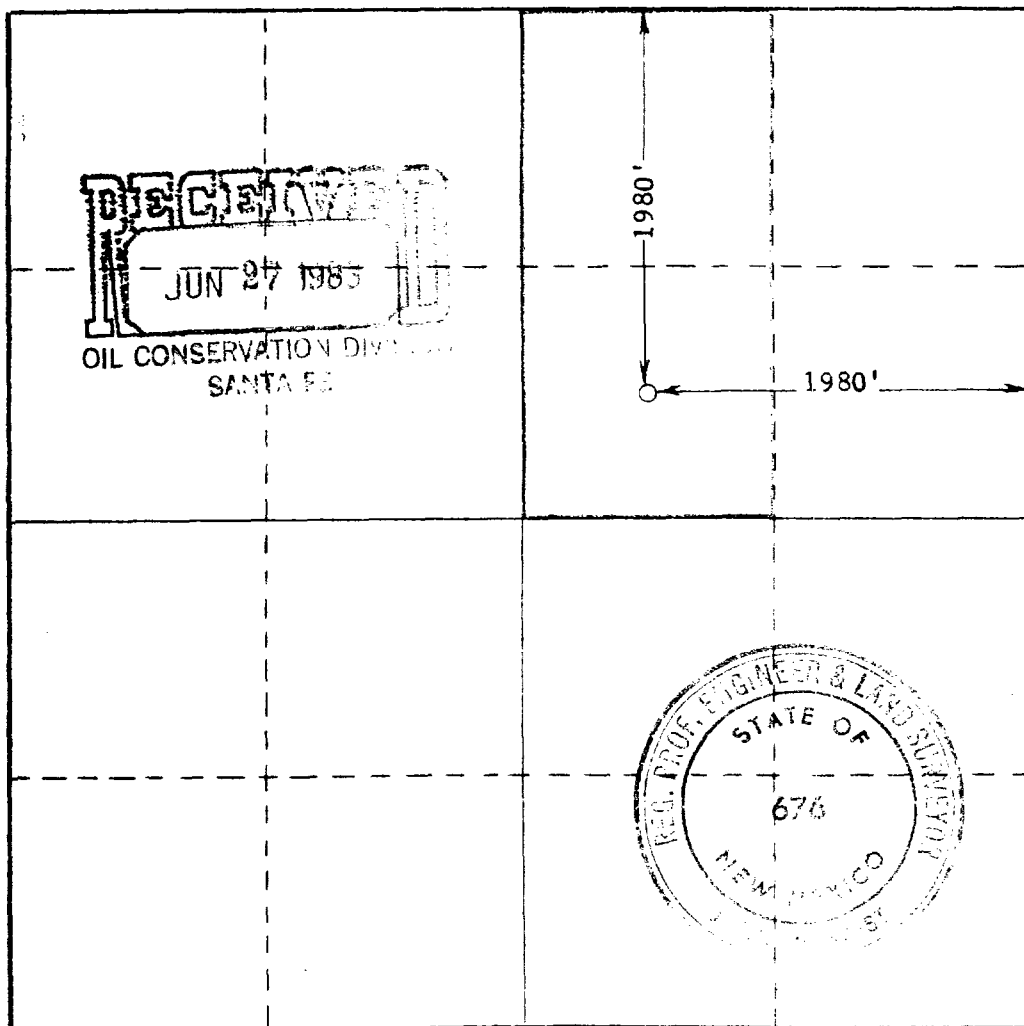

CERTIFICATION

I hereby certify that the information contained herein is true and complete to the best of my knowledge and belief.

Name *H. L. Smith*

Position
Agent

Company
Stolts & Co. - Clark

Date
January 20, 1967

I hereby certify that the well location shown on this plat was plotted from field notes of actual surveys made by me or under my supervision and that the same is true and correct to the best of my knowledge and belief.

JAN 1967
RECEIVED
STOLTZ & CO.
 1-20-67

Date Surveyed
1-20-67

Registered Professional Engineer and/or Land Surveyor
John West

