

OIL CONSERVATION COMMISSION

P. O. BOX 2088

SANTA FE, NEW MEXICO 87501

April 24, 1968

C
Midwest Oil Corporation
1500 Wilco Building
Midland, Texas

Attention: Mr. W. E. Wittenburg

O
Administrative Order OLS-64

Gentlemen:

P
Reference is made to your application dated March 19, 1968, for an exception to Rule 309-A of the Commission Rules and Regulations to permit off-lease storage for your Roy Epperson "A" Lease which comprises the N/2 SE/4 of Section 23, Township 11 South, Range 33 East, Inbe Permo-Pennsylvanian Pool, Lea County, New Mexico. It is our understanding that the tank battery for this lease would be in Unit P of Section 23 on your Roy Epperson Lease.

Y
Pursuant to the authority granted me by Rule 309-C of the Commission Rules and Regulations, Midwest Oil Corporation is hereby authorized off-lease storage as described above, provided that there shall be no intercommunication of the handling, separating, treating, or storage facilities designated to each lease.

Your application for off-lease storage for your State "O" Lease in Section 26 immediately south of the Epperson Lease is still being held pending receipt of filing fees by the State Land Office and approval of the off-lease storage by them.

Very truly yours,

A. L. PORTER, Jr.
Secretary-Director

ALP/DSN/esr

cc: Oil Conservation Commission - Hobbs
Oil & Gas Engineering Committee - Hobbs
State Land Office - Santa Fe

Enclosure

cc: Commissioner of Public Lands

OIL CONSERVATION COMMISSION

P. O. BOX 2088

SANTA FE, NEW MEXICO 87501

MIDWEST OIL CORPORATION

1500 WILCO BUILDING

MIDLAND, TEXAS

GENERAL OFFICES
1700 BROADWAY
DENVER 2, COLORADO

DIVISION OFFICE
1200 CONTINENTAL NATIONAL
BANK BUILDING
FORT WORTH 2, TEXAS

March 19, 1968

Oil Conservation Commission
P. O. Box 1980
Hobbs, New Mexico 88240

In Re: Exception to Rule 309-A
Midwest Oil Corporation
Roy Epperson 'A' No. 1
Inbe (Permo Penn)
Lea County, New Mexico

Gentlemen:

Midwest Oil Corporation hereby requests an exception to Rule 309-A to permit off-lease storage of production from our Roy Epperson 'A' No. 1 which was drilled 1980' FSL & 510' FEL of Sec. 23, T-11-S, R-33-E, Lea County, New Mexico.

Service Pipeline has requested that we locate the above mentioned storage at the same site as our Roy Epperson Battery: which is in SE/4 of SE/4 of Sec. 23, T-11-S, R-33-E, Lea County, New Mexico. These batteries will be separate and production will not be commingled.

The attached lease plat shows wells and producing formations as well as the proposed location for the off-lease storage.

If further information is needed please advise.

Yours very truly,

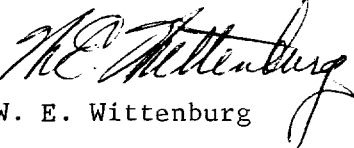
W. E. Wittenburg

WEW/jrs

Enclosure

cc: Commissioner of Public Lands

68 MAR 22 AM 8 33

R-33-E

T
II
S

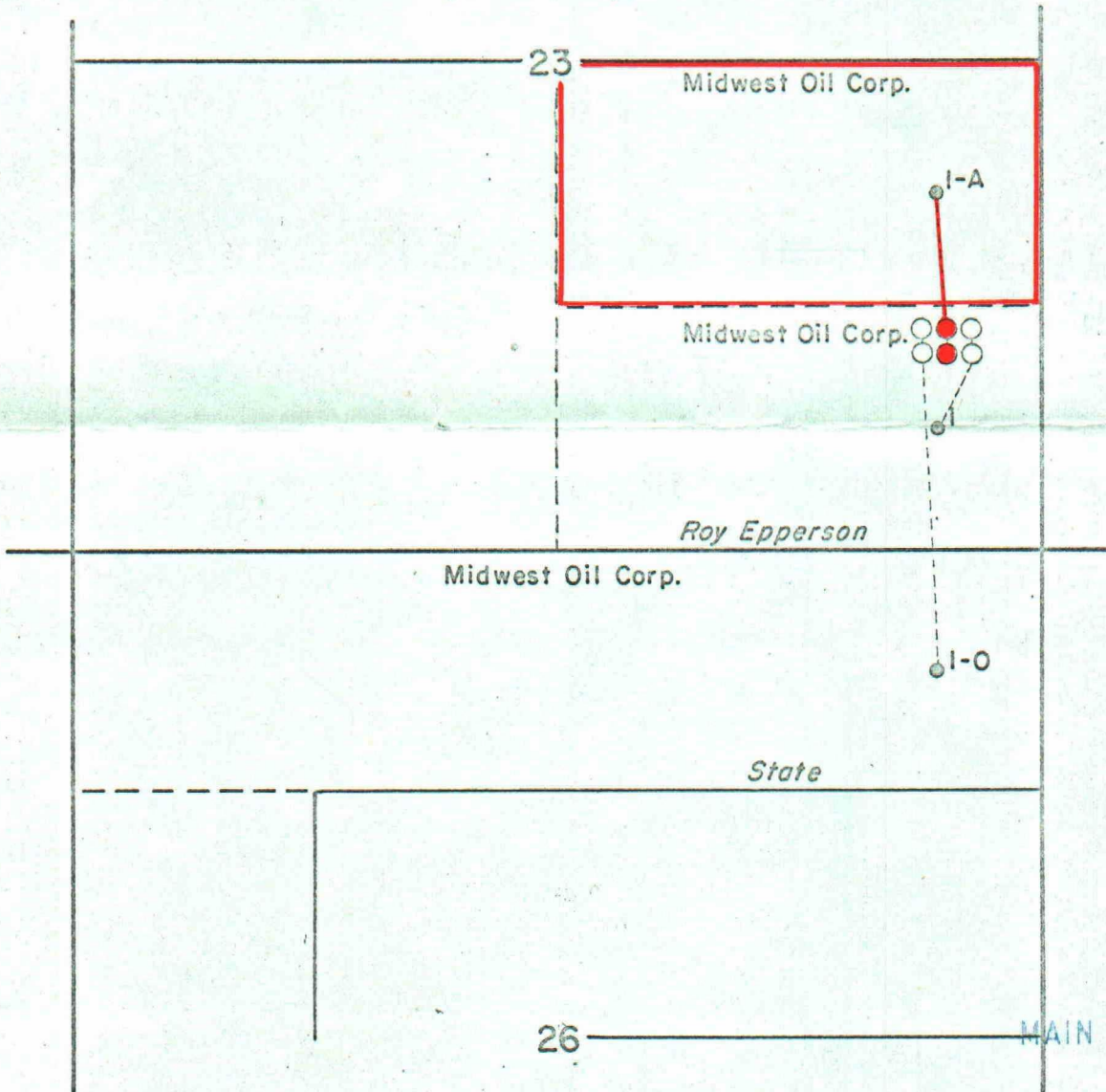

MAIN OFFICE OF
'68 MAR 22 AM 8 33

MIDWEST OIL CORPORATION
MIDLAND, TEXAS

STATE "O" & EPPERSON
LEASES

LEA COUNTY, NEW MEXICO

LOCATION OF WELLS
AND TANK BATTERY

Scale: 1" = 1000'

Mar. 18, 1968

n.f.g.