

# PAN AMERICAN PETROLEUM CORPORATION

Post Office Box 68  
Hobbs, New Mexico

October 10, 1968

File: VES-402-541.111 x 400

Subject: Commingle of Production  
GILLULLY "B" Federal Lease  
Lea County, New Mexico

New Mexico Oil Conservation Commission  
P. O. Box 2088  
Santa Fe, New Mexico 87501

*done*  
*File 12-111*

Gentlemen:

Our letter dated September 25, 1968, File: VES-379-541.111 x 400, Subject: as above, requested amendment to Administrative Order PC-111 to permit the commingling of WEIR Drinkard production from Well 13 with production from other pools on the same lease.

Subsequent to submission, it has been determined that there is no need for the retention of the MONUMENT (GSA) Pool authority, and we hereby request that it be deleted from Order PC-111.

Attached is a copy of the U.S. Geological Survey's authority to commingle the WEIR Drinkard.

Yours very truly,



V. E. Staley  
Area Superintendent

RRY/jt

cc: NMOCC-Hobbs  
Shell Pipe Line Corp. - Midland  
Pan American Petroleum Corp, Oil and Gas Purchases, Midland, Texas

Attachment

*40 Oct 11*



UNITED STATES  
DEPARTMENT OF THE INTERIOR  
GEOLOGICAL SURVEY

Drawer 1857  
Roswell, New Mexico

RECEIVED	
88201	
PAN AMERICAN	
PETROLEUM CORP.	
OCT 9 1968	
HOBBS, N. M.	
AS	
AC	
AE	
AF1	
AF2	
AAC	
EX43	
FILE	

October 8, 1968

Pan American Petroleum Corporation  
P. O. Box 68  
Hobbs, New Mexico 88240

Attention: Mr. V. E. Staley

Gentlemen:

Your letter of September 25 requests approval to modify the commingling system approved by our letter of September 3, 1968, for that portion of lease Las Cruces 031736(b) in the NE $\frac{1}{4}$  sec. 21 and the NW $\frac{1}{4}$ , NW $\frac{1}{4}$ NE $\frac{1}{4}$ , and NW $\frac{1}{4}$ SE $\frac{1}{4}$  sec. 22, T. 20 S., R. 37 E., Lea County, New Mexico. You propose to add Weir Drinkard pool production from well No. 13, in the SW $\frac{1}{4}$ NE $\frac{1}{4}$  sec. 22, to presently commingled Monument Grayburg-San Andres pool, Weir Blinebry pool, Monument Tubb pool, and Cass Pennsylvanian pool production.

The system for commingling described by the diagram attached to your letter is hereby approved. The addition of any other well to the system or any other change in the system must receive prior approval from this office.

Please notify our Hobbs office when the installation is completed so that a field inspection of the system can be made.

Sincerely yours,

*Eddie R. Wyatt*

EDDIE R. WYATT  
Acting Oil and Gas Supervisor

30 OCT 11 1968

# PAN AMERICAN PETROLEUM CORPORATION

Post Office Box 68  
Hobbs, New Mexico

September 25, 1968

File: VES-379-541.111 x 400

Subject: Commingling of Production  
Gillully "B" Federal Lease  
Lea County, New Mexico

New Mexico Oil Conservation Commission (2)  
P. O. Box 2088  
Santa Fe, New Mexico 87501

Gentlemen:

Our letter dated August 26, 1968, File: VES-341-541.112 x 400, Subject: same as above, requested amendment to Administrative Order PC-111 to permit the commingling of production from the Gillully "B" Federal Well No. 12, Cass Penn Oil Pool, with production from the Monument, Monument Tubb, and Weir Blinebry Oil Pools.

Subsequent to the above date, the Gillully "B" Federal Well No. 13, located in Unit G, Section 22, T-20-S, R-37-E, has been completed as a marginal oil producer in the Weir Drinkard Oil Pool. On potential test the well pumped and flowed 70 BO and 236 BW in 24 hours, CGR 34.

It is respectfully requested that further consideration be given to the Amendment of Administrative Order PC-111, providing for the commingling of the Weir Drinkard production with the other pools' production being commingled into our Gillully "B" Federal Commingled Battery No. 2, located in the SW/4 NE/4 of Section 21, T-20-S, R-37-E.

For all practical purposes the actual commercial value of the total commingled production shall remain approximately the same with no loss in revenue being sustained.

A plat of the Gillully "B" Federal Lease showing all wells and the formation in which completed, and a schematic diagram of the proposed commingling facilities are attached.

Yours very truly,

V. E. Staley  
Area Superintendent

RRY/jt

cc: U.S.G.S. (2) - Hobbs, New Mexico  
N.M.O.C.C. - Hobbs



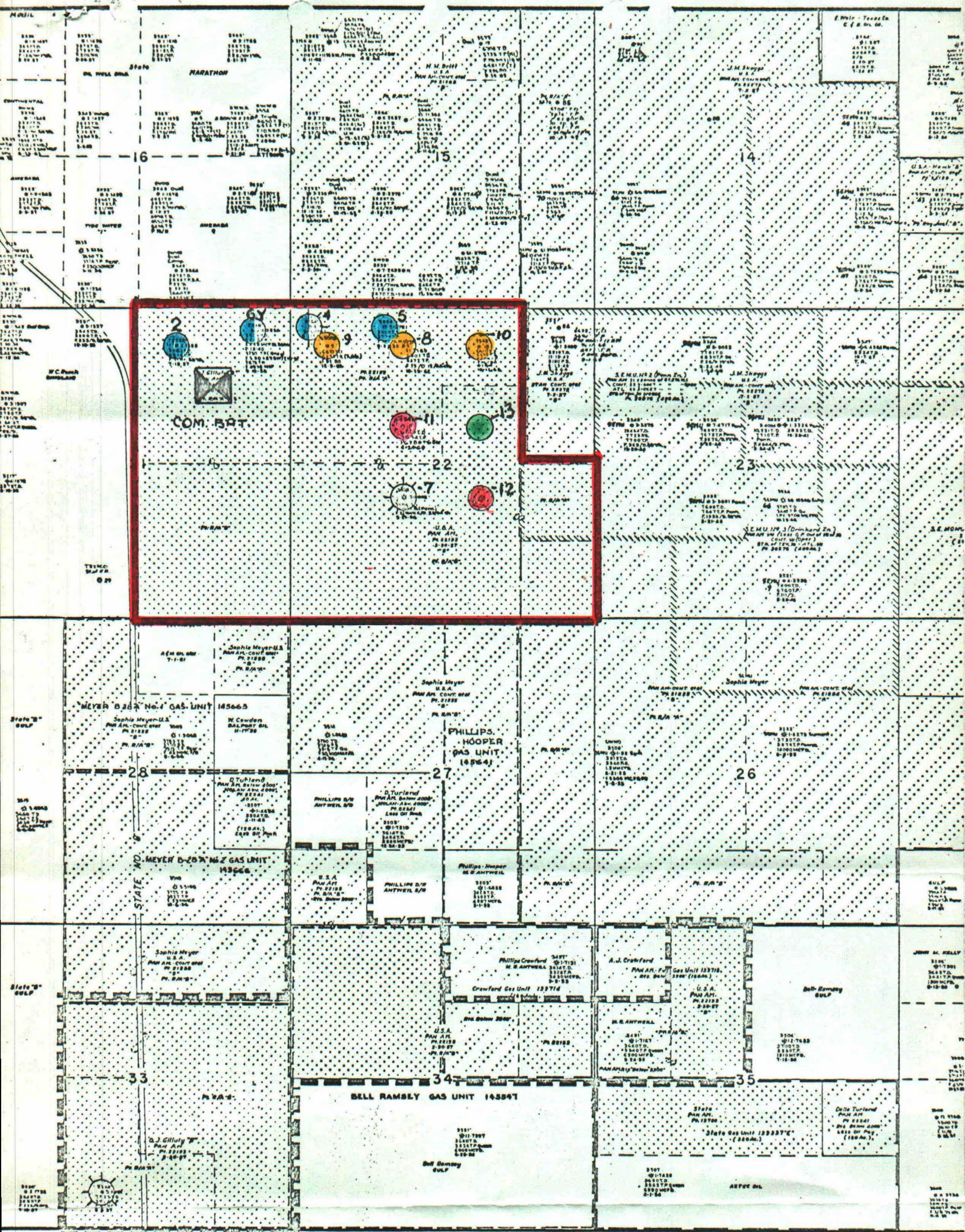

R-37-E



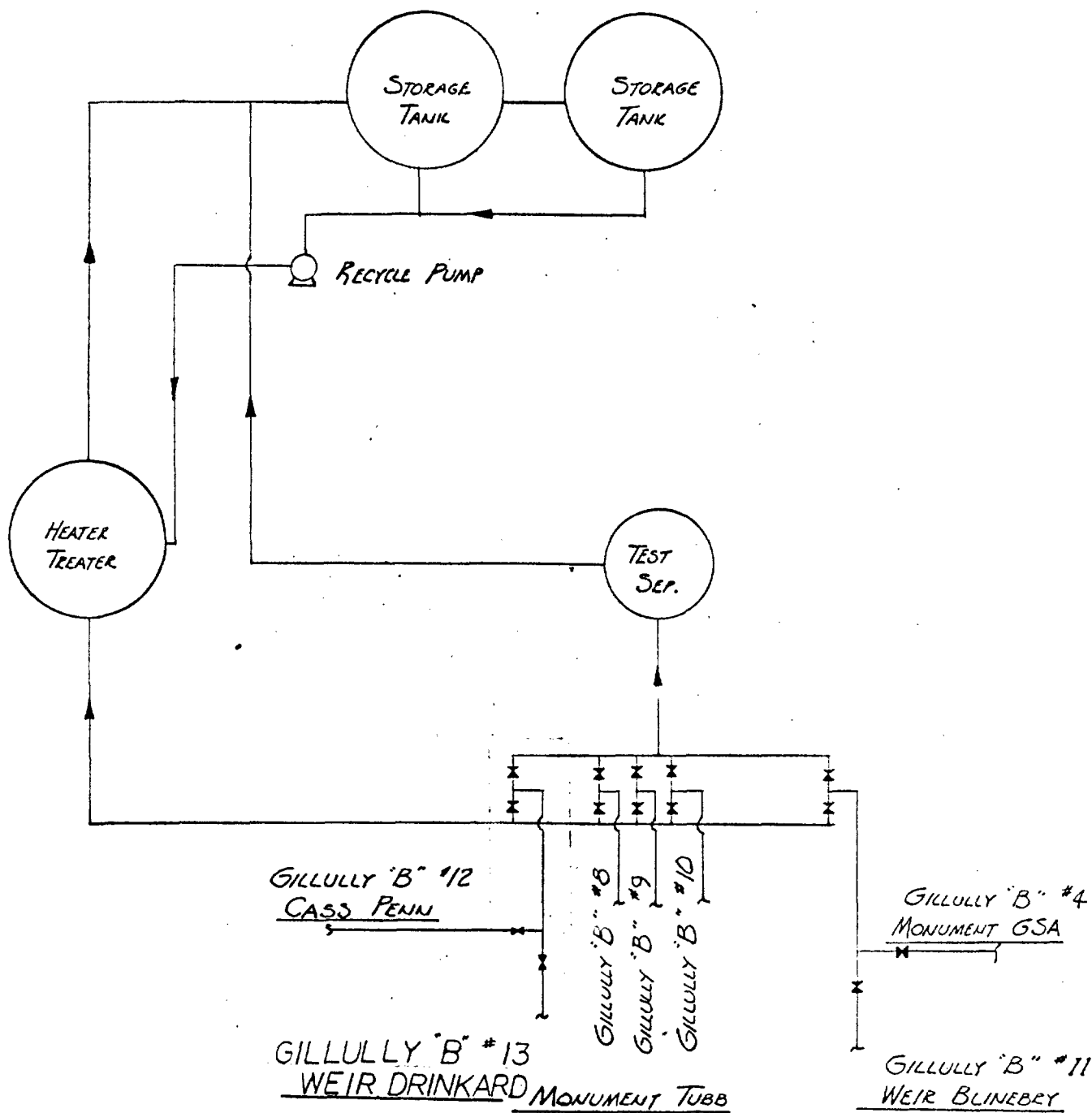

PAN AMERICAN PETROLEUM CORPORATION

SCALE: NONE

PROPOSED COMMINGLING INSTALLATION - GILLULLY 'B' LEASE BATTERY  
 SW/4 OF NE/4 SECT. 21 T-20-S R-35-E LEA COUNTY N.MEX.

DRG.  
 NO.

8/26/65