

SUNSET INTERNATIONAL PETROLEUM CORPORATION
TWO-O-ONE WALL BUILDING • SUITE 308
MIDLAND, TEXAS 79701

1 March 27, 1967

PC-320?

RECEIVED
MAR 30 AM 8 15

Oil Conservation Commission
State of New Mexico
P. O. Box 871
Santa Fe, New Mexico

Re: T. P. "A" State Lease
State No. OG-260
Sec. 10-11S-33E
Lea County, N. M.

Gentlemen:

Sunset International Petroleum Corporation requests permission to commingle oil on subject lease. The oil will be produced from the two zones and metered before going to common storage for sale.

The T. P. "A" State #1 well is producing in the North Bagley Pool from the Middle Pennsylvanian zone at a depth of 9889-98 feet or (-5637).

The T. P. "A" State #2 well is producing in the North Bagley Pool from the Lower Pennsylvanian zone at a depth of 10,110 to 10,154 or (-5877).

The mineral ownership for both zones is identical.

Attached to this application are waivers of objection from the other mineral owners and from the State Land Commission, a diagrammatical sketch of the lease installation, data relative to the two zones and plat of lease showing wells on the lease.

Yours very truly,

M. M. Frazier
M. M. Frazier
Petroleum Engineer
West Texas Area

MMF:mmm

March 21, 1967

Commissioner of Public Lands
State of New Mexico
Santa Fe, New Mexico

Attention: Mr. Guyton B. Hays

Re: T. P. "A" State Lease
State No. OG-260
Section 10, 11S, 33E
Lea County, New Mexico

Dear Sir:

Sunset International Petroleum Corporation is preparing an application for a commingling permit for the subject lease. Your consent is required since this is a state lease.

The T. P. "A" State #1 well is producing in the North Bagley Pool from the Middle Pennsylvanian zone at a depth of 9889-98 feet or (-5637).

The T. P. "A" State No.2 well is producing in the North Bagley Pool from the Lower Pennsylvanian zone at a depth of 10,110 to 10,154 feet or (-5877).

The production from the #2 well is metered through a Liqua-Meter unit before it is stored in a common storage tank with the production from the #1 well.

Attached is a diagrammatic sketch of the equipment being used to keep separate production figures from the two zones.

The mineral ownership for both zones is identical. If you consent to this application, approval of which will save the investment in another complete metering battery, please sign in the space below and return one copy at once.

Sincerely,

S. L. Parks

SLP:mmm

Approved

Guyton B. Hays
by Ted Balberg

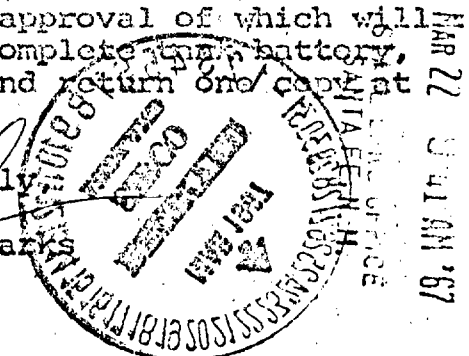

SUNSET International Pet. Corp.
T.P.A. State Lease.
S.E. 1/4 Sec 10 T11S R33E

3

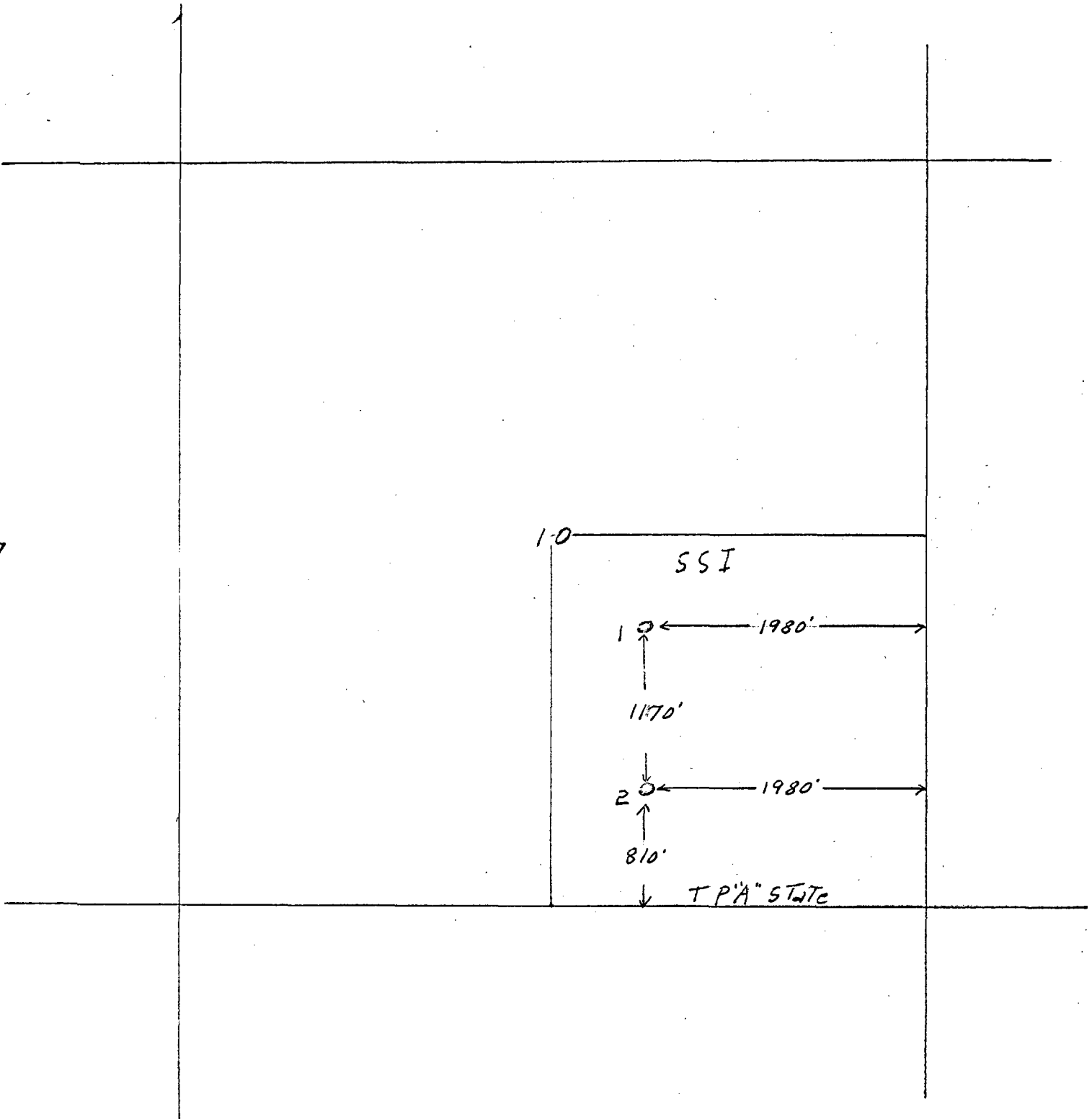

15

TEXAS PACIFIC OIL COMPANY

P. O. Box 4067
Midland, Texas 79701

March 21, 1967

Sunset International Petroleum Corp.
201 Wall Building
Midland, Texas

Attention: Mr. M. M. Frazier

Subject: Approval of meter TP "A" State lease, Section 10
T-11-S R-33-E Lea County, New Mexico

Gentlemen:

Reference made to your letter of March 20 requesting approval of the metering arrangement in conjunction with the commingling production from TP "A" State No. 1 and TP "A" State No. 2 wells subject lease.

Attached herewith is our approval pursuant to your request. This approval is given with the understanding that the meter will be kept in constant calibration and that TP will be permitted to verify calibration of the meter at such reasonable times as it may elect.

Yours very truly,

Frank A. Bolen

lg1
attachment

SUNSET INTERNATIONAL PETROLEUM CORPORATION
TWO-O-ONE WALL BUILDING • SUITE 308
MIDLAND, TEXAS 79701

March 20, 1967

Texas Pacific Oil Company
P. O. Box 4067
Midland, Texas

Attention: Mr. Frank Bolen

Re: T. P. "A" State Lease
State No. OG-260
Section 10, 11S, 33E
Lea County, New Mexico

Dear Sir:

Sunset International Petroleum Corporation requests
a comingling permit for the subject lease.

The T. P. "A" State #1 well is producing in the North
Bagley Pool from the Middle Pennsylvanian zone at a
depth of 9889-98 feet or (-5637).

The T. P. "A" State No. 2 well is producing in the
North Bagley Pool from the Lower Pennsylvanian zone
at a depth of 10,110 to 10,154 feet or (-5877).

The production from the #2 well is metered through a
Liqua-Meter unit before it is stored in a common stor-
age tank with the production from the #1 well.

Attached is a diagrammatic sketch of the equipment being
used to keep separate production figures from the two
zones.

The mineral ownership for both zones is identical.

Please signify your approval in the space below and
return one copy at once.

Yours very truly,

M. M. Frazier
M. M. Frazier
Petroleum Engineer
West Texas Area

APPROVED BY:

Texas Pacific Oil Company

SUNSET INTERNATIONAL PETROLEUM CORPORATION
TWO-O-ONE WALL BUILDING • SUITE 308
MIDLAND, TEXAS 79701

March 20, 1967

Messrs Montgomery & Merren
214 West Building
Midland, Texas

Re: T. P. "A" State Lease
State No. OG-260
Section 10, 11S, 33E
Lea County, New Mexico

Gentlemen:

Sunset International Petroleum Corporation requests a comingling permit for the subject lease.

The T. P. "A" State #1 well is producing in the North Bagley Pool from the Middle Pennsylvanian zone at a depth of 9889-98 feet or (-5637).

The T. P. "A" No. 2 well is producing in the North Bagley Pool from the Lower Pennsylvanian zone at a depth of 10,110 to 10,154 feet or (-5877).

The production from the #2 well is metered through a Liqua-Meter unit before it is stored in a common storage tank with the production from the #1 well.

Attached is a diagrammatic sketch of the equipment being used to keep separate production figures from the two zones.

The mineral ownership for both zones is identical.

Please signify your approval in the space below and return one copy at once.

Yours very truly,

M. M. Frazier
M. M. Frazier
Petroleum Engineer
West Texas Area

APPROVED BY:

W. C. Montgomery
W. C. Montgomery
Kem Merren
Kem Merren

Diagrammatical Sketch of
T. P. "A" State Lease Installation

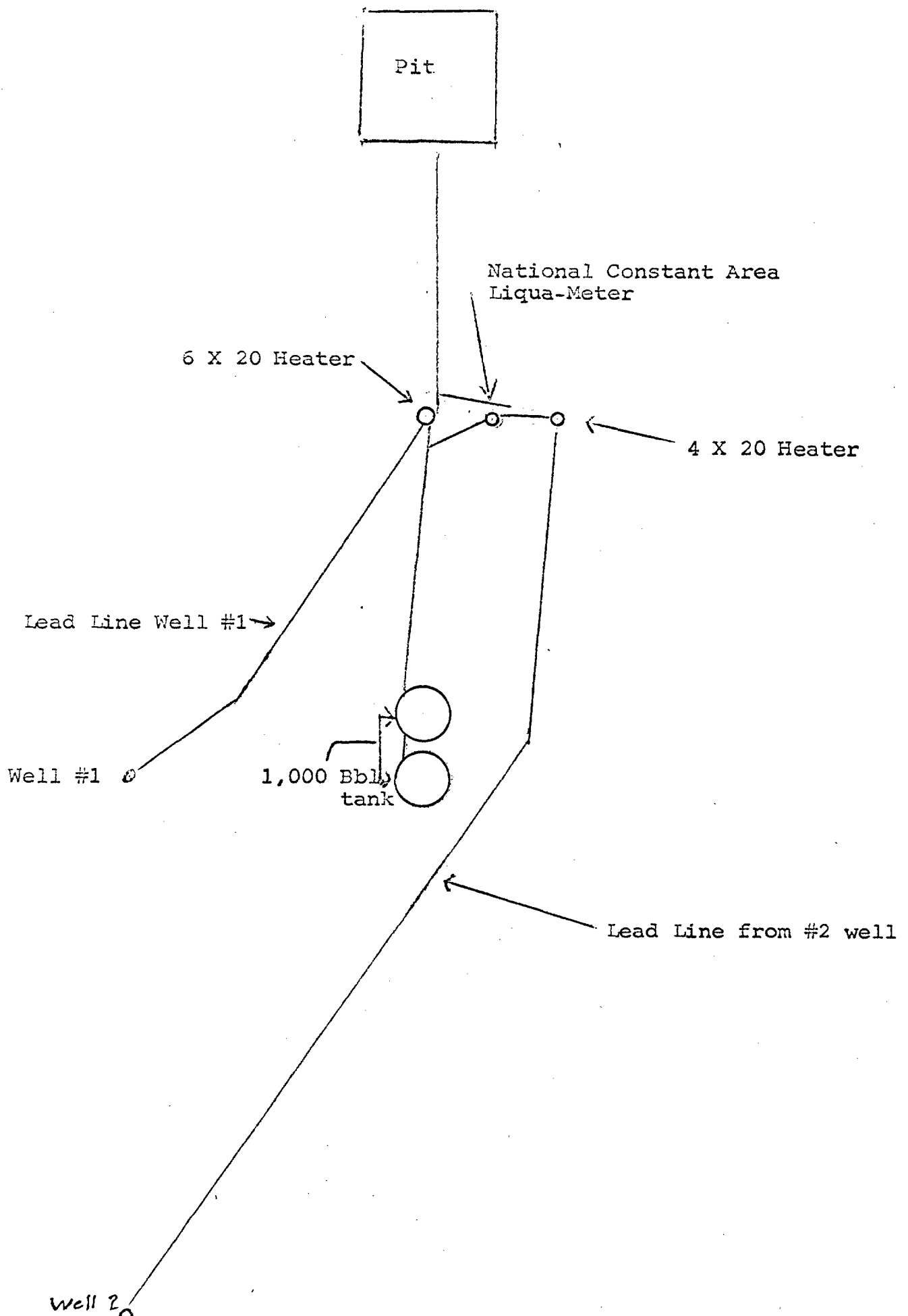

DATA SHEET

	<u>T. P. "A" #1</u>	<u>T. P. "A" State #2</u>
Gravity Oil	46.9 @ 60°	46.6 @ 60°
Value of Oil	\$3.02/Bbl	\$3.02/bbl
Est. Oil Prod.	249 BOPD	234 BOPD
Production zone	M. Penn	L. Penn
Gravity Comingled Oil	46.8	
Value of Comingled Oil	\$3.02/Bbl	

The actual value of the comingled production will be the same value and gravity as be for comingling.

MEF

