



Amoco Production Company

Post Office Box 68
Hobbs, New Mexico 88240

S. J. Okerson
District Superintendent

September 9, 1980

File: SJ0-986.51 x WF-1143

Re: Request Amendment to
Order R-1905 and
Administrative Order PC-394
Grizzell "B" Battery

State of New Mexico
Energy and Minerals Department
Oil Conservation Department
P. O. Box 2088
Santa Fe, NM 87501

Gentlemen:

Amoco Production Company requests an amendment to Order R-1905 and Administrative Order PC-394 to provide for the addition of Drinkard production from our Grizzell "B" Well No. 4 into our Grizzell "B" Commingle Battery. The Battery is located in Unit G, SW/4 NE/4, Section 8, T-22-S, R-37-E. A schematic of the facility and a plat depicting the lease and wells involved are attached.

Our Grizzell "B" Well No. 4, located 1838' FNL and 1750' FEL, Section 8, T-22-S, R-37-E, Lea County, New Mexico, was completed on June 20, 1980, as a pumping oil well in the Und. Drinkard Oil pool and commenced production on that day. Oil and gas production from Grizzell "B" Well No. 4 will be allocated back on the basis of well tests. Production from the Paddock and Blinebry is being allocated based on well tests and production from the Fusselman is being metered seperately.

Yours very truly,

Attachments

cc: NMOCD
Hobbs, NM

E. D. Newman
Houston, TX



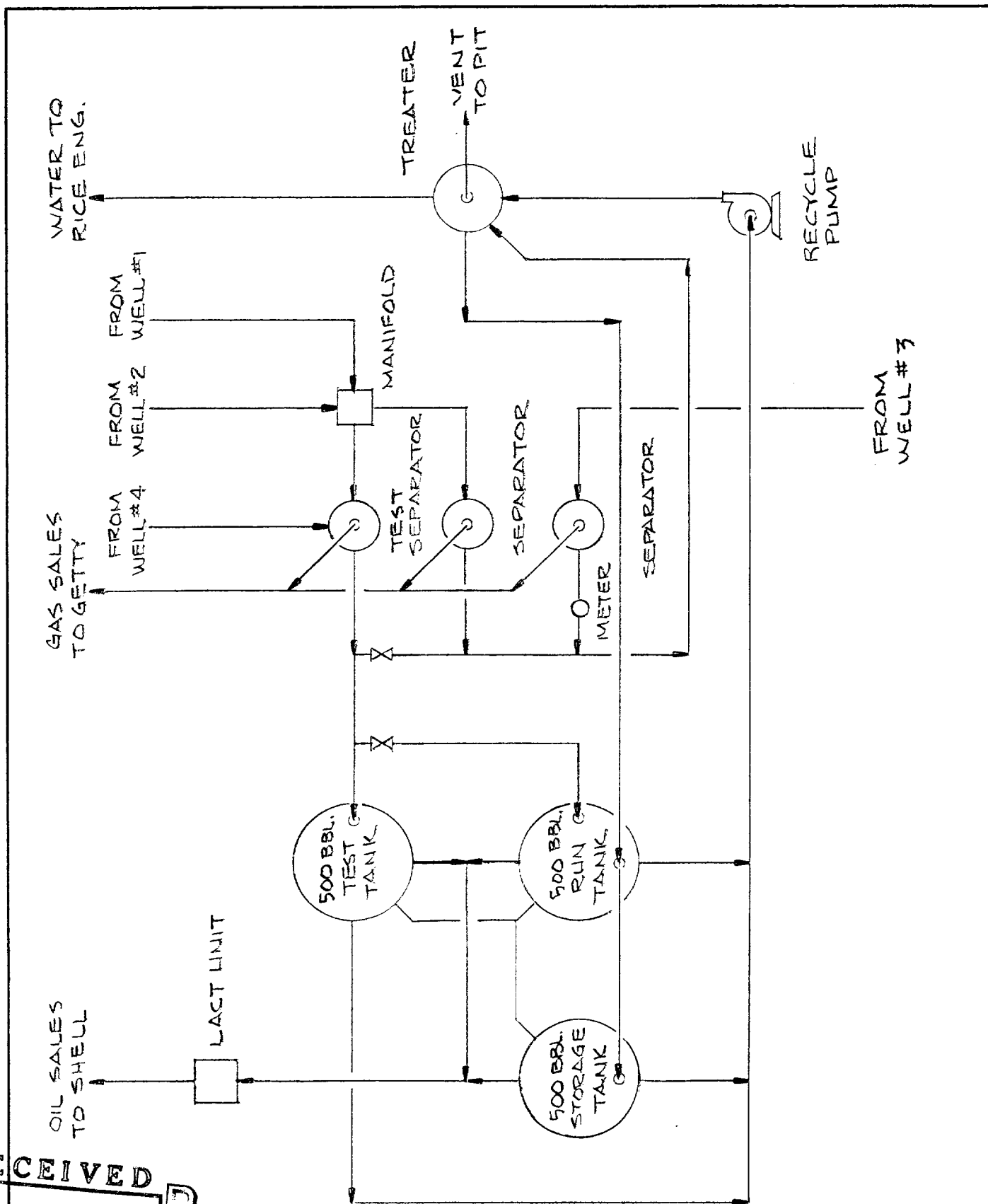

RECEIVED
SEP 13 1980

OIL CONSERVATION DIVISION
 SANTA FE

Amoco Production Company	SCALE: NONE
SCHMATIC DIAGRAM	9-9-80 R.H.
GRIZZELL 'B' BATTERY	DRG. NO. _____

ENGINEERING CHART
(TRACING)

FILE

APPN.

DATE

BY

SUBJECT Location of Wells On Grizzell B Lease

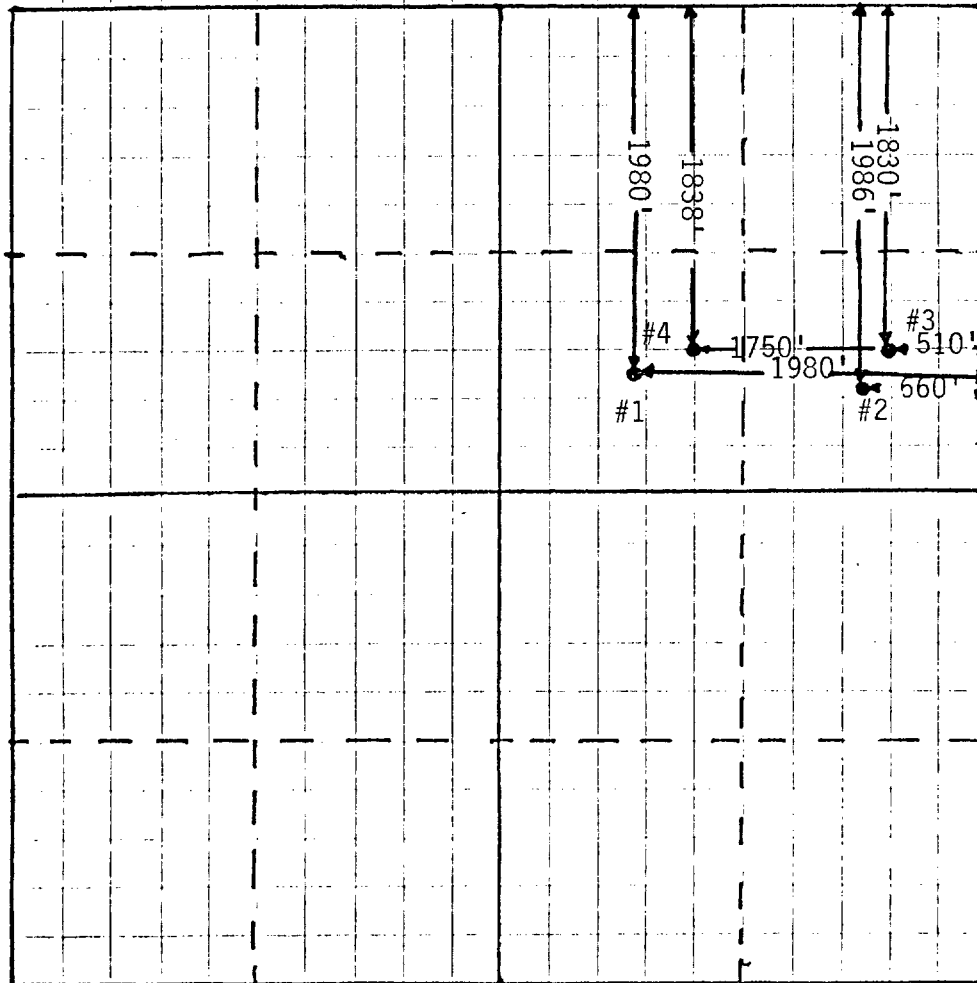

Grizzell B #1 1980' FNL & 1980' FEL , Sec. 8, T-22-S R-37-E
Grizzell B #2 1986' FNL & 660' FEL , Sec. 8, T-22-S R-37-E
Grizzell B #3 1830' FNL & 510' FEL , Sec. 8, T-22-S R-37-E
Grizzell B #4 1838' FNL & 1750' FEL , Sec. 8, T-22-S R-37-E

RECEIVED
SEP 16 1980OIL CONSERVATION DIVISION
SANTA FE