

North American Producing Division
Permian District — West Area
Post Office Box 1978
Roswell, New Mexico 88201
Telephone 505 622 4041

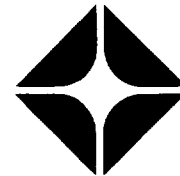

RECEIVED

MAR 7 1972

March 3, 1972

New Mexico Oil Conservation Commission
P. O. Box 2088
Santa Fe, New Mexico 87501

Attention: Mr. A. L. Porter, Jr.

Re: Atlantic Richfield - Friess Federal
Commingling (LC-060409)

Gentlemen:

The Atlantic Richfield Company respectfully requests permission to surface commingle production on its newly acquired Friess Federal lease, Eddy County, New Mexico (LC-060409). Of the three wells on the lease two, No. 2 and No. 3, are completed in the Grayburg-Jackson pool and one, No. 1, is completed in the Fren-Seven Rivers pool. All are marginal producers.

The gravity of the Grayburg crude is 37° API, and the gravity of the Fren crude is 34.6° API, both at 60°F; therefore, the expected gravity of the commingled crude would be 36.6° API at 60°F.

We acquired the lease as of March 1, 1972, from Kennedy Oil Company. The production is commingled and the commingling order cannot be located; therefore, we have the No. 1 well (Fren-Seven Rivers) shut in. We have received verbal approval from the U.S.G.S. to commingle.

I have included production history for each well since January 1, 1970, a schematic of the battery, and a lease plat.

Very truly yours



J. V. Curfew

JVC:rhs
Attachs.

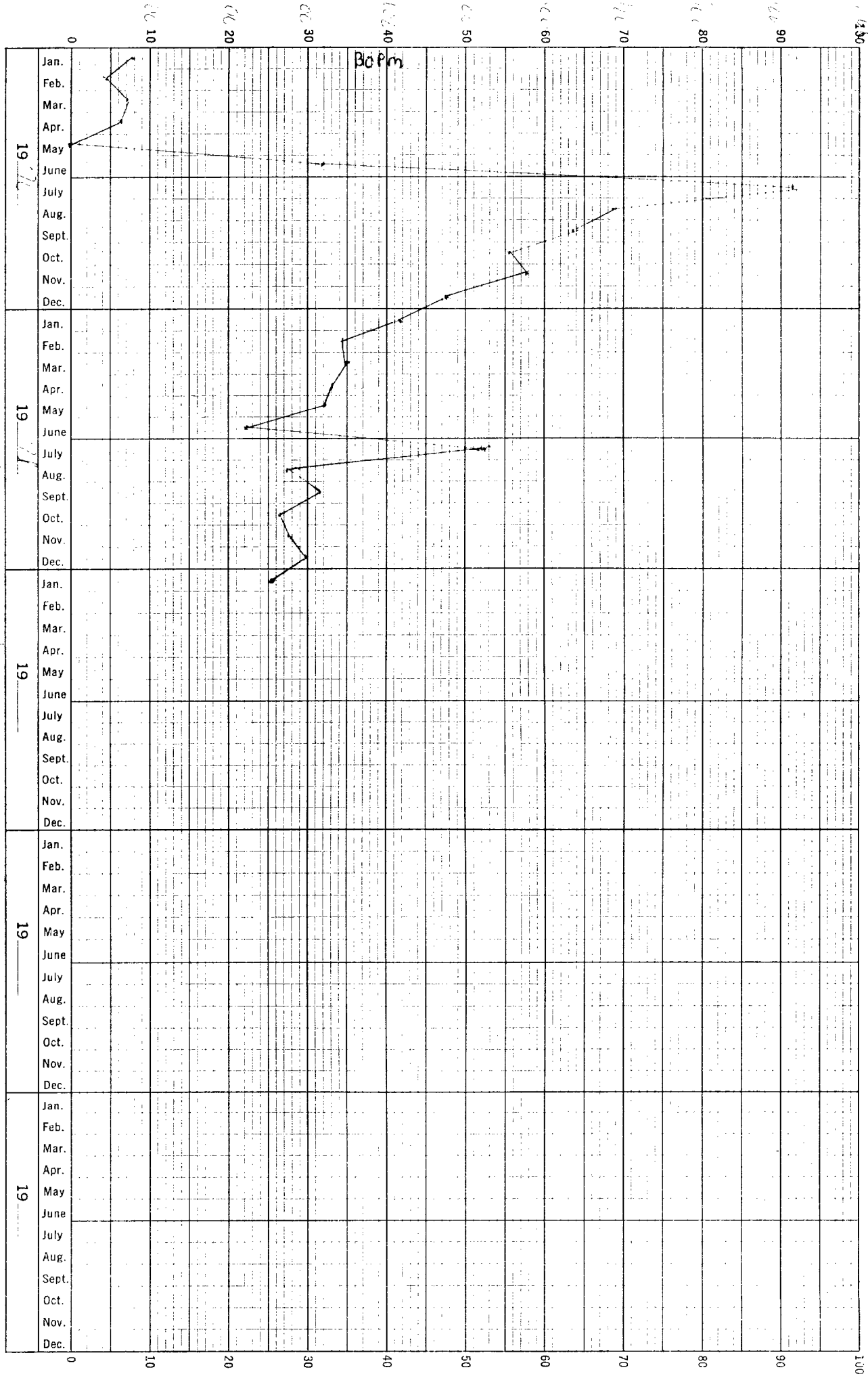
cc: Mr. W. P. Tomlinson - Midland
Mr. D. L. Wright - Roswell
Mr. A. D. Kloxin - Roswell

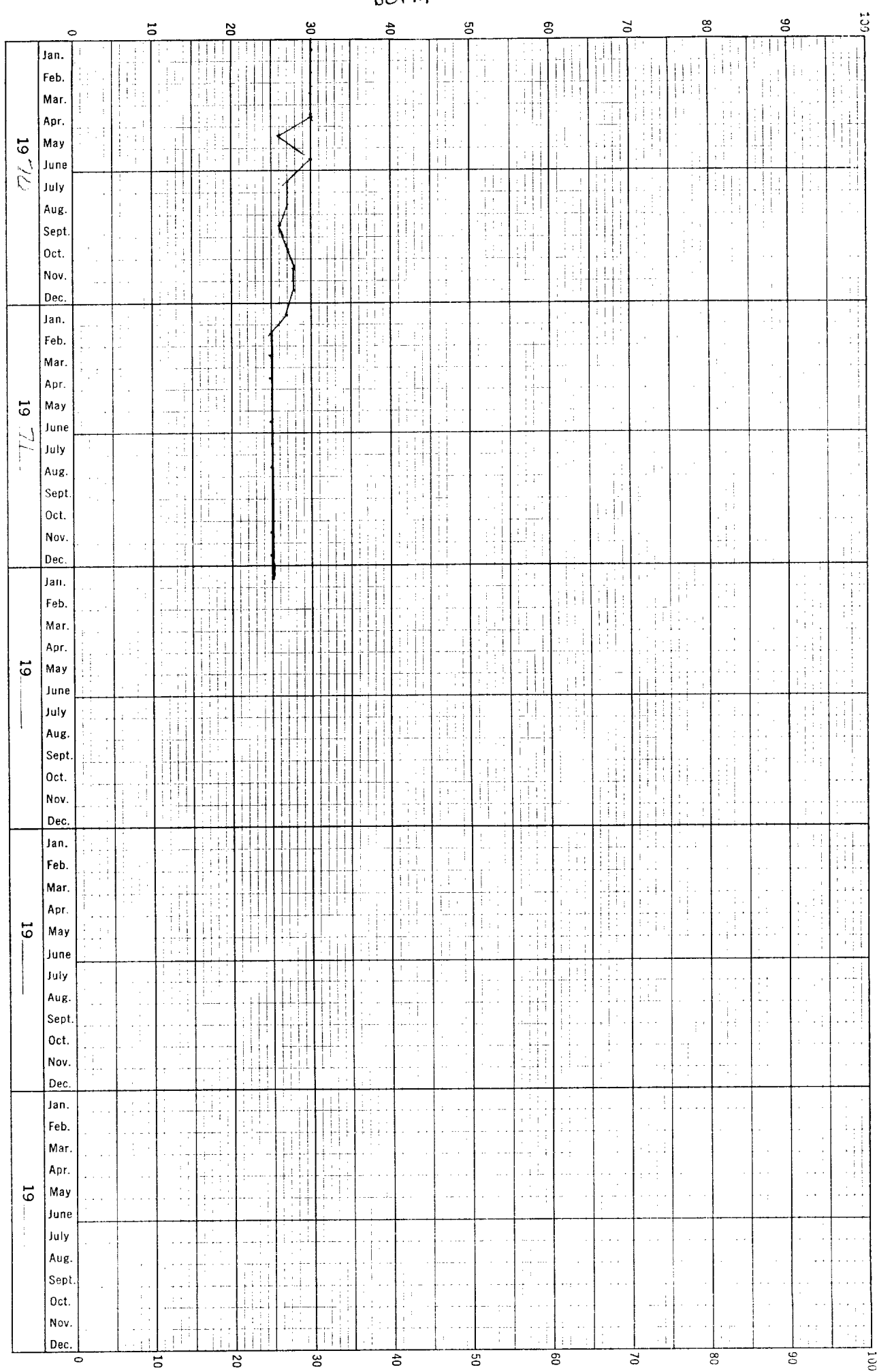

Handwritten notes:
 1971
 1972
 1973
 1974
 1975



Price Journal #1 - New York
 Madison

[illegible]

J. Lang National 3624999
 1116 National 14176 & 14171

T
17
S

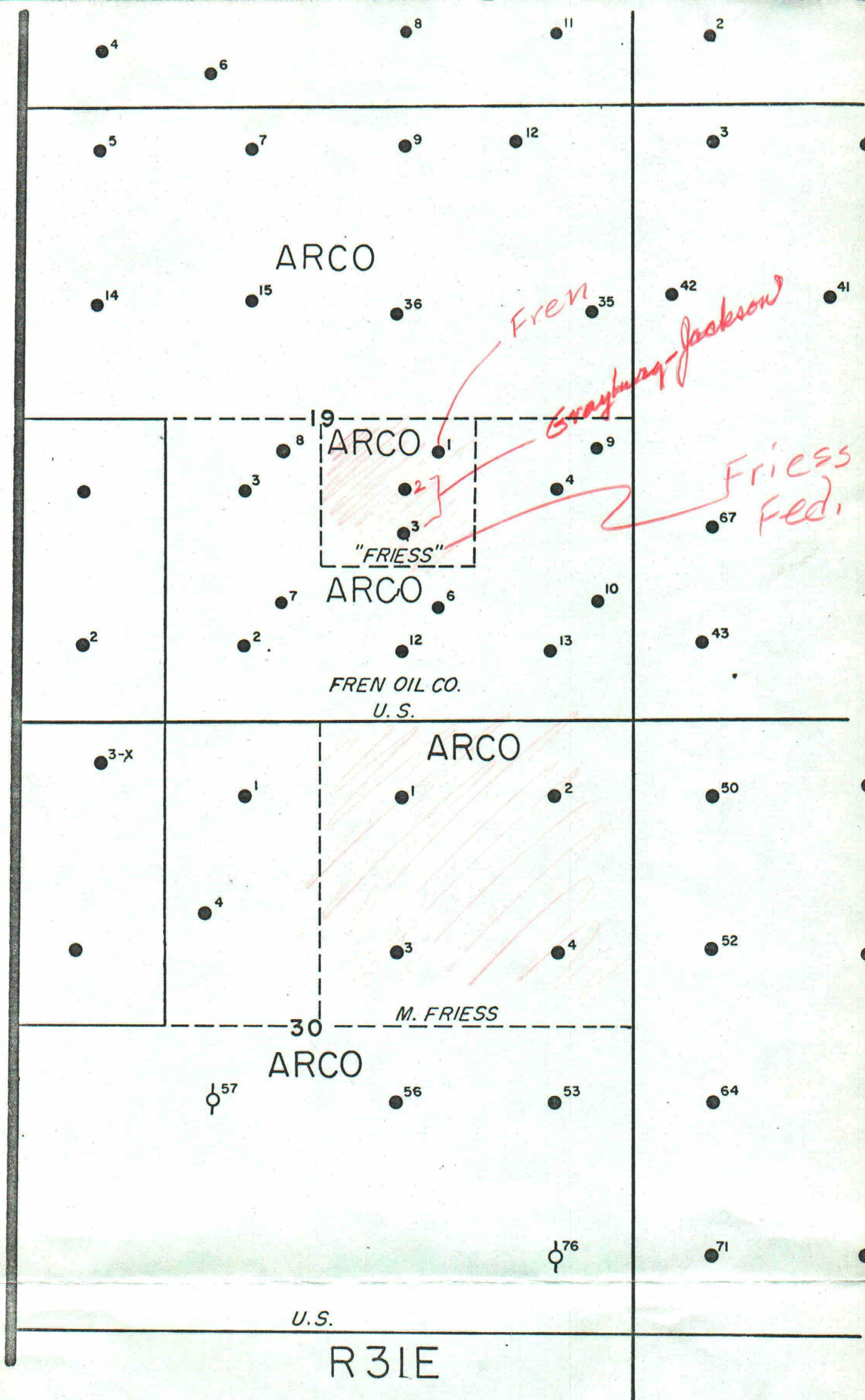

ATLANTIC RICHFIELD CO.
FRIESS FED.
EDDY CO. N.M.
SCALE: 1" = 1000'

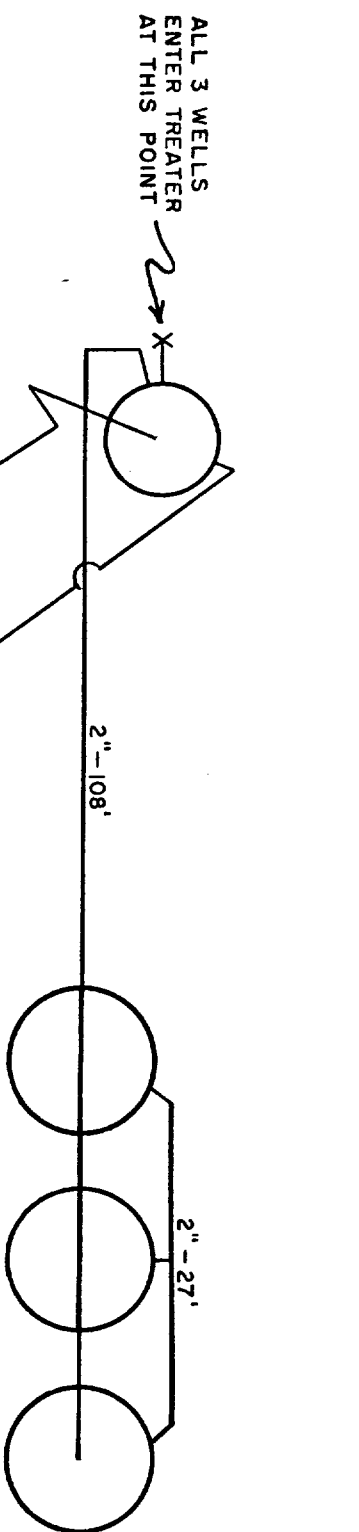

ATLANTIC RICHFIELD CO.
FRIESS FED.
BATTERY SCHEMATIC
EDDY CO. N.M.
NO SCALE

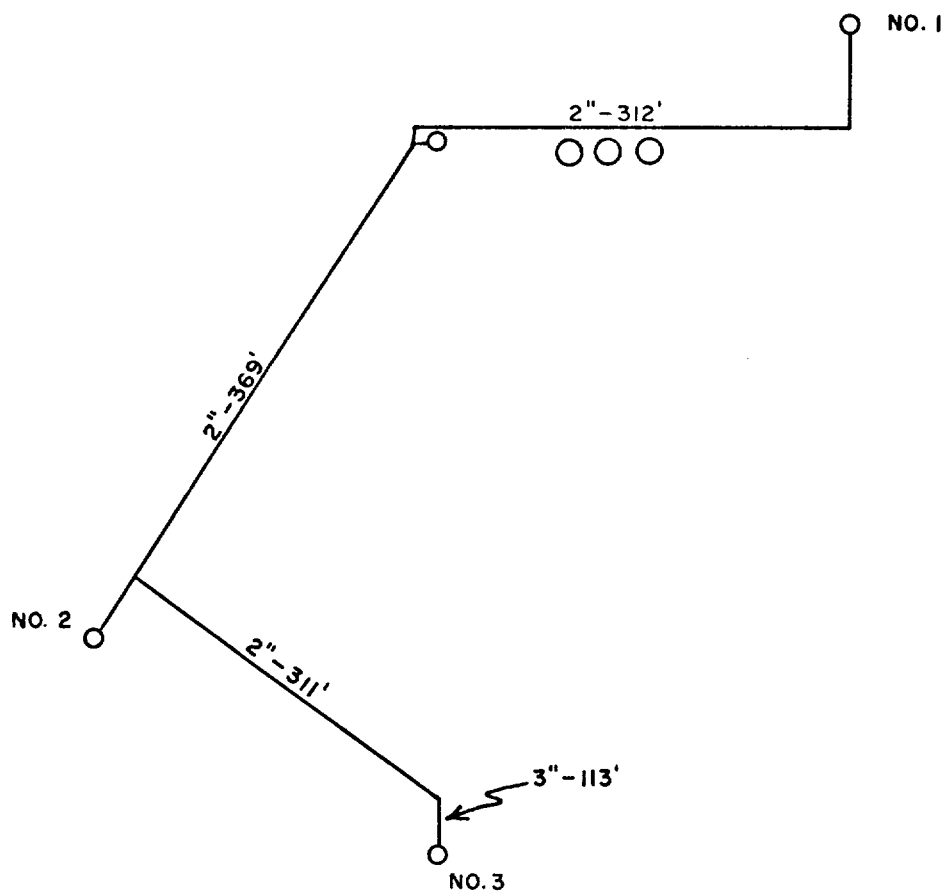

ATLANTIC RICHFIELD CO.
FRIESS FED.
EDDY CO. N.M.
NO SCALE