



SOHIO PETROLEUM COMPANY
EXPLORATION AND PRODUCTION

MIDLAND, TEXAS 79701
P. O. BOX 3000

July 8, 1974

MIDLAND DISTRICT

New Mexico Oil Conservation Commission (3)
P. O. Box 2088
Santa Fe, New Mexico 87501

PC -

Re: Elliott B-12-2 Well No. 3
2310' FNL, 660' FWL, Sec. 12,
T22S, R37E, NMPM
Lea County, New Mexico
Lease No. LC-064427

Gentlemen:

The above captioned well was drilled to a total depth of 7343' in the Granite Wash formation, plugged back to 7304', and completed as an oil well September 21, 1973, in the Drinkard formation. Perforations in the Drinkard are from 6254' - 6834'. The top of the Granite Wash is at 7306'. We have perforated the Granite Wash from 7182' - 7260'; and plan to produce both zones through dual strings of 2-1/16" tubing. Production from each zone will be measured by periodic well tests. The royalty interests in both zones are the same.

The gravity of the Drinkard oil is 43° with a value of \$5.31 per barrel. The gravity of the Granite Wash oil is 40° with a value of \$5.31 per barrel. The actual value of the commingled production will be the same as the sum of the values from Drinkard and Granite Wash.

Attached is a schematic diagram of the installation; and a plat showing the location of all wells on the subject lease, and the pool from which each well is producing. The United States Geological Survey was advised of our desire to commingle on the Form 9-331C.

May we request an exception to Rule 303-A be granted to permit the commingling into common facilities of the commonly owned production from the Drinkard and Granite Wash formations?

*Drinkard 12-13/day
Granite Wash 144 GOR 2300*

Yours very truly,

JHC/JHW:lsm
Attachs.

cc: N. W. O. C. C. - Hobbs, New Mexico

SOHIO PETROLEUM COMPANY

J. H. Walters
J. H. Walters

District Superintendent

Midland District

SCHEMATIC DIAGRAM OF PROPOSED DUAL COMPLETION
 DRINKARD AND WANTZ GRANITE WASH
 SOHIO PETROLEUM COMPANY
 ELLIOTT B-12-2 #3

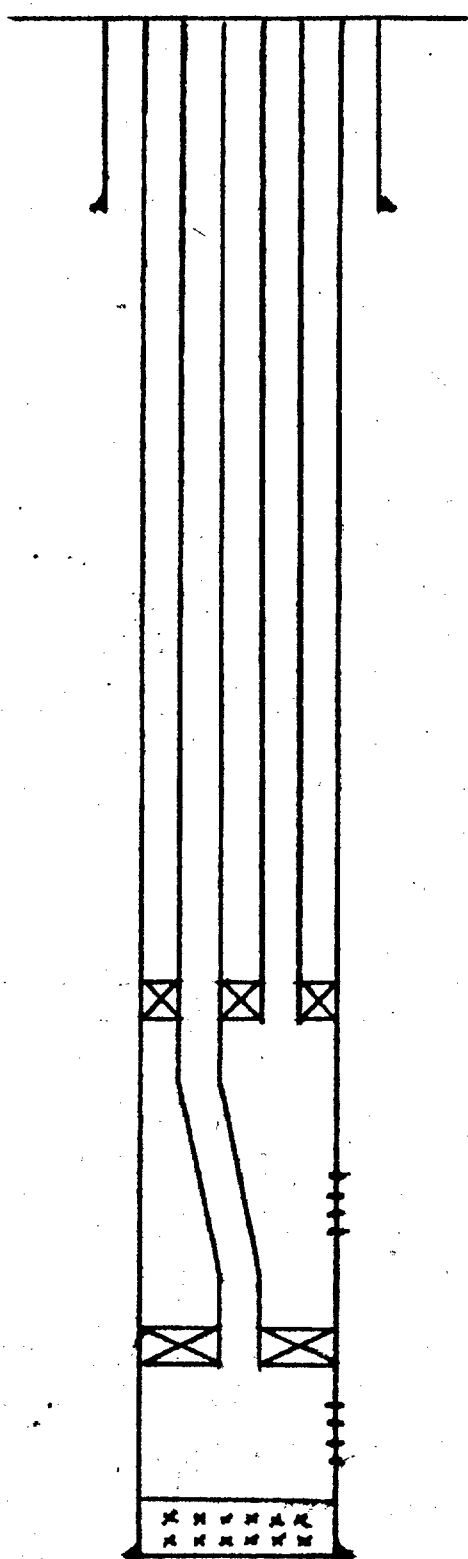

G. L. 3343'

8-5/8" 24# casing set at 1281.86' and cemented with 430 sacks. Cement circulated.

2-1/16" tubing (2 strings)

Baker Model K packer set at 6200'

Drinkard perforations 6254' - 6834'

Baker Model D packer at 7050'

Wantz Granite Wash perforations 7182' - 7260'

PBTD 7304'

5 1/2", 15.5# - 17#, casing set at 7343' and cemented with 675 sacks, TOC 3314'.

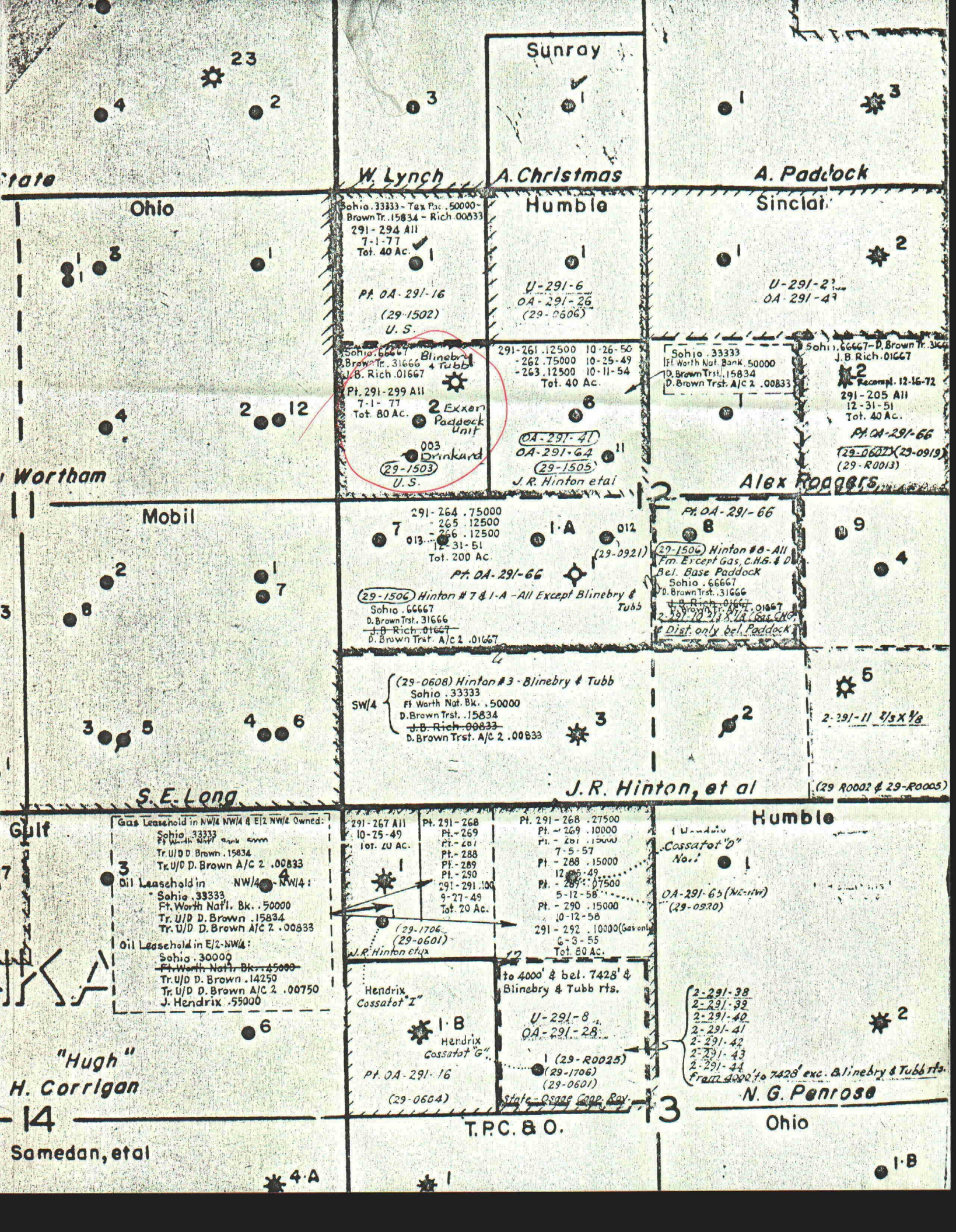

Sunray

W. Lynch

A. Christmas

A. Padlock

Ohio

Humble

Sinclair

Sohio .33333 - Tex Pac .50000 -
Brown Tr. 15834 - Rich .00833
291-294 All
7-1-77
Tot. 40 Ac.

PA OA-291-16
(29-1502)
U.S.

U-291-6
OA-291-26
(29-0606)

U-291-2
OA-291-43

Sohio .66667 Blinebry & Tubbs
Brown Tr. 31666
J.B. Rich .01667
Pt. 291-299 All
7-1-77
Tot. 80 Ac.

2 Exxon
Padlock
Unit

003 Drinkard
(29-1503)
U.S.

291-261 .12500 10-26-50
-262 .75000 10-25-49
-263 .12500 10-11-54
Tot. 40 Ac.

OA-291-41
OA-291-64
(29-1505)
J.R. Hinton et al

Sohio .33333
Ft. Worth Nat. Bank .50000
D. Brown Trst. 15834
D. Brown Trst. A/C 2 .00833

Sohio .66667 - D. Brown Tr. 31666
J.B. Rich .01667
Recompt. 12-16-72
291-205 All
12-31-51
Tot. 40 Ac.

PA OA-291-66
(29-0607) (29-0919)
(29-R0013)

Alex Rodgers

Mobil

PA OA-291-66

291-264 .75000
-265 .12500
-266 .12500
12-31-51
Tot. 200 Ac.

PA OA-291-66

(29-1506) Hinton #7 & I-A - All Except Blinebry & Tubbs
Sohio .66667
D. Brown Trst. 31666
J.B. Rich .01667
D. Brown Trst. A/C 2 .01667

(29-1506) Hinton #8 - All
Fm. Except Gas, C.H.G. & D.
Bel. Base Padlock
Sohio .66667
D. Brown Trst. 31666
J.B. Rich .01667
D. Brown Trst. A/C 2 .01667
Dist. only bel. Padlock

SW/4 { (29-0608) Hinton #3 - Blinebry & Tubbs
Sohio .33333
Ft. Worth Nat. Bk. .50000
D. Brown Trst. 15834
J.B. Rich .00833
D. Brown Trst. A/C 2 .00833

J.R. Hinton, et al

(29-R0002 & 29-R0005)

S.E. Long

Humble

Gas Leasehold in NW/4 NW/4 & E/2 NW/4 Owned:
Sohio .33333
Ft. Worth Nat'l Bank .50000
Tr. U/D D. Brown .15834
Tr. U/D D. Brown A/C 2 .00833
Oil Leasehold in NW/4 NW/4:
Sohio .33333
Ft. Worth Nat'l Bk. .50000
Tr. U/D D. Brown .15834
Tr. U/D D. Brown A/C 2 .00833
Oil Leasehold in E/2-NW/4:
Sohio .30000
Ft. Worth Nat'l Bk. .45000
Tr. U/D D. Brown .14250
Tr. U/D D. Brown A/C 2 .00750
J. Hendrix .59000

291-267 All
10-25-49
Tot. 20 Ac.

Pt. 291-268
Pt. 269
Pt. 281
Pt. 288
Pt. 289
Pt. 290
291-291.100
9-27-49
Tot. 20 Ac.

Pt. 291-268 .27500
Pt. 269 .10000
Pt. 281 .15000
7-5-57
Pt. 288 .15000
12-25-49
Pt. 289 .07500
5-12-58
Pt. 290 .15000
10-12-58
291-292 .10000 (Gas only)
6-3-55
Tot. 80 Ac.

U-291-65 (NE-1/4)
(29-0520)

(29-1706)
(29-0601)
J.R. Hinton et al

Hendrix
Cossatot "I"

1-B
Hendrix
Cossatot "G"

Pt. OA-291-16
(29-0604)

to 4000' & bel. 7428' &
Blinebry & Tubbs rts.

U-291-8
OA-291-28

1 (29-R0025)
(29-1706)
(29-0601)
State - Osage Corp. Roy.

2-291-38
2-291-39
2-291-40
2-291-41
2-291-42
2-291-43
2-291-44
From 4000' to 7428' exc. Blinebry & Tubbs rts.

N.G. Penrose

Ohio

T.P.C. & O.

"Hugh"
H. Corrigan

14
Samedan, et al

4-A

1

1-B