

Getty Oil Company

MID-CONTINENT EXPLORATION AND PRODUCTION DIVISION

~~NEW MEXICO OIL CONSERVATION COMMISSION~~

P. O. Box 249
Hobbs, New Mexico 88240

December 31, 1974

New Mexico Oil Conservation Commission
P. O. Box 2080
Santa Fe, New Mexico 87501

Attn: Mr. A. L. Porter, Jr.

Re: Request for Administrative Approval
To Surface Commingle the Blinebry
Oil and Drinkard Oil Pool on
GETTY OIL COMPANY'S
D. A. WILLIAMSON LEASE
Section 23, T-21-S, R-37-E
Lea County, New Mexico

Gentlemen:

Getty Oil Company respectfully requests permission to commingle oil production from the Blinebry Oil Unit (43.75% Getty, 56.25% Kirby) and the Drinkard Oil from Well No. 1 (100% Getty) on its D. A. Williamson Lease in accordance with the provisions provided in Rule 309-B of the New Mexico Oil Conservation Commission Rules and Regulations. The commingling is to be accomplished in accordance with the Commission "Manual for the Installation and Operation of Commingling Facilities" pertaining to Diversified Ownership.

In support of this application the following items are attached:

1. A schematic diagram of the proposed commingling installation.
2. A plat showing the location of all wells on the D. A. Williamson Lease and the zone from which each well is producing.
3. Waiver from Kirby Petroleum Company (only other party having diversified interest) consenting to the commingling of Blinebry and Drinkard Oil Production in a common battery.

In addition the following information is also submitted:

1. Getty Oil Company is the purchaser of the oil transported by Texas-New Mexico Pipeline who has checked the Drinkard Oil and agreed that it could be transported with the Blinebry in the Automatic Custody Transfer Equipment at the Battery.
2. The gravity of the Drinkard is 35.2° API. The gravity of the Blinebry is 39.6° API. Based on previous experiences in surface commingling of the Drinkard and Blinebry zones, no decrease in the value of the commingled liquid hydrocarbon production is anticipated.

Commingle D. A. Williamson Lease
NMOCC-Mr. A. L. Porter, Jr.-Santa Fe, N. M.
December 31, 1974

PAGE NO. 2

3. It is proposed to determine Blinebry production from each well by Monthly Well Tests as is presently done.
4. The Drinkard production from Well No. 1 will be metered continuously.
5. The total Blinebry production will be metered continuously.
6. Gas production will be determined by flowing through separate Sales gas meters, metering each zone continuously.

This Application to surface commingle is respectfully submitted for your consideration; and if additional information is needed, please advise.

Respectfully yours,
GETTY OIL COMPANY

C. L. Wade
C. L. WADE
Area Superintendent

Drk. Well No. 1

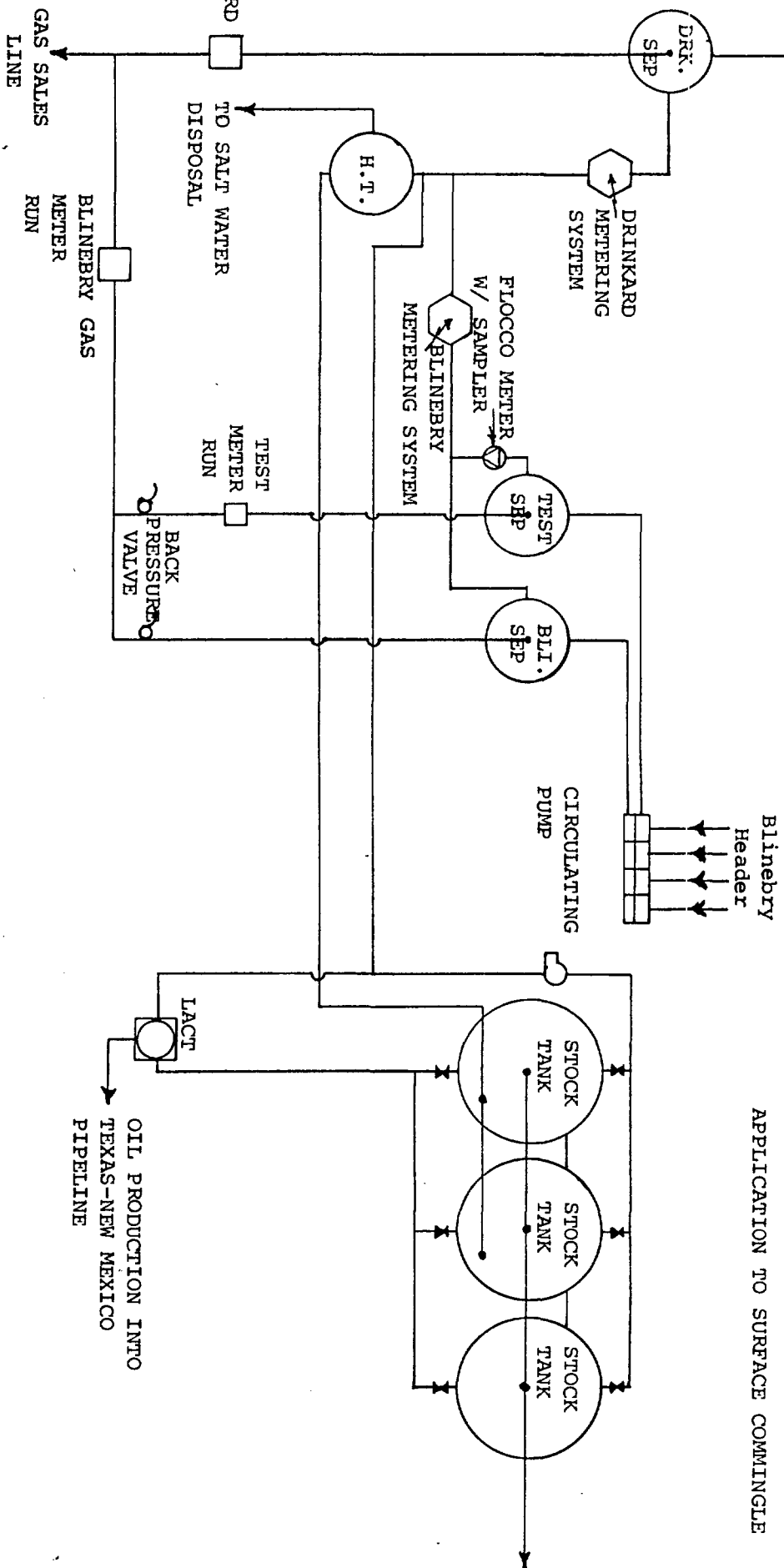

GETTY OIL COMPANY
B. A. WILLIAMSON LEASE
BLINEBRY & DRINKARD
APPLICATION TO SURFACE COMINGLE

DETAIL OF METERING SYSTEMS

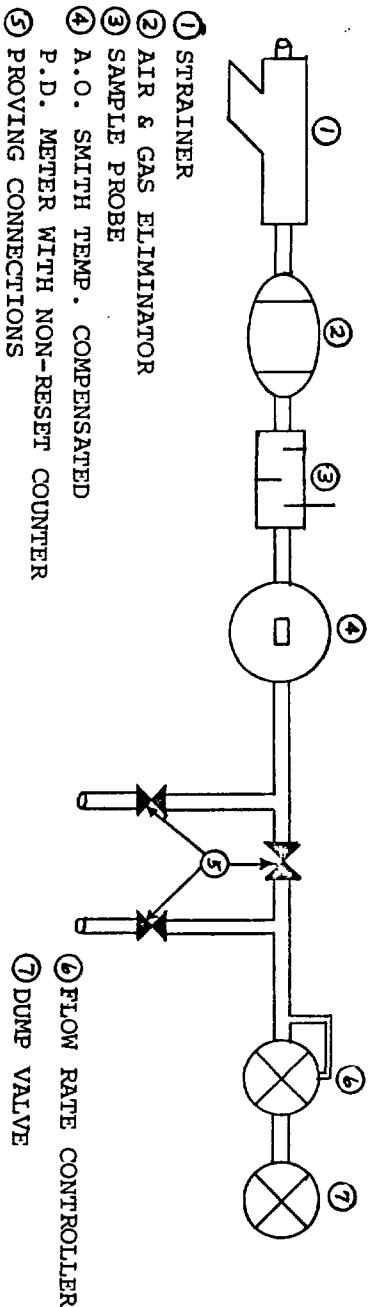

<p>State 1</p> <p>Getty 2 4 3 0</p> <p>State 0</p> <p>Service 5 3</p> <p>State 0</p> <p>Marathon 10 6 10 4 0 3</p> <p>Shell 0 4</p> <p>Go Oil 10 6 11 4 5</p> <p>Shell 11 13</p> <p>Sam Graves (S) Addis T. Turner (Dual)</p> <p>Cont'l, etal 032096 "A-27" "Lockhart" (4 E) 02 U.S. 11</p> <p>Small Tracts 27</p> <p>Marathon 0 3</p> <p>Humble 0 6 0 8</p> <p>Marshall 0 1</p> <p>Humble 0 4 0 2</p> <p>Small Tre 0 3</p> <p>A A Hardison</p> <p>Humble 0 4 0 2</p> <p>Small Tre 0 3</p> <p>A A Hardison</p> <p>Gulf 0 3</p>	<p>J.H. Nolan</p> <p>Abd Dire 2</p> <p>(Shell)</p> <p>Moranco</p> <p>Eva Owen</p> <p>Andrews</p> <p>J.R. Smith</p> <p>Dual 2</p> <p>J.R. Cone E. Flag-Redfern</p> <p>Dual-0 4</p> <p>O.R. Eubanks</p> <p>Getty 4</p> <p>(Sinclair) Mobil</p> <p>Atl. Rich. Dual</p> <p>Dual 0 4</p> <p>Mattie Williamson M.I.</p> <p>Eula Williams</p> <p>Lea Est. 23</p> <p>TD 7669</p> <p>Shell</p> <p>Sinclair</p> <p>Dual 0 4</p> <p>Eastman</p> <p>Finch</p> <p>S.J. Sarkeys</p> <p>Acoma 1</p> <p>Bo 1</p> <p>Triple</p> <p>Acoma</p> <p>Harper 0 2</p> <p>Triple</p> <p>Harper</p> <p>S.J. Sarkeys</p> <p>Atl. Rich. 0 2</p> <p>Gulf 0 1</p> <p>Dual</p> <p>S.E. Cone</p> <p>(Sinclair)</p> <p>Atl. Rich. 0 2</p> <p>B. Hill 0 3</p> <p>Dual</p> <p>E.C. Hill</p> <p>Cont'l, etal 032096</p> <p>"A-35" 0 3</p> <p>"B-35" 0 2</p> <p>"A M Lockhart"</p> <p>Moranco</p> <p>U.S.</p> <p>Marathon 0 4</p> <p>Cities 0 3</p>	<p>Chesner, Will N. Terry</p> <p>Summit Energy</p> <p>032096</p> <p>Gulf. Bunin</p> <p>Continental, etal</p> <p>032096</p> <p>13</p> <p>"Lockhart"</p> <p>U.S. 0 1</p> <p>Mark Owens</p> <p>Continental, etal</p> <p>032096</p> <p>05 "B-13-A"</p> <p>U.S.</p> <p>Lockhart Fed.</p> <p>Gulf</p> <p>S.I. 0 3</p> <p>Cont'l., etal</p> <p>H.B.P.</p> <p>032096</p> <p>U.S., M.I.</p> <p>J.M. Owens (S)</p> <p>Cont'l, etal</p> <p>HBP</p> <p>032096</p> <p>King Res.</p> <p>Nancy</p> <p>U.S., MI</p> <p>J.M.C.M.W. Owens</p> <p>Tex. Pac.</p> <p>(Gulf)</p> <p>(Gulf)</p> <p>D/R 2</p> <p>Dual (Quad)</p> <p>Imp. Amer.</p> <p>Gulf</p> <p>Sarkeys</p> <p>Dual 0 2</p> <p>"Sarkeys"</p> <p>(Atl. Rich. D/R)</p> <p>Tex. Pacific</p> <p>Repollo</p> <p>Simmons</p> <p>TD 0756</p> <p>DIA 8-20 46</p> <p>"Eva Owen"</p> <p>M.W. Owen S.</p> <p>Imp. Amer.</p> <p>OPST</p> <p>Solar</p> <p>Roy. Holding</p> <p>TIA 7525</p> <p>Roy. Holding</p> <p>Imp. Amer.</p> <p>Jones</p> <p>"Koger"</p> <p>TD 0524</p> <p>J. Simmons</p> <p>W. Wallach (S)</p> <p>Pan Amer</p>
--	--	--

NEW MEXICO OIL CONSERVATION COMMISSION
P. O. BOX 2080
SANTA FE, NEW MEXICO 87501

ATTN: MR. A. L. Porter, Jr.

SUBJECT: Application for Surface Commingling
The Blinbry Oil and Drinkard Oil
Pools on Getty Oil Company's
D. A. WILLIAMSON LEASE
Section 23, T-21-S, R-37-E
Lea County, New Mexico

Gentlemen:

We have received the subject application and herewith waive any objection to
Getty Oil Company's subject request.

KIRBY PETROLEUM CO.
Company

P. T. Hughes, Jr.
Company Representative

Staff Engineer
Title

December 10, 1974
Date

MRR/bh

OIL CONSERVATION COMMISSION

P. O. BOX 2088

SANTA FE NEW MEXICO 87501

December 23, 1974

C
O
P
Y
Getty Oil Company
P. O. Box 249
Hobbs, New Mexico 88240

Attention: Mr. C. L. Wade

Re: Application for Surface Commingling,
D. A. Williamson Lease

Gentlemen:

We are in receipt of your letter dated November 27, 1974, wherein you request authority to commingle Blinbry and Drinkard Production on your D. A. Williamson Lease.

While you do attach a waiver of objection to your proposed commingling from Kirby Petroleum Company, this installation does not meet the Commission's required standards of accuracy for administrative approval of commingling production of diversified ownership.

It will be necessary to either go to hearing with this application or to revise the installation to provide for continuous metering of the production from both pools, as required by the Commission's "Manual for the Installation and Operation of Commingling Facilities."

Very truly yours,

DANIEL S. NUTTER
Chief Engineer

DSN/dr

cc: Oil Conservation Commission - Hobbs
Kirby Petroleum Co. - Houston

THE CONSERVATION COMMISSION
P. O. BOX 2028
SANTA FE, NEW MEXICO 87501

Dear Mr. [Name]:

Thank you for your letter of [Date] regarding [Subject].

I am sorry that I cannot give you the answer you desire.

Sincerely,

[Name]
[Title]
[Address]
[City, State, Zip]

I am sorry that I cannot give you the answer you desire. I am sorry that I cannot give you the answer you desire. I am sorry that I cannot give you the answer you desire.

I am sorry that I cannot give you the answer you desire. I am sorry that I cannot give you the answer you desire. I am sorry that I cannot give you the answer you desire.

Very truly yours,

[Name]
[Title]
[Address]

[Name]
[Title]
[Address]



Getty Oil Company

MID-CONTINENT EXPLORATION AND PRODUCTION DIVISION
~~XXXXXXXXXXXXXXXXXXXXXXXXXXXX~~

P. O. Box 249
Hobbs, New Mexico 88240

November 27, 1974

New Mexico Oil Conservation Commission
P.O. Box 2080
Santa Fe, New Mexico 87501

Attn: Mr. A. L. Porter, Jr.

Re: Request for Administrative Approval
To Surface Commingle the Blinebry
Oil and Drinkard Oil Pool on
GETTY OIL COMPANY'S
D. A. WILLIAMSON LEASE
Section 23, T-21-S, R-37-E
Lea County, New Mexico

Gentlemen:

Getty Oil Company respectfully requests permission to commingle oil production from the Blinebry Oil Unit (43.75% Getty, 56.25% Kirby) and the Drinkard Oil from Well No. 1 (100% Getty) on its D. A. Williamson Lease in accordance with the provisions provided in Rule 309-B of the New Mexico Oil Conservation Commission Rules and Regulations. The commingling is to be accomplished by metering the Drinkard production (1 well) in accordance with the Commission "Manual for the Installation and Operation of Commingling Facilities" pertaining to Diversified Ownership. The Blinebry production (4 wells - none Top Allowable) will be obtained by the subtraction method.

In support of this application the following items are attached:

1. A schematic diagram of the proposed commingling installation.
2. A plat showing the location of all wells on the D. A. Williamson Lease and the zone from which each well is producing.
3. Waiver from Kirby Petroleum Company (only other party having diversified (interest) consenting to the commingling of Blinebry and Drinkard Oil Production in a common battery.

In addition the following information is also submitted:

1. Getty Oil Company is the purchaser of the oil transported by Texas-New Mexico Pipeline who has checked the Drinkard Oil and agreed that it could be transported with the Blinebry in the Automatic Custody Transfer Equipment at the Battery.
2. The gravity of the Drinkard is 35.2° API. The gravity of the Blinebry is 39.6°

Commingle D. A. Williamson Lease
NMOCC-Mr. A.L. Porter, Jr.-Santa Fe, N.M.
November 27, 1974

PAGE NO. 2

API. Based on previous experiences in surface commingling of the Drinkard and Blinebry zones, no decrease in the value of the commingled liquid hydrocarbon production is anticipated.

3. It is proposed to determine Blinebry production from each well by Monthly Well Tests as is presently done.
4. The Drinkard production from Well No. 1 will be metered continuously.
5. Gas production will be determined by flowing through separate Sales gas meters.

This Application to surface commingle is respectfully submitted for your consideration; and if additional information is needed, please advise.

Respectfully yours,
GETTY OIL COMPANY



C. L. Wade
Area Superintendent

WELL NO. 1

GETTY OIL COMPANY
D. A. WILLIAMSON LEASE
BLINEBRY AND DRINKARD

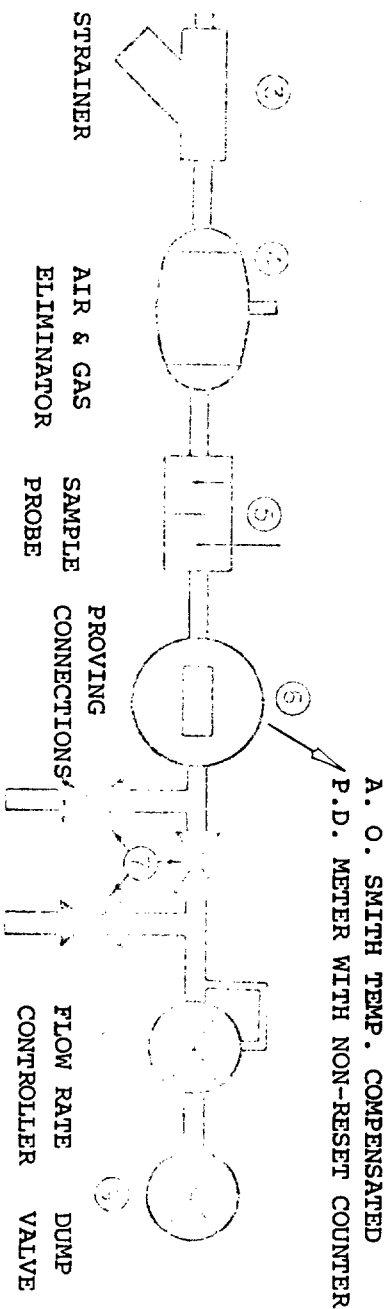
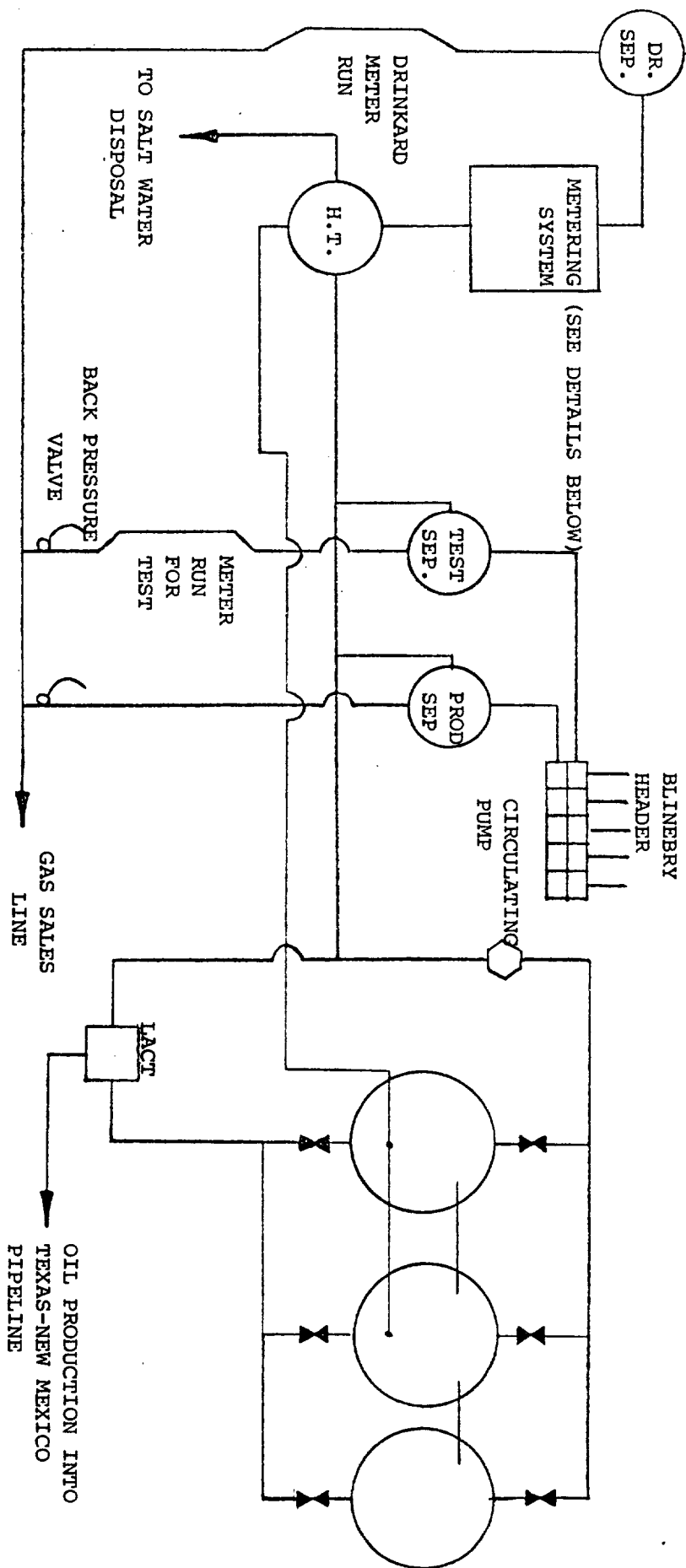
APPLICATION TO SURFACE COMMINGLE

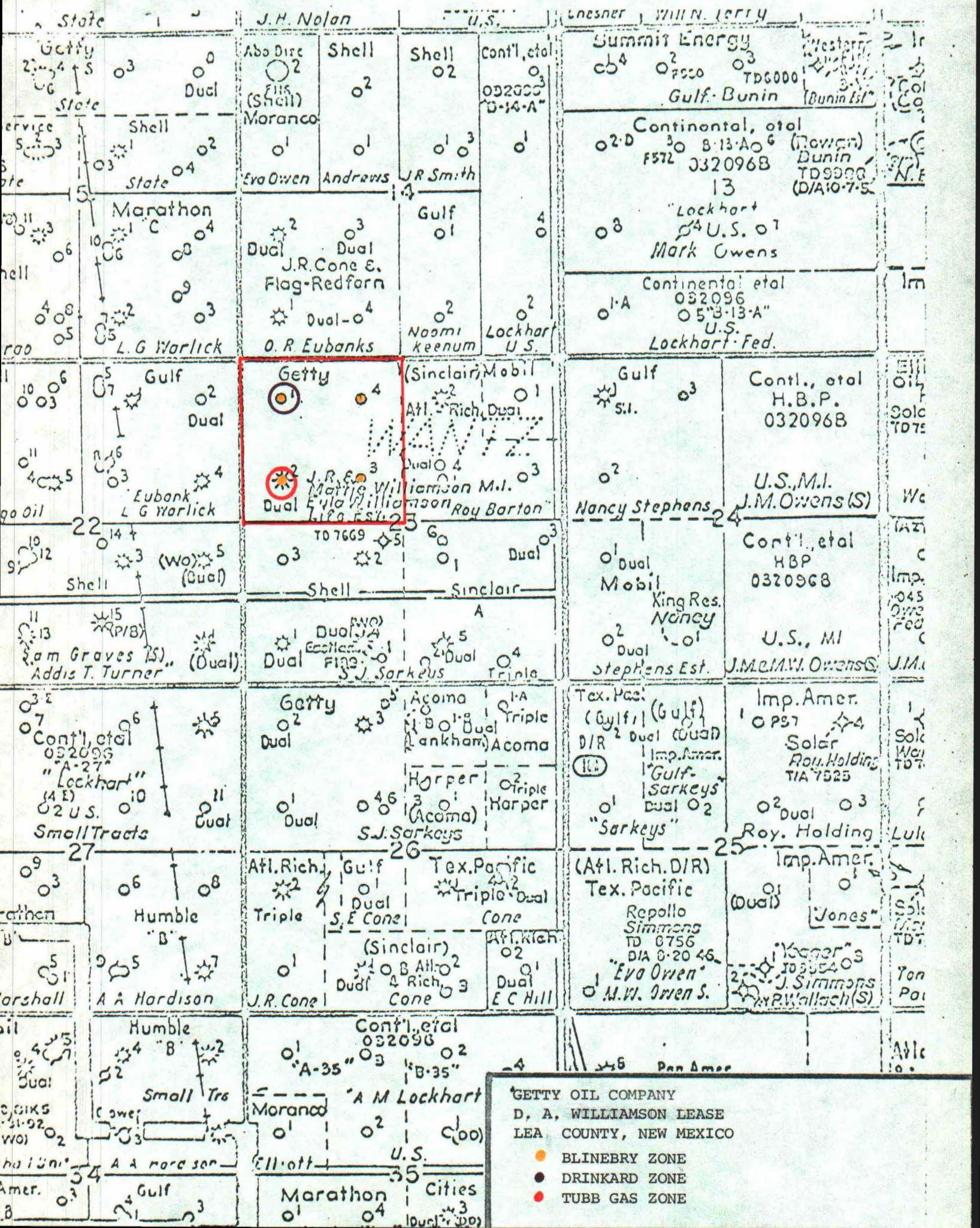



KIRBY PETROLEUM CO.

GENERAL OFFICES, FIRST CITY NATIONAL BANK BLDG.

P. O. Box 1745 HOUSTON, TEXAS 77001

December 10, 1974

Mr. A. L. Porter, Jr.
New Mexico Oil Conservation Commission
P.O. Box 2080
Santa Fe, New Mexico 87501

Dear Mr. Porter:

As per Getty Oil Company's request, please find enclosed a "letter of waiver" concerning Getty's Application for Surface Comingling on the D. A. Williamson lease, Lea County, New Mexico. A copy of this release is being sent back to Getty Oil Company as per their request.

If anything else is required, please so advise.

KIRBY PETROLEUM CO.

P. T. Hughes, Jr.
Staff Engineer

PTH:kr
1 enclosure



Getty Oil Company

MID-CONTINENT EXPLORATION AND PRODUCTION

~~XX~~

P. O. Box 249
Hobbs, New Mexico 88240

November 27, 1974

Kirby Petroleum Company
P. O. Box 1745
Houston, Texas 77001

Attn; Mr. Paul Hughes

Subject: Request for Waiver for Administrative
Approval to Surface Commingle the
Blinebry Oil and Drinkard Oil on
Getty's D. A. WILLIAMSON LEASE
Lea County, New Mexico

Dear Sir:

Enclosed is a copy of Getty's Application for Surface Commingling as requested per your telephone conversation with our Mr. Eakin in Midland. Getty Oil Company appreciates your verbal approval of the subject Application. Also enclosed is a "Letter of Waiver" which we need to attach to our Application before it is sent to the New Mexico Oil Conservation Commission. Please complete this letter at your earliest convenience and return to P.O. Box 249, Hobbs, New Mexico 88240, if you do not have any objections. Thank you!

Very truly yours,
GETTY OIL COMPANY

C. L. Wade
C. L. Wade
Area Superintendent

MRR/bh
ATTACHMENTS

NEW MEXICO OIL CONSERVATION COMMISSION
P. O. BOX 2080
SANTA FE, NEW MEXICO 87501

ATTN: MR. A. L. Porter, Jr.

SUBJECT: Application for Surface Commingling
The Blinebry Oil and Drinkard Oil
Pools on Getty Oil Company's
D. A. WILLIAMSON LEASE
Section 23, T-21-S, R-37-E
Lea County, New Mexico

Gentlemen:

We have received the subject application and herewith waive any objection to
Getty Oil Company's subject request.

KIRBY PETROLEUM CO.
Company

P. T. Hughes, Jr. 
Company Representative

Staff Engineer
Title

December 10, 1974
Date

MRR/bh