

ROUTE - MESSAGE SLIP

SUN-7401-A

DATE

TO

LOCATION

ROOM NO.

REMARKS:

Gilbert,

You also asked for the price we're  
selling the oil on this lease.

We have not sold any oil from  
this lease since the wells don't  
produce much.

Dee Ann Kemp

FROM

LOCATION

ROOM NO.



**Sun Exploration and  
Production Company**  
No 24 Smith Road  
ClayDesta Plaza  
PO Box 1861  
Midland TX 79702 9970  
915 688 0300

February 15, 1984

Mr. Gilbert Quintana  
State of New Mexico  
Energy & Mineral Department  
P. O. Box 1980  
Santa Fe, New Mexico 38240

Re: Exception to Statewide Rule 303A  
Surface Commingling  
Boyd Lease  
Wells Nos. 2 and 3  
Lea County, New Mexico

Dear Mr. Quintana:

Sun Exploration & Production Company recently submitted papers to surface commingle the referenced wells. Well no. 3 was shown to be in the Drinkard zone. Since you received this application it was discovered that well no. 3 should be listed in the Paddock zone. This will not affect the price of oil when commingled with the Blinbry and Drinkard from well no. 2.

Attached is the schematic diagram of the battery installation and plat showing location of the two wells (per your request).

If you have any questions or need additional information, please contact me at 915/688-0374.

Very truly yours,

A handwritten signature in black ink that reads "Dee Ann Kemp". The signature is written in a cursive, flowing style.

Dee Ann Kemp  
Senior Accounting Assistant

DAK/lw

Attachments

R 37 E

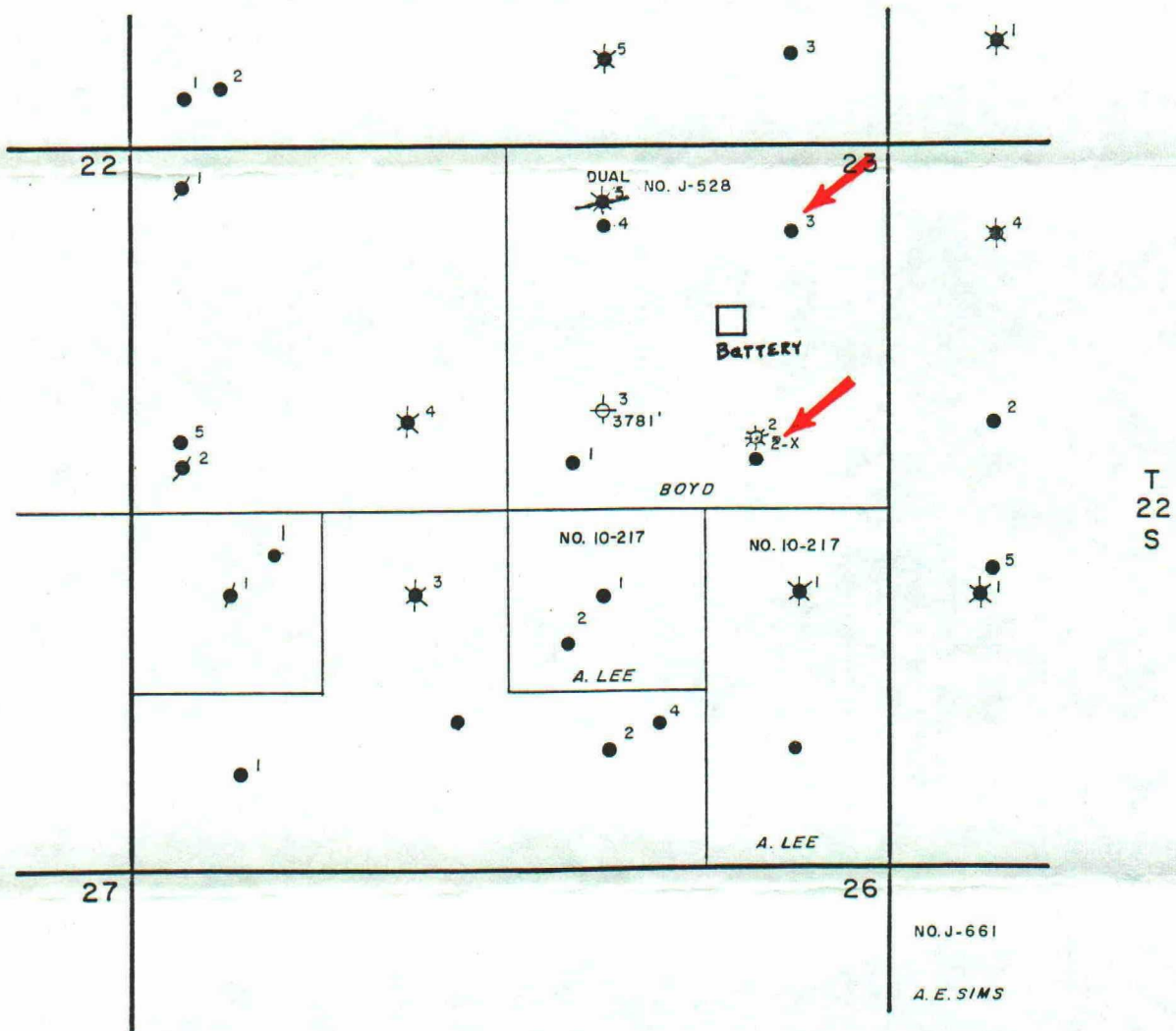

BOYD LEASE  
SEC 23  
T 22-S, R 37-E

BOYD WELL # 2Y  
2-13-84  
2210' FNL \$990' FEL  
SEC. 23, T 22-S, R 37-E  
LEA COUNTY, NEW MEXICO

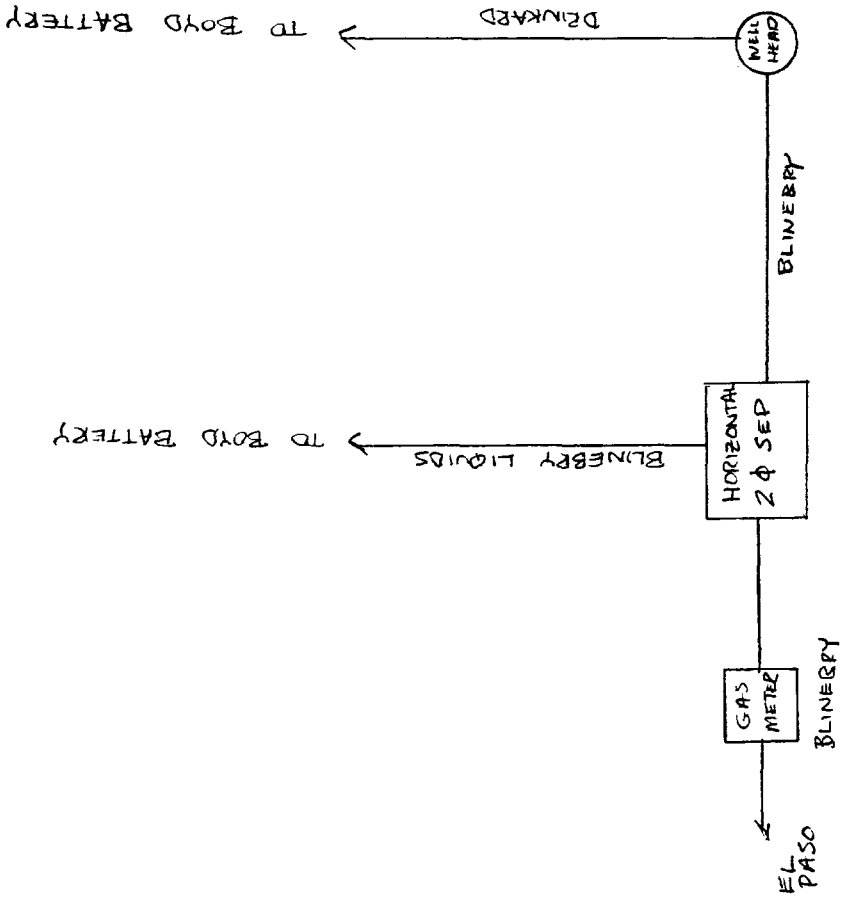

BOYD LEASE BATTERY  
2-13-84  
SEC. 23 T 22-S, R 37-E  
LEA COUNTY, NEW MEXICO

