



# PHILLIPS PETROLEUM COMPANY

ODESSA, TEXAS 79761  
PHILLIPS BUILDING

NATURAL RESOURCES GROUP  
Exploration and Production

October 25, 1977

Michel No. 1--Non-  
Standard Unit = Unit  
C, Section 13, T-16-S,  
R-33-E, Lea County

File: W4-Ta-521-77

New Mexico Oil Conservation Commission (3) ✓  
P. O. Box 2088  
Santa Fe, New Mexico 88501

Attention: Mr. Joe D. Ramey,  
Secretary Director

Gentlemen:

We respectfully request administrative approval of the non-standard proration unit for the captioned well where production has been activated in a previously temporarily abandoned zone. Circumstances supporting this request are as follows:

1. The Michel No. 1 was completed in June, 1957, from perforations 13,062-13,200' and subsequently assigned to the Sombrero (Penn Pool) as an orthodox location and standard unit on 160 acres.
2. Said completion was made prior to June 1, 1964, when 320 acre units were adopted for Pennsylvanian completions. The Sombrero (Penn) completion was shut in and temporarily abandoned on February 13, 1976, and the well bore completed in the West Kemnitz Cisco Pool.
3. Order No. R-5309 effective November 1, 1976, contracted the Sombrero (Penn) Gas Pool vertical limits to include only the Atoka formation and redesignated as the Sombrero (Atoka) Gas Pool. This action occurred during the time of shut in on the Michel No. 1 Penn completion.
4. The original perforated interval of 13,062-13,200' of this well bore has now been restored to production. That zone is currently recognized as a Morrow completion which, effective June 1, 1964, requires a location of 660 feet from side and 1980 feet from end unit boundaries on a 320 acre unit. The lease and dedicated acreage consists of only 160 acres.

NEW MEXICO OIL CONSERVATION COMMISSION  
OCT 28 1977  
NSP - 1070  
Rule 104 D. II.  
11-27-77  
Send copy to Hobbs  
NW/4 13-16 S-33E  
under Morrow  
Pool

To: New Mexico Oil Conservation Commission  
From: T. Harold McLemore  
Date: October 25, 1977  
Page: 2

5. Form C-102 reflecting the dedicated proration unit, and an area plat reflecting lease location and offset ownership are enclosed.
6. Offset owner(s)/operator(s) of the Morrow zone have been notified of this application by certified mail. Their waivers are hereby requested.
7. Statewide Rule 104 (F) provides for the requested administrative action on exceptions to Sections B and C of said rule where circumstances are as those cited above.

It is understood that the current completion will be assigned to "Undesignated-Morrow-Gas" classification for current proration purposes.

Your consideration and approval will be appreciated.

Very truly yours,



T. Harold McLemore

PHILLIPS PETROLEUM COMPANY

HM:db  
Attachments

cc: New Mexico Oil Conservation Commission, Hobbs, New Mexico  
Offset Operators: Amoco Production Company, Box 3092, Houston, Texas 77001  
Dalco Oil Company, 1200 Merchantile Nat'l Bank Bldg.,  
Dallas, Texas 75201  
*1704 an offset* → Dalco Petroleum Company, 2431 E. 51st, Tulsa, Oklahoma 74105  
Davoil, Inc., Box 12507, Ft. Worth, Texas 76116  
Great Western Drilling Company, Box 1659, Midland,  
Texas 79702  
Oil Development Company of Texas, Box 12058, Amarillo,  
Texas 79101  
Supron Energy Corporation, Suite 1700, 8350 N. Central  
Expressway, Dallas, Texas 75206

E. M. Gorence  
Attachments

## NEW MEXICO OIL CONSERVATION COMMISSION

## WELL LOCATION AND ACREAGE DEDICATION PLAT

Form C-102  
Supersedes C-128  
Effective 1-1-65

Activate and re-designate temporarily abandoned zone.

All distances must be from the outer boundaries of the Section.

Operator Phillips Petroleum Company			Lease Michel		Well No. 1
Unit Letter C	Section 13	Township 16-S	Range 32-E	County Lea	

Actual Footage Location of Well: 660 feet from the north line and 1979 feet from the west line					
Ground Level Elev. 4157'GR, 4172'RKB	Producing Formation Morrow - gas		Pool Undesignated-Morrow-Gas	Dedicated Acreage: 160 Acres	

1. Outline the acreage dedicated to the subject well by colored pencil or hachure marks on the plat below.
2. If more than one lease is dedicated to the well, outline each and identify the ownership thereof (both as to working interest and royalty).
3. If more than one lease of different ownership is dedicated to the well, have the interests of all owners been consolidated by communitization, unitization, force-pooling, etc?

☐ Yes ☐ No If answer is "yes," type of consolidation \_\_\_\_\_

If answer is "no," list the owners and tract descriptions which have actually been consolidated. (Use reverse side of this form if necessary.) \_\_\_\_\_

No allowable will be assigned to the well until all interests have been consolidated (by communitization, unitization, forced-pooling, or otherwise) or until a non-standard unit, eliminating such interests, has been approved by the Commission.

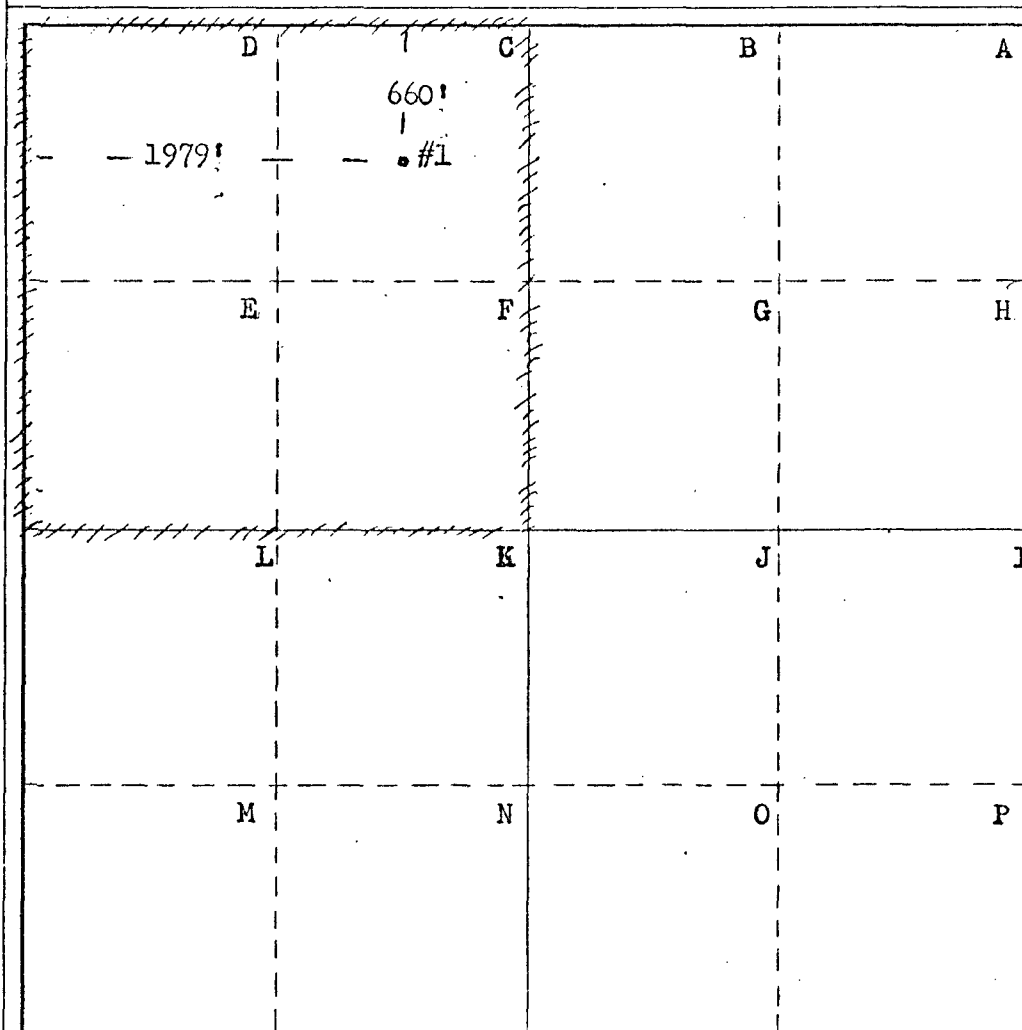

## CERTIFICATION

I hereby certify that the information contained herein is true and complete to the best of my knowledge and belief.

Name

W. J. Mueller

Position

Engineering Advisor

Company

Phillips Petroleum Company

Date

October 24, 1977

I hereby certify that the well location shown on this plat was plotted from field notes of actual surveys made by me or under my supervision, and that the same is true and correct to the best of my knowledge and belief.

Date Surveyed

4-6-57

Registered Professional Engineer and/or Land Surveyor

M. E. Spry

Certificate No.

679

0 330 660 990 1320 1650 1980 2310 2640 2000 1500 1000 500 0



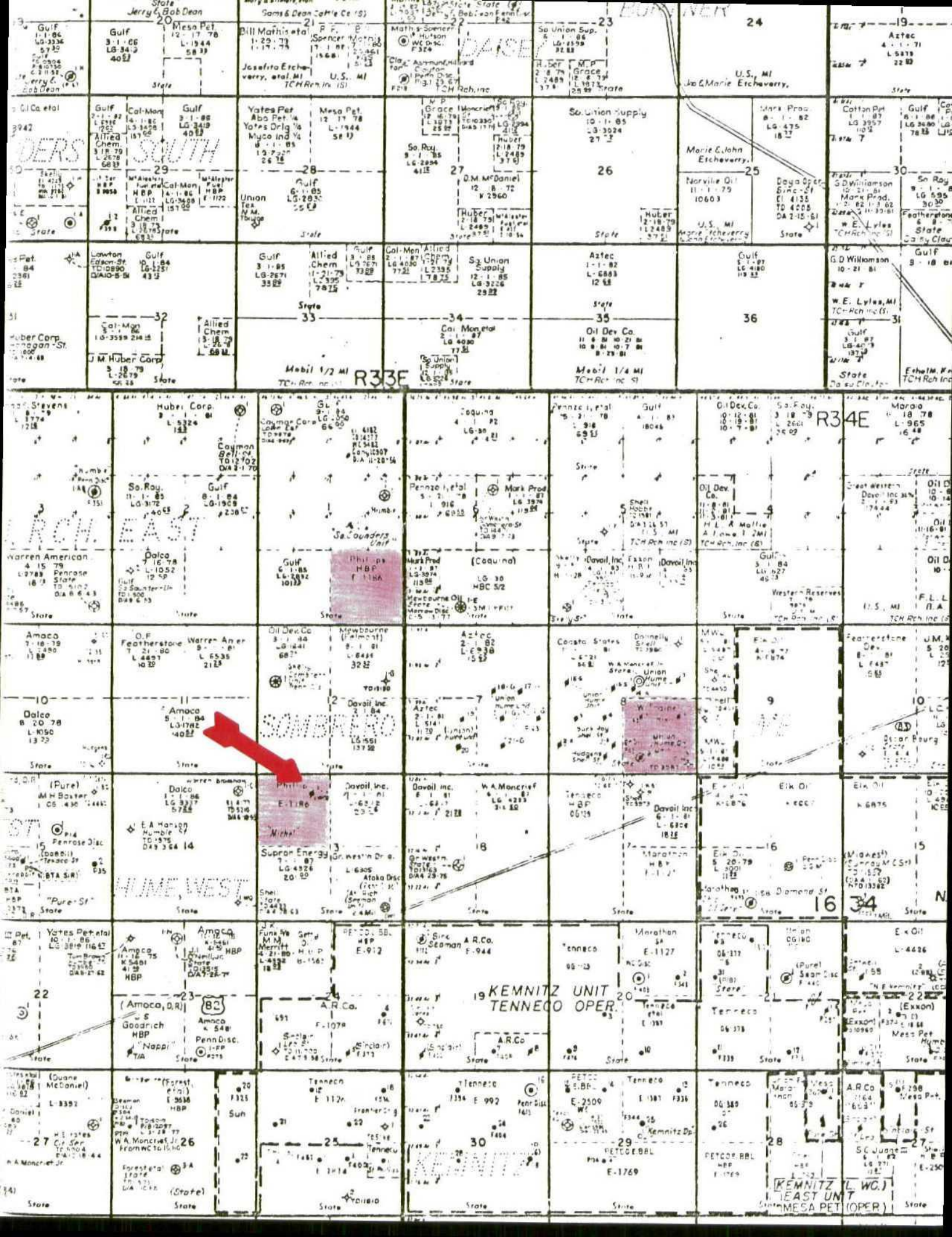

# SABINE PRODUCTION COMPANY

SUITE 901 / WALL TOWERS EAST  
201 W. WALL ST.  
MIDLAND, TEXAS 79701  
PHONE (915) 683-5607

October 31, 1977

New Mexico Oil Conservation Commission  
P. O. Box 2088  
Santa Fe, New Mexico 88501

Attention: Mr. Joe D. Ramey,  
Secretary Director

Re: Phillips Petroleum Company  
#1 Michel, Unit C, Section  
13, T-16-S, R-33-E, Lea  
County, New Mexico

Dear Sir:

We have followed the series of rulings affecting subject well, and as offset operator our waiver is granted.

Attention is called to our official name change from Dalco Oil Company to Sabine Production Company, 901 Wall Towers East, Midland, Texas 79701.

Very truly yours,

SABINE PRODUCTION COMPANY

  
C. H. Madsen  
District Geologist

CHM:cc

cc: Phillips Petroleum Company  
Phillips Building  
Odessa, Texas 79761



**Amoco Production Company**

500 Jefferson Building  
P.O. Box 3092  
Houston, Texas 77001

J. M. Brown  
Division Engineering  
Manager

November 3, 1977

*nsf-1070*

File: DBF-986.51NM-4823

Re: Non-Standard Proration Unit  
Michel No. 1  
Section 13, T-16-S, R-33-E  
Lea County, New Mexico

Mr. Joe D. Ramey, Secretary-Director  
New Mexico Oil Conservation Commission  
P. O. Box 2088  
Santa Fe, NM 88501

Dear Sir:

Phillips Petroleum Company has requested our waiver of objection to the administrative approval of a non-standard proration unit for the subject well.

The Michel No. 1 is located in Unit C, Section 13, T-16-S, R-33-E in Lea County, 660' FNL and 1979' FWL of the Section. Dedicated acreage consists of only 160 acres.

As an offset operator, Amoco Production Company has no objection to granting administrative approval to this unit and waives notice and hearing.

Yours very truly,

EHW:sam

cc: Phillips Petroleum Company  
Phillips Building  
Odessa, TX 79761

OIL CONSERVATION COMMISSION  
Hobbs DISTRICT

hsp-1070

OIL CONSERVATION COMMISSION  
BOX 2088  
SANTA FE, NEW MEXICO

DATE November 1, 1977

RE: Proposed MC \_\_\_\_\_  
Proposed DHC \_\_\_\_\_  
Proposed NSL \_\_\_\_\_  
Proposed SWD \_\_\_\_\_  
Proposed WFX \_\_\_\_\_  
Proposed PMX \_\_\_\_\_  
NSP X

11-1-1977  
SANTA FE, N.M.

Gentlemen:

I have examined the application dated \_\_\_\_\_  
for the Phillips Petroleum Co. Michel #1-C 13-16-33  
Operator Lease and Well No. Unit, S-T-R

and my recommendations are as follows:

O.K.-----J.S.

Yours very truly,

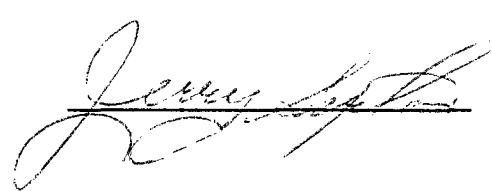



11-7 1977

PHONE 682-5241  
ADDRESS REPLY TO:  
BOX 1659  
MIDLAND, TEXAS 79701

November 4, 1977

New Mexico Oil Conservation Commission  
P. O. Box 2088  
Santa Fe, New Mexico 88501

Attention Mr. Joe D. Ramey

Re: Phillips Petroleum Company  
Michel No. 1  
Unit C, Section 13, T-16-S  
R-33-E, Lea County, NM

Gentlemen:

We have received Phillips request for a non standard  
proration unit captioned above. Great Western Drilling Company  
has no objections to this request.

Yours very truly,

GREAT WESTERN DRILLING COMPANY

F. L. Ballard  
General Superintendent

FLB/fl



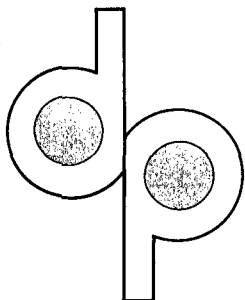

DALCO PETROLEUM, INC.

NOV 21 1977  
SANTA FE, N.M.

HSP-1070

November 7, 1977

T. Harold McLemore  
Phillips Petroleum Company  
Phillips Building  
Odessa, Texas 79761

Dear Mr. McLemore:

The attached letter does not pertain to Dalco Petroleum,  
Inc. 2431 East 51st Street, Tulsa, Oklahoma

Sincerely,

*Merrill J. Reynolds*  
ah

Merrill J. Reynolds  
Geologist

MJR/ah

encl.

Rec'd 11-18-77 - Original to NMOCC,  
Santa Fe - Attn: Mr. Richard L. Stamets

THM

*[Signature]*