

EXXON COMPANY, U.S.A.
POST OFFICE BOX 1600 • MIDLAND, TEXAS 79702

PRODUCTION DEPARTMENT
MIDCONTINENT DIVISION

April 6, 1981

Request for Approval on
Non-Standard Gas Unit
New Mexico "DA" State #1
Lea County, New Mexico

New Mexico Oil Conservation Commission
P. O. Box 2088
Santa Fe, New Mexico 87501

Attention: Mr. Joe Ramey

Gentlemen:

Please grant administrative approval without notice and hearing for a non-standard gas unit under the provisions of Rule 104D II for the above well. This request is necessitated by a variation in the legal subdivision of the U. S. Public Land Surveys.

The south half of Section 31, T21S, R35E, Lea County, New Mexico, contains only 312.42 acres. Attached is a copy of the Application for Permit to Drill with plat.

Please disregard our letter of March 27, 1981 pertaining to this well.

Very truly yours,

Melba Knipling

Melba Knipling
Unit Head

CH/me

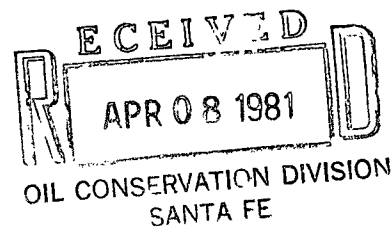

Exxon Lse. No. _____

NEW MEXICO OIL CONSERVATION COMMISSION

Form C-102
Supersedes C-128
Effective 1-1-65

State Lse. No. _____

WELL LOCATION AND ACREAGE DEDICATION PLAT

Federal Lse. No. _____

All distances must be from the outer boundaries of the Section.

Operator Exxon Corporation			Lease New Mexico "DA" State		Well No. 1
Unit Letter N	Section 31	Township 21 S	Range 35 E	County Lea	
Actual Footage Location of Well: 660 feet from the South line and 1980 feet from the West line					
Ground Level Elev. 3658	Producing Formation Wolfcamp		Pool Undesignated		Dedicated Acreage 312.42 Acres

1. Outline the acreage dedicated to the subject well by colored pencil or hachure marks on the plat below.
2. If more than one lease is dedicated to the well, outline each and identify the ownership thereof (both as to working interest and royalty).
3. If more than one lease of different ownership is dedicated to the well, have the interests of all owners been consolidated by communitization, unitization, force-pooling, etc?

☐ Yes ☐ No If answer is "yes," type of consolidation _____

If answer is "no," list the owners and tract descriptions which have actually been consolidated. (Use reverse side of this form if necessary.) _____

No allowable will be assigned to the well until all interests have been consolidated (by communitization, unitization, forced-pooling, or otherwise) or until a non-standard unit, eliminating such interests, has been approved by the Commission.

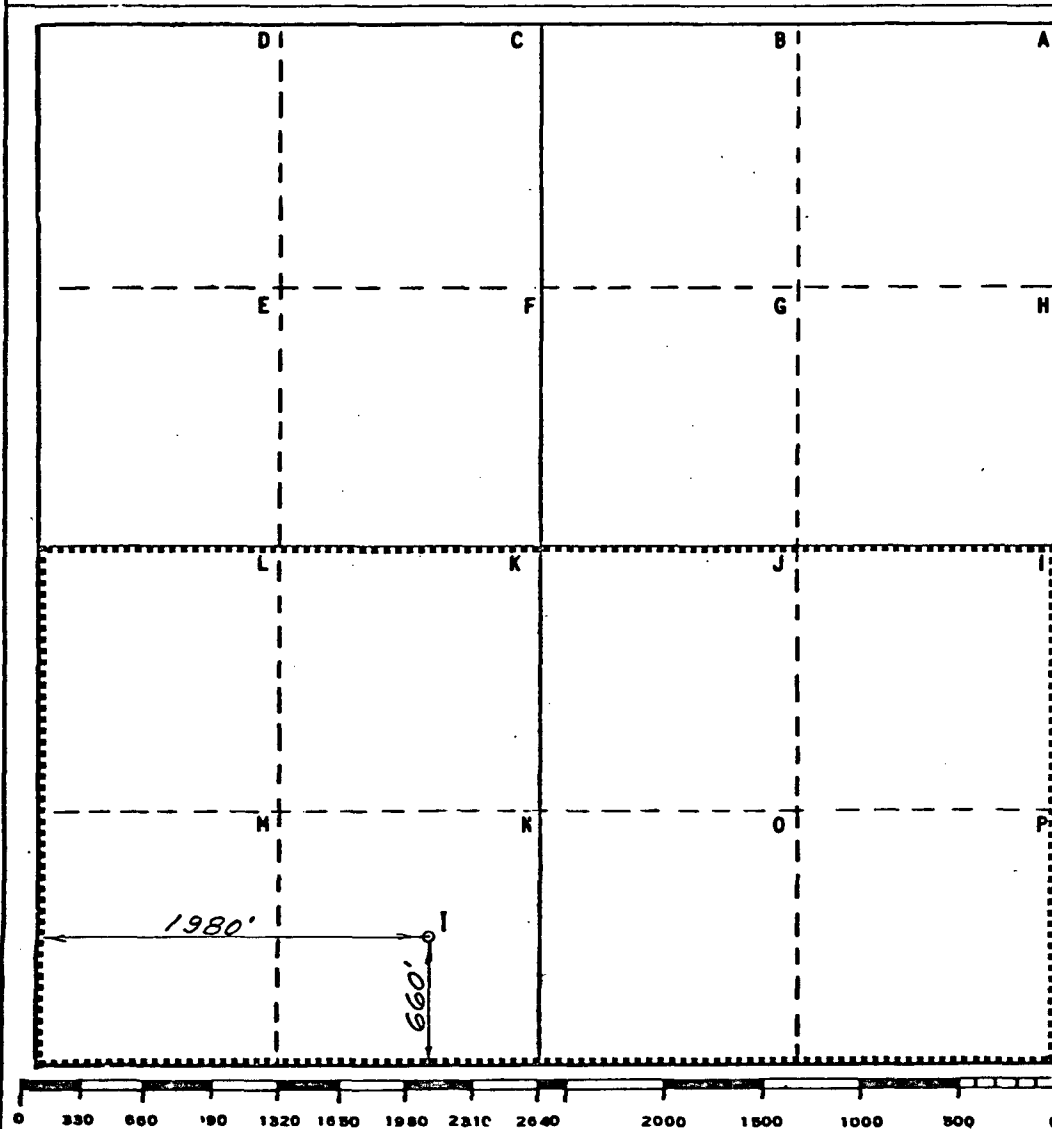

CERTIFICATION

I hereby certify that the information contained herein is true and complete to the best of my knowledge and belief.

Name

Melba Knippling

Position

Proration Specialist

Company Exxon Corporation

Box 1600 Midland, Texas

Date

4-6-81

I hereby certify that the well location shown on this plat was plotted from field notes of actual surveys made by me or under my supervision, and that the same is true and correct to the best of my knowledge and belief.

Date Surveyed

3-30-81

Registered Professional Engineer
and/or Land Surveyor*H. S. Shusterfeld*

Certificate No.

1382

Federal Lse. No. _____ All distances must be from the outer boundaries of the Section.

Operator Exxon Corporation			Lease New Mexico "DA" State		Well No. 1
Unit Letter N	Section 31	Township 21 S	Range 35 E	County Lea	
Actual Footage Location of Well: 660 feet from the South line and 1980 feet from the West line					
Ground Level Elev. 3658	Producing Formation Morrow (Gas)		Pool Undesignated		Dedicated Acreage: 312.42 Acres

1. Outline the acreage dedicated to the subject well by colored pencil or hachure marks on the plat below.
2. If more than one lease is dedicated to the well, outline each and identify the ownership thereof (both as to working interest and royalty).
3. If more than one lease of different ownership is dedicated to the well, have the interests of all owners been consolidated by communitization, unitization, force-pooling, etc?

☐ Yes ☐ No If answer is "yes," type of consolidation _____

If answer is "no," list the owners and tract descriptions which have actually been consolidated. (Use reverse side of this form if necessary.) _____

No allowable will be assigned to the well until all interests have been consolidated (by communitization, unitization, forced-pooling, or otherwise) or until a non-standard unit, eliminating such interests, has been approved by the Commission.

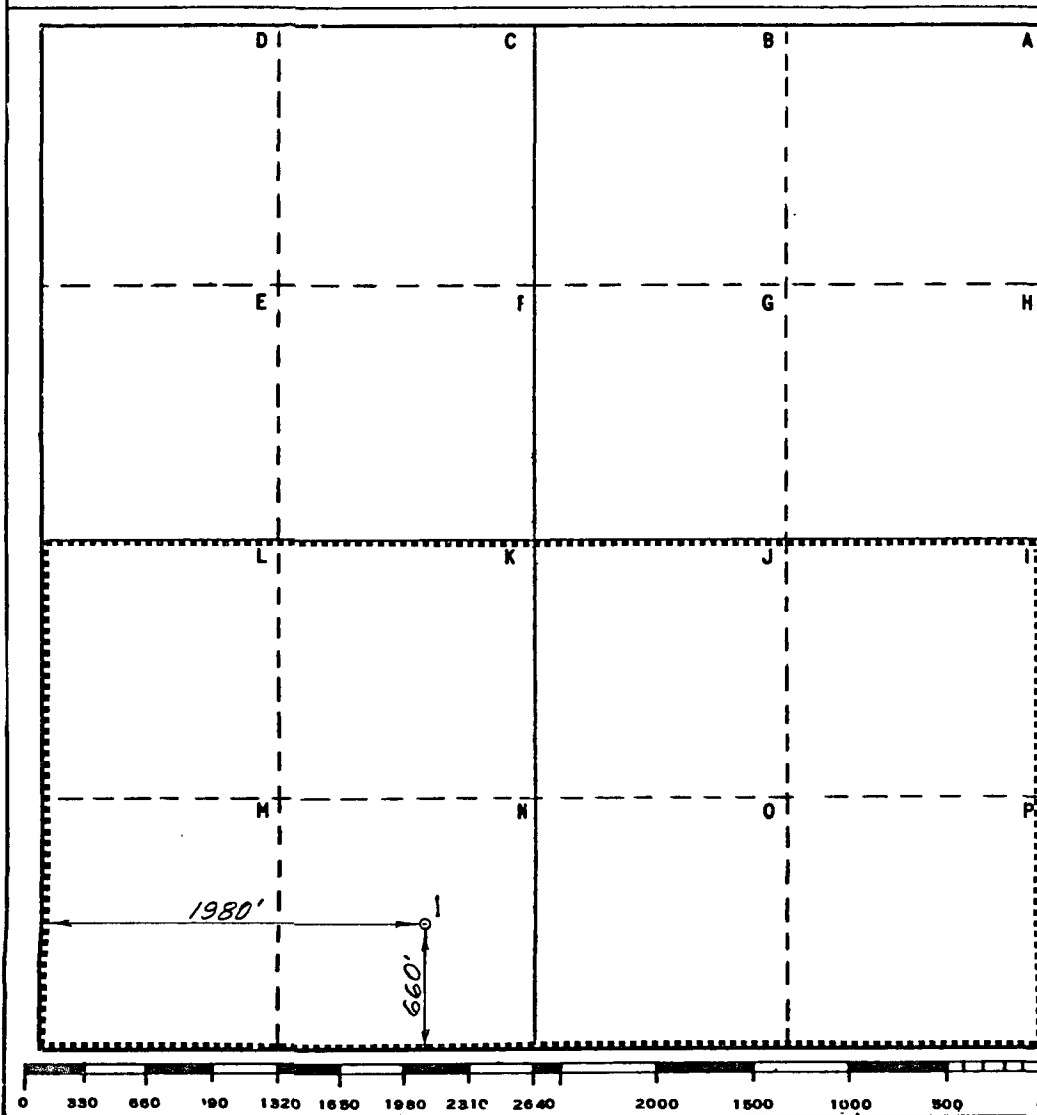

CERTIFICATION

I hereby certify that the information contained herein is true and complete to the best of my knowledge and belief.

Name
Melba Knipling
 Position
 Proration Specialist

Company Exxon Corporation
 Box 1600 Midland, Texas

Date
 4-6-81

I hereby certify that the well location shown on this plat was plotted from field notes of actual surveys made by me or under my supervision, and that the same is true and correct to the best of my knowledge and belief.

Date Surveyed
 3-30-81

Registered Professional Engineer and/or Land Surveyor

H. S. Westergaard
 Certificate No.
 1382