

1277
NSP-1278
Rule 104 D II
Immediate

NORTHWEST PIPELINE CORPORATION

PRODUCTION & DRILLING
P.O. BOX 90
FARMINGTON, NEW MEXICO 87401
5110.1-125-81

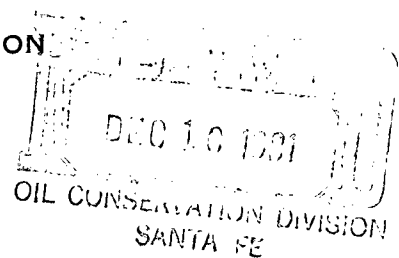

December 7, 1981

Joe Ramey
NMOCD
P.O. Box 2088
Santa Fe, New Mexico 87501

Re: Application for Non-Standard
Gas Proration Unit
San Juan 29-5 Unit #100
Sec 25, T29N, R5W

E/2

229.16 acres
Gobernador PC &
Blanco M✓

Dear Mr. Ramey:

Northwest Pipeline Corp requests permission to produce the above captioned well as a Non-Standard Gas Unit. The unorthodox size of this unit is necessitated by a variation in the legal subdivision of the U.S. Public Land Survey. The offset operators have been notified of our intentions by certified mail and they will forward any objections directly to your office. Copies of these letters along with the receipts for certified mail are enclosed.

Sincerely,

Paul C. Thompson
Paul C. Thompson
Drilling Engineer

PCT/djb

Enclosure

NORTHWEST PIPELINE CORPORATION

PRODUCTION & DRILLING
P.O. BOX 90
FARMINGTON, NEW MEXICO 87401
5110.1-128-81

December 7, 1981

John Schaik
200 Lomas Blvd N.W.
Albuquerque, New Mexico 87102

Re: Non-Standard Gas
Proration Unit
San Juan 29-5 Unit #100
NE/4 Sec 25, T29N, R5W

Dear Mr. Schalk:

Northwest Pipeline has requested permission from the New Mexico Oil & Gas Conservation Division to produce the above captioned well as a Non-Standard Gas Unit. Our records show you to be an offset operator. If you have any objections to this request, notify Joe Ramey with the NMOCD in Santa Fe within 30 days. This letter is being sent by certified mail in accordance with NMOCD regulations.

Sincerely,

Paul C. Thompson

Paul C. Thompson
Drilling Engineer

PCT:djb

NORTHWEST PIPELINE CORPORATION

PRODUCTION & DRILLING
P.O. BOX 90
FARMINGTON, NEW MEXICO 87401

5110.1-127-81

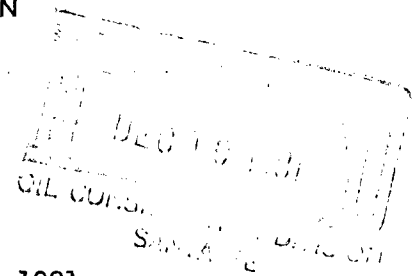

December 7, 1981

John Ahlm
El Paso Natural Gas Co
P.O. Box 289
Farmington, N.M. 87401

Re: Non Standard Gas
Proration Unit
San Juan 29-5 Unit #100
NE/4 Sec 25, T29N, R5W

Dear Mr. Ahlm:

Northwest Pipeline has requested permission from the New Mexico Oil & Gas Conservation Division to produce the above captioned well as a Non-Standard Gas Unit. Our records show you to be an offset operator. If you have any objections to this request, notify Joe Ramey with the NMOCD in Santa Fe within 30 days. This letter is being sent certified mail in accordance with NMOCD regulations.

Sincerely,

Paul C. Thompson

Paul C. Thompson
Drilling Engineer

PCT:djb

All distances must be from the outer boundaries of the Section.

Operator NORTHWEST PIPELINE CORPORATION			Lease SAN JUAN 29-5 UNIT		Well No. 100
Unit Letter G	Section 25	Township 29N	Range 5W	County Rio Arriba	
Actual Footage Location of Well: 1885 feet from the North line and 1165 feet from the East line.					
Ground Level Elev. 6786	Producing Formation Pictured Cliffs/Mesa Verde		Pool Gobernador PC/Blanco MV		Dedicated Acreage: 229.16 Acres

1. Outline the acreage dedicated to the subject well by colored pencil or hachure marks on the plat below.
2. If more than one lease is dedicated to the well, outline each and identify the ownership thereof (both as to working interest and royalty).
3. If more than one lease of different ownership is dedicated to the well, have the interests of all owners been consolidated by communitization, unitization, force-pooling, etc?

☒ Yes ☐ No If answer is "yes," type of consolidation Unitization

If answer is "no," list the owners and tract descriptions which have actually been consolidated. (Use reverse side of this form if necessary.)

No allowable will be assigned to the well until all interests have been consolidated (by communitization, unitization, forced-pooling, or otherwise) or until a non-standard unit, eliminating such interests, has been approved by the Commission.

4521.94
4526.94

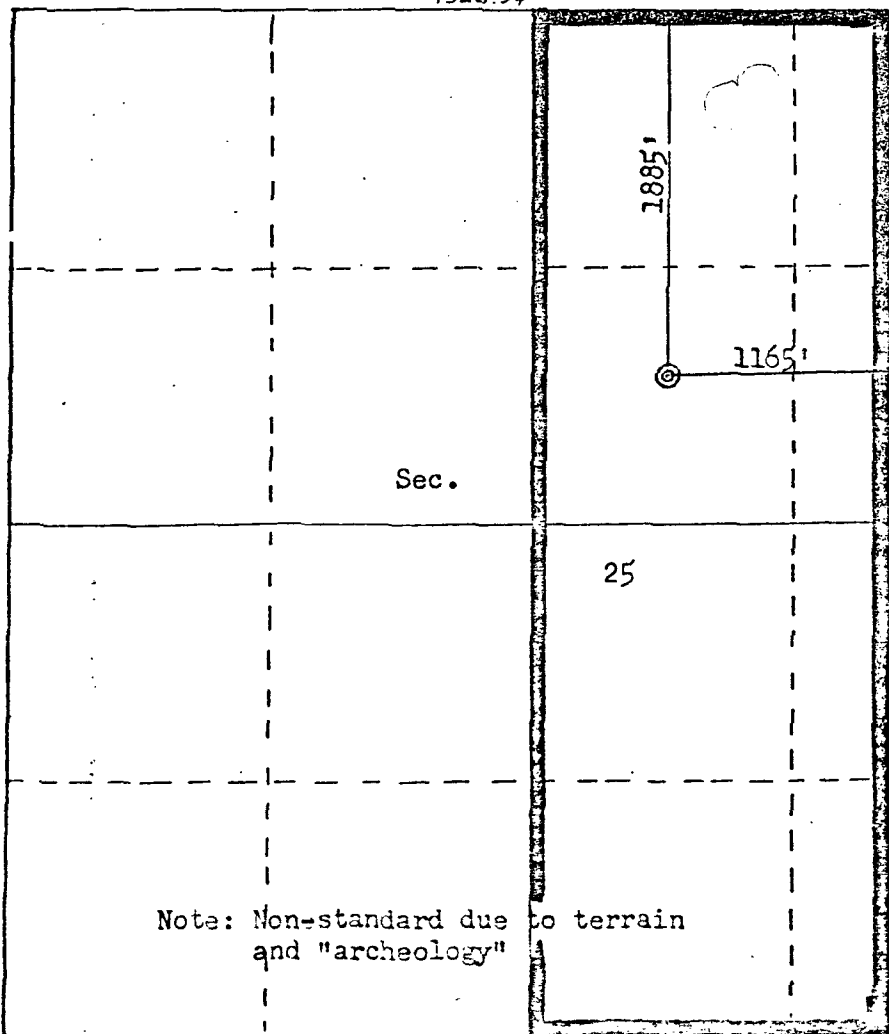

CERTIFICATION

I hereby certify that the information contained herein is true and complete to the best of my knowledge and belief.

Paul C. Thompson

Name

Paul C. Thompson

Position

Drilling Engineer

Company

Northwest Pipeline Corp

Date

July 23, 1980

I hereby certify that the well location shown on this plat was plotted from field notes of actual surveys made by me or under my supervision, and that the same is true and correct to the best of my knowledge and belief.

Date Surveyed

July 23, 1980
Professional Engineer
and Land Surveyor

Paul C. Thompson
Paul C. Thompson

Certificate No.

3950

NWP
WELL FILE

SAN JUAN 29-5 UNIT No. 100

NE 1/4 SEC 25 T29N-R5W

NEW MEXICO

GOVERNADOR PICTURED CLIFFS / BLANCO MESA VERDE

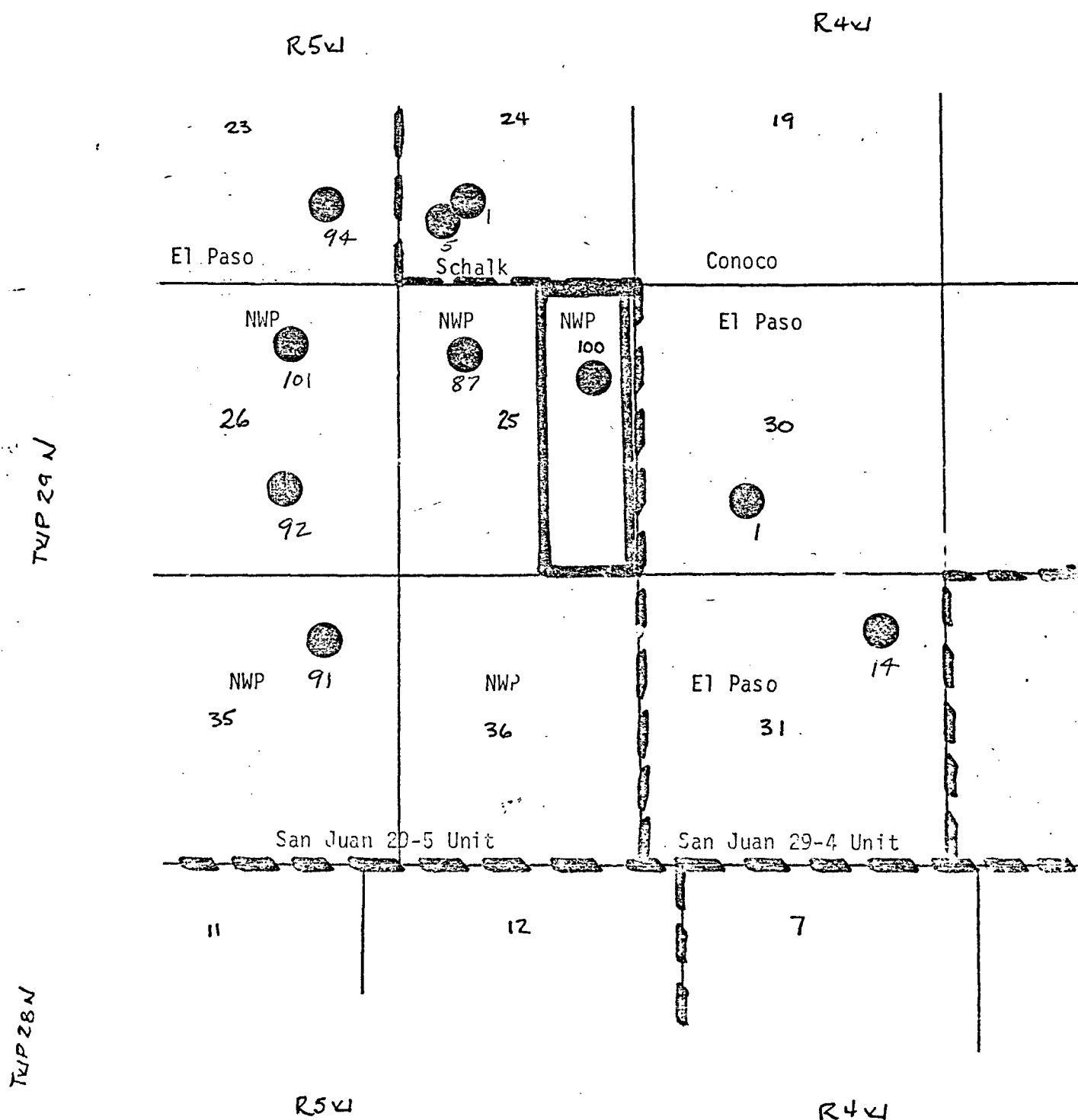

P22 0973602

RECEIPT FOR CERTIFIED MAIL

NO INSURANCE COVERAGE PROVIDED—
NOT FOR INTERNATIONAL MAIL
(See Reverse)

PS Form 3800, Apr. 1976

San Juan 29-5 Unit #100

SENT TO John Schalk		STREET AND NO. 200 Lomas Blvd N.W.	
P.O. STATE AND ZIP CODE Albuquerque, N.M. 87102		POSTAGE \$.20	
CONSULT POSTMASTER FOR FEES		CERTIFIED FEE \$.75	
OPTIONAL SERVICES		SPECIAL DELIVERY RESTRICTED DELIVERY	
RETURN RECEIPT SERVICE		SHOW TO WHOM AND DATE DELIVERED	
SHOW TO WHOM, DATE AND ADDRESS OF DELIVERY		SHOW TO WHOM, DATE AND ADDRESS OF DELIVERY	
SHOW TO WHOM, DATE AND ADDRESS OF DELIVERY WITH RESTRICTED DELIVERY		SHOW TO WHOM, DATE AND ADDRESS OF DELIVERY WITH RESTRICTED DELIVERY	
TOTAL POSTAGE AND FEES \$.95		POSTMARK OR DATE 	

P22 0973603

RECEIPT FOR CERTIFIED MAIL

NO INSURANCE COVERAGE PROVIDED—
NOT FOR INTERNATIONAL MAIL
(See Reverse)

PS Form 3800, Apr. 1976

S.J. 29-5 Unit #100

SENT TO John Ahlm		STREET AND NO. P.O. Box 289	
P.O. STATE AND ZIP CODE Farmington, N.M. 87401		POSTAGE \$.20	
CONSULT POSTMASTER FOR FEES		CERTIFIED FEE \$.75	
OPTIONAL SERVICES		SPECIAL DELIVERY RESTRICTED DELIVERY	
RETURN RECEIPT SERVICE		SHOW TO WHOM AND DATE DELIVERED	
SHOW TO WHOM, DATE AND ADDRESS OF DELIVERY		SHOW TO WHOM, DATE AND ADDRESS OF DELIVERY	
SHOW TO WHOM, DATE AND ADDRESS OF DELIVERY WITH RESTRICTED DELIVERY		SHOW TO WHOM, DATE AND ADDRESS OF DELIVERY WITH RESTRICTED DELIVERY	
TOTAL POSTAGE AND FEES \$.95		POSTMARK OR DATE 