

Release Oct 14, 1985

2, DRC



**Chevron U.S.A. Inc.**  
P.O. Box 670, Hobbs, NM 80240

R. C. Anderson  
Division Manager  
Hobbs Division  
Production Department

August 29, 1985

Amend NSP 1421- L

APPLICATION FOR A 160 ACRE NON-  
STANDARD PRORATION UNIT

Richard Stamets  
Oil Conservation Division  
P. O. Box 2088  
Santa Fe, New Mexico 87501

Gentlemen:

Chevron U.S.A. Inc. respectfully requests administrative approval for a 160 acre Non-Standard Gas Proration Unit in the Tubb Oil and Gas Pool, comprising the W/2 of NW/4 and SE/4 of NW/4 and SW/4 of NE/4 of Section 30-T22S-R38E, Lea County, New Mexico, to be assigned to Chevron's Vivian #13 Well. In support thereof, Chevron U.S.A. Inc. states the following facts:

1. The proposed Non-Standard Gas Proration Unit will meet the requirements of Rule 5(c)3 of the Oil Conservation Division Order No. R-6012 as follows:
  - a. The proposed unit consists of 160 acres.
  - b. The proposed unit consists of contiguous quarter-quarter sections.
  - c. The proposed unit lies wholly within a single government section in the Tubb Oil and Gas Pool.
  - d. The entire proposed unit may reasonably be presumed to be productive of gas from the Tubb Oil and Gas Pool.
  - e. A copy of this application will be sent by certified mail to all offset operators and operators owning interests in the proposed unit's boundary and shall serve as notification.

In support of this application, attached is a plat outlining the proposed Non-Standard Unit, the acreage to be dedicated to the proposed unit, and showing all offset operated properties and wells.

In view of the facts submitted, Chevron U.S.A. Inc. requests that administrative approval of the subject 160 acre Non-Standard Proration Unit be granted.

Yours very truly,

  
R. C. ANDERSON

MWC/skc  
Att'd

cc: OCD-Hobbs

CERTIFIED MAIL - RETURN RECEIPT REQUESTED

Texaco, Inc.  
P. O. Box 728  
Hobbs, New Mexico 88240

Marathon Oil Co.  
P. O. Box 552  
Midland, Texas 79702

Summit Energy Co.  
1925 Mercantile  
Dallas Bldg.  
Dallas, Texas 75201

## WELL LOCATION AND ACREAGE DEDICATION PLAT

Supplemental Form  
Effective 1-1-65

All distances must be from the outer boundaries of the Section.

Operator <b>Chevron U.S.A. Inc.</b>		Lease <b>Vivian</b>		Well No. <b>13</b>
Unit Letter <b>F</b>	Section <b>30</b>	Township <b>22S</b>	Range <b>38E</b>	County <b>Lea</b>
Actual Footage Location of Well: <b>2111</b> feet from the <b>North</b> line and <b>1962</b> feet from the <b>West</b> line				
Ground Level Elev. <b>3335.5</b>	Producing Formation <b>Tubb</b>	Pool <b>Tubb Oil and Gas</b>		Dedicated Acreage: <b>160</b> Acres

1. Outline the acreage dedicated to the subject well by colored pencil or hachure marks on the plat below.
2. If more than one lease is dedicated to the well, outline each and identify the ownership thereof (both as to working interest and royalty).
3. If more than one lease of different ownership is dedicated to the well, have the interests of all owners been consolidated by communitization, unitization, force-pooling, etc?

☐ Yes ☐ No If answer is "yes," type of consolidation \_\_\_\_\_

If answer is "no," list the owners and tract descriptions which have actually been consolidated. (Use reverse side of this form if necessary.) \_\_\_\_\_

No allowable will be assigned to the well until all interests have been consolidated (by communitization, unitization, forced-pooling, or otherwise) or until a non-standard unit, eliminating such interests, has been approved by the Commission.

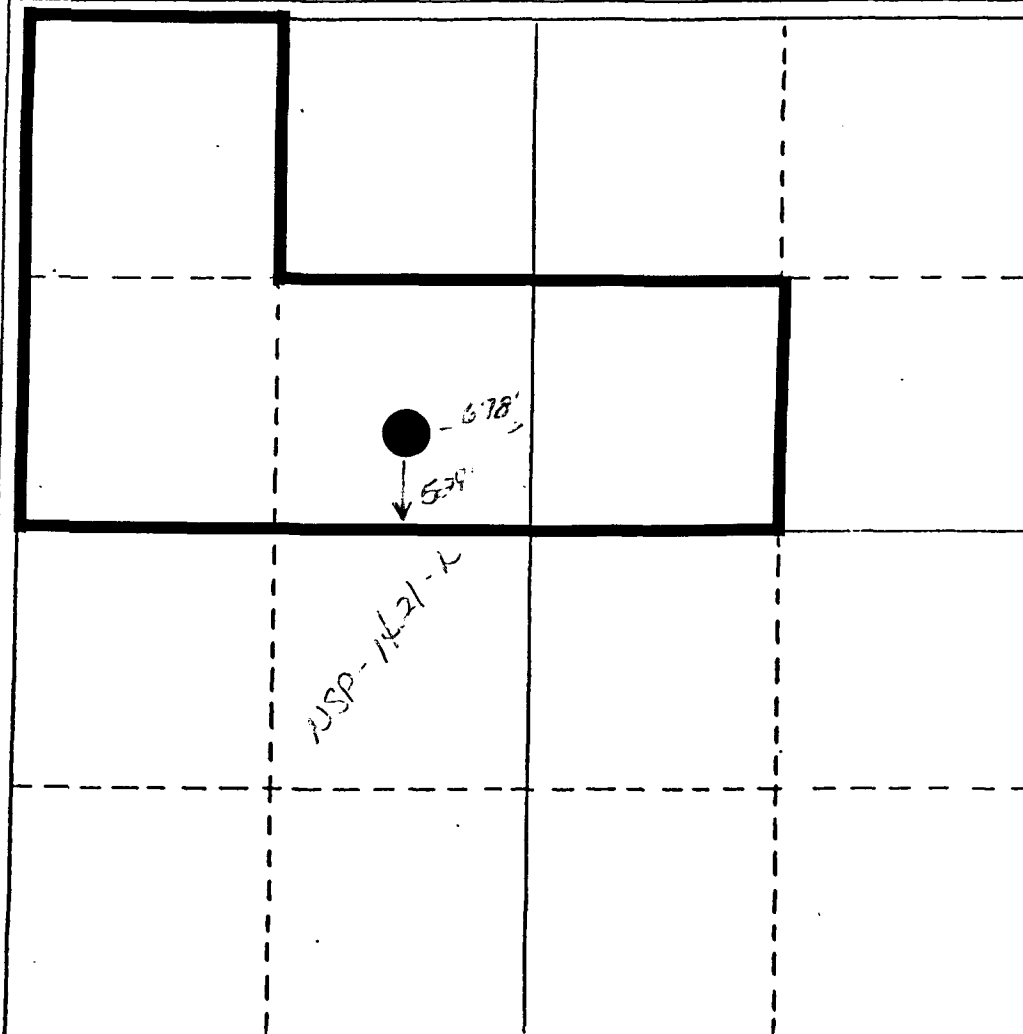

## CERTIFICATION

I hereby certify that the information contained herein is true and complete to the best of my knowledge and belief.

*R. D. Pitre*

Name

R. D. Pitre

Position

Division Petroleum Engineer

Company

Chevron U.S.A. Inc.

Date

August 29, 1985

I hereby certify that the well location shown on this plat was plotted from field notes of actual surveys made by me or under my supervision, and that the same is true and correct to the best of my knowledge and belief.

Date Surveyed

Registered Professional Engineer  
and/or Land Surveyor

Certificate No.

0 330 660 990 1320 1650 1980 2310 2640 2000 1500 1000 500 0

