

EXXON COMPANY, U.S.A.

POST OFFICE BOX 1600 • MIDLAND, TEXAS 79702-1600

NEW MEXICO OIL CONSERVATION DIVISION

ALBUQUERQUE, NM 87103

MAY 17 1994 8 50

PRODUCTION DEPARTMENT
SOUTHWESTERN DIVISION

ENVIRONMENTAL AND REGULATORY AFFAIRS

May 17, 1994

Non-Standard Gas Proration Unit
Simultaneous Dedication
Unorthodox Locations
Eumont Yates Seven Rivers Queen (Pro Gas)
Eumont Gas Com 2
Wells #1, 2, and 3
Section 29, T21S, R36E

Mr. William J. Le May
New Mexico Oil Conservation Division
P.O. Box 2088
Santa Fe, New Mexico 87504-2088

Dear Mr. Le May:

Exxon Corporation is requesting administrative approval of a 200 acre, Non-Standard Gas Proration Unit and Simultaneous Dedication for the Eumont Gas Com 2 Wells #1, 2, and 3 in the Eumont Yates Seven Rivers Queen (Pro Gas) Pool. This 200 acre Non-Standard Gas Proration Unit will consist of Unit letters I, J, K, L, and N.

A 160 acre Non-Standard Gas Proration Unit (Unit Letters I, J, K, and L) was previously approved for wells #1 and 2 (NSP-1688). A workover on #3 caused it to go from an oil well to a gas well, therefore, administrative approval is being requested for a 200 acre Non-Standard Gas Proration Unit, Simultaneous Dedication and Unorthodox locations for #1 and #3.

Enclosed is a copy of the cover letter, C-102 and C-103, that were sent to the Offset Operators and the District Office for each well. Also enclosed is a copy of the certified receipts. If you have any questions, please call me at (915) 6788-6782.

Sincerely,



Alex M. Correa
Senior Regulatory Specialist

AMC:mym
Enclosures
5\msgpu.ltr

Certified Mail Receipt No. P 322 579 804

A DIVISION OF EXXON CORPORATION



OFFSET OPERATORS

Exxon Corp.
Eumont Gas Com 2
Wells #1 and #2 and #3
Section 29, T 21S-R 36E
Lea County, New Mexico

ARCO Oil & Gas Company
P. O. Box 2819
Dallas, TX 75231
ATTN: Land Department

C. E. Long
P. O. Box 1943
Midland, TX 79702-1943

Conoco, Inc.
P. O. Box 4783
Houston, TX 77002
ATTN: Land Department

John H Hendrix Corporation
223 W. Wall, Suite 525
Midland, TX 79701

Lewis B. Burleson &
wife Kathryn K. Burleson
P. O. Box 2479
Midland, TX 79702

MKA Oil Properties
C/O Michael L. Klein
505 Midland National Bank Tower
Midland, TX 79701

Meridian Oil Inc.
P. O. Box 51810
Midland, TX 79710
ATTN: Land Department

Oxy USA Incorporated
P. O. Box 50250
Midland, TX 79705
ATTN: Land Department

Shell Western E & P Inc.
P. O. Box 576
Houston, TX 77001
ATTN: Land Department

Texaco, Inc.
P. O. Box 3109
Midland, TX 79702
ATTN: Land Department

Exxon Corp.
P. O. Box 1600, ML 14
Midland, TX 79702
ATTN: C. H. Harper

- Complete items 1 and/or 2 for additional services.
- Complete items 3, and 4a & b.
- Print your name and address on the reverse of this form so that we can return this card to you.
- Attach this form to the front of the mailpiece, or on the back if space does not permit.
- Write "Return Receipt Requested" on the mailpiece below the article number.
- The Return Receipt will show to whom the article was delivered and the date delivered.

3. Article Addressed to:

Conoco, Inc.
P.O. Box 4783
Houston, TX 77002
Attn: Land Dept.

4a. Article Number
P 322 579 794

4b. Service Type
☐ Registered ☐ Insured
☒ Certified ☐ COD
☐ Express Mail ☒ Return Receipt for Merchandise

7. Date of Delivery
MAY 4 1994

8. Addressee's Address (Only if requested and fee is paid)

PS Form 3811, December 1991 ☆ U.S.G.P.O.: 1992-307-530 DOMESTIC RETURN RECEIPT

Thank you for using Return Receipt Service.

SENDER:

- Complete items 1 and/or 2 for additional services.
- Complete items 3, and 4a & b.
- Print your name and address on the reverse of this form so that we can return this card to you.
- Attach this form to the front of the mailpiece, or on the back if space does not permit.
- Write "Return Receipt Requested" on the mailpiece below the article number.
- The Return Receipt will show to whom the article was delivered and the date delivered.

3. Article Addressed to:

Exxon Corp.
P.O. Box 1600, ML-14
Midland, TX 79702

4a. Article Number
P 322 579 802

4b. Service Type
☐ Registered ☐ Insured
☒ Certified ☐ COD
☐ Express Mail ☒ Return Receipt for Merchandise

7. Date of Delivery
MAY - 2 1994

8. Addressee's Address (Only if requested and fee is paid)

PS Form 3811, December 1991 ☆ U.S.G.P.O.: 1992-307-530 DOMESTIC RETURN RECEIPT

Thank you for using Return Receipt Service.

Is your RETURN ADDRESS completed on the reverse side?

- Complete items 1 and/or 2 for additional services.
- Complete items 3, and 4a & b.
- Print your name and address on the reverse of this form so that we can return this card to you.
- Attach this form to the front of the mailpiece, or on the back if space does not permit.
- Write "Return Receipt Requested" on the mailpiece below the article number.
- The Return Receipt will show to whom the article was delivered and the date delivered.

3. Article Addressed to:

ARC0 011 & Gas Company
P.O. Box 2819
Dallas, TX 75224
ATTN: Land Department

4a. Article Number
P 322 579 792

4b. Service Type
☐ Registered ☐ Insured
☒ Certified ☐ COD
☐ Express Mail ☒ Return Receipt for Merchandise

7. Date of Delivery
MAY 4 1994

8. Addressee's Address (Only if requested and fee is paid)

PS Form 3811, December 1991 ☆ U.S.G.P.O.: 1992-307-530 DOMESTIC RETURN RECEIPT

Thank you for using Return Receipt Service.

SENDER:

- Complete items 1 and/or 2 for additional services.
- Complete items 3, and 4a & b.
- Print your name and address on the reverse of this form so that we can return this card to you.
- Attach this form to the front of the mailpiece, or on the back if space does not permit.
- Write "Return Receipt Requested" on the mailpiece below the article number.
- The Return Receipt will show to whom the article was delivered and the date delivered.

3. Article Addressed to:

Lewis B. Burleson &
wife Kathryn K. Burleson
P.O. Box 2479
Midland, TX 79702

4a. Article Number
P 322 579 796

4b. Service Type
☐ Registered ☐ Insured
☒ Certified ☐ COD
☐ Express Mail ☒ Return Receipt for Merchandise

7. Date of Delivery

8. Addressee's Address (Only if requested and fee is paid)

PS Form 3811, December 1991 ☆ U.S.G.P.O.: 1992-307-530 DOMESTIC RETURN RECEIPT

Thank you for using Return Receipt Service.

SENDER:

- Complete items 1 and/or 2 for additional services.
- Complete items 3, and 4a & b.
- Print your name and address on the reverse of this form so that we can return this card to you.
- Attach this form to the front of the mailpiece, or on the back if space does not permit.
- Write "Return Receipt Requested" on the mailpiece below the article number.
- The Return Receipt will show to whom the article was delivered and the date delivered.

3. Article Addressed to:

MKA Oil Properties
C/O Michael L. Klein
505 Midland National Bank Tower
Midland, TX 79701

4a. Article Number

P 322 579 797

4b. Service Type

- ☐ Registered ☐ Insured
☒ Certified ☐ COD
☐ Express Mail ☒ Return Receipt for Merchandise

7. Date of Delivery

5/2/94

8. Addressee's Address (Only if requested and fee is paid)

Signature (Agent)

PS Form 3811, December 1991 ☆ U.S.G.P.O.: 1992-307-530 **DOMESTIC RETURN RECEIPT**

I also wish to receive the following services (for an extra fee):

1. ☐ Addressee's Address
2. ☐ Restricted Delivery
Consult postmaster for fee.

Thank you for using Return Receipt Service.

SENDER:

- Complete items 1 and/or 2 for additional services.
- Complete items 3, and 4a & b.
- Print your name and address on the reverse of this form so that we can return this card to you.
- Attach this form to the front of the mailpiece, or on the back if space does not permit.
- Write "Return Receipt Requested" on the mailpiece below the article number.
- The Return Receipt will show to whom the article was delivered and the date delivered.

3. Article Addressed to:

John H. Hendrix Corporation
223 W. Wall, Suite 525
Midland, TX 79701

4a. Article Number

P 322 579 795

4b. Service Type

- ☐ Registered ☐ Insured
☒ Certified ☐ COD
☐ Express Mail ☒ Return Receipt for Merchandise

7. Date of Delivery

5/2/94

8. Addressee's Address (Only if requested and fee is paid)

Signature (Agent)

PS Form 3811, December 1991 ☆ U.S.G.P.O.: 1992-307-530 **DOMESTIC RETURN RECEIPT**

I also wish to receive the following services (for an extra fee):

1. ☐ Addressee's Address
2. ☐ Restricted Delivery
Consult postmaster for fee.

Thank you for using Return Receipt Service.

SENDER:

- Complete items 1 and/or 2 for additional services.
- Complete items 3, and 4a & b.
- Print your name and address on the reverse of this form so that we can return this card to you.
- Attach this form to the front of the mailpiece, or on the back if space does not permit.
- Write "Return Receipt Requested" on the mailpiece below the article number.
- The Return Receipt will show to whom the article was delivered and the date delivered.

3. Article Addressed to:

Meridian Oil Inc.
P.O. Box 51810
Midland, TX 79710
Attn: Land Dept.

4a. Article Number

P 322 579 798

4b. Service Type

- ☐ Registered ☐ Insured
☒ Certified ☐ COD
☐ Express Mail ☒ Return Receipt for Merchandise

7. Date of Delivery

5-2

8. Addressee's Address (Only if requested and fee is paid)

Signature (Agent)

PS Form 3811, December 1991 ☆ U.S.G.P.O.: 1992-307-530 **DOMESTIC RETURN RECEIPT**

I also wish to receive the following services (for an extra fee):

1. ☐ Addressee's Address
2. ☐ Restricted Delivery
Consult postmaster for fee.

Thank you for using Return Receipt Service.

SENDER:

- Complete items 1 and/or 2 for additional services.
- Complete items 3, and 4a & b.
- Print your name and address on the reverse of this form so that we can return this card to you.
- Attach this form to the front of the mailpiece, or on the back if space does not permit.
- Write "Return Receipt Requested" on the mailpiece below the article number.
- The Return Receipt will show to whom the article was delivered and the date delivered.

3. Article Addressed to:

C. E. Long
P.O. Box 1943
Midland, TX 79702-1943

4a. Article Number

P 322 579 793

4b. Service Type

- ☐ Registered ☐ Insured
☒ Certified ☐ COD
☐ Express Mail ☒ Return Receipt for Merchandise

7. Date of Delivery

MAY - 2 1994

8. Addressee's Address (Only if requested and fee is paid)

Signature (Agent)

PS Form 3811, December 1991 ☆ U.S.G.P.O.: 1992-307-530 **DOMESTIC RETURN RECEIPT**

I also wish to receive the following services (for an extra fee):

1. ☐ Addressee's Address
2. ☐ Restricted Delivery
Consult postmaster for fee.

Thank you for using Return Receipt Service.

Is your RETURN ADDRESS completed on the reverse side?

PS Form 3811, December 1991 ☆ U.S.G.P.O.: 1992-307-530

SENDER:

- Complete items 1 and/or 2 for additional services.
- Complete items 3, and 4a & b.
- Print your name and address on the reverse of this form so that we can return this card to you.
- Attach this form to the front of the mailpiece, or on the back if space does not permit.
- Write "Return Receipt Requested" on the mailpiece below the article number. The Return Receipt will show to whom the article was delivered and the date delivered.

3. Article Addressed to:

Texaco, Inc.
P.O. Box 3109
Midland, TX 79705
Attn: Land Dept

4a. Article Number
P 322 579 801

4b. Service Type
☐ Registered
☒ Certified
☐ Insured

4c. Return Receipt for Merchandise
☒ Express Mail

7. Date of Delivery
MAY - 2 1994

8. Addressee's Address (Only if requested and fee is paid)

5. Signature (Addressee)

6. Signature (Agent)
John H. Hoyer

1. ☐ Addressee's Address

2. ☐ Restricted Delivery

Consult postmaster for fee.

I also wish to receive the following services (for an extra fee):

1. ☐ Addressee's Address

2. ☐ Restricted Delivery

Consult postmaster for fee.

PS Form 3811, December 1991 ☆ U.S.G.P.O.: 1992-307-530

Thank you for using Return Receipt Service.

Is your RETURN ADDRESS completed on the reverse side?

PS Form 3811, December 1991 ☆ U.S.G.P.O.: 1992-307-530

SENDER:

- Complete items 1 and/or 2 for additional services.
- Complete items 3, and 4a & b.
- Print your name and address on the reverse of this form so that we can return this card to you.
- Attach this form to the front of the mailpiece, or on the back if space does not permit.
- Write "Return Receipt Requested" on the mailpiece below the article number. The Return Receipt will show to whom the article was delivered and the date delivered.

3. Article Addressed to:

Oxy USA Incorporated
Attn: Land Dept.
P.O. Box 50250
Midland, TX 79705

4a. Article Number
P 322 579 799

4b. Service Type
☐ Registered
☒ Certified
☐ Insured

4c. Return Receipt for Merchandise
☐ Express Mail

7. Date of Delivery

8. Addressee's Address (Only if requested and fee is paid)

5. Signature (Addressee)

6. Signature (Agent)
John H. Hoyer

1. ☐ Addressee's Address

2. ☐ Restricted Delivery

Consult postmaster for fee.

I also wish to receive the following services (for an extra fee):

1. ☐ Addressee's Address

2. ☐ Restricted Delivery

Consult postmaster for fee.

PS Form 3811, December 1991 ☆ U.S.G.P.O.: 1992-307-530

Thank you for using Return Receipt Service.

Is your RETURN ADDRESS completed on the reverse side?

PS Form 3811, December 1991 ☆ U.S.G.P.O.: 1992-307-530

SENDER:

- Complete items 1 and/or 2 for additional services.
- Complete items 3, and 4a & b.
- Print your name and address on the reverse of this form so that we can return this card to you.
- Attach this form to the front of the mailpiece, or on the back if space does not permit.
- Write "Return Receipt Requested" on the mailpiece below the article number. The Return Receipt will show to whom the article was delivered and the date delivered.

3. Article Addressed to:

Shell Western E&P Inc.
P.O. Box 576
Houston, TX 77001
Attn: Land Dept.

4a. Article Number
P 322 579 800

4b. Service Type
☐ Registered
☒ Certified
☐ Insured

4c. Return Receipt for Merchandise
☐ Express Mail

7. Date of Delivery
MAY - 3 1994

8. Addressee's Address (Only if requested and fee is paid)

5. Signature (Addressee)

6. Signature (Agent)
John H. Hoyer

1. ☐ Addressee's Address

2. ☐ Restricted Delivery

Consult postmaster for fee.

I also wish to receive the following services (for an extra fee):

1. ☐ Addressee's Address

2. ☐ Restricted Delivery

Consult postmaster for fee.

PS Form 3811, December 1991 ☆ U.S.G.P.O.: 1992-307-530

Thank you for using Return Receipt Service.

DISTRICT I
P.O. Box 1980, Hobbs, NM 88240

DISTRICT II
P.O. Drawer DD, Artesia, NM 88210

DISTRICT III
1000 Rio Brazos Rd., Aztec, NM 87410

OIL CONSERVATION DIVISION
P O. Box 2088
Santa Fe, New Mexico 87504-2088

WELL API NO. 3002504823
5. Indicate Type of Lease STATE <input checked="" type="checkbox"/> FEE <input type="checkbox"/>
6. State Oil & Gas Lease No. B-935
7. Lease Name or Unit Agreement Name EUMONT GAS COM 2
8. Well No. 1
9. Pool name or Wildcat EUMONT YATES 7 RVRS QN (PRO GAS)

SUNDRY NOTICES AND REPORTS ON WELLS (DO NOT USE THIS FORM FOR PROPOSALS TO DRILL OR TO DEEPEN OR PLUG BACK TO A DIFFERENT RESERVOIR. USE "APPLICATION FOR PERMIT" (FORMC-101) FOR SUCH PROPOSALS.)	
1. Type of Well: OIL WELL <input type="checkbox"/> GAS WELL <input checked="" type="checkbox"/> OTHER	
2. Name of Operator EXXON CORPORATION	
3. Address of Operator ATTN: REGULATORY AFFAIRS P. O. BOX 1600 MIDLAND, TX 79702	
4. Well Location Unit Letter I : 1980 Feet From The SOUTH Line and 660 Feet From The EAST Line Section 29 Township 21S Range 36E NMPM LEA County	
10. Elevation (Show whether DF, RKB, RT, GR, etc.) 3637 GR	

Check Appropriate Box to Indicate Nature of Notice, Report, or Other Data

NOTICE OF INTENTION TO:

PERFORM REMEDIAL WORK ☐ PLUG AND ABANDON ☐
TEMPORARILY ABANDON ☐ CHANGE PLANS ☐
PULL OR ALTER CASING ☐
OTHER: **EXPAND PRORATION UNIT/SIMO DED** ☒

SUBSEQUENT REPORT OF:

REMEDIAL WORK ☐ ALTERING CASING ☐
COMMENCE DRILLING OPNS. ☐ PLUG & ABANDONMENT ☐
CASING TEST AND CEMENT JOB ☐
OTHER: ☐

12. Describe Proposed or Completed Operations (Clearly state all pertinent details, and give pertinent dates, including estimated date of starting any proposed work) SEE RULE 1103.

AUTHORIZATION IS REQUESTED TO EXPAND THE PRESENT NON-STANDARD GAS PRORATION UNIT IN THE EUMONT YATES 7 RVRS QN (PRO GAS) POOL FROM 160 ACS TO 200 ACS. THE NEW 200 AC PRORATION UNIT WILL BE UNIT LETTERS I, J, K, L AND N. THIS EXPANSION WILL INCLUDED THE 40 ACS. ASSIGNED TO THE NM B ST #10 THAT IS NOW A GAS WELL AFTER PERFS. WERE ADDED. APPROVAL FOR THE EXISTING 160 AC. NON-STANDARD GAS PRORATION UNIT WAS GRANTED BY ADM. ORDER NSP-1688. CONVERTING THE NM B ST. #10 TO A GAS WELL WILL REQUIRE THE NAME TO BE CHANGED TO THE EUMONT GAS COM 2 WELL #3.

**ADMINISTRATIVE APPROVAL IS ALSO BEING REQUESTED FOR SIMULTANEOUS DECICATION OF WELL #'S 1, 2 AND 3.
C-102 IS ATTACHED.**

I hereby certify that the information above is true and complete to the best of my knowledge and belief.

SIGNATURE *Alex M. Correa* TITLE Sr. Regulatory Specialist DATE 04/26/94
TYPE OR PRINT NAME Alex M. Correa (915) 688-6782 TELEPHONE NO.

(This space for State Use)

APPROVED BY _____ TITLE _____ DATE _____

CONDITIONS OF APPROVAL, IF ANY:

All distances must be from the outer boundaries of the Section.

1. Outline the acreage dedicated to the subject well by colored pencil or hachure marks on the plat below.
2. If more than one lease is dedicated to the well, outline each and identify the ownership thereof (both as to working interest and royalty).
3. If more than one lease of different ownership is dedicated to the well, have the interest of all owners been consolidated by communitization, unitization, force-pooling, etc.?

☐ Yes ☐ No If answer is "yes", type of consolidation

If answer is "no", list the owners and tract descriptions which have actually been consolidated. (Use reverse side of this form if necessary.)

No allowable will be assigned to the well until all interests have been consolidated (by communitization, unitization, forced-pooling, or otherwise) or until a non-standard unit, eliminating such interest, has been approved by the Division.

I hereby certify that the information
contained herein is true and complete to the
best of my knowledge and belief.

Signature

Printed Name
C.H. HARPER

Position	PERMITS SUPERVISOR
----------	--------------------

Company Exxon Corporation
P.O. Box 1600—Midland, Tx.—79702

Date 4/26/94

I hereby certify that the well location shown on this plat was plotted from field notes of actual surveys made by me or under my supervision, and that the same is true and correct to the best of my knowledge and belief.

Date Surveyed 12/9/35

Signature & Seal of
Professional Surveyor

Certificate No.

C.E. File No. A01970

4 Miles SSW of OIL CENTER, New Mexico.

DISTRICT I
P.O. Box 1980, Hobbs, NM 88240

DISTRICT II
P.O. Drawer DD, Artesia, NM 88210

DISTRICT III
1000 Rio Brazos Rd., Aztec, NM 87410

OIL CONSERVATION DIVISION

P O. Box 2088
Santa Fe, New Mexico 87504-2088

WELL API NO. 3002504825
5. Indicate Type of Lease STATE <input checked="" type="checkbox"/> FEE <input type="checkbox"/>
6. State Oil & Gas Lease No. B-935
7. Lease Name or Unit Agreement Name EUMONT GAS COM 2
8. Well No. 2
9. Pool name or Wildcat EUMONT YATES 7 RVRS QN (PRO GAS)

SUNDRY NOTICES AND REPORTS ON WELLS (DO NOT USE THIS FORM FOR PROPOSALS TO DRILL OR TO DEEPEN OR PLUG BACK TO A DIFFERENT RESERVOIR. USE "APPLICATION FOR PERMIT" (FORMC-101) FOR SUCH PROPOSALS.)	
1. Type of Well: OIL <input type="checkbox"/> GAS <input checked="" type="checkbox"/> OTHER	
2. Name of Operator EXXON CORPORATION	
3. Address of Operator ATTN: REGULATORY AFFAIRS P. O. BOX 1600 MIDLAND, TX 79702	
4. Well Location Unit Letter K : 1980 Feet From The SOUTH Line and 1980 Feet From The WEST Line Section 29 Township 21S Range 36E NMPM LEA County	
10. Elevation (Show whether DF, RKB, RT, GR, etc.) 3639 DF	

Check Appropriate Box to Indicate Nature of Notice, Report, or Other Data

NOTICE OF INTENTION TO:

PERFORM REMEDIAL WORK ☐ PLUG AND ABANDON ☐
TEMPORARILY ABANDON ☐ CHANGE PLANS ☐
PULL OR ALTER CASING ☐
OTHER: **EXPAND PRORATION UNIT/SIMO DED** ☒

SUBSEQUENT REPORT OF:

REMEDIAL WORK ☐ ALTERING CASING ☐
COMMENCE DRILLING OPNS. ☐ PLUG & ABANDONMENT ☐
CASING TEST AND CEMENT JOB ☐
OTHER: ☐

12. Describe Proposed or Completed Operations (Clearly state all pertinent details, and give pertinent dates, including estimated date of starting any proposed work) SEE RULE 1103.

AUTHORIZATION IS REQUESTED TO EXPAND THE PRESENT NON-STANDARD GAS PRORATION UNIT IN THE EUMONT YATES 7 RVRS QN (PRO GAS) POOL FROM 160 ACS TO 200 ACS. THE NEW 200 AC PRORATION UNIT WILL BE UNIT LETTES I, J, K, L AND N. THIS EXPANSION WILL INCLUDE THE 40 ACS. ASSIGNED TO THE NM B ST #10 THAT IS NOW A GAS WELL AFTER PERFS. WERE ADDED. APPROVAL FOR THE EXISTING 160 AC. NON-STANDARD GAS PRORATION UNIT WAS GRANTED BY ADM. ORDER NSP-1688. CONVERTING THE NM B ST. #10 TO A GAS WELL WILL REQUIRE THE NAME TO BE CHANGED TO THE EUMONT GAS COM 2 WELL # 3.

ADMINISTRATIVE APPROVAL IS ALSO BEING REQUESTED FOR SIMULTANEOUS DEDICATION OF WELL #'S 1, 2 AND 3.
C-102 IS ATTACHED.

I hereby certify that the information above is true and complete to the best of my knowledge and belief.

SIGNATURE Alex M. Correa TITLE Sr. Regulatory Specialist DATE 04/26/94

TYPE OR PRINT NAME Alex M. Correa (915) 688-6782 TELEPHONE NO.

(This space for State Use)

APPROVED BY _____ TITLE _____ DATE _____

CONDITIONS OF APPROVAL, IF ANY:

OIL CONSERVATION DIVISION

DISTRICT I
P.O. Box 1980, Hobbs, NM 88240

P.O. Box 2088
Santa Fe, New Mexico 87504-2088

DISTRICT II
P.O. Drawer DD, Artesia, NM 88210

DISTRICT III
1000 Rio Brazos Rd., Aztec, NM 87410

WELL LOCATION AND ACREAGE DEDICATION PLAT

All distances must be from the outer boundaries of the Section.

Operator Exxon Corporation			Lease EUMONT GAS COM 2		Well No. 2
Unit Letter K	Section 29	Township 21	Range 36	County NMPM	LEA
Actual Footage Location of Well: 1980 feet from the SOUTH line and 1980 feet from the WEST line.					
Ground level Elev. 3639 DF	Producing Formation YATES 7 RIVERS QN	Pool EUMONT YATES 7 RVRS QN (PRO GAS)		Dedicated Acreage: 200 Acres	

- Outline the acreage dedicated to the subject well by colored pencil or hachure marks on the plat below.
- If more than one lease is dedicated to the well, outline each and identify the ownership thereof (both as to working interest and royalty).
- If more than one lease of different ownership is dedicated to the well, have the interest of all owners been consolidated by communitization, unitization, force-pooling, etc.?
☐ Yes ☐ No If answer is "yes", type of consolidation _____
If answer is "no", list the owners and tract descriptions which have actually been consolidated. (Use reverse side of this form if necessary.) _____

No allowable will be assigned to the well until all interests have been consolidated (by communitization, unitization, forced-pooling, or otherwise) or until a non-standard unit, eliminating such interest, has been approved by the Division.

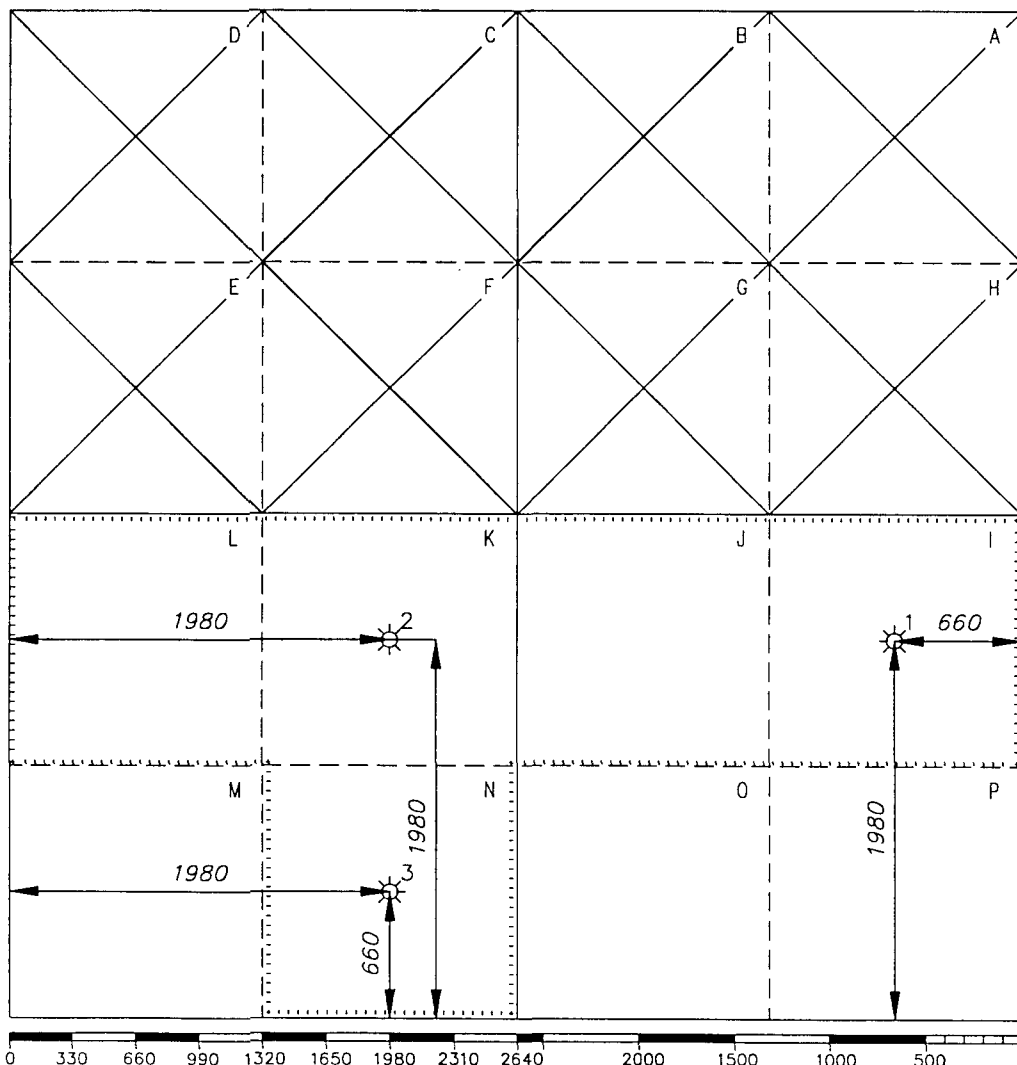

OPERATOR CERTIFICATION

I hereby certify that the information contained herein is true and complete to the best of my knowledge and belief.

Signature *C.H. Harper*

Printed Name
C.H. HARPER

Position
PERMITS SUPERVISOR

Company Exxon Corporation
P.O. Box 1600-Midland, Tx.-79702

Date
4/26/94

SURVEYOR CERTIFICATION

I hereby certify that the well location shown on this plat was plotted from field notes of actual surveys made by me or under my supervision, and that the same is true and correct to the best of my knowledge and belief.

Date Surveyed

Signature & Seal of
Professional Surveyor

Certificate No.

DISTRICT I
P.O. Box 1980, Hobbs, NM 88240

DISTRICT II
P.O. Drawer DD, Artesia, NM 88210

DISTRICT III
1000 Rio Brazos Rd., Aztec, NM 87410

OIL CONSERVATION DIVISION

P O. Box 2088
Santa Fe, New Mexico 87504-2088

WELL API NO. 3002504826
5. Indicate Type of Lease STATE <input checked="" type="checkbox"/> FEE <input type="checkbox"/>
6. State Oil & Gas Lease No. B 935
7. Lease Name or Unit Agreement Name EUMONT GAS COM 2
8. Well No. 3
9. Pool name or Wildcat EUMONT YATES 7 RVRS QN (PRO GAS)

SUNDRY NOTICES AND REPORTS ON WELLS (DO NOT USE THIS FORM FOR PROPOSALS TO DRILL OR TO DEEPEN OR PLUG BACK TO A DIFFERENT RESERVOIR. USE "APPLICATION FOR PERMIT" (FORMC-101) FOR SUCH PROPOSALS.)	
1. Type of Well: OIL <input type="checkbox"/> GAS <input checked="" type="checkbox"/> OTHER	
2. Name of Operator EXXON CORPORATION	
3. Address of Operator ATTN: REGULATORY AFFAIRS P. O. BOX 1600 MIDLAND, TX 79702	
4. Well Location Unit Letter N : 660 Feet From The SOUTH Line and 1980 Feet From The WEST Line Section 29 Township 21S Range 36E NMPM LEA County	
10. Elevation (Show whether DF, RKB, RT, GR, etc.) 3620 GR	

Check Appropriate Box to Indicate Nature of Notice, Report, or Other Data

NOTICE OF INTENTION TO:

PERFORM REMEDIAL WORK ☐ PLUG AND ABANDON ☐
TEMPORARILY ABANDON ☐ CHANGE PLANS ☐
PULL OR ALTER CASING ☐
OTHER: CONVERT TO GAS WELL/SIMO DED. ☒

SUBSEQUENT REPORT OF:

REMEDIAL WORK ☐ ALTERING CASING ☐
COMMENCE DRILLING OPNS. ☐ PLUG & ABANDONMENT ☐
CASING TEST AND CEMENT JOB ☐
OTHER: ☐

12. Describe Proposed or Completed Operations (Clearly state all pertinent details, and give pertinent dates, including estimated date of starting any proposed work) SEE RULE 1103.

ADDING PERFS. CAUSED THIS WELL TO GO FROM AN OIL WELL TO A GAS WELL. THEREFORE, THE WELL NAME HAS BEEN CHANGED FROM THE NM B ST. #10 TO THE EUMONT GAS COM 2 #3. AUTHORIZATION IS REQUESTED TO SIMULTANEOUSLY DEDICATE WITH #'S 1 & 2. AUTHORIZATION IS ALSO REQUESTED FOR AN UNORTHODOX LOCATION FOR THE # 3 AND A 200 AC. NON-STANDARD GAS PRORATION UNIT COMPPOSED OF UNIT LETTERS I, J, K, L AND N IN THE EUMONT YATES 7 RVRS QN (PRO GAS) POOL.

C-102 IS ATTACHED.

I hereby certify that the information above is true and complete to the best of my knowledge and belief.

SIGNATURE Alex M. Correa TITLE Sr. Regulatory Specialist DATE 04/26/94

TYPE OR PRINT NAME Alex M. Correa (915) 688-6782 TELEPHONE NO.

(This space for State Use)

APPROVED BY _____ TITLE _____ DATE _____

CONDITIONS OF APPROVAL, IF ANY:

P.O. Box 2088
Santa Fe, New Mexico 87504-2088

DISTRICT III
1000 Rio Brazos Rd., Aztec, NM 87410

All distances must be from the outer boundaries of the Section.

1. Outline the acreage dedicated to the subject well by colored pencil or hatchure marks on the plat below.
2. If more than one lease is dedicated to the well, outline each and identify the ownership thereof (both as to working interest and royalty).
3. If more than one lease of different ownership is dedicated to the well, have the interest of all owners been consolidated by communitization, unitization, force-pooling, etc?
☐ Yes ☐ No If answer is "yes", type of consolidation _____
If answer is "no", list the owners and tract descriptions which have actually been consolidated. (Use reverse side of this form if necessary.) _____

No allowable will be assigned to the well until all interests have been consolidated (by communitization, unitization, forced-pooling, or otherwise) or until a non-standard unit, eliminating such interest, has been approved by the Division.



C.E. File No. A01970

EXXON COMPANY, U.S.A.

POST OFFICE BOX 1600 • MIDLAND, TEXAS 79702-1600

PRODUCTION DEPARTMENT
SOUTHWESTERN DIVISION

ENVIRONMENTAL AND REGULATORY AFFAIRS

April 26, 1994

Non-Standard Gas Proration Unit
Simultaneous Dedication
Unorthodox Locations
Eumont Yates Seven Rivers Queen (Pro Gas)
Wells #1, 2 and 3
Section 29, T21S-R36E
Lea County, New Mexico

Offset Operators

Gentlemen:

Exxon Corporation is requesting administrative approval of a 200 acre, Non-Standard Gas Proration Unit and Simultaneous Dedication for the Eumont Gas Com 2 Wells #1, 2 and 3 in the Eumont Yates Seven Rivers Queen (Pro Gas) Pool. This 200 acre Non-Standard Gas Proration Unit will consist of Unit letters I, J, K, L and N.

A 160 acre Non-Standard Gas Proration Unit (Unit letters I, J, K and L) was previously approved for wells #1 and 2. A workover on #3 caused it to go from an oil well to a gas well, therefore, administrative approval is being requested for a 200 acre Non-Standard Gas Proration Unit, Simultaneous Dedication and Unorthodox locations for #1 and #3.

If you have no objections to the above referenced request, please sign and return one copy of the enclosed waiver to the NMOCD office in Santa Fe and one copy to me. Return envelopes and copies of associated documents are enclosed.

If you have any questions, please call me at (915) 688-6782.

Sincerely,



Alex M. Correa
Senior Regulatory Specialist

AMC:mym
4\nsgpu.ltr

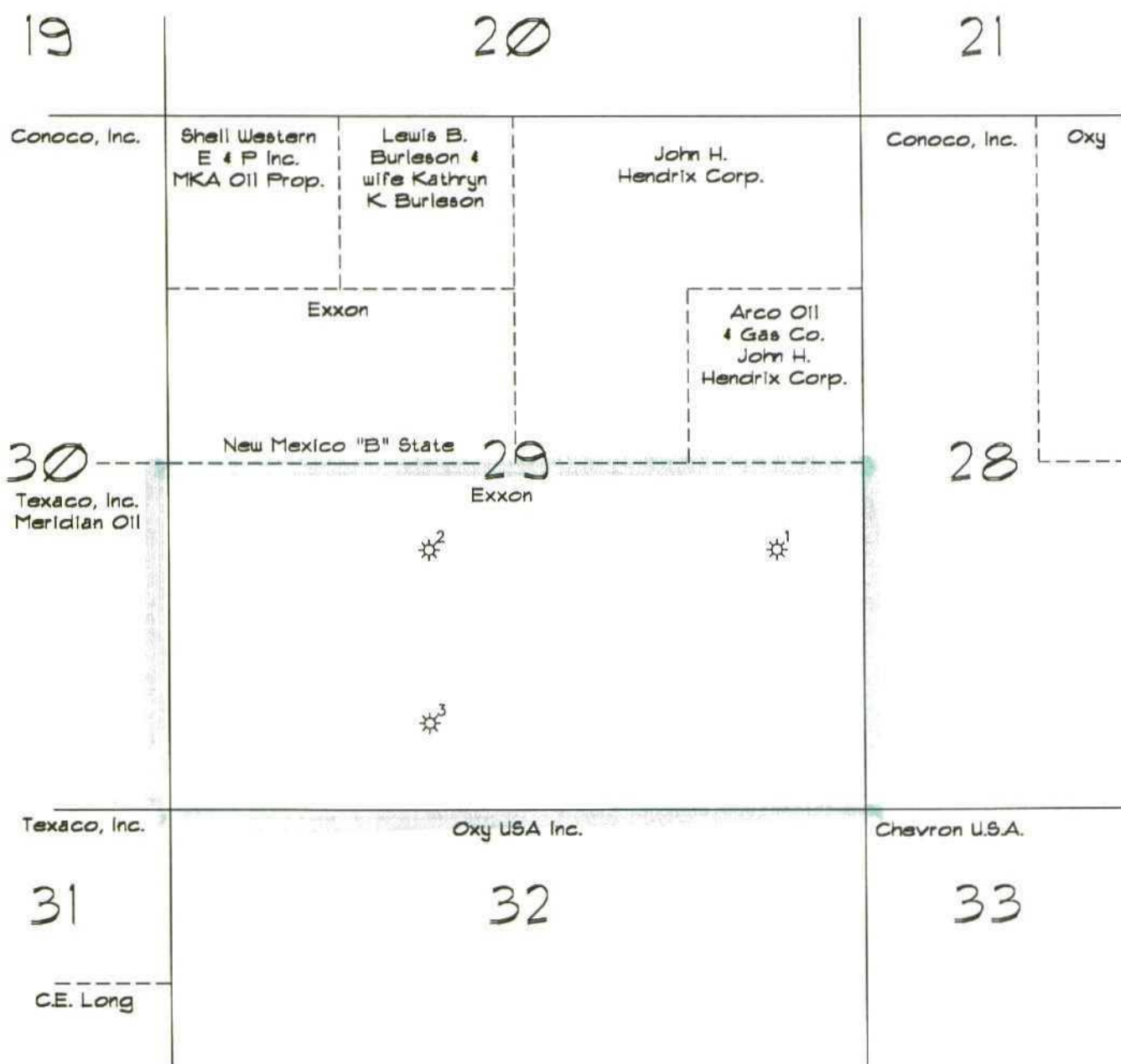

Eumont Gas Unit Com 2
A01970A

WAIVER

New Mexico Oil Conservation Division
P.O. Box 2088
Santa Fe, New Mexico 87504-2088

This is to advise that the undersigned has been given due notice that Exxon Corp. has made application for a 200 acre Non-Standard Gas Proration Unit and Simultaneous Dedication for the Exxon Corp., Eumont Gas Com 2 wells #1, 2 and 3 in the Eumont Yates 7 Rivers Queen (Pro Gas) Pool. This 200 acre Non-Standard Gas Proration Unit will consist of unit letters I, J, K, L, and N, Section 29, T21S-R36E, Lea County, New Mexico. Also, application was made for Unorthodox locations for wells #1 and 3.

We, the undersigned, hereby waive any objection to the granting of this application for a Non-Standard Gas Proration Unit consisting of 200 acres, Simultaneous Dedication and Unorthodox Locations for the Exxon Corporation, Eumont Gas Com 2 wells #1, 2, and 3 in the Eumont Yates 7 Rivers Queen (Pro Gas) Pool. Well #1 is located 1980' FSL & 660' FEL, #2 is located 1980' FSL & 1980' FWL and #3 is 660' FSL and 1980' FWL. These wells are in Section 29, T21S-R36E, Lea County, New Mexico.

Executed this _____ day of _____, 1994.

Company: _____

By: _____

WAIVER

MAY 05 1994

NGPA Permits

New Mexico Oil Conservation Division
P.O. Box 2088
Santa Fe, New Mexico 87504-2088

This is to advise that the undersigned has been given due notice that Exxon Corp. has made application for a 200 acre Non-Standard Gas Proration Unit and Simultaneous Dedication for the Exxon Corp., Eumont Gas Com 2 wells #1, 2 and 3 in the Eumont Yates 7 Rivers Queen (Pro Gas) Pool. This 200 acre Non-Standard Gas Proration Unit will consist of unit letters I, J, K, L, and N, Section 29, T21S-R36E, Lea County, New Mexico. Also, application was made for Unorthodox locations for wells #1 and 3.

We, the undersigned, hereby waive any objection to the granting of this application for a Non-Standard Gas Proration Unit consisting of 200 acres, Simultaneous Dedication and Unorthodox Locations for the Exxon Corporation, Eumont Gas Com 2 wells #1, 2, and 3 in the Eumont Yates 7 Rivers Queen (Pro Gas) Pool. Well #1 is located 1980' FSL & 660' FEL, #2 is located 1980' FSL & 1980' FWL and #3 is 660' FSL and 1980' FWL. These wells are in Section 29, T21S-R36E, Lea County, New Mexico.

Executed this 4 day of May, 1994.

Company:

John H. Hendrix Corp.

By:

Larry H. Wathen

WAIVER

MAY 05 1994
NGPA Permits

New Mexico Oil Conservation Division
P.O. Box 2088
Santa Fe, New Mexico 87504-2088

This is to advise that the undersigned has been given due notice that Exxon Corp. has made application for a 200 acre Non-Standard Gas Proration Unit and Simultaneous Dedication for the Exxon Corp., Eumont Gas Com 2 wells #1, 2 and 3 in the Eumont Yates 7 Rivers Queen (Pro Gas) Pool. This 200 acre Non-Standard Gas Proration Unit will consist of unit letters I, J, K, L, and N, Section 29, T21S-R36E, Lea County, New Mexico. Also, application was made for Unorthodox locations for wells #1 and 3.

We, the undersigned, hereby waive any objection to the granting of this application for a Non-Standard Gas Proration Unit consisting of 200 acres, Simultaneous Dedication and Unorthodox Locations for the Exxon Corporation, Eumont Gas Com 2 wells #1, 2, and 3 in the Eumont Yates 7 Rivers Queen (Pro Gas) Pool. Well #1 is located 1980' FSL & 660' FEL, #2 is located 1980' FSL & 1980' FWL and #3 is 660' FSL and 1980' FWL. These wells are in Section 29, T21S-R36E, Lea County, New Mexico.

Executed this 5 day of May, 1994.

Company: Lewis Berleson, Inc.

By: [Signature]