



RECEIVED
SEP 16 1996
SANTA FE, NM

RECEIVED
SEP 16 1996
SANTA FE, NM

September 16, 1996

Attn: Mr. Michael E. Stogner
NMOCD
2040 South Pacheco
Santa Fe, New Mexico

Mr. J. T. Sexton
NMOCD
P. O. Box 1980
Hobbs, New Mexico 88240

Re: Application for Non-Standard Gas Proration Unit & Unorthodox Location
C. H. Weir "B" #5
Unit G, Sec. 11, T20S, R37E,
Lea County, New Mexico

Dear Mr. Stogner and Mr. Sexton:

Enclosed is a plat containing the proposed 280-acre non-standard gas proration unit for the C. H. Weir "B" #5 as requested by Mr. Stogner by letter dated September 11, 1996. Also shown on this plat is the A. L. Christmas Lease which contained one Eumont gas well which has not produced since October 1993, and the Skaggs "B" Lease which contains one active Eumont gas well. Not shown on this plat is Conoco's SEMU Eumont lease comprising all of Section 14 except Unit A. This lease contains two active Eumont gas wells located in Units L and N.

The SE/4 of Section 11 was previously a Eumont Gas Pool non-standard proration unit created by Administrative Order NSP-553 dated May 11, 1961. This unit contained two Eumont gas wells located in Units I and J, but there has been no Eumont production from this proration unit since June 1974.

The NE/4 NE/4 of Section 11 is not included in this non-standard proration unit because it is included in the East Eumont Unit waterflood. The southern boundary of the East Eumont Unit is outlined in green on the attached offset operator map. If any additional information is required, please contact me at (505) 397-0413.

Sincerely,

Britton M. McQuien
Engineer
Texaco E&P Inc.

enc

DISTRICT I
P.O. Box 1980, Hobbs, NM 88241-1980
DISTRICT II
P.O. Box Drawer DD, Artesia, NM 88211-0719
DISTRICT III
1000 Rio Brazos Rd., Aztec, NM 87410
DISTRICT IV
P.O. Box 2088, Santa Fe, NM 87504-2088

State of New Mexico
Energy, Minerals and Natural Resources Department

Form C-102
Revised February 10, 1994
Instructions on back
Submit to Appropriate District Office
State Lease - 4 Copies
Fee Lease - 3 Copies

OIL CONSERVATION DIVISION

P.O. Box 2088
Santa Fe, New Mexico 87504-2088

☐ AMENDED REPORT

WELL LOCATION AND ACREAGE DEDICATION PLAT

¹ API Number 30 025 06062	² Pool Code 76480	³ Pool Name EUMONT; YATES-7 RVRS-QUEEN (PRO GAS)
⁴ Property Code 011132	⁵ Property Name WEIR, C. H. -B-	⁶ Well No. 5
⁷ OGRID Number 022351	⁸ Operator Name TEXACO EXPLORATION & PRODUCTION INC.	⁹ Elevation

¹⁰ Surface Location

UI or lot no. G	Section 11	Township 20S	Range 37E	Lot.Idn	Feet From The 1980'	North/South Line NORTH	Feet From The 1650'	East/West Line EAST	County LEA
--------------------	---------------	-----------------	--------------	---------	------------------------	---------------------------	------------------------	------------------------	---------------

¹¹ Bottom Hole Location If Different From Surface

UI or lot no.	Section	Township	Range	Lot.Idn	Feet From The	North/South Line	Feet From The	East/West Line	County
---------------	---------	----------	-------	---------	---------------	------------------	---------------	----------------	--------

¹² Dedicated Acres 280	¹³ Joint or Infill No	¹⁴ Consolidation Code	¹⁵ Order No.
--------------------------------------	-------------------------------------	----------------------------------	-------------------------

NO ALLOWABLE WILL BE ASSIGNED TO THIS COMPLETION UNTIL ALL INTERESTS HAVE BEEN CONSOLIDATED
OR A NON-STANDARD UNIT HAS BEEN APPROVED BY THE DIVISION

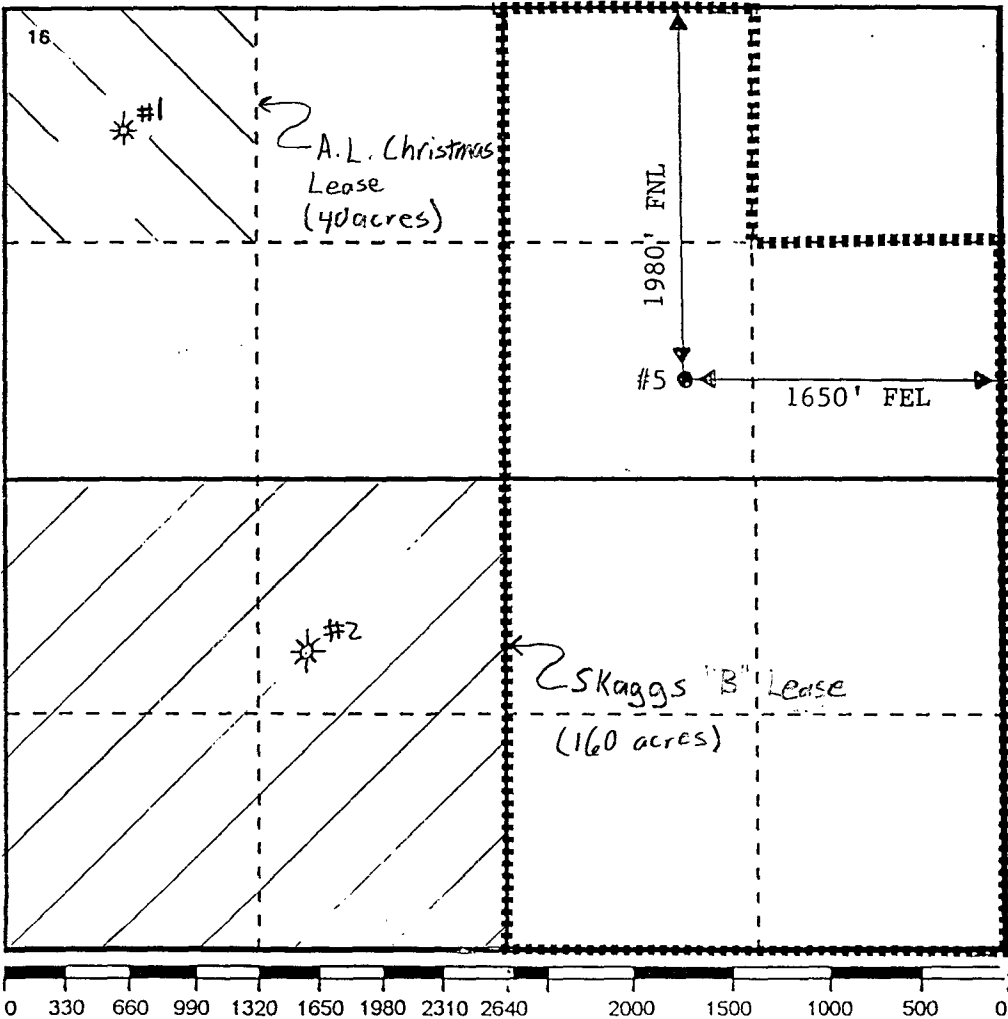

¹⁷ OPERATOR CERTIFICATION

I hereby certify that the information
contained herein is true and complete to the
best of my knowledge and belief

Signature
Paula S. Ives

Printed Name
Paula S. Ives

Position
Engineering Assistant

Date
8/15/96

¹⁸ SURVEYOR CERTIFICATION

I hereby certify that the well location shown
on this plat was plotted from field notes of
actual surveys made by me or under my
supervision, and that the same is true and
correct to the best of my knowledge and
belief.

Date Surveyed

Signature & Seal of
Professional Surveyor

Certificate No.

Offset Operators and all Lessees of Record
C. H. Weir "B" No. 5 Well
SW/4 NE/4 of Section 11, T-20-S, R-37-E
Eumont Formation
Lea County, New Mexico
August 9, 1996

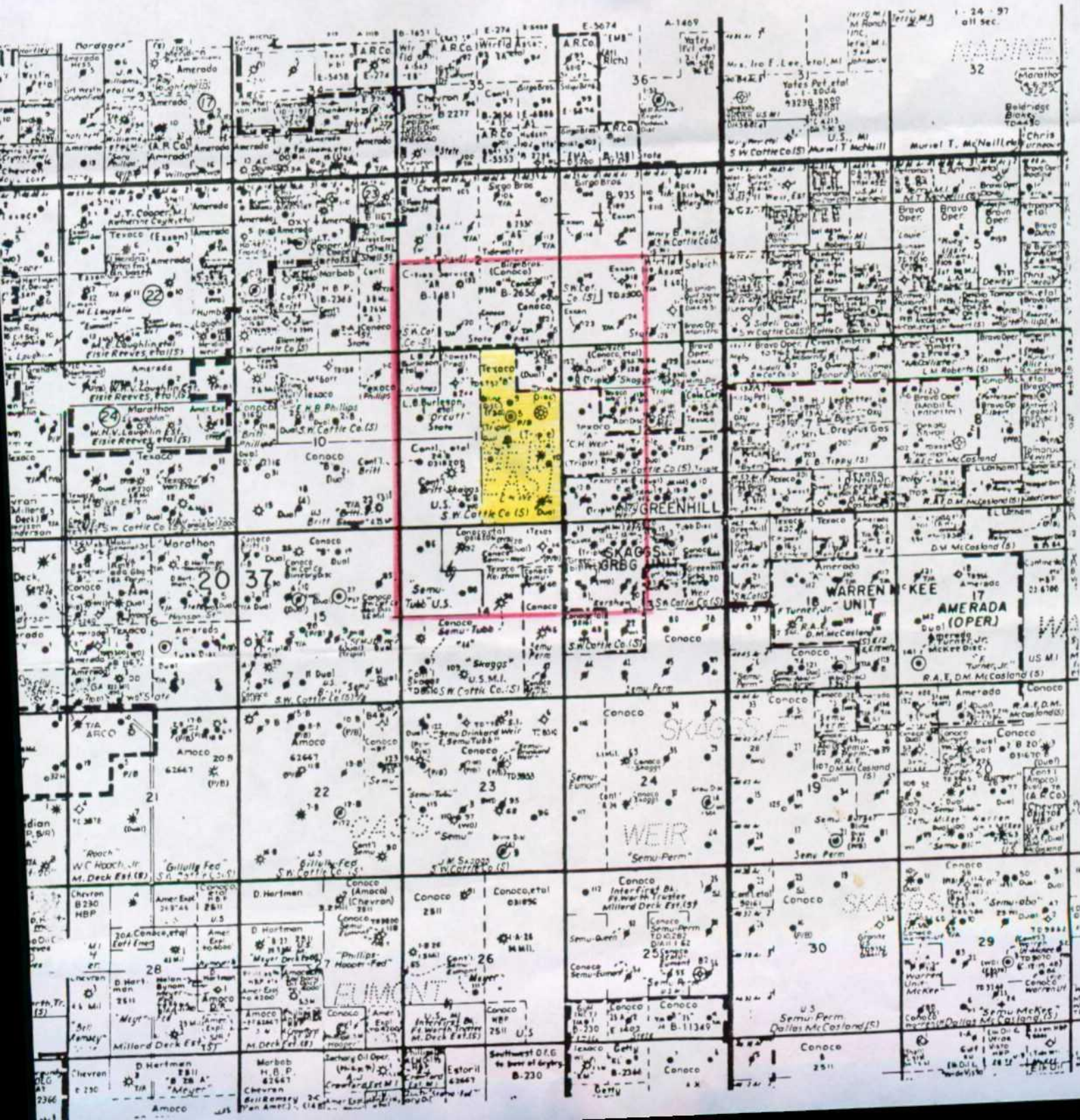

Offset Operators and all Lessees of Record
 C. H. Weir "B" No. 5 Well
 SW/4 NE/4 of Section 11, T-20-S, R-37-E
 Eumont Formation
 Lea County, New Mexico
 August 9, 1996

36	31	32	33	34	35	36	31
1	6	5	4	3	2	1	6
					E a s t		
					E u m o n t		
					Y n i t		
					1 1 1 1 1 1		
					2 3 1 1 1		
12	7	8	9	10	3 3 11 6 12	7	
					4 4 6 6		
					4 4 6 6		
					5 5 5 6 6 6		
13	18	17	16	15	5 5 14 5 5 6 6 13	18	
24	19	20	21	22	23	24	19
25	30	29	28	27	26	25	30
36	31	32	33	34	35	36	31
1	6	5	4	3	2	1	6

Offset Operators and all Lessees of Record
C. H. Weir "B" No. 5 Well
SW/4 NE/4 of Section 11, T-20-S, R-37-E
Eumont Formation
Lea County, New Mexico
August 9, 1996

Number 1

✓ OXY USA Inc.
P. O. Box 50250
Midland, Texas 79702

Number 2

✓ Lewis B. Burleson and wife, Kathryn K. Burleson
P. O. Box 2479
Midland, Texas 79702

Lewis B. Burleson Trust
P. O. Box 2479
Midland, Texas 79702

The New Mexico Company
P. O. Box 2479
Midland, Texas 79702

Nancy E. Wilson
P. O. Box 2479
Midland, Texas 79702

Steven L. Burleson
P. O. Box 2479
Midland, Texas 79702

✓ Sharon Beaver
4014 Lehigh Drive
Midland, Texas 79707

✓ Charles N. Evans
P. O. Box 41
Eunice, New Mexico 88231

✓ Wayne Jarvis
1105 Alpine
Andrews, Texas 79714

Offset Operators and all Lessees of Record
C. H. Weir "B" No. 5 Well
SW/4 NE/4 of Section 11, T-20-S, R-37-E
Eumont Formation
Lea County, New Mexico
August 9, 1996

Number 3

✓ Santa Fe Energy Resources, Inc.
550 W. Texas, Suite 1330
Midland, Texas 79701

Number 4

✓ Conoco Inc.
10 Desta Dr., Suite 100W
Midland, Texas 79705

Number 5

Apache Corporation
2000 Post Oak Blvd., Suite 100
Houston, Texas 77056

✓ Conoco Inc.
10 Desta Dr., Suite 100W
Midland, Texas 79705

✓ Chevron USA, Inc.
P. O. Box 1150
Midland, Texas 79702

✓ Atlantic Richfield Company
P. O. Box 1610
Midland, Texas 79702

Number 6

Texaco Exploration and Production Inc.
P. O. Box 3109
Midland, Texas 79702