

STATE OF NEW MEXICO
 ENERGY, MINERALS AND NATURAL RESOURCES DEPARTMENT
 OIL CONSERVATION DIVISION

IN THE MATTER OF THE HEARING CALLED BY)
 THE OIL CONSERVATION DIVISION FOR THE)
 PURPOSE OF CONSIDERING:)

CASE NO. 13,051

APPLICATION OF YATES PETROLEUM)
 CORPORATION FOR APPROVAL OF A UNIT)
 AGREEMENT, LEA COUNTY, NEW MEXICO)

ORIGINAL

REPORTER'S TRANSCRIPT OF PROCEEDINGS

EXAMINER HEARING

BEFORE: MICHAEL E. STOGNER, Hearing Examiner

April 24th, 2003

Santa Fe, New Mexico

RECEIVED

MAY 8 2003

Oil Conservation Division

This matter came on for hearing before the New Mexico Oil Conservation Division, MICHAEL E. STOGNER, Hearing Examiner, on Thursday, April 24th, 2003, at the New Mexico Energy, Minerals and Natural Resources Department, 1220 South Saint Francis Drive, Room 102, Santa Fe, New Mexico, Steven T. Brenner, Certified Court Reporter No. 7 for the State of New Mexico.

* * *

I N D E X

April 24th, 2003
 Examiner Hearing
 CASE NO. 13,051

	PAGE
APPEARANCES	3
APPLICANT'S WITNESS:	
<u>JOHN AMIET</u> (Geologist)	
Direct Examination by Mr. Carr	4
Examination by Examiner Stogner	15
REPORTER'S CERTIFICATE	18

* * *

E X H I B I T S

Applicant's	Identified	Admitted
Exhibit 1	6	14
Exhibit 2	6	14
Exhibit 3	6	14
Exhibit 4	8	14
Exhibit 5	8	14
Exhibit 6	9	14
Exhibit 7	10	14
Exhibit 8	12	14
Exhibit 9	13	14
Exhibit 10	14	14

* * *

A P P E A R A N C E S

FOR THE DIVISION:

DAVID K. BROOKS, JR.
Attorney at Law
Energy, Minerals and Natural Resources Department
Assistant General Counsel
1220 South St. Francis Drive
Santa Fe, New Mexico 87505

FOR THE APPLICANT:

HOLLAND & HART, L.L.P., and CAMPBELL & CARR
110 N. Guadalupe, Suite 1
P.O. Box 2208
Santa Fe, New Mexico 87504-2208
By: WILLIAM F. CARR

* * *

1 WHEREUPON, the following proceedings were had at
2 8:47 a.m.:

3 EXAMINER STOGNER: At this time I will call Case
4 Number 13,051. This is the Application of Yates Petroleum
5 Corporation for approval of a unit agreement, Lea County,
6 New Mexico.

7 Call for appearances.

8 MR. CARR: May it please the Examiner, my name is
9 William F. Carr with the Santa Fe office of Holland and
10 Hart, L.L.P. We represent Yates Petroleum Corporation in
11 this matter, and I have one witness.

12 EXAMINER STOGNER: Any other appearances?

13 Will the witness please stand to be sworn at this
14 time?

15 (Thereupon, the witness was sworn.)

16 JOHN AMIET,
17 the witness herein, after having been first duly sworn upon
18 his oath, was examined and testified as follows:

19 DIRECT EXAMINATION

20 BY MR. CARR:

21 Q. Would you state your name for the record, please?

22 A. John Amiet.

23 Q. Mr. Amiet, where do you reside?

24 A. Artesia, New Mexico.

25 Q. By whom are you employed?

1 A. Yates Petroleum.

2 Q. And what is your position with Yates Petroleum
3 Corporation?

4 A. I'm a geologist with Yates.

5 Q. Have you previously testified before this
6 Division?

7 A. Yes, I have.

8 Q. At the time of that testimony were your
9 credentials as an expert in petroleum geology accepted and
10 made a matter of record?

11 A. Yes, they were.

12 Q. Are you familiar with the Application filed in
13 this case on behalf of Yates?

14 A. Yes.

15 Q. Are you also familiar with the proposed Strait
16 State Exploratory Unit, including the status of the lands
17 in the proposed unit area?

18 A. Yes, I am.

19 Q. Have you made a geological study of the area
20 which is the subject of this unitization Application?

21 A. Yes, I have.

22 MR. CARR: Are the witness's qualifications
23 acceptable?

24 EXAMINER STOGNER: They are.

25 Q. (By Mr. Carr) Mr. Amiet, could you summarize for

1 Mr. Stogner what it is that Yates Petroleum Corporation
2 seeks with this Application?

3 A. Yates is seeking approval of the proposed Strait
4 State Exploratory Unit agreement. This is a voluntary
5 exploratory unit that contains approximately 3840 acres of
6 State of New Mexico lands, located in Lea County, New
7 Mexico.

8 Q. Have you prepared exhibits for presentation here
9 today?

10 A. Yes, I have.

11 Q. Let's first go to what has been marked for
12 identification as Yates Exhibit Number 1, and I would ask
13 you to identify the exhibit and review it for Mr. Stogner.

14 A. This is the unit agreement. It's based on the
15 state fee form for an exploratory unit.

16 Q. And what is Yates Exhibit Number 2?

17 A. This is a plat map, it's Exhibit "A" to the unit
18 agreement. It shows that all of these are state leases,
19 and there are a total of ten State of New Mexico leases in
20 this proposed unit.

21 Q. Would you identify Exhibit Number 3?

22 A. This is the ownership breakdown, it's Exhibit "B"
23 to the unit agreement. Once again, it shows the ownership
24 of each lease in the unit area. It shows that these leases
25 are 100-percent Yates.

1 Q. And so 100 percent of Yates' working interest is
2 committed to the unit?

3 A. That is correct.

4 Q. There is under one tract, which is the west half
5 of Section 21, an overriding royalty interest held by
6 Christensen Petroleum. What is the status of that?

7 A. We've both sent a letter to Christensen Petroleum
8 asking if they wanted to participate in this unit, and
9 we've also verbally spoken to them several times. At the
10 current time they are uncommitted, although they're more
11 than welcome to join the unit.

12 Q. And they know that?

13 A. That's correct.

14 Q. And they recognize that -- and have had it
15 explained, that if they don't voluntarily commit their
16 royalty will be paid on a lease basis?

17 A. That is correct.

18 Q. For the west half of Section 21?

19 A. Correct.

20 Q. Is Exhibit --

21 EXAMINER STOGNER: Before you move on, if I
22 may --

23 MR. CARR: Yeah.

24 EXAMINER STOGNER: -- you said "we" have
25 notified. Who's "we"?

1 THE WITNESS: The land department at Yates
2 Petroleum, Rob Bullock.

3 Q. (By Mr. Carr) Mr. Amiet, is Exhibit 4 a copy of
4 a letter dated April 17th from Mr. Bullock to the
5 Christensen group?

6 A. Yes, it is.

7 Q. And it is Mr. Bullock who has subsequently been
8 in telephone communication with them?

9 A. That's correct.

10 Q. And the opportunity to commit this override is
11 still available to them, and you're waiting to hear from
12 them?

13 A. That is correct.

14 Q. The proposed unit area is 100-percent state land;
15 is that correct?

16 A. Correct.

17 Q. Has Yates reviewed this proposed unit with the
18 Commissioner of Public Lands?

19 A. Yes, we met with Mr. Martinez and Joe Mraz about
20 two and a half weeks ago. He's given his preliminary
21 approval. That's Yates Exhibit Number 5.

22 Q. In the proposed unit agreement, does Yates
23 Petroleum Corporation seek to be designated operator of the
24 unit and the wells drilled therein?

25 A. Yes.

1 Q. Would you identify what has been marked as Yates
2 Exhibit Number 6?

3 A. This is the AFE for the initial well. It shows a
4 dryhole cost of \$1,187,000 and a completed well cost of
5 \$1,783,500. Yates plans to spud the initial well before
6 May 1st, 2003, because there are two leases that expire on
7 that date.

8 Q. And the initial test well will be located in the
9 southeast quarter of Section 33; is that correct?

10 A. That is correct.

11 Q. Does the unit agreement provide for periodic
12 filing of plans of development?

13 A. Yes.

14 Q. And will these plans be filed with the Oil
15 Conservation Division at the same time they're filed with
16 the Commissioner of Public Lands?

17 A. Yes.

18 Q. How often are these plans to be filed?

19 A. According to Article 9, the initial plan will be
20 six months after completion of the first well. Subsequent
21 plans will be 12 months thereafter.

22 Q. And what horizons are being unitized in the
23 proposed Strait State Exploratory Unit?

24 A. All horizons are proposed to be unitized.

25 Q. And we discussed a minute ago the location of the

1 initial test well. What is the actual footage location for
2 that well?

3 A. Footage location would be 1980 feet from the
4 south line and 660 feet from the east line, Section 33,
5 Township 10 South, Range 34 East.

6 Q. And to what depth will the well be drilled?

7 A. 12,750 feet. This would be into the lower
8 Mississippian limestone.

9 Q. What is the primary objective in this unit?

10 A. Primary objectives will be the Atoka-Morrow
11 sands. This will be a wildcat well, and I'll cover some
12 more of this when we talk about the structure map.

13 Q. Basically what Yates is doing is trying to extend
14 the Atoka-Morrow production out of the south of an area
15 which there has been production in the past; is that right?

16 A. That is correct.

17 Q. Are there secondary objectives in this unit?

18 A. Yes, both the Wolfcamp and the upper
19 Pennsylvanian carbonates will be secondary objectives.

20 Q. Let's go to what has been marked Yates Exhibit
21 Number 7. Would you identify this for the Examiner and
22 review the information on this exhibit?

23 A. This is a structure map on top of the upper
24 Mississippian limestone. Yates calls this zone the Austin
25 limestone. The map was constructed both from seismic data

1 and well control information.

2 The bold red outline shows the proposed unit
3 outline. The Atoka-Morrow producers that we've referred
4 to, there are three of them shown with the solid purple
5 circles clear in the southern part of the map. These are
6 all Atoka-Morrow producers. The only Atoka-Morrow
7 penetration is shown with the open purple circle in the
8 east half of Section 28, or the only Atoka-Morrow
9 penetration within the unit area.

10 These potential channels that we're trying to
11 discover are shown in blue with the blue lines. The green
12 line is the cross-section A-A' that we'll talk about in a
13 minute.

14 These wells that -- all dry holes up to the
15 northwest, are upper Pennsylvanian, are Bough wells. They
16 were drilled in the mid- to late 1960s, and all of these
17 were abandoned by the mid-1970s. So currently within the
18 unit outline there are no producing wells, and there's only
19 been one Atoka-Morrow penetration.

20 Q. What we're really looking for are channel sands,
21 fairly limited in areal extent; is that right?

22 A. Yes, that's correct. These are fairly narrow
23 features. They're linear in nature. Once we get a
24 discovery well, we're going to just track this channel with
25 further wells to try to delineate these channel outlines.

1 Q. And what you're doing is really finding these
2 sort of subtle lows that you're able to identify now with
3 the seismic information that you have available to you; is
4 that correct?

5 A. That is correct, we have 3-D seismic over this
6 area, which we are using to try to discover these channels.

7 Q. Let's go to what has been marked as Yates Exhibit
8 Number 8, the cross-section, and review this exhibit for
9 Mr. Stogner.

10 Q. This is a structural cross-section, A-A' that we
11 referred to earlier. The sands are shown in yellow. The
12 solid blue is the upper Mississippian or Austin limestone.

13 We'll start with the well on the left. This was
14 a productive sand in the Morrow. The top of the Morrow is
15 shown with the purple line. This well has cum'd about
16 22,000 barrels of oil and 1.2 BCF, so this was an economic
17 well.

18 Coming over to the east, or to the right on the
19 cross-section, you have a location that we've identified
20 from the 3-D seismic. We think there's a potential low
21 area there and potential sand development.

22 The well in the middle hit some very thin shaly
23 sands. It was not productive.

24 And then the well on the far right side of the
25 cross-section was not productive in the Morrow-Austin. It

1 was productive uphole. The Morrow is thinner in this well,
2 and the Austin is thicker. We're looking for just the
3 opposite. We're looking for a thick Morrow and a thin
4 Austin limestone.

5 Q. Is Yates Exhibit Number 9 a written summary of
6 your geological presentation?

7 A. Yes, it is.

8 Q. Refer to this summary and summarize for Mr.
9 Stogner why it is that Yates is proposing to attempt to
10 develop this particular area under a unit plan?

11 A. These wells are expensive to drill. It's almost
12 \$1.8 million AFE cost for a completed well. These are
13 narrow, linear features, and if we drill a successful well
14 we're going to follow this channel until we hit a dry hole.
15 Thus the formation of this unit will result in a more
16 reasonable development of these reserves, as these channels
17 are followed.

18 This is a risky play. Just hitting a low doesn't
19 necessarily guarantee that you're going to hit a
20 prospective well. Once again, I might emphasize that no
21 wells have been drilled in this proposed unit outline since
22 1977, and there's been no production since the mid-1970s.

23 Q. Mr. Amiet, does Yates request that the order in
24 this be expedited to the extent possible?

25 A. Yes, we have two leases expiring on May 1st,

1 2003.

2 Q. Is Yates Exhibit Number 10 a proposed order in
3 this case?

4 A. That is correct.

5 Q. And this is based on the most recent order from
6 the Division approving a similar unit application for
7 Yates?

8 A. That is correct.

9 Q. And this Application has also been sent to the
10 Division by e-mail; is that right?

11 A. Correct.

12 Q. In your opinion, will approval of this
13 Application and the development of this acreage pursuant to
14 the proposed unit plan be in the best interest of
15 conservation, the prevention of waste and the protection of
16 correlative rights?

17 A. Yes.

18 Q. Were Yates Exhibits 1 through 10 prepared by you
19 or compiled at your direction?

20 A. Yes, they were.

21 MR. CARR: Mr. Stogner, at this time we'd move
22 the admission into evidence of Yates Petroleum Corporation
23 Exhibits 1 through 10.

24 EXAMINER STOGNER: Exhibits 1 through 10 will be
25 admitted into evidence at this time.

1 MR. CARR: And that concludes my direct
2 examination of Mr. Amiet.

3 EXAMINATION

4 BY EXAMINER STOGNER:

5 Q. Mr. Amiet, I'll now refer to -- well, either
6 Exhibit 7 or 8, and this is the wells drilled up in the
7 northern portion.

8 A. Yes.

9 Q. What was the nature of those wells? Did they
10 produce? Were they all dry holes?

11 A. No, there are some excellent wells. The best
12 well within the unit area made about 200,000 barrels of
13 oil, several hundred million cubic feet of gas. It also
14 made about a half a million barrels of water, and that's
15 the best well. Then of course there are some uneconomic
16 wells that were drilled up there too. This is kind of
17 right on the edge of the Bough development. It's called
18 the Vada field.

19 Q. The Vada. And that was the Bough C, Boughs --

20 A. Bough A through C, I think, produce in this area.

21 Q. And what system is that?

22 A. Well, that's upper Pennsylvanian or Cisco --

23 Q. Okay.

24 A. -- what I would call Cisco.

25 Q. When were those wells drilled, when were they

1 plugged out or completed?

2 A. Most of them started in the mid-1960s to late
3 1960s, and all of them were plugged by the middle of the
4 1970s. By 1975 they were all plugged. So it developed and
5 produced fairly quickly. It produced a lot of water, so
6 the wells watered out.

7 Q. And who was the main player up there? Was this
8 some Yates wells, or did --

9 A. Yates was not involved, I don't think, in any of
10 these wells. This was BTA, the old Sunray Company, Humble
11 had -- and Atlantic Richfield had several of these wells.
12 So there were a number of major and independents involved.

13 Q. Now, this Mr. Christensen that is the subject of
14 Exhibit Number 4, is he a -- has Yates had an other
15 dealings with him in any other properties?

16 A. Not to my knowledge. This is the first time I've
17 been involved with him. They're located in Midland, Texas,
18 I believe it is. We've had verbal communication with him
19 several times in the last two weeks.

20 Q. And that's a 7.8-percent override?

21 A. That's just in the west half of Section 21, so
22 320 acres. So he --

23 Q. Isn't that kind of high for a normal override?

24 A. That's what I was given by the land department.

25 EXAMINER STOGNER: Okay, any other questions of

1 this witness?

2 MR. CARR: No further questions.

3 EXAMINER STOGNER: At this time I'll take this
4 under advisement. I understand the expeditious nature of
5 this request, and thank you for preparing a rough draft.

6 MR. CARR: Thank you, sir.

7 EXAMINER STOGNER: And I will do what I can on my
8 part to submit this to the Director as early as possible.

9 MR. CARR: Thank you, we appreciate that.

10 EXAMINER STOGNER: This case will be taken under
11 advisement, that's 13,051.

12 (Thereupon, these proceedings were concluded at
13 8:57 a.m.)

14 * * *

15
16
17 I do hereby certify that the foregoing is
18 a complete record of the proceedings in
19 the Examiner hearing of Case No. 13051,
20 heard by me on 24 April 2003.

21  Examiner
22 Oil Conservation Division
23
24
25

CERTIFICATE OF REPORTER

STATE OF NEW MEXICO)
) ss.
COUNTY OF SANTA FE)

I, Steven T. Brenner, Certified Court Reporter and Notary Public, HEREBY CERTIFY that the foregoing transcript of proceedings before the Oil Conservation Division was reported by me; that I transcribed my notes; and that the foregoing is a true and accurate record of the proceedings.

I FURTHER CERTIFY that I am not a relative or employee of any of the parties or attorneys involved in this matter and that I have no personal interest in the final disposition of this matter.

WITNESS MY HAND AND SEAL April 26th, 2003.

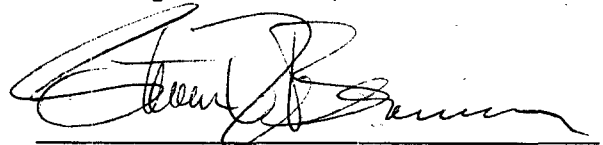

STEVEN T. BRENNER
CCR No. 7

My commission expires: October 16th, 2006

UNIT AGREEMENT
FOR THE DEVELOPMENT AND OPERATION
OF THE
STRAIT STATE EXPLORATORY UNIT
LEA COUNTY, NEW MEXICO

NO. _____

THIS AGREEMENT, entered into as of the 28th day of March, 2003, by and between the parties subscribing, ratifying or consenting hereto, and herein referred to as the "parties hereto";

WITNESSETH:

WHEREAS, the parties hereto are the owners of working, royalty, or other oil or gas interests in the unit area subject to this agreement; and

WHEREAS, the Commissioner of Public Lands of the State of New Mexico is authorized by an Act of the Legislature (Sec 3, Chap. 88, Laws 1943) as amended by Sec. 1 of Chapter 162, Laws of 1951, (Chap. 19, Art. 10, Sec. 45, N. M. Statutes 1978 Annot.), to consent to and approve the development or operation of State Lands under agreements made by lessees of State Land jointly or severally with other lessees where such agreements provide for the unit operation or development of part of or all of any oil or gas pool, field, or area; and

WHEREAS, the Commissioner of Public Lands of the State of New Mexico is authorized by an Act of the Legislature (Sec. 1, Chap. 162), (Laws of 1951, Chap. 19, Art. 10, Sec. 47, N. M. Statutes 1978 Annotated) to amend with the approval of lessee, evidenced by the lessee's execution of such agreement or otherwise, any oil and gas lease embracing State Lands so that the length of the term of said lease may coincide with the term of such agreements for the unit operation and development of part or all of any oil or gas pool, field, or area; and

WHEREAS, the Oil Conservation Division of the Energy and Minerals Department of the State of New Mexico (hereinafter referred to as the "Division"), is authorized by an Act of the Legislature (Chap. 72, Laws 1935, as amended, being Section 70-2-1 et seq. New Mexico Statutes Annotated, 1978 Compilation) to approve this agreement and the conservation provisions hereof; and

BEFORE THE OIL CONSERVATION DIVISION
Santa Fe, New Mexico
Case No. 13051 Exhibit No. 1
Submitted by:
YATES PETROLEUM CORPORATION
Hearing Date: April 24, 2003

WHEREAS, the parties hereto hold sufficient interests in the STRAIT STATE EXPLORATORY UNIT AREA covering the land hereinafter described to give reasonably effective control of operations therein; and

WHEREAS, it is the purpose of the parties hereto to conserve natural resources, prevent waste and secure other benefits obtainable through development and operation of the area subject to this agreement under the terms, conditions and limitations herein set forth;

NOW, THEREFORE, in consideration of the premises and the promises herein contained, the parties hereto commit to this agreement their respective interests in the below defined unit area, and agree severally among themselves as follows:

1. UNIT AREA: The following described land is hereby designated and recognized as constituting the unit area:

Township 10 South, Range 34 East

Section 20: All

Section 21: All

Section 28: All

Section 29: All

Section 32: All

Section 33: All

Lea County, New Mexico

containing 3840.00 acres, more or less

Exhibit "A" attached hereto is a map showing the unit area and the boundaries and identity of tracts and leases in said area to the extent known to the unit operator. Exhibit "B" attached hereto is a schedule showing to the extent known to the unit operator the acreage, percentage and kind of ownership of oil and gas interests in all lands in the unit area. However, nothing herein or in said schedule or map shall be construed as a representation by any party hereto as to the ownership of any interest other than such interest or interests as are shown on said map or schedule as owned by such party. Exhibit "A" and "B" shall be revised by the unit operator whenever changes in ownership in the unit area render such revisions necessary or when requested by the Commissioner of Public Lands, hereinafter referred to as "Commissioner" or the Oil Conservation Division, hereinafter referred to as the "Division".

All land committed to this agreement shall constitute land referred to herein as "unitized land" or "land subject to this agreement".

2. UNITIZED SUBSTANCES: All oil, gas, natural gasoline, and associated fluid hydrocarbons in any and all formations of the unitized land are unitized under the terms of this agreement and herein are called "unitized substances".

3. UNIT OPERATOR: Yates Petroleum Corporation, whose address is 105 South Fourth Street, Artesia, New Mexico 88210 is hereby designated as unit operator and by signature hereto commits to this agreement all interest in unitized substances vested in it as set forth in Exhibit "B", and agrees and consents to accept the duties and obligations of unit operator for the discovery, development and production of unitized substances as herein provided. Whenever reference is made herein to the unit operator, such reference means the unit operator acting in that capacity and not as an owner of interests in unitized substances, and the term "working interest owner" when used herein shall include or refer to unit operator as the owner of a working interest when such an interest is owned by it.

4. RESIGNATION OR REMOVAL OF UNIT OPERATOR: Unit operator shall have the right to resign at any time but such resignation shall not become effective until a successor unit operator has been selected and approved in the manner provided for in Section 5 of this agreement. The resignation of the unit operator shall not release the unit operator from any liability or any default by it hereunder occurring prior to the effective date of its resignation.

Unit operator may, upon default or failure in the performance of its duties or obligations hereunder, be subject to removal by the same percentage vote of the owners of working interests determined in like manner as herein provided for the selection of a new unit operator. Such removal shall be effective upon notice thereof to the Commissioner and the Division.

The resignation or removal of the unit operator under this agreement shall not terminate his right, title or interest as the owner of a working interest or other interest in unitized substances, but upon the resignation or removal of unit operator becoming effective, such unit operator shall deliver possession of all equipment, materials, and appurtenances used in conducting the unit operations and owned by the working interest owners to the new duly qualified successor unit operator, or to the owners thereof if no such new unit operation is elected, to be used for the purpose of conducting unit operations hereunder. Nothing herein shall be construed as authorizing removal of any material, equipment and appurtenances needed for the preservation of wells.

5. SUCCESSOR UNIT OPERATOR: Whenever the unit operator shall resign as unit operator or shall be removed as hereinabove provided, the owners of the working interests according to their respective acreage interests in all unitized land shall by a majority vote select a successor unit operator; provided that, if a majority but less than seventy five percent (75%) of the working interests qualified to vote is owned by one party to this agreement, a concurring vote of sufficient additional parties, so as to constitute in the aggregate not less than seventy-five percent (75%) of the total working interests, shall be required to select a new operator. Such selection shall not become effective until (a) a unit operator so selected shall accept in writing the duties and responsibilities of unit operator, and (b) the selection shall have been approved by the Commissioner. If no successor unit operator is selected and qualified as herein provided, the Commissioner at his election, with notice to the Division, may declare this unit agreement terminated.

6. ACCOUNTING PROVISIONS: The unit operator shall pay in the first instance all costs and expenses incurred in conducting unit operations hereunder, and such costs and expenses and the working interest benefits accruing hereunder shall be apportioned among the owners of the unitized working interests in accordance with an operating agreement entered into by and between the unit operator and the owners of such interests, whether one or more, separately or collectively. Any agreement or agreements entered into between the working interest owners and the unit operator as provided in this section, whether one or more, are herein referred to as the "Operating Agreement". No such agreement shall be deemed either to modify any of the terms and conditions of this unit agreement or to relieve the unit operator of any right or obligation established under this unit agreement and in case of any inconsistencies or conflict between this unit agreement and the operating agreement, this unit agreement shall prevail.

7. RIGHTS AND OBLIGATIONS OF UNIT OPERATOR: Except as otherwise specifically provided herein, the exclusive right, privilege and duty of exercising any and all rights of the parties hereto which are necessary or convenient for prospecting for, producing, storing, allocating and distributing the unitized substances are hereby delegated to and shall be exercised by the unit operator as herein provided. Acceptable evidence of title to said rights shall be deposited with said unit operator and, together with this agreement, shall constitute and define the rights, privileges and obligations of unit operator. Nothing herein, however, shall be construed to transfer title to any land or to any lease or operating agreement, it being understood that under this agreement the unit operator, in

its capacity as unit operator, shall exercise the rights of possession and use vested in the parties hereto only for the purposes herein specified.

8. DRILLING TO DISCOVERY: The unit operator shall, within sixty (60) days after the effective date of this agreement, commence operations upon an adequate test well for oil and gas upon some part of the lands embraced within the unit area and shall drill said well with due diligence to a depth sufficient to attain the top of the Mississippian formation or to such a depth as unitized substances shall be discovered in paying quantities at a lesser depth or until it shall, in the opinion of unit operator, be determined that the further drilling of said well shall be unwarranted or impracticable; provided, however, that unit operator shall not, in any event, be required to drill said well to a depth in excess of 12,800 feet. Until a discovery of a deposit of unitized substances capable of being produced in paying quantities (to wit: quantities sufficient to repay the cost of drilling and producing operations with a reasonable profit) unit operator shall continue drilling diligently, one well at a time, allowing not more than six months between the completion of one well and the beginning of the next well, until a well capable of producing unitized substances in paying quantities is completed to the satisfaction of the Commissioner or until it is reasonably proven to the satisfaction of the unit operator that the unitized land is incapable of producing unitized substances in paying quantities in the formation drilled hereunder.

Any well commenced prior to the effective date of this agreement upon the unit area and drilled to the depth provided herein for the drilling of an initial test well shall be considered as complying with the drilling requirements hereof with respect to the initial well. The Commissioner may modify the drilling requirements of this section by granting reasonable extensions of time when in his opinion such action is warranted. Upon failure to comply with the drilling provisions of this article the Commissioner may, after reasonable notice to the unit operator and each working interest owner, lessee and lessor at their last known addresses, declare this unit agreement terminated, and all rights, privileges and obligations granted and assumed by this unit agreement shall cease and terminate as of such date.

9. OBLIGATIONS OF UNIT OPERATOR AFTER DISCOVERY OF UNITIZED SUBSTANCES:

Should unitized substances in paying quantities be discovered upon the unit area, the unit operator shall on or before six months from the time of the completion of the initial discovery well and within thirty days after the expiration of each twelve months period thereafter, file a report with the Commissioner and Division of the status of the development of the unit area and the development contemplated for the following twelve months period.

It is understood that one of the main considerations for the approval of this agreement by the Commissioner of Public Lands is to secure the orderly development of the unitized lands in accordance with good conservation practices so as to obtain the greatest ultimate recovery of unitized substances.

After discovery of unitized substances in paying quantities, unit operator shall proceed with diligence to reasonably develop the unitized area as a reasonably prudent operator would develop such area under the same or similar circumstances.

If the unit operator should fail to comply with the above covenant for reasonable development this agreement may be terminated by the Commissioner as to all lands of the State of New Mexico embracing undeveloped regular well spacing or proration units, but in such event, the basis of participation by the working interest owners shall remain the same as if this agreement had not been terminated as to such lands; provided, however, the Commissioner shall give notice to the unit operator and the lessees of record in the manner prescribed by (Sec. 19-10-20 N.M. Statutes 1978 Annotated,) of intention to cancel on account of any alleged breach of said covenant for reasonable development and decision entered thereunder shall be subject to appeal in the manner prescribed by (Sec. 19-10-23 N.M. Statutes 1978 Annotated), and, provided further, in any event the unit operator shall be given a reasonable opportunity after a final determination within which to remedy any default, failing in which this agreement shall be terminated as to all lands of the State of New Mexico embracing undeveloped regular well spacing or proration units.

Notwithstanding any of the provisions of this Agreement to the contrary, all undeveloped regular well spacing or proration unit tracts within the unit boundaries embracing lands of the State of New Mexico shall be automatically eliminated from this Agreement and shall no longer be a part of the unit or be further subject to the terms of this Agreement unless at the expiration of five years (5) after the first day of the month following the effective date of this Agreement diligent drilling operations are in progress on said tracts.

10. PARTICIPATION AFTER DISCOVERY: Upon completion of a well capable of producing unitized substances in paying quantities, the owners of working interests shall participate in the production therefrom and in all other producing wells which may be drilled pursuant hereto in the proportions that their respective leasehold interests covered hereby on an acreage basis bears to the total number of acres committed to this unit agreement, and such unitized substances shall be deemed to have been produced from the respective leasehold interests participating therein. For the purpose of determining any benefits accruing under this agreement and the

distribution of the royalties payable to the State of New Mexico and other lessors, each separate lease shall have allocated to it such percentage of said production as the number of acres in each lease respectively committed to this agreement bears to the total number of acres committed hereto.

Notwithstanding any provisions contained herein to the contrary, each working interest owner shall have the right to take such owner's proportionate share of the unitized substances in kind or to personally sell or dispose of the same, and nothing herein contained shall be construed as giving or granting to the unit operator the right to sell or otherwise dispose of the proportionate share of any working interest owner without specific authorization from time to time so to do.

11. ALLOCATION OF PRODUCTION: All unitized substances produced from each tract in the unitized area established under this agreement, except any part thereof used for production or development purposes hereunder, or unavoidably lost, shall be deemed to be produced equally on an acreage basis from the several tracts of the unitized land, and for the hereunder, or unavoidably lost, shall be deemed to be produced equally on an acreage basis from the several tracts of the unitized land, and for the purpose of determining any benefits that accrue on an acreage basis, each such tract shall have allocated to it such percentage of said production as its area bears to the entire unitized area. It is hereby agreed that production of unitized substances from the unitized area shall be allocated as provided herein, regardless of whether any wells are drilled on any particular tracts of said unitized area.

12. PAYMENT OF RENTALS, ROYALTIES AND OVERRIDING ROYALTIES: All rentals due the State of New Mexico shall be paid by the respective lease owners in accordance with the terms of their leases.

All royalties due to the State of New Mexico under the terms of the leases committed to this agreement shall be computed and paid on the basis of all unitized substances allocated to the respective leases committed hereto; provided, however, the State shall be entitled to take in kind its share of the unitized substances allocated to the respective leases, and in such case the unit operator shall make deliveries of such royalty share in accordance with the terms of the respective leases.

All rentals, if any, due under any leases embracing lands other than the State of New Mexico, shall be paid by the respective lease owners in accordance with the terms of their leases and all royalties due under the terms of any such leases shall be paid on the basis of all unitized substances allocated to the respective leases committed hereto.

If the unit operator introduces gas obtained from sources other than the unitized substances into any producing formation for the purpose of repressuring, stimulating or increasing the ultimate recovery of unitized substances therefrom, a like amount of gas, if available, with due allowance for loss or depletion from any cause may be withdrawn from the formation into which the gas was introduced royalty free as to dry gas but not as to the products extracted therefrom; provided, that such withdrawal shall be at such time as may be provided in a plan of operation consented to by the Commissioner and approved by the Division as conforming to good petroleum engineering practices; and provided further, that such right of withdrawal shall terminate on the termination of this unit agreement.

If any lease committed hereto is burdened with an overriding royalty, payment out of production or other charge in addition to the usual royalty, the owner of such lease shall bear and assume the same out of the unitized substances allocated to the lands embraced in each such lease as provided herein.

13. LEASES AND CONTRACTS CONFORMED AND EXTENDED INsofar AS THEY APPLY TO LANDS WITHIN THE UNITIZED AREA: The terms, conditions and provision of all leases, subleases, operating agreements and other contracts relating to the exploration, drilling development or operation for oil or gas of the lands committed to this agreement, shall as of the effective date hereof, be and the same are hereby expressly modified and amended insofar as they apply to lands within the unitized area to the extent necessary to make the same conform to the provisions hereof and so that the respective terms of said leases and agreements will be extended insofar as necessary to coincide with the terms of this agreement and the approval of this agreement by the Commissioner and the respective lessors and lessees shall be effective to conform the provisions and extend the terms of each such lease as to lands within the unitized area to the provisions and terms of this agreement; but otherwise to remain in full force and effect. Each lease committed to this agreement, insofar as it applies to lands within the unitized area, shall continue in force beyond the term provided therein as long as this agreement remains in effect, provided, drilling operations upon the initial test well provided for herein shall have been commenced or said well is in the process of being drilled by the unit operator prior to the expiration of the shortest term lease committed to this agreement. Termination of this agreement shall not affect any lease which pursuant to the terms thereof or any applicable laws would continue in full force and effect thereafter. The commencement, completion, continued operation or production on each of the leasehold interests committed to this agreement and operations or production pursuant to this agreement shall be deemed to be operations upon and production from

each leasehold interest committed hereto and there shall be no obligation on the part of the unit operator or any of the owners of the respective leasehold interests committed hereto to drill offset to wells as between the leasehold interests committed to this agreement, except as provided in Section 9 hereof.

Any lease embracing lands of the State of New Mexico of which only a portion is committed hereto shall be segregated as to the portion committed and as to the portion not committed and the terms of such leases shall apply separately as two separate leases as to such segregated portions, commencing as of the effective date hereof. Notwithstanding any of the provisions of this agreement to the contrary, any lease embracing lands of the State of New Mexico having only a portion of its lands committed hereto shall continue in full force and effect beyond the term provided therein as to all lands embraced within the unitized area and committed to this agreement, in accordance with the terms of this agreement. If oil and gas, or either of them, are discovered and are being produced in paying quantities from some part of the lands embraced in such lease which part is committed to this agreement at the expiration of the secondary term of such lease, such production shall not be considered as production from lands embraced in such lease which are not within the unitized area, and which are not committed thereto, and drilling or reworking operations upon some part of the lands embraced within the unitized area and committed to this agreement shall be considered as drilling and reworking operations only as to lands embraced within the unit agreement and not as to lands embraced within the lease and not committed to this unit agreement; provided, however, as to any lease embracing lands of the State of New Mexico having only a portion of its lands committed hereto upon which oil and gas, or either of them, has been discovered is discovered upon that portion of such lands not committed to this agreement, and are being produced in paying quantities prior to the expiration of the primary term of such lease, such production in paying quantities shall serve to continue such lease in full force and effect in accordance with its terms as to all of the lands embraced in said lease.

14. CONSERVATION: Operations hereunder and production of unitized substances shall be conducted to provide for the most economical and efficient recovery of said substances without waste, as defined by or pursuant to State laws or regulations.

15. DRAINAGE: In the event a well or wells producing oil or gas in paying quantities should be brought in on land adjacent to the unit area draining unitized substances from the lands embraced therein, unit operator shall drill such offset well or wells as a reasonably prudent operator would drill under the same or similar circumstances.

16. COVENANTS RUN WITH LAND: The covenants herein shall be construed to be covenants running with the land with respect to the interests of the parties hereto and their successors in interest until this agreement terminates, and any grant, transfer or conveyance of interest in land or leases subject hereto shall be and hereby is conditioned upon the assumption of all privileges and obligations hereunder to the grantee, transferee or other successor in interest. No assignment or transfer or any working, royalty, or other interest subject hereto shall be binding upon unit operator until the first day of the calendar month after the unit operator is furnished with the original, photostatic, or certified copy of the instrument of transfer.

17. EFFECTIVE DATE AND TERM: This agreement shall become effective upon approval by the Commissioner and the Division and shall terminate in five years after such date unless (a) such date of expiration is extended by the Commissioner, or (b) a valuable discovery of unitized substances has been made on unitized land during said initial term or any extension thereof in which case this agreement shall remain in effect so long as unitized substances are being produced in paying quantities from the unitized land and, should production cease, so long thereafter as diligent operations are in progress for the restoration of production or discovery of new production and so long thereafter as the unitized substances so discovered are being produced as aforesaid. This agreement may be terminated at any time by not less than seventy-five percent (75%) on an acreage basis of the owners of the working interests, signatory hereto, with the approval of the Commissioner and with notice to Division. Likewise, the failure to comply with the drilling requirements of Section 8 hereof, may subject this agreement to termination as provided in said section.

18. RATE OF PRODUCTION: All production and the disposal thereof shall be in conformity with allocations, allotments, and quotas made or fixed by the Division, and in conformity with applicable laws and lawful regulations.

19. APPEARANCES: Unit operator shall, after notice to other parties affected, have the right to appear for and on behalf of any and all interests affected hereby, before the Commissioner of Public Lands and the Division, and to appeal from orders issued under the regulations of the Commissioner or Division, or to apply for relief from any of said regulations or in any proceedings on its own behalf relative to operations pending before the Commissioner or Division; provided, however, that any other interest party shall also have the rights at his own expense to appear and to participate in any such proceeding.

20. NOTICES: All notices, demands or statements required hereunder to be given or rendered to the parties hereto, shall be deemed fully given, if given in writing and sent by postpaid registered mail, addressed to such party or parties at their respective addresses, set forth in connection with the signatures hereto or to the ratification or consent hereof, or to such other address as any such party may have furnished in writing to party sending the notice, demand, or statement.

21. LOSS OF TITLE: In the event title to any tract of unitized land or substantial interest therein shall fail, and the true owner cannot be induced to join the unit agreement so that such tract is not committed to this agreement, or the operation thereof hereunder becomes impracticable as a result thereof, such tract may be eliminated from the unitized area, and the interest of the parties readjusted as a result of such tract being eliminated from the unitized area. In the event of a dispute as to the title to any royalty, working, or other interest subject hereto, the unit operator may withhold payment or delivery of the allocated portion of the unitized substances involved on account thereof, without liability for interest until the dispute is finally settled, provided that no payments of funds due the State of New Mexico shall be withheld. Unit operator, as such, is relieved from any responsibility for any defect or failure of any title hereunder.

22. SUBSEQUENT JOINDER: Any oil or gas interest in lands within the unit area not committed hereto, prior to the submission of the agreement for final approval by the Commissioner and the Division, may be committed hereto by the owner or owners of such rights, subscribing or consenting to this agreement, or executing a ratification thereof, and if such owner is also a working interest owner, by subscribing to the operating agreement providing for the allocation of costs of exploration, development and operation. A subsequent joinder shall be effective as of the first day of the month following the approval by the Commissioner and the filing with the Division of duly executed counterparts of the instrument or instruments committing the interest of such owner to this agreement, but such joining party or parties, before participating in any benefits hereunder, shall be required to assume and pay to unit operator, their proportionate share of the unit expenses incurred prior to such party's or parties joinder in the unit agreement, and the unit operator shall make appropriate adjustments caused by such joinder, without any retroactive adjustment of revenue.

23. COUNTERPARTS: This agreement may be executed in any number of counterparts, no one of which needs to be executed by all parties, or may be ratified or consented to by separate instrument in writing specifically referring hereto, and shall be binding upon all those parties who have executed such a

counterpart, ratification, or consent hereto with the same force and effect as if all such parties had signed the same document, and regardless of whether or not it is executed by all other parties owning or claiming an interest in the lands within the above described unit area.

IN WITNESS WHEREOF, the undersigned parties hereto have caused this agreement to be executed as of the respective dates set forth opposite their signatures.

UNIT OPERATOR AND WORKING INTEREST OWNERS

YATES PETROLEUM CORPORATION
YATES DRILLING COMPANY
ABO PETROLEUM CORPORATION
MYCO INDUSTRIES, INC.

Date 3-28-03



Attorney-in-Fact

AB

STATE OF NEW MEXICO §
 §
COUNTY OF EDDY §

The foregoing instrument was acknowledged before me this 28 day of March, 2003 by Randy G. Patterson, Attorney-in-Fact for YATES PETROLEUM CORPORATION, YATES DRILLING COMPANY, ABO PETROLEUM CORPORATION and MYCO INDUSTRIES, INC., all New Mexico corporations, on behalf of said corporations.

My commission expires:
1-8-04



Notary Public

EXHIBIT "A"

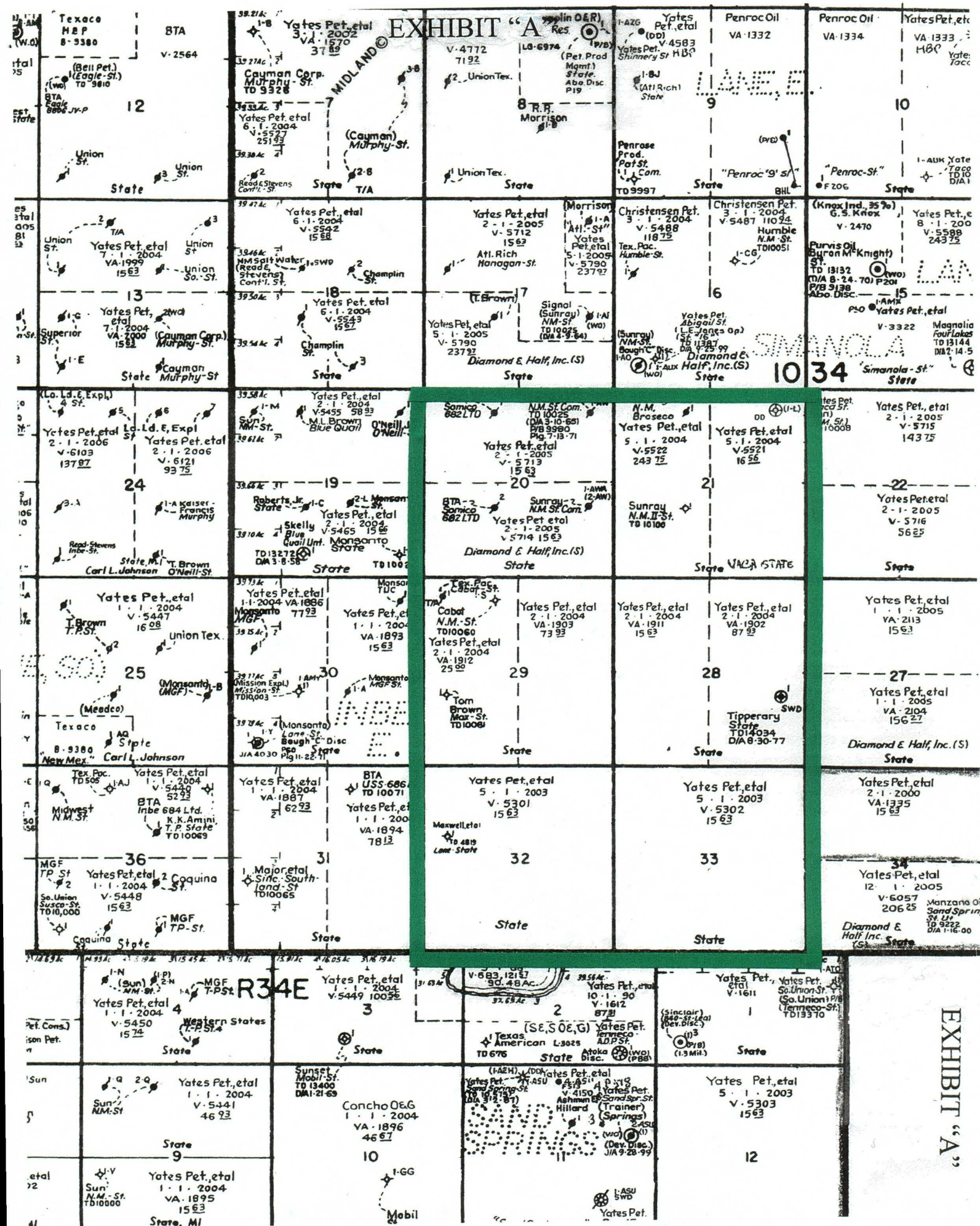
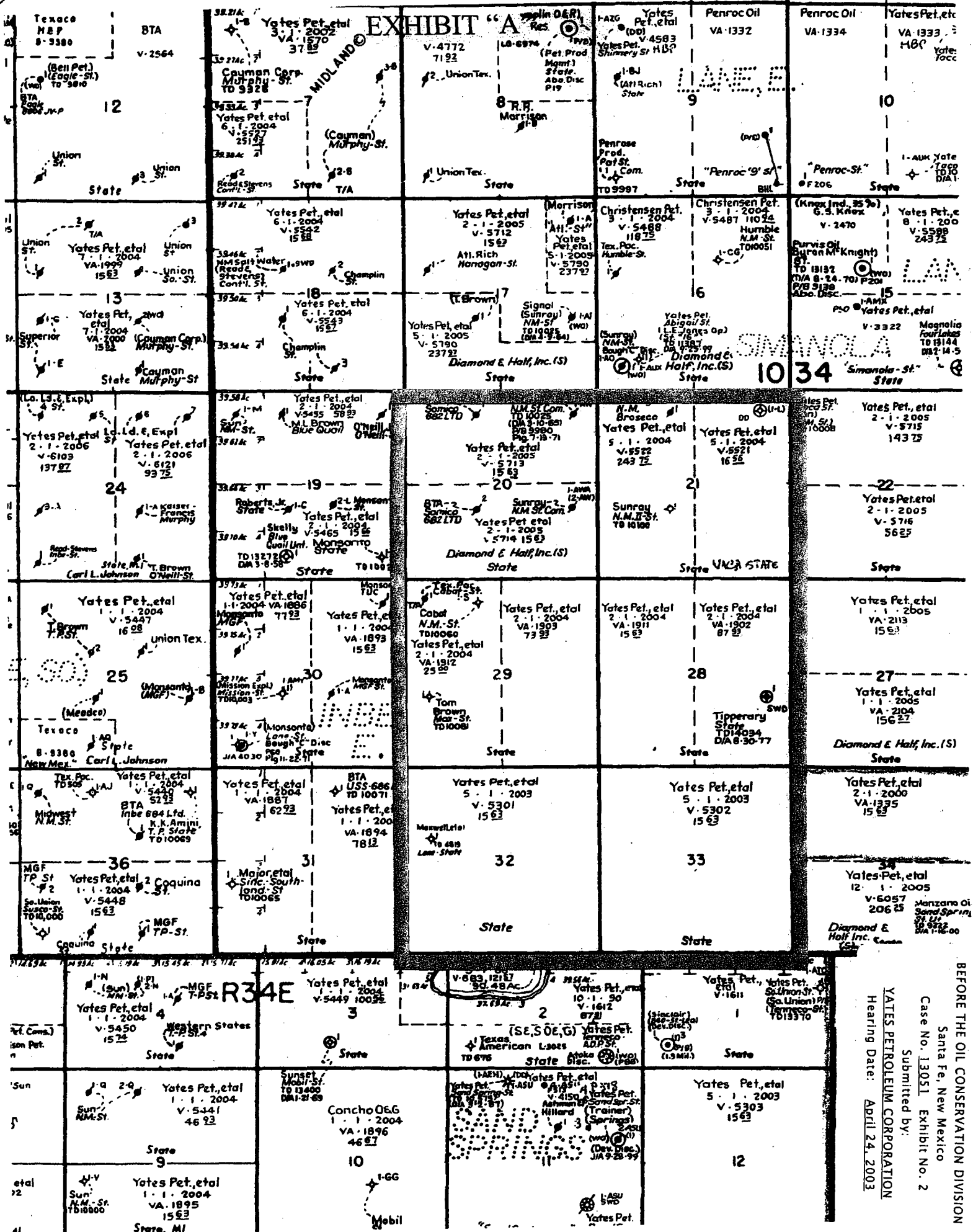

EXHIBIT "B"
STRAIT STATE EXPLORATORY UNIT
LEA COUNTY, NEW MEXICO

TRACT NUMBER	DESCRIPTION OF LANDS	NET ACRES	SERIAL NUMBER AND EXPIRATION DATE	LESSOR & ROYALTY	LESSEE OF RECORD	OVERRIDING ROYALTY	WORKING INTEREST
1.	<u>T10S,R34E</u> Sec. 32: All Lea County, NM	640.00	VO-5301 5/1/03	State of New Mexico 1/6	Yates Petroleum Corporation	None	Yates Petroleum Corporation Yates Drilling Company Abo Petroleum Corporation Myco Industries, Inc. 70.000% 10.000% 10.000% 10.000%
2.	<u>T10S,R34E</u> Sec. 33: All Lea County, NM	640.00	VO-5302 5/1/03	State of New Mexico 1/6	Yates Petroleum Corporation	None	Yates Petroleum Corporation Yates Drilling Company Abo Petroleum Corporation Myco Industries, Inc. 70.000% 10.000% 10.000% 10.000%
3.	<u>T10S,R34E</u> Sec. 29: W2 Lea County, NM	320.00	VA-1912 2/1/04	State of New Mexico 1/8	Yates Petroleum Corporation	None	Yates Petroleum Corporation Yates Drilling Company Abo Petroleum Corporation Myco Industries, Inc. 70.000% 10.000% 10.000% 10.000%
4.	<u>T10S,R34E</u> Sec. 29: E2 Lea County, NM	320.00	VA-1903 2/1/04	State of New Mexico 1/8	Yates Petroleum Corporation	None	Yates Petroleum Corporation Yates Drilling Company Abo Petroleum Corporation Myco Industries, Inc. 70.000% 10.000% 10.000% 10.000%
5.	<u>T10S,R34E</u> Sec. 28: W2 Lea County, NM	320.00	VA-1911 2/1/04	State of New Mexico 1/8	Yates Petroleum Corporation	None	Yates Petroleum Corporation Yates Drilling Company Abo Petroleum Corporation Myco Industries, Inc. 70.000% 10.000% 10.000% 10.000%
6.	<u>T10S,R34E</u> Sec. 28: E2 Lea County, NM	320.00	VA-1902 2/1/04	State of New Mexico 1/8	Yates Petroleum Corporation	None	Yates Petroleum Corporation Yates Drilling Company Abo Petroleum Corporation Myco Industries, Inc. 70.000% 10.000% 10.000% 10.000%
7.	<u>T10S,R34E</u> Sec. 21: W2 Lea County, NM	320.00	VO-5522 5/1/04	State of New Mexico 1/6	Yates Petroleum Corporation	Christianson Petroleum 7.833%	Yates Petroleum Corporation 70.000%
8.	<u>T10S,R34E</u> Sec. 21: E2 Lea County, NM	320.00	VO-5521 5/1/04	State of New Mexico 1/6	Yates Petroleum Corporation	None	Yates Petroleum Corporation Yates Drilling Company Abo Petroleum Corporation Myco Industries, Inc. 70.000% 10.000% 10.000% 10.000%
9.	<u>T10S,R34E</u> Sec. 20: N2 Lea County, NM	320.00	VO-5713 2/1/05	State of New Mexico 1/6	Yates Petroleum Corporation	None	Yates Petroleum Corporation Yates Drilling Company Abo Petroleum Corporation Myco Industries, Inc. 70.000% 10.000% 10.000% 10.000%
10.	<u>T10S,R34E</u> Sec. 20: S2 Lea County, NM	320.00	VO-5714 2/1/05	State of New Mexico 1/6	Yates Petroleum Corporation	None	Yates Petroleum Corporation Yates Drilling Company Abo Petroleum Corporation Myco Industries, Inc. 70.000% 10.000% 10.000% 10.000%
<u>TOTAL ACRES</u>		<u>3840.00</u>					
<u>STATE LANDS</u>		<u>100%</u>					



BEFORE THE OIL CONSERVATION DIVISION
Santa Fe, New Mexico
Case No. 13051 Exhibit No. 2
Submitted by:
YATES PETROLEUM CORPORATION
Hearing Date: April 24, 2003

EXHIBIT "B"
STRAIT STATE EXPLORATORY UNIT
LEA COUNTY, NEW MEXICO

TRACT NUMBER	DESCRIPTION OF LANDS	NET ACRES	SERIAL NUMBER AND EXPIRATION DATE	LESSOR & ROYALTY	LESSEE OF RECORD	OVERRIDING ROYALTY	WORKING INTEREST
1.	<u>T10S,R34E</u> Sec. 32: All Lea County, NM	640.00	VO-5301 5/1/03	State of New Mexico 1/6	Yates Petroleum Corporation	None	Yates Petroleum Corporation Yates Drilling Company Abo Petroleum Corporation Myco Industries, Inc. 70.000% 10.000% 10.000% 10.000%
2.	<u>T10S,R34E</u> Sec. 33: All Lea County, NM	640.00	VO-5302 5/1/03	State of New Mexico 1/6	Yates Petroleum Corporation	None	Yates Petroleum Corporation Yates Drilling Company Abo Petroleum Corporation Myco Industries, Inc. 70.000% 10.000% 10.000% 10.000%
3.	<u>T10S,R34E</u> Sec. 29: W2 Lea County, NM	320.00	VA-1912 2/1/04	State of New Mexico 1/8	Yates Petroleum Corporation	None	Yates Petroleum Corporation Yates Drilling Company Abo Petroleum Corporation Myco Industries, Inc. 70.000% 10.000% 10.000% 10.000%
4.	<u>T10S,R34E</u> Sec. 29: E2 Lea County, NM	320.00	VA-1903 2/1/04	State of New Mexico 1/8	Yates Petroleum Corporation	None	Yates Petroleum Corporation Yates Drilling Company Abo Petroleum Corporation Myco Industries, Inc. 70.000% 10.000% 10.000% 10.000%
5.	<u>T10S,R34E</u> Sec. 28: W2 Lea County, NM	320.00	VA-1911 2/1/04	State of New Mexico 1/8	Yates Petroleum Corporation	None	Yates Petroleum Corporation Yates Drilling Company Abo Petroleum Corporation Myco Industries, Inc. 70.000% 10.000% 10.000% 10.000%
6.	<u>T10S,R34E</u> Sec. 28: E2 Lea County, NM	320.00	VA-1902 2/1/04	State of New Mexico 1/8	Yates Petroleum Corporation	None	Yates Petroleum Corporation Yates Drilling Company Abo Petroleum Corporation Myco Industries, Inc. 70.000% 10.000% 10.000% 10.000%
7.	<u>T10S,R34E</u> Sec. 21: W2 Lea County, NM	320.00	VO-5522 5/1/04	State of New Mexico 1/6	Yates Petroleum Corporation	Christianson Petroleum 7.833%	Yates Petroleum Corporation 100.000%
8.	<u>T10S,R34E</u> Sec. 21: E2 Lea County, NM	320.00	VO-5521 5/1/04	State of New Mexico 1/6	Yates Petroleum Corporation	None	Yates Petroleum Corporation Yates Drilling Company Abo Petroleum Corporation Myco Industries, Inc. 70.000% 10.000% 10.000% 10.000%
9.	<u>T10S,R34E</u> Sec. 20: N2 Lea County, NM	320.00	VO-5713 2/1/05	State of New Mexico 1/6	Yates Petroleum Corporation	None	Yates Petroleum Corporation Yates Drilling Company Abo Petroleum Corporation Myco Industries, Inc. 70.000% 10.000% 10.000% 10.000%
10.	<u>T10S,R34E</u> Sec. 20: S2 Lea County, NM	320.00	VO-5714 2/1/05	State of New Mexico 1/6	Yates Petroleum Corporation	None	Yates Petroleum Corporation Yates Drilling Company Abo Petroleum Corporation Myco Industries, Inc. 70.000% 10.000% 10.000% 10.000%
				BEFORE THE OIL CONSERVATION DIVISION			
				Santa Fe, New Mexico			
				Case No. <u>13051</u> Exhibit No. 3			
				Submitted by:			
				YATES PETROLEUM CORPORATION			
<u>TOTAL ACRES</u>		<u>3840.00</u>					
<u>STATE LANDS</u>		<u>100%</u>					



105 South Fourth Street
Artesia, NM 88210
505-748-1471
FAX 505-748-4572

April 17, 2003

Douglas H. Christensen
PO Box 3790
Midland, TX 79702

RE: VO-5522 – Christensen orri 7.833%
Township 10 South, Range 34 East
Section 21: W/2
Lea County, New Mexico

Dear Mr. Christensen:

Please find enclosed a Ratification and Joinder of Unit Agreement for the Strait State Unit, including a copy of the unit agreement. The Strait State Unit #1 well will be drilled 1980' FSL and 660' FEL Section 33, T10S, R34E to test the Mississippian at approximately 12,500'.

You have the right to spread your orri over the entire unit or limit it just to Section 21. If we have not received your executed Ratification and Joinder on or before May 1, 2003 you will be deemed to have limited your orri to Section 21.

Please call me at 505-748-4351 if you would like to discuss the above.

Thank you.

Very truly yours,

YATES PETROLEUM CORPORATION

Robert Bullock
Landman

RB:bn
enclosures

BEFORE THE OIL CONSERVATION DIVISION
Santa Fe, New Mexico
Case No. 13051 Exhibit No. 4
Submitted by:
YATES PETROLEUM CORPORATION
Hearing Date: April 24, 2003

RATIFICATION AND JOINDER OF UNIT AGREEMENT

In consideration of the execution of the Unit Agreement for the Development and Operation of the Strait State Exploratory Unit, County of Lea, State of New Mexico, dated April 8, 2003, in form approved on behalf of the Commissioner of Public Lands and the New Mexico Oil and Gas Conservation Commission, and in consideration of the execution or ratification by other working interest owners of the contemporary Unit Operating Agreement which relates to said Unit Agreement, the undersigned hereby expressly ratifies, approves and adopts said Unit Agreement as fully as though the undersigned had executed the original instrument.

This Ratification and Joinder shall be effective as to the undersigned's interests in any lands and leases, or interests therein, and royalties presently held or which may arise under existing option agreements or other interests in unitized substances, covering any lands within the Unit Area in which the undersigned may be found to have an oil or gas interest.

This Ratification and Joinder shall be binding upon the undersigned, its heirs, devisees, assignees or successors in interest.

EXECUTED this _____ day of _____, 2003.

CHRISTENSEN PETROLEUM, INC.

By: _____

Title: _____

Address: PO Drawer 3790
Midland, TX 79702

STATE OF TEXAS §
 §
COUNTY OF §

The foregoing instrument was acknowledged before me this _____ day of _____, 2003,
by _____ as _____ of
Christensen Petroleum, Inc., a _____ corporation, on behalf of said corporation.

My commission expires: _____

Notary Public



PATRICK H. LYONS
COMMISSIONER

State of New Mexico
Commissioner of Public Lands

310 OLD SANTA FE TRAIL
P.O. BOX 1148
SANTA FE, NEW MEXICO 87504-1148

COMMISSIONER'S OFFICE

Phone (505) 827-5760

Fax (505) 827-5766

www.nmstatelands.org

April 22, 2003

Yates Petroleum Corporation
105 South Fourth Street
Artesia, New Mexico 88210

Attention: Mr. Robert Bullock

Re: Preliminary Approval
Proposed Strait State Exploratory Unit
Lea County, New Mexico

Dear Mr. Bullock:

This office has received the unexecuted copy of the unit agreement, which you have submitted for the proposed Strait State Exploratory Unit area, Lea County, New Mexico. This agreement meets the general requirements of the Commissioner of Public Lands, who has this date granted you preliminary approval as to form and content.

Preliminary approval shall not be construed to mean final approval of this agreement in any way and will not extend any short-term leases, until final approval and an effective date have been given.

When submitting your agreement for final approval, please submit the following:

1. Application for final approval by the Commissioner setting forth the tracts that have been committed and the tracts that have not been committed.
2. Pursuant to Rule 19.2.100.51, applications for approval shall contain a statement of facts showing:
 - a. That such agreement will tend to promote the conservation of oil and gas and the better utilization of reservoir energy.
 - b. That under the proposed unit operation, the State of New Mexico will receive its fair share of the recoverable oil and gas in place under its lands in the proposed unit area.
 - c. That each beneficiary institution of the State of New Mexico will receive its fair and equitable share of the recoverable oil and gas under its lands within the unit area.
 - d. That such unit agreement is in other respects for the best interest of the trust.
3. All ratifications from the Lessees of Record and Working Interest Owners. All signatures should be acknowledged by a notary and one set must contain original signatures.
4. Order of the New Mexico Oil Conservation Division. Our approval will be conditioned upon subsequent favorable approval by the New Mexico Oil Conservation Division.

BEFORE THE OIL CONSERVATION DIVISION

Santa Fe, New Mexico

Case No. 13051 Exhibit No. 5

Submitted by:

YATES PETROLEUM CORPORATION

Hearing Date: April 24, 2003

"WORKING FOR EDUCATION"

Yates Petroleum Corporation
April 22, 2003
Page 2

5. Please submit two copies of the Unit Agreement.
6. A copy of the Unit Operating Agreement (if applicable).
7. Copies of all the well records for the initial unit well.
8. Your filing fee in the amount of \$180.00 has been received.

If you have any questions or if we may be of further help, please contact Pete Martinez at (505) 827-5791.

Very truly yours,

PATRICK H. LYONS
COMMISSIONER OF PUBLIC LANDS

BY: 

JAMI BAILEY, Director
Oil, Gas and Minerals Division
(505) 827-5744

PL/JB/pm

cc: OCD-Santa Fe, Attention: Mr. Roy Johnson
William F. Carr



105 SOUTH FOURTH STREET
ARTESIA, NEW MEXICO 88210
TELEPHONE (505) 748-1471

AUTHORITY FOR EXPENDITURE

NEW DRILLING, RECOMPLETION & RE-ENTRY

AFE Type:

<input checked="" type="checkbox"/>	New Drilling
<input type="checkbox"/>	Recompletion
<input type="checkbox"/>	Re-entry

Well Objective:

<input checked="" type="checkbox"/>	Oil
<input checked="" type="checkbox"/>	Gas
<input type="checkbox"/>	Injector

Well Type:

<input type="checkbox"/>	Development
<input checked="" type="checkbox"/>	Exploratory

AFE NO.

AFE DATE

03-170-0

4/18/03

AFEND (rev 0/00)

AFE STATUS:

<input checked="" type="checkbox"/>	Original
<input type="checkbox"/>	Revised
<input type="checkbox"/>	Final
<input type="checkbox"/>	Supplemental

LEASE NAME
COUNTY
FIELD
LOCATION

Strait State Unit #1

Lea

Section 33 T10S-R34E, 1,980' S & 660' E

PROJ'D DEPTH
STATE
HORIZON

12,750'

New Mexico

Mississippian

DIVISION CODE
DISTRICT CODE
BRANCH CODE

100

DIVISION NAME
DISTRICT NAME
BRANCH NAME

Oil & Gas Division

PROGNOSIS: New well drilled to 12,750' to test the Atoka and Morrow formations.

INTANGIBLE DRILLING COSTS:

		DRY HOLE	COMP'D WELL
920-100	Staking, Permit & Legal Fees	3,000	3,000
920-110	Location, Right-of-Way	24,000	24,000
920-120	Drilling, Footage		
920-130	Drilling, Daywork 60 days @ \$8,200/day + \$25,000 for Mob	548,000	548,000
920-140	Drilling Water, Fasline Rental	25,000	25,000
920-150	Drilling Mud & Additives	60,000	60,000
920-160	Mud Logging Unit, Sample Bags	50,000	50,000
920-170	Cementing - Surface Casing	40,000	40,000
920-180	Drill Stem Testing, OHT 2 dst's	15,000	15,000
920-190	Electric Logs & Tape Copies	50,000	50,000
920-200	Tools & Equip. Rntl., Trkg. & Welding	70,000	70,000
920-205	Control of Well-Insurance	9,000	9,000
920-210	Supervision & Overhead	60,000	60,000
920-230	Coring, Tools & Service		
920-240	Bits, Tool & Supplies Purchase	68,000	68,000
920-350	Cementing - Production Casing		45,000
920-410	Completion Unit - Swabbing		15,000
920-420	Water for Completion		5,000
920-430	Mud & Additives for Completion		
920-440	Cementing - Completion		
920-450	Elec. Logs, Testing, Etc. - Completion		25,000
920-460	Tools & Equip. Rental, Etc. - Completion		40,000
920-470	Stimulation for Completion Completions only for Morrow & Atoka		80,000
920-480	Supervision & O/H - Completion		5,000
920-490	Additional LOC Charges - Completion		6,000
920-510	Bits, Tools & Supplies - Completion		1,000
920-500	Contingency for Completion 10 percent	100,000	160,000
TOTAL INTANGIBLE DRILLING COSTS		1,122,000	1,404,000

TANGIBLE EQUIPMENT COSTS:

930-010	Christmas Tree & Wellhead	2,500	22,000
930-020	Casing 13 3/8" @ 400'	7,000	7,000
	9 5/8" @ 4,150'	55,500	55,500
	7" @ 12,750'		150,000
930-030	Tubing 2 3/8" @ 12,550' & 2 3/8" @ 11,550'		60,000
930-040	Packer & Special Equipment Dual packer		25,000
940-010	Pumping Equipment		
940-020	Storage Facilities		15,000
940-030	Separation Equip., Flowlines, Misc.		30,000
940-040	Trucking & Construction Costs		15,000
TOTAL TANGIBLE EQUIPMENT COSTS		65,000	379,500

TOTAL COSTS

1,187,000 1,783,500

APPROVAL OF THIS AFE CONSTITUTES APPROVAL OF OPERATOR'S OPTION TO CHARGE THE JOINT ACCOUNT WITH
TUBULAR GOODS FROM THE OPERATOR'S WAREHOUSE STOCK AT THE RATES STATED ABOVE.

Prepared By	Jeremiah Mullen	Operations Approval	
-------------	-----------------	---------------------	--

BY	DATE
----	------

BY	DATE
----	------

BY	DATE
----	------

BEFORE THE OIL CONSERVATION DIVISION
Santa Fe, New Mexico
Case No. 13051 Exhibit No. 6
Submitted by:
YATES PETROLEUM CORPORATION
Hearing Date: April 24, 2003

Strait Exploratory Unit Geologic Justification

Yates Petroleum Corporation requests the formation of the Strait Exploratory Unit to support the drilling of a well in the SE/4 of section 33 T10S R34E. . The footage location of this well is 1980' FSL and 660' FEL. The primary target will be the Atoka-Morrow, but the well will reach TD in the Mississippian limestone at a depth of 12,750'. The proposed unit outline is shown on the geologic structure map by the red outline.

The targeted Atoka-Morrow sands are gas productive channel sands of limited aerial extent. These channel sands were deposited in structurally low areas that developed during Atoka-Morrow time. During late Mississippian time, erosion from uplifted fault blocks located to the southwest supplied sand to this area. These sand channels developed in subtle lows, which are shown on the Austin (Miss age) structure map in blue. Both seismic and well control were used to construct the Austin map.

These sand channels form narrow, elongate features, but they can be very prolific. One of the best Morrow well on the map is the Yates, Sand Springs ASU #1 shown in the extreme south portion of the map. This well, which has a cumulative production of 1.2 BCF, is shown on cross section A – A'). The well has an expanded Morrow section which has eroded into the underlying Austin zone. The Atoka Morrow producers are shown by a purple circle.

There has been only one Atoka Morrow penetration inside the proposed 6 section unit, and it was a dry hole. There has been upper Pennsylvanian production in the northwest corner of the proposed unit, but all wells were abandoned by 1975. Yates is attempting to extend the Morrow production in the southern edge of the map north into the unit area.

A successful first well in the Unit outline will lead to the other channel systems shown on the map being tested.

Yates Petroleum Corporation believes there is potential for channel sand development in this proposed unit. This is a high risk project which will cost approximately \$1,429,600 for a completed well. The formation of this exploratory unit would aid in the development of potential reservoirs in an area with no exploration success in the Atoka Morrow.

BEFORE THE OIL CONSERVATION DIVISION
Santa Fe, New Mexico
Case No. 13051 Exhibit No. 9
Submitted by:
YATES PETROLEUM CORPORATION
Hearing Date: April 24, 2003

**STATE OF NEW MEXICO
ENERGY, MINERALS AND NATURAL RESOURCES DEPARTMENT
OIL CONSERVATION DIVISION**

**IN THE MATTER OF THE HEARING
CALLED BY THE OIL CONSERVATION
DIVISION FOR THE PURPOSE OF
CONSIDERING:**

**CASE NO. 13051
ORDER NO. R-_____**

**APPLICATION OF YATES PETROLEUM CORPORATION FOR A UNIT
AGREEMENT, LEA COUNTY, NEW MEXICO.**

ORDER OF THE DIVISION

BY THE DIVISION:

This case came on for hearing on April 24, 2003 at Santa Fe, New Mexico, before Examiner Michael E. Stogner.

NOW, on this ___ th day of April, 2003, the Division Director, having considered the record and the recommendations of the Examiner,

FINDS THAT:

(1) Due public notice has been given, and the Division has jurisdiction of this case and its subject matter.

(2) The applicant, Yates Petroleum Corporation, seeks approval of its Strait State Exploratory Unit Agreement for all oil and gas in all formations underlying the following-described 3,840.00 acres, more or less, of state lands in Lea County, New Mexico:

TOWNSHIP 10 SOUTH, RANGE 34 EAST, NMPM

Sections 20 and 21: All
Sections 28 and 29: All
Sections 32 and 33: All

(3) No interested party appeared or otherwise objected to the proposed unit agreement.

(4) The approval of the proposed unit agreement will serve to prevent waste and protect correlative rights within the lands assigned to the unit area.

BEFORE THE OIL CONSERVATION DIVISION
Santa Fe, New Mexico
Case No. 13051 Exhibit No. 10
Submitted by:
YATES PETROLEUM CORPORATION
Hearing Date: April 24, 2003

IT IS THEREFORE ORDERED THAT:

(1) The Strait State Exploratory Unit Agreement executed by Yates Petroleum Corporation is hereby approved for all oil and gas in all formations underlying the following-described 3840.00 acres, more or less, of state lands in Lea County, New Mexico:

TOWNSHIP 10 SOUTH, RANGE 34 EAST, NMPM

Sections 20 and 21: All
Sections 28 and 29: All
Sections 32 and 33: All

(2) The plan contained in the Strait State Exploratory Unit Agreement for the development and operation of the above-described unit area is hereby approved in principle; provided, however, notwithstanding any of the provisions contained in the unit agreement, this approval shall not be considered as waiving or relinquishing, in any manner, any right, duty, or obligation that is now, or may hereinafter be, vested in the Division to supervise and control operations for the unit and production of oil and gas therefrom.

(3) The unit operator shall file with the Division an executed original or executed counterpart of the unit agreement within 30 days of the effective date thereof; in the event of subsequent joinder by any other party, or expansion or contraction of the unit area, the unit operator shall file with the Division, within 30 days thereafter, copies of the unit agreement reflecting the subscription of those interests having joined or ratified.

(4) All: (i) plans of development and operation; (ii) creations, expansions or contractions of participating areas; and (iii) expansions or contractions of the unit area shall be submitted to the Division Director for approval.

(5) This order shall become effective upon approval of the unit agreement by the Commissioner of Public Lands for the State of New Mexico. This order shall terminate upon the termination of the unit agreement. The last unit operator shall notify the Division immediately in writing of such termination.

(6) Jurisdiction of this case is retained for the entry of such further orders as the Division may deem necessary.

Case No. 13051

Order No. R-_____

Page 3

DONE at Santa Fe, New Mexico on the day and year hereinabove designated.

STATE OF NEW MEXICO
OIL CONSERVATION DIVISION

LORI WROTENBERY
Director

SEAL