

Ex. 11: Saba State #1

API #30-025-33726

UL I, Section 7, T13S, R36E

Exhibit 11-A: Form C-101, Application for Permit to Drill, Re-Enter, Deepen, Plugback or Add a Zone, dated 11-8-96. Approved by OCD 12-19-96. Operator: "Saba Energy of Texas, Incorporated."

Exhibit 11-B: Form C-103, Sundry Notices and Reports on Wells (notice of intention to change plans, and subsequent report of commence drilling opns), dated 11-20-96. (Changing the surface location reported on the C-101 form to 2310' FSL and 1308' FEL Section 7-13S-36E, Lea County, NM.) Operator: "Saba Energy of Texas, Incorporated."

Issue 1
Box 1980, Hobbs, NM 88241-1980
District II
11 South First, Artesia, NM 88210
District III
100 Rio Brazos Rd., Aztec, NM 87410
District IV
140 South Pacheco, Santa Fe, NM 87505

State of New Mexico
Energy, Minerals & Natural Resources Department
OIL CONSERVATION DIVISION
2040 South Pacheco
Santa Fe, NM 87505

Before the OCC
Case 13163
de novo
OCD Ex. 11-A
☐ AMENDED REPORT

APPLICATION FOR PERMIT TO DRILL, RE-ENTER, DEEPEN, PLUGBACK, OR ADD A ZONE

¹ Operator Name and Address. Saba Energy of Texas, Incorporated 1603 S.E. 19th Street, Suite 202 Edmond, Oklahoma 73013		² OGRID Number 34703 ³ API Number 30-025-33726
⁴ Property Code 20071	⁵ Property Name Saba State Inc	⁶ Well No. 1 2

⁷ Surface Location									
UL or lot no.	Section	Township	Range	Lot Idn	Feet from the	North/South line	Feet from the	East/West line	County
I	7	13S	36E		2310 2320	South	1308	East	Lea

⁸ Proposed Bottom Hole Location If Different From Surface									
UL or lot no.	Section	Township	Range	Lot Idn	Feet from the	North/South line	Feet from the	East/West line	County

⁹ Proposed Pool 1	¹⁰ Proposed Pool 2
Wildcat	Tatum Wolfcamp

¹¹ Work Type Code N	¹² Well Type Code O	¹³ Cable/Rotary Rotary	¹⁴ Lease Type Code State	¹⁵ Ground Level Elevation 4003'
¹⁶ Multiple No	¹⁷ Proposed Depth 14,200'	¹⁸ Formation Devonian	¹⁹ Contractor N/A	²⁰ Spud Date 12/30/96

²¹ Proposed Casing and Cement Program					
Hole Size	Casing Size	Casing weight/foot	Setting Depth	Sacks of Cement	Estimated TOC
17-1/2"	13-3/8"	54.5#	450'	495	surface
12-1/4"	8-5/8"	24# & 32#	4500'	1770	surface
7-7/8"	5-1/2"	17# & 20#	14,200'	400	12,200'

Describe the proposed program. If this application is to DEEPEN or PLUG BACK give the data on the present productive zone and proposed new productive zone. Describe the blowout prevention program, if any. Use additional sheets if necessary.

Drilling program designed to safely and efficiently drill a 14,200' Devonian exploratory well. BOP equipment on desired rig will consist of 1 - 11" x 5000 psi double hydraulic BOP, 1 - 11" x 5000 psi annular BOP, 4" x 5000 psi choke manifold and Koomey 6 station accumulator with remote control.

Permit Expires 1 Year From Approval Date Unless Drilling Underway

¹ I hereby certify that the information given above is true and complete to the best of my knowledge and belief. Signature: <u>Tracy Mills</u> Printed name: Tracy Mills Title: Engineering Assistant Date: 11/08/96		OIL CONSERVATION DIVISION Approved by: <u>ORC/MIA</u> Title: _____ Approval Date: DEC 19 1996 Expiration Date: _____ Conditions of Approval: Attached <input type="checkbox"/>	
Phone: (405) 340-3600			

DISTRICT I
P.O. Box 1980, Hobbs, NM 88240

DISTRICT II
P.O. Drawer DD, Artesia, NM 88210

DISTRICT III
1000 Rio Brazos Rd., Aztec, NM 87410

OIL CONSERVATION DIVISION

2040 Pacheco St.
Santa Fe, 87505

WELL API NO.

30-025-33726

5. Indicate Type of Lease

STATE ☒

FEE ☐

6. State Oil & Gas Lease No.

NMVA914

7. Lease Name or Unit Agreement Name

Saba State

8. Well No.

1

9. Pool name or Wildcat

Wildcat

SUNDRY NOTICES AND REPORTS ON WELLS

(DO NOT USE THIS FORM FOR PROPOSALS TO DRILL OR TO DEEPEN OR PLUG BACK TO A
DIFFERENT RESERVOIR. USE "APPLICATION FOR PERMIT"
(FORM C-101) FOR SUCH PROPOSALS.)

1. Type of Well:

OIL
WELL ☒

GAS
WELL ☐

OTHER

2. Name of Operator

Saba Energy of Texas, Incorporated

3. Address of Operator

1603 S.E. 19th Street, Suite 202 Edmond, Oklahoma 73013

4. Well Location

Unit Letter T : 2310 Feet From The South Line and 1308 Feet From The East Line

Section

7

Township

13S

Range

36E

NMPM

Lea

County

10. Elevation (Show whether DF, RKB, RT, GR, etc.)

4003' GR

11.

Check Appropriate Box to Indicate Nature of Notice, Report, or Other Data

NOTICE OF INTENTION TO:

PERFORM REMEDIAL WORK ☐

PLUG AND ABANDON ☐

TEMPORARILY ABANDON ☐

CHANGE PLANS ☒

WELL OR ALTER CASING ☐

OTHER: ☐

SUBSEQUENT REPORT OF:

REMEDIAL WORK ☐

ALTERING CASING ☐

COMMENCE DRILLING OPNS. ☒

PLUG AND ABANDONMENT ☐

CASING TEST AND CEMENT JOB ☐

OTHER: ☐

12. Describe Proposed or Completed Operations (Clearly state all pertinent details, and give pertinent dates, including estimated date of starting any proposed work) SEE RULE 1103.

This is being filed to change the surface location reported on the C-101 form from
2325' FSL and 1308' FEL to 2310' FSL and 1308' FEL Section 7-13S-36E, Lea County, NM.

Before the OCC
Case 13163
de novo
OCD Ex. 11-B

I hereby certify that the information above is true and complete to the best of my knowledge and belief.

SIGNATURE

Tracy Mills

TITLE Engineering Assistant

DATE 11/20/96

TYPE OR PRINT NAME

Tracy Mills

(405) 340-3600
TELEPHONE NO.

This space for State Use

APPROVED BY

TITLE

DATE

CONDITIONS OF APPROVAL, IF ANY:

P. O. Box 1980
Hobbs, NM 88241-1980

State of New Mexico
Department of Energy, Minerals, and Natural Resources

Revised 02-10-94
Instructions on back

DISTRICT II
P. O. Drawer DD
Artesia, NM 88211-0719

DISTRICT III
1000 Rio Brazos Rd.
Aztec, NM 87410

DISTRICT IV
P. O. Box 2088
Santa Fe, NM 87507-2088

OIL CONSERVATION DIVISION
P. O. Box 2088
Santa Fe, New Mexico 87504-2088

Submit to the Appropriate
District Office
State Lease - 4 copies
Fee Lease - 3 copies

☒ AMENDED REPORT

WELL LOCATION AND ACREAGE DEDICATION PLAT

1 API Number 30-025-33726		2 Pool Code ✓		3 Pool Name Wildcat	
4 Property Code 20071		5 Property Name SABA STATE			6 Well Number 1
7 OGRID No. 34703		8 Operator Name SABA ENERGY OF TEXAS, INC.			9 Elevation 4003'

10 SURFACE LOCATION

UL or lot no. I	Section 7	Township 13 SOUTH	Range 36 EAST, N.M.P.M.	Lot Ida	Feet from the 2310'	North/South line SOUTH	Feet from the 1308'	East/West line EAST	County LEA
---------------------------	---------------------	-----------------------------	-----------------------------------	---------	-------------------------------	----------------------------------	-------------------------------	-------------------------------	----------------------

"BOTTOM HOLE LOCATION IF DIFFERENT FROM SURFACE"

UL or lot no.	Section	Township	Range	Lot Ida	Feet from the	North/South line	Feet from the	East/West line	County
---------------	---------	----------	-------	---------	---------------	------------------	---------------	----------------	--------

12 Dedicated Acres 40	13 Joint or Infill N	14 Consolidation Code	15 Order No.
---------------------------------	--------------------------------	-----------------------	--------------

NO ALLOWABLE WELL BE ASSIGNED TO THIS COMPLETION UNTIL ALL INTERESTS HAVE BEEN CONSOLIDATED OR A NON-STANDARD UNIT HAS BEEN APPROVED BY THE DIVISION

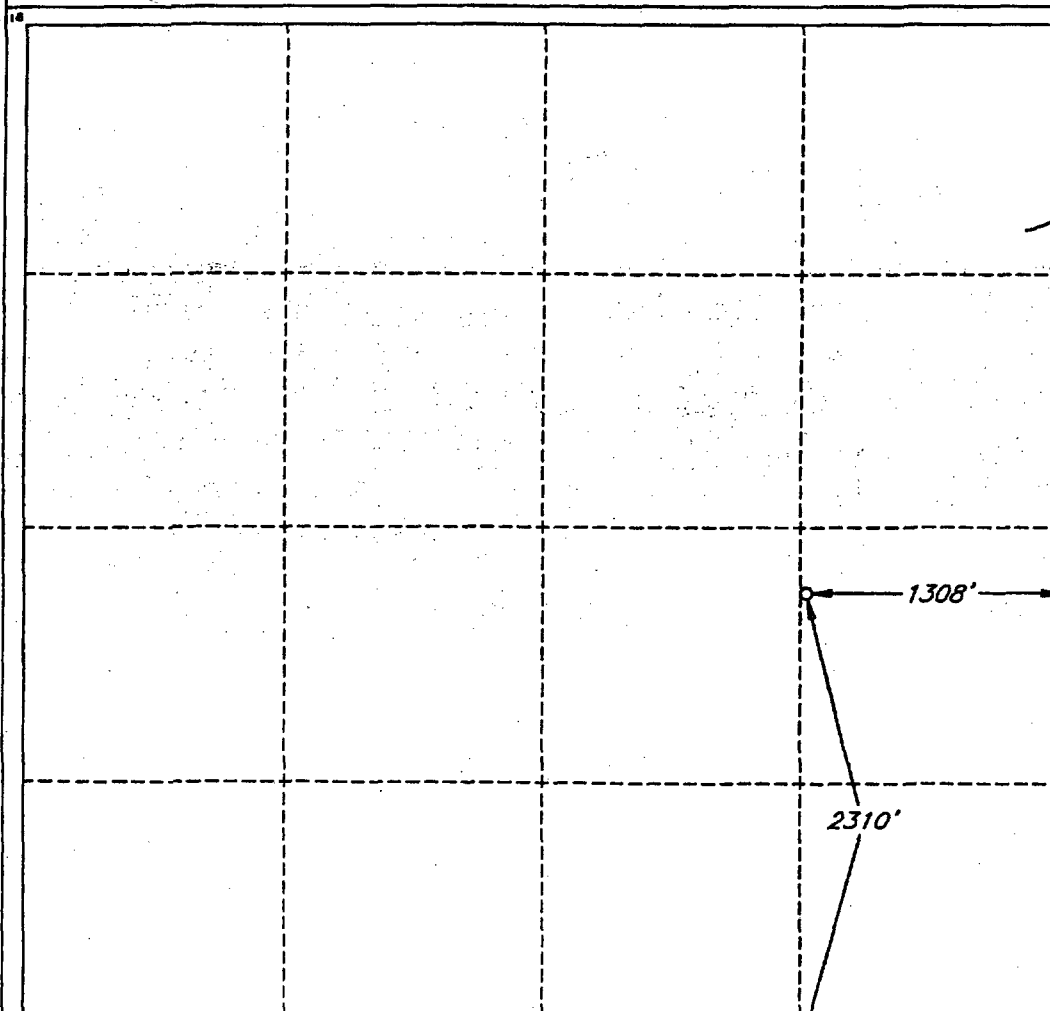

OPERATOR CERTIFICATION

I hereby certify that the information contained herein is true and complete to the best of my knowledge and belief.

Signature
Tracy Mills

Printed Name
Tracy Mills

Title
Engineering Assistant

Date
November 20, 1996

SURVEYOR CERTIFICATION

I hereby certify that the well location shown on this plat was plotted from field notes of actual surveys made by me or under my supervision, and that the same is true and correct to the best of my belief.

Date of Survey
NOVEMBER 18, 1996

Signature and Seal of Professional Surveyor

V. LYNN BEZNER
NO. 7920
Certified Surveyor
V. L. BEZNER R.P.S. #7920