

Brabant #1
 South Paddock Area
 Sec. 8, T 22 S, R 38 E
 Lea County, New Mexico

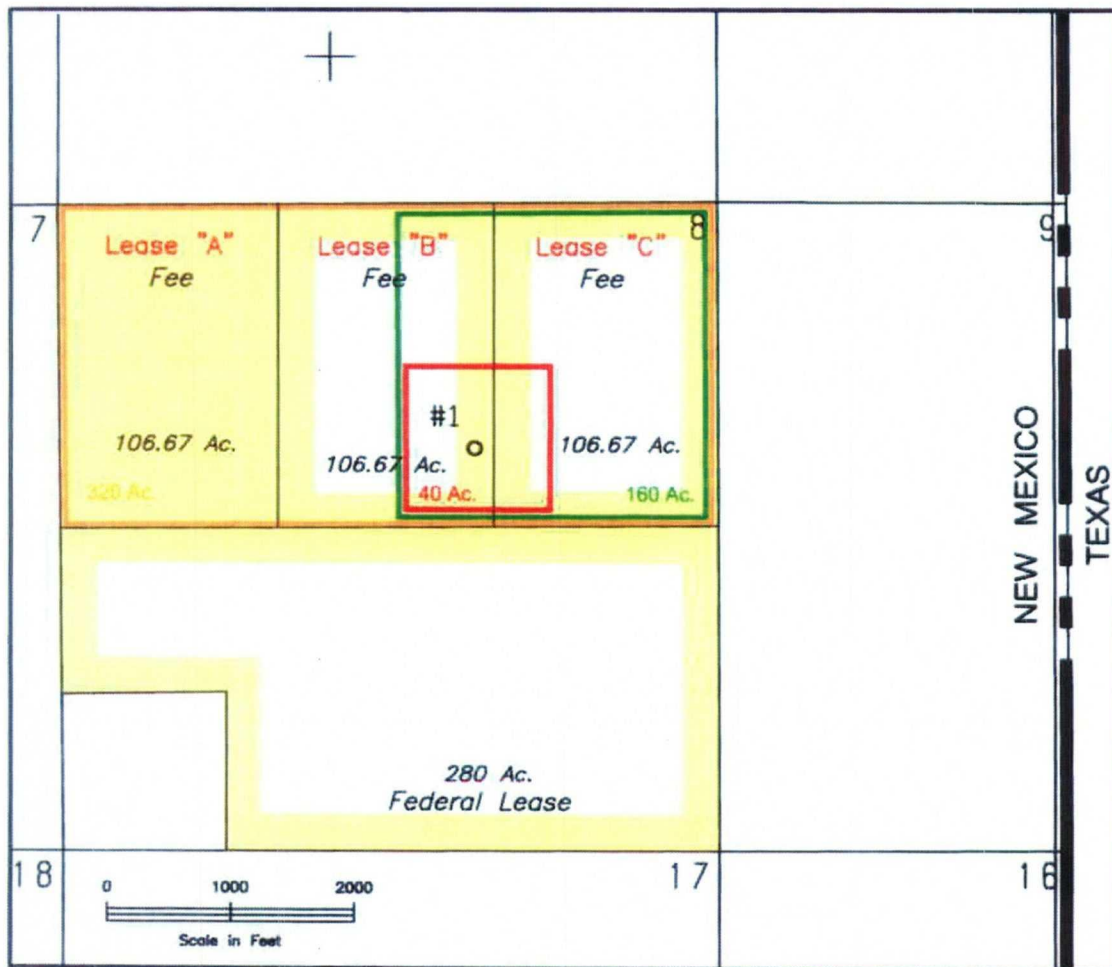

Owners - Unleased by OXY & uncommitted			
Lease A	Lease B		Lease C
None	W. Akers	0.0833%	W.E. Scarlett 1.3021%
	E.F. Barnes	0.5555%	G.P. Scarlett 1.3021%
	F. Tankersley	0.5555%	
	Macenas Minerals	0.3150%	
	Republic Royalty	1.2383%	
	Fasken Foundation	0.0833%	
	L.J. Houston	0.1029%	
	B.T. Houston	0.3086%	

Legend	
—	40 Acre Unit
—	160 Acre Unit
—	320 Acre Unit

BEFORE THE OIL CONSERVATION DIVISION

Santa Fe, New Mexico

Case No. 13430 Exhibit No. 2

Submitted by:

Redmon Oil Company, Inc.

Hearing Date: February 17, 2005

Brabant No1.dwg