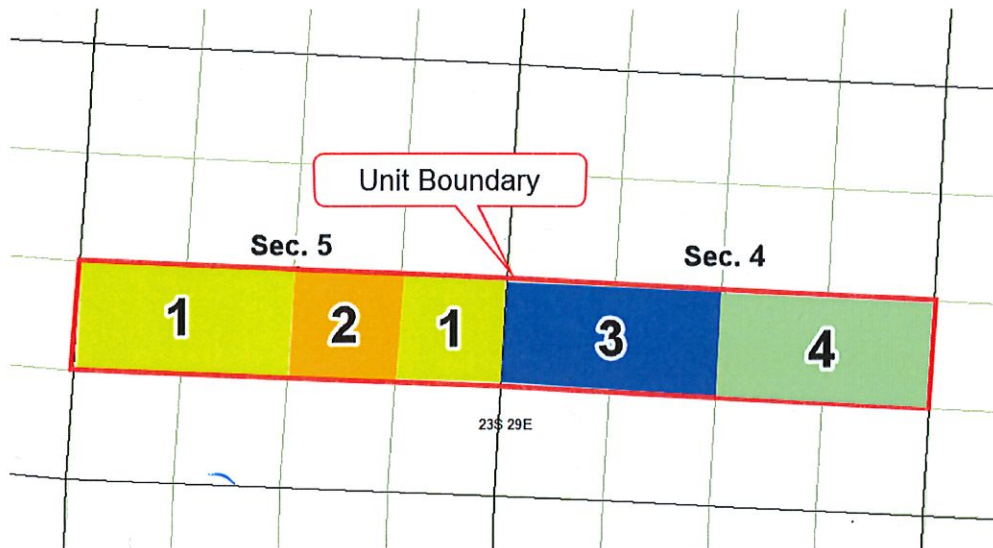

Exhibit: 16
Case No. 16283



Tract 1: N/2 SW/4, NE/4 SE/4 of Section 5-23S-29E

Novo Oil & Gas Northern Delaware, LLC

Surface to 8,773'

100.00%

Below 8,773'

100.00%

Tract 2: NW/4 SE/4 of Section 5-23S-29E

Novo Oil & Gas Northern Delaware, LLC
COG Operating LLC

0%
100.00%

100.00%
0%

Tract 3: N/2 SW/4 of Section 4-23S-29E

EOG Y Resources, Inc.
EOG A Resources, Inc.
EOG M Resources, Inc.
OXY Y-1 Company

40.00%
20.00%
20.00%
20.00%

40.00%
20.00%
20.00%
20.00%

Tract 4: N/2 SE/4 of Section 4-23S-29E

XTO Energy, Inc.

100.00%

100.00%

Unit Working Interest

Novo Oil & Gas Northern Delaware, LLC
COG Operating LLC
EOG Y Resources, Inc.
EOG A Resources, Inc.
EOG M Resources, Inc.
OXY Y-1 Company
XTO Energy, Inc.

37.50%
12.50%
10.00%
5.00%
5.00%
5.00%
25.00%

50.00%
0%
10.00%
5.00%
5.00%
5.00%
25.00%

100.00%

100.00%