



February 29, 2012

Assistant District Manager, Minerals  
Bureau of Land Management  
Farmington Resource Area  
1235 LaPlata Highway  
Farmington, New Mexico 87401

Commissioner of Public Lands  
State of New Mexico  
P. O. Box 1148  
Santa Fe, New Mexico 87504-1148

Oil Conservation Commission  
State of New Mexico  
1220 South St. Francis Drive  
Santa Fe, New Mexico 87505-4000

Re: Cox Canyon Unit I, Sec. No. 946  
San Juan County, New Mexico  
2012 Plan of Development

Gentlemen:

By letter dated January 10, 2011 WPX Energy Production, LLC (f/k/a Williams Production Company, LLC), as Cox Canyon Unit Operator, filed the 2011 Plan of Development for the referenced Unit. WPX Energy Production, LLC did not propose any wells under the 2011 Cox Canyon Plan of Development.

The Participating Areas, which have been established in the Cox Canyon Unit, are as follows:

<u>Formation</u>	<u>Revision</u>	<u>Effective</u>
Pictured Cliffs	Fifth	October 1, 1977
Mesaverde	Initial	July 20, 1953
Fruitland Coal	First	November 1, 1990

Attached are maps of each of the producing formations within the Cox Canyon Unit showing the boundaries of the Participating Areas as applicable. The Cox Canyon #14C PC and Cox Canyon #24 PC wells were plugged and abandoned in 2011. The Cox Canyon #9B MV/DK well was commingled in 2011.

Cox Canyon  
2012 Plan of Development  
February 29, 2012

**Pursuant to Section 10 the Cox Canyon Unit Agreement, WPX Energy Production, LLC, as Unit Operator, proposes that no wells will be drilled within the Cox Canyon Unit during 2012.** WPX Energy Production, LLC, as Unit Operator, will drill any offset wells that may be required to prevent drainage of unitized substances and any other wells deemed necessary or which are requested by the Unit Operator or Working Interest Owners.

If this Plan of Development is acceptable, please signify your approval, as required under Section 10 of the Unit Agreement, in the space provided on the enclosed sheet and return an approved copy to Williams Production Company.

Copies of this Plan of Development are being sent to the Working Interest Owners as shown on the enclosed sheet.

Sincerely,

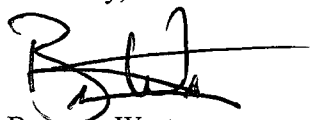
A handwritten signature in black ink, appearing to read 'Brennan West', with a horizontal line extending to the right.

Brennan West  
Landman  
WPX Energy Production, LLC

Enclosures

cc: Working Interest Owners  
Ken McQueen  
Bobby Goodwin  
Kris Russell  
Bryan Holmes  
Sean Brezas  
Barb Pickup  
Kirk Place  
Heather Riley

Cox Canyon  
2012 Plan of Development  
February 29, 2012

APPROVED: \_\_\_\_\_  
Assistant District Manager, Minerals  
Bureau of Land Management  
Subject to like approval by the  
Commissioner of Public Lands and  
The Oil Conservation Commission

DATE: \_\_\_\_\_

APPROVED: \_\_\_\_\_  
Commissioner of Public Lands  
Subject to like approval by the  
Area Oil and Gas Supervisor and  
The Oil Conservation Commission

DATE: \_\_\_\_\_

APPROVED: *Ed Martin*  
Oil Conservation Commission  
Subject to like approval by the  
Area Oil and Gas Supervisor and  
The Commissioner of Public Lands

DATE: 3/6/2012

The foregoing approvals are for the 2012 Plan of Development for the Cox Canyon Unit I, Sec. No. 946,  
San Juan County, New Mexico.

Cox Canyon  
2012 Plan of Development  
February 29, 2012

**WORKING INTEREST OWNERS  
COX CANYON UNIT**

BP America Production Company  
Attn: Craig Carley  
501 Westlake Park Boulevard (77079)  
P.O. Box 3092  
Houston, TX 77253-3092

Burlington Resources  
Attn: Land Department  
P. O. Box 4289  
Farmington, NM 87499-4289

ConocoPhillips Company  
Attn: Land Department  
P. O. Box 4289  
Farmington, NM 87499-4289

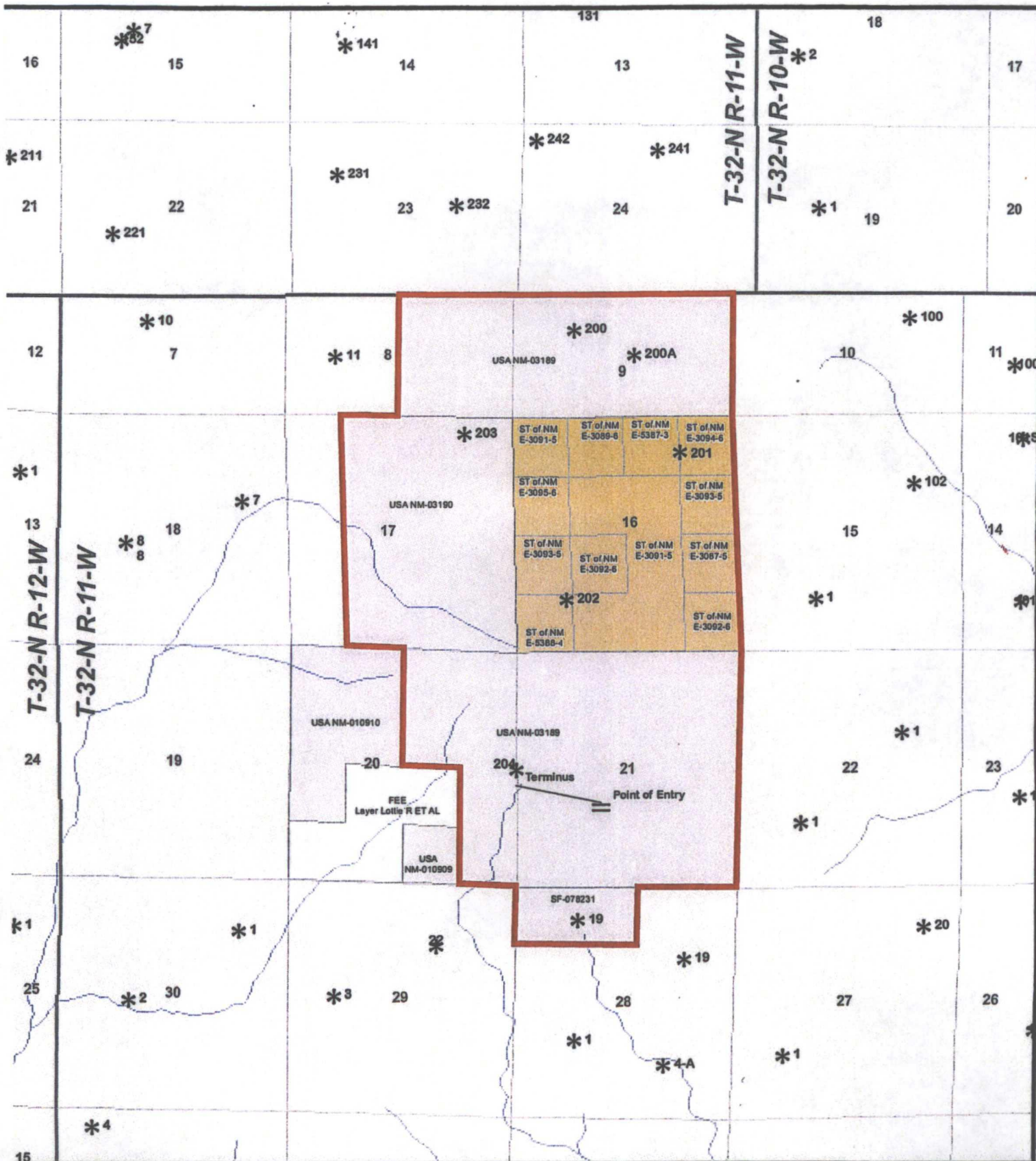

- \* Fruitland Wells
- Cox Canyon Unit
- Mineral Ownership
- Federal
- Fee
- State

2,000 Feet



Exporation & Production



**Cox Canyon**  
**Fruitland Formation**  
**San Juan County, New Mexico**

Scale: 1:36,000	Projection: NAD 1983 State Plane NM West
Date: 3/20/2006	Author: SA



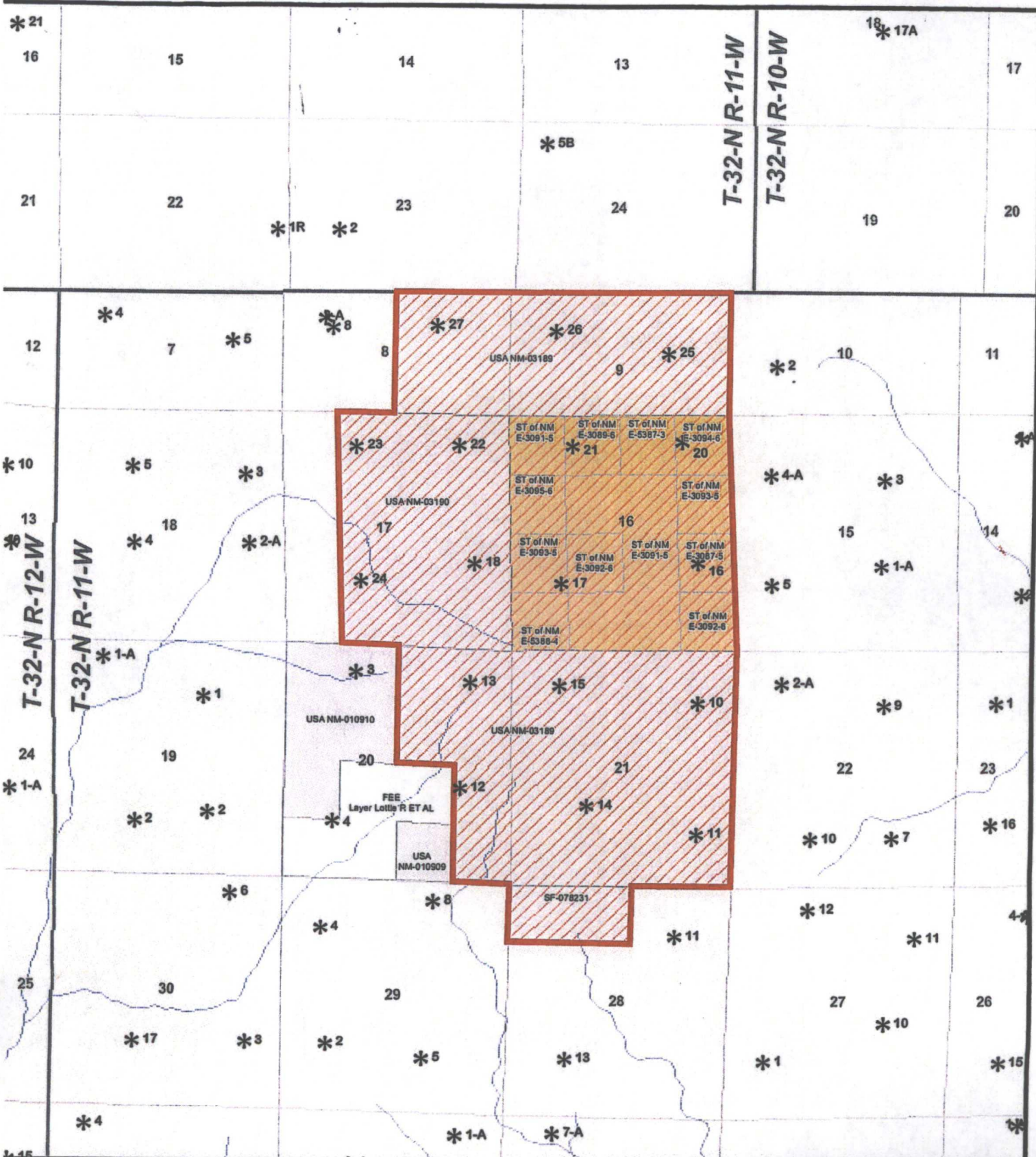



Exporation & Production

**Cox Canyon**

**Pictured Cliffs Formation**

**San Juan County, New Mexico**



Scale: 1:36,000	Projection: NAD 1983 State Plane NM West
Date: 3/20/2006	Author: SA



