

36 E

22

27

27

34

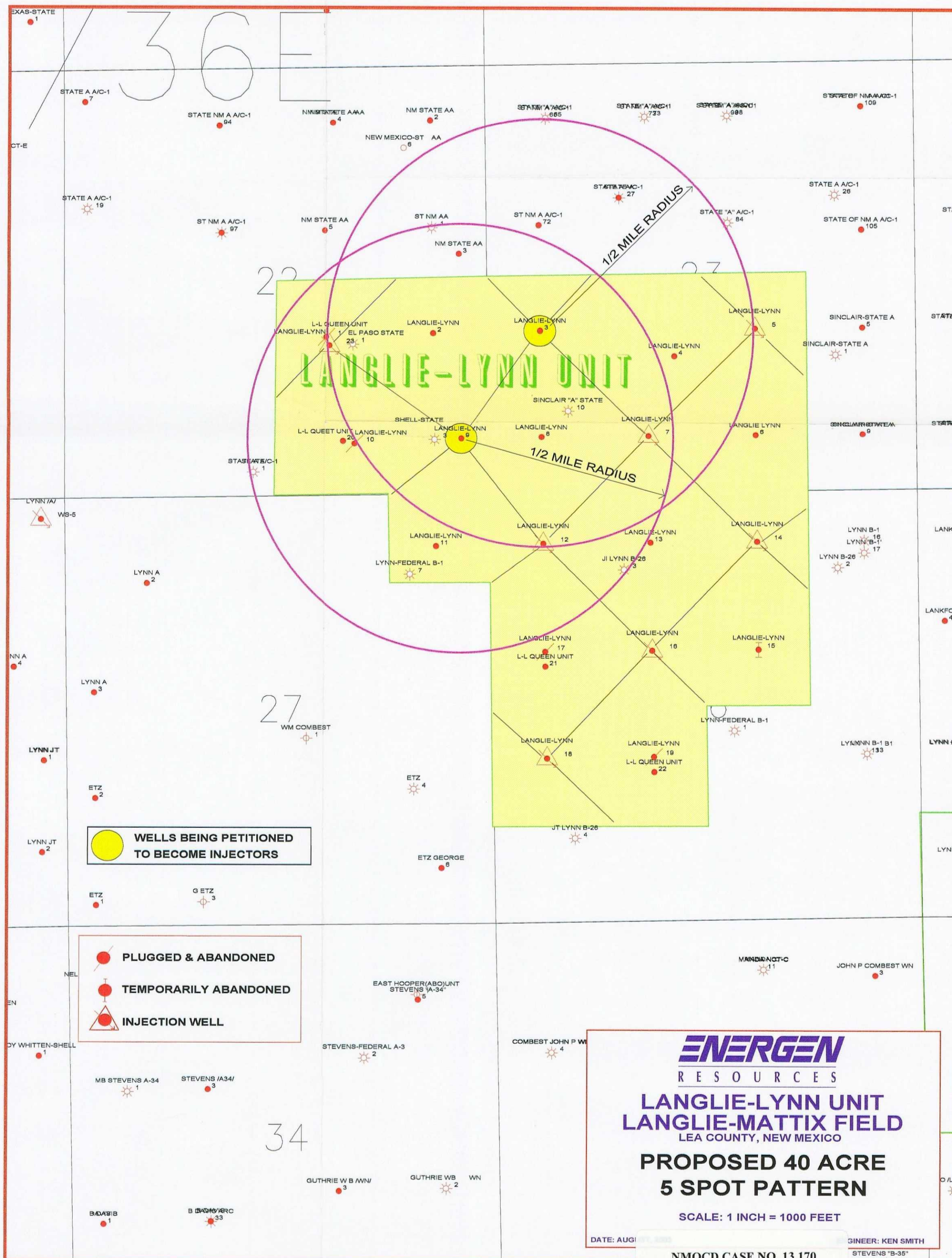

 **WELLS BEING PETITIONED TO BECOME INJECTORS**

 **PLUGGED & ABANDONED**

 **TEMPORARILY ABANDONED**

 **INJECTION WELL**

**ENERGEN**  
RESOURCES

**LANGLIE-LYNN UNIT**  
**LANGLIE-MATTIX FIELD**  
LEA COUNTY, NEW MEXICO

**PROPOSED 40 ACRE**  
**5 SPOT PATTERN**

SCALE: 1 INCH = 1000 FEET

DATE: AUGUST 2003

ENGINEER: KEN SMITH

NMOCD CASE NO. 13,170  
DECEMBER 4, 2003  
ENERGEN EXHIBIT NO. 8