

366
MAIN MAIL ROOM OCC
1963 JAN 28 AM 8:30
William A. & Edward R. Hudson
1510 First National Building
Fort Worth, Texas

January 25th, 1963

Oil Conservation Commission
State of New Mexico
Santa Fe, New Mexico

Gentlemen:

We enclose a single copy of a Consent and Ratification of the Poker Lake Unit Agreement and Unit Operating Agreement, committing Federal Lease LC-069108, to said Unit Agreement.

Yours very truly,



ERH:m
Encl

EDWARD R. HUDSON, FOR
WILLIAM A. & EDWARD R. HUDSON

William A. & Edward R. Hudson
MAIN OFFICE OCC

1510 First National Building

1963 JAN 28 AM 6:38

Fort Worth, Texas

January 25th, 1963

U. S. Geological Survey
P. O. Drawer 1857
Roswell, New Mexico

Gentlemen:

I enclose the original and three copies of Consent and Ratification of the Poker Lake Unit Agreement and Unit Operating Agreement covering lands in Eddy County, New Mexico, executed by William A. and wife, Roxie E. Hudson, and Edward R. and wife, Josephine T. Hudson, committing Lease No. LC-069108 to that Unit Agreement and ratifying the terms of that Unit Operating Agreement.

We are continuing negotiations with the Operator of that Unit, Perry R. Bass, with a view of working out an equitable basis for settlement with them in joining the Unit.

If there are any further requirements, kindly notify us.

We are filing a single copy of this Consent and Ratification with the Commissioner of Public Lands and the Oil Conservation Commission of the State of New Mexico.

Yours truly,

Edward R. Hudson

EDWARD R. HUDSON, FOR
WILLIAM A. & EDWARD R. HUDSON

ERH:m
Encls

366
MAIN OFFICE OCC

1963 FEB 11 AM 8:15
Alamogordo, New Mexico

February 7, 1963

Perry R. Bass
Fort Worth National Bank Building
Fort Worth, Texas

Gentlemen:

By letter of January 30 we acknowledged receipt on January 28, 1963, of a ratification and joinder to the Poker Lake unit agreement and unit operating agreement, Eddy County, New Mexico, executed by William A. Hudson and Edward E. Hudson, leasees of record and working interest owners of lease Las Cruces 069108, unit tract No. 47. Our letter advised that lease Las Cruces 069108 is considered effectively committed to the Poker Lake unit agreement as of February 1, 1963.

The above described letter is hereby modified to the extent necessary to provide that evidence of compliance with section 19 of the Poker Lake unit operating agreement required by section 30 of the Poker Lake unit agreement must be furnished this office before lease Las Cruces 069108 can be considered as committed to the Poker Lake unit agreement. Upon receipt of satisfactory evidence that the signatory parties to the above described ratification and joinder have complied with the requirements and approvals provided for in the unit operating agreement pertaining to such subsequent joinder, lease Las Cruces 069108 will be considered effectively committed to the Poker Lake unit agreement as of February 1, 1963. If such evidence is not furnished by March 15, 1963, the joinder will be considered as incomplete and noneffective.

Very truly yours,

(Orig. Sgd.) JOHN A. ANDERSON

JOHN A. ANDERSON
Regional Oil and Gas Supervisor

Copy to: William A. and Edward E. Hudson
1510 First Nat. Bank Bldg.
Fort Worth, Texas

Washington
BLM, Santa Fe
Artesia

MAIN OFFICE OCC

1963 JAMES LAKE UNIT AGREEMENT
AND UNIT OPERATING AGREEMENT

KNOW ALL MEN BY THESE PRESENTS:

The undersigned acknowledge receipt of a copy of the Unit Agreement and Unit Operating Agreement for the development and operation of the Poker Lake Unit Area dated the 18th day of March, 1952, embracing lands situated in Eddy County, New Mexico, and acknowledge that they have read the same and are familiar with the terms and conditions thereof. The undersigned also being the owners of the leasehold interest in the lands or minerals embraced in said Unit Area, as indicated on the schedule attached to the Unit Agreement as Exhibit "B", do hereby commit all of their said interest to the Poker Lake Unit Agreement and Unit Operating Agreement and do hereby consent thereto and ratify all of the terms and provisions thereof, exactly the same as if the undersigned had executed the original of said Unit Agreement and Unit Operating Agreement or a counterpart thereof.

IN WITNESS WHEREOF, this instrument is executed by the undersigned as of the date set forth in their respective acknowledgments.

Lease Committed:

LC-069108

William A. Hudson
William A. Hudson

Roxie E. Hudson
Roxie E. Hudson

Edward R. Hudson
Edward R. Hudson

Josephine T. Hudson
Josephine T. Hudson

THE STATE OF TEXAS)

COUNTY OF TARRANT)

The foregoing instrument was acknowledged before me this 15th day of January, 1963, by WILLIAM A. HUDSON and wife, ROXIE E. HUDSON, and EDWARD R. HUDSON and wife, JOSEPHINE T. HUDSON.

J. B. Meeker
Notary Public, Tarrant County,
Texas.

My Commission Expires: 5/1/63

PERRY R. BASS
12TH FLOOR FT. WORTH NAT'L BANK BLDG.
FORT WORTH, TEXAS

MAIN OFFICE OCC

October 16, 1963

1963 OCT 21 AM 8:24

Mrs. Marian Rhea
State Land Office
P. O. Box 791
Santa Fe, New Mexico

Dear Mrs. Rhea:

Enclosed please find Plan of Development, in duplicate,
together with exhibits attached, covering the Poker Lake Unit Area.

We submit this application for your approval and request that
you advise the United States Geological Survey of your approval of same
after same has been properly executed.

We ask that the Commissioner of Public Lands and the New
Mexico Oil Conservation Commission please notify other interested
parties by a copy of their transmittal letter in order that the respective
parties hereto shall receive official notification.

Very truly yours,

PERRY R. BASS

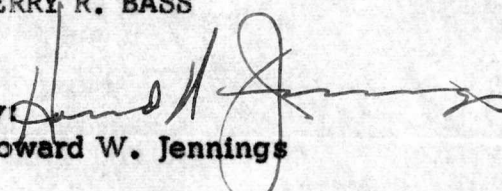
By 
Howard W. Jennings

HWJ:lcc
Encls. (2)

cc: United States Geological Survey
New Mexico Oil Conservation Commission

PERRY R. BASS
12TH FLOOR FT. WORTH NAT'L BANK BLDG.
FORT WORTH, TEXAS

October 16, 1963

United States Geological Survey
Commissioner of Public Lands
New Mexico Oil Conservation Commission

Re: Plan of Development - June 1,
1963 to June 1, 1964 - Poker Lake
Unit Area No. 14-08-001-303 -
Eddy County, New Mexico

Gentlemen:

In compliance with Section 10 of the Poker Lake Unit Agreement, dated July 16, 1952, Perry R. Bass, as Unit Operator, hereby submits for your approval Plan of Development covering the period from June 1, 1963 to June 1, 1964.

History of Past Development

In reviewing the past development of the Poker Lake Unit, we are attaching hereto a map marked "Exhibit A" which reflects all of the wells drilled within this Unit Area since its inception. You will note that the deep tests are marked in red, all of which wells were drilled below 13,500 feet. The Richardson & Bass No. 1 Harrison, which was completed as a dry hole May 22, 1954, was drilled to a total depth of 16,705 feet. This well was drilled in the NW $\frac{1}{4}$ NW $\frac{1}{4}$ of Section 12, Township 25 South, Range 30 East. The next deep test was located in the NE $\frac{1}{4}$ NE $\frac{1}{4}$ of Section 1, Township 25 South, Range 30 East, and was completed as a dry hole September 5, 1955 at a total depth of 13,792 feet. The third deep test was drilled in the NW $\frac{1}{4}$ SW $\frac{1}{4}$ of Section 22, Township 25 South, Range 30 East, and was completed on March 24, 1956 at a total depth of 14,883 feet. In addition to the deep tests as outlined above, there have been 28 wells drilled within the Unit Area as of June 1, 1963. These tests varied in depth from 3,500 to 4,500 feet and, as reflected on the plat, have been scattered throughout the Unit in an effort to find Delaware and Lower Delaware production.

A review of our previous Plan of Development calls for three wells to be drilled in the period from June 1, 1962 to June 1, 1963, and we actually

United States Geological Survey
Commissioner of Public Lands
New Mexico Oil Conservation Commission
October 16, 1963
Page 2

drilled, or caused to be drilled, seven wells during that period, which wells are reflected on the attached exhibit. We are at the present time continuing our geological studies and correlating our sub-surface data on the basis of the seven wells drilled last year with the anticipation that other productive areas will be found within the Unit Area.

Development

Perry R. Bass, as Unit Operator, plans to drill, or cause to be drilled, at least two additional wells in the period from June 1, 1963 to June 1, 1964.

Effective Date

This Plan of Development shall be effective June 1, 1963 and expire June 1, 1964.

Very truly yours,

PERRY R. BASS

By 
Howard W. Jennings

HWJ:lcc

Approved: _____ Date: _____
Supervisor, United States Geological Survey

Approved: _____ Date: _____
Commissioner of Public Lands

Approved:  Date: March 12, 1964
Oil Conservation Commission

EXHIBIT A

POKER LAKE UNIT AREA

EDDY COUNTY, NEW MEXICO

SCALE 1" = 3000'

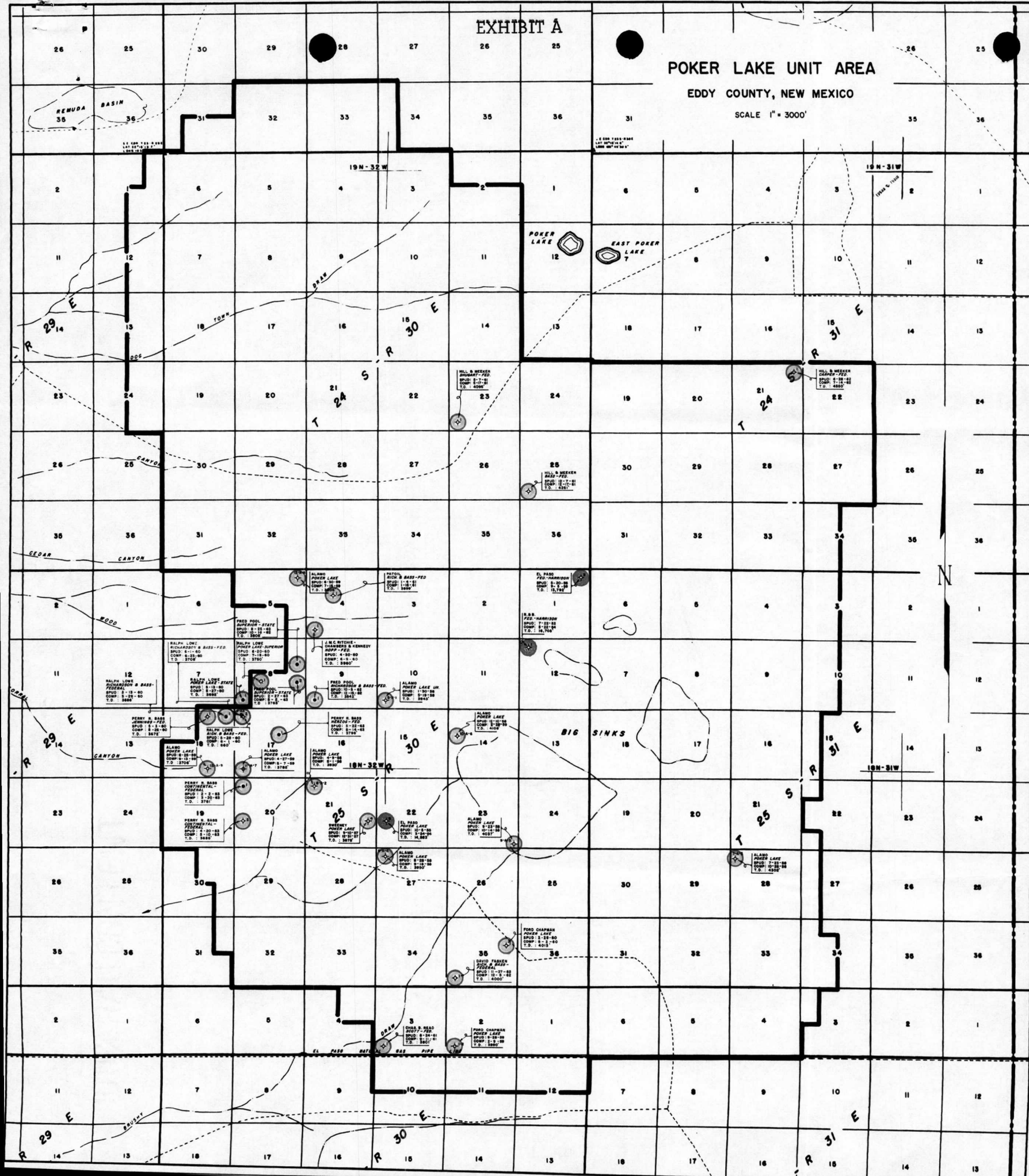



UNITED STATES
DEPARTMENT OF THE INTERIOR
GEOLOGICAL SURVEY
MAIN OFFICE OCC

Drawer 1857
Roswell, New Mexico 88201 8124

November 19, 1963

Perry R. Bass
Fort Worth National Bank Building
Fort Worth, Texas

Attention: Mr. Howard U. Jennings

Gentlemen:

Your plan of development for the period from June 1, 1963, to June 1, 1964, Poker Lake unit area, Eddy County, New Mexico, proposing the drilling of two wells, has been approved on this date subject to like approval by the appropriate State officials.

One approved copy of the plan is enclosed.

Sincerely yours,

(Orig. Sgd.) CARL C. TRAYWICK

CARL C. TRAYWICK
Acting Oil and Gas Supervisor

cc:

Washington (w/cy of Plan)
Artesia (w/cy of Plan)
NMOCC, Santa Fe (ltr. only) ✓
Com. of Pub. Lands, Santa Fe (ltr. only)