

January 15, 2013

RECEIVED WPX ENERGY

2013 JAN 22 P 1:30

Assistant District Manager, Minerals (3 copies)  
Bureau of Land Management  
Farmington Resources Area  
Attn: Mr. Wayne Townsend  
6251 College Blvd. Suite A  
Farmington, NM 87402

State of New Mexico (2 copies)  
Commissioner of Public Lands  
Attn: Mr. Pete Martinez  
P.O. Box 1148  
Santa Fe, NM 87504-1148

State of New Mexico (2 copies)  
Oil Conservation Division  
Attn: Ed Martin  
1220 S. St. Francis  
Santa Fe, NM 87505

Re: Rosa Unit I - Sec. 587  
San Juan and Rio Arriba Counties, New Mexico  
Mesaverde Participating Area

Twenty Seventh Expansion – Effective 9/1/2009

Ladies & Gentlemen:

Pursuant to the provisions of Section 10 of the Rosa Unit Agreement I – Section Number 587, approved January 24, 1948, WPX Energy Production, LLC, as Unit Operator, hereby respectfully requests approval of the referenced participating area for the Mesaverde Formation. Pursuant to the BLM letter, attached is the well that was deemed commercial.

**Twenty Seventh Expansion – Effective 9/1/2009**

Total acres brought in to PA = 320

<u>Wells/No./Dedication</u>	<u>Tract #</u>	<u>Tract Description</u>	<u>Tract Acres</u>	<u>Lease No</u>
Rosa Unit #189	17	T31N R5W Sec. 21: E/2	320.00	SF078769

Attached hereto is the schedule for the Twenty Seventh Expansion for the Mesaverde Participating Area. The schedule describes the Participating Area, shows the percentages of ownership in the tracts, and shows the percentages of unitized substances allocated to the tract. Also included is a map reflecting the current participating area and the Twenty Seventh Expansion.

If this proposed Participating Area as set forth herein meets with your approval, please indicate such approval in the space provided on the attached sheet and return an approved copy for our files.

Copies of this application are being sent to the Working Interest Owners shown on the attached sheet. If you have any questions or need any additional information, please contact the undersigned at (539) 573-6181.

Sincerely,

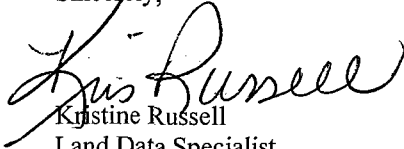
A handwritten signature in cursive script, appearing to read "Kristine Russell".

Kristine Russell  
Land Data Specialist  
WPX ENERGY PRODUCTION, LLC  
P.O. Box 3102  
Tulsa, OK 74101

Cc: Working Interest Owners  
MV FILE

Bureau of Land Management  
Commissioner of Public Lands  
Oil Conservation Commission

APPROVED \_\_\_\_\_ DATE \_\_\_\_\_  
Assistant District Manager, Minerals  
Bureau of Land Management  
Subject to like approval by the Commissioner of Public Lands  
And the Oil Conservation Commission

APPROVED \_\_\_\_\_ DATE \_\_\_\_\_  
Commissioner of Public lands  
Subject to like approval by the Area Oil & Gas Supervisor  
And the Oil Conservation Commission

APPROVED Ed Martin DATE 1/22/2013  
Oil Conservation Commission  
Subject to like approval by the Area Oil & Gas Supervisor  
And the Commissioners of Public Lands

The foregoing are approvals for the Twenty Seventh Participating Area in the Mesaverde formation of the Rosa Unit I - Sec. 587.

WORKING INTEREST OWNERS  
ROSA MESAVERDE

BP AMERICA PRODUCTION CO.  
ATTN: LAUREN KREJCI  
P.O. BOX 3092  
HOUSTON, TX 77253

OMIMEX PETROLEUM, INC.  
ATTN: CLARK P. STORMS  
7950 JOHN T. WHITE ROAD  
FORT WORTH, TX 76120

MS. ELIZABETH T. CALLOWAY  
P.O. BOX 191767  
DALLAS, TX 75219-1767

FRED E. TURNER, LLC  
4925 GREENVILLE AVE., SUITE 852  
DALLAS, TX 75206-4079

J. GLENN TURNER, JR. LLC  
4809 COLE AVE., SUITE 212  
DALLAS, TX 75205

MR. JOHN TURNER  
8409 PICKWICK LANE, SUITE 258  
DALLAS, TX 75225

MARY FRANCES TURNER, JR TRUST  
C/o JPMORGAN CHASE BANK, N.A., TRUSTEE  
ATTN: LESLIE TIPPING  
P O BOX 2605  
FORT WORTH, TX 76113

SACRAMENTO MUNICIPAL UTILITIES DIST.  
ATTN: BOB SHIPLEY  
P.O. BOX 15830  
SACRAMENTO, CA 95852-1830

SCHEDULE XXVIII  
 TWENTY SEVENTH PARTICIPATING AREA FOR THE MESAVERDE FORAMTION ROSA UNIT AREA

SERIAL NUMBER	DESCRIPTION	NON-COMMITTED ACRES	PA ACRES	TRACT OWNERSHIP	GW% PERCENTAGE	NRI PERCENTAGE	PARTICIPATION FACTOR
SF-078763	T31N R5W			<b>Tract 13</b>			2.238186%
	Sec 5: ALL		527.96	WORKING INTEREST			
	Sec 8: NE/4			WPX Energy Production, LLC	73.000000%	63.875000%	
	#41, #41A, #41B, #46A			Sacramento Municipal Utility District	27.000000%	23.625000%	
				ROYALTY		12.500000%	
				ORRI		0.000000%	
					100.000000%	100.000000%	
	T31N R5W						1.356579%
	Sec 8: S/2		320.00	WORKING INTEREST			
	#46A, #80, #80A			WPX Energy Production, LLC	23.000000%	20.125000%	
	#80A BP NON-CONSENT			BP America Production Co	50.000000%	43.750000%	
				Sacramento Municipal Utility District	27.000000%	23.625000%	
				ROYALTY		12.500000%	
				ORRI		0.000000%	
					100.000000%	100.000000%	
SF-078767	T31N R5W			<b>Tract 14</b>			10.674750%
	Sec 6: ALL		2518.04	WORKING INTEREST			
	Sec 7: ALL			WPX Energy Production, LLC	73.000000%	63.875000%	
	Sec 8: NW/4			Sacramento Municipal Utility District	27.000000%	23.625000%	
				ROYALTY		12.500000%	
				ORRI		0.000000%	
					100.000000%	100.000000%	
	T31N R6W						
	Sec 12: ALL						
	Sec 13: ALL						
	Sec 24: ALL						
	#72, #72A, #171, #171A, #171B, #171C, #154, #154A						
	#80, #80A, #149, #149A, #30, #30A, #30B, #149B						
	#125, #125E, #10, #10B, #66M, #19, #19B, #163						
	#163A, #101M						
	#30A, #72A, #149A, #154, #154A, #163, #163A, #171, #171A BP NON-CONSENT						
	#80A BP NON-CONSENT						
SF-078770	T31N R5W			<b>Tract 16</b>			1.356579%
	Sec 27: S/2		320.00	WORKING INTEREST			
	#6Y			WPX Energy Production, LLC	23.000000%	20.125000%	
	#6Y BP NON-CONSENT			BP America Production Co	50.000000%	43.750000%	
				Sacramento Municipal Utility District	27.000000%	23.625000%	
				ROYALTY		12.500000%	
				ORRI		0.000000%	
					100.000000%	100.000000%	
SF-078769	T31N R5W			<b>Tract 17</b>			8.139473%
	Sec 17: ALL		1920.00	WORKING INTEREST			
	Sec 21: ALL			WPX Energy Production, LLC	23.000000%	20.125000%	
	Sec 28: ALL			BP America Production Co	50.000000%	43.750000%	
	#31, #31A, #31B, #31C, #153, #153A, #187			Sacramento Municipal Utility District	27.000000%	23.625000%	
	#146, #168, #168A, #189			ROYALTY		12.500000%	
	#31, #153A, #168, #168A, #189 BP NON-CONSENT			ORRI		0.000000%	
					100.000000%	100.000000%	
SF-078764	T31N R5W			<b>Tract 18</b>			9.272641%
	Sec 18: ALL		2187.30	WORKING INTEREST			
	Sec 19: Lots 1, 4, E/2E/2, NW/4NE/4, SW/4SE/4,			WPX Energy Production, LLC	73.000000%	63.875000%	
	Sec 20: SE/4			Sacramento Municipal Utility District	27.000000%	23.625000%	
	Sec 29: N/2NE/4, SW/4, W/2SE/4			ROYALTY		12.500000%	
	Sec 30: ALL			ORRI		0.000000%	
	Sec 31: ALL				100.000000%	100.000000%	
	#22, #22A, #182, #182A, #183, #183A, #17, #17A, #17B,						
	#23, #23B, #64M, #162, #162A, #166, #166A, #15, #15A						
	#13, #13A, #137, #137A, #137B, #159, #159A						
	#13A, #17A, #137A, #159A, #162, #162A, #166, #166A BP NON-CONSENT						
	#22A, #182, #182A, #183, #183A BP NON-CONSENT						

SCHEDULE XXVIII  
 TWENTY SEVENTH PARTICIPATING AREA FOR THE MESAVERDE FORAMTION ROSA UNIT AREA

SF-078764	T31NR5W Sec 20: N/2 #85, #85A #85A BP NON-CONSENT	320.00	WORKING INTEREST WPX Energy Production, LLC BP America Production Co Sacramento Municipal Utility District ROYALTY ORRI	23.000000% 50.000000% 27.000000% 12.500000% 0.000000%	20.125000% 43.750000% 23.625000% 12.500000% 100.000000%	1.356579%
Fee	T31N R5W Sec 19: Lots 2,3, SW/4NE/4, NW/4SE/4 #183, #183A, #159, #159A #159A, #183, #183A BP NON-CONSENT	152.22	TRACT 19 WORKING INTEREST WPX Energy Production, LLC Sacramento Municipal Utility District ROYALTY ORRI	73.000000% 27.000000% 12.500000% 0.000000%	63.875000% 23.625000% 12.500000% 100.000000%	0.645308%
Fee	T31N R5W Sec 20: SW/4 Sec 29: NW/4 #17, #17A, #17B, #64M, #23, #23B #17A BP NON-CONSENT	320.00	Tract 20 WORKING INTEREST WPX Energy Production, LLC Sacramento Municipal Utility District ROYALTY ORRI	73.000000% 27.000000% 12.500000% 0.000000%	63.875000% 23.625000% 12.500000% 100.000000%	1.356579%
SF-079165	T31N R5W Sec 29: S/2NE/4, E/2SE/4 #15, #15A	160.00	Tract 21 WORKING INTEREST WPX Energy Production, LLC Sacramento Municipal Utility District ROYALTY ORRI	73.000000% 27.000000% 12.500000% 0.000000%	63.875000% 23.625000% 12.500000% 100.000000%	0.678289%
E-347-56	T31N R5W Sec 32: NW/4 #24, #24A, #24B, #24C	160.00	Tract 25 WORKING INTEREST WPX Energy Production, LLC BP America Production Co ROYALTY ORRI	86.944599% 13.055401% 12.500000% 0.000000%	76.076524% 11.423476% 12.500000% 100.000000%	0.678289%
E-347-48	T31N R5W Sec 32: NE/4 #26, #26A, #26B	160.00	Tract 26 WORKING INTEREST WPX Energy Production, LLC ROYALTY ORRI	100.000000% 12.500000% 0.000000%	87.500000% 12.500000% 100.000000%	0.678289%
E-347-55	T31N R5W Sec 32: S/2 #24, #24A, #24B, #24C, #26, #26A, #26B	320.00	Tract 27 WORKING INTEREST WPX Energy Production, LLC ROYALTY ORRI	100.000000% 12.500000% 21.875000%	65.625000% 12.500000% 100.000000%	1.356579%
SF-078773	T31N R5W Sec 33: ALL Sec 34: W/2, SE/4, N/2NE/4, SE/4NE/4 not including SW/4NE/4 where #184A (is non-commercial) #77, #77A, #77B #147, #147A, #188, #184, #188A #147A, #188 BP NON-CONSENT	1240.00	Tract 28 WORKING INTEREST WPX Energy Production, LLC BP America Production Co Sacramento Municipal Utility District ROYALTY ORRI	23.000000% 50.000000% 27.000000% 12.500000% 0.000000%	20.125000% 43.750000% 23.625000% 12.500000% 100.000000%	5.256743%
SF-078772	T31N R6W Sec 1: ALL Sec 3: Lots 5,6,7,8,9, SE/4, E/2SW/4, SW/4SW/4 Sec 4: Lots 5,6,7,8,9, N/2SW/4 NW/4SE/4, SE/4SE/4  T32N R6W Sec 33: W/2 #164, #164A, #164B, #169, #169A, #60, #60A	1161.86	Tract 29 WORKING INTEREST WPX Energy Production, LLC Sacramento Municipal Utility District ROYALTY ORRI	73.000000% 27.000000% 12.500000% 0.000000%	63.875000% 23.625000% 12.500000% 100.000000%	4.925484%

SCHEDULE XXVIII  
 TWENTY SEVENTH PARTICIPATING AREA FOR THE MESAVERDE FORAMTION ROSA UNIT AREA

	#151, #151A						
SF-078772	#60, #60A, #151A, #164, #164A, #169, #169A BP NON-CONSENT						
	T32N R6W						5.935033%
	Sec 33: NE1/4, W2SE1/4		1400.00	WORKING INTEREST			
	Sec 34: E1/2, E1/2W1/2, SW1/4SW1/4			WPX Energy Production, LLC	23.000000%	20.125000%	
	Sec 35: ALL			BP America Production Co	50.000000%	43.750000%	
	#90A, #89, #89A, #89C, #129, #129A,			Sacramento Municipal Utility District	27.000000%	23.625000%	
	#91, #91A, #91B, #91C, #44, #44A, #44B			ROYALTY		12.500000%	
	#44, #44A, #90A, #91A, #129, #129A BP NON-CONSENT			ORRI		0.000000%	
					100.000000%	100.000000%	
E-289-53	T31N R6W			Tract 30			1.470659%
	Sec 2: Lots 6, 7, 8, S/2		346.91	WORKING INTEREST			
	#148, #148A, #148B			WPX Energy Production, LLC	73.000000%	62.050000%	
	#148A BP NON-CONSENT			Sacramento Municipal Utility District	27.000000%	22.950000%	
				ROYALTY		12.500000%	
				ORRI		2.500000%	
					100.000000%	100.000000%	
Uncommitted	T31N R6W	9.35		Tract 31			
	Sec 2: Lot 5,						
	#148, #148A, #148B						
	This tract is not committed to the unit						
	#148A BP NON-CONSENT						
Uncommitted	T31N R6W	38.12		Tract 32			
	Sec 3 & 4 a portion thereof						
	designated as Tract 37						
	This tract is not committed to the unit						
Uncommitted	T32N R6W	120.00					
	Sec 33: E1/2SE1/4						
	Sec 34: NW1/4SW1/4						
	#90, #90A						
	This tract is not committed to the unit						
	#90A SAN JUAN BASIN PROPERTIES NON-CONSENT						
SF-078765	T31N R6W			Tract 33			9.412241%
	Sec 4: S1/2SW1/4, SW1/4SE1/4		2220.23	WORKING INTEREST			
	Sec 5: ALL			WPX Energy Production, LLC	73.000000%	63.875000%	
	Sec 8: NW1/4, E1/2NE1/4			Sacramento Municipal Utility District	27.000000%	23.625000%	
	Sec 9: ALL			ROYALTY		12.500000%	
	Sec 10: Lots 1, 2, 3, E1/2E1/2, NW1/4			ORRI		0.000000%	
	Sec 15: Lots 1, 2, E1/2SW1/4, E1/2				100.000000%	100.000000%	
	#12, #12A, #12B, #181, #181A						
	#60, #60A, #75, #75A						
	#35A, #35X						
	#88, #88A, #167, #167A, #167B						
	#156, #156A, #180, #180A						
	#12A, #156, #156A, #167, #167A, BP NON-CONSENT						
	#35A, #60, #60A, #75, #75A, #180, #180A, #181, #181A BP NON-CONSENT						
SF-078765	T31N R6W						1.017434%
	Sec 8: SW1/4, E1/2SE1/4		240.00	WORKING INTEREST			
	#88, #88A, #167, #167A, #167B,			WPX Energy Production, LLC	23.000000%	20.125000%	
	#167, #167A, BP NON-CONSENT			BP America Production Co	50.000000%	43.750000%	
				Sacramento Municipal Utility District	27.000000%	23.625000%	
				ROYALTY		12.500000%	
				ORRI		0.000000%	
					100.000000%	100.000000%	
Fee	T31N R6W			Tract 34			0.339145%
	Sec 8: W1/2SE1/4		80.00	WORKING INTEREST			
	#167, #167A, #167B			WPX Energy Production, LLC	23.000000%	20.125000%	
	#167 & #167A BP NON-CONSENT			BP America Production Co	50.000000%	43.750000%	
				Sacramento Municipal Utility District	27.000000%	23.625000%	
				ROYALTY		12.500000%	
				ORRI		0.000000%	
					100.000000%	100.000000%	
Fee	T31N R6W						0.339145%
	Sec 8: W1/2NE1/4		80.00	WORKING INTEREST			
	#167, #167A, #167B			WPX Energy Production, LLC	73.000000%	63.875000%	
	#167 & #167A BP NON-CONSENT			Sacramento Municipal Utility District	27.000000%	23.625000%	
				ROYALTY		12.500000%	

SCHEDULE XXVIII

				ORRI		0.000000%	
					100.000000%	100.000000%	
Fee	T31N R6W Sec 10: W/2E/2 #181, #181A #181, #181A BP NON-CONSENT	160.00	Tract 35 WORKING INTEREST WPX Energy Production, LLC Sacramento Municipal Utility District ROYALTY ORRI	73.000000% 27.000000%	63.875000% 23.625000% 12.500000% 0.000000%		0.678289%
					100.000000%	100.000000%	
Fee	T31N R6W Sec 10: Tract 38 Sec 15: Tract 38 #25A, #75, #75A #25A, #75, #75A BP NON-CONSENT	161.52	Tract 36 WORKING INTEREST WPX Energy Production, LLC Sacramento Municipal Utility District ROYALTY ORRI	73.000000% 27.000000%	63.875000% 23.625000% 12.500000% 0.000000%		0.684733%
					100.000000%	100.000000%	
SF-078771	T31N R6W Sec 11: ALL Sec 14: ALL Sec 23: ALL Sec 26: ALL #1E, #9, #9A, #9B, #36, #36B, #16, #16A, #16B, #16C, #20, #20A, #20B, #20C #14, #14A, #21, #21A, #21B #5A, #5B, #5Y, #8, #8A, #8B, #8C #5Y, #14A, #16B, #16C, #20B, #20C, #21A, BP NON-CONSENT	2560.00	Tract 37 WORKING INTEREST WPX Energy Production, LLC Sacramento Municipal Utility District ROYALTY ORRI	73.000000% 27.000000%	63.875000% 23.625000% 12.500000% 0.000000%		10.852631%
					100.000000%	100.000000%	
Fee	T31N R6W Sec 15: Tract 39 Also described as the E/2NE/4 of the resurveyed tracts lying in Sec. 15 #25A #25A BP NON-CONSENT	80.00	Tract 38 WORKING INTEREST WPX Energy Production, LLC Sacramento Municipal Utility District ROYALTY ORRI	73.000000% 27.000000%	63.875000% 23.625000% 12.500000% 0.000000%		0.339145%
					100.000000%	100.000000%	
Fee	T31N R6W Sec 16: Tract 39 Also described as SE/4NW/4 & SW/4NE/4 of the resurveyed tracts lying in Sec. 16, #185, #185A, #185A BP NON-CONSENT	80.00	WORKING INTEREST WPX Energy Production, LLC BP America Production Co Sacramento Municipal Utility District ROYALTY ORRI	23.000000% 50.000000% 27.000000%	20.125000% 43.750000% 23.625000% 12.500000% 0.000000%		0.339145%
					100.000000%	100.000000%	
SF-078766	T31N R6W Sec 22: E/2 Sec 25: ALL #18, #18A #160, #160A, #165, #165A, #165B, #165C #160, #160A, #165, #165A BP NON-CONSENT	864.48	Tract 39 WORKING INTEREST WPX Energy Production, LLC Sacramento Municipal Utility District ROYALTY ORRI	73.000000% 27.000000%	63.875000% 23.625000% 12.500000% 0.000000%		3.564798%
					100.000000%	100.000000%	
SF-078766	T31N R6W Sec 16: Lots 1,2,3, (94.50), N/2NE/4, SW/4NW/4, N/2NW/4, W/2SW/4 Sec 17: ALL Sec 21: Lots 1,2,3, W/2NW/4, S/2, Sec 22: Lot 1, SW/4, E/2NW/4 #145, #145A #138, #138A, #139, #139A, #100E, #170, #32, #32A, #32B, #32C #79, #79A, #79B	1688.23	WORKING INTEREST WPX Energy Production, LLC BP America Production Co Sacramento Municipal Utility District ROYALTY ORRI	23.000000% 50.000000% 27.000000%	20.125000% 43.750000% 23.625000% 12.500000% 0.000000%		7.156929%
					100.000000%	100.000000%	



SCHEDULE XXVIII  
 TWENTY SEVENTH PARTICIPATING AREA FOR THE MESAVERDE FORAMTION ROSA UNIT AREA

E-346-20	T31N R6W			<u>Tract 40</u>			0.339145%
	Sec 16: The approximate NE/4SW/4, NW/4SE/4		80.00	WORKING INTEREST			
	Also described as the N/2NW/4 of the resurveyed tracts lying in Sec. 15,16,21 & 22			WPX Energy Production, LLC	50.000000%	32.812500%	
	#185, #185A			J. Glenn Turner Jr LLC	10.000000%	6.562500%	
	#185, #185A BP NON-CONSENT			John L. Turner	10.000000%	6.562500%	
				Fred E. Turner LLC	10.000000%	6.562500%	
				Mary Francis Turner Jr	10.000000%	6.562500%	
				Elizabeth Jeanne Turner	10.000000%	6.562500%	
				ROYALTY		12.500000%	
				ORRI		21.875000%	
					100.000000%	100.000000%	
E-346-22	T31N R6W			<u>Tract 40A</u>			0.339145%
	Sec 16: The approximate SE/4SW/4, NE/4SE/4		80.00	WORKING INTEREST			
	Also described as the SW/4NW/4, NW/4NE/4 of the resurveyed tracts lying in			WPX Energy Production, LLC	50.000000%	32.812500%	
	Sec 15,16 21 & 22			J. Glenn Turner Jr LLC	10.000000%	6.562500%	
	#185, #185A			John L. Turner	10.000000%	6.562500%	
	#185, #185A BP NON-CONSENT			Fred E. Turner LLC	10.000000%	6.562500%	
				Mary Francis Turner Jr	10.000000%	6.562500%	
				Elizabeth Jeanne Turner	10.000000%	6.562500%	
				ROYALTY		12.500000%	
				ORRI		21.875000%	
					100.000000%	100.000000%	
E-289	T31N R6W			<u>Tract 41</u>			0.678289%
	Sec 21: 71.56 acres out of the E/2NW/4, 71.56 acres out of W/2NE/4		160.00	WORKING INTEREST			
	Sec 16: approximately 16.88 acres S/2S/2SE/4SW/4 & S/2S/2SW/4SE/4			Omnimex Petroleum Inc.	100.000000%	87.500000%	
	Also described as the SW/4 of the resurveyed tracts lying in Sec. 15,16,21 & 22			ROYALTY		12.500000%	
	#32, #32A, #32B, #32C			ORRI		0.000000%	
	#32, #32A WISER NON-CONSENT				100.000000%	100.000000%	
E-289-43	T31N R6W			<u>Tract 42</u>			0.339145%
	Sec 21: 71.56 acres out of the E/2NE/4		80.00	WORKING INTEREST			
	Sec 16: 8.44 acres in the S/2S/2SE/4SE/4 of Sec 16			WPX Energy Production, LLC	23.000000%	19.550000%	
	Also described as the W/2SE/4 of the resurveyed tracts lying in Sec. 15,16 21 & 22			BP America Production Co	50.000000%	42.500000%	
	#32, #32A, #32B, #32C			Sacramento Municipal Utility District	27.000000%	22.950000%	
	#32, #32A WISER NON-CONSENT			ROYALTY		12.500000%	
				ORRI		2.500000%	
					100.000000%	100.000000%	
E-289-50	T31N R6W			<u>Tract 43</u>			0.339145%
	Sec 15: 8.41 acres out of S/2S/2SW/4SW/4		80.00	WORKING INTEREST			
	Sec 22: 71.59 acres in the W/2NW/4			WPX Energy Production, LLC	100.000000%	82.500000%	
	Also described as the E/2SE/4 of the resurveyed tracts in Sec 15,16 21 & 22			ROYALTY		12.500000%	
	#25A, #79, #79A, #79B, #185A			ORRI		5.000000%	
	#25A BP NON-CONSENT				100.000000%	100.000000%	
E-504-15	T32N R6W			<u>Tract 44</u>			1.356579%
	Sec 32: W/2		320.00	WORKING INTEREST			
	#150, #150A, #150B			WPX Energy Production, LLC	100.000000%	84.500000%	
	#150A BP NON-CONSENT			ROYALTY		12.500000%	
				ORRI		3.000000%	
					100.000000%	100.000000%	
E-504-19	T32N R6W			<u>Tract 45</u>			1.356578%
	Sec 32: E/2		320.00	WORKING INTEREST			
	#29, #29B, #29M			WPX Energy Production, LLC	100.000000%	65.625000%	
	#29M BP NON-CONSENT			ROYALTY		12.500000%	
				ORRI		21.875000%	
					100.000000%	100.000000%	
Fee	T32N R6W			<u>Tract 46</u>			0.339144%
	Sec 34: W/2NW/4		80.00	WORKING INTEREST			
	#129, #129A			WPX Energy Production, LLC	23.000000%	20.125000%	
	#129, #129A BP NON-CONSENT			BP America Production Co	50.000000%	43.750000%	
				Sacramento Municipal Utility District	27.000000%	23.625000%	
				ROYALTY		12.500000%	
				ORRI		0.000000%	
					100.000000%	100.000000%	

SCHEDULE XXVIII  
 TWENTY SEVENTH PARTICIPATING AREA FOR THE MESAVERDE FORAMTION ROSA UNIT AREA

E-346-30	T32N R6W						1.356578%
	Sec 36: W/2		320.00	Tract 47			
	#152, #152A, #152B			WORKING INTEREST			
	#152A BP NON-CONSENT			WPX Energy Production, LLC	73.000000%	63.875000%	
				Sacramento Municipal Utility District	27.000000%	23.625000%	
				ROYALTY		12.500000%	
				ORRI		0.000000%	
					100.000000%	100.000000%	
E-346-33	T32N R6W			Tract 48			1.356578%
	Sec 36: E/2		320.00	WORKING INTEREST			
	#34, #34A, #34B, #34C			WPX Energy Production, LLC	100.000000%	65.625000%	
	#34A BP NON-CONSENT			ROYALTY		12.500000%	
				ORRI		21.875000%	
		167.47	23588.75		100.000000%	100.000000%	100.000000%

UNIT AREA EXPANSION SCHEDULE

SCHEDULE XXVIII  
TWENTY-SEVENTH PARTICIPATING AREA FOR THE MESAVERDE FORMATION  
ROSA UNIT AREA

RECAPITULATION

Description of lands in Mesaverde Participating Areas

Township 31 North, Range 5 West, N.M.P.M.

Sections 5, 6, 7, 8, 17, 18, 19, 20, 28, 29, 30, 31, 32, 33 ALL

Section 21: ALL

Section 27: S/2

Section 34: W/2, SE/4, N/2NE/4, SE/4NE/4

Township 31 North, Range 6 West, N.M.P.M.

Sections 1, \*2, \*3, \*4, 5, 8, 9, 10, 11, 12, 13, 14, 15, 16, 17, 21, 22, 23, 24, 25, 26: ALL

Township 32 North, Range 6 West, N.M.P.M.

Sections 32, \*33, \*34, 35, 36: ALL

Total number of acres in Participating Area: 23,421.28

Total number of acres not committed to Participating Area: 167.47

Total number of acres committed to Participating Area: 23,588.75

\*Portions of this acreage not committed to unit.

Effective September 1, 2009

WPX ENERGY PRODUCTION , LLC  
SUMMARY BY OWNER  
ROSA UNIT MESAVERDE 27TH EXPANSION

WORKING INTEREST OWNERS	GWI
Sacramento Municipal Utility District	0.24710774
BP America Production Co	0.16554518
J. Glenn Turner Jr LLC	0.00067829
John L. Turner	0.00067829
Fred E. Turner LLC	0.00067829
Mary Francis Turner Jr	0.00067829
Elizabeth Jeanne Turner	0.00067829
Omimex Petroleum Inc.	0.00678289
WPX Energy Production, LLC	0.57717274
	1.00000000



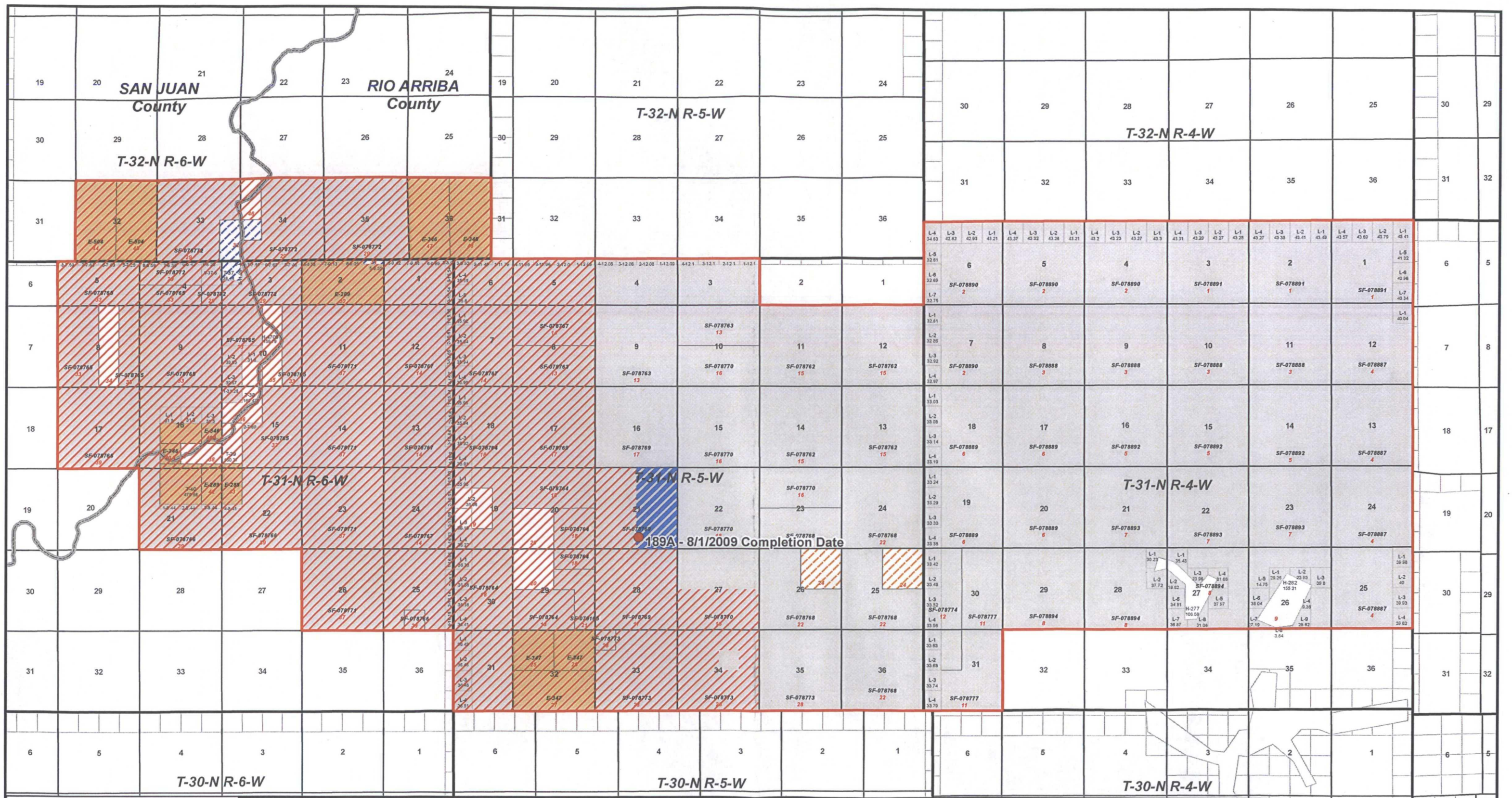

Mesaverde Participating Area - Projected - 27th Expansion  
Mesaverde Participating Area - Initial - 27th Expansion  
Rosa Unit Mineral Ownership  
Federal  
Fee  
Partially Committed  
State  
Not Committed

Rosa Unit Tract No: XX

6,000 3,000 0 6,000 12,000 Feet



WPXENERGY.

Rosa Unit  
Mesaverde Formation  
San Juan and Rio Arriba Counties, New Mexico

Scale: 1:72,000  
Date: 01/17/2013  
Projection: NAD 1983 State Plane NM West  
Author: GRR