

NORTHEAST CHACO CA
9237.3 ACRES (TOTAL)

WPX - 8,639.13 NET AC / 8,677.3 GROSS AC - 93.52%
LOGOS - 560 NET AC. / 560 GROSS AC. - 6.06%
MANANA - 38.17 NET AC - 0.41%

FEDERAL: 8357.3 AC - 90.47%
STATE - 480 AC - 5.20%
FEE - 400 AC - 4.33%
TOTAL: 9237.3 AC - 100%

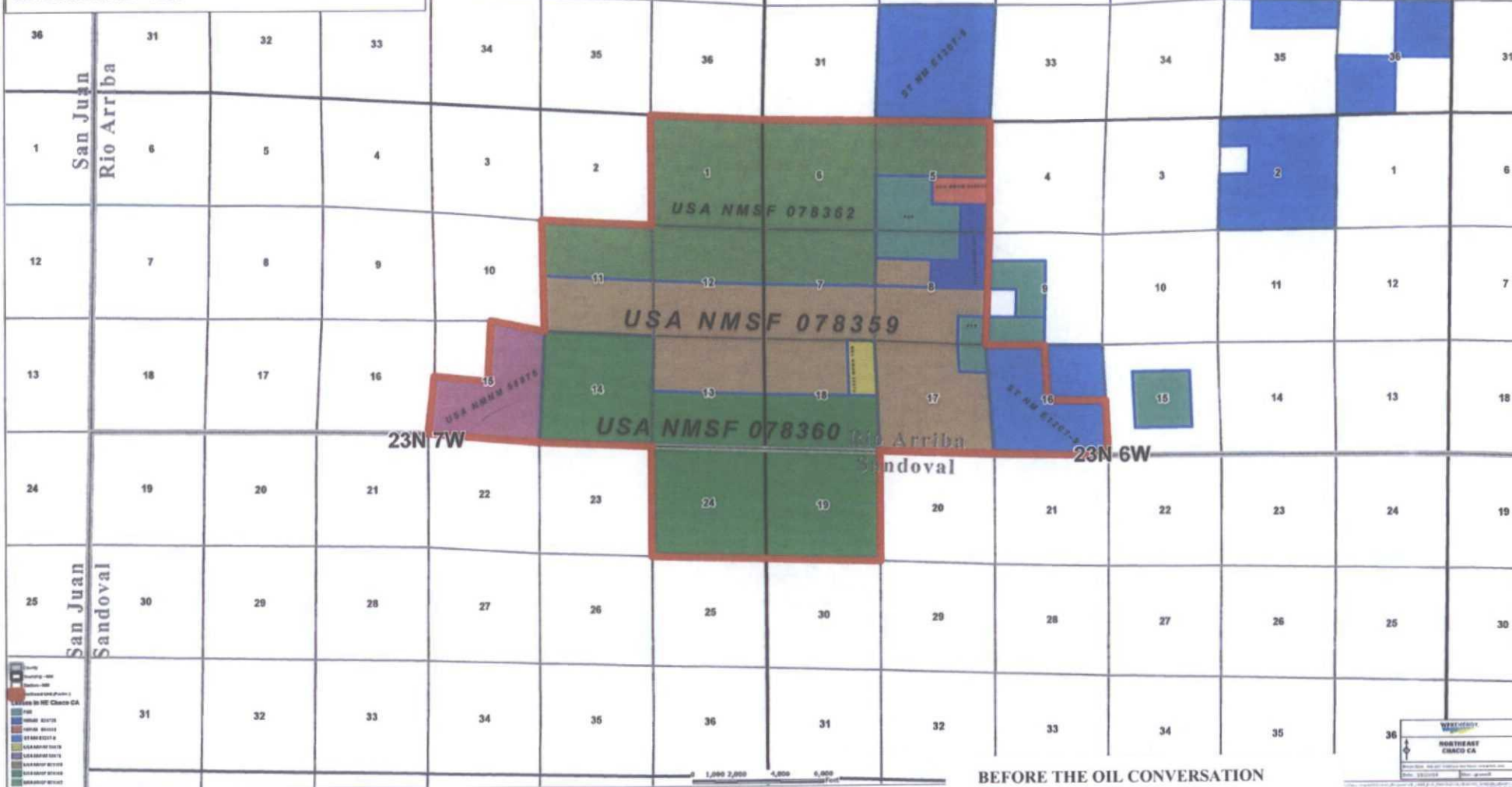

BEFORE THE OIL CONVERSION
DIVISION

Santa Fe, New Mexico

Exhibit No. 2

Submitted by: WPX ENERGY

Hearing Date: March 20, 2014