

4357 14 SW  
(WATERFLOW)

UNITED STATES  
DEPARTMENT OF THE INTERIOR  
GEOLOGICAL SURVEY

Kirtland, NM Quad

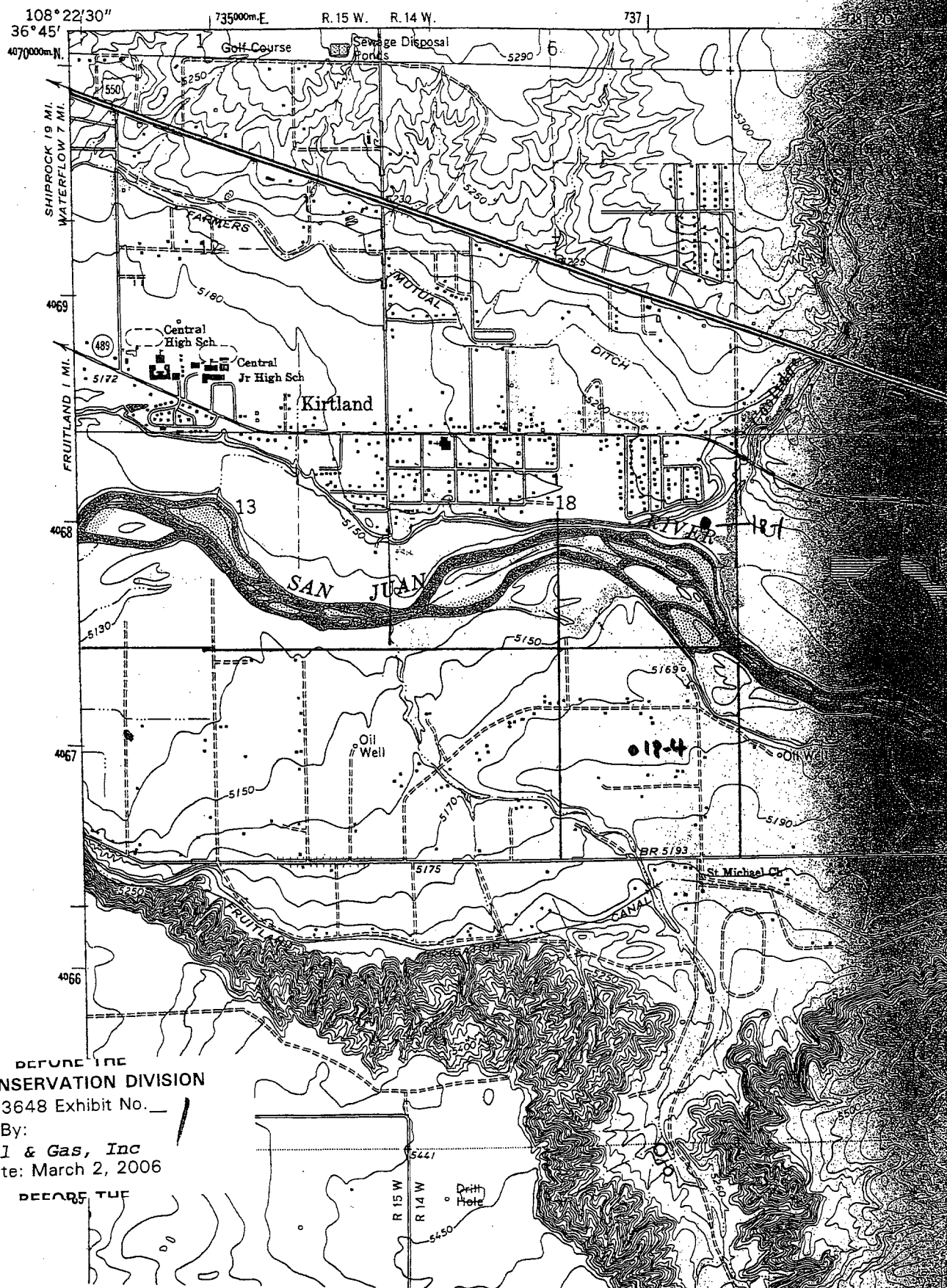

BEFORE THE  
OIL CONSERVATION DIVISION  
Case No. 13648 Exhibit No. 1  
Submitted By:  
Lance Oil & Gas, Inc  
Hearing Date: March 2, 2006  
BEFORE THE