



ConocoPhillips
San Juan Business Unit
Land Department
P.O. Box 4289
Farmington, NM 87499-4289

February 27, 2015

Bureau of Land Management
Farmington Resource Area
6251 College Blvd, Ste A
Farmington, NM 87402

Commissioner of Public Lands
State of New Mexico
PO Box 1148
Santa Fe, NM 87501-1148

RECEIVED

FEB 27 2015

BUREAU OF LAND MANAGEMENT

Oil Conservation Division
State of New Mexico
1220 S Saint Francis Dr
Santa Fe, NM 87505

RE: 2015 Plan of Development
San Juan 29-6 Unit #14-08-001-439
Rio Arriba County, New Mexico

Ladies and Gentlemen:

The following Participating Areas currently exist in the San Juan 29-6 Unit:

FORMATION	EXPANSION	EFFECTIVE DATE
DAKOTA "A"	INITIAL	31-DEC-74
DAKOTA	015	01-JUL-11
FRUITLAND COAL	020	01-FEB-04
MESAVERDE	037	01-FEB-88
PICTURED CLIFFS	005	01-JAN-01

W/ 204
C/ 419

RECEIVED OGD
2015 MAR -3 P 3:15

The **2014 Plan of Development** (or amendments thereto) provided for no activity; there is therefore no status update to provide for 2014 development.

Pursuant to Section 10 of the San Juan 29-6 Unit Agreement, ConocoPhillips Company, as Unit Operator, is hereby providing notification that there is no activity currently scheduled for 2015.

The working interest owners are being furnished a copy of this letter, well status listing and enclosed map. ConocoPhillips, as Unit Operator, will drill any offset wells required to prevent drainage of unitized substances and any other wells deemed necessary by the working interest owners or Unit Operator.

In accordance to Section 10 of the Unit Agreement, please provide your approvals by executing and returning a copy of the attached approval page to the undersigned.

Please contact me at (505) 326-9868 if there are any questions regarding this letter.

Sincerely,

Cameron Ming,
Land Supervisor, SE CH

CM/jmr
xc: San Juan 29-6 Unit, 3.0 (2015)
San Juan 29-6 Unit Working Interest Owners

**SAN JUAN 29-6 UNIT
2015 PLAN OF DEVELOPMENT APPROVALS**

Bureau of Land Management

2/27/15
Date

New Mexico Oil Conservation Division

Date

New Mexico Commissioner of Public Lands

Date

SAN JUAN 29-6 UNIT WORKING INTEREST OWNERS

BETTY T JOHNSTON MARITAL TRUST
BIG SNOWY EXPLORATION LP
BP AMERICA PRODUCTION COMPANY
BURLINGTON RESOURCES O&G CO LP
BURLINGTON RESOURCES O&G SJB
CHARLES W GAY
CONOCOPHILLIPS COMPANY
EULA MAY JOHNSTON TRUST
GRAYFORE PARTNERS LP
J&M RAYMOND LTD
LORRAYN GAY HACKER
MCELVAIN OIL COMPANY
PGC GAS COMPANY
PHILLIPS NEW MEXICO PARTNERS LP
PHILLIPS SAN JUAN LTD PARTNERSHIP
PINTAIL PRODUCTION CO INC
PRODUCTION GATHERING LLC
RESOURCE DEVELOPMENT TECHNOLOGY LLC
RKC INC
SABLE ENERGY LTD
SAN JUAN BASIN PARTNERSHIP
SAN JUAN BASIN TRUST
T H MCELVAIN OIL & GAS LLLP
T H MCELVAIN OIL AND GAS PROP
TAMACAM LLC
V A JOHNSTON LTD
VAUGHAN-MCELVAIN ENERGY INC
VEVA JEAN GIBBARD
WPX ENERGY INC

SAN JUAN 29-6 UNIT
STATUS OF WELLS - 2-27-15

API	Well Name	COUNTY	STATE	TOWNSHIP	RANGE	SECTION NUMBER	Unit Letter	Oper Name	Rsvr Name	Production Status	Completion Date	Abandon Date	Initial Production Date	First Sale Date	
	SAN JUAN 29-6 UNIT 47M	RIO ARRIBA	NM					CONOCOPHILLIPS COMPANY	BASIN: DAKOTA		71				
	SAN JUAN 29-6 UNIT 47M	RIO ARRIBA	NM					CONOCOPHILLIPS COMPANY	BASIN: DAKOTA		72	1/1/2002			
3003907836	SAN JUAN 29-6 UNIT 33	RIO ARRIBA	NM	29N	6W	13	B	CONOCOPHILLIPS COMPANY	BLANCO: MESAVERDE		11	9/28/1959			
3003907836	SAN JUAN 29-6 UNIT 33	RIO ARRIBA	NM	29N	6W	13	B	CONOCOPHILLIPS COMPANY	BASIN: DAKOTA		11	9/28/1959			
3003924610	SAN JUAN 29-6 UNIT 231	RIO ARRIBA	NM	29N	6W	36	B	CONOCOPHILLIPS COMPANY	BASIN CB: FRUITLAND COAL		11	4/8/1990	5/18/1990	5/18/1990	
3003929434	SAN JUAN 29-6 UNIT 62C	RIO ARRIBA	NM	29N	6W	4	1	CONOCOPHILLIPS COMPANY	BLANCO: MESAVERDE		11	9/23/2005	9/23/2005	9/23/2005	
3003929532	SAN JUAN 29-6 UNIT 19C	RIO ARRIBA	NM	29N	6W	8		CONOCOPHILLIPS COMPANY	BLANCO: MESAVERDE		11	3/8/2006	3/30/2006	3/30/2006	
3003929463	SAN JUAN 29-6 UNIT 59B	RIO ARRIBA	NM	29N	6W	5		CONOCOPHILLIPS COMPANY	BLANCO: MESAVERDE		11	5/16/2006	6/20/2006	6/20/2006	
3003929521	SAN JUAN 29-6 UNIT 18C	RIO ARRIBA	NM	29N	6W	5	D	CONOCOPHILLIPS COMPANY	BLANCO: MESAVERDE		11	4/26/2006	5/25/2006	5/25/2006	
3003929452	SAN JUAN 29-6 UNIT 63C	RIO ARRIBA	NM	29N	6W	30		CONOCOPHILLIPS COMPANY	BLANCO: MESAVERDE		11	6/9/2006	8/15/2006	8/15/2006	
3003929690	SAN JUAN 29-6 UNIT 11C	RIO ARRIBA	NM	29N	6W	7		CONOCOPHILLIPS COMPANY	BLANCO: MESAVERDE		11	4/11/2007	4/24/2007	4/24/2007	
3003930748	SAN JUAN 29-6 UNIT 5M	RIO ARRIBA	NM	29N	6W	30	N	CONOCOPHILLIPS COMPANY	BLANCO: MESAVERDE		11	12/13/2010	12/13/2010	2/15/2011	
3003930748	SAN JUAN 29-6 UNIT 5M	RIO ARRIBA	NM	29N	6W	30	N	CONOCOPHILLIPS COMPANY	BASIN: DAKOTA		11	12/13/2010	12/13/2010	2/15/2011	
3003929870	SAN JUAN 29-6 UNIT 64B	RIO ARRIBA	NM	29N	6W	9	B	CONOCOPHILLIPS COMPANY	BLANCO: MESAVERDE		11	1/26/2007	2/7/2007	2/7/2007	
3003924597	SAN JUAN 29-6 UNIT 201	RIO ARRIBA	NM	29N	6W	6		CONOCOPHILLIPS COMPANY	BASIN: FRUITLAND COAL		11	1/14/1990	12/6/1990	12/6/1990	
3003924729	SAN JUAN 29-6 UNIT 236	RIO ARRIBA	NM	29N	6W	18		CONOCOPHILLIPS COMPANY	BASIN: FRUITLAND COAL		11	8/2/1990	5/18/1993	5/18/1993	
3003924822	SAN JUAN 29-6 UNIT 204	RIO ARRIBA	NM	29N	6W	7		CONOCOPHILLIPS COMPANY	BASIN: FRUITLAND COAL		11	12/17/1990			
3003924735	SAN JUAN 29-6 UNIT 203	RIO ARRIBA	NM	29N	6W	7		CONOCOPHILLIPS COMPANY	BASIN: FRUITLAND COAL		11	1/25/1991	5/14/1993	5/14/1993	
3003924899	SAN JUAN 29-6 UNIT 202	RIO ARRIBA	NM	29N	6W	6		CONOCOPHILLIPS COMPANY	BASIN: FRUITLAND COAL		11	1/26/1990	8/10/1993	8/10/1993	
3003924931	SAN JUAN 29-6 UNIT 205	RIO ARRIBA	NM	29N	6W	21		CONOCOPHILLIPS COMPANY	BASIN: FRUITLAND COAL		11	3/28/1991	5/18/1993	5/18/1993	
3003924589	SAN JUAN 29-6 UNIT 208	RIO ARRIBA	NM	29N	6W	17		CONOCOPHILLIPS COMPANY	BASIN: FRUITLAND COAL		11	1/23/1990	3/30/1990	3/30/1990	
3003924932	SAN JUAN 29-6 UNIT 240	RIO ARRIBA	NM	29N	6W	18		CONOCOPHILLIPS COMPANY	BASIN: FRUITLAND COAL		11	2/9/1991	5/18/1993	5/18/1993	
3003924933	SAN JUAN 29-6 UNIT 241	RIO ARRIBA	NM	29N	6W	19		CONOCOPHILLIPS COMPANY	BASIN: FRUITLAND COAL		11	2/21/1991	5/18/1993	5/18/1993	
3003924730	SAN JUAN 29-6 UNIT 242	RIO ARRIBA	NM	29N	6W	19		CONOCOPHILLIPS COMPANY	BASIN: FRUITLAND COAL		11	3/18/1991	5/18/1993	5/18/1993	
3003924978	SAN JUAN 29-6 UNIT 244	RIO ARRIBA	NM	29N	6W	31	B	CONOCOPHILLIPS COMPANY	BASIN: FRUITLAND COAL		41	10/28/1992	9/8/1993	9/8/1993	
3003924521	SAN JUAN 29-6 UNIT 206	RIO ARRIBA	NM	29N	6W	4		CONOCOPHILLIPS COMPANY	BASIN: FRUITLAND COAL		11	2/13/1990	5/18/1990	5/18/1990	
3003924806	SAN JUAN 29-6 UNIT 214	RIO ARRIBA	NM	29N	6W	3		CONOCOPHILLIPS COMPANY	BASIN: FRUITLAND COAL		11	3/15/1990	5/18/1990	5/18/1990	
3003924726	SAN JUAN 29-6 UNIT 215	RIO ARRIBA	NM	29N	6W	3		CONOCOPHILLIPS COMPANY	BASIN: FRUITLAND COAL		11	4/30/1990	5/18/1990	5/18/1990	
3003924607	SAN JUAN 29-6 UNIT 216	RIO ARRIBA	NM	29N	6W	4		CONOCOPHILLIPS COMPANY	BASIN: FRUITLAND COAL		11	3/30/1990	5/18/1990	5/18/1990	
3003924580	SAN JUAN 29-6 UNIT 209	RIO ARRIBA	NM	29N	6W	17		CONOCOPHILLIPS COMPANY	BASIN: FRUITLAND COAL		11	12/10/1989			
3003924845	SAN JUAN 29-6 UNIT 247	RIO ARRIBA	NM	29N	6W	10		CONOCOPHILLIPS COMPANY	BASIN: FRUITLAND COAL		71	12/21/1992	2/1/1995	9/1/1993	9/1/1993
3003925090	SAN JUAN 29-6 UNIT 262	RIO ARRIBA	NM	29N	6W	21		CONOCOPHILLIPS COMPANY	BASIN: FRUITLAND COAL		11	1/21/1992	1/21/1992	1/21/1992	
3003926443	SAN JUAN 29-6 UNIT 86M	RIO ARRIBA	NM					CONOCOPHILLIPS COMPANY	BASIN: DAKOTA		11				
3003928443	SAN JUAN 29-6 UNIT 86M	RIO ARRIBA	NM					CONOCOPHILLIPS COMPANY	BLANCO: MESAVERDE		11				
3003927516	SAN JUAN 29-6 UNIT 31M	RIO ARRIBA	NM	29N	6W	10		CONOCOPHILLIPS COMPANY	BASIN: DAKOTA		71	3/18/2004	2/10/2005	4/9/2004	4/9/2004
3003927516	SAN JUAN 29-6 UNIT 31M	RIO ARRIBA	NM	29N	6W	10		CONOCOPHILLIPS COMPANY	BLANCO: MESAVERDE		11				
3003927592	SAN JUAN 29-6 UNIT 104M	RIO ARRIBA	NM	29N	6W	14		CONOCOPHILLIPS COMPANY	BLANCO: MESAVERDE		11	1/14/2005	2/10/2005	2/10/2005	
3003927592	SAN JUAN 29-6 UNIT 104M	RIO ARRIBA	NM	29N	6W	14		CONOCOPHILLIPS COMPANY	BASIN: DAKOTA		11				
3003926466	SAN JUAN 29-6 UNIT 95M	RIO ARRIBA	NM					CONOCOPHILLIPS COMPANY	BLANCO: MESAVERDE		11				
3003926466	SAN JUAN 29-6 UNIT 95M	RIO ARRIBA	NM					CONOCOPHILLIPS COMPANY	BASIN: DAKOTA		11				
3003927527	SAN JUAN 29-6 UNIT 33M	RIO ARRIBA	NM					CONOCOPHILLIPS COMPANY	BLANCO: MESAVERDE		11				
3003926423	SAN JUAN 29-6 UNIT 35M	RIO ARRIBA	NM					CONOCOPHILLIPS COMPANY	BLANCO: MESAVERDE		11				
3003926423	SAN JUAN 29-6 UNIT 35M	RIO ARRIBA	NM					CONOCOPHILLIPS COMPANY	BASIN: DAKOTA		11				
3003926340	SAN JUAN 29-6 UNIT 69M	RIO ARRIBA	NM					CONOCOPHILLIPS COMPANY	BASIN: DAKOTA		11				
3003926340	SAN JUAN 29-6 UNIT 69M	RIO ARRIBA	NM					CONOCOPHILLIPS COMPANY	BLANCO: MESAVERDE		11				
3003927553	SAN JUAN 29-6 UNIT 75M	RIO ARRIBA	NM					CONOCOPHILLIPS COMPANY	BASIN: DAKOTA		11				
3003927553	SAN JUAN 29-6 UNIT 75M	RIO ARRIBA	NM					CONOCOPHILLIPS COMPANY	BLANCO: MESAVERDE		11				
3003926409	SAN JUAN 29-6 UNIT 77M	RIO ARRIBA	NM	29N	6W	22		CONOCOPHILLIPS COMPANY	BLANCO: MESAVERDE		11				
3003926374	SAN JUAN 29-6 UNIT 81M	RIO ARRIBA	NM					CONOCOPHILLIPS COMPANY	BASIN: DAKOTA		11				
3003926374	SAN JUAN 29-6 UNIT 81M	RIO ARRIBA	NM					CONOCOPHILLIPS COMPANY	BLANCO: MESAVERDE		11				
3003927526	SAN JUAN 29-6 UNIT 83M	RIO ARRIBA	NM					CONOCOPHILLIPS COMPANY	BLANCO: MESAVERDE		11				
3003927526	SAN JUAN 29-6 UNIT 83M	RIO ARRIBA	NM					CONOCOPHILLIPS COMPANY	BASIN: DAKOTA		11				
3003928343	SAN JUAN 29-6 UNIT 85M	RIO ARRIBA	NM	29N	6W	27		CONOCOPHILLIPS COMPANY	BASIN: DAKOTA		71	8/1/2000			
3003928343	SAN JUAN 29-6 UNIT 85M	RIO ARRIBA	NM	29N	6W	27		CONOCOPHILLIPS COMPANY	BLANCO: MESAVERDE		11				
3003927554	SAN JUAN 29-6 UNIT 88M	RIO ARRIBA	NM					CONOCOPHILLIPS COMPANY	BLANCO: MESAVERDE		11				
3003927554	SAN JUAN 29-6 UNIT 88M	RIO ARRIBA	NM					CONOCOPHILLIPS COMPANY	BASIN: DAKOTA		11				
3003927520	SAN JUAN 29-6 UNIT 89F	RIO ARRIBA	NM	29N	6W	11		CONOCOPHILLIPS COMPANY	BLANCO: MESAVERDE		11				
3003927520	SAN JUAN 29-6 UNIT 89F	RIO ARRIBA	NM	29N	6W	11		CONOCOPHILLIPS COMPANY	BASIN: DAKOTA		11				
3003927555	SAN JUAN 29-6 UNIT 92M	RIO ARRIBA	NM					CONOCOPHILLIPS COMPANY	BLANCO: MESAVERDE		11				
3003927555	SAN JUAN 29-6 UNIT 92M	RIO ARRIBA	NM					CONOCOPHILLIPS COMPANY	BASIN: DAKOTA		11				
3003927560	SAN JUAN 29-6 UNIT 90M	RIO ARRIBA	NM					CONOCOPHILLIPS COMPANY	BLANCO: MESAVERDE		11				
3003927560	SAN JUAN 29-6 UNIT 90M	RIO ARRIBA	NM					CONOCOPHILLIPS COMPANY	BASIN: DAKOTA		11				
3003928419	SAN JUAN 29-6 UNIT 91M	RIO ARRIBA	NM					CONOCOPHILLIPS COMPANY	BLANCO: MESAVERDE		11				
3003928419	SAN JUAN 29-6 UNIT 91M	RIO ARRIBA	NM					CONOCOPHILLIPS COMPANY	BASIN: DAKOTA		11				
3003926405	SAN JUAN 29-6 UNIT 93M	RIO ARRIBA	NM					CONOCOPHILLIPS COMPANY	BLANCO: MESAVERDE		11				
3003926405	SAN JUAN 29-6 UNIT 93M	RIO ARRIBA	NM					CONOCOPHILLIPS COMPANY	BASIN: DAKOTA		11				
3003927559	SAN JUAN 29-6 UNIT 80M	RIO ARRIBA	NM					CONOCOPHILLIPS COMPANY	BASIN: DAKOTA		11				
3003927559	SAN JUAN 29-6 UNIT 80M	RIO ARRIBA	NM					CONOCOPHILLIPS COMPANY	BLANCO: MESAVERDE		11				
3003927573	SAN JUAN 29-6 UNIT 79M	RIO ARRIBA	NM					CONOCOPHILLIPS COMPANY	BASIN: DAKOTA		11				

SAN JUAN 29-4 UNIT
STATUS OF WELLS-7-27-15

3003927573	SAN JUAN 29-6 UNIT 79M	RIO ARRIBA	NM					CONOCOPHILLIPS COMPANY	BLANCO:MESAVERDE	11						
3003926342	SAN JUAN 29-6 UNIT 97M	RIO ARRIBA	NM					CONOCOPHILLIPS COMPANY	BLANCO:MESAVERDE	11						
3003926342	SAN JUAN 29-6 UNIT 97M	RIO ARRIBA	NM					CONOCOPHILLIPS COMPANY	BASIN:DAKOTA	11						
3003927519	SAN JUAN 29-6 UNIT 103M	RIO ARRIBA	NM					CONOCOPHILLIPS COMPANY	BLANCO:MESAVERDE	11						
3003927519	SAN JUAN 29-6 UNIT 103M	RIO ARRIBA	NM					CONOCOPHILLIPS COMPANY	BASIN:DAKOTA	11						
3003926462	SAN JUAN 29-6 UNIT 82M	RIO ARRIBA	NM					CONOCOPHILLIPS COMPANY	BLANCO:MESAVERDE	11						
3003926462	SAN JUAN 29-6 UNIT 82M	RIO ARRIBA	NM					CONOCOPHILLIPS COMPANY	BASIN:DAKOTA	11						
3003927517	SAN JUAN 29-6 UNIT 102M	RIO ARRIBA	NM					CONOCOPHILLIPS COMPANY	BASIN:DAKOTA	11						
3003927517	SAN JUAN 29-6 UNIT 102M	RIO ARRIBA	NM					CONOCOPHILLIPS COMPANY	BLANCO:MESAVERDE	11						
3003926338	SAN JUAN 29-6 UNIT 101M	RIO ARRIBA	NM					CONOCOPHILLIPS COMPANY	BASIN:DAKOTA	11						
3003926338	SAN JUAN 29-6 UNIT 101M	RIO ARRIBA	NM					CONOCOPHILLIPS COMPANY	BLANCO:MESAVERDE	11						
3003926430	SAN JUAN 29-6 UNIT 99M	RIO ARRIBA	NM					CONOCOPHILLIPS COMPANY	BLANCO:MESAVERDE	11						
3003926430	SAN JUAN 29-6 UNIT 99M	RIO ARRIBA	NM					CONOCOPHILLIPS COMPANY	BASIN:DAKOTA	11						
3003924516	SAN JUAN 29-6 UNIT 207	RIO ARRIBA	NM	29N	6W		2	CONOCOPHILLIPS COMPANY	BASIN:FRUITLAND COAL	11		2/6/1990				
3003924608	SAN JUAN 29-6 UNIT 219	RIO ARRIBA	NM	29N	6W		10	CONOCOPHILLIPS COMPANY	BASIN:FRUITLAND COAL	11		3/8/1990	5/3/1990			5/3/1990
3003924680	SAN JUAN 29-6 UNIT 221	RIO ARRIBA	NM	29N	6W		11	CONOCOPHILLIPS COMPANY	BASIN:FRUITLAND COAL	11		5/5/1990	6/20/1990			6/20/1990
3003924794	SAN JUAN 29-6 UNIT 217	RIO ARRIBA	NM	29N	6W		5	CONOCOPHILLIPS COMPANY	BASIN:FRUITLAND COAL	11		7/16/1990	8/28/1990			8/28/1990
3003924748	SAN JUAN 29-6 UNIT 218	RIO ARRIBA	NM	29N	6W		5	CONOCOPHILLIPS COMPANY	BASIN:FRUITLAND COAL	11		6/22/1990	8/15/1993			8/15/1993
3003924690	SAN JUAN 29-6 UNIT 220	RIO ARRIBA	NM	29N	6W		11	CONOCOPHILLIPS COMPANY	BASIN:FRUITLAND COAL	11		6/14/1990	7/28/1990			7/28/1990
3003924681	SAN JUAN 29-6 UNIT 223	RIO ARRIBA	NM	29N	6W		12	CONOCOPHILLIPS COMPANY	BASIN:FRUITLAND COAL	11		6/5/1990	7/12/1990			7/12/1990
3003924824	SAN JUAN 29-6 UNIT 248	RIO ARRIBA	NM	29N	6W		8	CONOCOPHILLIPS COMPANY	BASIN:FRUITLAND COAL	11		3/28/1992	5/12/1993			5/12/1993
3003924747	SAN JUAN 29-6 UNIT 210	RIO ARRIBA	NM	29N	6W		20	CONOCOPHILLIPS COMPANY	BASIN:FRUITLAND COAL	11		3/5/1991				
3003924723	SAN JUAN 29-6 UNIT 211	RIO ARRIBA	NM	29N	6W		20	CONOCOPHILLIPS COMPANY	BASIN:FRUITLAND COAL	11		10/18/1992	5/1/1993			5/1/1993
3003924910	SAN JUAN 29-6 UNIT 245	RIO ARRIBA	NM	29N	6W		8	CONOCOPHILLIPS COMPANY	BASIN:FRUITLAND COAL	11		1/3/1991	7/9/1991			7/9/1991
3003924763	SAN JUAN 29-6 UNIT 259	RIO ARRIBA	NM	29N	6W		9	CONOCOPHILLIPS COMPANY	BASIN:FRUITLAND COAL	11		3/24/1992				
3003925161	SAN JUAN 29-6 UNIT 248	RIO ARRIBA	NM	29N	6W		15	CONOCOPHILLIPS COMPANY	BASIN:FRUITLAND COAL	71		1/5/1992	1/1/1995			
3003921790	SAN JUAN 29-6 UNIT 111	RIO ARRIBA	NM					CONOCOPHILLIPS COMPANY	GOBERNADOR:PICTURED CLIF	11						
3003907491	SAN JUAN 29-6 UNIT NP 88	RIO ARRIBA	NM					CONOCOPHILLIPS COMPANY	BLANCO:MESAVERDE	11						
3003907603	SAN JUAN 29-6 UNIT 94	RIO ARRIBA	NM					CONOCOPHILLIPS COMPANY	BLANCO:MESAVERDE	11						
3003908076	SAN JUAN 29-6 UNIT NP 96	RIO ARRIBA	NM	29N	6W		2	CONOCOPHILLIPS COMPANY	BASIN:DAKOTA	71		7/5/1966	5/2/2002	10/14/1966		10/14/1966
3003921039	SAN JUAN 29-6 UNIT 106	RIO ARRIBA	NM					CONOCOPHILLIPS COMPANY	BASIN:DAKOTA	11		12/24/1974	12/24/1974			12/24/1974
3003921039	SAN JUAN 29-6 UNIT 106	RIO ARRIBA	NM					CONOCOPHILLIPS COMPANY	BLANCO:MESAVERDE	11		8/14/1999	8/14/1999			8/14/1999
3003920490	SAN JUAN 29-6 UNIT 104	RIO ARRIBA	NM					CONOCOPHILLIPS COMPANY	BLANCO:MESAVERDE	11						
3003907492	SAN JUAN 29-6 UNIT 67	RIO ARRIBA	NM					CONOCOPHILLIPS COMPANY	BLANCO:MESAVERDE	11						
3003920027	SAN JUAN 29-6 UNIT 95	RIO ARRIBA	NM					CONOCOPHILLIPS COMPANY	BLANCO:MESAVERDE	11						
3003907549	SAN JUAN 29-6 UNIT 69	RIO ARRIBA	NM					CONOCOPHILLIPS COMPANY	BLANCO:MESAVERDE	11						
3003907557	SAN JUAN 29-6 UNIT 76	RIO ARRIBA	NM	29N	6W		23	CONOCOPHILLIPS COMPANY	BLANCO:PICTURED CLIFFS	11		12/14/2000				
3003907581	SAN JUAN 29-6 UNIT 77	RIO ARRIBA	NM					CONOCOPHILLIPS COMPANY	BLANCO:MESAVERDE	11						
3003907578	SAN JUAN 29-6 UNIT 78	RIO ARRIBA	NM	29N	6W		22	CONOCOPHILLIPS COMPANY	BASIN:DAKOTA	61		10/18/1964	4/8/1965			4/8/1965
3003907578	SAN JUAN 29-6 UNIT 78	RIO ARRIBA	NM	29N	6W		22	CONOCOPHILLIPS COMPANY	BLANCO:MESAVERDE	11						
3003907623	SAN JUAN 29-6 UNIT 84	RIO ARRIBA	NM					CONOCOPHILLIPS COMPANY	BLANCO:MESAVERDE	11						
3003907604	SAN JUAN 29-6 UNIT 83	RIO ARRIBA	NM					CONOCOPHILLIPS COMPANY	BLANCO:MESAVERDE	11						
3003907551	SAN JUAN 29-6 UNIT 85	RIO ARRIBA	NM					CONOCOPHILLIPS COMPANY	BLANCO:MESAVERDE	11						
3003907516	SAN JUAN 29-6 UNIT 86	RIO ARRIBA	NM					CONOCOPHILLIPS COMPANY	BLANCO:MESAVERDE	11						
3003907622	SAN JUAN 29-6 UNIT 90	RIO ARRIBA	NM					CONOCOPHILLIPS COMPANY	BLANCO:MESAVERDE	11						
3003907582	SAN JUAN 29-6 UNIT 91	RIO ARRIBA	NM	29N	6W		21	CONOCOPHILLIPS COMPANY	BASIN:DAKOTA	71		8/5/1965	5/28/2002	11/2/1965		11/3/1965
3003907582	SAN JUAN 29-6 UNIT 91	RIO ARRIBA	NM	29N	6W		21	CONOCOPHILLIPS COMPANY	BLANCO:MESAVERDE	71			5/28/2002			
3003907629	SAN JUAN 29-6 UNIT 93	RIO ARRIBA	NM					CONOCOPHILLIPS COMPANY	BLANCO:MESAVERDE	11						
3003908077	SAN JUAN 29-6 UNIT 80	RIO ARRIBA	NM					CONOCOPHILLIPS COMPANY	BLANCO:MESAVERDE	11						
3003920225	SAN JUAN 29-6 UNIT 79	RIO ARRIBA	NM					CONOCOPHILLIPS COMPANY	BLANCO:MESAVERDE	11						
3003920241	SAN JUAN 29-6 UNIT 97	RIO ARRIBA	NM					CONOCOPHILLIPS COMPANY	BLANCO:MESAVERDE	11						
3003920297	SAN JUAN 29-6 UNIT 98	RIO ARRIBA	NM					CONOCOPHILLIPS COMPANY	BLANCO:MESAVERDE	11						
3003920299	SAN JUAN 29-6 UNIT 100	RIO ARRIBA	NM					CONOCOPHILLIPS COMPANY	BLANCO:MESAVERDE	11						
3003920359	SAN JUAN 29-6 UNIT 103	RIO ARRIBA	NM					CONOCOPHILLIPS COMPANY	BLANCO:MESAVERDE	11						
3003920357	SAN JUAN 29-6 UNIT 82	RIO ARRIBA	NM					CONOCOPHILLIPS COMPANY	BLANCO:MESAVERDE	11						
3003920365	SAN JUAN 29-6 UNIT 102	RIO ARRIBA	NM					CONOCOPHILLIPS COMPANY	BLANCO:MESAVERDE	11						
3003920298	SAN JUAN 29-6 UNIT 99	RIO ARRIBA	NM					CONOCOPHILLIPS COMPANY	BLANCO:MESAVERDE	11						
3003920298	SAN JUAN 29-6 UNIT 99	RIO ARRIBA	NM					CONOCOPHILLIPS COMPANY	BASIN:DAKOTA	11						
3003907607	SAN JUAN 29-6 UNIT 4	RIO ARRIBA	NM	29N	6W		17	CONOCOPHILLIPS COMPANY	BLANCO:MESAVERDE	72		12/15/1952	1/1/1973	5/1/1953		5/1/1953
3003907688	SAN JUAN 29-6 UNIT 8	RIO ARRIBA	NM	29N	6W		1	CONOCOPHILLIPS COMPANY	BLANCO:MESAVERDE	72		3/30/1954	1/1/1963	4/1/1954		4/1/1954
3003924758	SAN JUAN 29-6 UNIT 222	RIO ARRIBA	NM	29N	6W		12	CONOCOPHILLIPS COMPANY	BASIN:FRUITLAND COAL	11		7/7/1990				
3003924759	SAN JUAN 29-6 UNIT 224	RIO ARRIBA	NM	29N	6W		13	CONOCOPHILLIPS COMPANY	BASIN:FRUITLAND COAL	11		3/20/1991				
3003924804	SAN JUAN 29-6 UNIT 237	RIO ARRIBA	NM	29N	6W		1	CONOCOPHILLIPS COMPANY	BASIN:FRUITLAND COAL	11		2/2/1991				12/29/1992
3003924805	SAN JUAN 29-6 UNIT 239	RIO ARRIBA	NM	29N	6W		1	CONOCOPHILLIPS COMPANY	BASIN:FRUITLAND COAL	11		2/27/1991				12/29/1992
3003924705	SAN JUAN 29-6 UNIT 239	RIO ARRIBA	NM	29N	6W		2	CONOCOPHILLIPS COMPANY	BASIN:FRUITLAND COAL	11		3/9/1991				3/9/1991
3003924882	SAN JUAN 29-6 UNIT 225	RIO ARRIBA	NM	29N	6W		13	CONOCOPHILLIPS COMPANY	BASIN:FRUITLAND COAL	71		5/13/1990	12/1/1995	5/13/1990		5/13/1990
3003924668	SAN JUAN 29-6 UNIT 226	RIO ARRIBA	NM	29N	6W		14	CONOCOPHILLIPS COMPANY	BASIN:FRUITLAND COAL	11		1/21/1992				
3003924766	SAN JUAN 29-6 UNIT 258	RIO ARRIBA	NM	29N	6W		16	CONOCOPHILLIPS COMPANY	BASIN:FRUITLAND COAL	11		4/12/1991				
3003924767	SAN JUAN 29-6 UNIT 260	RIO ARRIBA	NM	29N	6W		16	CONOCOPHILLIPS COMPANY	BASIN:FRUITLAND COAL	11		10/16/1992				
3003925414	SAN JUAN 29-6 UNIT 247R	RIO ARRIBA	NM	29N	6W		10	CONOCOPHILLIPS COMPANY	BASIN:FRUITLAND COAL	11		12/19/1994				12/30/1994
3003925456	SAN JUAN 29-6 UNIT 257R	RIO ARRIBA	NM	29N	6W		9	CONOCOPHILLIPS COMPANY	BASIN:FRUITLAND COAL	11		12/2/1994				12/15/1994
3003921226	SAN JUAN 29-6 UNIT 55A	RIO ARRIBA	NM					CONOCOPHILLIPS COMPANY	BLANCO:MESAVERDE	41						

SAN JUAN 29-6 UNIT
STATUS OF WELLS - 2-27-15

3003907648	SAN JUAN 29-6 UNIT 92	RIO ARRIBA	NM						CONOCOPHILLIPS COMPANY	BLANCO::MESAVERDE	11				
3003907471	SAN JUAN 29-6 UNIT 16	RIO ARRIBA	NM						CONOCOPHILLIPS COMPANY	BLANCO::PICTURED CLIFFS	11				
3003907662	SAN JUAN 29-6 UNIT 18	RIO ARRIBA	NM						CONOCOPHILLIPS COMPANY	BLANCO::MESAVERDE	72	1/1/1970	10/6/1994	1/1/1970	1/1/1970
3003907675	SAN JUAN 29-6 UNIT 19	RIO ARRIBA	NM	29N	6W	5			CONOCOPHILLIPS COMPANY	BLANCO::MESAVERDE	71	1/1/1970	8/23/1998	1/1/1970	1/1/1970
3003907652	SAN JUAN 29-6 UNIT	RIO ARRIBA	NM						CONOCOPHILLIPS COMPANY	BLANCO::MESAVERDE	72				
3003907500	SAN JUAN 29-6 UNIT 25	RIO ARRIBA	NM						CONOCOPHILLIPS COMPANY	BLANCO S.:PICTURED CLIFF	11				
3003907550	SAN JUAN 29-6 UNIT 47	RIO ARRIBA	NM	29N	8W	28			CONOCOPHILLIPS COMPANY	BASIN::DAKOTA	71	7/21/1959	12/30/1998	9/1/1959	9/22/1959
3003907550	SAN JUAN 29-6 UNIT 47	RIO ARRIBA	NM	29N	6W	28			CONOCOPHILLIPS COMPANY	BASIN::FRUITLAND COAL	11				
3003907502	SAN JUAN 29-6 UNIT 48	RIO ARRIBA	NM						CONOCOPHILLIPS COMPANY	BLANCO::MESAVERDE	11				
3003907470	SAN JUAN 29-6 UNIT 51	RIO ARRIBA	NM						CONOCOPHILLIPS COMPANY	BLANCO::PICTURED CLIFFS	11				
3003921088	SAN JUAN 29-6 UNIT 51A	RIO ARRIBA	NM						CONOCOPHILLIPS COMPANY	BLANCO::PICTURED CLIFFS	11				
3003921086	SAN JUAN 29-6 UNIT 53A	RIO ARRIBA	NM						CONOCOPHILLIPS COMPANY	BLANCO::PICTURED CLIFFS	11				
3003907527	SAN JUAN 29-6 UNIT 58	RIO ARRIBA	NM						CONOCOPHILLIPS COMPANY	BLANCO::MESAVERDE	61				
3003921262	SAN JUAN 29-6 UNIT 58A	RIO ARRIBA	NM						CONOCOPHILLIPS COMPANY	BASIN::FRUITLAND COAL	11				
3003921263	SAN JUAN 29-6 UNIT 70A	RIO ARRIBA	NM	29N	6W	29			CONOCOPHILLIPS COMPANY	BASIN::FRUITLAND COAL	11				
3003926184	SAN JUAN 29-6 UNIT 8B	RIO ARRIBA	NM	29N	8W	1			CONOCOPHILLIPS COMPANY	BASIN::DAKOTA	61	10/13/1999		10/13/1999	10/13/1999
3003926184	SAN JUAN 29-6 UNIT 8B	RIO ARRIBA	NM	29N	6W	1			CONOCOPHILLIPS COMPANY	BLANCO::MESAVERDE	11				
3003926188	SAN JUAN 29-6 UNIT 10B	RIO ARRIBA	NM	29N	6W	5			CONOCOPHILLIPS COMPANY	BLANCO::MESAVERDE	11				
3003926179	SAN JUAN 29-6 UNIT 29B	RIO ARRIBA	NM	29N	6W	3			CONOCOPHILLIPS COMPANY	BLANCO::MESAVERDE	11				
3003926186	SAN JUAN 29-6 UNIT 47B	RIO ARRIBA	NM						CONOCOPHILLIPS COMPANY	BLANCO::MESAVERDE	11				
3003926180	SAN JUAN 29-6 UNIT 25B	RIO ARRIBA	NM						CONOCOPHILLIPS COMPANY	BLANCO::MESAVERDE	11				
3003926185	SAN JUAN 29-6 UNIT 68B	RIO ARRIBA	NM						CONOCOPHILLIPS COMPANY	BLANCO::MESAVERDE	11				
3003926197	SAN JUAN 29-6 UNIT 31B	RIO ARRIBA	NM						CONOCOPHILLIPS COMPANY	BASIN::DAKOTA	41				
3003926197	SAN JUAN 29-6 UNIT 31B	RIO ARRIBA	NM						CONOCOPHILLIPS COMPANY	BLANCO::MESAVERDE	11				
3003926183	SAN JUAN 29-6 UNIT 84M	RIO ARRIBA	NM						CONOCOPHILLIPS COMPANY	BASIN::DAKOTA	11				
3003926183	SAN JUAN 29-6 UNIT 84M	RIO ARRIBA	NM						CONOCOPHILLIPS COMPANY	BLANCO::MESAVERDE	11				
3003926187	SAN JUAN 29-6 UNIT 87M	RIO ARRIBA	NM						CONOCOPHILLIPS COMPANY	BLANCO::MESAVERDE	11				
3003926187	SAN JUAN 29-6 UNIT 87M	RIO ARRIBA	NM						CONOCOPHILLIPS COMPANY	BASIN::DAKOTA	11				
3003927238	SAN JUAN 29-6 UNIT 47M *	RIO ARRIBA	NM	29N	6W	28			CONOCOPHILLIPS COMPANY	BASIN::DAKOTA	71	12/20/1999	5/3/2002	12/30/1999	12/30/1999
3003927238	SAN JUAN 29-6 UNIT 47M *	RIO ARRIBA	NM	29N	6W	28			CONOCOPHILLIPS COMPANY	BLANCO::MESAVERDE	11				
3003927238	SAN JUAN 29-6 UNIT COM 47	RIO ARRIBA	NM	29N	6W	28			CONOCOPHILLIPS COMPANY	BASIN::DAKOTA	71	12/20/1999	5/3/2002	12/30/1999	12/30/1999
3003926341	SAN JUAN 29-6 UNIT 78M	RIO ARRIBA	NM						CONOCOPHILLIPS COMPANY	BASIN::DAKOTA	11				
3003926341	SAN JUAN 29-6 UNIT 78M	RIO ARRIBA	NM						CONOCOPHILLIPS COMPANY	BLANCO::MESAVERDE	11				
3003926458	SAN JUAN 29-6 UNIT 98M	RIO ARRIBA	NM						CONOCOPHILLIPS COMPANY	BLANCO::MESAVERDE	11				
3003926458	SAN JUAN 29-6 UNIT 98M	RIO ARRIBA	NM						CONOCOPHILLIPS COMPANY	BASIN::DAKOTA	11				
3003926339	SAN JUAN 29-6 UNIT 94M	RIO ARRIBA	NM						CONOCOPHILLIPS COMPANY	BLANCO::MESAVERDE	11				
3003926339	SAN JUAN 29-6 UNIT 94M	RIO ARRIBA	NM						CONOCOPHILLIPS COMPANY	BASIN::DAKOTA	11				
3003926467	SAN JUAN 29-6 UNIT 105R	RIO ARRIBA	NM						CONOCOPHILLIPS COMPANY	BLANCO::MESAVERDE	11				
3003926421	SAN JUAN 29-6 UNIT 19R	RIO ARRIBA	NM						CONOCOPHILLIPS COMPANY	BLANCO::MESAVERDE	11				
3003926444	SAN JUAN 29-6 UNIT 18R	RIO ARRIBA	NM						CONOCOPHILLIPS COMPANY	BLANCO::MESAVERDE	11				
3003926708	SAN JUAN 29-6 UNIT 10B	RIO ARRIBA	NM						CONOCOPHILLIPS COMPANY	BLANCO::MESAVERDE	11				
3003926738	SAN JUAN 29-6 UNIT 70B	RIO ARRIBA	NM						CONOCOPHILLIPS COMPANY	BLANCO::MESAVERDE	11				
3003926717	SAN JUAN 29-6 UNIT 70C	RIO ARRIBA	NM						CONOCOPHILLIPS COMPANY	BLANCO::MESAVERDE	11				
3003926676	SAN JUAN 29-6 UNIT 73B	RIO ARRIBA	NM						CONOCOPHILLIPS COMPANY	BLANCO::MESAVERDE	11				
3003926673	SAN JUAN 29-6 UNIT 73C	RIO ARRIBA	NM						CONOCOPHILLIPS COMPANY	BLANCO::MESAVERDE	11				
3003926707	SAN JUAN 29-6 UNIT 10C	RIO ARRIBA	NM						CONOCOPHILLIPS COMPANY	BLANCO::MESAVERDE	11				
3003926740	SAN JUAN 29-6 UNIT 13B	RIO ARRIBA	NM						CONOCOPHILLIPS COMPANY	BLANCO::MESAVERDE	11				
3003926705	SAN JUAN 29-6 UNIT 15B	RIO ARRIBA	NM						CONOCOPHILLIPS COMPANY	BLANCO::MESAVERDE	11				
3003926704	SAN JUAN 29-6 UNIT 15C	RIO ARRIBA	NM						CONOCOPHILLIPS COMPANY	BLANCO::MESAVERDE	11				
3003926743	SAN JUAN 29-6 UNIT 1C	RIO ARRIBA	NM						CONOCOPHILLIPS COMPANY	BLANCO::MESAVERDE	11				
3003926748	SAN JUAN 29-6 UNIT 12C	RIO ARRIBA	NM						CONOCOPHILLIPS COMPANY	BLANCO::MESAVERDE	11				
3003926799	SAN JUAN 29-6 UNIT 25C	RIO ARRIBA	NM						CONOCOPHILLIPS COMPANY	BLANCO::MESAVERDE	11				
3003927864	SAN JUAN 29-6 UNIT 62B	RIO ARRIBA	NM						CONOCOPHILLIPS COMPANY	BLANCO::MESAVERDE	11				
3003929434	SAN JUAN 29-6 UNIT 62C	RIO ARRIBA	NM						CONOCOPHILLIPS COMPANY	BLANCO::MESAVERDE	11				
3003927532	SAN JUAN 29-6 UNIT 237A	RIO ARRIBA	NM	29N	6W	1			CONOCOPHILLIPS COMPANY	BASIN::FRUITLAND COAL	11	3/31/2004		5/3/2004	5/3/2004
3003927489	SAN JUAN 29-6 UNIT 238A	RIO ARRIBA	NM	29N	8W	1			CONOCOPHILLIPS COMPANY	BASIN::FRUITLAND COAL	11	4/13/2004		5/17/2004	5/17/2004
3003927521	SAN JUAN 29-6 UNIT 12B	RIO ARRIBA	NM						CONOCOPHILLIPS COMPANY	BLANCO::MESAVERDE	11				
3003927507	SAN JUAN 29-6 UNIT 22M	RIO ARRIBA	NM	29N	6W	12			CONOCOPHILLIPS COMPANY	BASIN::DAKOTA	11	1/16/2004		3/4/2004	3/4/2004
3003927507	SAN JUAN 29-6 UNIT 22M	RIO ARRIBA	NM	29N	8W	12			CONOCOPHILLIPS COMPANY	BLANCO::MESAVERDE	11				
3003927504	SAN JUAN 29-6 UNIT 201A	RIO ARRIBA	NM	29N	6W	6			CONOCOPHILLIPS COMPANY	BASIN::FRUITLAND COAL	11	2/1/2004		2/24/2003	2/24/2003
3003927501	SAN JUAN 29-6 UNIT 202A	RIO ARRIBA	NM	29N	6W	6			CONOCOPHILLIPS COMPANY	BASIN::FRUITLAND COAL	11	2/12/2004		3/17/2004	3/17/2004
3003927505	SAN JUAN 29-6 UNIT 204A	RIO ARRIBA	NM	29N	6W	7			CONOCOPHILLIPS COMPANY	BASIN::FRUITLAND COAL	11	2/19/2004		3/15/2004	3/15/2004
3003927511	SAN JUAN 29-6 UNIT 215A	RIO ARRIBA	NM	29N	6W	3			CONOCOPHILLIPS COMPANY	BASIN::FRUITLAND COAL	11	3/26/2004		4/23/2004	4/23/2004
3003927512	SAN JUAN 29-6 UNIT 216A	RIO ARRIBA	NM	29N	6W	4			CONOCOPHILLIPS COMPANY	BASIN::FRUITLAND COAL	11	1/13/2004		2/27/2004	2/27/2004
3003927502	SAN JUAN 29-6 UNIT 217A	RIO ARRIBA	NM	29N	8W	5			CONOCOPHILLIPS COMPANY	BASIN::FRUITLAND COAL	11	1/11/2004		1/27/2004	1/27/2004
3003927508	SAN JUAN 29-6 UNIT 245A	RIO ARRIBA	NM	29N	6W	8			CONOCOPHILLIPS COMPANY	BASIN::FRUITLAND COAL	11	3/10/2004		3/25/2004	3/25/2004
3003927506	SAN JUAN 29-6 UNIT 218A	RIO ARRIBA	NM	29N	6W	5			CONOCOPHILLIPS COMPANY	BASIN::FRUITLAND COAL	11	1/15/2004		3/17/2004	3/17/2004
3003927543	SAN JUAN 29-6 UNIT 239A	RIO ARRIBA	NM	29N	6W	2			CONOCOPHILLIPS COMPANY	BASIN::FRUITLAND COAL	11	3/8/2004		3/19/2004	3/19/2004
3003927541	SAN JUAN 29-6 UNIT 240A	RIO ARRIBA	NM	29N	6W	18			CONOCOPHILLIPS COMPANY	BASIN::FRUITLAND COAL	11	1/21/2004		3/16/2004	3/16/2004
3003927544	SAN JUAN 29-6 UNIT 203A	RIO ARRIBA	NM	29N	6W	7			CONOCOPHILLIPS COMPANY	BASIN::FRUITLAND COAL	11	3/7/2004		5/28/2004	5/28/2004
3003927546	SAN JUAN 29-6 UNIT 207A	RIO ARRIBA	NM	29N	6W	2			CONOCOPHILLIPS COMPANY	BASIN::FRUITLAND COAL	11	3/22/2004		6/21/2004	6/21/2004
3003927540	SAN JUAN 29-6 UNIT 208A	RIO ARRIBA	NM	29N	6W	17			CONOCOPHILLIPS COMPANY	BASIN::FRUITLAND COAL	11	3/23/2004		5/13/2004	5/13/2004

SAN JUAN 29-6 UNIT
STATUS OF WELLS - 2-27-15

3003927539	SAN JUAN 29-6 UNIT 209A	RIO ARRIBA	NM	29N	6W	17		CONOCOPHILLIPS COMPANY	BASIN::FRUITLAND COAL	11	3/8/2004		4/21/2004	4/21/2004
3003927562	SAN JUAN 29-6 UNIT 214A	RIO ARRIBA	NM	29N	6W	3		CONOCOPHILLIPS COMPANY	BASIN::FRUITLAND COAL	11	3/17/2004		5/21/2004	5/21/2004
3003927534	SAN JUAN 29-6 UNIT 236A	RIO ARRIBA	NM	29N	6W	18		CONOCOPHILLIPS COMPANY	BASIN::FRUITLAND COAL	11	2/7/2004		4/13/2004	4/13/2004
3003927561	SAN JUAN 29-6 UNIT 242A	RIO ARRIBA	NM	29N	6W	19 C		CONOCOPHILLIPS COMPANY	BASIN::FRUITLAND COAL	11	3/13/2004		4/14/2004	4/14/2004
3003927542	SAN JUAN 29-6 UNIT 106M	RIO ARRIBA	NM					CONOCOPHILLIPS COMPANY	BASIN::DAKOTA	11	5/3/2004		5/3/2004	5/3/2004
3003927542	SAN JUAN 29-6 UNIT 106M	RIO ARRIBA	NM					CONOCOPHILLIPS COMPANY	BLANCO::MESAVERDE	11	5/3/2004		5/3/2004	
3003927531	SAN JUAN 29-6 UNIT 108	RIO ARRIBA	NM					CONOCOPHILLIPS COMPANY	BLANCO::MESAVERDE	11				
3003927531	SAN JUAN 29-6 UNIT 108	RIO ARRIBA	NM					CONOCOPHILLIPS COMPANY	BASIN::DAKOTA	11				
3003927536	SAN JUAN 29-6 UNIT 108M	RIO ARRIBA	NM	29N	6W	31		CONOCOPHILLIPS COMPANY	BLANCO::MESAVERDE	11	5/11/2004		5/19/2004	5/19/2004
3003927536	SAN JUAN 29-6 UNIT 108M	RIO ARRIBA	NM	29N	6W	31		CONOCOPHILLIPS COMPANY	BASIN::DAKOTA	11				
3003927529	SAN JUAN 29-6 UNIT 109	RIO ARRIBA	NM					CONOCOPHILLIPS COMPANY	BLANCO::MESAVERDE	11				
3003929276	SAN JUAN 29-6 UNIT 11B	RIO ARRIBA	NM					CONOCOPHILLIPS COMPANY	BLANCO::MESAVERDE	11				
3003927623	SAN JUAN 29-6 UNIT 90F	RIO ARRIBA	NM					CONOCOPHILLIPS COMPANY	BLANCO::MESAVERDE	11				
3003927623	SAN JUAN 29-6 UNIT 90F	RIO ARRIBA	NM					CONOCOPHILLIPS COMPANY	BASIN::DAKOTA	11				
3003929331	SAN JUAN 29-6 UNIT 64M DK	RIO ARRIBA	NM					CONOCOPHILLIPS COMPANY	BASIN::DAKOTA	11				
3003929331	SAN JUAN 29-6 UNIT 64M DK	RIO ARRIBA	NM					CONOCOPHILLIPS COMPANY	BLANCO::MESAVERDE	11				
3003927503	SAN JUAN 29-6 UNIT 17B	RIO ARRIBA	NM					CONOCOPHILLIPS COMPANY	BLANCO::MESAVERDE	11				
3003927599	SAN JUAN 29-6 UNIT 17C	RIO ARRIBA	NM					CONOCOPHILLIPS COMPANY	BLANCO::MESAVERDE	11				
3003927855	SAN JUAN 29-6 UNIT 205A	RIO ARRIBA	NM	29N	6W	21		CONOCOPHILLIPS COMPANY	BASIN::FRUITLAND COAL	11	1/19/2005		3/10/2005	3/10/2005
3003927835	SAN JUAN 29-6 UNIT 210A	RIO ARRIBA	NM	29N	6W	20		CONOCOPHILLIPS COMPANY	BASIN::FRUITLAND COAL	11	12/28/2004		1/24/2005	1/24/2005
3003929279	SAN JUAN 29-6 UNIT 220A	RIO ARRIBA	NM	29N	6W	11		CONOCOPHILLIPS COMPANY	BASIN::FRUITLAND COAL	11	12/4/2004		3/21/2005	3/21/2005
3003927859	SAN JUAN 29-6 UNIT 221A	RIO ARRIBA	NM	29N	6W	11		CONOCOPHILLIPS COMPANY	BASIN::FRUITLAND COAL	11	12/1/2004		3/31/2005	3/31/2005
3003927870	SAN JUAN 29-6 UNIT 241A	RIO ARRIBA	NM	29N	6W	19 J		CONOCOPHILLIPS COMPANY	BASIN::FRUITLAND COAL	11	12/17/2004		3/29/2005	3/29/2005
3003929337	SAN JUAN 29-6 UNIT 6C	RIO ARRIBA	NM					CONOCOPHILLIPS COMPANY	BLANCO::MESAVERDE	11				
3003929360	SAN JUAN 29-6 UNIT 55C	RIO ARRIBA	NM					CONOCOPHILLIPS COMPANY	BLANCO::MESAVERDE	11				
3003929231	SAN JUAN 29-6 UNIT 58C	RIO ARRIBA	NM					CONOCOPHILLIPS COMPANY	BLANCO::MESAVERDE	11				
3003927552	SAN JUAN 29-6 UNIT 33F	RIO ARRIBA	NM					CONOCOPHILLIPS COMPANY	BLANCO::MESAVERDE	11				
3003927552	SAN JUAN 29-6 UNIT 33F	RIO ARRIBA	NM					CONOCOPHILLIPS COMPANY	BASIN::DAKOTA	11				
3003929466	SAN JUAN 29-6 UNIT 29C	RIO ARRIBA	NM					CONOCOPHILLIPS COMPANY	BLANCO::MESAVERDE	11				
3003929350	SAN JUAN 29-6 UNIT 54C	RIO ARRIBA	NM					CONOCOPHILLIPS COMPANY	BLANCO::MESAVERDE	11				
3003929359	SAN JUAN 29-6 UNIT 55B	RIO ARRIBA	NM					CONOCOPHILLIPS COMPANY	BLANCO::MESAVERDE	11				
3003929606	SAN JUAN 29-6 UNIT 211A	RIO ARRIBA	NM	29N	6W	20		CONOCOPHILLIPS COMPANY	BASIN::FRUITLAND COAL	11	12/10/2005		1/10/2006	1/10/2006
3003929410	SAN JUAN 29-6 UNIT 14B	RIO ARRIBA	NM					CONOCOPHILLIPS COMPANY	BLANCO::MESAVERDE	11				
3003921440	SAN JUAN 29-6 UNIT 110	RIO ARRIBA	NM					CONOCOPHILLIPS COMPANY	BLANCO::PICTURED CLIFFS	11				
3003929728	SAN JUAN 29-6 UNIT 107F	RIO ARRIBA	NM					CONOCOPHILLIPS COMPANY	BLANCO::MESAVERDE	11				
3003929728	SAN JUAN 29-6 UNIT 107F	RIO ARRIBA	NM					CONOCOPHILLIPS COMPANY	BASIN::DAKOTA	11				
3003930386	SAN JUAN 29-6 UNIT 13C	RIO ARRIBA	NM	29N	6W	6		CONOCOPHILLIPS COMPANY	BLANCO::MESAVERDE	11	4/7/2008		4/7/2008	
3003929522	SAN JUAN 29-6 UNIT	RIO ARRIBA	NM					CONOCOPHILLIPS COMPANY	BLANCO::MESAVERDE	11				
3003929618	SAN JUAN 29-6 UNIT 61B	RIO ARRIBA	NM					CONOCOPHILLIPS COMPANY	BLANCO::MESAVERDE	11				
3003929694	SAN JUAN 29-6 UNIT 74C	RIO ARRIBA	NM					CONOCOPHILLIPS COMPANY	BLANCO::MESAVERDE	11				
3003929563	SAN JUAN 29-6 UNIT 68C	RIO ARRIBA	NM					CONOCOPHILLIPS COMPANY	BLANCO::MESAVERDE	11				
3003929808	SAN JUAN 29-6 UNIT 65C	RIO ARRIBA	NM	29N	6W	19 B		CONOCOPHILLIPS COMPANY	BLANCO::MESAVERDE	11	6/22/2007		6/21/2007	6/27/2007
3003930706	SAN JUAN 29-6 UNIT 4M	RIO ARRIBA	NM	29N	6W	17 F		CONOCOPHILLIPS COMPANY	BASIN::DAKOTA	11	2/2/2010		2/2/2010	3/16/2010
3003930706	SAN JUAN 29-6 UNIT 4M	RIO ARRIBA	NM	29N	6W	17 F		CONOCOPHILLIPS COMPANY	BLANCO::MESAVERDE	11	2/2/2010		2/2/2010	3/16/2010
3003926337	SAN JUAN 29-6 UNIT 100M D	RIO ARRIBA	NM					CONOCOPHILLIPS COMPANY	BASIN::DAKOTA	11				
3003926337	SAN JUAN 29-6 UNIT 100M D	RIO ARRIBA	NM					CONOCOPHILLIPS COMPANY	BLANCO::MESAVERDE	11				
3003930447	SAN JUAN 29-6 UNIT 65B	RIO ARRIBA	NM	29N	6W	19 I		CONOCOPHILLIPS COMPANY	BLANCO::MESAVERDE	11	3/6/2009		6/1/2009	6/1/2009
3003930664	SAN JUAN 29-6 UNIT 5N	RIO ARRIBA	NM	29N	7W	25 H		CONOCOPHILLIPS COMPANY	BASIN::DAKOTA	11	7/28/2010		8/24/2010	8/24/2010
3003930664	SAN JUAN 29-6 UNIT 5N	RIO ARRIBA	NM	29N	7W	25 H		CONOCOPHILLIPS COMPANY	BLANCO::MESAVERDE	11	7/28/2010		8/24/2010	8/24/2010
3003930985	SAN JUAN 29-6 UNIT 61M	RIO ARRIBA	NM	29N	6W	19 K		CONOCOPHILLIPS COMPANY	BASIN::DAKOTA	11	6/2/2011		6/7/2011	6/7/2011
3003930985	SAN JUAN 29-6 UNIT 61M	RIO ARRIBA	NM	29N	6W	19 K		CONOCOPHILLIPS COMPANY	BLANCO::MESAVERDE	11	6/2/2011		6/7/2011	6/7/2011
3003930721	SAN JUAN 29-6 UNIT 101N	RIO ARRIBA	NM	29N	6W	36 H		CONOCOPHILLIPS COMPANY	BASIN::DAKOTA	11	3/25/2010		3/25/2010	5/20/2010
3003930721	SAN JUAN 29-6 UNIT 101N	RIO ARRIBA	NM	29N	6W	36 H		CONOCOPHILLIPS COMPANY	BLANCO::MESAVERDE	11	3/25/2010		3/25/2010	5/20/2010
3003930929	SAN JUAN 29-6 UNIT 20C	RIO ARRIBA	NM	29N	6W	8 L		CONOCOPHILLIPS COMPANY	BASIN::DAKOTA	11	2/8/2011		3/29/2011	3/29/2011
3003930929	SAN JUAN 29-6 UNIT 20C	RIO ARRIBA	NM	29N	6W	8 L		CONOCOPHILLIPS COMPANY	BLANCO::MESAVERDE	11	2/8/2011		2/7/2011	2/7/2011

San Juan 29-6 Unit

R6W

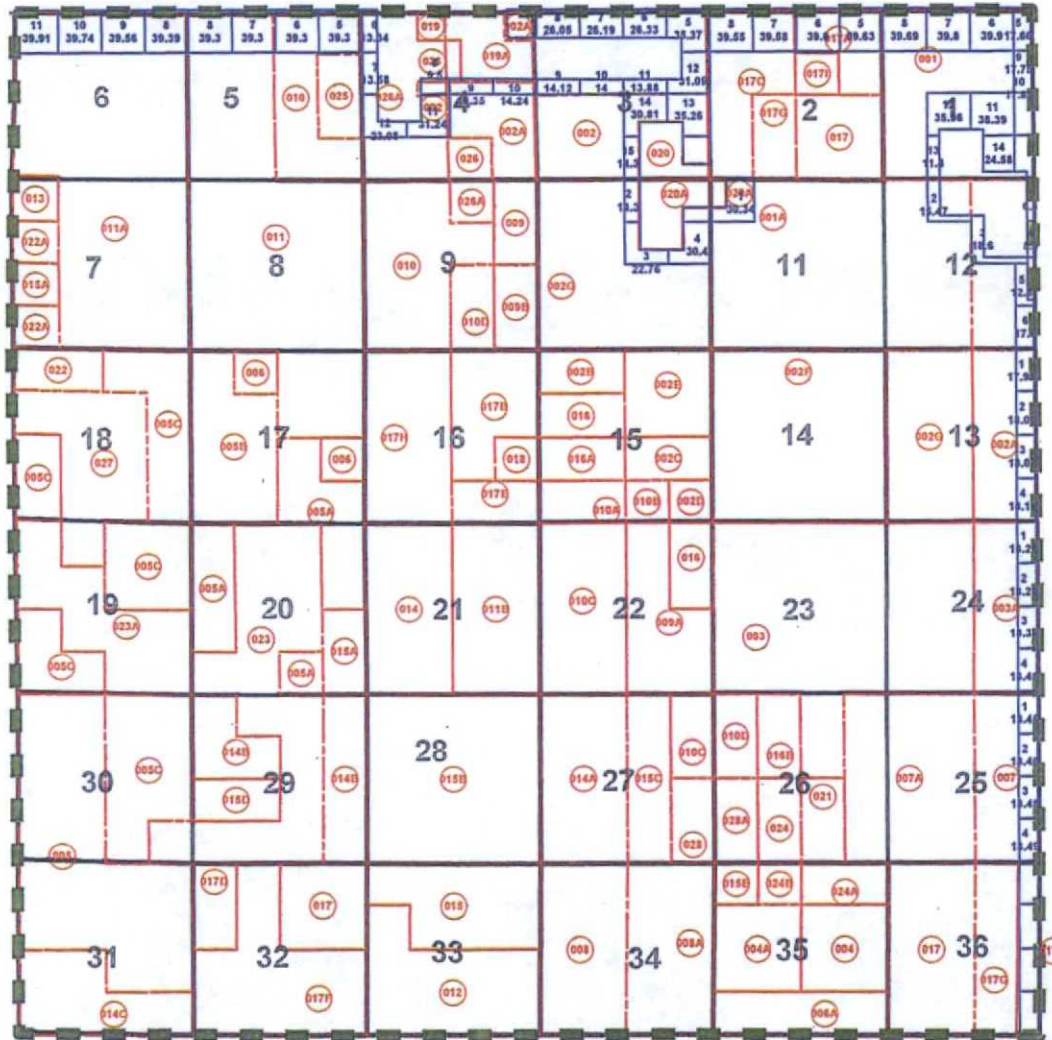

T
29
N



ConocoPhillips
San Juan Business Unit
Land Department
P.O. Box 4289
Farmington, NM 87499-4289

RECEIVED OOD

February 25, 2016

2016 MAR -2 P 2:10

Bureau of Land Management
Farmington Resource Area
6251 College Blvd, Ste A
Farmington, NM 87402

Commissioner of Public Lands
State of New Mexico
PO Box 1148
Santa Fe, NM 87501-1148

Oil Conservation Division
State of New Mexico
1220 S Saint Francis Dr
Santa Fe, NM 87505

RECEIVED
FEB 25 2016
Farmington Field Office
Bureau of Land Management

RE: 2016 Plan of Development
San Juan 29-6 Unit #14-08-001-439
Rio Arriba County, New Mexico

Ladies and Gentlemen:

Approval of this POD
does not constitute
approval of specific APD's

The following Participating Areas currently exist in the San Juan 29-6 Unit:

FORMATION	EXPANSION	EFFECTIVE DATE
DAKOTA "A"	INITIAL	31-DEC-74
DAKOTA	015	01-JUL-11
FRUITLAND COAL	020	01-FEB-04
MESAVERDE	037	01-FEB-88
PICTURED CLIFFS	005	01-JAN-01

R: 204
C: 419

The **2015 Plan of Development** (or amendments thereto) provided for no activity; there is therefore no status update to provide for 2015 development.

Pursuant to Section 10 of the San Juan 29-6 Unit Agreement, ConocoPhillips Company, as Unit Operator, is hereby providing notification that there is no activity currently scheduled for 2016.

The working interest owners are being furnished a copy of this letter, well status listing and enclosed map. ConocoPhillips, as Unit Operator, will drill any offset wells required to prevent drainage of unitized substances and any other wells deemed necessary by the working interest owners or Unit Operator.

In accordance to Section 10 of the Unit Agreement, please provide your approvals by executing and returning a copy of the attached approval page to the undersigned.

Please contact me at (505) 326-9868 if there are any questions regarding this letter.

Sincerely,

Cameron Ming,
Land Supervisor, SE

CM/jmr

xc: San Juan 29-6 Unit, 3.0 (2016)
San Juan 29-6 Unit Working Interest Owners

**SAN JUAN 29-6 UNIT
2016 PLAN OF DEVELOPMENT APPROVALS**

Cynthia Marquez, LLE
Bureau of Land Management

02/26/2016
Date

New Mexico Oil Conservation Division

Date

New Mexico Commissioner of Public Lands

Date

SAN JUAN 29-6 UNIT WORKING INTEREST OWNERS

BETTY T JOHNSTON MARITAL TRUST
BIG SNOWY EXPLORATION LP
BP AMERICA PRODUCTION COMPANY
BURLINGTON RESOURCES O&G CO LP
BURLINGTON RESOURCES O&G SJBT
CHARLES W GAY
CONOCOPHILLIPS COMPANY
EULA MAY JOHNSTON TRUST
GRAYFORE PARTNERS LP
J&M RAYMOND LTD
LORRAYN GAY HACKER
MCELVAIN OIL COMPANY
PGC GAS COMPANY
PHILLIPS NEW MEXICO PARTNERS LP
PHILLIPS SAN JUAN LTD PARTNERSHIP
PINTAIL PRODUCTION CO INC
PRODUCTION GATHERING LLC
RESOURCE DEVELOPMENT TECHNOLOGY LLC
RKC INC
SABLE ENERGY LTD
SAN JUAN BASIN PARTNERSHIP
SAN JUAN BASIN TRUST
T H MCELVAIN OIL & GAS LLLP
T H MCELVAIN OIL AND GAS PROP
TAMACAM LLC
V A JOHNSTON LTD
VAUGHAN-MCELVAIN ENERGY INC
VEVA JEAN GIBBARD
WPX ENERGY INC

San Juan 29-6 Unit

R6W

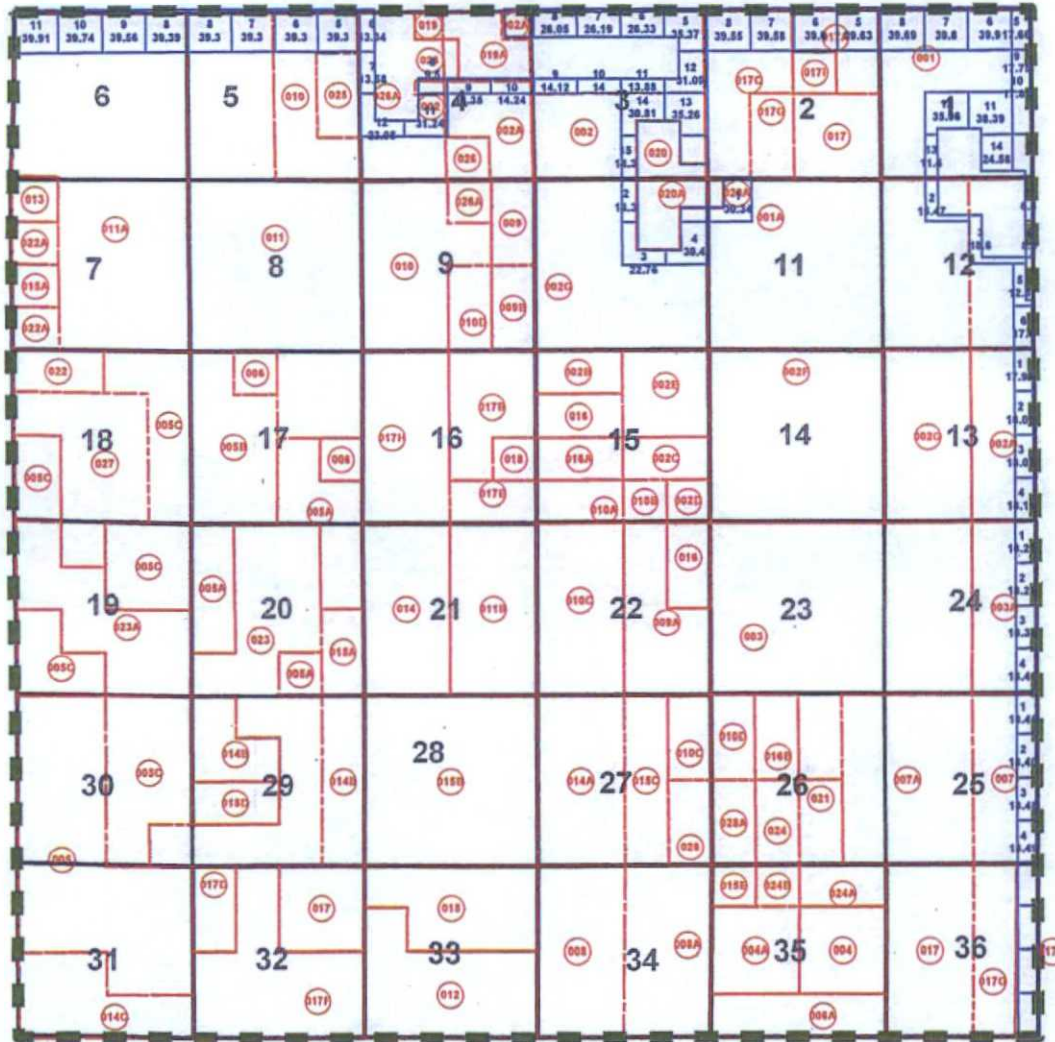

T
29
N

Well Status
San Juan 29-6 Unit
2/25/2016

API	Well Name	Rsvr Name	Production Status	State	County	Township	Range	Section Number	Unit Letter	Oper Name	Spud Date	Completion Date	Initial Production Date	Abandon Date
300390746800	SAN JUAN 29-6 56	BLANCO::MESAVERDE	11	NM	RIO ARRIBA	29N	6W	33	N	CONOCOPHILLIPS COMPANY	2/18/1957			
300390747000	SAN JUAN 29-6 51	BLANCO::MESAVERDE	11	NM	RIO ARRIBA	29N	6W	31	N	CONOCOPHILLIPS COMPANY	12/5/1955	1/6/1956		
300390747000	SAN JUAN 29-6 51	GOBERNADOR:PICTURED CLIFF	11	NM	RIO ARRIBA	29N	6W	31	N	CONOCOPHILLIPS COMPANY	12/5/1955	12/14/1999	12/18/1999	
300390747000	SAN JUAN 29-6 UNIT 51	BLANCO::PICTURED CLIFFS	11	NM	RIO ARRIBA					CONOCOPHILLIPS COMPANY	12/5/1955			
300390747100	SAN JUAN 29-6 16	BLANCO::MESAVERDE	11	NM	RIO ARRIBA	29N	6W	32	N	CONOCOPHILLIPS COMPANY	5/18/1955			
300390747100	SAN JUAN 29-6 16	GOBERNADOR:PICTURED CLIFF	11	NM	RIO ARRIBA	29N	6W	32	N	CONOCOPHILLIPS COMPANY	5/18/1955	11/27/1999	12/1/1999	
300390747100	SAN JUAN 29-6 UNIT 16	BLANCO::PICTURED CLIFFS	11	NM	RIO ARRIBA					CONOCOPHILLIPS COMPANY	5/18/1955			
300390747300	SAN JUAN 29-6 7	BLANCO::MESAVERDE	11	NM	RIO ARRIBA	29N	6W	34	M	CONOCOPHILLIPS COMPANY	11/17/1953			
300390747400	SAN JUAN 29-6 49	BLANCO::MESAVERDE	11	NM	RIO ARRIBA	29N	6W	35	N	CONOCOPHILLIPS COMPANY	7/2/1957			
300390747600	SAN JUAN 29-6 9	BLANCO::MESAVERDE	11	NM	RIO ARRIBA	29N	6W	36	M	CONOCOPHILLIPS COMPANY	6/7/1954			
300390749100	SAN JUAN 29-6 88	BASIN::DAKOTA	11	NM	RIO ARRIBA	29N	6W	33	L	CONOCOPHILLIPS COMPANY	3/27/1965	5/24/1965		
300390749100	SAN JUAN 29-6 88	BLANCO::MESAVERDE	11	NM	RIO ARRIBA	29N	6W	33	L	CONOCOPHILLIPS COMPANY	3/27/1965	3/1/1959	12/31/1999	
300390749100	SAN JUAN 29-6 UNIT NP 88	BLANCO::MESAVERDE	11	NM	RIO ARRIBA					CONOCOPHILLIPS COMPANY	3/1/1965			
300390749200	SAN JUAN 29-6 87	BASIN::DAKOTA	11	NM	RIO ARRIBA	29N	6W	33	H	CONOCOPHILLIPS COMPANY	3/8/1965			
300390749200	SAN JUAN 29-6 87	BLANCO::MESAVERDE	11	NM	RIO ARRIBA	29N	6W	33	H	CONOCOPHILLIPS COMPANY	3/8/1965		8/8/2000	
300390749200	SAN JUAN 29-6 UNIT 87	BLANCO::MESAVERDE	11	NM	RIO ARRIBA					CONOCOPHILLIPS COMPANY	3/8/1965			
300390749500	SAN JUAN 29-6 50	BLANCO::MESAVERDE	11	NM	RIO ARRIBA	29N	6W	36	G	CONOCOPHILLIPS COMPANY	6/9/1958			
300390750000	SAN JUAN 29-6 25	BLANCO::MESAVERDE	11	NM	RIO ARRIBA	29N	6W	32	B	CONOCOPHILLIPS COMPANY	7/9/1955			
300390750000	SAN JUAN 29-6 25	BLANCO S.:PICTURED CLIFFS	11	NM	RIO ARRIBA	29N	6W	32	B	CONOCOPHILLIPS COMPANY	7/9/1955		12/12/2000	
300390750000	SAN JUAN 29-6 UNIT 25	BLANCO S.:PICTURED CLIFF	11	NM	RIO ARRIBA					CONOCOPHILLIPS COMPANY	7/9/1955			
300390750200	SAN JUAN 29-6 48	BLANCO::MESAVERDE	11	NM	RIO ARRIBA	29N	6W	35	A	CONOCOPHILLIPS COMPANY	8/26/1958			
300390750200	SAN JUAN 29-6 UNIT 48	BLANCO::MESAVERDE	11	NM	RIO ARRIBA					CONOCOPHILLIPS COMPANY	6/1/1969			
300390750300	SAN JUAN 29-6 52	BLANCO::MESAVERDE	11	NM	RIO ARRIBA	29N	6W	34	B	CONOCOPHILLIPS COMPANY	12/18/1955		2/27/1956	
300390750400	SAN JUAN 29-6 57	BLANCO::MESAVERDE	11	NM	RIO ARRIBA	29N	6W	33	A	CONOCOPHILLIPS COMPANY	2/25/1956	3/7/1956		
300390750900	SAN JUAN 29-6 53	BLANCO::MESAVERDE	11	NM	RIO ARRIBA	29N	6W	31	B	CONOCOPHILLIPS COMPANY	7/30/1956			
300390750900	SAN JUAN 29-6 53	GOBERNADOR:PICTURED CLIFF	11	NM	RIO ARRIBA	29N	6W	31	B	CONOCOPHILLIPS COMPANY	7/30/1956	12/8/1999	12/14/1999	
300390751600	SAN JUAN 29-6 86	BASIN::DAKOTA	11	NM	RIO ARRIBA	29N	6W	27	N	CONOCOPHILLIPS COMPANY	12/28/1964	3/22/1965		
300390751600	SAN JUAN 29-6 86	BLANCO::MESAVERDE	11	NM	RIO ARRIBA	29N	6W	27	N	CONOCOPHILLIPS COMPANY	12/28/1964	12/11/1999	12/22/1999	
300390751600	SAN JUAN 29-6 UNIT 86	BLANCO::MESAVERDE	11	NM	RIO ARRIBA					CONOCOPHILLIPS COMPANY	12/27/1964			
300390751700	SAN JUAN 29-6 70	BLANCO::MESAVERDE	11	NM	RIO ARRIBA	29N	6W	29	N	CONOCOPHILLIPS COMPANY	5/1/1962			
300390751800	SAN JUAN 29-6 5	BLANCO::MESAVERDE	11	NM	RIO ARRIBA	29N	6W	30	N	CONOCOPHILLIPS COMPANY	7/12/1953	9/15/1953		
300390751900	SAN JUAN 29-6 44	BLANCO::MESAVERDE	11	NM	RIO ARRIBA	29N	6W	26	N	CONOCOPHILLIPS COMPANY	6/20/1957	6/1/1969		

Well Status
San Juan 29-6 Unit
2/25/2016

API	Well Name	Ravr Name	Production Status	State	County	Township	Range	Section Number	Unit Letter	Oper Name	Spud Date	Completion Date	Initial Production Date	Abandon Date
300390752600	SAN JUAN 29-6 46	BLANCO::MESAVERDE	11	NM	RIO ARRIBA	29N	6W	27	K	CONOCOPHILLIPS COMPANY	7/8/1962	9/12/1962	9/12/1962	
300390752700	SAN JUAN 29-6 58	BLANCO::MESAVERDE	11	NM	RIO ARRIBA	29N	6W	28	K	CONOCOPHILLIPS COMPANY	2/12/1958			
300390752700	SAN JUAN 29-6 UNIT 58	BLANCO::MESAVERDE	61	NM	RIO ARRIBA					CONOCOPHILLIPS COMPANY	4/1/1970			
300390752800	SAN JUAN 29-6 81	BASIN::DAKOTA	11	NM	RIO ARRIBA	29N	6W	25	L	CONOCOPHILLIPS COMPANY	11/18/1963	12/1/1963		
300390753000	SAN JUAN 29-6 3	BLANCO::MESAVERDE	11	NM	RIO ARRIBA	29N	6W	25	L	CONOCOPHILLIPS COMPANY	3/11/1953	12/21/1953		
300390753900	SAN JUAN 29-6 45	BLANCO::MESAVERDE	11	NM	RIO ARRIBA	29N	6W	27	H	CONOCOPHILLIPS COMPANY	7/1/1962		7/18/1962	
300390754200	SAN JUAN 29-6 42	BLANCO::MESAVERDE	11	NM	RIO ARRIBA	29N	6W	25	G	CONOCOPHILLIPS COMPANY	5/28/1958			
300390754700	SAN JUAN 29-6 68	BASIN::FRUITLAND COAL	11	NM	RIO ARRIBA	29N	6W	29	A	CONOCOPHILLIPS COMPANY	9/16/1961	9/16/1961	9/27/2002	
300390754700	SAN JUAN 29-6 68	BLANCO::MESAVERDE	11	NM	RIO ARRIBA	29N	6W	29	A	CONOCOPHILLIPS COMPANY	9/16/1961	11/27/1963		
300390754800	SAN JUAN 29-6 69	BASIN::DAKOTA	11	NM	RIO ARRIBA	29N	6W	26	A	CONOCOPHILLIPS COMPANY	10/22/1963	11/27/1963		
300390754900	SAN JUAN 29-6 69	BLANCO::MESAVERDE	11	NM	RIO ARRIBA	29N	6W	26	A	CONOCOPHILLIPS COMPANY	10/22/1963	11/27/1963	9/14/2000	
300390754900	SAN JUAN 29-6 UNIT 69	BLANCO::MESAVERDE	11	NM	RIO ARRIBA					CONOCOPHILLIPS COMPANY	10/22/1963			
300390755000	SAN JUAN 29-6 47	BASIN CB::FRUITLAND COAL	11	NM	RIO ARRIBA	29N	6W	28	B	CONOCOPHILLIPS COMPANY	3/23/1959	7/21/1959	2/24/2003	
300390755000	SAN JUAN 29-6 47	BASIN::DAKOTA	71	NM	RIO ARRIBA	29N	6W	28	B	CONOCOPHILLIPS COMPANY	3/23/1959			1/1/1999
300390755000	SAN JUAN 29-6 47	BLANCO::MESAVERDE	11	NM	RIO ARRIBA	29N	6W	28	B	CONOCOPHILLIPS COMPANY	3/23/1959	6/1/1959		
300390755000	SAN JUAN 29-6 47	BLANCO S::PICTURED CLIFFS	11	NM	RIO ARRIBA	29N	6W	28	B	CONOCOPHILLIPS COMPANY	3/23/1959	7/21/1959	2/28/2001	
300390755100	SAN JUAN 29-6 85	BASIN::DAKOTA	11	NM	RIO ARRIBA	29N	6W	27	A	CONOCOPHILLIPS COMPANY	9/24/1964		7/23/1994	
300390755100	SAN JUAN 29-6 85	BLANCO::MESAVERDE	11	NM	RIO ARRIBA	29N	6W	27	A	CONOCOPHILLIPS COMPANY	9/24/1964		3/25/2002	
300390755100	SAN JUAN 29-6 UNIT 85	BLANCO::MESAVERDE	11	NM	RIO ARRIBA					CONOCOPHILLIPS COMPANY	9/24/1964			
300390755300	SAN JUAN 29-6 63	BLANCO::MESAVERDE	11	NM	RIO ARRIBA	29N	6W	30	A	CONOCOPHILLIPS COMPANY	7/29/1959			
300390755700	SAN JUAN 29-6 76	BASIN::DAKOTA	61	NM	RIO ARRIBA	29N	6W	23	N	CONOCOPHILLIPS COMPANY	10/14/1963	10/14/1963		
300390755700	SAN JUAN 29-6 76	BASIN::PICTURED CLIFFS	11	NM	RIO ARRIBA	29N	6W	23	N	CONOCOPHILLIPS COMPANY	10/14/1963	1/10/2001	1/10/2001	
300390755700	SAN JUAN 29-6 UNIT 76	BLANCO::PICTURED CLIFFS	11	NM	RIO ARRIBA	29N	6W	23		CONOCOPHILLIPS COMPANY	10/14/1963	12/14/2000		
300390755800	SAN JUAN 29-6 72	BLANCO::MESAVERDE	11	NM	RIO ARRIBA	29N	6W	22	M	CONOCOPHILLIPS COMPANY	8/7/1962	9/25/2005		
300390756000	SAN JUAN 29-6 28	BLANCO::MESAVERDE	11	NM	RIO ARRIBA	29N	6W	24	N	CONOCOPHILLIPS COMPANY	2/15/1957			
300390757100	SAN JUAN 29-6 73	BLANCO::MESAVERDE	11	NM	RIO ARRIBA	29N	6W	20	L	CONOCOPHILLIPS COMPANY	11/11/1962	12/1/1982		
300390757200	SAN JUAN 29-6 27	BLANCO::MESAVERDE	11	NM	RIO ARRIBA	29N	6W	23	K	CONOCOPHILLIPS COMPANY	1/27/1957	3/25/1957	3/25/1957	
300390757300	SAN JUAN 29-6 6	BLANCO::MESAVERDE	11	NM	RIO ARRIBA	29N	6W	21	K	CONOCOPHILLIPS COMPANY	7/16/1953	8/10/1953		
300390757700	SAN JUAN 29-6 61	BLANCO::MESAVERDE	11	NM	RIO ARRIBA	29N	6W	19	K	CONOCOPHILLIPS COMPANY	7/1/1958	9/5/1958		
300390757800	SAN JUAN 29-6 78	BASIN::DAKOTA	61	NM	RIO ARRIBA	29N	6W	11	L	CONOCOPHILLIPS COMPANY	9/2/1964		7/22/1994	
300390757800	SAN JUAN 29-6 78	BLANCO::MESAVERDE	11	NM	RIO ARRIBA	29N	6W	11	L	CONOCOPHILLIPS COMPANY	9/2/1964		1/13/2000	
300390757800	SAN JUAN 29-6 UNIT 78	BLANCO::MESAVERDE	11	NM	RIO ARRIBA	29N	6W	22		CONOCOPHILLIPS COMPANY	9/2/1964			

Well Status
San Juan 29-6 Unit
2/25/2016

API	Well Name	Rsvr Name	Production Status	State	County	Township	Range	Section Number	Unit Letter	Oper Name	Spud Date	Completion Date	Initial Production Date	Abandon Date
300390757900	SAN JUAN 29-6 75	BASIN::DAKOTA	11	NM	RIO ARRIBA	29N	6W	23	H	CONOCOPHILLIPS COMPANY	10/12/1963			
300390758100	SAN JUAN 29-6 77	BASIN::DAKOTA	11	NM	RIO ARRIBA	29N	6W	22	H	CONOCOPHILLIPS COMPANY	11/14/1963	12/1/1963		
300390758100	SAN JUAN 29-6 77	BLANCO::MESAVERDE	11	NM	RIO ARRIBA	29N	6W	22	H	CONOCOPHILLIPS COMPANY	11/14/1963	12/1/1963	1/7/2000	
300390758100	SAN JUAN 29-6 UNIT 77	BLANCO::MESAVERDE	11	NM	RIO ARRIBA					CONOCOPHILLIPS COMPANY	11/14/1963			
300390758200	SAN JUAN 29-6 91	BASIN::DAKOTA	72	NM	RIO ARRIBA	29N	6W	21	H	CONOCOPHILLIPS COMPANY	6/16/1965	8/3/1965		5/28/2002
300390758400	SAN JUAN 29-6 74	BLANCO::MESAVERDE	11	NM	RIO ARRIBA	29N	6W	20	H	CONOCOPHILLIPS COMPANY	12/14/1962			
300390758500	SAN JUAN 29-6 40	BLANCO::MESAVERDE	11	NM	RIO ARRIBA	29N	6W	23	H	CONOCOPHILLIPS COMPANY	1/11/1957			
300390758900	SAN JUAN 29-6 39	BLANCO::MESAVERDE	11	NM	RIO ARRIBA	29N	6W	22	B	CONOCOPHILLIPS COMPANY	10/31/1962	12/11/1962		
300390759100	SAN JUAN 29-6 41	BLANCO::MESAVERDE	11	NM	RIO ARRIBA	29N	6W	24	B	CONOCOPHILLIPS COMPANY	5/18/1958		6/25/1958	
300390759200	SAN JUAN 29-6 24	BLANCO::MESAVERDE	72	NM	RIO ARRIBA	29N	6W	21	A	CONOCOPHILLIPS COMPANY	6/18/1955	8/8/1955		5/19/1997
300390759400	SAN JUAN 29-6 65	BLANCO::MESAVERDE	11	NM	RIO ARRIBA	29N	6W	19	A	CONOCOPHILLIPS COMPANY	6/12/1960			
300390760300	SAN JUAN 29-6 94	BASIN::DAKOTA	11	NM	RIO ARRIBA	29N	6W	16	M	CONOCOPHILLIPS COMPANY	9/22/1965			
300390760300	SAN JUAN 29-6 94	BLANCO::MESAVERDE	11	NM	RIO ARRIBA	29N	6W	16	M	CONOCOPHILLIPS COMPANY	9/22/1965		7/3/2000	
300390760300	SAN JUAN 29-6 UNIT 94	BLANCO::MESAVERDE	11	NM	RIO ARRIBA					CONOCOPHILLIPS COMPANY	9/1/1965			
300390760400	SAN JUAN 29-6 83	BASIN::DAKOTA	11	NM	RIO ARRIBA	29N	6W	13	M	CONOCOPHILLIPS COMPANY	7/26/1964	8/1/1964		
300390760400	SAN JUAN 29-6 83	BLANCO::MESAVERDE	11	NM	RIO ARRIBA	29N	6W	13	M	CONOCOPHILLIPS COMPANY	7/26/1964	10/2/1964	8/1/2000	
300390760400	SAN JUAN 29-6 UNIT 83	BLANCO::MESAVERDE	11	NM	RIO ARRIBA					CONOCOPHILLIPS COMPANY	7/26/1964			
300390760500	SAN JUAN 29-6 2	BLANCO::MESAVERDE	11	NM	RIO ARRIBA	29N	6W	14	M	CONOCOPHILLIPS COMPANY	1/24/1953			
300390760600	SAN JUAN 29-6 38	BLANCO::MESAVERDE	11	NM	RIO ARRIBA	29N	6W	16	N	CONOCOPHILLIPS COMPANY	5/14/1962	5/28/1962	5/28/1962	
300390761100	SAN JUAN 29-6 26	BLANCO::MESAVERDE	11	NM	RIO ARRIBA	29N	6W	13	K	CONOCOPHILLIPS COMPANY	12/22/1956			
300390761300	SAN JUAN 29-6 55	BLANCO::MESAVERDE	11	NM	RIO ARRIBA	29N	6W	18	K	CONOCOPHILLIPS COMPANY	7/13/1957			
300390762100	SAN JUAN 29-6 60	BLANCO::MESAVERDE	11	NM	RIO ARRIBA	29N	6W	18	H	CONOCOPHILLIPS COMPANY	6/19/1958	8/6/1958		
300390762200	SAN JUAN 29-6 90	BASIN::DAKOTA	11	NM	RIO ARRIBA	29N	6W	15	G	CONOCOPHILLIPS COMPANY	5/29/1965	6/30/1965		
300390762200	SAN JUAN 29-6 90	BLANCO::MESAVERDE	11	NM	RIO ARRIBA	29N	6W	15	G	CONOCOPHILLIPS COMPANY	5/29/1965	6/30/1965	7/17/2000	
300390762200	SAN JUAN 29-6 UNIT 90	BLANCO::MESAVERDE	11	NM	RIO ARRIBA					CONOCOPHILLIPS COMPANY	5/29/1965			
300390762300	SAN JUAN 29-6 84	BASIN::DAKOTA	11	NM	RIO ARRIBA	29N	6W	14	G	CONOCOPHILLIPS COMPANY	8/15/1964	9/1/1964		
300390762300	SAN JUAN 29-6 84	BLANCO::MESAVERDE	11	NM	RIO ARRIBA	29N	6W	14	G	CONOCOPHILLIPS COMPANY	8/15/1964	9/1/1964	8/28/2000	
300390762300	SAN JUAN 29-6 UNIT 84	BLANCO::MESAVERDE	11	NM	RIO ARRIBA					CONOCOPHILLIPS COMPANY	8/15/1964			
300390762400	SAN JUAN 29-6 36	BLANCO::MESAVERDE	72	NM	RIO ARRIBA	29N	6W	15	H	CONOCOPHILLIPS COMPANY	3/2/1961			3/31/2006
300390762800	SAN JUAN 29-6 34	BLANCO::MESAVERDE	11	NM	RIO ARRIBA	29N	6W	14	A	CONOCOPHILLIPS COMPANY	3/5/1957			
300390762900	SAN JUAN 29-6 93	BASIN::DAKOTA	11	NM	RIO ARRIBA	29N	6W	16	B	CONOCOPHILLIPS COMPANY	9/2/1965	9/1/1965		
300390762900	SAN JUAN 29-6 93	BLANCO::MESAVERDE	11	NM	RIO ARRIBA	29N	6W	16	B	CONOCOPHILLIPS COMPANY	9/2/1965	9/1/1965	6/23/2000	

Well Status
San Juan 29-6 Unit
2/25/2016

API	Well Name	Rsvr Name	Production Status	State	County	Township	Range	Section Number	Unit Letter	Oper Name	Spud Date	Completion Date	Initial Production Date	Abandon Date
300390762900	SAN JUAN 29-6 UNIT 93	BLANCO::MESAVERDE	11	NM	RIO ARRIBA					CONOCOPHILLIPS COMPANY	9/2/1965			
300390763100	SAN JUAN 29-6 37	BLANCO::MESAVERDE	11	NM	RIO ARRIBA	29N	6W	16	A	CONOCOPHILLIPS COMPANY	11/9/1959			
300390763400	SAN JUAN 29-6 71	BLANCO::MESAVERDE	11	NM	RIO ARRIBA	29N	6W	17	B	CONOCOPHILLIPS COMPANY	8/29/1962	9/14/1962		
300390763600	SAN JUAN 29-6 UNIT 33	BASIN::DAKOTA	11	NM	RIO ARRIBA	29N	6W	13	B	CONOCOPHILLIPS COMPANY	7/27/1959	9/28/1959		
300390763600	SAN JUAN 29-6 UNIT 33	BLANCO::MESAVERDE	11	NM	RIO ARRIBA	29N	6W	13	B	CONOCOPHILLIPS COMPANY	7/27/1959	9/28/1959		
300390763900	SAN JUAN 29-6 31	BLANCO::MESAVERDE	11	NM	RIO ARRIBA	29N	6W	10	M	CONOCOPHILLIPS COMPANY	4/4/1961			
300390764000	SAN JUAN 29-6 11	BLANCO::MESAVERDE	11	NM	RIO ARRIBA	29N	6W	7	M	CONOCOPHILLIPS COMPANY	11/4/1954	11/24/1954		
300390764100	SAN JUAN 29-6 89	BASIN::DAKOTA	11	NM	RIO ARRIBA	29N	6W	11	M	CONOCOPHILLIPS COMPANY	5/8/1965	6/18/1965		
300390764600	SAN JUAN 29-6 92	BASIN::DAKOTA	11	NM	RIO ARRIBA	29N	6W	12	M	CONOCOPHILLIPS COMPANY	8/10/1965	9/24/1965		
300390764600	SAN JUAN 29-6 92	BLANCO::MESAVERDE	11	NM	RIO ARRIBA	29N	6W	12	M	CONOCOPHILLIPS COMPANY	8/10/1965	8/10/2000	8/10/2000	
300390764600	SAN JUAN 29-6 UNIT 92	BLANCO::MESAVERDE	11	NM	RIO ARRIBA					CONOCOPHILLIPS COMPANY	8/10/1965			
300390765100	SAN JUAN 29-6 32	BLANCO::MESAVERDE	11	NM	RIO ARRIBA	29N	6W	11	L	CONOCOPHILLIPS COMPANY	1/22/1956			
300390765200	SAN JUAN 29-6 20	BLANCO::MESAVERDE	72	NM	RIO ARRIBA	29N	6W	8	K	CONOCOPHILLIPS COMPANY	7/6/1955	10/9/1955		7/9/2012
300390765200	SAN JUAN 29-6 UNIT	BLANCO::MESAVERDE	72	NM	RIO ARRIBA					CONOCOPHILLIPS COMPANY	6/1/1969			
300390766000	SAN JUAN 29-6 66	BLANCO::MESAVERDE	11	NM	RIO ARRIBA	29N	6W	9	K	CONOCOPHILLIPS COMPANY	3/15/1961			
300390766300	SAN JUAN 29-6 30	BLANCO::MESAVERDE	11	NM	RIO ARRIBA	29N	6W	10	H	CONOCOPHILLIPS COMPANY	5/30/1962			
300390766600	SAN JUAN 29-6 64	BLANCO::MESAVERDE	11	NM	RIO ARRIBA	29N	6W	9	G	CONOCOPHILLIPS COMPANY	6/29/1960	8/30/1960	8/30/1960	
300390767300	SAN JUAN 29-6 14	BLANCO::MESAVERDE	72	NM	RIO ARRIBA	29N	6W	7	B	CONOCOPHILLIPS COMPANY	11/6/1952			8/31/2015
300390767400	SAN JUAN 29-6 21	BLANCO::MESAVERDE	11	NM	RIO ARRIBA	29N	6W	11	A	CONOCOPHILLIPS COMPANY	6/22/1955			
300390767500	SAN JUAN 29-6 19	BLANCO::MESAVERDE	72	NM	RIO ARRIBA	29N	6W	8	B	CONOCOPHILLIPS COMPANY	6/7/1955	8/25/1955		8/24/1999
300390767500	SAN JUAN 29-6 UNIT 19	BLANCO::MESAVERDE	71	NM	RIO ARRIBA	29N	6W	8		CONOCOPHILLIPS COMPANY	6/1/1969	1/1/1970	1/1/1970	8/23/1999
300390767600	SAN JUAN 29-6 22	BLANCO::MESAVERDE	11	NM	RIO ARRIBA	29N	6W	12	B	CONOCOPHILLIPS COMPANY	7/4/1955			
300390768600	SAN JUAN 29-6 29	BLANCO::MESAVERDE	11	NM	RIO ARRIBA	29N	6W	3	N	CONOCOPHILLIPS COMPANY	5/5/1958			
300390769201	SAN JUAN 29-6 15	BLANCO::MESAVERDE	11	NM	RIO ARRIBA	29N	6W	2	K	CONOCOPHILLIPS COMPANY	5/17/1955	11/10/1996	12/28/1996	
300390769300	SAN JUAN 29-6 13	BLANCO::MESAVERDE	11	NM	RIO ARRIBA	29N	6W	6	L	CONOCOPHILLIPS COMPANY	11/2/1952			
300390769500	SAN JUAN 29-6 54	BLANCO::MESAVERDE	11	NM	RIO ARRIBA	29N	6W	4	K	CONOCOPHILLIPS COMPANY	3/10/1957			
300390769800	SAN JUAN 29-6 59	BLANCO::MESAVERDE	11	NM	RIO ARRIBA	29N	6W	5	H	CONOCOPHILLIPS COMPANY	3/23/1958			
300390769900	SAN JUAN 29-6 12	BLANCO::MESAVERDE	11	NM	RIO ARRIBA	29N	6W	6	H	CONOCOPHILLIPS COMPANY	4/25/1952			
300390770100	SAN JUAN 29-6 62	BLANCO::MESAVERDE	11	NM	RIO ARRIBA	29N	6W	4	A	CONOCOPHILLIPS COMPANY	7/5/1959			
300390770200	SAN JUAN 29-6 17	BLANCO::MESAVERDE	72	NM	RIO ARRIBA	29N	6W	1	B	CONOCOPHILLIPS COMPANY	5/29/1955	12/15/1998		7/22/2013
300390770301	SAN JUAN 29-6 10	BLANCO::MESAVERDE	11	NM	RIO ARRIBA	29N	6W	2	B	CONOCOPHILLIPS COMPANY	9/20/1954	10/24/1996	11/14/1996	
300390770400	SAN JUAN 29-6 1	BLANCO::MESAVERDE	11	NM	RIO ARRIBA	29N	6W	3	A	CONOCOPHILLIPS COMPANY	10/22/1952		2/28/1953	

Well Status
San Juan 29-6 Unit
2/25/2016

API	Well Name	Rsvr Name	Production Status	State	County	Township	Range	Section Number	Unit Letter	Oper Name	Spud Date	Completion Date	Initial Production Date	Abandon Date
300390807700	SAN JUAN 29-6 80	BASIN::DAKOTA	11	NM	RIO ARRIBA	29N	6W	24	H	CONOCOPHILLIPS COMPANY	6/15/1966			
300390807700	SAN JUAN 29-6 80	BLANCO::MESAVERDE	11	NM	RIO ARRIBA	29N	6W	24	H	CONOCOPHILLIPS COMPANY	6/15/1966		2/14/2001	
300390807700	SAN JUAN 29-6 UNIT 80	BLANCO::MESAVERDE	11	NM	RIO ARRIBA					CONOCOPHILLIPS COMPANY	6/15/1966			
300392002700	SAN JUAN 29-6 95	BASIN::DAKOTA	11	NM	RIO ARRIBA	29N	6W	34	L	CONOCOPHILLIPS COMPANY	5/13/1967	6/21/1967		
300392002700	SAN JUAN 29-6 95	BLANCO::MESAVERDE	11	NM	RIO ARRIBA	29N	6W	34	L	CONOCOPHILLIPS COMPANY	5/13/1967	5/17/2001	5/29/2001	
300392002700	SAN JUAN 29-6 UNIT 95	BLANCO::MESAVERDE	11	NM	RIO ARRIBA					CONOCOPHILLIPS COMPANY	5/13/1967			
300392022500	SAN JUAN 29-6 79	BASIN::DAKOTA	11	NM	RIO ARRIBA	29N	6W	24	M	CONOCOPHILLIPS COMPANY	6/24/1969			
300392022500	SAN JUAN 29-6 79	BLANCO::MESAVERDE	11	NM	RIO ARRIBA	29N	6W	24	M	CONOCOPHILLIPS COMPANY	6/24/1969		7/17/2000	
300392022500	SAN JUAN 29-6 UNIT 79	BLANCO::MESAVERDE	11	NM	RIO ARRIBA					CONOCOPHILLIPS COMPANY	6/24/1969			
300392024100	SAN JUAN 29-6 97	BASIN::DAKOTA	11	NM	RIO ARRIBA	29N	6W	35	M	CONOCOPHILLIPS COMPANY	7/26/1969			
300392024100	SAN JUAN 29-6 97	BLANCO::MESAVERDE	11	NM	RIO ARRIBA	29N	6W	35	M	CONOCOPHILLIPS COMPANY	7/26/1969		7/14/2000	
300392024100	SAN JUAN 29-6 UNIT 97	BLANCO::MESAVERDE	11	NM	RIO ARRIBA					CONOCOPHILLIPS COMPANY	7/26/1969			
300392029700	SAN JUAN 29-6 98	BASIN::DAKOTA	11	NM	RIO ARRIBA	29N	6W	26	K	CONOCOPHILLIPS COMPANY	2/20/1970	10/11/2000		
300392029700	SAN JUAN 29-6 98	BLANCO::MESAVERDE	11	NM	RIO ARRIBA	29N	6W	26	K	CONOCOPHILLIPS COMPANY	2/20/1970		10/11/2000	
300392029700	SAN JUAN 29-6 UNIT 98	BLANCO::MESAVERDE	11	NM	RIO ARRIBA					CONOCOPHILLIPS COMPANY	2/20/1970			
300392029800	SAN JUAN 29-6 99	BASIN::DAKOTA	11	NM	RIO ARRIBA	29N	6W	34	A	CONOCOPHILLIPS COMPANY	3/15/1970			
300392029800	SAN JUAN 29-6 99	BLANCO::MESAVERDE	11	NM	RIO ARRIBA	29N	6W	34	A	CONOCOPHILLIPS COMPANY	3/15/1970		7/26/2000	
300392029800	SAN JUAN 29-6 UNIT 99	BLANCO::MESAVERDE	11	NM	RIO ARRIBA					CONOCOPHILLIPS COMPANY	3/15/1970			
300392029900	SAN JUAN 29-6 100	BASIN::DAKOTA	11	NM	RIO ARRIBA	29N	6W	35	G	CONOCOPHILLIPS COMPANY	3/4/1970			
300392029900	SAN JUAN 29-6 100	BLANCO::MESAVERDE	11	NM	RIO ARRIBA	29N	6W	35	G	CONOCOPHILLIPS COMPANY	3/4/1970		10/21/2000	
300392029900	SAN JUAN 29-6 UNIT 100	BLANCO::MESAVERDE	11	NM	RIO ARRIBA					CONOCOPHILLIPS COMPANY	3/4/1970			
300392035500	SAN JUAN 29-6 101	BASIN::DAKOTA	11	NM	RIO ARRIBA	29N	6W	36	B	CONOCOPHILLIPS COMPANY	2/15/1971			
300392035700	SAN JUAN 29-6 82	BASIN::DAKOTA	11	NM	RIO ARRIBA	29N	6W	25	B	CONOCOPHILLIPS COMPANY	3/14/1971			
300392035700	SAN JUAN 29-6 82	BLANCO::MESAVERDE	11	NM	RIO ARRIBA	29N	6W	25	B	CONOCOPHILLIPS COMPANY	3/14/1971		8/30/2000	
300392035700	SAN JUAN 29-6 UNIT 82	BLANCO::MESAVERDE	11	NM	RIO ARRIBA					CONOCOPHILLIPS COMPANY	3/14/1971			
300392035900	SAN JUAN 29-6 103	BASIN::DAKOTA	11	NM	RIO ARRIBA	29N	6W	11	G	CONOCOPHILLIPS COMPANY	3/28/1971			
300392035900	SAN JUAN 29-6 103	BLANCO::MESAVERDE	11	NM	RIO ARRIBA	29N	6W	11	G	CONOCOPHILLIPS COMPANY	3/28/1971		8/10/2000	
300392035900	SAN JUAN 29-6 UNIT 103	BLANCO::MESAVERDE	11	NM	RIO ARRIBA					CONOCOPHILLIPS COMPANY	3/28/1971			
300392036500	SAN JUAN 29-6 102	BASIN::DAKOTA	11	NM	RIO ARRIBA	29N	6W	10	G	CONOCOPHILLIPS COMPANY	4/10/1971			
300392036500	SAN JUAN 29-6 102	BLANCO::MESAVERDE	11	NM	RIO ARRIBA	29N	6W	10	G	CONOCOPHILLIPS COMPANY	4/10/1971		1/11/2001	
300392036500	SAN JUAN 29-6 UNIT 102	BLANCO::MESAVERDE	11	NM	RIO ARRIBA					CONOCOPHILLIPS COMPANY	4/10/1971			
300392042500	SAN JUAN 29-6 8Y	BLANCO::MESAVERDE	11	NM	RIO ARRIBA	29N	6W	11	L	CONOCOPHILLIPS COMPANY	10/19/1971			

Well Status
San Juan 29-6 Unit
2/25/2016

API	Well Name	Rsvr Name	Production Status	State	County	Township	Range	Section Number	Unit Letter	Oper Name	Spud Date	Completion Date	Initial Production Date	Abandon Date
300392045300	SAN JUAN 29-6 107	BASIN::DAKOTA	11	NM	RIO ARRIBA	29N	6W	36	M	CONOCOPHILLIPS COMPANY	4/20/1972			
300392049000	SAN JUAN 29-6 104	BASIN::DAKOTA	11	NM	RIO ARRIBA	29N	6W	14	N	CONOCOPHILLIPS COMPANY	4/8/1972			
300392049000	SAN JUAN 29-6 104	BLANCO::MESAVERDE	11	NM	RIO ARRIBA	29N	6W	14	N	CONOCOPHILLIPS COMPANY	4/8/1972		8/28/2000	
300392049000	SAN JUAN 29-6 UNIT 104	BLANCO::MESAVERDE	11	NM	RIO ARRIBA					CONOCOPHILLIPS COMPANY	4/8/1972			
300392051300	SAN JUAN 29-6 4Y	BLANCO::MESAVERDE	11	NM	RIO ARRIBA	29N	6W	17	M	CONOCOPHILLIPS COMPANY	9/15/1972			
300392103900	SAN JUAN 29-6 106	BASIN::DAKOTA	11	NM	RIO ARRIBA	29N	6W	31	M	CONOCOPHILLIPS COMPANY	12/8/1974			
300392103900	SAN JUAN 29-6 108	BLANCO::MESAVERDE	11	NM	RIO ARRIBA	29N	6W	31	M	CONOCOPHILLIPS COMPANY	12/8/1974		9/18/1999	
300392103900	SAN JUAN 29-6 UNIT 106	BLANCO::MESAVERDE	11	NM	RIO ARRIBA					CONOCOPHILLIPS COMPANY	7/13/1999	8/14/1999	8/14/1999	
300392108500	SAN JUAN 29-6 56A	BLANCO::MESAVERDE	11	NM	RIO ARRIBA	29N	6W	33	C	CONOCOPHILLIPS COMPANY	9/14/1975			
300392108600	SAN JUAN 29-6 53A	BLANCO::MESAVERDE	11	NM	RIO ARRIBA	29N	6W	31	O	CONOCOPHILLIPS COMPANY	8/2/1975			
300392108600	SAN JUAN 29-6 53A	GOBERNADOR:PICTURED CLIFF	11	NM	RIO ARRIBA	29N	6W	31	O	CONOCOPHILLIPS COMPANY	8/2/1975	7/29/1999	8/3/1999	
300392108600	SAN JUAN 29-6 UNIT 53A	BLANCO::PICTURED CLIFFS	11	NM	RIO ARRIBA					CONOCOPHILLIPS COMPANY	4/1/1975			
300392108700	SAN JUAN 29-6 57A	BLANCO::MESAVERDE	11	NM	RIO ARRIBA	29N	6W	33	P	CONOCOPHILLIPS COMPANY	9/1/1975			
300392108800	SAN JUAN 29-6 51A	BASIN::PICTURED CLIFFS	11	NM	RIO ARRIBA	29N	6W	31	D	CONOCOPHILLIPS COMPANY	7/5/1975	8/18/1999	8/23/1999	
300392108800	SAN JUAN 29-6 51A	BLANCO::MESAVERDE	11	NM	RIO ARRIBA	29N	6W	31	D	CONOCOPHILLIPS COMPANY	7/5/1975			
300392108800	SAN JUAN 29-6 UNIT 51A	BLANCO::PICTURED CLIFFS	11	NM	RIO ARRIBA					CONOCOPHILLIPS COMPANY	3/1/1975			
300392108900	SAN JUAN 29-6 63A	BLANCO::MESAVERDE	11	NM	RIO ARRIBA	29N	6W	30	P	CONOCOPHILLIPS COMPANY	6/21/1975	7/4/1975		
300392109000	SAN JUAN 29-6 16A	BLANCO::MESAVERDE	11	NM	RIO ARRIBA	29N	6W	32	D	CONOCOPHILLIPS COMPANY	6/9/1975			
300392109100	SAN JUAN 29-6 88A	BLANCO::MESAVERDE	11	NM	RIO ARRIBA	29N	6W	29	O	CONOCOPHILLIPS COMPANY	5/26/1975			
300392109200	SAN JUAN 29-6 25A	BLANCO::MESAVERDE	11	NM	RIO ARRIBA	29N	6W	32	O	CONOCOPHILLIPS COMPANY	8/17/1975			
300392109200	SAN JUAN 29-6 25A	BLANCO S::PICTURED CLIFFS	11	NM	RIO ARRIBA	29N	6W	32	O	CONOCOPHILLIPS COMPANY	8/17/1975		12/22/2000	
300392111800	SAN JUAN 29-6 29A	BLANCO::MESAVERDE	11	NM	RIO ARRIBA	29N	6W	3	F	CONOCOPHILLIPS COMPANY	11/16/1975			
300392111900	SAN JUAN 29-6 10A	BLANCO::MESAVERDE	11	NM	RIO ARRIBA	29N	6W	2	P	CONOCOPHILLIPS COMPANY	10/15/1975			
300392112000	SAN JUAN 29-6 15A	BLANCO::MESAVERDE	11	NM	RIO ARRIBA	29N	6W	2	C	CONOCOPHILLIPS COMPANY	10/28/1975			
300392112100	SAN JUAN 29-6 2A	BLANCO::MESAVERDE	11	NM	RIO ARRIBA	29N	6W	14	F	CONOCOPHILLIPS COMPANY	10/14/1975		11/1/1975	
300392112200	SAN JUAN 29-6 34A	BLANCO::MESAVERDE	11	NM	RIO ARRIBA	29N	6W	14	I	CONOCOPHILLIPS COMPANY	9/28/1975			
300392112300	SAN JUAN 29-6 8A	BLANCO::MESAVERDE	11	NM	RIO ARRIBA	29N	6W	1	F	CONOCOPHILLIPS COMPANY	10/2/1975			
300392112400	SAN JUAN 29-6 1A	BLANCO::MESAVERDE	11	NM	RIO ARRIBA	29N	6W	3	P	CONOCOPHILLIPS COMPANY	11/11/1975			
300392112600	SAN JUAN 29-6 62A	BLANCO::MESAVERDE	11	NM	RIO ARRIBA	29N	6W	4	P	CONOCOPHILLIPS COMPANY	11/1/1975			
300392122400	SAN JUAN 29-6 38A	BLANCO::MESAVERDE	11	NM	RIO ARRIBA	29N	6W	16	D	CONOCOPHILLIPS COMPANY	6/10/1978			
300392122500	SAN JUAN 29-6 37A	BLANCO::MESAVERDE	11	NM	RIO ARRIBA	29N	6W	16	P	CONOCOPHILLIPS COMPANY	6/15/1976			
300392122600	SAN JUAN 29-6 55A	BLANCO::MESAVERDE	72	NM	RIO ARRIBA	29N	6W	18	C	CONOCOPHILLIPS COMPANY	8/8/1976	9/9/1976	12/1/1994	8/29/2011

Well Status
San Juan 29-6 Unit
2/25/2016

API	Well Name	Rsvr Name	Production Status	State	County	Township	Range	Section Number	Unit Letter	Oper Name	Spud Date	Completion Date	Initial Production Date	Abandon Date
300392122600	SAN JUAN 29-6 UNIT 55A	BLANCO::MESAVERDE	41	NM	RIO ARRIBA					CONOCOPHILLIPS COMPANY	8/1/1976			
300392122700	SAN JUAN 29-6 60A	BLANCO::MESAVERDE	11	NM	RIO ARRIBA	29N	6W	18	J	CONOCOPHILLIPS COMPANY	8/25/1976			
300392122800	SAN JUAN 29-6 4A	BLANCO::MESAVERDE	11	NM	RIO ARRIBA	29N	6W	17	E	CONOCOPHILLIPS COMPANY	9/10/1976			
300392122900	SAN JUAN 29-6 71A	BLANCO::MESAVERDE	11	NM	RIO ARRIBA	29N	6W	17	O	CONOCOPHILLIPS COMPANY	9/24/1976			
300392124700	SAN JUAN 29-6 61A	BLANCO::MESAVERDE	11	NM	RIO ARRIBA	29N	6W	19	C	CONOCOPHILLIPS COMPANY	1/8/1977			
300392124800	SAN JUAN 29-6 65A	BLANCO::MESAVERDE	11	NM	RIO ARRIBA	29N	6W	19	J	CONOCOPHILLIPS COMPANY	1/4/1977			
300392124900	SAN JUAN 29-6 73A	BLANCO::MESAVERDE	11	NM	RIO ARRIBA	29N	6W	20	D	CONOCOPHILLIPS COMPANY	12/22/1976			
300392125000	SAN JUAN 29-6 74A	BLANCO::MESAVERDE	11	NM	RIO ARRIBA	29N	6W	20	I	CONOCOPHILLIPS COMPANY	12/8/1976		2/26/1997	
300392125100	SAN JUAN 29-6 6A	BLANCO::MESAVERDE	11	NM	RIO ARRIBA	29N	6W	21	C	CONOCOPHILLIPS COMPANY	7/21/1976			
300392125200	SAN JUAN 29-6 24A	BLANCO::MESAVERDE	11	NM	RIO ARRIBA	29N	6W	21	O	CONOCOPHILLIPS COMPANY	11/15/1976			
300392126100	SAN JUAN 29-6 47A	BLANCO::MESAVERDE	11	NM	RIO ARRIBA	29N	6W	28	O	CONOCOPHILLIPS COMPANY	12/10/1976			
300392126200	SAN JUAN 29-6 58A	BASIN CB::FRUITLAND COAL	11	NM	RIO ARRIBA	29N	6W	28	D	CONOCOPHILLIPS COMPANY	12/21/1976	1/23/2004	2/16/2004	
300392126200	SAN JUAN 29-6 58A	BLANCO::MESAVERDE	11	NM	RIO ARRIBA	29N	6W	28	D	CONOCOPHILLIPS COMPANY	12/21/1976	1/21/1977	1/21/1977	
300392126300	SAN JUAN 29-6 70A	BASIN CB::FRUITLAND COAL	11	NM	RIO ARRIBA	29N	6W	29	E	CONOCOPHILLIPS COMPANY	11/23/1976		9/1/2004	
300392126300	SAN JUAN 29-6 70A	BLANCO::MESAVERDE	11	NM	RIO ARRIBA	29N	6W	29	E	CONOCOPHILLIPS COMPANY	11/23/1976	12/15/1976		
300392126400	SAN JUAN 29-6 5A	BLANCO::MESAVERDE	11	NM	RIO ARRIBA	29N	6W	30	F	CONOCOPHILLIPS COMPANY	11/3/1976	12/2/1976		
300392128700	SAN JUAN 29-6 46A	BLANCO::MESAVERDE	11	NM	RIO ARRIBA	29N	6W	27	D	CONOCOPHILLIPS COMPANY	11/26/1976			
300392131100	SAN JUAN 29-6 9A	BLANCO::MESAVERDE	11	NM	RIO ARRIBA	29N	6W	36	E	CONOCOPHILLIPS COMPANY	1/15/1977	2/8/1977		
300392131200	SAN JUAN 29-6 50A	BLANCO::MESAVERDE	11	NM	RIO ARRIBA	29N	6W	38	J	CONOCOPHILLIPS COMPANY	2/7/1977			
300392131500	SAN JUAN 29-6 49A	BLANCO::MESAVERDE	11	NM	RIO ARRIBA	29N	6W	35	E	CONOCOPHILLIPS COMPANY	1/27/1977			
300392131600	SAN JUAN 29-6 48A	BLANCO::MESAVERDE	11	NM	RIO ARRIBA	29N	6W	35	I	CONOCOPHILLIPS COMPANY	2/17/1977			
300392132400	SAN JUAN 29-6 43A	BLANCO::MESAVERDE	11	NM	RIO ARRIBA	29N	6W	26	J	CONOCOPHILLIPS COMPANY	3/9/1977	3/28/1977	3/28/1977	
300392132500	SAN JUAN 29-6 45A	BLANCO::MESAVERDE	11	NM	RIO ARRIBA	29N	6W	27	I	CONOCOPHILLIPS COMPANY	2/27/1977			
300392134400	SAN JUAN 29-6 72A	BASIN CB::FRUITLAND COAL	11	NM	RIO ARRIBA	29N	6W	22	F	CONOCOPHILLIPS COMPANY	4/22/1977		8/18/2004	
300392134400	SAN JUAN 29-6 72A	BLANCO::MESAVERDE	11	NM	RIO ARRIBA	29N	6W	22	F	CONOCOPHILLIPS COMPANY	4/22/1977			
300392136700	SAN JUAN 29-6 7A	BLANCO::MESAVERDE	11	NM	RIO ARRIBA	29N	6W	34	E	CONOCOPHILLIPS COMPANY	3/18/1977			
300392136800	SAN JUAN 29-6 52A	BLANCO::MESAVERDE	11	NM	RIO ARRIBA	29N	6W	34	P	CONOCOPHILLIPS COMPANY	3/28/1977			
300392138600	SAN JUAN 29-6 11A	BLANCO::MESAVERDE	11	NM	RIO ARRIBA	29N	6W	7	D	CONOCOPHILLIPS COMPANY	12/14/1977			
300392140200	SAN JUAN 29-6 44A	BLANCO::MESAVERDE	11	NM	RIO ARRIBA	29N	6W	26	E	CONOCOPHILLIPS COMPANY	4/5/1977			
300392141200	SAN JUAN 29-6 27A	BLANCO::MESAVERDE	11	NM	RIO ARRIBA	29N	6W	23	C	CONOCOPHILLIPS COMPANY	4/14/1977			
300392141500	SAN JUAN 29-6 17A	BLANCO::MESAVERDE	11	NM	RIO ARRIBA	29N	6W	1	J	CONOCOPHILLIPS COMPANY	7/14/1977			
300392141600	SAN JUAN 29-6 54A	BLANCO::MESAVERDE	11	NM	RIO ARRIBA	29N	6W	4	E	CONOCOPHILLIPS COMPANY	12/2/1977			

Well Status
San Juan 29-6 Unit
2/25/2016

API	Well Name	Rsvr Name	Production Status	State	County	Township	Range	Section Number	Unit Letter	Oper Name	Spud Date	Completion Date	Initial Production Date	Abandon Date
300392141700	SAN JUAN 29-6 59A	BLANCO::MESAVERDE	11	NM	RIO ARRIBA	29N	6W	5 I		CONOCOPHILLIPS COMPANY	11/23/1977			
300392141900	SAN JUAN 29-6 19A	BLANCO::MESAVERDE	11	NM	RIO ARRIBA	29N	6W	8 I		CONOCOPHILLIPS COMPANY	11/5/1977			
300392142000	SAN JUAN 29-6 66A	BLANCO::MESAVERDE	11	NM	RIO ARRIBA	29N	6W	9 D		CONOCOPHILLIPS COMPANY	11/15/1977	12/1/1977		
300392142100	SAN JUAN 29-6 31A	BLANCO::MESAVERDE	11	NM	RIO ARRIBA	29N	6W	10 C		CONOCOPHILLIPS COMPANY	9/15/1977			
300392142200	SAN JUAN 29-6 30A	BLANCO::MESAVERDE	11	NM	RIO ARRIBA	29N	6W	10 I		CONOCOPHILLIPS COMPANY	8/22/1977			
300392142300	SAN JUAN 29-6 32A	BLANCO::MESAVERDE	11	NM	RIO ARRIBA	29N	6W	11 F		CONOCOPHILLIPS COMPANY	9/4/1977			
300392142400	SAN JUAN 29-6 23A	BLANCO::MESAVERDE	11	NM	RIO ARRIBA	29N	6W	12 E		CONOCOPHILLIPS COMPANY	8/4/1977			
300392142500	SAN JUAN 29-6 22A	BLANCO::MESAVERDE	11	NM	RIO ARRIBA	29N	6W	12 O		CONOCOPHILLIPS COMPANY	7/26/1977			
300392144000	SAN JUAN 29-6 110	GOBERNADOR:PICTURED CLIFF	11	NM	RIO ARRIBA	29N	6W	1 G		CONOCOPHILLIPS COMPANY	8/24/1977	1/17/1978		
300392144000	SAN JUAN 29-6 UNIT 110	BLANCO::PICTURED CLIFFS	11	NM	RIO ARRIBA					CONOCOPHILLIPS COMPANY	8/24/1977			
300392156100	SAN JUAN 29-6 18A	BLANCO::MESAVERDE	11	NM	RIO ARRIBA	29N	6W	5 E		CONOCOPHILLIPS COMPANY	10/14/1978	11/3/1978		
300392156200	SAN JUAN 29-6 13A	BLANCO::MESAVERDE	11	NM	RIO ARRIBA	29N	6W	6 D		CONOCOPHILLIPS COMPANY	10/25/1978			
300392156300	SAN JUAN 29-6 12A	BLANCO::MESAVERDE	11	NM	RIO ARRIBA	29N	6W	6 J		CONOCOPHILLIPS COMPANY	10/5/1978			
300392156400	SAN JUAN 29-6 14A	BLANCO::MESAVERDE	11	NM	RIO ARRIBA	29N	6W	7 I		CONOCOPHILLIPS COMPANY	9/26/1978			
300392156500	SAN JUAN 29-6 20A	BLANCO::MESAVERDE	11	NM	RIO ARRIBA	29N	6W	6 D		CONOCOPHILLIPS COMPANY	9/17/1978			
300392156600	SAN JUAN 29-6 64A	BLANCO::MESAVERDE	11	NM	RIO ARRIBA	29N	6W	9 P		CONOCOPHILLIPS COMPANY	6/2/1978			
300392156700	SAN JUAN 29-6 21A	BLANCO::MESAVERDE	11	NM	RIO ARRIBA	29N	6W	11 P		CONOCOPHILLIPS COMPANY	5/7/1978			
300392156800	SAN JUAN 29-6 28A	BLANCO::MESAVERDE	11	NM	RIO ARRIBA	29N	6W	13 D		CONOCOPHILLIPS COMPANY	4/28/1978			
300392156900	SAN JUAN 29-6 33A	BLANCO::MESAVERDE	11	NM	RIO ARRIBA	29N	6W	13 J		CONOCOPHILLIPS COMPANY	3/7/1978			
300392157000	SAN JUAN 29-6 35A	BLANCO::MESAVERDE	11	NM	RIO ARRIBA	29N	6W	15 D		CONOCOPHILLIPS COMPANY	5/24/1978			
300392157100	SAN JUAN 29-6 36A	BLANCO::MESAVERDE	11	NM	RIO ARRIBA	29N	6W	15 J		CONOCOPHILLIPS COMPANY	5/16/1978			
300392157200	SAN JUAN 29-6 39A	BLANCO::MESAVERDE	11	NM	RIO ARRIBA	29N	6W	22 I		CONOCOPHILLIPS COMPANY	4/11/1978			
300392157300	SAN JUAN 29-6 40A	BLANCO::MESAVERDE	11	NM	RIO ARRIBA	29N	6W	23 O		CONOCOPHILLIPS COMPANY	4/19/1978			
300392157400	SAN JUAN 29-6 28A	BLANCO::MESAVERDE	11	NM	RIO ARRIBA	29N	6W	24 D		CONOCOPHILLIPS COMPANY	3/17/1978			
300392157500	SAN JUAN 29-6 41A	BLANCO::MESAVERDE	11	NM	RIO ARRIBA	29N	6W	24 J		CONOCOPHILLIPS COMPANY	2/14/1978			
300392157600	SAN JUAN 29-6 3A	BLANCO::MESAVERDE	11	NM	RIO ARRIBA	29N	6W	25 D		CONOCOPHILLIPS COMPANY	2/25/1978	3/17/1978	3/17/1978	
300392157700	SAN JUAN 29-6 42A	BLANCO::MESAVERDE	11	NM	RIO ARRIBA	29N	6W	25 J		CONOCOPHILLIPS COMPANY	3/26/1978			
300392179000	SAN JUAN 29-6 111	GOBERNADOR:PICTURED CLIFF	11	NM	RIO ARRIBA	29N	6W	1 C		CONOCOPHILLIPS COMPANY	8/21/1978			
300392179000	SAN JUAN 29-6 UNIT 111	GOBERNADOR::PICTURED CLIF	11	NM	RIO ARRIBA					CONOCOPHILLIPS COMPANY	8/21/1978			
300392299500	SAN JUAN 29-6 114	BASIN::DAKOTA	11	NM	RIO ARRIBA	29N	6W	7 A		CONOCOPHILLIPS COMPANY	11/20/1982			
300392451600	SAN JUAN 29-6 207	BASIN CB::FRUITLAND COAL	11	NM	RIO ARRIBA	29N	6W	2 K		CONOCOPHILLIPS COMPANY	11/19/1989		3/8/1990	
300392452100	SAN JUAN 29-6 206	BASIN CB::FRUITLAND COAL	11	NM	RIO ARRIBA	29N	6W	4 H		CONOCOPHILLIPS COMPANY	12/1/1989		3/21/1990	

Well Status
San Juan 29-6 Unit
2/25/2016

API	Well Name	Rsvr Name	Production Status	State	County	Township	Range	Section Number	Unit Letter	Oper Name	Spud Date	Completion Date	Initial Production Date	Abandon Date
300392458000	SAN JUAN 29-6 209	BASIN CB::FRUITLAND COAL	11	NM	RIO ARRIBA	29N	6W	17	B	CONOCOPHILLIPS COMPANY	11/30/1989		3/30/1990	
300392458100	SAN JUAN 29-6 213	BASIN CB::FRUITLAND COAL	11	NM	RIO ARRIBA	29N	6W	30	H	CONOCOPHILLIPS COMPANY	12/6/1989	2/10/1990	4/10/1990	
300392459200	SAN JUAN 29-6 212	BASIN CB::FRUITLAND COAL	11	NM	RIO ARRIBA	29N	6W	30	N	CONOCOPHILLIPS COMPANY	12/12/1989	2/2/1990	4/11/1990	
300392459700	SAN JUAN 29-6 201	BASIN CB::FRUITLAND COAL	11	NM	RIO ARRIBA	29N	6W	6	H	CONOCOPHILLIPS COMPANY	12/19/1989		12/6/1990	
300392459900	SAN JUAN 29-6 208	BASIN CB::FRUITLAND COAL	11	NM	RIO ARRIBA	29N	6W	17	N	CONOCOPHILLIPS COMPANY	1/2/1990		3/30/1990	
300392460600	SAN JUAN 29-6 214	BASIN CB::FRUITLAND COAL	11	NM	RIO ARRIBA	29N	6W	3	A	CONOCOPHILLIPS COMPANY	2/25/1990		5/3/1990	
300392460700	SAN JUAN 29-6 216	BASIN CB::FRUITLAND COAL	11	NM	RIO ARRIBA	29N	6W	4	K	CONOCOPHILLIPS COMPANY	3/2/1990		5/22/1990	
300392460800	SAN JUAN 29-6 219	BASIN CB::FRUITLAND COAL	11	NM	RIO ARRIBA	29N	6W	10	G	CONOCOPHILLIPS COMPANY	2/21/1990		5/3/1990	
300392460900	SAN JUAN 29-6 230	BASIN CB::FRUITLAND COAL	11	NM	RIO ARRIBA	29N	6W	35	A	CONOCOPHILLIPS COMPANY	6/29/1990		9/3/1993	
300392461000	SAN JUAN 29-6 UNIT 231	BASIN CB::FRUITLAND COAL	11	NM	RIO ARRIBA	29N	6W	36	B	CONOCOPHILLIPS COMPANY	3/8/1990	4/8/1990	5/18/1990	
300392466800	SAN JUAN 29-6 226	BASIN CB::FRUITLAND COAL	11	NM	RIO ARRIBA	29N	6W	14	G	CONOCOPHILLIPS COMPANY	6/21/1990		5/7/1993	
300392466900	SAN JUAN 29-6 227	BASIN CB::FRUITLAND COAL	11	NM	RIO ARRIBA	29N	6W	14	N	CONOCOPHILLIPS COMPANY	6/26/1990		8/24/1993	
300392468000	SAN JUAN 29-6 221	BASIN CB::FRUITLAND COAL	11	NM	RIO ARRIBA	29N	6W	11	M	CONOCOPHILLIPS COMPANY	4/13/1990		6/20/1990	
300392468100	SAN JUAN 29-6 223	BASIN CB::FRUITLAND COAL	11	NM	RIO ARRIBA	29N	6W	12	K	CONOCOPHILLIPS COMPANY	5/17/1990		7/12/1990	
300392468200	SAN JUAN 29-6 UNIT 225	BASIN::FRUITLAND COAL	71	NM	RIO ARRIBA	29N	6W	13		CONOCOPHILLIPS COMPANY	4/21/1990	5/13/1990	5/13/1990	12/11/1995
300392468400	SAN JUAN 29-6 229	BASIN CB::FRUITLAND COAL	11	NM	RIO ARRIBA	29N	6W	35	N	CONOCOPHILLIPS COMPANY	12/6/1990		9/8/1993	
300392469000	SAN JUAN 29-6 220	BASIN CB::FRUITLAND COAL	11	NM	RIO ARRIBA	29N	6W	11	A	CONOCOPHILLIPS COMPANY	4/17/1990		7/28/1990	
300392470500	SAN JUAN 29-6 239	BASIN CB::FRUITLAND COAL	11	NM	RIO ARRIBA	29N	6W	2	B	CONOCOPHILLIPS COMPANY	9/1/1990		5/24/1991	
300392472300	SAN JUAN 29-6 211	BASIN CB::FRUITLAND COAL	11	NM	RIO ARRIBA	29N	6W	20	H	CONOCOPHILLIPS COMPANY	7/11/1990		5/19/1993	
300392472600	SAN JUAN 29-6 215	BASIN CB::FRUITLAND COAL	11	NM	RIO ARRIBA	29N	6W	3	N	CONOCOPHILLIPS COMPANY	4/9/1990		6/18/1990	
300392472800	SAN JUAN 29-6 233	BASIN CB::FRUITLAND COAL	11	NM	RIO ARRIBA	29N	6W	26	N	CONOCOPHILLIPS COMPANY	12/2/1990		11/23/1993	
300392472900	SAN JUAN 29-6 236	BASIN CB::FRUITLAND COAL	11	NM	RIO ARRIBA	29N	6W	18	K	CONOCOPHILLIPS COMPANY	7/3/1990		5/18/1993	
300392473000	SAN JUAN 29-6 242	BASIN CB::FRUITLAND COAL	11	NM	RIO ARRIBA	29N	6W	19	K	CONOCOPHILLIPS COMPANY	7/14/1990	3/17/1991	5/18/1993	
300392473500	SAN JUAN 29-6 203	BASIN CB::FRUITLAND COAL	11	NM	RIO ARRIBA	29N	6W	7	M	CONOCOPHILLIPS COMPANY	7/27/1990		5/14/1993	
300392474600	SAN JUAN 29-6 218	BASIN CB::FRUITLAND COAL	11	NM	RIO ARRIBA	29N	6W	5	L	CONOCOPHILLIPS COMPANY	5/21/1990		8/15/1990	
300392474700	SAN JUAN 29-6 210	BASIN CB::FRUITLAND COAL	11	NM	RIO ARRIBA	29N	6W	20	L	CONOCOPHILLIPS COMPANY	7/8/1990		5/19/1993	
300392475800	SAN JUAN 29-6 222	BASIN CB::FRUITLAND COAL	11	NM	RIO ARRIBA	29N	6W	12	G	CONOCOPHILLIPS COMPANY	6/14/1990		10/3/1991	
300392475900	SAN JUAN 29-6 224	BASIN CB::FRUITLAND COAL	11	NM	RIO ARRIBA	29N	6W	13	B	CONOCOPHILLIPS COMPANY	6/17/1990		6/25/1991	
300392476300	SAN JUAN 29-6 259	BASIN CB::FRUITLAND COAL	11	NM	RIO ARRIBA	29N	6W	9	B	CONOCOPHILLIPS COMPANY	12/23/1990		7/2/1993	
300392476600	SAN JUAN 29-6 258	BASIN CB::FRUITLAND COAL	11	NM	RIO ARRIBA	29N	6W	16	N	CONOCOPHILLIPS COMPANY	9/8/1990		6/2/1991	
300392476700	SAN JUAN 29-6 260	BASIN CB::FRUITLAND COAL	11	NM	RIO ARRIBA	29N	6W	16	G	CONOCOPHILLIPS COMPANY	9/18/1992		5/12/1993	
300392479400	SAN JUAN 29-6 217	BASIN CB::FRUITLAND COAL	11	NM	RIO ARRIBA	29N	6W	5	H	CONOCOPHILLIPS COMPANY	6/30/1990		8/28/1990	

Well Status
San Juan 29-6 Unit
2/25/2016

API	Well Name	Rsvr Name	Production Status	State	County	Township	Range	Section Number	Unit Letter	Oper Name	Spud Date	Completion Date	Initial Production Date	Abandon Date
300392480400	SAN JUAN 29-6 237	BASIN CB::FRUITLAND COAL	11	NM	RIO ARRIBA	29N	6W	1	B	CONOCOPHILLIPS COMPANY	9/4/1990		5/29/1991	
300392480500	SAN JUAN 29-6 238	BASIN CB::FRUITLAND COAL	11	NM	RIO ARRIBA	29N	6W	1	L	CONOCOPHILLIPS COMPANY	8/28/1990		5/28/1991	
300392480700	SAN JUAN 29-6 301 OIL	BLANCO::MESAVERDE	11	NM	RIO ARRIBA	29N	6W	2	P	CONOCOPHILLIPS COMPANY	7/20/1990	1/24/1991		
300392482200	SAN JUAN 29-6 204	BASIN CB::FRUITLAND COAL	11	NM	RIO ARRIBA	29N	6W	7	A	CONOCOPHILLIPS COMPANY	7/18/1990		7/28/1993	
300392482300	SAN JUAN 29-6 235	BASIN CB::FRUITLAND COAL	11	NM	RIO ARRIBA	29N	6W	34	A	CONOCOPHILLIPS COMPANY	7/24/1990		8/10/1993	
300392482400	SAN JUAN 29-6 246 P&A'D	BASIN CB::FRUITLAND COAL	72	NM	RIO ARRIBA	29N	6W	8	K	CONOCOPHILLIPS COMPANY	9/12/1990	3/18/1992	5/12/1993	7/12/2012
300392489900	SAN JUAN 29-6 202	BASIN CB::FRUITLAND COAL	11	NM	RIO ARRIBA	29N	6W	6	L	CONOCOPHILLIPS COMPANY	9/16/1990		8/10/1993	
300392490000	SAN JUAN 29-6 234	BASIN CB::FRUITLAND COAL	11	NM	RIO ARRIBA	29N	6W	34	N	CONOCOPHILLIPS COMPANY	9/24/1990		8/10/1993	
300392491000	SAN JUAN 29-6 245	BASIN CB::FRUITLAND COAL	11	NM	RIO ARRIBA	29N	6W	8	B	CONOCOPHILLIPS COMPANY	9/20/1990		7/9/1991	
300392493100	SAN JUAN 29-6 205	BASIN CB::FRUITLAND COAL	11	NM	RIO ARRIBA	29N	6W	21	K	CONOCOPHILLIPS COMPANY	12/9/1990		5/11/1993	
300392493200	SAN JUAN 29-6 240	BASIN CB::FRUITLAND COAL	11	NM	RIO ARRIBA	29N	6W	18	H	CONOCOPHILLIPS COMPANY	12/13/1990		5/18/1993	
300392493300	SAN JUAN 29-6 241	BASIN CB::FRUITLAND COAL	11	NM	RIO ARRIBA	29N	6W	19	A	CONOCOPHILLIPS COMPANY	12/17/1990		5/18/1993	
300392494300	SAN JUAN 29-6 243	BASIN CB::FRUITLAND COAL	11	NM	RIO ARRIBA	29N	6W	31	H	CONOCOPHILLIPS COMPANY	11/18/1990	11/4/1992	9/3/1993	
300392509000	SAN JUAN 29-6 262	BASIN CB::FRUITLAND COAL	11	NM	RIO ARRIBA	29N	6W	21	A	CONOCOPHILLIPS COMPANY	12/7/1991		5/11/1993	
300392516900	SAN JUAN 29-6 251	BASIN CB::FRUITLAND COAL	11	NM	RIO ARRIBA	29N	6W	23	K	CONOCOPHILLIPS COMPANY	9/18/1992		12/20/1993	
300392518800	SAN JUAN 29-6 263	BASIN CB::FRUITLAND COAL	11	NM	RIO ARRIBA	29N	6W	22	L	CONOCOPHILLIPS COMPANY	9/7/1992		12/21/1993	
300392520100	SAN JUAN 29-6 249	BASIN CB::FRUITLAND COAL	11	NM	RIO ARRIBA	29N	6W	22	B	CONOCOPHILLIPS COMPANY	9/3/1992		12/1/1993	
300392526700	SAN JUAN 29-6 225R	BASIN::FRUITLAND COAL	72	NM	RIO ARRIBA	29N	6W	13	K	CONOCOPHILLIPS COMPANY	8/13/1993	10/20/1994	10/20/1994	1/17/2012
300392541400	SAN JUAN 29-6 247R	BASIN::FRUITLAND COAL	72	NM	RIO ARRIBA	29N	6W	10	K	CONOCOPHILLIPS COMPANY	11/2/1994		12/30/1994	2/19/2015
300392545600	SAN JUAN 29-6 257R	BASIN::FRUITLAND COAL	11	NM	RIO ARRIBA	29N	6W	9	D	CONOCOPHILLIPS COMPANY	11/7/1994		12/15/1994	
300392553500	SAN JUAN 29-6 264	BASIN::FRUITLAND COAL	11	NM	RIO ARRIBA	29N	6W	27	A	CONOCOPHILLIPS COMPANY	7/17/1995		11/30/1995	
300392617900	SAN JUAN 29-6 29B	BASIN::DAKOTA	61	NM	RIO ARRIBA	29N	6W	3	C	CONOCOPHILLIPS COMPANY	9/5/1999		11/3/1999	
300392617900	SAN JUAN 29-6 29B	BLANCO::MESAVERDE	11	NM	RIO ARRIBA	29N	6W	3	C	CONOCOPHILLIPS COMPANY	9/5/1999		8/25/2000	
300392617900	SAN JUAN 29-6 UNIT 29B	BLANCO::MESAVERDE	11	NM	RIO ARRIBA	29N	6W	3		CONOCOPHILLIPS COMPANY	9/5/1999			
300392618000	SAN JUAN 29-6 25B	BLANCO::MESAVERDE	11	NM	RIO ARRIBA	29N	6W	32	I	CONOCOPHILLIPS COMPANY	7/21/1999		10/6/1999	
300392618000	SAN JUAN 29-6 UNIT 25B	BLANCO::MESAVERDE	11	NM	RIO ARRIBA					CONOCOPHILLIPS COMPANY	7/21/1999			
300392618300	SAN JUAN 29-6 84M	BASIN::DAKOTA	11	NM	RIO ARRIBA	29N	6W	14	D	CONOCOPHILLIPS COMPANY	9/16/1999		11/19/1999	
300392618300	SAN JUAN 29-6 84M	BLANCO::MESAVERDE	11	NM	RIO ARRIBA	29N	6W	14	D	CONOCOPHILLIPS COMPANY	9/16/1999		6/15/2000	
300392618300	SAN JUAN 29-6 UNIT 84M	BLANCO::MESAVERDE	11	NM	RIO ARRIBA					CONOCOPHILLIPS COMPANY	9/16/1999			
300392618400	SAN JUAN 29-6 8B	BASIN::DAKOTA	61	NM	RIO ARRIBA	29N	6W	1	D	CONOCOPHILLIPS COMPANY	8/26/1999	10/29/1999	10/29/1999	
300392618400	SAN JUAN 29-6 8B	BLANCO::MESAVERDE	11	NM	RIO ARRIBA	29N	6W	1	D	CONOCOPHILLIPS COMPANY	8/26/1999		5/15/2000	
300392618400	SAN JUAN 29-6 UNIT 8B	BLANCO::MESAVERDE	11	NM	RIO ARRIBA	29N	6W	1		CONOCOPHILLIPS COMPANY	8/26/1999			

Well Status
San Juan 29-6 Unit
2/25/2016

API	Well Name	Rsvr Name	Production Status	State	County	Township	Range	Section Number	Unit Letter	Oper Name	Spud Date	Completion Date	Initial Production Date	Abandon Date
300392618500	SAN JUAN 29-6 68B	BLANCO::MESAVERDE	11	NM	RIO ARRIBA	29N	6W	29	G	CONOCOPHILLIPS COMPANY	7/29/1999		10/7/1999	
300392618500	SAN JUAN 29-6 UNIT 68B	BLANCO::MESAVERDE	11	NM	RIO ARRIBA					CONOCOPHILLIPS COMPANY	7/29/1999			
300392618600	SAN JUAN 29-6 47B	BLANCO::MESAVERDE	11	NM	RIO ARRIBA	29N	6W	28	H	CONOCOPHILLIPS COMPANY	8/7/1999		10/11/1999	
300392618600	SAN JUAN 29-6 UNIT 47B	BLANCO::MESAVERDE	11	NM	RIO ARRIBA					CONOCOPHILLIPS COMPANY	8/7/1999			
300392618700	SAN JUAN 29-6 87M	BASIN::DAKOTA	11	NM	RIO ARRIBA	29N	6W	33	O	CONOCOPHILLIPS COMPANY	8/16/1999		11/12/1999	
300392618700	SAN JUAN 29-6 87M	BLANCO::MESAVERDE	11	NM	RIO ARRIBA	29N	6W	33	O	CONOCOPHILLIPS COMPANY	8/16/1999		9/19/2000	
300392618700	SAN JUAN 29-6 UNIT 87M	BLANCO::MESAVERDE	11	NM	RIO ARRIBA					CONOCOPHILLIPS COMPANY	8/16/1999			
300392618800	SAN JUAN 29-6 18B	BASIN::DAKOTA	71	NM	RIO ARRIBA	29N	6W	5	C	CONOCOPHILLIPS COMPANY	7/8/1999		9/23/1999	6/7/2002
300392618800	SAN JUAN 29-6 18B	BLANCO::MESAVERDE	11	NM	RIO ARRIBA	29N	6W	5	C	CONOCOPHILLIPS COMPANY	7/8/1999		7/16/2002	
300392618800	SAN JUAN 29-6 UNIT 18B	BLANCO::MESAVERDE	11	NM	RIO ARRIBA	29N	6W	5		CONOCOPHILLIPS COMPANY	7/8/1999			
300392619700	SAN JUAN 29-6 31B	BASIN::DAKOTA	11	NM	RIO ARRIBA	29N	6W	10	E	CONOCOPHILLIPS COMPANY	9/26/1999	10/20/1999	11/19/1999	
300392619700	SAN JUAN 29-6 31B	BLANCO::MESAVERDE	11	NM	RIO ARRIBA	29N	6W	10	E	CONOCOPHILLIPS COMPANY	9/26/1999	5/4/2000	5/4/2000	
300392619700	SAN JUAN 29-6 UNIT 31B	BLANCO::MESAVERDE	11	NM	RIO ARRIBA					CONOCOPHILLIPS COMPANY	9/26/1999			
300392633700	SAN JUAN 29-6 100M	BASIN::DAKOTA	11	NM	RIO ARRIBA	29N	6W	35	C	CONOCOPHILLIPS COMPANY	5/5/2000		8/20/2000	
300392633700	SAN JUAN 29-6 100M	BLANCO::MESAVERDE	11	NM	RIO ARRIBA	29N	6W	35	C	CONOCOPHILLIPS COMPANY	5/5/2000		11/17/2000	
300392633700	SAN JUAN 29-6 UNIT 100M D	BLANCO::MESAVERDE	11	NM	RIO ARRIBA					CONOCOPHILLIPS COMPANY				
300392633800	SAN JUAN 29-6 101M	BASIN::DAKOTA	11	NM	RIO ARRIBA	29N	6W	36	O	CONOCOPHILLIPS COMPANY	5/13/2000	6/15/2000	8/20/2000	
300392633800	SAN JUAN 29-6 101M	BLANCO::MESAVERDE	11	NM	RIO ARRIBA	29N	6W	36	O	CONOCOPHILLIPS COMPANY	5/13/2000	12/8/2000	12/8/2000	
300392633800	SAN JUAN 29-6 UNIT 101M	BLANCO::MESAVERDE	11	NM	RIO ARRIBA					CONOCOPHILLIPS COMPANY	5/13/2000			
300392633900	SAN JUAN 29-6 94M	BASIN::DAKOTA	11	NM	RIO ARRIBA	29N	6W	16	F	CONOCOPHILLIPS COMPANY	7/26/2000		9/28/2000	
300392633900	SAN JUAN 29-6 94M	BLANCO::MESAVERDE	11	NM	RIO ARRIBA	29N	6W	16	F	CONOCOPHILLIPS COMPANY	7/26/2000		2/7/2001	
300392633900	SAN JUAN 29-6 UNIT 94M	BLANCO::MESAVERDE	11	NM	RIO ARRIBA					CONOCOPHILLIPS COMPANY	7/26/2000			
300392634000	SAN JUAN 29-6 69M	BASIN::DAKOTA	11	NM	RIO ARRIBA	29N	6W	26	C	CONOCOPHILLIPS COMPANY	6/17/2000		8/22/2000	
300392634000	SAN JUAN 29-6 69M	BLANCO::MESAVERDE	11	NM	RIO ARRIBA	29N	6W	26	C	CONOCOPHILLIPS COMPANY	6/17/2000		5/10/2001	
300392634000	SAN JUAN 29-6 UNIT 69M	BLANCO::MESAVERDE	11	NM	RIO ARRIBA					CONOCOPHILLIPS COMPANY	6/17/2000			
300392634100	SAN JUAN 29-6 76M	BASIN::DAKOTA	11	NM	RIO ARRIBA	29N	6W	23	E	CONOCOPHILLIPS COMPANY	8/13/2000	10/4/2000	10/4/2000	
300392634100	SAN JUAN 29-6 76M	BLANCO::MESAVERDE	11	NM	RIO ARRIBA	29N	6W	23	E	CONOCOPHILLIPS COMPANY	8/13/2000	10/4/2000	5/31/2001	
300392634100	SAN JUAN 29-6 UNIT 76M	BLANCO::MESAVERDE	11	NM	RIO ARRIBA					CONOCOPHILLIPS COMPANY	8/13/2000			
300392634200	SAN JUAN 29-6 97M	BASIN::DAKOTA	11	NM	RIO ARRIBA	29N	6W	35	O	CONOCOPHILLIPS COMPANY	7/8/2000		8/29/2000	
300392634200	SAN JUAN 29-6 97M	BLANCO::MESAVERDE	11	NM	RIO ARRIBA	29N	6W	35	O	CONOCOPHILLIPS COMPANY	7/8/2000		1/23/2001	
300392634200	SAN JUAN 29-6 UNIT 97M	BLANCO::MESAVERDE	11	NM	RIO ARRIBA					CONOCOPHILLIPS COMPANY	7/8/2000			
300392634300	SAN JUAN 29-6 85M	BASIN::DAKOTA	71	NM	RIO ARRIBA	29N	6W	2	O	CONOCOPHILLIPS COMPANY	5/30/2000		8/11/2000	

Well Status
San Juan 29-6 Unit
2/25/2016

API	Well Name	Rsvr Name	Production Status	State	County	Township	Range	Section Number	Unit Letter	Oper Name	Spud Date	Completion Date	Initial Production Date	Abandon Date
300392634300	SAN JUAN 29-6 85M	BLANCO::MESAVERDE	11	NM	RIO ARRIBA	29N	6W	2	O	CONOCOPHILLIPS COMPANY	5/30/2000		5/4/2001	
300392634300	SAN JUAN 29-6 UNIT 85M	BLANCO::MESAVERDE	11	NM	RIO ARRIBA	29N	6W	27		CONOCOPHILLIPS COMPANY	5/31/2000			
300392637400	SAN JUAN 29-6 81M	BASIN::DAKOTA	11	NM	RIO ARRIBA	29N	6W	25	F	CONOCOPHILLIPS COMPANY	12/30/2000	9/27/2001	9/27/2001	
300392637400	SAN JUAN 29-6 81M	BLANCO::MESAVERDE	11	NM	RIO ARRIBA	29N	6W	25	F	CONOCOPHILLIPS COMPANY	12/30/2000	3/15/2002	3/15/2002	
300392637400	SAN JUAN 29-6 UNIT 81M	BLANCO::MESAVERDE	11	NM	RIO ARRIBA					CONOCOPHILLIPS COMPANY	12/30/2000			
300392640500	SAN JUAN 29-6 93M	BASIN::DAKOTA	11	NM	RIO ARRIBA	29N	6W	16	O	CONOCOPHILLIPS COMPANY	7/17/2000		9/7/2000	
300392640500	SAN JUAN 29-6 93M	BLANCO::MESAVERDE	11	NM	RIO ARRIBA	29N	6W	16	O	CONOCOPHILLIPS COMPANY	7/17/2000		2/21/2001	
300392640500	SAN JUAN 29-6 UNIT 93M	BLANCO::MESAVERDE	11	NM	RIO ARRIBA					CONOCOPHILLIPS COMPANY	7/17/2000			
300392640900	SAN JUAN 29-6 77M	BASIN::DAKOTA	71	NM	RIO ARRIBA	29N	6W	22	P	CONOCOPHILLIPS COMPANY	11/7/2000			4/20/2002
300392640900	SAN JUAN 29-6 77M	BLANCO::MESAVERDE	11	NM	RIO ARRIBA	29N	6W	22	P	CONOCOPHILLIPS COMPANY	11/7/2000		8/8/2002	
300392640900	SAN JUAN 29-6 UNIT 77M	BLANCO::MESAVERDE	11	NM	RIO ARRIBA	29N	6W	22		CONOCOPHILLIPS COMPANY	11/7/2000			
300392641900	SAN JUAN 29-6 91M	BASIN::DAKOTA	11	NM	RIO ARRIBA	29N	6W	21	I	CONOCOPHILLIPS COMPANY	8/22/2000		10/12/2000	
300392641900	SAN JUAN 29-6 91M	BLANCO::MESAVERDE	11	NM	RIO ARRIBA	29N	6W	21	I	CONOCOPHILLIPS COMPANY	8/22/2000		4/5/2001	
300392641900	SAN JUAN 29-6 UNIT 91M	BLANCO::MESAVERDE	11	NM	RIO ARRIBA					CONOCOPHILLIPS COMPANY	8/22/2000			
300392642100	SAN JUAN 29-6 19R	BLANCO::MESAVERDE	11	NM	RIO ARRIBA	29N	6W	8	B	CONOCOPHILLIPS COMPANY	5/21/2000		7/18/2000	
300392642100	SAN JUAN 29-6 UNIT 19R	BLANCO::MESAVERDE	11	NM	RIO ARRIBA					CONOCOPHILLIPS COMPANY	5/21/2000			
300392642300	SAN JUAN 29-6 35M	BASIN::DAKOTA	11	NM	RIO ARRIBA	29N	6W	15	P	CONOCOPHILLIPS COMPANY	8/4/2000		9/25/2000	
300392642300	SAN JUAN 29-6 35M	BLANCO::MESAVERDE	11	NM	RIO ARRIBA	29N	6W	15	P	CONOCOPHILLIPS COMPANY	8/4/2000		3/14/2001	
300392642300	SAN JUAN 29-6 UNIT 35M	BLANCO::MESAVERDE	11	NM	RIO ARRIBA					CONOCOPHILLIPS COMPANY	8/4/2000			
300392643000	SAN JUAN 29-6 99M	BASIN::DAKOTA	11	NM	RIO ARRIBA	29N	6W	34	F	CONOCOPHILLIPS COMPANY	7/18/2000	10/10/2000	10/10/2000	
300392643000	SAN JUAN 29-6 99M	BLANCO::MESAVERDE	11	NM	RIO ARRIBA	29N	6W	34	F	CONOCOPHILLIPS COMPANY	7/16/2000	5/30/2001	5/30/2001	
300392643000	SAN JUAN 29-6 UNIT 99M	BLANCO::MESAVERDE	11	NM	RIO ARRIBA					CONOCOPHILLIPS COMPANY	7/16/2000			
300392644300	SAN JUAN 29-6 86M	BASIN::DAKOTA	61	NM	RIO ARRIBA	29N	6W	27	C	CONOCOPHILLIPS COMPANY	6/7/2000		7/20/2000	
300392644300	SAN JUAN 29-6 86M	BLANCO::MESAVERDE	11	NM	RIO ARRIBA	29N	6W	27	C	CONOCOPHILLIPS COMPANY	6/7/2000		1/31/2001	
300392644300	SAN JUAN 29-6 UNIT 86M	BLANCO::MESAVERDE	11	NM	RIO ARRIBA					CONOCOPHILLIPS COMPANY	6/7/2000			
300392644400	SAN JUAN 29-6 18R	BLANCO::MESAVERDE	11	NM	RIO ARRIBA	29N	6W	5	M	CONOCOPHILLIPS COMPANY	12/16/2000		1/24/2001	
300392644400	SAN JUAN 29-6 UNIT 18R	BLANCO::MESAVERDE	11	NM	RIO ARRIBA					CONOCOPHILLIPS COMPANY	12/16/2000			
300392645800	SAN JUAN 29-6 98M	BASIN::DAKOTA	11	NM	RIO ARRIBA	29N	6W	26	I	CONOCOPHILLIPS COMPANY	11/18/2000		4/10/2001	
300392645800	SAN JUAN 29-6 98M	BLANCO::MESAVERDE	11	NM	RIO ARRIBA	29N	6W	26	I	CONOCOPHILLIPS COMPANY	11/18/2000		3/18/2002	
300392645800	SAN JUAN 29-6 UNIT 98M	BLANCO::MESAVERDE	11	NM	RIO ARRIBA					CONOCOPHILLIPS COMPANY	11/18/2000			
300392646200	SAN JUAN 29-6 82M	BASIN::DAKOTA	11	NM	RIO ARRIBA	29N	6W	25	O	CONOCOPHILLIPS COMPANY	7/4/2000		9/26/2000	
300392646200	SAN JUAN 29-6 82M	BLANCO::MESAVERDE	11	NM	RIO ARRIBA	29N	6W	25	O	CONOCOPHILLIPS COMPANY	7/4/2000		5/22/2001	

Well Status
San Juan 29-6 Unit
2/25/2016

API	Well Name	Rev Name	Production Status	State	County	Township	Range	Section Number	Unit Letter	Oper Name	Spud Date	Completion Date	Initial Production Date	Abandon Date
300392646200	SAN JUAN 29-6 UNIT 82M	BLANCO::MESAVERDE	11	NM	RIO ARRIBA					CONOCOPHILLIPS COMPANY	7/4/2000			
300392646600	SAN JUAN 29-6 95M	BASIN::DAKOTA	11	NM	RIO ARRIBA	29N	6W	34	O	CONOCOPHILLIPS COMPANY	7/28/2000	9/28/2000	9/28/2000	
300392646600	SAN JUAN 29-6 95M	BLANCO::MESAVERDE	11	NM	RIO ARRIBA	29N	6W	34	O	CONOCOPHILLIPS COMPANY	7/28/2000	5/11/2001	5/11/2001	
300392646600	SAN JUAN 29-6 UNIT 95M	BLANCO::MESAVERDE	11	NM	RIO ARRIBA					CONOCOPHILLIPS COMPANY	7/28/2000			
300392646700	SAN JUAN 29-6 105R	BASIN::DAKOTA	11	NM	RIO ARRIBA	29N	6W	28	M	CONOCOPHILLIPS COMPANY	8/31/2000		10/19/2000	
300392646700	SAN JUAN 29-6 105R	BLANCO::MESAVERDE	11	NM	RIO ARRIBA	29N	6W	28	M	CONOCOPHILLIPS COMPANY	8/31/2000		3/29/2001	
300392646700	SAN JUAN 29-6 UNIT 105R	BLANCO::MESAVERDE	11	NM	RIO ARRIBA					CONOCOPHILLIPS COMPANY	8/31/2000			
300392667300	SAN JUAN 29-6 73C	BLANCO::MESAVERDE	11	NM	RIO ARRIBA	29N	6W	20	N	CONOCOPHILLIPS COMPANY	5/21/2001		7/12/2001	
300392667300	SAN JUAN 29-6 UNIT 73C	BLANCO::MESAVERDE	11	NM	RIO ARRIBA					CONOCOPHILLIPS COMPANY	5/21/2001			
300392667600	SAN JUAN 29-6 73B	BLANCO::MESAVERDE	11	NM	RIO ARRIBA	29N	6W	20	C	CONOCOPHILLIPS COMPANY	5/1/2001		8/16/2001	
300392667600	SAN JUAN 29-6 UNIT 73B	BLANCO::MESAVERDE	11	NM	RIO ARRIBA					CONOCOPHILLIPS COMPANY	5/30/2001			
300392668100	SAN JUAN 29-6 116P	BASIN::FRUITLAND COAL	11	NM	RIO ARRIBA	29N	6W	27	K	CONOCOPHILLIPS COMPANY	4/3/2001	12/10/2001	12/10/2001	
300392668100	SAN JUAN 29-6 116P	BLANCO S::PICTURED CLIFFS	11	NM	RIO ARRIBA	29N	6W	27	K	CONOCOPHILLIPS COMPANY	4/3/2001	5/23/2001	5/23/2001	
300392670400	SAN JUAN 29-6 15C	BLANCO::MESAVERDE	11	NM	RIO ARRIBA	29N	6W	2	M	CONOCOPHILLIPS COMPANY	4/27/2001		8/12/2001	
300392670400	SAN JUAN 29-6 UNIT 15C	BLANCO::MESAVERDE	11	NM	RIO ARRIBA					CONOCOPHILLIPS COMPANY	4/27/2001			
300392670500	SAN JUAN 29-6 15B	BLANCO::MESAVERDE	11	NM	RIO ARRIBA	29N	6W	2	D	CONOCOPHILLIPS COMPANY	5/5/2001		6/14/2001	
300392670500	SAN JUAN 29-6 UNIT 15B	BLANCO::MESAVERDE	11	NM	RIO ARRIBA					CONOCOPHILLIPS COMPANY	5/5/2001			
300392670600	SAN JUAN 29-6 10B	BLANCO::MESAVERDE	11	NM	RIO ARRIBA	29N	6W	2	A	CONOCOPHILLIPS COMPANY	4/9/2001		6/1/2001	
300392670600	SAN JUAN 29-6 UNIT 10B	BLANCO::MESAVERDE	11	NM	RIO ARRIBA					CONOCOPHILLIPS COMPANY	4/9/2001			
300392670700	SAN JUAN 29-6 10C	BLANCO::MESAVERDE	11	NM	RIO ARRIBA	29N	6W	2	J	CONOCOPHILLIPS COMPANY	4/19/2001		6/1/2001	
300392670700	SAN JUAN 29-6 UNIT 10C	BLANCO::MESAVERDE	11	NM	RIO ARRIBA					CONOCOPHILLIPS COMPANY	4/19/2001			
300392671700	SAN JUAN 29-6 70C	BLANCO::MESAVERDE	11	NM	RIO ARRIBA	29N	6W	29	F	CONOCOPHILLIPS COMPANY	5/13/2001		5/18/2001	
300392671700	SAN JUAN 29-6 UNIT 70C	BLANCO::MESAVERDE	11	NM	RIO ARRIBA					CONOCOPHILLIPS COMPANY	5/13/2001			
300392673800	SAN JUAN 29-6 70B	BLANCO::MESAVERDE	11	NM	RIO ARRIBA	29N	6W	29	L	CONOCOPHILLIPS COMPANY	6/9/2001		8/15/2001	
300392673800	SAN JUAN 29-6 UNIT 70B	BLANCO::MESAVERDE	11	NM	RIO ARRIBA					CONOCOPHILLIPS COMPANY	6/9/2001			
300392674000	SAN JUAN 29-6 13B	BLANCO::MESAVERDE	11	NM	RIO ARRIBA	29N	6W	6	C	CONOCOPHILLIPS COMPANY	10/27/2002		2/3/2003	
300392674000	SAN JUAN 29-6 UNIT 13B	BLANCO::MESAVERDE	11	NM	RIO ARRIBA					CONOCOPHILLIPS COMPANY	10/27/2002			
300392674300	SAN JUAN 29-6 1C	BLANCO::MESAVERDE	11	NM	RIO ARRIBA	29N	6W	3	J	CONOCOPHILLIPS COMPANY	10/7/2002		1/10/2003	
300392674300	SAN JUAN 29-6 UNIT 1C	BLANCO::MESAVERDE	11	NM	RIO ARRIBA					CONOCOPHILLIPS COMPANY	10/7/2002			
300392674800	SAN JUAN 29-6 12C	BLANCO::MESAVERDE	11	NM	RIO ARRIBA	29N	6W	6	I	CONOCOPHILLIPS COMPANY	10/17/2002		2/3/2003	
300392674800	SAN JUAN 29-6 UNIT 12C	BLANCO::MESAVERDE	11	NM	RIO ARRIBA					CONOCOPHILLIPS COMPANY	10/17/2002			
300392679900	SAN JUAN 29-6 25C	BLANCO::MESAVERDE	11	NM	RIO ARRIBA	29N	6W	32	A	CONOCOPHILLIPS COMPANY	9/26/2001		12/11/2001	

Well Status
San Juan 29-6 Unit
2/25/2016

API	Well Name	Rsvr Name	Production Status	State	County	Township	Range	Section Number	Unit Letter	Oper Name	Spud Date	Completion Date	Initial Production Date	Abandon Date
300392679900	SAN JUAN 29-6 UNIT 25C	BLANCO::MESAVERDE	11	NM	RIO ARRIBA					CONOCOPHILLIPS COMPANY	9/27/2001			
300392723800	SAN JUAN 29-6 47M	BASIN::DAKOTA	71	NM	RIO ARRIBA	29N	6W	28	P	CONOCOPHILLIPS COMPANY	11/17/1999	12/20/1999	12/20/1999	5/3/2002
300392723800	SAN JUAN 29-6 47M	BLANCO::MESAVERDE	11	NM	RIO ARRIBA	29N	6W	28	P	CONOCOPHILLIPS COMPANY	11/17/1999	8/8/2000	8/8/2000	
300392723800	SAN JUAN 29-6 UNIT 47M *	BLANCO::MESAVERDE	11	NM	RIO ARRIBA	29N	6W	28		CONOCOPHILLIPS COMPANY	11/14/1999			
300392748900	SAN JUAN 29-6 238A FC	BASIN CB::FRUITLAND COAL	11	NM	RIO ARRIBA	29N	6W	1	C	CONOCOPHILLIPS COMPANY	11/4/2004		5/17/2004	
300392750100	SAN JUAN 29-6 202A FC	BASIN CB::FRUITLAND COAL	11	NM	RIO ARRIBA	29N	6W	6	D	CONOCOPHILLIPS COMPANY	11/21/2003		3/17/2004	
300392750200	SAN JUAN 29-6 217A	BASIN CB::FRUITLAND COAL	11	NM	RIO ARRIBA	29N	6W	5	O	CONOCOPHILLIPS COMPANY	12/4/2003		1/27/2004	
300392750300	SAN JUAN 29-6 17B	BLANCO::MESAVERDE	11	NM	RIO ARRIBA	29N	6W	1	G	CONOCOPHILLIPS COMPANY	10/15/2004		12/16/2004	
300392750300	SAN JUAN 29-6 UNIT 17B	BLANCO::MESAVERDE	11	NM	RIO ARRIBA					CONOCOPHILLIPS COMPANY	10/16/2004			
300392750400	SAN JUAN 29-6 201A FC	BASIN CB::FRUITLAND COAL	11	NM	RIO ARRIBA	29N	6W	6	I	CONOCOPHILLIPS COMPANY	11/28/2003	2/24/2004	2/24/2004	
300392750500	SAN JUAN 29-6 204A FC	BASIN CB::FRUITLAND COAL	11	NM	RIO ARRIBA	29N	6W	7	J	CONOCOPHILLIPS COMPANY	12/14/2003		3/15/2004	
300392750600	SAN JUAN 29-6 218A	BASIN CB::FRUITLAND COAL	11	NM	RIO ARRIBA	29N	6W	5	D	CONOCOPHILLIPS COMPANY	12/24/2004		3/17/2004	
300392750700	SAN JUAN 29-6 22M	BASIN::DAKOTA	11	NM	RIO ARRIBA	29N	6W	12	J	CONOCOPHILLIPS COMPANY	11/17/2003		3/4/2004	
300392750700	SAN JUAN 29-6 22M	BLANCO::MESAVERDE	11	NM	RIO ARRIBA	29N	6W	12	J	CONOCOPHILLIPS COMPANY	11/17/2003		3/4/2004	
300392750700	SAN JUAN 29-6 UNIT 22M	BLANCO::MESAVERDE	11	NM	RIO ARRIBA	29N	6W	12		CONOCOPHILLIPS COMPANY	11/17/2003			
300392750800	SAN JUAN 29-6 245A FC	BASIN CB::FRUITLAND COAL	11	NM	RIO ARRIBA	29N	6W	8	D	CONOCOPHILLIPS COMPANY	2/2/2004		3/25/2004	
300392750900	SAN JUAN 29-6 78M	BASIN::DAKOTA	11	NM	RIO ARRIBA	29N	6W	22	D	CONOCOPHILLIPS COMPANY	2/14/2004	5/27/2004	5/27/2004	
300392750900	SAN JUAN 29-6 78M	BLANCO::MESAVERDE	11	NM	RIO ARRIBA	29N	6W	22	D	CONOCOPHILLIPS COMPANY	2/14/2004	5/27/2004	5/27/2004	
300392751100	SAN JUAN 29-6 215A	BASIN CB::FRUITLAND COAL	11	NM	RIO ARRIBA	29N	6W	3	C	CONOCOPHILLIPS COMPANY	3/6/2004		4/26/2004	
300392751200	SAN JUAN 29-6 216A	BASIN CB::FRUITLAND COAL	11	NM	RIO ARRIBA	29N	6W	4	D	CONOCOPHILLIPS COMPANY	12/9/2003		2/27/2004	
300392751600	SAN JUAN 29-6 31M	BASIN::DAKOTA	71	NM	RIO ARRIBA	29N	6W	10	K	CONOCOPHILLIPS COMPANY	1/20/2004		4/9/2004	
300392751600	SAN JUAN 29-6 31M	BLANCO::MESAVERDE	11	NM	RIO ARRIBA	29N	6W	10	K	CONOCOPHILLIPS COMPANY	1/20/2004		4/9/2004	
300392751600	SAN JUAN 29-6 UNIT 31M	BLANCO::MESAVERDE	11	NM	RIO ARRIBA	29N	6W	10		CONOCOPHILLIPS COMPANY	1/20/2004			
300392751700	SAN JUAN 29-6 102M	BASIN::DAKOTA	11	NM	RIO ARRIBA	29N	6W	10	O	CONOCOPHILLIPS COMPANY	12/11/2003		3/15/2004	
300392751700	SAN JUAN 29-6 102M	BLANCO::MESAVERDE	11	NM	RIO ARRIBA	29N	6W	10	O	CONOCOPHILLIPS COMPANY	12/11/2003		3/15/2004	
300392751700	SAN JUAN 29-6 UNIT 102M	BLANCO::MESAVERDE	11	NM	RIO ARRIBA					CONOCOPHILLIPS COMPANY	12/11/2003			
300392751900	SAN JUAN 29-6 103M	BASIN::DAKOTA	11	NM	RIO ARRIBA	29N	6W	11	D	CONOCOPHILLIPS COMPANY	12/28/2003		3/15/2004	
300392751900	SAN JUAN 29-6 103M	BLANCO::MESAVERDE	11	NM	RIO ARRIBA	29N	6W	11	D	CONOCOPHILLIPS COMPANY	12/26/2003		3/15/2004	
300392751900	SAN JUAN 29-6 UNIT 103M	BLANCO::MESAVERDE	11	NM	RIO ARRIBA					CONOCOPHILLIPS COMPANY	12/26/2003			
300392752000	SAN JUAN 29-6 89F	BASIN::DAKOTA	11	NM	RIO ARRIBA	29N	6W	11	N	CONOCOPHILLIPS COMPANY	1/8/2004		5/21/2004	
300392752000	SAN JUAN 29-6 89F	BLANCO::MESAVERDE	11	NM	RIO ARRIBA	29N	6W	11	N	CONOCOPHILLIPS COMPANY	1/6/2004		5/21/2004	
300392752000	SAN JUAN 29-6 UNIT 89F	BLANCO::MESAVERDE	11	NM	RIO ARRIBA	29N	6W	11		CONOCOPHILLIPS COMPANY	1/7/2004			

Well Status
San Juan 29-6 Unit
2/25/2016

API	Well Name	Rsvr Name	Production Status	State	County	Township	Range	Section Number	Unit Letter	Oper Name	Spud Date	Completion Date	Initial Production Date	Abandon Date
300392752100	SAN JUAN 29-6 12B MV	BLANCO::MESAVERDE	11	NM	RIO ARRIBA	29N	6W	6	B	CONOCOPHILLIPS COMPANY	11/19/2003		2/23/2004	
300392752100	SAN JUAN 29-6 UNIT 12B	BLANCO::MESAVERDE	11	NM	RIO ARRIBA					CONOCOPHILLIPS COMPANY	11/29/2003			
300392752600	SAN JUAN 29-6 83M	BASIN::DAKOTA	11	NM	RIO ARRIBA	29N	6W	13	C	CONOCOPHILLIPS COMPANY	2/1/2004		5/10/2004	
300392752600	SAN JUAN 29-6 83M	BLANCO::MESAVERDE	11	NM	RIO ARRIBA	29N	6W	13	C	CONOCOPHILLIPS COMPANY	2/1/2004		5/10/2004	
300392752600	SAN JUAN 29-6 UNIT 83M	BLANCO::MESAVERDE	11	NM	RIO ARRIBA					CONOCOPHILLIPS COMPANY	2/1/2004			
300392752700	SAN JUAN 29-6 33M	BASIN::DAKOTA	11	NM	RIO ARRIBA	29N	6W	13	O	CONOCOPHILLIPS COMPANY	1/8/2005		5/17/2005	
300392752700	SAN JUAN 29-6 33M	BLANCO::MESAVERDE	11	NM	RIO ARRIBA	29N	6W	13	O	CONOCOPHILLIPS COMPANY	1/8/2005		5/17/2005	
300392752700	SAN JUAN 29-6 UNIT 33M	BLANCO::MESAVERDE	11	NM	RIO ARRIBA					CONOCOPHILLIPS COMPANY	1/8/2005			
300392752900	SAN JUAN 29-6 109	BASIN::DAKOTA	11	NM	RIO ARRIBA	29N	6W	32	F	CONOCOPHILLIPS COMPANY	3/4/2004		5/26/2004	
300392752900	SAN JUAN 29-6 109	BLANCO::MESAVERDE	11	NM	RIO ARRIBA	29N	6W	32	F	CONOCOPHILLIPS COMPANY	3/4/2004		5/26/2004	
300392752900	SAN JUAN 29-6 UNIT 109	BLANCO::MESAVERDE	11	NM	RIO ARRIBA					CONOCOPHILLIPS COMPANY	3/4/2004			
300392753100	SAN JUAN 29-6 108	BASIN::DAKOTA	11	NM	RIO ARRIBA	29N	6W	31	H	CONOCOPHILLIPS COMPANY	4/7/2004		5/27/2004	
300392753100	SAN JUAN 29-6 108	BLANCO::MESAVERDE	11	NM	RIO ARRIBA	29N	6W	31	H	CONOCOPHILLIPS COMPANY	4/7/2004		5/27/2004	
300392753100	SAN JUAN 29-6 UNIT 108	BLANCO::MESAVERDE	11	NM	RIO ARRIBA					CONOCOPHILLIPS COMPANY	4/7/2004			
300392753200	SAN JUAN 29-6 237A	BASIN CB::FRUITLAND COAL	11	NM	RIO ARRIBA	29N	6W	1	O	CONOCOPHILLIPS COMPANY	1/27/2004	5/3/2004	5/3/2004	
300392753400	SAN JUAN 29-6 236A FC	BASIN CB::FRUITLAND COAL	11	NM	RIO ARRIBA	29N	6W	18	C	CONOCOPHILLIPS COMPANY	1/3/2004		4/13/2004	
300392753600	SAN JUAN 29-6 108M	BASIN::DAKOTA	11	NM	RIO ARRIBA	29N	6W	31	E	CONOCOPHILLIPS COMPANY	3/26/2004		5/19/2004	
300392753600	SAN JUAN 29-6 108M	BLANCO::MESAVERDE	11	NM	RIO ARRIBA	29N	6W	31	E	CONOCOPHILLIPS COMPANY	3/26/2004		5/19/2004	
300392753900	SAN JUAN 29-6 209A FC	BASIN CB::FRUITLAND COAL	11	NM	RIO ARRIBA	29N	6W	17	J	CONOCOPHILLIPS COMPANY	2/14/2004		4/21/2004	
300392754000	SAN JUAN 29-6 208A FC	BASIN CB::FRUITLAND COAL	11	NM	RIO ARRIBA	29N	6W	17	E	CONOCOPHILLIPS COMPANY	2/10/2004		5/13/2004	
300392754100	SAN JUAN 29-6 240A FC	BASIN CB::FRUITLAND COAL	11	NM	RIO ARRIBA	29N	6W	18	I	CONOCOPHILLIPS COMPANY	1/8/2004		3/16/2004	
300392754200	SAN JUAN 29-6 106M	BASIN::DAKOTA	11	NM	RIO ARRIBA	29N	6W	31	J	CONOCOPHILLIPS COMPANY	3/17/2004	5/7/2004	5/7/2004	
300392754200	SAN JUAN 29-6 106M	BLANCO::MESAVERDE	11	NM	RIO ARRIBA	29N	6W	31	J	CONOCOPHILLIPS COMPANY	3/17/2004	5/7/2004	5/7/2004	
300392754200	SAN JUAN 29-6 UNIT 106M	BLANCO::MESAVERDE	11	NM	RIO ARRIBA					CONOCOPHILLIPS COMPANY	3/17/2004	5/3/2004	5/3/2004	
300392754300	SAN JUAN 29-6 239A FC	BASIN CB::FRUITLAND COAL	11	NM	RIO ARRIBA	29N	6W	2	P	CONOCOPHILLIPS COMPANY	12/27/2003		3/19/2004	
300392754400	SAN JUAN 29-6 203A FC	BASIN CB::FRUITLAND COAL	11	NM	RIO ARRIBA	29N	6W	7	E	CONOCOPHILLIPS COMPANY	1/13/2004		5/28/2004	
300392754600	SAN JUAN 29-6 207A FC	BASIN CB::FRUITLAND COAL	11	NM	RIO ARRIBA	29N	6W	2	D	CONOCOPHILLIPS COMPANY	2/24/2004		6/21/2004	
300392755200	SAN JUAN 29-6 33F	BASIN::DAKOTA	11	NM	RIO ARRIBA	29N	6W	13	G	CONOCOPHILLIPS COMPANY	3/28/2005		8/26/2005	
300392755200	SAN JUAN 29-6 33F	BLANCO::MESAVERDE	11	NM	RIO ARRIBA	29N	6W	13	G	CONOCOPHILLIPS COMPANY	3/28/2005		8/26/2005	
300392755200	SAN JUAN 29-6 UNIT 33F	BASIN::DAKOTA	11	NM	RIO ARRIBA					CONOCOPHILLIPS COMPANY	3/28/2005			
300392755200	SAN JUAN 29-6 UNIT 33F	BLANCO::MESAVERDE	11	NM	RIO ARRIBA					CONOCOPHILLIPS COMPANY	3/28/2005			
300392755300	SAN JUAN 29-6 75M	BASIN::DAKOTA	11	NM	RIO ARRIBA	29N	6W	23	P	CONOCOPHILLIPS COMPANY	12/6/2004		4/1/2005	

Well Status
San Juan 29-6 Unit
2/25/2016

API	Well Name	Rsvr Name	Production Status	State	County	Township	Range	Section Number	Unit Letter	Oper Name	Spud Date	Completion Date	Initial Production Date	Abandon Date
300392755300	SAN JUAN 29-6 75M	BLANCO::MESAVERDE	11	NM	RIO ARRIBA	29N	6W	23	P	CONOCOPHILLIPS COMPANY	12/6/2004		4/1/2005	
300392755300	SAN JUAN 29-6 UNIT 75M	BLANCO::MESAVERDE	11	NM	RIO ARRIBA					CONOCOPHILLIPS COMPANY	12/6/2004			
300392755400	SAN JUAN 29-6 88M	BASIN::DAKOTA	11	NM	RIO ARRIBA	29N	6W	33	F	CONOCOPHILLIPS COMPANY	1/22/2006	3/23/2006	5/3/2006	
300392755400	SAN JUAN 29-6 88M	BLANCO::MESAVERDE	11	NM	RIO ARRIBA	29N	6W	33	F	CONOCOPHILLIPS COMPANY	1/22/2006	3/23/2006	5/3/2006	
300392755400	SAN JUAN 29-6 UNIT 88M	BLANCO::MESAVERDE	11	NM	RIO ARRIBA					CONOCOPHILLIPS COMPANY	1/19/2006			
300392755500	SAN JUAN 29-6 92M	BASIN::DAKOTA	11	NM	RIO ARRIBA	29N	6W	12	C	CONOCOPHILLIPS COMPANY	10/30/2004	2/14/2005	3/29/2005	
300392755500	SAN JUAN 29-6 92M	BLANCO::MESAVERDE	11	NM	RIO ARRIBA	29N	6W	12	C	CONOCOPHILLIPS COMPANY	10/30/2004	2/14/2005	3/29/2005	
300392755500	SAN JUAN 29-6 UNIT 92M	BLANCO::MESAVERDE	11	NM	RIO ARRIBA					CONOCOPHILLIPS COMPANY	10/30/2004			
300392755900	SAN JUAN 29-6 80M	BASIN::DAKOTA	11	NM	RIO ARRIBA	29N	6W	24	O	CONOCOPHILLIPS COMPANY	12/15/2004		4/22/2005	
300392755900	SAN JUAN 29-6 80M	BLANCO::MESAVERDE	11	NM	RIO ARRIBA	29N	6W	24	O	CONOCOPHILLIPS COMPANY	12/15/2004		4/22/2005	
300392755900	SAN JUAN 29-6 UNIT 80M	BLANCO::MESAVERDE	11	NM	RIO ARRIBA					CONOCOPHILLIPS COMPANY	12/15/2004			
300392756000	SAN JUAN 29-6 90M	BASIN::DAKOTA	11	NM	RIO ARRIBA	29N	6W	15	C	CONOCOPHILLIPS COMPANY	12/12/2004		5/11/2005	
300392756000	SAN JUAN 29-6 90M	BLANCO::MESAVERDE	11	NM	RIO ARRIBA	29N	6W	15	C	CONOCOPHILLIPS COMPANY	12/12/2004		5/11/2005	
300392756000	SAN JUAN 29-6 UNIT 90M	BLANCO::MESAVERDE	11	NM	RIO ARRIBA					CONOCOPHILLIPS COMPANY	12/12/2004			
300392756100	SAN JUAN 29-6 242A FC	BASIN CB::FRUITLAND COAL	11	NM	RIO ARRIBA	29N	6W	19	C	CONOCOPHILLIPS COMPANY	2/10/2004	3/10/2004	4/14/2004	
300392756200	SAN JUAN 29-6 214A	BASIN CB::FRUITLAND COAL	11	NM	SAN JUAN	29N	6W	3	P	CONOCOPHILLIPS COMPANY	2/29/2004		5/21/2004	
300392756800	SAN JUAN 29-6 107M	BASIN::DAKOTA	11	NM	RIO ARRIBA	29N	6W	36	C	CONOCOPHILLIPS COMPANY	11/17/2004		2/24/2005	
300392756800	SAN JUAN 29-6 107M	BLANCO::MESAVERDE	11	NM	RIO ARRIBA	29N	6W	36	C	CONOCOPHILLIPS COMPANY	11/17/2004		2/24/2005	
300392757300	SAN JUAN 29-6 79M	BASIN::DAKOTA	11	NM	RIO ARRIBA	29N	6W	24	F	CONOCOPHILLIPS COMPANY	12/28/2004		5/11/2005	
300392757300	SAN JUAN 29-6 79M	BLANCO::MESAVERDE	11	NM	RIO ARRIBA	29N	6W	24	F	CONOCOPHILLIPS COMPANY	12/28/2004		5/11/2005	
300392757300	SAN JUAN 29-6 UNIT 79M	BLANCO::MESAVERDE	11	NM	RIO ARRIBA					CONOCOPHILLIPS COMPANY	12/28/2004			
300392758100	SAN JUAN 29-6 89M	BASIN::DAKOTA	72	NM	RIO ARRIBA	29N	6W	11	J	CONOCOPHILLIPS COMPANY	11/11/2004			12/13/2004
300392758100	SAN JUAN 29-6 89M	BLANCO::MESAVERDE	72	NM	RIO ARRIBA	29N	6W	11	J	CONOCOPHILLIPS COMPANY	11/11/2004			12/13/2004
300392758200	SAN JUAN 29-6 104M	BASIN::DAKOTA	11	NM	RIO ARRIBA	29N	6W	14	O	CONOCOPHILLIPS COMPANY	11/8/2004		2/10/2005	
300392758200	SAN JUAN 29-6 104M	BLANCO::MESAVERDE	11	NM	RIO ARRIBA	29N	6W	14	O	CONOCOPHILLIPS COMPANY	11/8/2004		2/10/2005	
300392759200	SAN JUAN 29-6 UNIT 104M	BLANCO::MESAVERDE	11	NM	RIO ARRIBA	29N	6W	14		CONOCOPHILLIPS COMPANY	11/7/2004	1/14/2005	2/10/2005	
300392759900	SAN JUAN 29-6 17C	BLANCO::MESAVERDE	11	NM	RIO ARRIBA	29N	6W	1	O	CONOCOPHILLIPS COMPANY	10/30/2004		12/20/2004	
300392759900	SAN JUAN 29-6 UNIT 17C	BLANCO::MESAVERDE	11	NM	RIO ARRIBA					CONOCOPHILLIPS COMPANY	10/30/2004			
300392762300	SAN JUAN 29-6 90F	BASIN::DAKOTA	11	NM	RIO ARRIBA	29N	6W	15	A	CONOCOPHILLIPS COMPANY	11/28/2004		4/14/2005	
300392762300	SAN JUAN 29-6 90F	BLANCO::MESAVERDE	11	NM	RIO ARRIBA	29N	6W	15	A	CONOCOPHILLIPS COMPANY	11/28/2004		4/14/2005	
300392762300	SAN JUAN 29-6 UNIT 90F	BASIN::DAKOTA	11	NM	RIO ARRIBA					CONOCOPHILLIPS COMPANY	11/28/2004			
300392762300	SAN JUAN 29-6 UNIT 90F	BLANCO::MESAVERDE	11	NM	RIO ARRIBA					CONOCOPHILLIPS COMPANY	11/28/2004			

Well Status
San Juan 29-6 Unit
2/25/2016

API	Well Name	Rsvr Name	Production Status	State	County	Township	Range	Section Number	Unit Letter	Oper Name	Spud Date	Completion Date	Initial Production Date	Abandon Date
300392783500	SAN JUAN 29-6 210A	BASIN CB::FRUITLAND COAL	11	NM	RIO ARRIBA	29N	6W	20	C	CONOCOPHILLIPS COMPANY	9/17/2004		1/24/2005	
300392785500	SAN 29-6 205A FC	BASIN CB::FRUITLAND COAL	11	NM	RIO ARRIBA	29N	6W	21	C	CONOCOPHILLIPS COMPANY	10/14/2004		3/10/2005	
300392785900	SAN JUAN 29-6 221A	BASIN CB::FRUITLAND COAL	11	NM	RIO ARRIBA	29N	6W	11	E	CONOCOPHILLIPS COMPANY	10/28/2004		3/31/2005	
300392786400	SAN JUAN 29-6 62B	BLANCO::MESAVARDE	11	NM	RIO ARRIBA	29N	6W	4	G	CONOCOPHILLIPS COMPANY	3/21/2005		8/10/2005	
300392786400	SAN JUAN 29-6 UNIT 62B	BLANCO::MESAVARDE	11	NM	RIO ARRIBA					CONOCOPHILLIPS COMPANY	3/21/2005			
300392787000	SAN JUAN 29-6 241A FC	BASIN CB::FRUITLAND COAL	11	NM	RIO ARRIBA	29N	6W	19	J	CONOCOPHILLIPS COMPANY	9/13/2004	3/29/2005	3/29/2005	
300392923100	SAN JUAN 29-6 58C	BLANCO::MESAVARDE	11	NM	RIO ARRIBA	29N	6W	28	F	CONOCOPHILLIPS COMPANY	1/16/2005		4/18/2005	
300392923100	SAN JUAN 29-6 UNIT 58C	BLANCO::MESAVARDE	11	NM	RIO ARRIBA					CONOCOPHILLIPS COMPANY	1/16/2005			
300392927600	SAN JUAN 29-6 11B	BLANCO::MESAVARDE	11	NM	RIO ARRIBA	29N	6W	7	C	CONOCOPHILLIPS COMPANY	12/6/2005	2/22/2006	3/14/2006	
300392927600	SAN JUAN 29-6 UNIT 11B	BLANCO::MESAVARDE	11	NM	RIO ARRIBA					CONOCOPHILLIPS COMPANY	12/7/2005			
300392927900	SAN JUAN 29-6 220A FC	BASIN CB::FRUITLAND COAL	11	NM	RIO ARRIBA	29N	6W	11	O	CONOCOPHILLIPS COMPANY	11/2/2004		3/21/2005	
300392933100	SAN JUAN 29-6 64M	BASIN::DAKOTA	11	NM	RIO ARRIBA	29N	6W	9	J	CONOCOPHILLIPS COMPANY	12/23/2004		5/18/2005	
300392933100	SAN JUAN 29-6 64M	BLANCO::MESAVARDE	11	NM	RIO ARRIBA	29N	6W	9	J	CONOCOPHILLIPS COMPANY	12/23/2004		5/18/2005	
300392933100	SAN JUAN 29-6 UNIT 64M DK	BASIN::DAKOTA	11	NM	RIO ARRIBA					CONOCOPHILLIPS COMPANY	12/23/2004			
300392933100	SAN JUAN 29-6 UNIT 64M DK	BLANCO::MESAVARDE	11	NM	RIO ARRIBA					CONOCOPHILLIPS COMPANY	12/23/2004			
300392933700	SAN JUAN 29-6 6C	BLANCO::MESAVARDE	11	NM	RIO ARRIBA	29N	8W	21	M	CONOCOPHILLIPS COMPANY	3/12/2005		9/14/2005	
300392933700	SAN JUAN 29-6 UNIT 6C	BLANCO::MESAVARDE	11	NM	RIO ARRIBA					CONOCOPHILLIPS COMPANY	3/12/2005			
300392935000	SAN JUAN 29-6 54C	BLANCO::MESAVARDE	11	NM	RIO ARRIBA	29N	6W	4	C	CONOCOPHILLIPS COMPANY	3/31/2005		9/26/2005	
300392935000	SAN JUAN 29-6 UNIT 54C	BLANCO::MESAVARDE	11	NM	RIO ARRIBA					CONOCOPHILLIPS COMPANY	3/29/2005			
300392935900	SAN JUAN 29-6 55B	BLANCO::MESAVARDE	11	NM	RIO ARRIBA	29N	6W	18	N	CONOCOPHILLIPS COMPANY	11/23/2005	1/1/2006	5/16/2006	
300392935900	SAN JUAN 29-6 UNIT 55B	BLANCO::MESAVARDE	11	NM	RIO ARRIBA					CONOCOPHILLIPS COMPANY	11/26/2005			
300392936000	SAN JUAN 29-6 55C	BLANCO::MESAVARDE	11	NM	RIO ARRIBA	29N	6W	18	F	CONOCOPHILLIPS COMPANY	11/5/2005	2/14/2006	5/18/2006	
300392936000	SAN JUAN 29-6 UNIT 55C	BLANCO::MESAVARDE	11	NM	RIO ARRIBA					CONOCOPHILLIPS COMPANY	11/5/2005			
300392941000	SAN JUAN 29-6 14B	BLANCO::MESAVARDE	11	NM	RIO ARRIBA	29N	6W	7	G	CONOCOPHILLIPS COMPANY	12/21/2005	2/22/2006	4/3/2006	
300392941000	SAN JUAN 29-6 UNIT 14B	BLANCO::MESAVARDE	11	NM	RIO ARRIBA					CONOCOPHILLIPS COMPANY	12/22/2005			
300392943000	SAN JUAN 29-6 1B	BLANCO::MESAVARDE	11	NM	RIO ARRIBA	29N	6W	3	B	CONOCOPHILLIPS COMPANY	3/6/2007	7/16/2007	7/30/2007	
300392943400	SAN JUAN 29-6 UNIT 62C	BLANCO::MESAVARDE	11	NM	RIO ARRIBA	29N	6W	4	I	CONOCOPHILLIPS COMPANY	4/18/2005	9/23/2005	9/23/2005	
300392943400	SAN JUAN 29-6 UNIT 62C	BLANCO::MESAVARDE	11	NM	RIO ARRIBA					CONOCOPHILLIPS COMPANY	4/18/2005			
300392945200	SAN JUAN 29-6 63C	BLANCO::MESAVARDE	11	NM	RIO ARRIBA					CONOCOPHILLIPS COMPANY	4/28/2006			
300392945200	SAN JUAN 29-6 UNIT 63C	BLANCO::MESAVARDE	11	NM	RIO ARRIBA	29N	6W	30		CONOCOPHILLIPS COMPANY	4/28/2006	6/9/2006	8/15/2006	
300392945400	SAN JUAN 29-6 19B	BLANCO::MESAVARDE	11	NM	RIO ARRIBA	29N	6W	8	H	CONOCOPHILLIPS COMPANY	3/9/2007	8/3/2007	8/13/2007	
300392946300	SAN JUAN 29-6 59B	BLANCO::MESAVARDE	11	NM	RIO ARRIBA					CONOCOPHILLIPS COMPANY	3/18/2006			

Well Status
San Juan 29-6 Unit
2/25/2016

API	Well Name	Rsvr Name	Production Status	State	County	Township	Range	Section Number	Unit Letter	Oper Name	Spud Date	Completion Date	Initial Production Date	Abandon Date
300392946300	SAN JUAN 29-6 UNIT 59B	BLANCO::MESAVERDE	11	NM	RIO ARRIBA	29N	6W	5		CONOCOPHILLIPS COMPANY	3/18/2006	5/16/2006	6/20/2006	
300392946600	SAN JUAN 29-6 29C	BLANCO::MESAVERDE	11	NM	RIO ARRIBA	29N	6W	3	L	CONOCOPHILLIPS COMPANY	4/9/2005		9/26/2005	
300392946600	SAN JUAN 29-6 UNIT 29C	BLANCO::MESAVERDE	11	NM	RIO ARRIBA					CONOCOPHILLIPS COMPANY	4/9/2005			
300392951600	SAN JUAN 29-6 91F	BASIN::DAKOTA	11	NM	RIO ARRIBA	29N	6W	21	B	CONOCOPHILLIPS COMPANY	2/23/2007	6/8/2007	5/31/2007	
300392951600	SAN JUAN 29-6 91F	BLANCO::MESAVERDE	11	NM	RIO ARRIBA	29N	6W	21	B	CONOCOPHILLIPS COMPANY	2/23/2007	6/8/2007	5/23/2007	
300392952100	SAN JUAN 29-6 18C	BLANCO::MESAVERDE	11	NM	RIO ARRIBA					CONOCOPHILLIPS COMPANY	2/26/2006			
300392952100	SAN JUAN 29-6 UNIT 18C	BLANCO::MESAVERDE	11	NM	RIO ARRIBA	29N	6W	5	D	CONOCOPHILLIPS COMPANY	2/26/2006	4/26/2006	5/25/2006	
300392952200	SAN JUAN 29-6 20B	BLANCO::MESAVERDE	11	NM	RIO ARRIBA	29N	6W	8		CONOCOPHILLIPS COMPANY	3/8/2006	4/21/2006	5/19/2006	
300392952200	SAN JUAN 29-6 UNIT	BLANCO::MESAVERDE	11	NM	RIO ARRIBA					CONOCOPHILLIPS COMPANY	3/9/2006			
300392953200	SAN JUAN 29-6 19C	BLANCO::MESAVERDE	11	NM	RIO ARRIBA					CONOCOPHILLIPS COMPANY	1/6/2006			
300392953200	SAN JUAN 29-6 UNIT 19C	BLANCO::MESAVERDE	11	NM	RIO ARRIBA	29N	6W	8		CONOCOPHILLIPS COMPANY	1/7/2006	3/8/2006	3/30/2006	
300392953300	SAN JUAN 29-6 66B	BLANCO::MESAVERDE	11	NM	RIO ARRIBA	29N	6W	9	M	CONOCOPHILLIPS COMPANY	11/1/2006	1/10/2007	1/23/2007	
300392956300	SAN JUAN 29-6 68C	BLANCO::MESAVERDE	11	NM	RIO ARRIBA	29N	6W	29	I	CONOCOPHILLIPS COMPANY	4/9/2006	5/26/2006	7/14/2006	
300392956300	SAN JUAN 29-6 UNIT 68C	BLANCO::MESAVERDE	11	NM	RIO ARRIBA					CONOCOPHILLIPS COMPANY	4/9/2006			
300392960600	SAN JUAN 29-6 211A	BASIN CB::FRUITLAND COAL	11	NM	RIO ARRIBA	29N	6W	20		CONOCOPHILLIPS COMPANY	10/14/2005	12/10/2005	1/10/2005	
300392961800	SAN JUAN 29-6 61B	BLANCO::MESAVERDE	11	NM	RIO ARRIBA	29N	6W	19		CONOCOPHILLIPS COMPANY	4/2/2006	5/18/2006	6/22/2006	
300392961800	SAN JUAN 29-6 UNIT 61B	BLANCO::MESAVERDE	11	NM	RIO ARRIBA					CONOCOPHILLIPS COMPANY	4/4/2006			
300392969400	SAN JUAN 29-6 74C	BLANCO::MESAVERDE	11	NM	RIO ARRIBA	29N	6W	20		CONOCOPHILLIPS COMPANY	2/11/2006	4/12/2006	5/16/2006	
300392969400	SAN JUAN 29-6 UNIT 74C	BLANCO::MESAVERDE	11	NM	RIO ARRIBA					CONOCOPHILLIPS COMPANY	2/11/2006			
300392972800	SAN JUAN 29-6 107F	BASIN::DAKOTA	11	NM	RIO ARRIBA	29N	6W	36		CONOCOPHILLIPS COMPANY	4/19/2006	6/13/2006	7/5/2006	
300392972800	SAN JUAN 29-6 107F	BLANCO::MESAVERDE	11	NM	RIO ARRIBA	29N	6W	36		CONOCOPHILLIPS COMPANY	4/19/2006	6/13/2006	7/5/2006	
300392972800	SAN JUAN 29-6 UNIT 107F	BASIN::DAKOTA	11	NM	RIO ARRIBA					CONOCOPHILLIPS COMPANY	4/19/2006			
300392972800	SAN JUAN 29-6 UNIT 107F	BLANCO::MESAVERDE	11	NM	RIO ARRIBA					CONOCOPHILLIPS COMPANY	4/19/2006			
300392973500	SAN JUAN 29-6 54B	BLANCO::MESAVERDE	11	NM	RIO ARRIBA	29N	6W	4	N	CONOCOPHILLIPS COMPANY	3/27/2006	5/3/2006	6/21/2006	
300392974900	SAN JUAN 29-6 75F	BASIN::DAKOTA	11	NM	RIO ARRIBA	29N	6W	23	A	CONOCOPHILLIPS COMPANY	12/11/2006	3/15/2007	3/20/2007	
300392974900	SAN JUAN 29-6 75F	BLANCO::MESAVERDE	11	NM	RIO ARRIBA	29N	6W	23	A	CONOCOPHILLIPS COMPANY	12/11/2006	3/15/2007	3/20/2007	
300392975000	SAN JUAN 29-6 14C	BLANCO::MESAVERDE	11	NM	RIO ARRIBA	29N	6W	7	O	CONOCOPHILLIPS COMPANY	1/12/2006	1/18/2007	1/18/2007	
300392975100	SAN JUAN 29-6 8M	BASIN::DAKOTA	11	NM	RIO ARRIBA	29N	6W	1	M	CONOCOPHILLIPS COMPANY	4/9/2006	7/29/2006	8/4/2006	
300392975100	SAN JUAN 29-6 8M	BLANCO::MESAVERDE	11	NM	RIO ARRIBA	29N	6W	1	M	CONOCOPHILLIPS COMPANY	4/9/2006	7/29/2006	8/4/2006	
300392975200	SAN JUAN 29-6 35F	BASIN::DAKOTA	11	NM	RIO ARRIBA	29N	6W	15	L	CONOCOPHILLIPS COMPANY	12/15/2006	5/14/2007	5/18/2007	
300392975200	SAN JUAN 29-6 35F	BLANCO::MESAVERDE	11	NM	RIO ARRIBA	29N	6W	15	L	CONOCOPHILLIPS COMPANY	12/15/2006	5/14/2007	5/18/2007	
300392975300	SAN JUAN 29-6 6B	BLANCO::MESAVERDE	11	NM	RIO ARRIBA	29N	6W	21		CONOCOPHILLIPS COMPANY	12/21/2006	6/14/2007	6/12/2007	

Well Status
San Juan 29-6 Unit
2/25/2016

API	Well Name	Rsvr Name	Production Status	State	County	Township	Range	Section Number	Unit Letter	Oper Name	Spud Date	Completion Date	Initial Production Date	Abandon Date
300392975700	SAN JUAN 29-6 22N	BASIN::DAKOTA	11	NM	RIO ARRIBA	29N	6W	12	G	CONOCOPHILLIPS COMPANY	3/28/2008	9/5/2008	9/9/2008	
300392975700	SAN JUAN 29-6 22N	BLANCO::MESAVERDE	11	NM	RIO ARRIBA	29N	6W	12	G	CONOCOPHILLIPS COMPANY	3/28/2008	9/5/2008	9/9/2008	
300392976400	SAN JUAN 29-6 63B	BLANCO::MESAVERDE	11	NM	RIO ARRIBA	29N	6W	30	H	CONOCOPHILLIPS COMPANY	12/13/2006	2/6/2007	2/21/2007	
300392976500	SAN JUAN 29-6 60C	BLANCO::MESAVERDE	11	NM	RIO ARRIBA	29N	6W	18	I	CONOCOPHILLIPS COMPANY	12/6/2006	2/14/2007	4/4/2007	
300392980800	SAN JUAN 29-6 UNIT 65C	BLANCO::MESAVERDE	11	NM	RIO ARRIBA	29N	6W	19	B	CONOCOPHILLIPS COMPANY	1/31/2007	6/22/2007	6/21/2007	
300392986300	SAN JUAN 29-6 81F	BASIN::DAKOTA	11	NM	RIO ARRIBA	29N	6W	25	M	CONOCOPHILLIPS COMPANY	12/28/2006	4/23/2007	4/19/2007	
300392986300	SAN JUAN 29-6 81F	BLANCO::MESAVERDE	11	NM	RIO ARRIBA	29N	6W	25	M	CONOCOPHILLIPS COMPANY	12/28/2006	4/23/2007	5/1/2007	
300392986600	SAN JUAN 29-6 76F	BASIN::DAKOTA	11	NM	RIO ARRIBA	29N	6W	23	L	CONOCOPHILLIPS COMPANY	3/13/2007	7/30/2007	7/30/2007	
300392986600	SAN JUAN 29-6 76F	BLANCO::MESAVERDE	11	NM	RIO ARRIBA	29N	6W	23	L	CONOCOPHILLIPS COMPANY	3/13/2007	7/30/2007	7/25/2007	
300392986700	SAN JUAN 29-6 71C	BLANCO::MESAVERDE	11	NM	RIO ARRIBA	29N	6W	16	L	CONOCOPHILLIPS COMPANY	3/13/2007	7/10/2007	7/9/2007	
300392986800	SAN JUAN 29-6 59C	BLANCO::MESAVERDE	11	NM	RIO ARRIBA	29N	6W	5	O	CONOCOPHILLIPS COMPANY	3/5/2007	7/20/2007	7/26/2007	
300392987000	SAN JUAN 29-6 UNIT 64B	BLANCO::MESAVERDE	11	NM	RIO ARRIBA	29N	6W	9	B	CONOCOPHILLIPS COMPANY	11/22/2006	1/29/2007	2/7/2007	
300392992300	SAN JUAN 29-6 74B	BLANCO::MESAVERDE	11	NM	RIO ARRIBA	29N	6W	20	J	CONOCOPHILLIPS COMPANY	12/18/2006	7/9/2007	8/7/2007	
300392993000	SAN JUAN 29-6 UNIT 11C	BLANCO::MESAVERDE	11	NM	RIO ARRIBA	29N	6W	7		CONOCOPHILLIPS COMPANY	12/20/2006	4/11/2007	4/24/2007	
300393012700	SAN JUAN 29-6 4B	BLANCO::MESAVERDE	11	NM	RIO ARRIBA	29N	6W	17	D	CONOCOPHILLIPS COMPANY	3/14/2007	6/29/2007	9/19/2007	
300393013301	SAN JUAN 29-6 71M	BASIN::DAKOTA	11	NM	RIO ARRIBA	29N	6W	17	B	CONOCOPHILLIPS COMPANY	4/11/2007	7/20/2007	7/19/2007	
300393013301	SAN JUAN 29-6 71M	BLANCO::MESAVERDE	11	NM	RIO ARRIBA	29N	6W	17	B	CONOCOPHILLIPS COMPANY	4/11/2007	7/20/2007	7/17/2007	
300393014500	SAN JUAN 29-6 89R	BASIN::DAKOTA	11	NM	RIO ARRIBA	29N	6W	11	J	CONOCOPHILLIPS COMPANY	3/5/2007	8/1/2007	8/8/2007	
300393014500	SAN JUAN 29-6 89R	BLANCO::MESAVERDE	11	NM	RIO ARRIBA	29N	6W	11	J	CONOCOPHILLIPS COMPANY	3/5/2007	8/1/2007	8/8/2007	
300393023300	SAN JUAN 29-6 109M	BASIN::DAKOTA	11	NM	RIO ARRIBA	29N	6W	32	E	CONOCOPHILLIPS COMPANY	5/11/2007	8/13/2007	8/13/2007	
300393023300	SAN JUAN 29-6 109M	BLANCO::MESAVERDE	11	NM	RIO ARRIBA	29N	6W	32	E	CONOCOPHILLIPS COMPANY	5/11/2007	8/13/2007	8/13/2007	
300393038500	SAN JUAN 29-6 13C MV	BLANCO::MESAVERDE	11	NM	RIO ARRIBA	29N	6W	7	B	CONOCOPHILLIPS COMPANY	1/31/2008	4/7/2008	4/24/2008	
300393038500	SAN JUAN 29-6 UNIT 13C	BLANCO::MESAVERDE	11	NM	RIO ARRIBA	29N	6W	6		CONOCOPHILLIPS COMPANY	1/24/2008	4/7/2008	4/7/2008	
300393044700	SAN JUAN 29-6 UNIT 65B	BLANCO::MESAVERDE	11	NM	RIO ARRIBA	29N	6W	19	I	CONOCOPHILLIPS COMPANY	10/27/2008	3/6/2009	6/1/2009	
300393049700	SAN JUAN 29-6 60M	BASIN::DAKOTA	11	NM	RIO ARRIBA	29N	6W	18	F	CONOCOPHILLIPS COMPANY	4/21/2008	4/8/2009	5/27/2009	
300393049700	SAN JUAN 29-6 60M	BLANCO::MESAVERDE	11	NM	RIO ARRIBA	29N	6W	18	F	CONOCOPHILLIPS COMPANY	4/21/2008	4/8/2009	5/27/2009	
300393066400	SAN JUAN 29-6 UNIT 5N	BASIN::DAKOTA	11	NM	RIO ARRIBA	29N	7W	25	H	CONOCOPHILLIPS COMPANY	5/10/2010	7/28/2010	8/24/2010	
300393066400	SAN JUAN 29-6 UNIT 5N	BLANCO::MESAVERDE	11	NM	RIO ARRIBA	29N	7W	25	H	CONOCOPHILLIPS COMPANY	5/10/2010	7/28/2010	8/24/2010	
300393070600	SAN JUAN 29-6 UNIT 4M	BASIN::DAKOTA	11	NM	RIO ARRIBA	29N	6W	17	F	CONOCOPHILLIPS COMPANY	10/20/2009	2/2/2010	2/2/2010	
300393070600	SAN JUAN 29-6 UNIT 4M	BLANCO::MESAVERDE	11	NM	RIO ARRIBA	29N	6W	17	F	CONOCOPHILLIPS COMPANY	10/20/2009	2/2/2010	2/2/2010	
300393072100	SAN JUAN 29-6 UNIT 101N	BASIN::DAKOTA	11	NM	RIO ARRIBA	29N	6W	36	H	CONOCOPHILLIPS COMPANY	12/12/2009	3/25/2010	3/25/2010	
300393072100	SAN JUAN 29-6 UNIT 101N	BLANCO::MESAVERDE	11	NM	RIO ARRIBA	29N	6W	36	H	CONOCOPHILLIPS COMPANY	12/12/2009	3/25/2010	3/25/2010	



Aubrey Dunn
COMMISSIONER

State of New Mexico
Commissioner of Public Lands

310 OLD SANTA FE TRAIL
P.O. BOX 1148
SANTA FE, NEW MEXICO 87504-1148

COMMISSIONER'S OFFICE

Phone (505) 827-5760
Fax (505) 827-5766
www.nmstatelands.org

March 9, 2015

Conoco Phillips
San Juan Business Unit
PO Box 4289
Farmington, NM 87499-4289

Attn: Mr. Cameron Ming

Re: 2015 Plan of Development
San Juan 29-6 Unit
Rio Arriba County, New Mexico

Dear Mr. Ming:

The Commissioner of Public Lands has, of this date, approved the referenced Plan of Development. Our approval is subject to like approval by all other appropriate agencies. The possibility of drainage by wells outside the unit area, and the need for further development of the unit may exist; therefore, we may contact you at a later date regarding these possibilities.

If you have any questions or if we may be of further help, please contact Pete Martinez at (505)-827-5791.

Very truly yours,

AUBREY DUNN
COMMISSIONER OF PUBLIC LANDS

BY: 
TERRY WARNELL, Director
Oil, Gas and Minerals Division
AD/TW/sk
xc: Reader File
OCD-Daniel Sanchez
BLM Farmington – Cynthia Marquez

Well Status
San Juan 29-6 Unit
2/25/2016

API	Well Name	Rsvr Name	Production Status	State	County	Township	Range	Section Number	Unit Letter	Oper Name	Spud Date	Completion Date	Initial Production Date	Abandon Date
300393074800	SAN JUAN 29-6 UNIT 5M	BASIN::DAKOTA	11	NM	RIO ARRIBA	29N	6W	30	N	CONOCOPHILLIPS COMPANY	9/27/2010	12/13/2010	12/13/2010	
300393074800	SAN JUAN 29-6 UNIT 5M	BLANCO::MESAVERDE	11	NM	RIO ARRIBA	29N	6W	30	N	CONOCOPHILLIPS COMPANY	9/27/2010	12/13/2010	12/13/2010	
300393092900	SAN JUAN 29-6 UNIT 20C	BASIN::DAKOTA	11	NM	RIO ARRIBA	29N	6W	8	L	CONOCOPHILLIPS COMPANY	10/28/2010	2/8/2011	3/29/2011	
300393092900	SAN JUAN 29-6 UNIT 20C	BLANCO::MESAVERDE	11	NM	RIO ARRIBA	29N	6W	8	L	CONOCOPHILLIPS COMPANY	10/28/2010	2/8/2011	2/7/2011	
300393098500	SAN JUAN 29-6 UNIT 61M	BASIN::DAKOTA	11	NM	RIO ARRIBA	29N	6W	19	K	CONOCOPHILLIPS COMPANY	3/30/2011	6/2/2011	6/7/2011	
300393098500	SAN JUAN 29-6 UNIT 61M	BLANCO::MESAVERDE	11	NM	RIO ARRIBA	29N	6W	19	K	CONOCOPHILLIPS COMPANY	3/30/2011	6/2/2011	6/7/2011	
300396007000	SAN JUAN 29-8 43	BLANCO::MESAVERDE	11	NM	RIO ARRIBA	29N	6W	26	G	CONOCOPHILLIPS COMPANY	1/28/1958			
300398238800	SAN JUAN 29-8 35	BASIN::DAKOTA	11	NM	RIO ARRIBA	29N	6W	15	M	CONOCOPHILLIPS COMPANY	8/20/1960			
300398238800	SAN JUAN 29-8 35	BLANCO::MESAVERDE	11	NM	RIO ARRIBA	29N	6W	15	M	CONOCOPHILLIPS COMPANY	8/20/1960			
NO API	SAN JUAN 29-6 WATER WELL1	UNK::SHALLOW	11	NM	RIO ARRIBA	29N	6W	28		BURLINGTON RESOURCES O&G CO LP		2/4/1970		
	SAN JUAN 29-6 UNIT 47M	BASIN::DAKOTA	71	NM	RIO ARRIBA					CONOCOPHILLIPS COMPANY	1/1/1985			