

Tract 3	Tract 2	Tract 1B	Tract 1A

**BEFORE THE OIL CONVERSION  
DIVISION**  
Santa Fe, New Mexico  
**Exhibit No. 3**  
Submitted by: **COG OPERATING LLC**  
Hearing Date: August 4, 2016

Halberd 27 State Com 1H and Halberd 27 State Com 21H ORRI Breakdown  
S2S2 of Section 27, T17S-R28E, Eddy County, NM  
Ownership as to each Tract From Top of Glorieta to 4,000' Subsurface/4,000' Subsurface to Top of Abo Formation

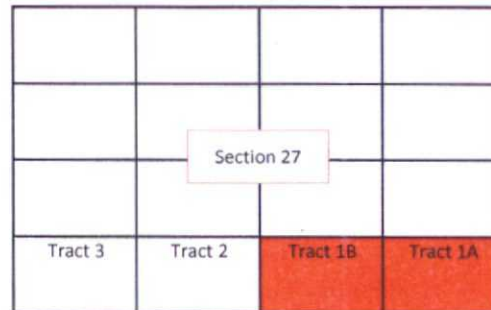

**ORRI Interest from Top of Glorieta to 4,000' Subsurface**

**Tract 1A: SESE**

The Wright Company 8.203130%

**Tract 1B: SWSE**

Bud F. Walker 2.916600%

Ernest Byron Hailey, III 0.972200%

Michael Lee Hailey 0.972200%

Marjorie Ann Estevis 0.972200%

**Tract 2: SESW**

Manix Royalty Ltd. 1.250000%

**Tract 3: SWSW**

COG Operating LLC 23.750000%

Concho Oil & Gas LLC 1.250000%

**Unit ORRI**

The Wright Company 2.050700%

Bud F. Walker 0.729100%

Ernest Byron Hailey, III 0.243000%

Michael Lee Hailey 0.243000%

Marjorie Ann Estevis 0.243000%

Manix Royalty Ltd. 0.312500%

COG Operating LLC 5.937500%

Concho Oil & Gas LLC 0.312500%

= Parties COG is seeking to Force Pool  
 = Differences in ownership

**ORRI Interest from 4,000' Subsurface to Top of Abo Formation**

**Tract 1A: SESE**

The Wright Company 10.937500%

**Tract 1B: SWSE**

Bud F. Walker 1.749900%

Ernest Byron Hailey, III 0.583200%

Michael Lee Hailey 0.583200%

Marjorie Ann Estevis 0.583200%

**Tract 2: SESW**

Manix Royalty Ltd. 1.250000%

**Tract 3: SWSW**

COG Operating LLC 23.750000%

Concho Oil & Gas LLC 1.250000%

**Unit ORRI**

The Wright Company 2.734300%

Bud F. Walker 0.437400%

Ernest Byron Hailey, III 0.145800%

Michael Lee Hailey 0.145800%

Marjorie Ann Estevis 0.145800%

Manix Royalty Ltd. 0.312500%

COG Operating LLC 5.937500%

Concho Oil & Gas LLC 0.312500%