

R 15 W

T  
30  
N

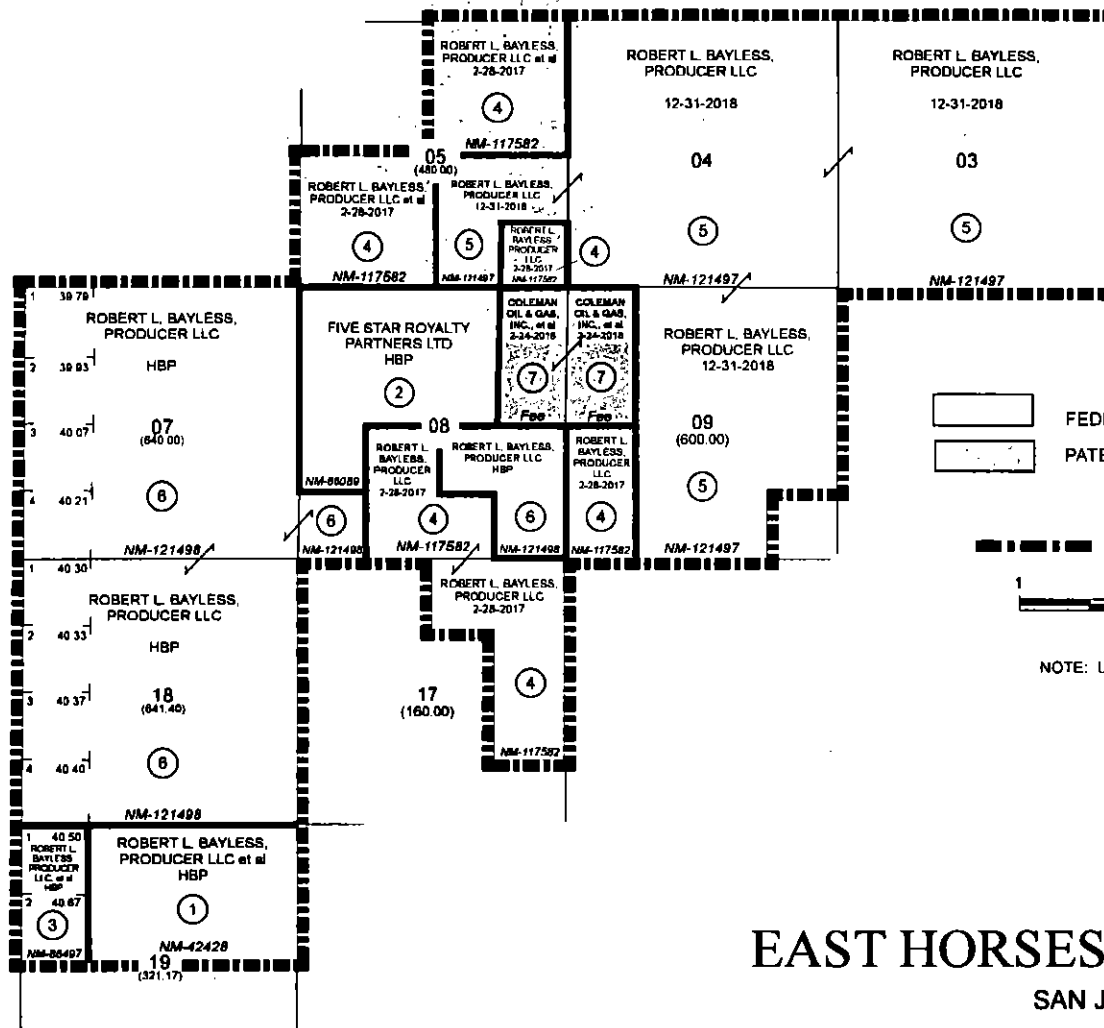

	ACREAGE	PERCENTAGE
FEDERAL LANDS	4,602.57	96.64%
PATENTED LANDS	160.00	3.36%
TOTALS	4,762.57	100.00%

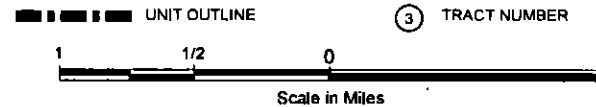

NOTE: UNLESS OTHERWISE NOTED HEREIN THE SECTIONS  
ON THIS PLAT CONTAIN 640.00 ACRES

EXHIBIT "A"

EAST HORSESHOE GALLUP UNIT AREA

SAN JUAN COUNTY, NEW MEXICO

EXHIBIT 1

ROBERT L. BAYLESS, PRODUCER LLC  
DENVER, COLORADO

10-27-2016