

**BEFORE THE OIL CONSERVATION DIVISION  
EXAMINER HEARING FEBRUARY 16, 2017**

**CASE No. 15618**

*RODEO UNIT*

**SAN JUAN COUNTY, NEW MEXICO**



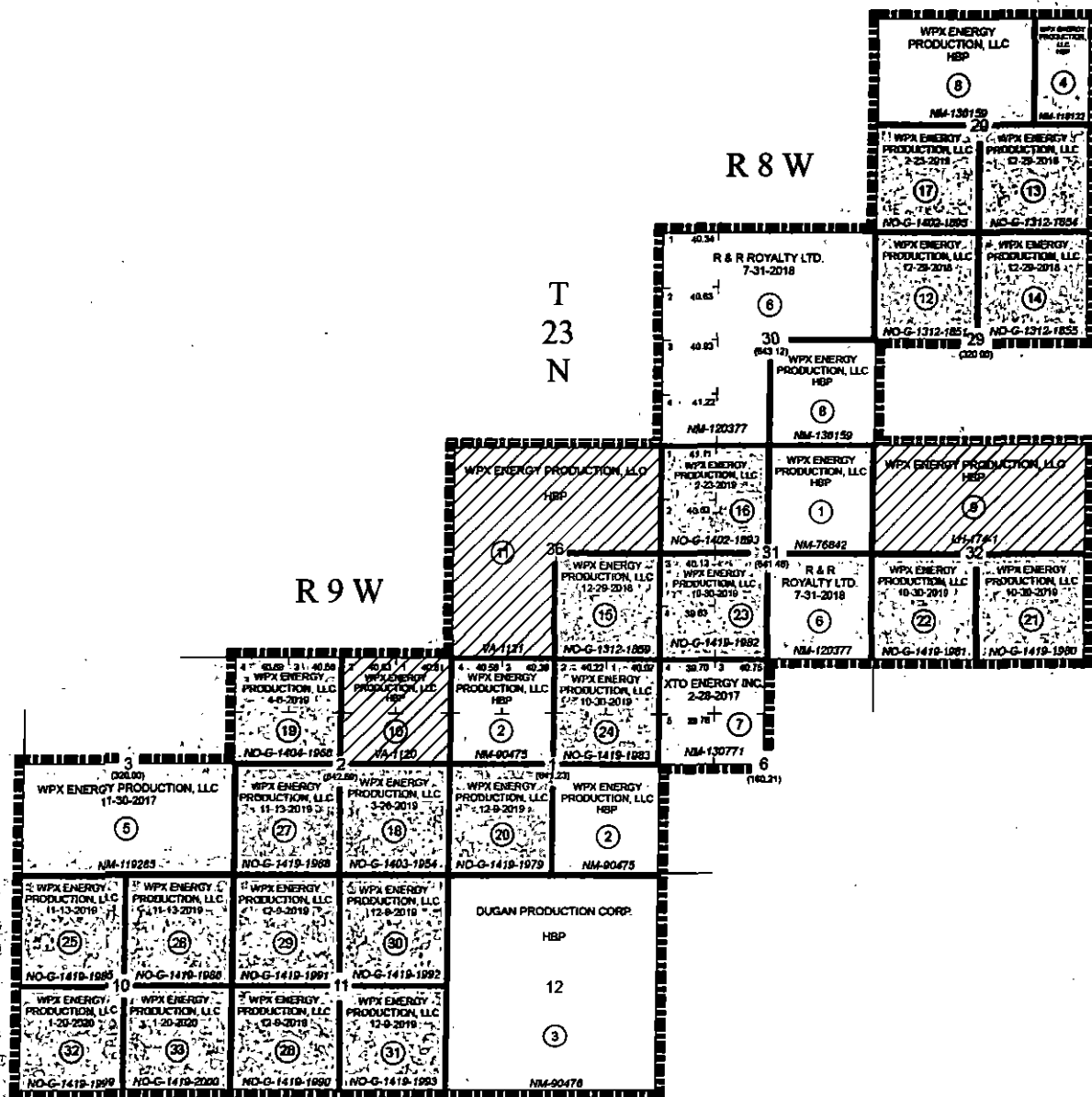

	ACREAGE	PERCENTAGE
FEDERAL LANDS	2,724.27	37.79%
STATE LANDS	981.24	13.34%
ALLOTTED LANDS	3,523.12	48.87%
<b>TOTALS</b>	<b>7,208.63</b>	<b>100.00%</b>

EXHIBIT "A"

## RODEO UNIT AREA

SAN JUAN COUNTY, NEW MEXICO

WPX ENERGY PRODUCTION, LLC  
TULSA, OKLAHOMA

11-29-2016