

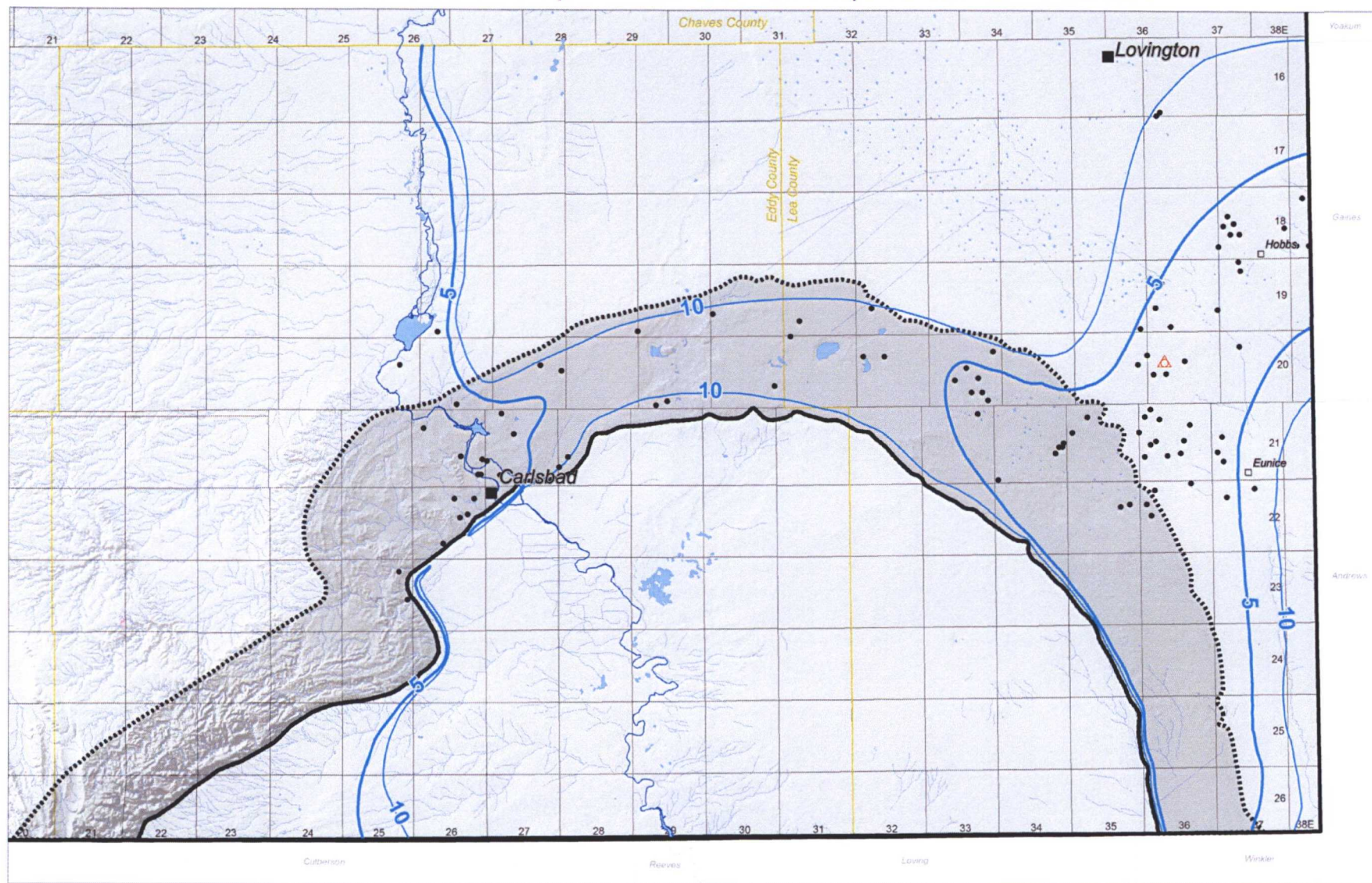

Low Chlorides in Capitan and Shelf Aquifers, New Mexico



Aubrey Durin
Commissioner of Public Lands
505-827-5760

Capitan Reef Boundaries

- Aquifer Boundary
- Leaky Boundary
- Wellbores with Chloride Data
- Proposed SWD - Oasis/Cooper 17 #1
- County Lines

Chloride Contours

- 5,000
 - 10,000
- ## Water Bodies
- LAKE/POND; RESERVOIR

Drainage

- Canal/Ditch
- Pipeline/Aqueduct
- Pipeline/Siphon
- River or Stream/Intermittent
- River or Stream/Perennial

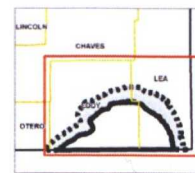

NMSLO Exhibit _____

NMOCD CASE No. 15307

Map Based on Resource Map 4, "Chloride-Ion Concentration in Ground Water in Permian Guadalupian Rocks, Southeast New Mexico and West Texas", New Mexico Bureau of Mines and Mineral Resources, W.L. Hess, 1975.

The New Mexico State Land Office assumes no responsibility or liability for any connection with the accuracy, reliability or use of the information provided here. In State Land Office data users or any other data user.

Flushed Zone - Capitan and Shelf Aquifers, Area of Oasis/Cooper 17 #1 Proposed SWD

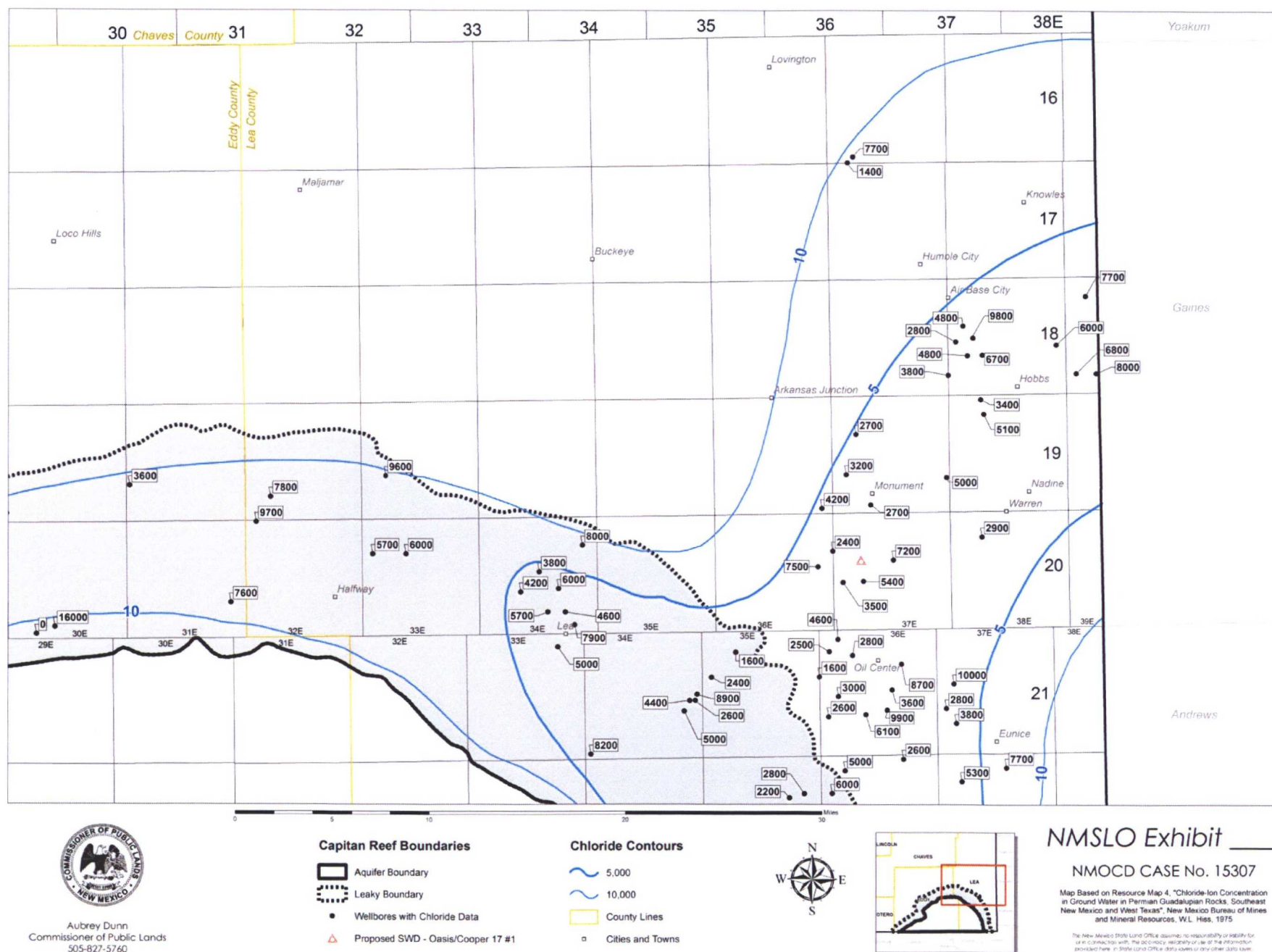

pg. 3.

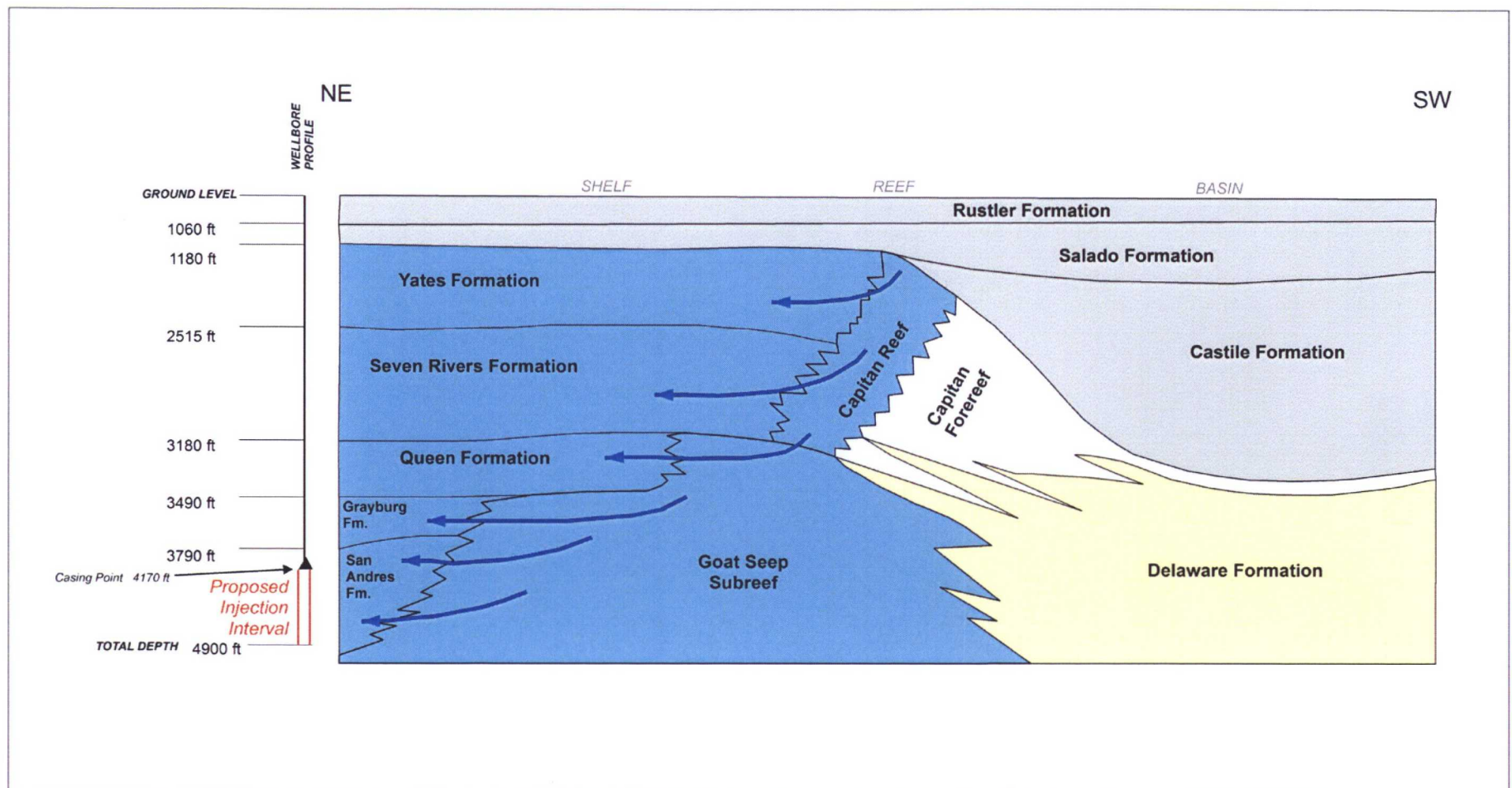

After Hiss, William L., Movement of ground water in Permian Guadalupian aquifer systems, southeastern New Mexico and western Texas, 1980, pp. 289-294 of New Mexico Geological Society Fall Field Conference Guidebook - 31, Trans Pecos Region (Southeastern New Mexico and West Texas)

NMOCD Case No. 15307

NM SLO Exhibit ____

PS 4