

**STATE OF NEW MEXICO
DEPARTMENT OF ENERGY, MINERALS AND NATURAL RESOURCES
OIL CONSERVATION DIVISION**

**APPLICATION OF MESQUITE SWD, INC.
TO APPROVE PRODUCED WATER DISPOSAL
WELL IN EDDY COUNTY, NEW MEXICO.**

CASE NO. 20472

APPLICATION

Mesquite SWD, Inc. ("Mesquite"), OGRID No. 161968, through its undersigned attorneys, hereby makes this application to the Oil Conservation Division pursuant to the provisions Rule No. 19.15.4.8 for an order approving drilling of a produced water disposal well in Eddy County, New Mexico. In support of this application, Mesquite states as follows:

(1) Mesquite proposes to drill the Baker SWD Well No. 1 well at a surface location 330 feet from the South line and 309 feet from the West line (Unit M) of Section 1, Township 26 South, Range 31 East, NMPM, Eddy County, New Mexico for the purpose of operating a produced water disposal well.

(2) Mesquite seeks authority to inject produced water into the Siluro-Devonian formation through the open-hole interval from approximately 17,300' to 18,500'.

(3) Mesquite further seeks approval of the use of 7 inch tubing inside the surface and intermediate casings and 5 ½ inch tubing inside the liner and requests that the Division approve a maximum daily injection rate for the well of 40,000 bbls per day.

(4) Mesquite anticipates a maximum injection pressure of 3,460 psi, or as controlled by depth.

(5) On or about September 27, 2018 Mesquite SWD, Inc., filed with the Division, an administrative application for approval of the subject well for produced water disposal.

(6) Mesquite has determined to request that this matter be set for hearing before a Division Examiner.

(7) A proposed C-108 for the subject well is attached hereto in Attachment A.

(8) The granting of this application will avoid the drilling of unnecessary wells, will prevent waste, and will protect correlative rights.

WHEREFORE, Mesquite requests that this application be set for hearing before an Examiner of the Oil Conservation Division on May 4, 2019; and that after notice and hearing, the Division enter its order approving this application.

Respectfully submitted,

MODRALL, SPERLING, ROEHL, HARRIS
& SISK, P.A.

By: Deana M. Bennett

Deana Bennett
Post Office Box 2168
Bank of America Centre
500 Fourth Street NW, Suite 1000
Albuquerque, New Mexico 87103-2168
Telephone: 505.848.1800
Attorneys for Applicant

CASE NO. ____: Application of Mesquite SWD, Inc., for approval of produced water disposal well in Eddy County, New Mexico. Applicant seeks an order approving disposal into the Silurian-Devonian formation through the Baker SWD Well No. 1 well at a surface location 330 feet from the South line and 309 feet from the West line (Unit M) of Section 1, Township 26 South, Range 31 East, NMPM, Eddy County, New Mexico for the purpose of operating a produced water disposal well. Mesquite seeks authority to inject produced water into the Silurian-Devonian formation at a depth of approximately 17,300' to 18,500'. Mesquite further seeks approval of the use of 7 inch tubing inside the surface and intermediate casings and 5 ½ inch tubing inside the liner and requests that the Division approve a maximum daily injection rate for the well of 40,000 bbls per day. Said area is located approximately 22 miles Southwest of Malaga, New Mexico.

RECEIVED:	REVIEWER:	TYPE:	APP NO:
-----------	-----------	-------	---------

ABOVE THIS TABLE FOR OCD DIVISION USE ONLY

NEW MEXICO OIL CONSERVATION DIVISION
 - Geological & Engineering Bureau -
 1220 South St. Francis Drive, Santa Fe, NM 87505

**ADMINISTRATIVE APPLICATION CHECKLIST**

THIS CHECKLIST IS MANDATORY FOR ALL ADMINISTRATIVE APPLICATIONS FOR EXCEPTIONS TO DIVISION RULES AND
 REGULATIONS WHICH REQUIRE PROCESSING AT THE DIVISION LEVEL IN SANTA FE

Applicant: Mesquite SWD, Inc. **OGRID Number:** 161968
Well Name: Baker SWD Well No. 1 **API:** Not Yet Assigned
Pool: SWD; Devonian **Pool Code:** N/A

**SUBMIT ACCURATE AND COMPLETE INFORMATION REQUIRED TO PROCESS THE TYPE OF APPLICATION
 INDICATED BELOW**

1) TYPE OF APPLICATION: Check those which apply for [A]**A. Location - Spacing Unit - Simultaneous Dedication**

☐ NSL ☐ NSP (PROJECT AREA) ☐ NSP (PROBATION UNIT) ☐ SD

B. Check one only for [I] or [II]**[I] Commingling - Storage - Measurement**

☐ DHC ☐ CTB ☐ PLC ☐ PC ☐ OLS ☐ OLM

[II] Injection - Disposal - Pressure Increase - Enhanced Oil Recovery

☐ WFX ☐ PMX ☒ SWD ☐ IPI ☐ EOR ☐ PPR

2) NOTIFICATION REQUIRED TO: Check those which apply.

- A. ☒ Offset operators or lease holders
 B. ☐ Royalty, overriding royalty owners, revenue owners
 C. ☒ Application requires published notice
 D. ☐ Notification and/or concurrent approval by SLO
 E. ☒ Notification and/or concurrent approval by BLM
 F. ☒ Surface owner
 G. ☒ For all of the above, proof of notification or publication is attached, and/or,
 H. ☐ No notice required

FOR OCD ONLY

☐ Notice Complete
☐ Application
 Content
 Complete

- 3) CERTIFICATION:** I hereby certify that the information submitted with this application for administrative approval is **accurate and complete** to the best of my knowledge. I also understand that **no action** will be taken on this application until the required information and notifications are submitted to the Division.

Note: Statement must be completed by an individual with managerial and/or supervisory capacity.

Melanie Wilson

Print or Type Name

Signature

9/27/2018

Date

(575) 914-1461

Phone Number

mjp1692@gmail.com

e-mail Address

September 27, 2018

Energy, Minerals and Natural Resources Department
Oil Conservation Division
1220 South St. Francis Drive
Santa Fe, New Mexico 87505

Attention: Ms. Heather Riley
Division Director

Re: Form C-108
Baker SWD Well No. 1
API No. (Not Yet Assigned)
330' FSL & 309' FWL, Unit M
Section 1, T-26S, R-31E, NMPM,
Eddy County, New Mexico

Dear Ms. Riley,

Enclosed please find a Division Form C-108 (Application for Authorization to Inject) for the Mesquite SWD, Inc. Baker SWD Well No. 1. Mesquite SWD, Inc. proposes to drill and utilize this well as a produced water disposal well, injection to occur into the Siluro-Devonian formation through the open-hole interval from approximately 17,300 feet to 18,500 feet. Produced water from the Bone Spring, Wolfcamp and other formations originating from wells in this area will be injected into the well.

I believe that all the information necessary to approve the application is enclosed. If additional information is needed, please contact me at (575) 914-1461.

Sincerely,

Melanie Wilson-Regulatory Analyst
Mesquite SWD, Inc.
P.O. Box 1479
Carlsbad, New Mexico 88221-1479

Xc: OCD-Artesia

APPLICATION FOR AUTHORIZATION TO INJECT

- I. PURPOSE: Secondary Recovery Pressure Maintenance ☒ Disposal Storage
Application qualifies for administrative approval? Yes No
- II. OPERATOR: Mesquite SWD, Inc.
ADDRESS: P.O. Box 1479, Carlsbad, New Mexico 88221-1479
CONTACT PARTY: Melanie Wilson PHONE: 575-914-1461
- III. WELL DATA: Complete the data required on the reverse side of this form for each well proposed for injection.
Additional sheets may be attached if necessary.
- IV. Is this an expansion of an existing project? Yes ☒ No
If yes, give the Division order number authorizing the project: _____
- V. Attach a map that identifies all wells and leases within two miles of any proposed injection well with a one-half mile radius circle drawn around each proposed injection well. This circle identifies the well's area of review.
- VI. Attach a tabulation of data on all wells of public record within the area of review which penetrate the proposed injection zone. Such data shall include a description of each well's type, construction, date drilled, location, depth, record of completion, and a schematic of any plugged well illustrating all plugging detail.
- VII. Attach data on the proposed operation, including:
1. Proposed average and maximum daily rate and volume of fluids to be injected;
 2. Whether the system is open or closed;
 3. Proposed average and maximum injection pressure;
 4. Sources and an appropriate analysis of injection fluid and compatibility with the receiving formation if other than reinjected produced water; and,
 5. If injection is for disposal purposes into a zone not productive of oil or gas at or within one mile of the proposed well, attach a chemical analysis of the disposal zone formation water (may be measured or inferred from existing literature, studies, nearby wells, etc.).
- *VIII. Attach appropriate geologic data on the injection zone including appropriate lithologic detail, geologic name, thickness, and depth. Give the geologic name, and depth to bottom of all underground sources of drinking water (aquifers containing waters with total dissolved solids concentrations of 10,000 mg/l or less) overlying the proposed injection zone as well as any such sources known to be immediately underlying the injection interval.
- IX. Describe the proposed stimulation program, if any.
- *X. Attach appropriate logging and test data on the well. (If well logs have been filed with the Division, they need not be resubmitted).
- *XI. Attach a chemical analysis of fresh water from two or more fresh water wells (if available and producing) within one mile of any injection or disposal well showing location of wells and dates samples were taken.
- XII. Applicants for disposal wells must make an affirmative statement that they have examined available geologic and engineering data and find no evidence of open faults or any other hydrologic connection between the disposal zone and any underground sources of drinking water.
- XIII. Applicants must complete the "Proof of Notice" section on the reverse side of this form.
- XIV. Certification: I hereby certify that the information submitted with this application is true and correct to the best of my knowledge and belief.
- NAME: Melanie Wilson TITLE: Regulatory Analyst
SIGNATURE: _____ DATE: 9/27/18
E-MAIL ADDRESS: mjp1692@gmail.com
- * If the information required under Sections VI, VIII, X, and XI above has been previously submitted, it need not be resubmitted.
Please show the date and circumstances of the earlier submittal: _____

DISTRIBUTION: Original and one copy to Santa Fe with one copy to the appropriate District Office

III. WELL DATA

- A. The following well data must be submitted for each injection well covered by this application. The data must be both in tabular and schematic form and shall include:

- (1) Lease name; Well No.; Location by Section, Township and Range; and footage location within the section.
- (2) Each casing string used with its size, setting depth, sacks of cement used, hole size, top of cement, and how such top was determined.
- (3) A description of the tubing to be used including its size, lining material, and setting depth.
- (4) The name, model, and setting depth of the packer used or a description of any other seal system or assembly used.

Division District Offices have supplies of Well Data Sheets which may be used or which may be used as models for this purpose. Applicants for several identical wells may submit a "typical data sheet" rather than submitting the data for each well.

- B. The following must be submitted for each injection well covered by this application. All items must be addressed for the initial well. Responses for additional wells need be shown only when different. Information shown on schematics need not be repeated.

- (1) The name of the injection formation and, if applicable, the field or pool name.
- (2) The injection interval and whether it is perforated or open-hole.
- (3) State if the well was drilled for injection or, if not, the original purpose of the well.
- (4) Give the depths of any other perforated intervals and detail on the sacks of cement or bridge plugs used to seal off such perforations.
- (5) Give the depth to and the name of the next higher and next lower oil or gas zone in the area of the well, if any.

XIV. PROOF OF NOTICE

All applicants must furnish proof that a copy of the application has been furnished, by certified or registered mail, to the owner of the surface of the land on which the well is to be located and to each leasehold operator within one-half mile of the well location.

Where an application is subject to administrative approval, a proof of publication must be submitted. Such proof shall consist of a copy of the legal advertisement which was published in the county in which the well is located. The contents of such advertisement must include:

- (1) The name, address, phone number, and contact party for the applicant;
- (2) The intended purpose of the injection well; with the exact location of single wells or the Section, Township, and Range location of multiple wells;
- (3) The formation name and depth with expected maximum injection rates and pressures; and,
- (4) A notation that interested parties must file objections or requests for hearing with the Oil Conservation Division, 1220 South St. Francis Dr., Santa Fe, New Mexico 87505, within 15 days.

NO ACTION WILL BE TAKEN ON THE APPLICATION UNTIL PROPER PROOF OF NOTICE HAS BEEN SUBMITTED.

NOTICE: Surface owners or offset operators must file any objections or requests for hearing of administrative applications within 15 days from the date this application was mailed to them.

DISTRICT IV
1220 S. ST. FRANCIS DR., SANTA FE, NM 87505
Phone: (505) 478-3460 Fax: (505) 478-3462

Form C-102
Revised August 1, 2011
Submit one copy to appropriate
District Office

WELL LOCATION AND ACREAGE DEDICATION PLAT

Bottom Hole Location If Different From Surface									
UL or lot No.	Section	Township	Range	Lot Idn	Feet from the	North/South line	Feet from the	East/West line	County
Dedicated Acres	Joint or Infill		Consolidation Code		Order No.				

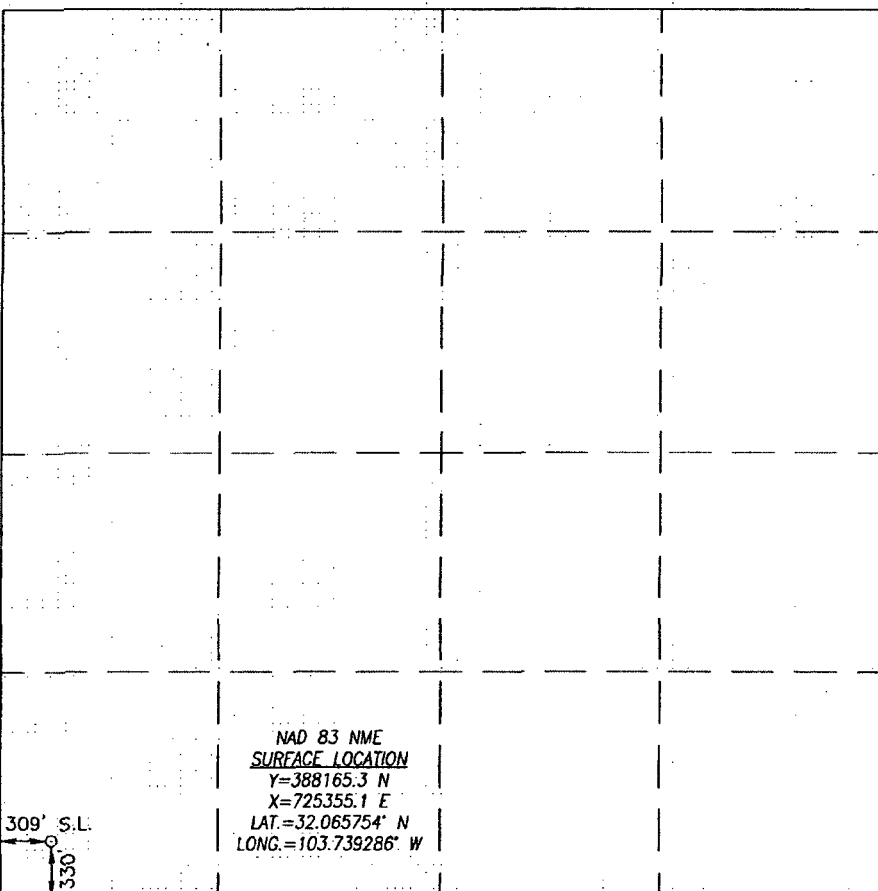
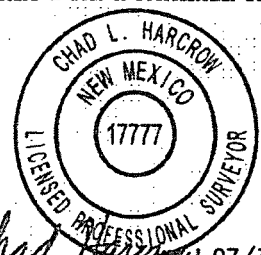
		OPERATOR CERTIFICATION <i>I hereby certify that the information herein is true and complete to the best of my knowledge and belief, and that this organization either owns a working interest or unleased mineral interest in the land including the proposed bottom hole location or has a right to drill this well at this location pursuant to a contract with an owner of such mineral or working interest, or to a voluntary pooling agreement or a compulsory pooling order heretofore entered by the division.</i>
	Signature	Date
	Printed Name	
	E-mail Address	
	SURVEYOR CERTIFICATION <i>I hereby certify that the well location shown on this plat was plotted from field notes of actual surveys made by me or under my supervision, and that the same is true and correct to the best of my belief.</i> JULY 20, 2018 Date of Survey	
Signature & Seal of Professional Surveyor		
		
Certificate No. CHAD HARCROW 17777 W.O. # 18-819 DRAWN BY: SP		

309' S.L.



NAD 83 NME
SURFACE LOCATION
Y=388165.3 N
X=725355.1 E
LAT.=32.065754° N
LONG.=103.739286° W



LEGEND

- WELL
- WELLPAD
- PROPOSED ROAD
- EXISTING ROAD

BAKER SWD #1

SEC: 1	TWP: 26 S.	RGE: 31 E.	ELEV: 3280.0'
STATE: NEW MEXICO		COUNTY: EDDY	330' FSL & 309' FWL
W.O. # 18-819	LEASE: BAKER SWD		SURVEY: N.M.P.M

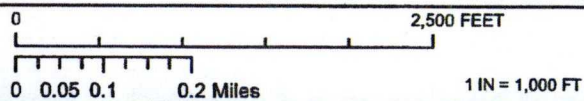

LOCATION OVERVIEW	IMAGERY	7/25/2018	S.P.
-------------------	---------	-----------	------

MESQUITE SWD



HARCROW SURVEYING, LLC.
 2314 W. MAIN ST, ARTESIA, NM 88210
 PH: (575) 746-2158 FAX: (575) 746-2158
 TEXAS FIRM NO. 10194089
 c.harcrow@harcrowsurveying.com

INJECTION WELL DATA SHEET

OPERATOR: Mesquite SWD, Inc.

WELL NAME & NUMBER: Baker SWD Well No. 1

WELL LOCATION: 330' FSL & 309' FWL M 1 26S 31E
FOOTAGE LOCATION UNIT LETTER SECTION TOWNSHIP RANGE

WELLBORE SCHEMATIC
(SEE ATTACHED)

WELL CONSTRUCTION DATA

Surface Casing

Hole Size: 26" Casing Size: 20" 94# J-55 BTC
Cemented with: 1700 SK or ft³
Top of Cement: Surface Method Determined: Circulate

1st Intermediate Casing

Hole Size: 17.5" Casing Size: 13.375" 68# P-110
Cemented with: 2500 SK or ft³
Top of Cement: Surface Method Determined: Circulate

2nd Intermediate Casing

Hole Size: 12.5" Casing Size: 9.625" 53.5# P-110 BTC
Cemented with: 2,800 SK. Staged; DV Tools @ 8,200' & 4,500'
Top of Cement: Surface Method Determined: Circulate

Liner

Hole Size: 8.5" Casing Size: 7.625" 39# P-110 UFJ Liner
Cemented with: 400 SK or ft³
Top of Cement: 11,400' (Liner Top) Method Determined: Circulate

Total Depth: Approximately 18,500'

Injection Interval

Approximately 17,300' To 18,500'
(Perforated or Open Hole; indicate which) Open Hole

Tubing Size: Tapered String 7" 26# P-110/5 1/2" 17# P-110 Lining Material: Fiberglass Coated
Type of Packer: Lok-Set or Equivalent
Packer Setting Depth: Approximately 17,250'
Other Type of Tubing/Casing Seal (if applicable): _____

- (Note: See attached OCD Pool Maps)**

(Note: See attached OCD Pool Maps)

Mesquite SWD, Inc.
Baker SWD No. 1: Proposed Wellbore Schematic
330' FSL & 309' FWL (Unit M)
Section 1, T-26S, R-31E, NMPM, Eddy County, NM

Surface Casing:

Hole Size: 26"
 Size: 20" 94# J-55
 Set @: 950'
 Sx. Cmt: 1700
 TOC: Surface

1st Intermediate Casing:

Hole Size: 17.5"
 Size: 13.375" 68# P-110
 Set @: 4,300'
 Sx. Cmt: 2,500
 TOC: Surface

2nd Intermediate Casing:

Hole Size: 12.5"
 Size: 9.625 53.5# P-110
 Set @: 11,900'
 Stage Cemented
 DV Tools @ 8,200' & 4,500'
 All Stages Circulate
 TOC: Surface

Liner

Hole Size: 8.5"
 Size: 7.625" 39# P-110 UFJ
 Set @: 11,400'-17,300'
 Sx. Cmt: 400
 TOC: 11,400' (Liner Top)

Open Hole Injection Interval

Hole Size: 6 1/2"
 Interval: 17,300'-18,500'

Formation Tops:

Rustler:	925'
Top of Salt:	1,275'
Base of Salt:	4195'
Bone Spring:	9,416'
Wolfcamp:	11,852'
Strawn:	14,056'
Atoka:	14,191'
Morrow:	14,956'
Mississippian:	16,860'
Top Siluro-Devonian:	17,302'
Montoya:	18,854'

(Note: Formation tops based on offset
 Paduca 6 SWD No. 1Y located in
 Section 6, T-26S, R-32E)

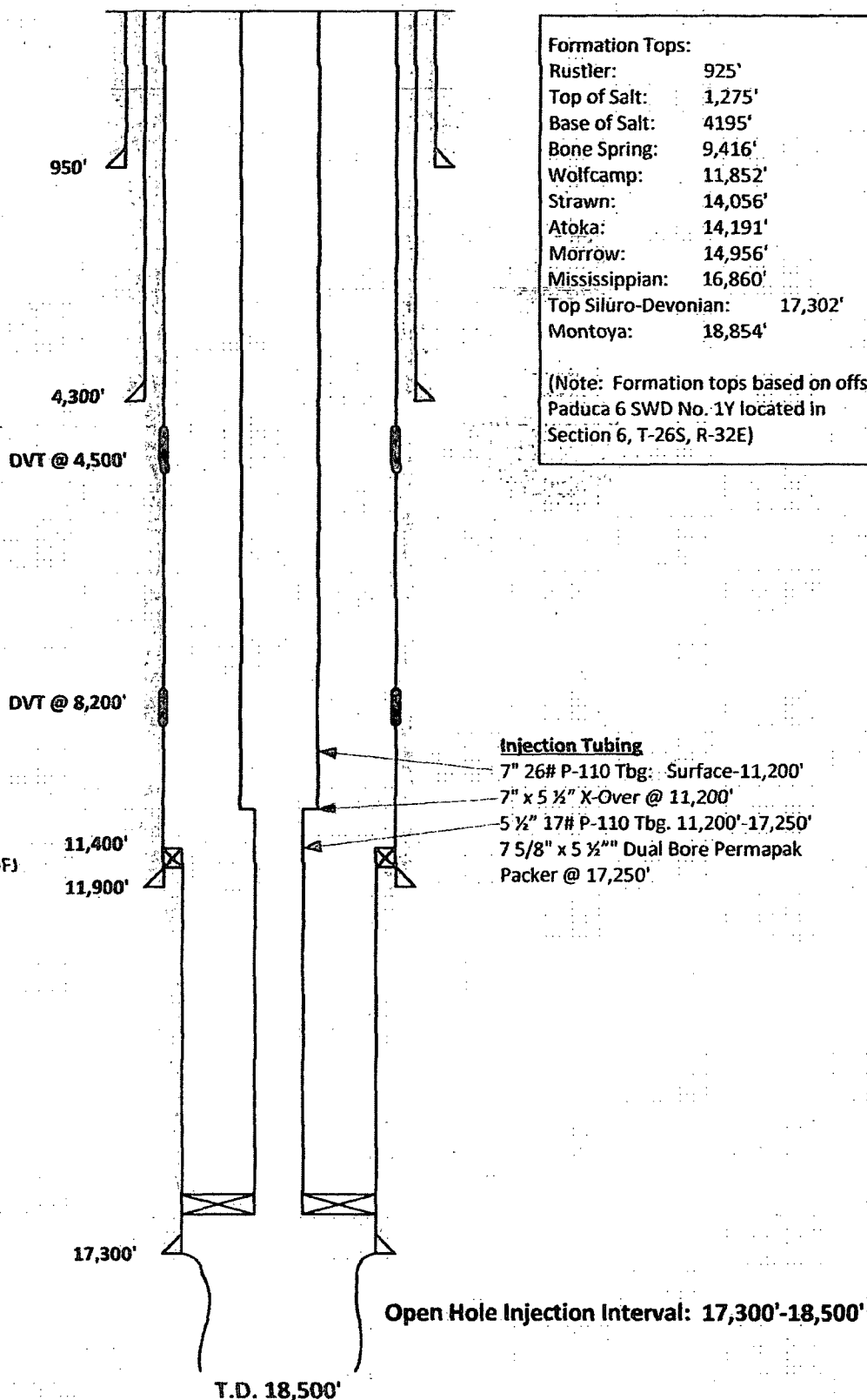

C-108 Application
Mesquite SWD, Inc.
Baker SWD No. 1
330' FSL & 309' FWL (Unit M)
Section 1, T-26S, R-31E, NMPM
Eddy County, New Mexico

- I. The purpose of the application is to request approval to utilize the proposed Baker SWD No. 1 as a produced water disposal well. This is a new well to be drilled for injection.
- II. Mesquite SWD, Inc.
P.O. Box 1479
Carlsbad, New Mexico 88221-1479
Contact Party: Melanie Wilson (575) 914-1461
- III. Injection well data sheet and wellbore schematic diagram showing the proposed wellbore configuration is attached.
- IV. This is not an expansion of an existing project.
- V. Attached are maps that identify all wells/leases within a 2-mile and 1-mile radius of the proposed water disposal well and a map that identifies the 1-mile "Area of Review" ("AOR").
- VI. A listing of all wells within the AOR, including API No., operator, well name & number, well type and status, surface and bottomhole well locations, MD and TVD and completed formation is attached. An examination of the AOR well listing shows that none of the 31 active or proposed wells within the AOR penetrate, or will penetrate the proposed injection interval. In addition, none of the four PA'd wells within the AOR penetrate the proposed injection interval.
- VII.
 1. The average injection rate is anticipated to be approximately 30,000 BWPD. The maximum rate will be approximately 40,000 BWPD. If the average or maximum rates increase in the future, the Division will be notified.
 2. This will be a closed system.
 3. Mesquite SWD, Inc. will initially inject water into the subject well at or below a surface injection pressure in compliance with the Division's limit of 0.2 psi/ft., or approximately 3,460 psi. If a surface injection pressure above 3,460 psi is necessary, Mesquite SWD, Inc. will conduct a step rate injection test to determine the fracture pressure of the Siluro-Devonian formation in this area.

4. Produced water from the Bone Spring, Wolfcamp, Delaware and other producing formations originating from wells in this area will be injected into the subject well. Attached are produced water analysis from various producing wells in Township 26 South, Range 31 East that produce from the Delaware, Bone Spring and Wolfcamp formations. These produced water analyses were obtained from the GO Tech website.
5. An examination of Division records indicate that the Siluro-Devonian formation is not productive within one mile of the Baker SWD No. 1. A produced water analysis from the Devonian formation within the Remuda Basin Unit Well No. 1, located in Section 24, Township 23 South, Range 29 East, NMPM, Eddy County, New Mexico, was obtained from the Go Tech website, and is attached to this application. This produced water analysis shows a TDS of 56,922 Mg/L.

VIII. Geologic Formation: Devonian/Silurian
Estimated Top: 17,302'
Thickness: 1,552'
Lithology: Limestone w/Interbedded Dolomites

(Note: The top of the Devonian interval cited above was determined by examination of the well file for the offset Paduca 6 SWD No. 1Y, located in Unit E of Section 6, Township 26 South, Range 32 East, NMPM. This well is located approximately 1.25 miles Northeast of the proposed Baker SWD No. 1, and was permitted for injection into the Devonian interval by Order No. SWD-1607-A issued on August 17, 2016. Division records also indicate that this well is active, is currently injecting approximately 17,656 BWPd into the Devonian interval, and has cumulatively injected 6,666,203 barrels of water).

(Note: An examination of OCD well records indicate that there are no additional produced water disposal wells located within the nine-section area surrounding Section 1, T-26S, R-31E, NMPM.)

USDW's: According to data obtained from the New Mexico State Engineer, there are four fresh water wells located within one mile of the Baker SWD No. 1 (See Attached). These wells range in depth from 350 feet to 700 feet, and the depth to water averages 335 feet. Mesquite SWD, Inc. will attempt to obtain a water sample from one of these wells and forward a fresh water analysis to the Division when obtained.

Mesquite SWD, Inc.

Form C-108 (Application for Authorization to Inject)

Baker SWD No. 1

Page 3

- IX. Formation chemical stimulation may be applied after completion. No other stimulation is currently planned.
- X. Logs will be filed subsequent to the completion of drilling operations. Density-Neutron is planned to be run from surface to TD.
- XI. There are four fresh water wells located within a one-mile radius of the Baker SWD No. 1. (See attached report from the OSE).
- XII. Affirmative statement is enclosed.
- XIII. Proof of Notice is enclosed.

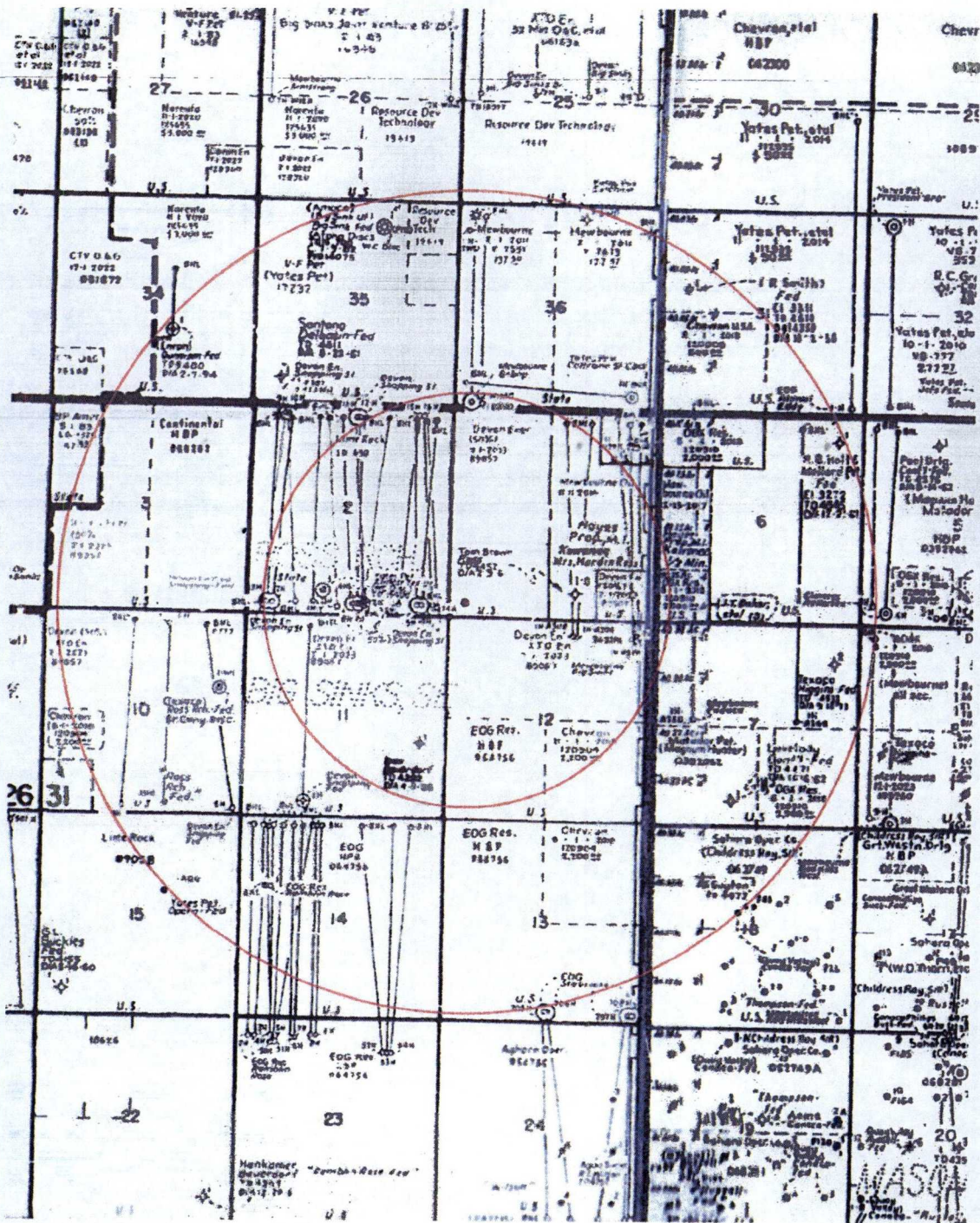

Mesquite SWD, Inc.
Form C-108; Baker SWD No. 1
1-Mile & 2-Mile Lease Map

MESQUITE SWD, INC.
BAKER SWD WELL NO. 1
ONE-MILE AREA OF REVIEW WELL LIST

API NUMBER	OPERATOR	LEASE NAME	WELL NO.	WELL TYPE	STATUS	FTG. N/S	N/S	FTG. E/W	E/W	UNIT	SEC.	TSHP	RNG.	TVD	MD	COMPLETION
30-015-44737	Devon Energy Prod. Co. LP	Snapping 12 1 Fed	521H	Oil	NYD	2325'	N	810'	W	E	12	26S	31E	8,713' *	15,794' *	Bone Spring
					BHL	330'	N	550'	W	D	1	26S	31E			
30-015-44738	Devon Energy Prod. Co. LP	Snapping 12 1 Fed	522H	Oil	NYD	2325'	N	1790'	W	F	12	26S	31E	8,753' *	16,170' *	Bone Spring
					BHL	330'	N	1430'	W	C	1	26S	31E			
30-015-44758	Devon Energy Prod. Co. LP	Snapping 12 1 Fed	523H	Oil	NYD	2325'	N	1880'	W	F	12	26S	31E	8,773' *	16,198' *	Bone Spring
					BHL	330'	N	2310'	W	C	1	26S	31E			
30-015-44721	Devon Energy Prod. Co. LP	Snapping 12 1 Fed	531H	Oil	NYD	2325'	N	780'	W	E	12	26S	31E	8,983' *	16,064' *	Bone Spring
					BHL	330'	N	500'	W	D	1	26S	31E			
30-015-44739	Devon Energy Prod. Co. LP	Snapping 12 1 Fed	532H	Oil	NYD	2325'	N	840'	W	E	12	26S	31E	8,973' *	16,084' *	Bone Spring
					BHL	330'	N	1320'	W	D	1	26S	31E			
30-015-44722	Devon Energy Prod. Co. LP	Snapping 12 1 Fed	533H	Oil	NYD	2325'	N	1850'	W	F	12	26S	31E	9,013' *	16,379' *	Bone Spring
					BHL	330'	N	2140'	W	C	1	26S	31E			
30-015-44740	Devon Energy Prod. Co. LP	Snapping 12 1 Fed	523H	Oil	NYD	2325'	N	1820'	W	F	12	26S	31E	11,541' *	18,958' *	Wolfcamp
					BHL	330'	N	2090'	W	C	1	26S	31E			
30-015-42694	Mewbourne Oil Company	Big Sinks 1 A2 PA Fed Com	1H	Oil	Active	465'	N	460'	E	A	12	26S	31E	8,838'	13,965'	Bone Spring
					BHL	354'	N	482'	W	A	1	26S	31E			
30-015-43318	Mewbourne Oil Company	Big Sinks 1 A2OB Fee	1H	Oil	NYD	410'	N	1850'	E	B	12	26S	31E	9,097' *	13,938' *	Bone Spring
					BHL	330'	N	1650'	E	B	1	26S	31E			
30-015-42712	Mewbourne Oil Company	Big Sinks 1 A30B Fee	2H	Oil	Active	410'	N	1980'	E	B	12	26S	31E	9,131'	14,295'	Bone Spring
					BHL	337'	N	2275'	E	B	1	26S	31E			
30-015-43725	Mewbourne Oil Company	Big Sinks 1 B2 PA Fed Com	3H	Oil	NYD	485'	N	395'	E	A	12	26S	31E	10,317' *	15,627' *	Bone Spring
					BHL	330'	N	660'	E	A	1	26S	31E			
30-015-43800	Mewbourne Oil Company	Big Sinks 1 W1PA Fed Com	2H	Gas	Active	485'	N	330'	E	A	12	26S	31E	12,071'	17,430'	Wolfcamp
					BHL	330'	N	330'	E	A	1	26S	31E			
30-015-43453	Mewbourne Oil Company	BEBOP 36 B2MD State	1H	Oil	NYD	185'	S	660'	W	M	36	25S	31E	9,000' *	14,880' *	Bone Spring
					BHL	330'	N	660'	W	D	36	25S	31E			

MESQUITE SWD, INC.
BAKER SWD WELL NO. 1
ONE-MILE AREA OF REVIEW WELL LIST

API NUMBER	OPERATOR	LEASE NAME	WELL NO.	WELL TYPE	STATUS	FTG' N/S	N/S	FTG' E/W	E/W	UNIT	SEC.	TSHP	RNG.	TVD'	MD'	COMPLETION
30-015-43320	Mewbourne Oil Company	BEBOP 36 W1MD State	2H	Gas	Active	185'	S	450'	W	M	36	25S	31E	12,038'	16,550'	Wolfcamp
					BHL	338'	N	532'	W	D	36	26S	31E			
30-015-39104	Devon Energy Prod. Co. LP	Snapping 2 State	1Y	Oil	Active	330'	S	1710'	W	N	2	26S	31E	8,574'	13,007'	Bone Spring
					BHL	343'	N	1650'	W	C	2	26S	31E			
30-015-39035	Devon Energy Prod. Co. LP	Snapping 2 State	2H	Oil	Active	330'	S	680'	W	M	2	26S	31E	8,966'	13,600'	Bone Spring
					BHL	330'	N	990'	W	D	2	26S	31E			
30-015-39036	Devon Energy Prod. Co. LP	Snapping 2 State	3H	Oil	Active	330'	S	630'	W	M	2	26S	31E	8,560'	13,136'	Bone Spring
					BHL	355'	N	390'	W	D	2	26S	31E			
30-015-39071	Devon Energy Prod. Co. LP	Snapping 2 State	4H	Oil	Active	330'	S	735'	E	P	2	26S	31E	9,054'	13,539'	Bone Spring
					BHL	342'	N	413'	E	A	2	26S	31E			
30-015-39073	Devon Energy Prod. Co. LP	Snapping 2 State	5H	Oil	Active	330'	S	785'	E	P	2	26S	31E	8,607'	13,122'	Bone Spring
					BHL	346'	N	1037'	E	A	2	26S	31E			
30-015-39162	Devon Energy Prod. Co. LP	Snapping 2 State	6H	Oil	Active	330'	S	2260'	E	O	2	26S	31E	9,004'	13,798'	Bone Spring
					BHL	350'	N	1712'	E	B	2	26S	31E			
30-015-39163	Devon Energy Prod. Co. LP	Snapping 2 State	7H	Oil	Active	330'	S	2310'	E	O	2	26S	31E	8,550'	13,102'	Bone Spring
					BHL	353'	N	2306'	E	B	2	26S	31E			
30-015-39165	Devon Energy Prod. Co. LP	Snapping 2 State	8H	Oil	Active	330'	S	2360'	E	O	2	26S	31E	8,981'	13,654'	Bone Spring
					BHL	400'	N	2337'	W	C	2	26S	31E			
30-015-43023	Devon Energy Prod. Co. LP	Snapping 2 State	9H	Oil	Active	200'	N	880'	W	D	2	26S	31E	10,214'	14,825'	Bone Spring
					BHL	348'	S	410'	W	M	2	26S	31E			
30-015-43024	Devon Energy Prod. Co. LP	Snapping 2 State	10H	Oil	Active	200'	N	930'	W	D	2	26S	31E	10,204'	14,766'	Bone Spring
					BHL	350'	S	410'	W	M	2	26S	31E			
30-015-43041	Devon Energy Prod. Co. LP	Snapping 2 State	11H	Oil	Active	220'	N	2490'	E	B	2	26S	31E	10,242'	14,811'	Bone Spring
					BHL	340'	S	2183'	W	N	2	26S	31E			
30-015-43042	Devon Energy Prod. Co. LP	Snapping 2 State	12H	Oil	Active	229'	N	2440'	E	B	2	26S	31E	10,239'	14,790'	Bone Spring
					BHL	342'	S	2215'	E	O	2	26S	31E			

MESQUITE SWD, INC.
BAKER SWD WELL NO. 1
ONE-MILE AREA OF REVIEW WELL LIST

[illegible]

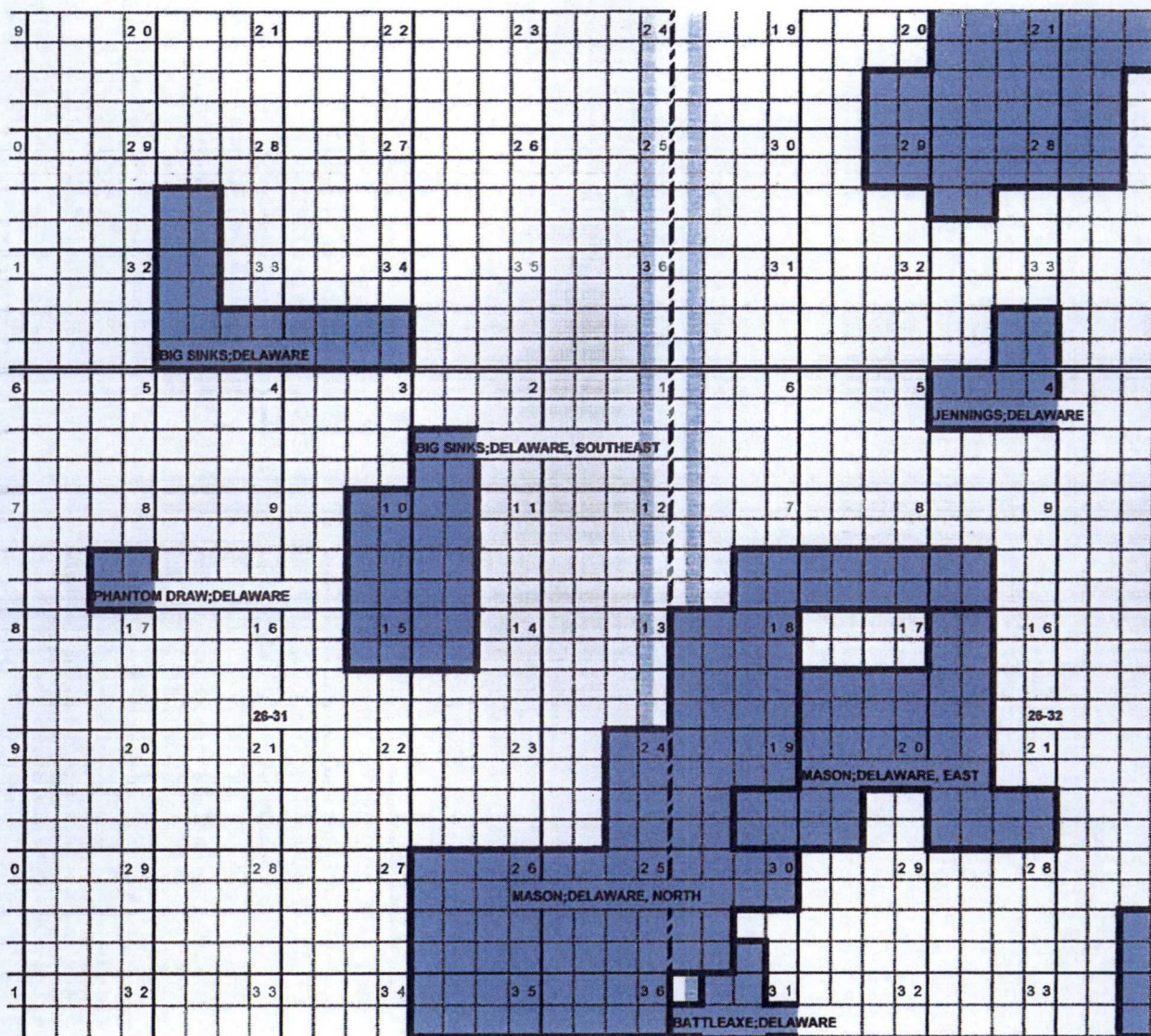

Mesquite SWD, Inc.
Form C-108; Baker SWD No. 1
OCD Designated Delaware Pools

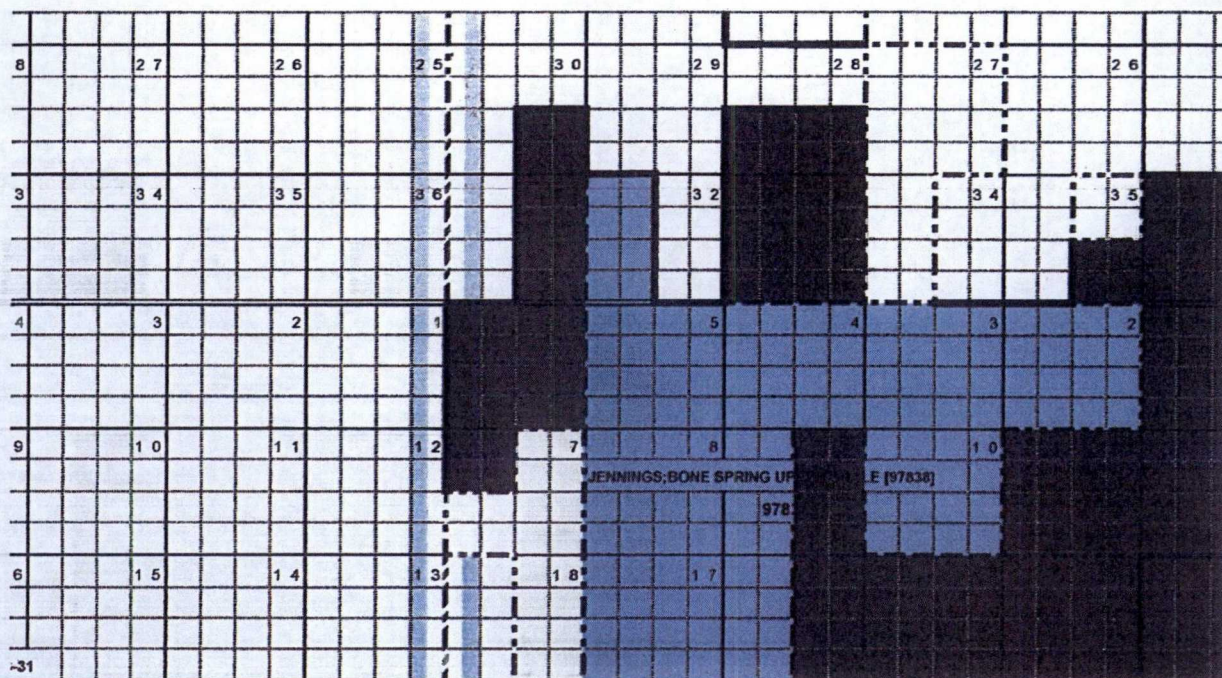

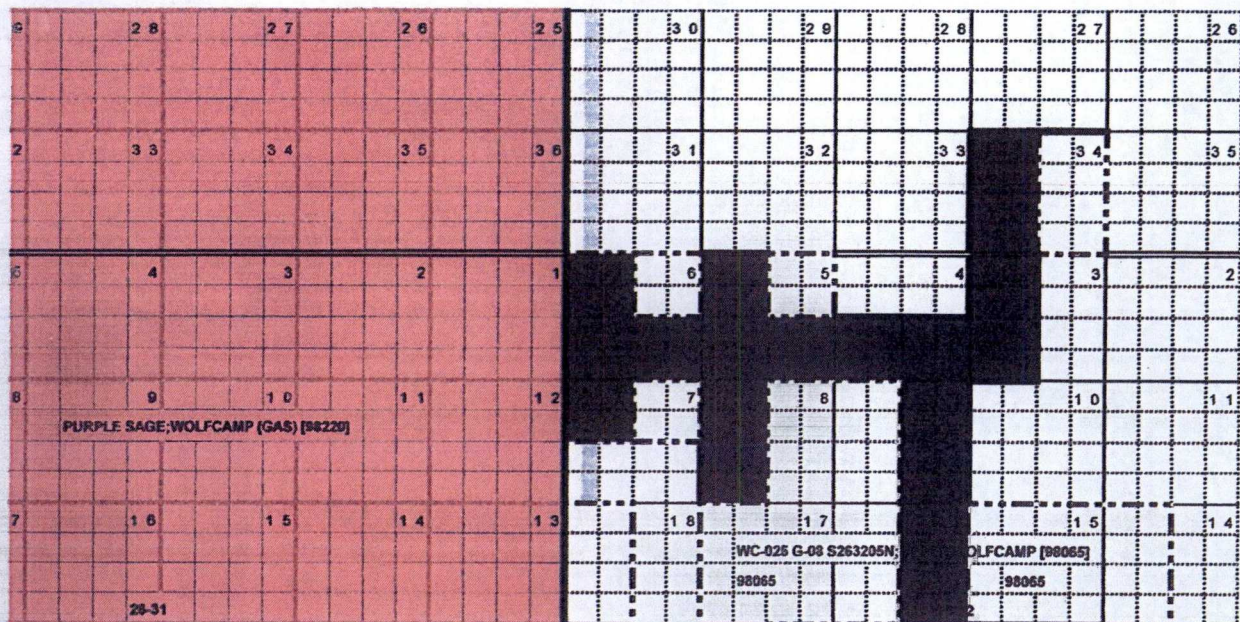

Mesquite SWD, Inc.
Form C-108; Baker SWD No. 1
OCD Designated Wolfcamp Pools

	1 6		1 5		1 4		1 3	32440	1 8		1 7		1 6		1 5
								PADUCA;DEVONIAN (GAS)							
	25-31												25-32		
	2 1		2 2		2 3		2 4		1 9		2 0		2 1		2 2
	2 8		2 7		2 6		2 5		3 0		2 9		2 8		2 7
	3 3		3 4		3 5		3 6		3 1		3 2		3 3		3 4
	4		3		2		1		6		5		4		3
	9		1 0		1 1		1 2		7		8		9		1 0
	1 6		1 5		1 4		1 3		1 8		1 7		1 6		1 5
	26-31												26-32		
	2 1		2 2		2 3		2 4		1 9		2 0		2 1		2 2

Mesquite SWD, Inc.
Form C-108; Baker SWD No. 1
OCD Designated Devonian Pools

Well Name	Section	Township	Range	Unit	Formation	Ph	TDS/Mg/l	Sodium Mg/l	Calcium Mg/l	Iron Mg/l	Magnesium Mg/l	Manganese Mg/l	Chloride Mg/l	Bicarbonate Mg/l	Sulfate Mg/l	CO2 Mg/l
SNAPPING 2 STATE #013H	2	26S	31E	N	BONE SPRING 3RD SAND	6.5	94965.6	31352.7	3678.6	31.7	483.6	0.83	57489.5	244	0	200
SNAPPING 2 STATE #013H	2	26S	31E	N	BONE SPRING 3RD SAND	7	94518.2	30031.5	3402.8	19.9	438.9		58782.2		355.2	200
SNAPPING 2 STATE #013H	2	26S	31E	N	BONE SPRING 3RD SAND	7.2	94863.9	30224.8	3424	14.8	444		59015.2		365	200
SNAPPING 2 STATE #014H	2	26S	31E	P	WOLF CAMP	7.3	81366.4	26319.4	2687.4	26.1	326.7		50281.2		399.7	100
SNAPPING 2 STATE #013H	2	26S	31E	N	BONE SPRING 3RD SAND	6.8	91289.1	28721.3	3440.7	16.3	437.4		56957.4		327.9	150
ROSS RANCH 10 FEDERAL #001	10	26S	31E	H		6.3	111430.5	38922.4	3647.3	76.8	487.9	1.05	66173.2	366	0	300
ROSS RANCH 10 FEDERAL #001	10	26S	31E	H		7	54116.9	46100	5224	349.6	719.3	3.73	0	73.2	0	570
SNAPPING 10 FEDERAL #005H	10	26S	31E	P	BONE SPRING 2ND SAND	6.6	138161.9	44458.5	6280.8	29.7	781.3	0	84470	122	0	20
SNAPPING 10 FEDERAL #005H	10	26S	31E	P	BONE SPRING 2ND SAND	6.6	138376	44458.5	6280.8	29.7	781.3	0	84470	122	618	20
SNAPPING 10 FEDERAL #001H	10	26S	31E	B	AVALON UPPER	6.5	199638.8	68948.2	7560.4	111.2	1522.8	2.19	118195	732	0	500
SNAPPING 11 FEDERAL #001H	11	26S	31E	N	AVALON UPPER	6.1	225189.8	77010.7	8743.8	636.1	1649.2	6.75	134075	366	0	300
SNAPPING 2 STATE #003H	2	26S	31E	M	AVALON UPPER	6.1	223019	76001.7	10437.8	209.9	1922.4	4.5	131072	366	632	1100
SNAPPING 2 STATE #006H	2	26S	31E	O	AVALON UPPER	6.5	179788.5	71575.7	617.4	21.8	109.6	0	101374	3660	0	500
SNAPPING 2 STATE #006H	2	26S	31E	O	AVALON UPPER	6.5	179938	71575.7	617.4	21.8	109.6	0	101374	3660	844	500
SNAPPING 10 FEDERAL #003H	10	26S	31E	N	BONE SPRING 2ND SAND	6.5	152439.2	48495.7	6731.3	29.1	801.4	1.06	94055	244	0	100
E D WHITE FEDERAL NCT 1 #003	26	26S	31E	O	DELAWARE		212112						132100	195	425	
SNAPPING 10 FEDERAL #001H	10	26S	31E	B	AVALON UPPER	7.1	209352.4	70089.5	7327	203	1557	2.5	127230	146.4	600	600
SNAPPING 11 FEDERAL #001H	11	26S	31E	N	AVALON UPPER	7	196576.7	68797.3	5059	12	1066	0.9	118943	122	872	380
SNAPPING 11 FEDERAL #001H	11	26S	31E	N	AVALON UPPER	7	203078.9	72261.4	4407	112	904	1.5	122172	1098	658	80
SNAPPING 2 STATE #001Y	2	26S	31E	N	AVALON UPPER	7	162560.1	57137	3886	42	776	0.6	97161	1403	756	70

Mesquite SWD, Inc.
Form C-108; Baker SWD No. 1
Source Water Analysis

Well Name	Section	Township	Range	Unit	Field	Formation	Sample Source	TDS Mg/l	Chloride Mg/l	Bicarbonate Mg/l	Sulfate Mg/l
REMUDA BASIN UNIT #001	24	23S	29E	J	REMUDA	DEVONIAN	SWAB	56922	29000	1740	4980

Mesquite SWD, Inc.
 Form C-108; Baker SWD No. 1
 Devonian Water Analysis



New Mexico Office of the State Engineer Water Column/Average Depth to Water

(A CLW##### in the
POD suffix indicates the
POD has been replaced
& no longer serves a
water right file.)

(R=POD has
been replaced,
O=orphaned,
C=the file is

closed) (quarters are 1=NW 2=NE 3=SW 4=SE)

(quarters are smallest to largest) (NAD83 UTM in meters)

(in feet)

POD Number	POD Sub-Code	basin	County	Q 64	Q 16	Q 4	Sec	Tws	Range	X	Y	Depth Well	Depth Water	Water Column
C-02090	C	ED		4	4	01	26S	31E		620329	3548533*	350	335	15
C-03554 POD1	CUB	ED		2	1	4	01	26S	31E	620547	3549148	630	300	330
C-03639 POD1	CUB	ED		3	4	2	01	26S	31E	620168	3549279	700	365	335
C-04256 POD1	CUB	ED		4	4	2	01	26S	31E	620384	3549257	666	340	326

Average Depth to Water: 335 feet

Minimum Depth: 300 feet

Maximum Depth: 365 feet

Record Count: 4

PLSS Search:

Section(s): 1, 2, 11, 12

Township: 26S

Range: 31E

Mesquite SWD, Inc.
Form C-108; Baker SWD No. 1
Office of the State Engineer
Fresh Water Well Data

*UTM location was derived from PLSS - see Help

The data is furnished by the NMOSE/ISC and is accepted by the recipient with the expressed understanding that the OSE/ISC make no warranties, expressed or implied, concerning the accuracy, completeness, reliability, usability, or suitability for any particular purpose of the data.

8/7/18 2:00 PM

Page 1 of 1

WATER COLUMN/ AVERAGE
DEPTH TO WATER

Form C-108
Affirmative Statement
Mesquite SWD, Inc.
Baker SWD No. 1
Section 1, T-26 South, R-31 East, NMPM,
Eddy County, New Mexico

Available geologic and engineering data has been examined and no evidence of open faults or hydrological connection between the injection zone and any underground sources of drinking water has been found.



Riley Neatherlin
Operations Manager – Mesquite SWD, Inc.

9/27/18
Date

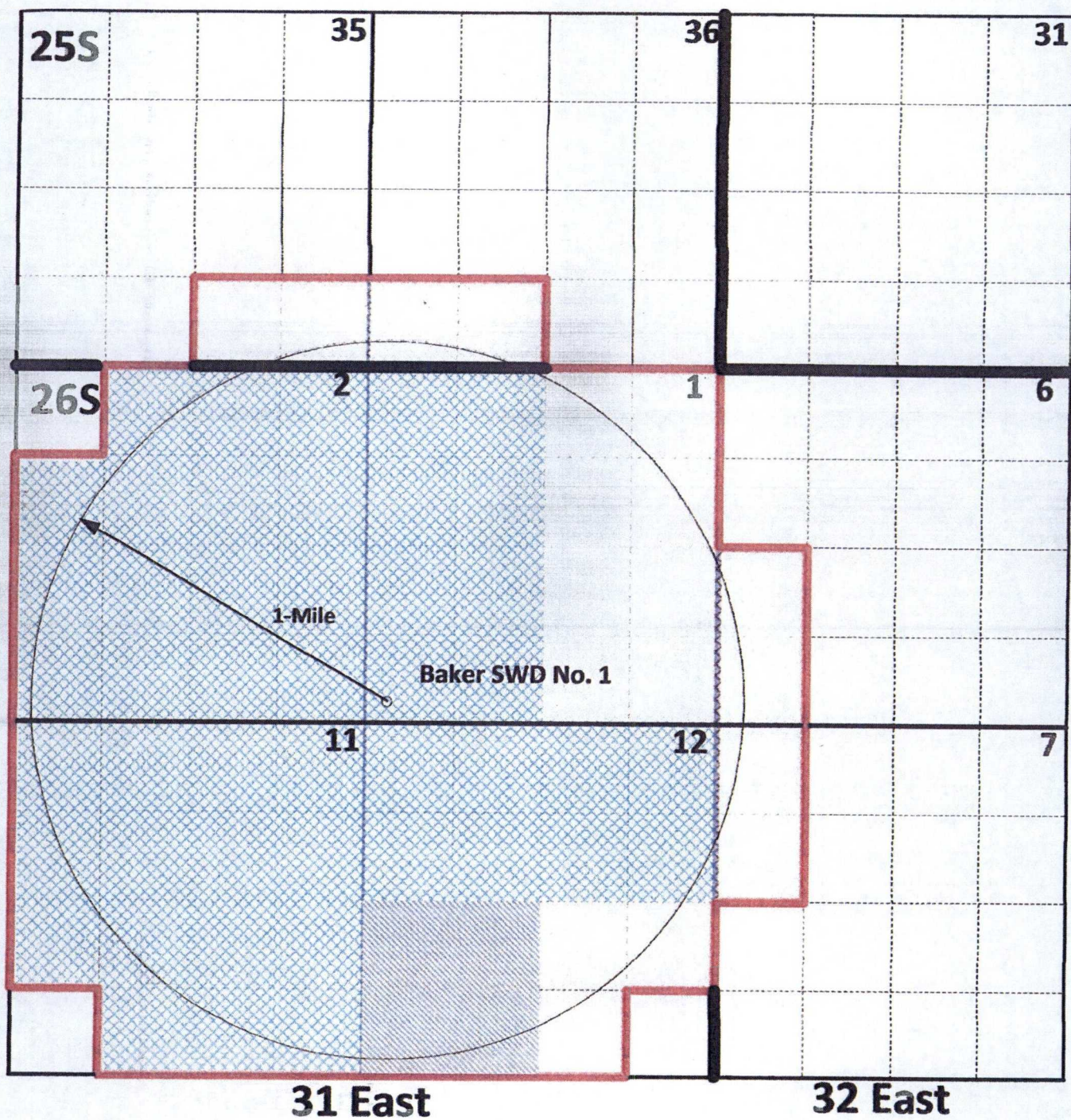

C-108 Application
 Mesquite SWD, Inc.
 Baker SWD Well No. 1
 1-Mile Notice Area

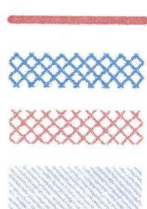

1-Mile Notice Area
 Tract 1
 Tract 2
 Tract 3

Form C-108 Application
Mesquite SWD, Inc.
Baker SWD No. 1
Section 1, T-26 South, R-31 East, NMPM
Notice List

Tract 1:

Section 2: E/2, E/2 W/2, SW/4 NW/4 & W/2 SW/4	Devon Energy Production Co., LP 20 North Broadway Oklahoma City, OK 73102
Section 11: E/2 W/2:	Devon Energy Production Co., LP
Section 11: E/2, W/2 NW/4 & NW/4 SW/4	Devon Energy Production Co., LP XTO Holdings, LLC 810 Houston Street Fort Worth, Texas 76102
Section 12: N/2:	Devon Energy Production Co., LP XTO Holdings, LLC
Section 1: W/2:	Devon Energy Production Co., LP XTO Holdings, LLC

Tract 2:

Section 36: S/2 SW/4:	Mewbourne Oil Company P.O. Box 5270 Hobbs, New Mexico 88241
Section 35: S/2 SE/4:	Mewbourne Oil Company
Section 12: N/2 SE/4 & SW/4 SE/4:	Mewbourne Oil Company
Section 7: NW/4 NW/4 & SW/4 NW/4: (Lots 1 & 2)	Mewbourne Oil Company
Section 6: NW/4 SW/4: (Lot 3)	Mewbourne Oil Company Chevron USA, Inc. 6301 Deauville Blvd. Midland, Texas 79706

**Form C-108 Application
Mesquite SWD, Inc.
Baker SWD No. 1
Section 1, T-26 South, R-31 East, NMPM
Notice List (Page 2)**

**Section 6: NW/4 SW/4:
(Lot 3) (Cont.)**

**RBP Land Company Trust
Robert B. Porter Jr., Trustee
P.O. Box 10392
Midland, Texas 79702**

**Hayes Land, LP
P.O. Box 51510
Midland, Texas 79710-1510**

**Hayes Land & Production, LP
P.O. Box 51407
Midland, Texas 79710**

**Section 6: SW/4 SW/4:
(Lot 4)**

Mewbourne Oil Company

Section 1: NE/4 NE/4:

Mewbourne Oil Company

**Section 1: W/2 E/2, NE/4 SE/4 &:
SE/4 NE/4**

Mewborne Oil Company

Chevron USA, Inc.

RBP Land Company Trust

Hayes Land, LP

Hayes Land & Production, LP

Section 1: SE/4 SE/4:

Mewbourne Oil Company

Tract 3:

Section 12: SW/4:

**EOG Resources, Inc.
P.O. Box 2267
Midland, Texas 79706**

**ConocoPhillips Company
600 N. Dairy Ashford Rd.
Office EC3-10-W285
Houston, Texas 77079**

Form C-108 Application
Mesquite SWD, Inc.
Baker SWD No. 1
Section 1, T-26 South, R-31 East, NMPM
Notice List (Page 3)

Additional Notice:

Bureau of Land Management
620 E. Greene Street
Carlsbad, New Mexico 88220-6292

(Surface Owner):

Jessie T. & Susan Ann Baker
P.O. Box 24
Silver City, New Mexico 88062

September 27, 2018

CERTIFIED MAIL
RETURN RECEIPT REQUESTED

TO: Sec Attached Notice List

Re: Mesquite SWD, Inc.
Form C-108 (Application for Authorization to Inject)
Baker SWD Well No. 1
API No. (Not Yet Assigned)
330' FSL & 309' FWL, Unit M, Section 1, T-26S, R-31E, NMPM,
Eddy County, New Mexico

Ladies & Gentlemen:

Enclosed please find a copy of Oil Conservation Division Form C-108 (Application for Authorization to Inject) for the Mesquite SWD, Inc. Baker SWD No. 1. You are being provided a copy of the application as an offset operator/leaseholder or as the owner of the surface where the proposed well is located. Mesquite SWD, Inc. proposes to drill the Baker SWD No. 1 and utilize the well as a produced water disposal well, injection to occur into the Siluro-Devonian formation through the open-hole interval from approximately 17,300 feet to 18,500 feet.

Objections must be filed with the Oil Conservation Division, 1220 South St. Francis Drive, Santa Fe, New Mexico 87505, within 15 days.

If you should have any questions, please contact me at (575) 914-1461.

Sincerely,

Melanie Wilson-Regulatory Analyst
Mesquite SWD, Inc.
P.O. Box 1479
Carlsbad, New Mexico 88221-1479

Enclosure

Form C-108
Mesquite SWD, Inc.
Baker SWD No. 1
Section 1, T-26 South, R-31 East, NMPM,
Eddy County, New Mexico

The following-described legal advertisement will be published in the:

Artesia Daily Press
503 W. Main Street
Artesia, New Mexico 88210-2067

The Affidavit of Publication will be forwarded to the Division upon receipt by Mesquite SWD, Inc.

LEGAL NOTICE

Mesquite SWD, Inc., P.O. Box 1479, Carlsbad, New Mexico 88221-1479, has filed a Form C-108 (Application for Authorization to Inject) with the Oil Conservation Division ("Division") seeking administrative approval to utilize its proposed Baker SWD No. 1 (API No. N/A) to be drilled 330 feet from the South line and 309 feet from the West line (Unit M) of Section 1, Township 26 South, Range 31 East, NMPM, Eddy County, New Mexico and complete the well as a produced water disposal well in the Siluro-Devonian formation. Injection is to occur through the open-hole interval from approximately 17,300 feet to 18,500 feet.

Produced water from the Bone Spring, Wolfcamp and other formations originating from wells in this area will be injected into the Baker SWD No. 1 at average and maximum rates of 30,000 and 40,000 barrels of water per day, respectively. The initial surface injection pressure for the well is anticipated to be at or below 3,460 psi., which is in compliance with Division regulations. The maximum surface injection pressure will be determined by step rate injection test.

Interested parties must file objections with the New Mexico Oil Conservation Division, 1220 S. St Francis Drive, Santa Fe, New Mexico 87505, within 15 days of the date of this publication.

Additional information can be obtained by contacting Ms. Melanie Wilson-Regulatory Analyst-Mesquite SWD, Inc. at (575) 914-1461.



March 27, 2019

Florene Davidson
NM Oil Conservation Division
1220 S. St. Francis Drive
Santa Fe, NM 87505

Deana M. Bennett
Tel: 505.848.1834
Fax: 505.848.9710
deana.bennett@modrall.com

Re: **APPLICATION OF MESQUITE SWD, INC
TO APPROVE PRODUCED WATER DISPOSAL
WELL IN EDDY COUNTY, NEW MEXICO**

Dear Ms. Davidson:

Enclosed please find a copy of the following:

1. No. ____ Mesquite's Application / Baker SWD Well No. 1

Thank you for your assistance. Please contact me if you have any questions.

Sincerely,

Karlene Schuman
Legal Assistant to
Deana M. Bennett

Enclosure

Modrall Sperling
Roehl Harris & Sisk P.A.

500 Fourth Street NW
Suite 1000
Albuquerque,
New Mexico 87102

PO Box 2168
Albuquerque,
New Mexico 87103-2168

Tel: 505.848.1800
www.modrall.com

**STATE OF NEW MEXICO
DEPARTMENT OF ENERGY, MINERALS AND NATURAL RESOURCES
OIL CONSERVATION DIVISION**

**APPLICATION OF MESQUITE SWD, INC.
TO APPROVE PRODUCED WATER DISPOSAL
WELL IN EDDY COUNTY, NEW MEXICO.**

CASE NO. _____

APPLICATION

Mesquite SWD, Inc. ("Mesquite"), OGRID No. 161968, through its undersigned attorneys, hereby makes this application to the Oil Conservation Division pursuant to the provisions Rule No. 19.15.4.8 for an order approving drilling of a produced water disposal well in Eddy County, New Mexico. In support of this application, Mesquite states as follows:

(1) Mesquite proposes to drill the Baker SWD Well No. 1 well at a surface location 330 feet from the South line and 309 feet from the West line (Unit M) of Section 1, Township 26 South, Range 31 East, NMPM, Eddy County, New Mexico for the purpose of operating a produced water disposal well.

(2) Mesquite seeks authority to inject produced water into the Siluro-Devonian formation through the open-hole interval from approximately 17,300' to 18,500'.

(3) Mesquite further seeks approval of the use of 7 inch tubing inside the surface and intermediate casings and 5 ½ inch tubing inside the liner and requests that the Division approve a maximum daily injection rate for the well of 40,000 bbls per day.

(4) Mesquite anticipates a maximum injection pressure of 3,460 psi, or as controlled by depth.

(5) On or about September 27, 2018 Mesquite SWD, Inc., filed with the Division, an administrative application for approval of the subject well for produced water disposal.

(6) Mesquite has determined to request that this matter be set for hearing before a Division Examiner.

(7) A proposed C-108 for the subject well is attached hereto in Attachment A.

(8) The granting of this application will avoid the drilling of unnecessary wells, will prevent waste, and will protect correlative rights.

WHEREFORE, Mesquite requests that this application be set for hearing before an Examiner of the Oil Conservation Division on May 4, 2019; and that after notice and hearing, the Division enter its order approving this application.

Respectfully submitted,

MODRALL, SPERLING, ROEHL, HARRIS
& SISK, P.A.

By: Deana M. Bennett
Deana Bennett
Post Office Box 2168
Bank of America Centre
500 Fourth Street NW, Suite 1000
Albuquerque, New Mexico 87103-2168
Telephone: 505.848.1800
Attorneys for Applicant

CASE NO. _____: Application of Mesquite SWD, Inc., for approval of produced water disposal well in Eddy County, New Mexico. Applicant seeks an order approving disposal into the Silurian-Devonian formation through the Baker SWD Well No. 1 well at a surface location 330 feet from the South line and 309 feet from the West line (Unit M) of Section 1, Township 26 South, Range 31 East, NMPM, Eddy County, New Mexico for the purpose of operating a produced water disposal well. Mesquite seeks authority to inject produced water into the Silurian-Devonian formation at a depth of approximately 17,300' to 18,500'. Mesquite further seeks approval of the use of 7 inch tubing inside the surface and intermediate casings and 5 ½ inch tubing inside the liner and requests that the Division approve a maximum daily injection rate for the well of 40,000 bbls per day. Said area is located approximately 22 miles Southwest of Malaga, New Mexico.

Revised March 23, 2017

RECEIVED:	REVIEWER:	TYPE:	APP NO:
-----------	-----------	-------	---------

ABOVE THIS TABLE FOR OCD DIVISION USE ONLY

NEW MEXICO OIL CONSERVATION DIVISION
 - Geological & Engineering Bureau -
 1220 South St. Francis Drive, Santa Fe, NM 87505



ADMINISTRATIVE APPLICATION CHECKLIST

THIS CHECKLIST IS MANDATORY FOR ALL ADMINISTRATIVE APPLICATIONS FOR EXCEPTIONS TO DIVISION RULES AND
 REGULATIONS WHICH REQUIRE PROCESSING AT THE DIVISION LEVEL IN SANTA FE

Applicant: Mesquite SWD, Inc.

OGRID Number: 161968

Well Name: Baker SWD Well No. 1

API: Not Yet Assigned

Pool: SWD; Devonian

Pool Code: N/A

**SUBMIT ACCURATE AND COMPLETE INFORMATION REQUIRED TO PROCESS THE TYPE OF APPLICATION
 INDICATED BELOW**

1) TYPE OF APPLICATION: Check those which apply for [A]

A. Location - Spacing Unit - Simultaneous Dedication

☐ NSL☐ NSP (PROJECT AREA)☐ NSP (PRORATION UNIT)☐ SD

B. Check one only for [I] or [II]

[I] Commingling - Storage - Measurement

☐ DHC☐ CTB☐ PLC☐ PC☐ OLS☐ OLM

[II] Injection - Disposal - Pressure Increase - Enhanced Oil Recovery

☐ WFX☐ PMX☒ SWD☐ IPI☐ EOR☐ PPR

2) NOTIFICATION REQUIRED TO: Check those which apply.

A. ☒ Offset operators or lease holdersB. ☐ Royalty, overriding royalty owners, revenue ownersC. ☒ Application requires published noticeD. ☐ Notification and/or concurrent approval by SLOE. ☒ Notification and/or concurrent approval by BLMF. ☒ Surface ownerG. ☒ For all of the above, proof of notification or publication is attached, and/or,H. ☐ No notice required

FOR OCD ONLY

☐ Notice Complete☐ Application
Content
Complete

- 3) CERTIFICATION:** I hereby certify that the information submitted with this application for administrative approval is **accurate** and **complete** to the best of my knowledge. I also understand that **no action** will be taken on this application until the required information and notifications are submitted to the Division.

Note: Statement must be completed by an individual with managerial and/or supervisory capacity.

Melanie Wilson

Print or Type Name

Signature

9/27/2018

Date

(575) 914-1461

Phone Number

mjp1692@gmail.com

e-mail Address

September 27, 2018

Energy, Minerals and Natural Resources Department
Oil Conservation Division
1220 South St. Francis Drive
Santa Fe, New Mexico 87505

Attention: Ms. Heather Riley
Division Director

Re: Form C-108
Baker SWD Well No. 1
API No. (Not Yet Assigned)
330' FSL & 309' FWL, Unit M
Section 1, T-26S, R-31E, NMPM,
Eddy County, New Mexico

Dear Ms. Riley,

Enclosed please find a Division Form C-108 (Application for Authorization to Inject) for the Mesquite SWD, Inc. Baker SWD Well No. 1. Mesquite SWD, Inc. *proposes to drill and utilize this well as a produced water disposal well*, injection to occur into the Siluro-Devonian formation through the open-hole interval from approximately 17,300 feet to 18,500 feet. Produced water from the Bone Spring, Wolfcamp and other formations originating from wells in this area will be injected into the well.

I believe that all the information necessary to approve the application is enclosed. If additional information is needed, please contact me at (575) 914-1461.

Sincerely,

Melanie Wilson-Regulatory Analyst
Mesquite SWD, Inc.
P.O. Box 1479
Carlsbad, New Mexico 88221-1479

Xc: OCD-Artesia

APPLICATION FOR AUTHORIZATION TO INJECT

I. PURPOSE: Secondary Recovery Pressure Maintenance X Disposal Storage
Application qualifies for administrative approval? Yes No

II. OPERATOR: Mesquite SWD, Inc.

ADDRESS: P.O. Box 1479, Carlsbad, New Mexico 88221-1479

CONTACT PARTY: Melanie Wilson

PHONE: 575-914-1461

III. WELL DATA: Complete the data required on the reverse side of this form for each well proposed for injection.
Additional sheets may be attached if necessary.

IV. Is this an expansion of an existing project? Yes X No
If yes, give the Division order number authorizing the project: _____

V. Attach a map that identifies all wells and leases within two miles of any proposed injection well with a one-half mile radius circle drawn around each proposed injection well. This circle identifies the well's area of review.

VI. Attach a tabulation of data on all wells of public record within the area of review which penetrate the proposed injection zone. Such data shall include a description of each well's type, construction, date drilled, location, depth, record of completion, and a schematic of any plugged well illustrating all plugging detail.

VII. Attach data on the proposed operation, including:

1. Proposed average and maximum daily rate and volume of fluids to be injected;
2. Whether the system is open or closed;
3. Proposed average and maximum injection pressure;
4. Sources and an appropriate analysis of injection fluid and compatibility with the receiving formation if other than reinjected produced water; and,
5. If injection is for disposal purposes into a zone not productive of oil or gas at or within one mile of the proposed well, attach a chemical analysis of the disposal zone formation water (may be measured or inferred from existing literature, studies, nearby wells, etc.).

*VIII. Attach appropriate geologic data on the injection zone including appropriate lithologic detail, geologic name, thickness, and depth. Give the geologic name, and depth to bottom of all underground sources of drinking water (aquifers containing waters with total dissolved solids concentrations of 10,000 mg/l or less) overlying the proposed injection zone as well as any such sources known to be immediately underlying the injection interval.

IX. Describe the proposed stimulation program, if any.

*X. Attach appropriate logging and test data on the well. (If well logs have been filed with the Division, they need not be resubmitted).

*XI. Attach a chemical analysis of fresh water from two or more fresh water wells (if available and producing) within one mile of any injection or disposal well showing location of wells and dates samples were taken.

XII. Applicants for disposal wells must make an affirmative statement that they have examined available geologic and engineering data and find no evidence of open faults or any other hydrologic connection between the disposal zone and any underground sources of drinking water.

XIII. Applicants must complete the "Proof of Notice" section on the reverse side of this form.

XIV. Certification: I hereby certify that the information submitted with this application is true and correct to the best of my knowledge and belief.

NAME: Melanie Wilson

TITLE: Regulatory Analyst

SIGNATURE: _____

DATE: 9/27/18

E-MAIL ADDRESS: mjp1692@gmail.com

* If the information required under Sections VI, VIII, X, and XI above has been previously submitted, it need not be resubmitted.
Please show the date and circumstances of the earlier submittal: _____

DISTRIBUTION: Original and one copy to Santa Fe with one copy to the appropriate District Office

III. WELL DATA

A. The following well data must be submitted for each injection well covered by this application. The data must be both in tabular and schematic form and shall include:

- (1) Lease name; Well No.; Location by Section, Township and Range; and footage location within the section.
- (2) Each casing string used with its size, setting depth, sacks of cement used, hole size, top of cement, and how such top was determined.
- (3) A description of the tubing to be used including its size, lining material, and setting depth.
- (4) The name, model, and setting depth of the packer used or a description of any other seal system or assembly used.

Division District Offices have supplies of Well Data Sheets which may be used or which may be used as models for this purpose. Applicants for several identical wells may submit a "typical data sheet" rather than submitting the data for each well.

B. The following must be submitted for each injection well covered by this application. All items must be addressed for the initial well. Responses for additional wells need be shown only when different. Information shown on schematics need not be repeated.

- (1) The name of the injection formation and, if applicable, the field or pool name.
- (2) The injection interval and whether it is perforated or open-hole.
- (3) State if the well was drilled for injection or, if not, the original purpose of the well.
- (4) Give the depths of any other perforated intervals and detail on the sacks of cement or bridge plugs used to seal off such perforations.
- (5) Give the depth to and the name of the next higher and next lower oil or gas zone in the area of the well, if any.

XIV. PROOF OF NOTICE

All applicants must furnish proof that a copy of the application has been furnished, by certified or registered mail, to the owner of the surface of the land on which the well is to be located and to each leasehold operator within one-half mile of the well location.

Where an application is subject to administrative approval, a proof of publication must be submitted. Such proof shall consist of a copy of the legal advertisement which was published in the county in which the well is located. The contents of such advertisement must include:

- (1) The name, address, phone number, and contact party for the applicant;
- (2) The intended purpose of the injection well; with the exact location of single wells or the Section, Township, and Range location of multiple wells;
- (3) The formation name and depth with expected maximum injection rates and pressures; and,
- (4) A notation that interested parties must file objections or requests for hearing with the Oil Conservation Division, 1220 South St. Francis Dr., Santa Fe, New Mexico 87505, within 15 days.

NO ACTION WILL BE TAKEN ON THE APPLICATION UNTIL PROPER PROOF OF NOTICE HAS BEEN SUBMITTED.

NOTICE: Surface owners or offset operators must file any objections or requests for hearing of administrative applications within 15 days from the date this application was mailed to them.

DISTRICT IV
1220 S. ST. FRANCIS DR., SANTA FE, NM 87505
Phone: (505) 476-3460 Fax: (505) 476-3462

Form C-102
Revised August 1, 2011
Submit one copy to appropriate
District Office

☐ AMENDED REPORT

API Number	Pool Code	Pool Name
Property Code	Property Name BAKER SWD	Well Number 1
OGRID No.	Operator Name MESQUITE SWD	Elevation 3280.0'

UL or lot No.	Section	Township	Range	Lot Idn	Feet from the	North/South line	Feet from the	East/West line	County
M	1	26-S	31-E		330	SOUTH	309	WEST	EDDY

UL or lot No.	Section	Township	Range	Lot Idn	Feet from the	North/South line	Feet from the	East/West line	County
Dedicated Acres	Joint or Infill	Consolidation Code	Order No.						

<p>NAD 83 NME <u>SURFACE LOCATION</u> Y=388165.3 N X=725355.1 E LAT.=32.065754° N LONG.=103.739286° W</p> <p>309' S.L. 330'</p>		OPERATOR CERTIFICATION	
		<i>I hereby certify that the information herein is true and complete to the best of my knowledge and belief, and that this organization either owns a working interest or unleased mineral interest in the land including the proposed bottom hole location or has a right to drill this well at this location pursuant to a contract with an owner of such mineral or working interest, or to a voluntary pooling agreement or a compulsory pooling order heretofore entered by the division.</i>	
		Signature	Date
		Printed Name	
		E-mail Address	
		SURVEYOR CERTIFICATION	
		<i>I hereby certify that the well location shown on this plat was plotted from field notes of actual surveys made by me or under my supervision, and that the same is true and correct to the best of my belief.</i>	
		JULY 20, 2018	
		Date of Survey	
		Signature & Seal of Professional Surveyor	
			
		Certificate No. CHAD HARGROW 17777	
		W.O. # 18-819 DRAWN BY: SP	

T 26 S

R
3
1
E

02

01

PROPOSED
BAKER SWD #1

105.7

12

11

LEGEND



WELL



WELLPAD



PROPOSED ROAD



EXISTING ROAD

BAKER SWD #1

SEC: 1 TWP: 26 S. RGE: 31 E. ELEV: 3280.0'

STATE: NEW MEXICO COUNTY: EDDY 330' FSL & 309' FWL

W.O. # 18-819 LEASE: BAKER SWD SURVEY: N.M.P.M

0 2,500 FEET

0 0.05 0.1 0.2 Miles

1 IN = 1,000 FT

LOCATION OVERVIEW

IMAGERY

7/25/2018

S.P.

MESQUITE SWD



HARCROW SURVEYING, LLC.
2314 W. MAIN ST, ARTESIA, NM 88210
PH: (575) 746-2158 FAX: (575) 746-2158
TEXAS FIRM NO. 10194089
c.harcrow@harcrowsurveying.com

INJECTION WELL DATA SHEET

OPERATOR: Mesquite SWD, Inc.

WELL NAME & NUMBER: Baker SWD Well No. 1

WELL LOCATION: 330' FSL & 309' FWL M 1 26S 31E
FOOTAGE LOCATION UNIT LETTER SECTION TOWNSHIP RANGE

WELLBORE SCHEMATIC
(SEE ATTACHED)

WELL CONSTRUCTION DATA

Surface Casing

Hole Size: 26" Casing Size: 20" 94# J-55 BTC
Cemented with: 1700 sx. or ft³
Top of Cement: Surface Method Determined: Circulate

1st Intermediate Casing

Hole Size: 17.5" Casing Size: 13.375" 68# P-110
Cemented with: 2500 sx. or ft³
Top of Cement: Surface Method Determined: Circulate

2nd Intermediate Casing

Hole Size: 12.5" Casing Size: 9.625" 53.5# P-110 BTC
Cemented with: 2,800 sx. Staged; DV Tools @ 8,200' & 4,500'
Top of Cement: Surface Method Determined: Circulate

Liner

Hole Size: 8.5" Casing Size: 7.625" 39# P-110 UFJ Liner
Cemented with: 400 sx. or ft³
Top of Cement: 11,400' (Liner Top) Method Determined: Circulate

Total Depth: Approximately 18,500'

Injection Interval

Approximately 17,300' To 18,500'
(Perforated or Open Hole; indicate which) Open Hole

Tubing Size: Tapered String 7" 26# P-110/5 1/2" 17# P-110 Lining Material: Fiberglass Coated

Type of Packer: Lok-Set or Equivalent

Packer Setting Depth: Approximately 17,250'

Other Type of Tubing/Casing Seal (if applicable): _____

Additional Data

1. Is this a new well drilled for injection: X Yes No
If no, for what purpose was the well originally drilled? _____

2. Name of Injection Formation: Siluro-Devonian
3. Name of Field or Pool (if applicable): SWD; Devonian
4. Has the well ever been perforated in any other zone(s)? List all such perforated intervals
and give plugging detail, i.e. sacks of cement or plug(s) used: None

5. Give the name and depths of any oil or gas zones underlying or overlying the proposed
injection zone in this area: According to OCD pool records, the only pool existing in Section 1 is the
Purple Sage-Wolfcamp (Gas) Pool (Depth 12,000'). Within the area surrounding Section 1 are the
following pools: Southeast Big Sinks-Delaware & Big Sinks-Delaware Pools (Depth: 4,172'); Jennings-
Bone Spring Upper Shale Pool; (Depths: 8,700'-9,100');

(Note: See attached OCD Pool Maps)

Mesquite SWD, Inc.
Baker SWD No. 1: Proposed Wellbore Schematic
330' FSL & 309' FWL (Unit M)
Section 1, T-26S, R-31E, NMPM, Eddy County, NM

Surface Casing:

Hole Size: 26"
 Size: 20" 94# J-55
 Set @: 950'
 Sx. Cmt: 1700
 TOC: Surface

1st Intermediate Casing:

Hole Size: 17.5"
 Size: 13.375" 68# P-110
 Set @: 4,300'
 Sx. Cmt: 2,500
 TOC: Surface

2nd Intermediate Casing

Hole Size: 12.5"
 Size: 9.625 53.5# P-110
 Set @: 11,900'
 Stage Cemented
 DV Tools @ 8,200' & 4,500'
 All Stages Circulate
 TOC: Surface

Liner

Hole Size: 8.5"
 Size: 7.625" 39# P-110 UFJ
 Set @: 11,400'-17,300'
 Sx. Cmt: 400
 TOC: 11,400' (Liner Top)

Open Hole Injection Interval

Hole Size: 6 1/2"
 Interval: 17,300'-18,500'

Formation Tops:

Rustler:	925'
Top of Salt:	1,275'
Base of Salt:	4195'
Bone Spring:	9,416'
Wolfcamp:	11,852'
Strawn:	14,056'
Atoka:	14,191'
Morrow:	14,956'
Mississippian:	16,860'
Top Siluro-Devonian:	17,302'
Montoya:	18,854'

(Note: Formation tops based on offset
 Paduca 6 SWD No. 1Y located in
 Section 6, T-26S, R-32E)

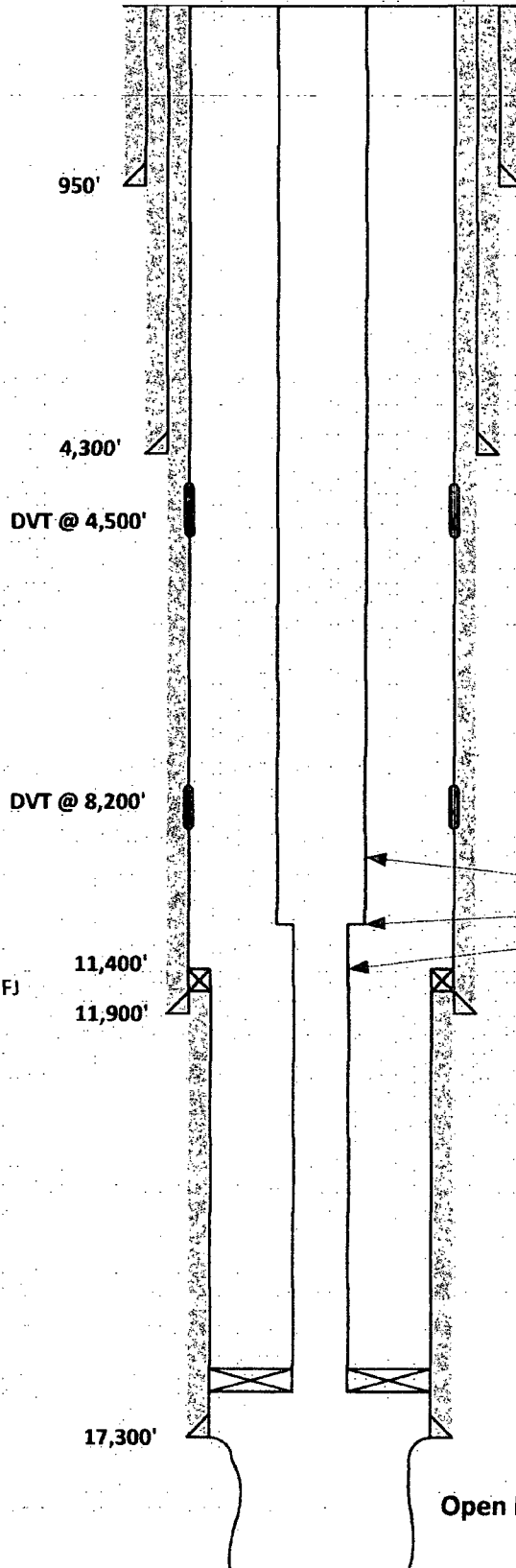

Injection Tubing

7" 26# P-110 Tbg: Surface-11,200'
 7" x 5 1/2" X-Over @ 11,200'
 5 1/2" 17# P-110 Tbg: 11,200'-17,250'
 7 5/8" x 5 1/2" Dual Bore Permapak
 Packer @ 17,250'

Open Hole Injection Interval: 17,300'-18,500'

T.D. 18,500'

C-108 Application
Mesquite SWD, Inc.
Baker SWD No. 1
330' FSL & 309' FWL (Unit M)
Section 1, T-26S, R-31E, NMPM
Eddy County, New Mexico

- I. The purpose of the application is to request approval to utilize the proposed Baker SWD No. 1 as a produced water disposal well. This is a new well to be drilled for injection.
- II. Mesquite SWD, Inc.
P.O. Box 1479
Carlsbad, New Mexico 88221-1479
Contact Party: Melanie Wilson (575) 914-1461
- III. Injection well data sheet and wellbore schematic diagram showing the proposed wellbore configuration is attached.
- IV. This is not an expansion of an existing project.
- V. Attached are maps that identify all wells/leases within a 2-mile and 1-mile radius of the proposed water disposal well and a map that identifies the 1-mile "Area of Review" ("AOR").
- VI. A listing of all wells within the AOR, including API No., operator, well name & number, well type and status, surface and bottomhole well locations, MD and TVD and completed formation is attached. An examination of the AOR well listing shows that none of the 31 active or proposed wells within the AOR penetrate, or will penetrate the proposed injection interval. In addition, none of the four PA'd wells within the AOR penetrate the proposed injection interval.
- VII.
 1. The average injection rate is anticipated to be approximately 30,000 BWPd. The maximum rate will be approximately 40,000 BWPd. If the average or maximum rates increase in the future, the Division will be notified.
 2. This will be a closed system.
 3. Mesquite SWD, Inc. will initially inject water into the subject well at or below a surface injection pressure in compliance with the Division's limit of 0.2 psi/ft., or approximately 3,460 psi. If a surface injection pressure above 3,460 psi is necessary, Mesquite SWD, Inc. will conduct a step rate injection test to determine the fracture pressure of the Siluro-Devonian formation in this area.

4. Produced water from the Bone Spring, Wolfcamp, Delaware and other producing formations originating from wells in this area will be injected into the subject well. Attached are produced water analysis from various producing wells in Township 26 South, Range 31 East that produce from the Delaware, Bone Spring and Wolfcamp formations. These produced water analyses were obtained from the GO Tech website.
5. An examination of Division records indicate that the Siluro-Devonian formation is not productive within one mile of the Baker SWD No. 1. A produced water analysis from the Devonian formation within the Remuda Basin Unit Well No. 1, located in Section 24, Township 23 South, Range 29 East, NMPM, Eddy County, New Mexico, was obtained from the Go Tech website, and is attached to this application. This produced water analysis shows a TDS of 56,922 Mg/L.

VIII. Geologic Formation: Devonian/Silurian
Estimated Top: 17,302'
Thickness: 1,552'
Lithology: Limestone w/Interbedded Dolomites

(Note: The top of the Devonian interval cited above was determined by examination of the well file for the offset Paduca 6 SWD No. 1Y, located in Unit E of Section 6, Township 26 South, Range 32 East, NMPM. This well is located approximately 1.25 miles Northeast of the proposed Baker SWD No. 1, and was permitted for injection into the Devonian interval by Order No. SWD-1607-A issued on August 17, 2016. Division records also indicate that this well is active, is currently injecting approximately 17,656 BWPD into the Devonian interval, and has cumulatively injected 6,666,203 barrels of water).

(Note: An examination of OCD well records indicate that there are no additional produced water disposal wells located within the nine-section area surrounding Section 1, T-26S, R-31E, NMPM.)

USDW's: According to data obtained from the New Mexico State Engineer, there are four fresh water wells located within one mile of the Baker SWD No. 1 (See Attached). These wells range in depth from 350 feet to 700 feet, and the depth to water averages 335 feet. Mesquite SWD, Inc. will attempt to obtain a water sample from one of these wells and forward a fresh water analysis to the Division when obtained.

- IX. Formation chemical stimulation may be applied after completion. No other stimulation is currently planned.
- X. Logs will be filed subsequent to the completion of drilling operations. Density-Neutron is planned to be run from surface to TD.
- XI. There are four fresh water wells located within a one-mile radius of the Baker SWD No. 1. (See attached report from the OSE).
- XII. Affirmative statement is enclosed.
- XIII. Proof of Notice is enclosed.

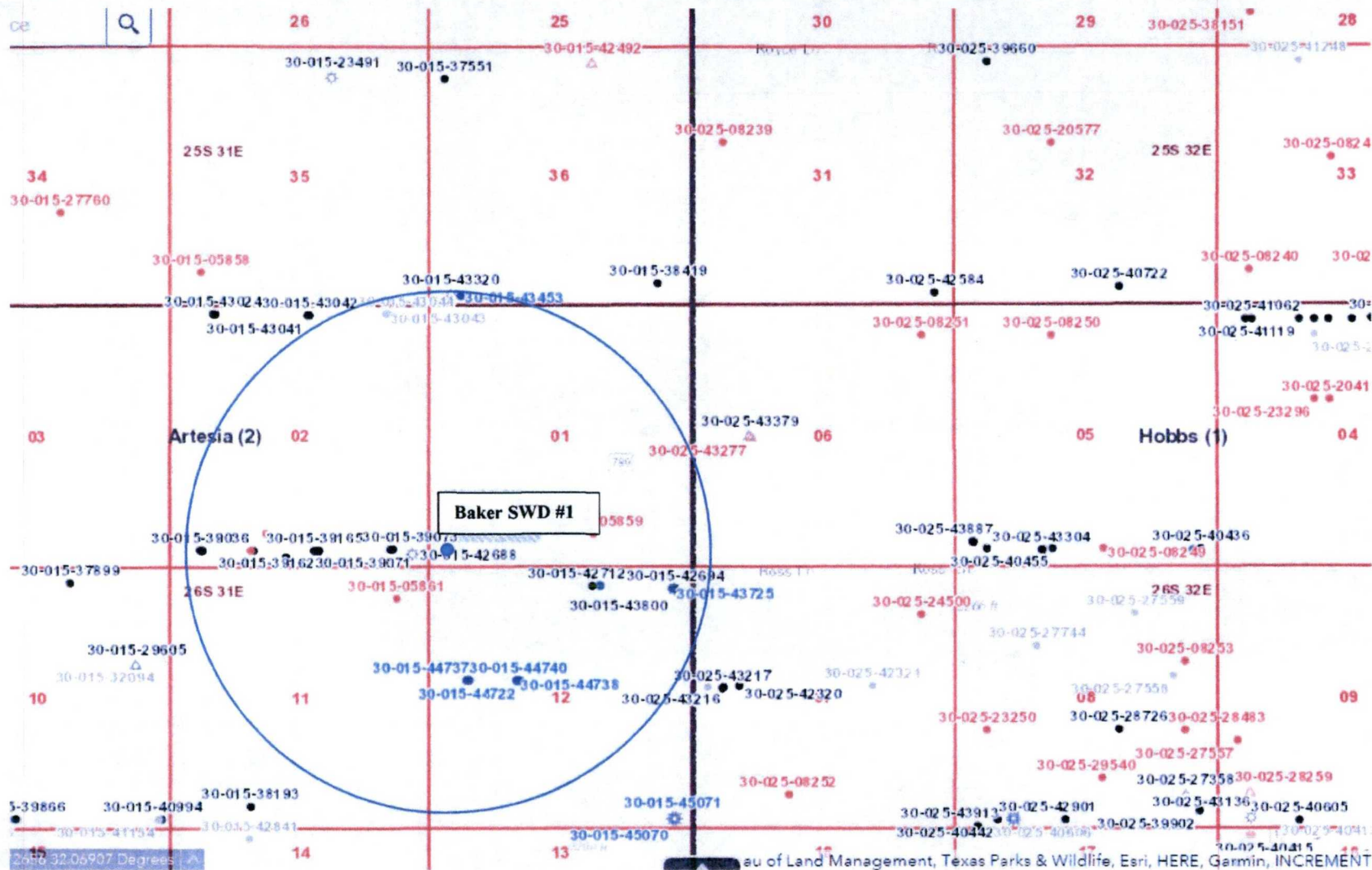

Mesquite SWD, Inc.
Form C-108: Baker SWD No. 1
1-Mile Area of Review Map

MESQUITE SWD, INC.
BAKER SWD WELL NO. 1
ONE-MILE AREA OF REVIEW WELL LIST

API NUMBER	OPERATOR	LEASE NAME	WELL NO.	WELL TYPE	STATUS	FTG. N/S	N/S	FTG. E/W	E/W	UNIT	SEC.	TSHF.	RNG.	TVD	MD	COMPLETION
30-015-44737	Devon Energy Prod. Co. LP	Snapping 12 1 Fed	521H	Oil	NYD	2325'	N	810'	W	E	12	26S	31E	8,713' *	15,794' *	Bone Spring
					BHL	330'	N	550'	W	D	1	26S	31E			
30-015-44738	Devon Energy Prod. Co. LP	Snapping 12 1 Fed	522H	Oil	NYD	2325'	N	1790'	W	F	12	26S	31E	8,753' *	16,170' *	Bone Spring
					BHL	330'	N	1430'	W	C	1	26S	31E			
30-015-44758	Devon Energy Prod. Co. LP	Snapping 12 1 Fed	523H	Oil	NYD	2325'	N	1880'	W	F	12	26S	31E	8,773' *	16,198' *	Bone Spring
					BHL	330'	N	2310'	W	C	1	26S	31E			
30-015-44721	Devon Energy Prod. Co. LP	Snapping 12 1 Fed	531H	Oil	NYD	2325'	N	780'	W	E	12	26S	31E	8,983' *	16,064' *	Bone Spring
					BHL	330'	N	500'	W	D	1	26S	31E			
30-015-44739	Devon Energy Prod. Co. LP	Snapping 12 1 Fed	532H	Oil	NYD	2325'	N	840'	W	E	12	26S	31E	8,973' *	16,084' *	Bone Spring
					BHL	330'	N	1320'	W	D	1	26S	31E			
30-015-44722	Devon Energy Prod. Co. LP	Snapping 12 1 Fed	533H	Oil	NYD	2325'	N	1850'	W	F	12	26S	31E	9,013' *	16,379' *	Bone Spring
					BHL	330'	N	2140'	W	C	1	26S	31E			
30-015-44740	Devon Energy Prod. Co. LP	Snapping 12 1 Fed	623H	Oil	NYD	2325'	N	1820'	W	F	12	26S	31E	11,541' *	18,958' *	Wolfcamp
					BHL	330'	N	2090'	W	C	1	26S	31E			
30-015-42694	Mewbourne Oil Company	Big Sinks 1 A2 PA Fed Com	1H	Oil	Active	465'	N	460'	E	A	12	26S	31E	8,838'	13,965'	Bone Spring
					BHL	354'	N	482'	W	A	1	26S	31E			
30-015-43318	Mewbourne Oil Company	Big Sinks 1 A2OB Fee	1H	Oil	NYD	410'	N	1850'	E	B	12	26S	31E	9,097' *	13,938' *	Bone Spring
					BHL	330'	N	1650'	E	B	1	26S	31E			
30-015-42712	Mewbourne Oil Company	Big Sinks 1 A30B Fee	2H	Oil	Active	410'	N	1980'	E	B	12	26S	31E	9,131'	14,295'	Bone Spring
					BHL	337'	N	2275'	E	B	1	26S	31E			
30-015-43725	Mewbourne Oil Company	Big Sinks 1 B2 PA Fed Com	3H	Oil	NYD	465'	N	395'	E	A	12	26S	31E	10,317' *	15,627' *	Bone Spring
					BHL	330'	N	660'	E	A	1	26S	31E			
30-015-43800	Mewbourne Oil Company	Big Sinks 1 W1PA Fed Com	2H	Gas	Active	465'	N	330'	E	A	12	26S	31E	12,071'	17,430'	Wolfcamp
					BHL	330'	N	330'	E	A	1	26S	31E			
30-015-43453	Mewbourne Oil Company	BEBOP 36 B2MD State	1H	Oil	NYD	185'	S	660'	W	M	36	25S	31E	9,000' *	14,880' *	Bone Spring
					BHL	330'	N	660'	W	D	36	25S	31E			

MESQUITE SWD, INC.
BAKER SWD WELL NO. 1
ONE-MILE AREA OF REVIEW WELL LIST

API NUMBER	OPERATOR	LEASE NAME	WELL NO.	WELL TYPE	STATUS	FTG N/S	N/S	FTG E/W	E/W	UNIT	SEC.	TSHP	RNG.	TVD	MD	COMPLETION
30-015-43320	Mewbourne Oil Company	BEBOP 36 W1MD State	2H	Gas	Active	185'	S	450'	W	M	36	25S	31E	12,038'	16,550'	Wolfcamp
					BHL	338'	N	532'	W	D	36	26S	31E			
30-015-39104	Devon Energy Prod. Co. LP	Snapping 2 State	1Y	Oil	Active	330'	S	1710'	W	N	2	26S	31E	8,574'	13,007'	Bone Spring
					BHL	343'	N	1650'	W	C	2	26S	31E			
30-015-39035	Devon Energy Prod. Co. LP	Snapping 2 State	2H	Oil	Active	330'	S	680'	W	M	2	26S	31E	8,966'	13,600'	Bone Spring
					BHL	330'	N	990'	W	D	2	26S	31E			
30-015-39036	Devon Energy Prod. Co. LP	Snapping 2 State	3H	Oil	Active	330'	S	630'	W	M	2	26S	31E	8,560'	13,136'	Bone Spring
					BHL	355'	N	390'	W	D	2	26S	31E			
30-015-39071	Devon Energy Prod. Co. LP	Snapping 2 State	4H	Oil	Active	330'	S	735'	E	P	2	26S	31E	9,054'	13,539'	Bone Spring
					BHL	342'	N	413'	E	A	2	26S	31E			
30-015-39073	Devon Energy Prod. Co. LP	Snapping 2 State	5H	Oil	Active	330'	S	785'	E	P	2	26S	31E	8,607'	13,122'	Bone Spring
					BHL	346'	N	1037'	E	A	2	26S	31E			
30-015-39162	Devon Energy Prod. Co. LP	Snapping 2 State	6H	Oil	Active	330'	S	2260'	E	O	2	26S	31E	9,004'	13,798'	Bone Spring
					BHL	350'	N	1712'	E	B	2	26S	31E			
30-015-39163	Devon Energy Prod. Co. LP	Snapping 2 State	7H	Oil	Active	330'	S	2310'	E	O	2	26S	31E	8,550'	13,102'	Bone Spring
					BHL	353'	N	2306'	E	B	2	26S	31E			
30-015-39165	Devon Energy Prod. Co. LP	Snapping 2 State	8H	Oil	Active	330'	S	2360'	E	O	2	26S	31E	8,981'	13,654'	Bone Spring
					BHL	400'	N	2337'	W	C	2	26S	31E			
30-015-43023	Devon Energy Prod. Co. LP	Snapping 2 State	9H	Oil	Active	200'	N	880'	W	D	2	26S	31E	10,214'	14,825'	Bone Spring
					BHL	348'	S	410'	W	M	2	26S	31E			
30-015-43024	Devon Energy Prod. Co. LP	Snapping 2 State	10H	Oil	Active	200'	N	930'	W	D	2	26S	31E	10,204'	14,766'	Bone Spring
					BHL	350'	S	410'	W	M	2	26S	31E			
30-015-43041	Devon Energy Prod. Co. LP	Snapping 2 State	11H	Oil	Active	220'	N	2490'	E	B	2	26S	31E	10,242'	14,811'	Bone Spring
					BHL	340'	S	2183'	W	N	2	26S	31E			
30-015-43042	Devon Energy Prod. Co. LP	Snapping 2 State	12H	Oil	Active	229'	N	2440'	E	B	2	26S	31E	10,239'	14,790'	Bone Spring
					BHL	342'	S	2215'	E	O	2	26S	31E			

**MESQUITE SWD, INC.
BAKER SWD WELL NO. 1
ONE-MILE AREA OF REVIEW WELL LIST**

[illegible]

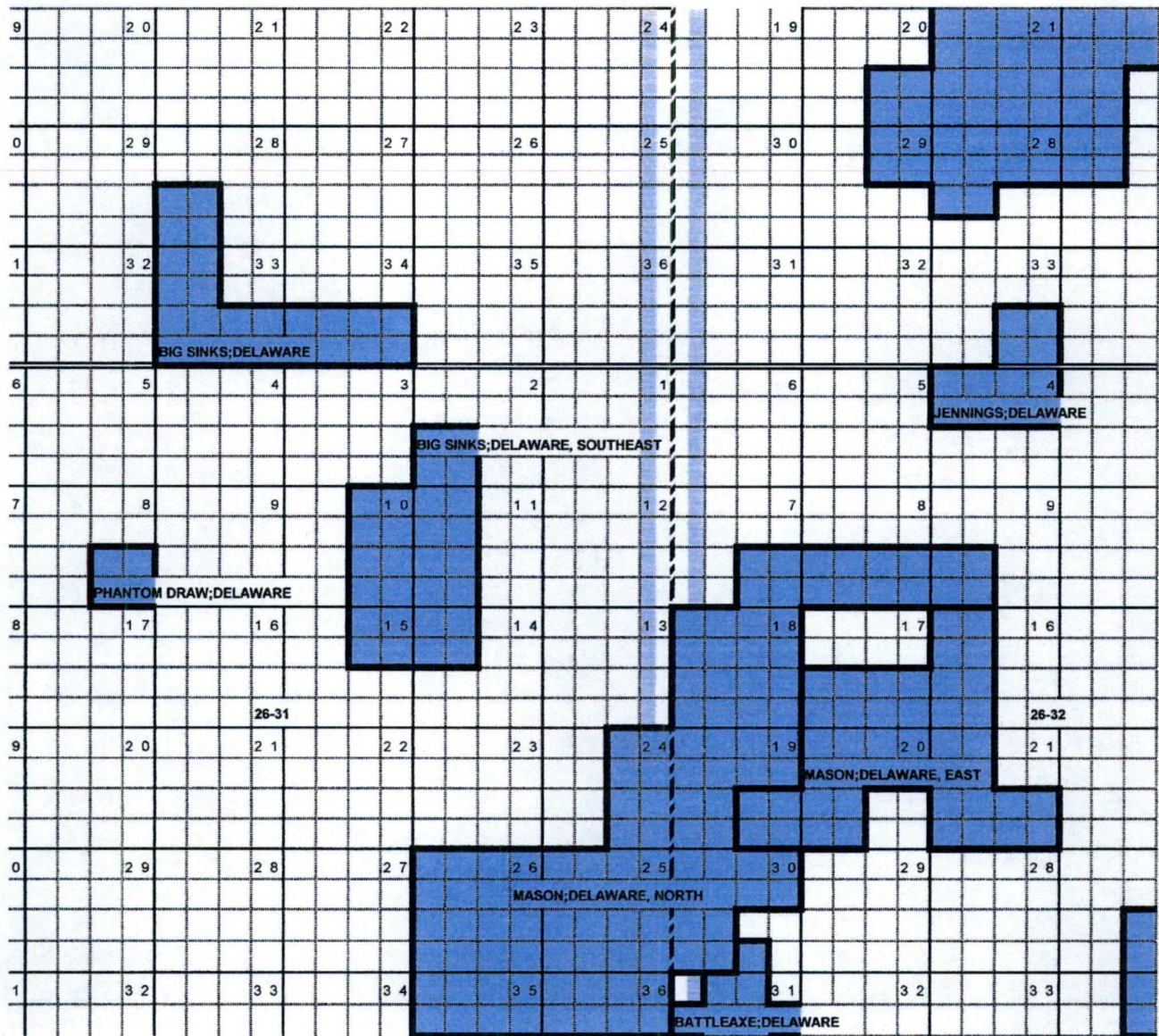

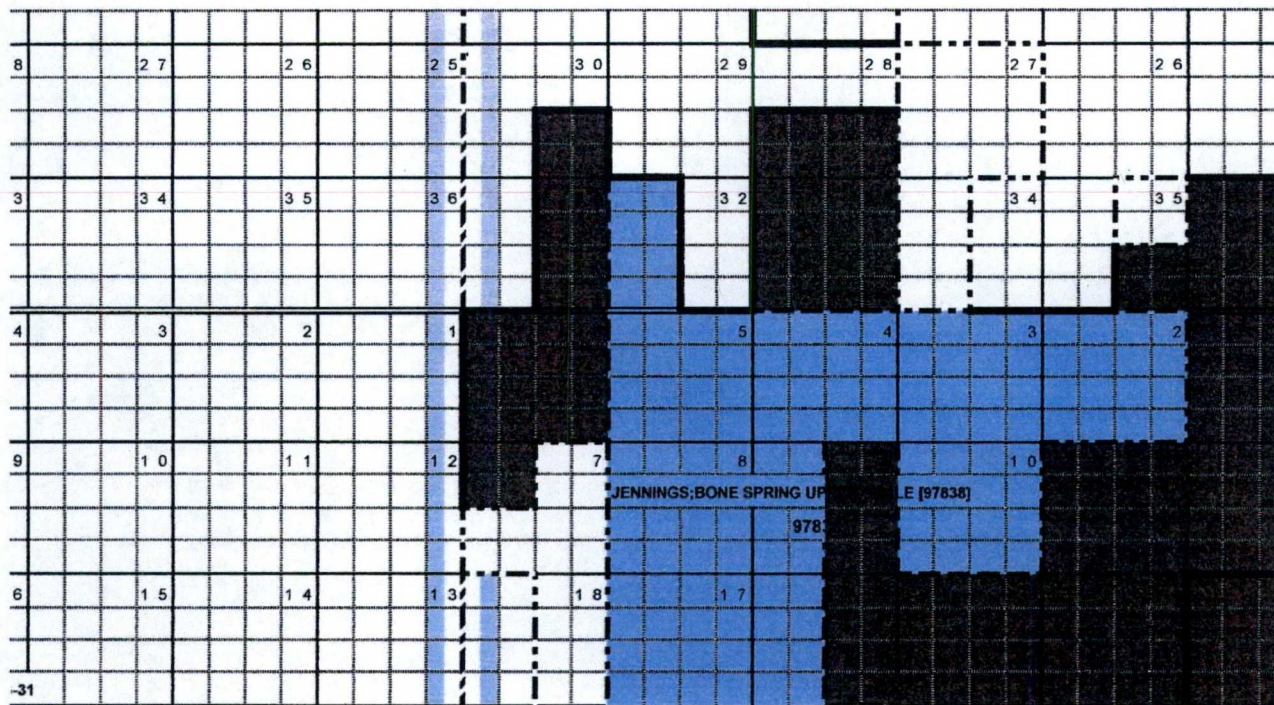

9	2 8	2 7	2 6	2 5		3 0		2 9		2 8		2 7		2 6
2	3 3	3 4	3 5	3 6		3 1		3 2		3 3		3 4		3 5
5	4	3	2	1		6		5		4		3		2
8	9	1 0	1 1	1 2		7		8				1 0		1 1
PURPLE SAGE;WOLFCAMP (GAS) [98220]														
7	1 6	1 5	1 4	1 3		1 8		1 7				1 5		1 4
WC-025 G-08 S263205N: WOLFCAMP [98065]														
98065 98065														
26-31														

	1 6		1 5		1 4		1 3	82440	1 8		1 7		1 6		1 5
								PADUCA, DEVONIAN (GAS)							
	25-31												25-32		
	2 1		2 2		2 3		2 4		1 9		2 0		2 1		2 2
	2 8		2 7		2 6		2 5		3 0		2 9		2 8		2 7
	3 3		3 4		3 5		3 6		3 1		3 2		3 3		3 4
	4		3		2		1		6		5		4		3
	9		1 0		1 1		1 2		7		8		9		1 0
	1 6		1 5		1 4		1 3		1 8		1 7		1 6		1 5
	26-31												26-32		
	2 1		2 2		2 3		2 4		1 9		2 0		2 1		2 2

Well Name	Section	Township	Range	Unit	Formation	Ph	TD5/Mg/l	Sodium Mg/l	Calcium Mg/l	Iron Mg/l	Magnesium Mg/l	Manganese Mg/l	Chloride Mg/l	Bicarbonate Mg/l	Sulfate Mg/l	CO2 Mg/l
SNAPPING 2 STATE #013H	2	26S	31E	N	BONE SPRING 3RD SAND	6.5	94965.6	31352.7	3678.6	31.7	483.6	0.83	57489.5	244	0	200
SNAPPING 2 STATE #013H	2	26S	31E	N	BONE SPRING 3RD SAND	7	94518.2	30031.5	3402.8	19.9	438.9		58782.2		355.2	200
SNAPPING 2 STATE #013H	2	26S	31E	N	BONE SPRING 3RD SAND	7.2	94863.9	30224.8	3424	14.8	444		59015.2		365	200
SNAPPING 2 STATE #014H	2	26S	31E	P	WOLF CAMP	7.3	81366.4	26319.4	2687.4	26.1	326.7		50281.2		399.7	100
SNAPPING 2 STATE #013H	2	26S	31E	N	BONE SPRING 3RD SAND	6.8	91289.1	28721.3	3440.7	16.3	437.4		56957.4		327.9	150
ROSS RANCH 10 FEDERAL #001	10	26S	31E	H		6.3	111430.5	38922.4	3647.3	76.8	487.9	1.05	66173.2	366	0	300
ROSS RANCH 10 FEDERAL #001	10	26S	31E	H		7	54116.9	46100	5224	349.6	719.3	3.73	0	73.2	0	570
SNAPPING 10 FEDERAL #005H	10	26S	31E	P	BONE SPRING 2ND SAND	6.6	138161.9	44458.5	6280.8	29.7	781.3	0	84470	122	0	20
SNAPPING 10 FEDERAL #005H	10	26S	31E	P	BONE SPRING 2ND SAND	6.6	138376	44458.5	6280.8	29.7	781.3	0	84470	122	618	20
SNAPPING 10 FEDERAL #001H	10	26S	31E	B	AVALON UPPER	6.5	199638.8	68948.2	7560.4	111.2	1522.8	2.19	118195	732	0	500
SNAPPING 11 FEDERAL #001H	11	26S	31E	N	AVALON UPPER	6.1	225189.8	77010.7	8743.8	636.1	1649.2	6.75	134075	366	0	300
SNAPPING 2 STATE #003H	2	26S	31E	M	AVALON UPPER	6.1	223019	76001.7	10437.8	209.9	1922.4	4.5	131072	366	632	1100
SNAPPING 2 STATE #006H	2	26S	31E	O	AVALON UPPER	6.5	179788.5	71575.7	617.4	21.8	109.6	0	101374	3660	0	500
SNAPPING 2 STATE #006H	2	26S	31E	O	AVALON UPPER	6.5	179938	71575.7	617.4	21.8	109.6	0	101374	3660	844	500
SNAPPING 10 FEDERAL #003H	10	26S	31E	N	BONE SPRING 2ND SAND	6.5	152439.2	48495.7	6731.3	29.1	801.4	1.06	94055	244	0	100
E D WHITE FEDERAL NCT 1 #003	26	26S	31E	O	DELAWARE		212112						132100	195	425	
SNAPPING 10 FEDERAL #001H	10	26S	31E	B	AVALON UPPER	7.1	209352.4	70089.5	7327	203	1557	2.5	127230	146.4	600	600
SNAPPING 11 FEDERAL #001H	11	26S	31E	N	AVALON UPPER	7	196576.7	68797.3	5059	12	1066	0.9	118943	122	872	380
SNAPPING 11 FEDERAL #001H	11	26S	31E	N	AVALON UPPER	7	203078.9	72261.4	4407	112	904	1.5	122172	1098	658	80
SNAPPING 2 STATE #001Y	2	26S	31E	N	AVALON UPPER	7	162560.1	57137	3886	42	776	0.6	97161	1403	756	70

Well Name	Section	Township	Range	Unit	Field	Formation	Sample Source	TDS Mg/l	Chloride Mg/l	Bicarbonate Mg/l	Sulfate Mg/l
REMUDA BASIN UNIT #001	24	23S	29E	J	REMUDA	DEVONIAN	SWAB	56922	29000	1740	4980



New Mexico Office of the State Engineer Water Column/Average Depth to Water

(A CLW##### in the
POD suffix indicates the
POD has been replaced
& no longer serves a
water right file.)

(R=POD has
been replaced,
O=orphaned,
C=the file is
closed)

(quarters are 1=NW 2=NE 3=SW 4=SE)

(quarters are smallest to largest) (NAD83 UTM in meters) (In feet)

POD Number	POD Sub- Code	basin	County	Q	Q	Q	Sec	Tws	Rng	X	Y	Depth Well	Depth Water	Water Column
C 02090	C	ED		4	4	01	26S	31E		620329	3548533*	350	335	15
C 03554 POD1	CUB	ED		2	1	4	01	26S	31E	620547	3549148	630	300	330
C 03639 POD1	CUB	ED		3	4	2	01	26S	31E	620168	3549279	700	365	335
C 04256 POD1	CUB	ED		4	4	2	01	26S	31E	620384	3549257	666	340	326

Average Depth to Water: 335 feet

Minimum Depth: 300 feet

Maximum Depth: 365 feet

Record Count: 4

PLSS Search:

Section(s): 1, 2, 11, 12

Township: 26S

Range: 31E

Mesquite SWD, Inc.
Form C-108; Baker SWD No. 1
Office of the State Engineer
Fresh Water Well Data

*UTM location was derived from PLSS - see Help

The data is furnished by the NMOSE/ISC and is accepted by the recipient with the expressed understanding that the OSE/ISC make no warranties, expressed or implied, concerning the accuracy, completeness, reliability, usability, or suitability for any particular purpose of the data.

8/7/18 2:00 PM

Page 1 of 1

WATER COLUMN/ AVERAGE
DEPTH TO WATER

Form C-108
Affirmative Statement
Mesquite SWD, Inc.
Baker SWD No. 1
Section 1, T-26 South, R-31 East, NMPM,
Eddy County, New Mexico

Available geologic and engineering data has been examined and no evidence of open faults or hydrological connection between the injection zone and any underground sources of drinking water has been found.



Riley Neatherlin
Operations Manager – Mesquite SWD, Inc.

9/27/18
Date

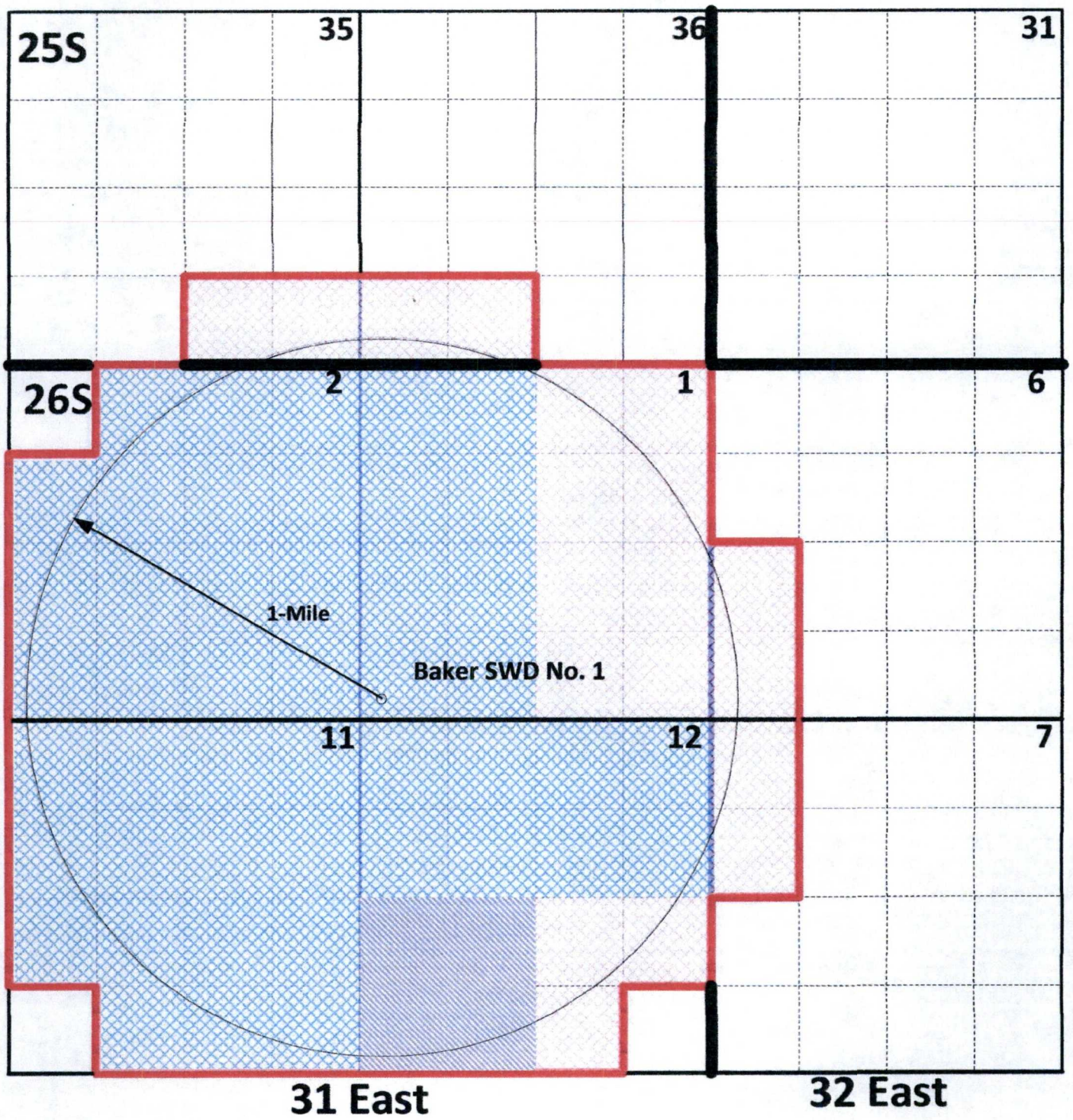

C-108 Application
 Mesquite SWD, Inc.
 Baker SWD Well No. 1
 1-Mile Notice Area

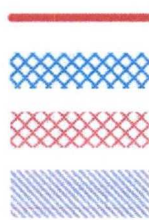

1-Mile Notice Area
 Tract 1
 Tract 2
 Tract 3

Form C-108 Application
Mesquite SWD, Inc.
Baker SWD No. 1
Section 1, T-26 South, R-31 East, NMPM
Notice List

Tract 1:

Section 2: E/2, E/2 W/2, SW/4 NW/4 & W/2 SW/4	Devon Energy Production Co., LP 20 North Broadway Oklahoma City, OK 73102
Section 11: E/2 W/2:	Devon Energy Production Co., LP
Section 11: E/2, W/2 NW/4 & NW/4 SW/4	Devon Energy Production Co., LP XTO Holdings, LLC 810 Houston Street Fort Worth, Texas 76102
Section 12: N/2:	Devon Energy Production Co., LP XTO Holdings, LLC
Section 1: W/2:	Devon Energy Production Co., LP XTO Holdings, LLC

Tract 2:

Section 36: S/2 SW/4:	Mewbourne Oil Company P.O. Box 5270 Hobbs, New Mexico 88241
Section 35: S/2 SE/4:	Mewbourne Oil Company
Section 12: N/2 SE/4 & SW/4 SE/4:	Mewbourne Oil Company
Section 7: NW/4 NW/4 & SW/4 NW/4: (Lots 1 & 2)	Mewbourne Oil Company
Section 6: NW/4 SW/4: (Lot 3)	Mewbourne Oil Company Chevron USA, Inc. 6301 Deauville Blvd. Midland, Texas 79706

**Form C-108 Application
Mesquite SWD, Inc.
Baker SWD No. 1
Section 1, T-26 South, R-31 East, NMPM
Notice List (Page 2)**

**Section 6: NW/4 SW/4:
(Lot 3) (Cont.)**

**RBP Land Company Trust
Robert B. Porter Jr., Trustee
P.O. Box 10392
Midland, Texas 79702**

**Hayes Land, LP
P.O. Box 51510
Midland, Texas 79710-1510**

**Hayes Land & Production, LP
P.O. Box 51407
Midland, Texas 79710**

**Section 6: SW/4 SW/4:
(Lot 4)**

Mewbourne Oil Company

Section 1: NE/4 NE/4:

Mewbourne Oil Company

**Section 1: W/2 E/2, NE/4 SE/4 &:
SE/4 NE/4**

Mewborne Oil Company

Chevron USA, Inc.

RBP Land Company Trust

Hayes Land, LP

Hayes Land & Production, LP

Section 1: SE/4 SE/4:

Mewbourne Oil Company

Tract 3:

Section 12: SW/4:

**EOG Resources, Inc.
P.O. Box 2267
Midland, Texas 79706**

**ConocoPhillips Company
600 N. Dairy Ashford Rd.
Office EC3-10-W285
Houston, Texas 77079**

Form C-108 Application
Mesquite SWD, Inc.
Baker SWD No. 1
Section 1, T-26 South, R-31 East, NMPM
Notice List (Page 3)

Additional Notice:

Bureau of Land Management
620 E. Greene Street
Carlsbad, New Mexico 88220-6292

(Surface Owner):

Jessie T. & Susan Ann Baker
P.O. Box 24
Silver City, New Mexico 88062

September 27, 2018

CERTIFIED MAIL
RETURN RECEIPT REQUESTED

TO: **See Attached Notice List**

Re: Mesquite SWD, Inc.
Form C-108 (Application for Authorization to Inject)
Baker SWD Well No. 1
API No. (Not Yet Assigned)
330' FSL & 309' FWL, Unit M, Section 1, T-26S, R-31E, NMPM,
Eddy County, New Mexico

Ladies & Gentlemen:

Enclosed please find a copy of Oil Conservation Division Form C-108 (Application for Authorization to Inject) for the Mesquite SWD, Inc. Baker SWD No. 1. You are being provided a copy of the application as an offset operator/leaseholder or as the owner of the surface where the proposed well is located. Mesquite SWD, Inc. proposes to *drill the Baker SWD No. 1 and utilize the well as a produced water disposal well*, injection to occur into the Siluro-Devonian formation through the open-hole interval from approximately 17,300 feet to 18,500 feet.

Objections must be filed with the Oil Conservation Division, 1220 South St. Francis Drive, Santa Fe, New Mexico 87505, within 15 days.

If you should have any questions, please contact me at (575) 914-1461.

Sincerely,

Melanie Wilson-Regulatory Analyst
Mesquite SWD, Inc.
P.O. Box 1479
Carlsbad, New Mexico 88221-1479

Enclosure

Form C-108
Mesquite SWD, Inc.
Baker SWD No. 1
Section 1, T-26 South, R-31 East, NMPM,
Eddy County, New Mexico

The following-described legal advertisement will be published in the:

Artesia Daily Press
503 W. Main Street
Artesia, New Mexico 88210-2067

The Affidavit of Publication will be forwarded to the Division upon receipt by Mesquite SWD, Inc.

LEGAL NOTICE

Mesquite SWD, Inc., P.O. Box 1479, Carlsbad, New Mexico 88221-1479, has filed a Form C-108 (Application for Authorization to Inject) with the Oil Conservation Division ("Division") seeking administrative approval to utilize its proposed Baker SWD No. 1 (API No. N/A) to be drilled 330 feet from the South line and 309 feet from the West line (Unit M) of Section 1, Township 26 South, Range 31 East, NMPM, Eddy County, New Mexico and complete the well as a produced water disposal well in the Siluro-Devonian formation. Injection is to occur through the open-hole interval from approximately 17,300 feet to 18,500 feet.

Produced water from the Bone Spring, Wolfcamp and other formations originating from wells in this area will be injected into the Baker SWD No. 1 at average and maximum rates of 30,000 and 40,000 barrels of water per day, respectively. The initial surface injection pressure for the well is anticipated to be at or below 3,460 psi., which is in compliance with Division regulations. The maximum surface injection pressure will be determined by step rate injection test.

Interested parties must file objections with the New Mexico Oil Conservation Division, 1220 S. St Francis Drive, Santa Fe, New Mexico 87505, within 15 days of the date of this publication.

Additional information can be obtained by contacting Ms. Melanie Wilson-Regulatory Analyst-Mesquite SWD, Inc. at (575) 914-1461.