



San Juan Business Unit
PO Box 4289
Farmington NM 87499-4289
(505) 326-9700

Burlington Resources Oil & Gas Co LP
"a wholly owned subsidiary"

February 22, 2007

Bureau of Land Management
Farmington Resource Area
1235 La Plata Highway
Farmington, NM 87401

Commissioner of Public Lands
State of New Mexico
P. O. Box 1148
Santa Fe, NM 87501-1148

RECEIVED

Oil Conservation Division
State of New Mexico
1220 S. Saint Francis Drive
Santa Fe, NM 87505

FEB 26 2007

RE: **2007 Plan of Development**
SAN JUAN 28-4 UNIT 14-08-001-933
RIO ARRIBA COUNTY, NEW MEXICO

Oil Conservation Division
1220 S. St. Francis Drive
Santa Fe, NM 87505

Ladies and Gentlemen:

The following Participating Areas currently exist in the SAN JUAN 28-4 UNIT:

FORMATION	EXPANSION	EFFECTIVE DATE
DAKOTA	007	01-Dec-73
MESAVERDE	012	01-Nov-61
PICTURED CLIFFS	001	01-Dec-55

The 2006 Plan of Development (or amendments thereto) provided for the following activity:

WELL NAME	FORMATION	TYPE	DEDICATION	STATUS
SAN JUAN 28-4 UNIT 14A	MESAVERDE	NewDrill - Single	N2 29-028N-004W	COMPLETED
SAN JUAN 28-4 UNIT 16R	MESAVERDE	NewDrill - Commingle	N2 30-028N-004W	COMPLETED
SAN JUAN 28-4 UNIT 16R	DAKOTA	NewDrill - Commingle	E2 30-028N-004W	COMPLETED
		NewDrill - Single		COMPLETED
SAN JUAN 28-4 UNIT 28A	MESAVERDE	(subsequently changed to MV/DK Commingle)	N2 19-028N-004W	
SAN JUAN 28-4 UNIT 28A	DAKOTA	NewDrill - Commingle	N2 19-028N-004W	COMPLETED
SAN JUAN 28-4 UNIT 30E	DAKOTA	NewDrill - Commingle	E2 31-028N-004W	COMPLETED
SAN JUAN 28-4 UNIT 33E	DAKOTA	NewDrill - Commingle	W2 33-028N-004W	COMPLETED
SAN JUAN 28-4 UNIT 33E	MESAVERDE	NewDrill - Commingle	N2 33-028N-004W	COMPLETED
SAN JUAN 28-4 UNIT 34M	MESAVERDE	NewDrill - Commingle	N2 30-028N-004W	COMPLETED
SAN JUAN 28-4 UNIT 34M	DAKOTA	NewDrill - Commingle	W2 30-028N-004W	COMPLETED
SAN JUAN 28-4 UNIT 33	MESAVERDE	Recompletion - Commingle	S2 33-028N-004W	CANCELLED

SAN JUAN 28-4 UNIT
2007 PLAN OF DEVELOPMENT

Pursuant to Section 10 of the SAN JUAN 28-4 UNIT Agreement, Burlington Resources Oil & Gas Company LP, as Unit Operator, hereby submits the 2007 Plan of Development as follows:

WELL NAME	FORMATION	TYPE	DEDICATION
SAN JUAN 28-4 UNIT 14B	MESAVERDE	NewDrill - Single	N2 29-028N-004W
SAN JUAN 28-4 UNIT 16C	MESAVERDE	NewDrill - Single	N2 30-028N-004W
SAN JUAN 28-4 UNIT 17B	MESAVERDE	NewDrill - Single	N2 20-028N-004W
SAN JUAN 28-4 UNIT 20B	MESAVERDE	NewDrill - Commingle	S2 30-028N-004W
SAN JUAN 28-4 UNIT 20B	DAKOTA	NewDrill - Commingle	E2 30-028N-004W
SAN JUAN 28-4 UNIT 20C	MESAVERDE	NewDrill - Commingle	S2 30-028N-004W
SAN JUAN 28-4 UNIT 20C	DAKOTA	NewDrill - Commingle	E2 30-028N-004W
SAN JUAN 28-4 UNIT 20M	MESAVERDE	NewDrill - Commingle	S2 30-028N-004W
SAN JUAN 28-4 UNIT 20M	DAKOTA	NewDrill - Commingle	E2 30-028N-004W
SAN JUAN 28-4 UNIT 27M	MESAVERDE	NewDrill - Commingle	S2 19-028N-004W
SAN JUAN 28-4 UNIT 27M	DAKOTA	NewDrill - Commingle	S2 19-028N-004W
SAN JUAN 28-4 UNIT 29M	MESAVERDE	NewDrill - Commingle	S2 31-028N-004W
SAN JUAN 28-4 UNIT 29M	DAKOTA	NewDrill - Commingle	S2 31-028N-004W
SAN JUAN 28-4 UNIT 36M	MESAVERDE	NewDrill - Commingle	S2 29-028N-004W
SAN JUAN 28-4 UNIT 36M	DAKOTA	NewDrill - Commingle	E2 29-028N-004W
SAN JUAN 28-4 UNIT 36N	MESAVERDE	NewDrill - Commingle	S2 29-028N-004W
SAN JUAN 28-4 UNIT 36N	DAKOTA	NewDrill - Commingle	E2 29-028N-004W

The working interest owners are being furnished a copy of this letter, well status listing and enclosed map. Burlington, as Unit Operator, will drill any offset wells required to prevent drainage of unitized substances and any other wells deemed necessary by the working interest owners or Unit Operator.

In accordance to Section 10 of the Unit Agreement, please provide your approval by executing and returning a copy of the attached approval page to the undersigned.

Please contact me at (505) 326-9760 if there are any questions regarding this letter.

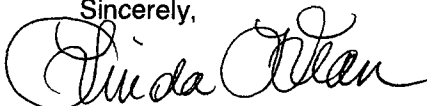
Sincerely,

 Linda Dean

SAN JUAN 28-4 UNIT
2007 PLAN OF DEVELOPMENT APPROVALS

Bureau of Land Management

Date

New Mexico Oil Conservation Division

Date

WORKING INTEREST OWNERS SAN JUAN 28-4 UNIT

XTO ENERGY INC

WILLIAMS PRODUCTION COMPANY

ANADARKO E & P COMPANY LP

CONOCOPHILLIPS COMPANY

ROBERT CRITCHFIELD

San Juan 28-4 Unit Wells Status as of 2/22/2007

Well Name	Rsv Name	Sec Num	Twnship	Twnship Dir	Ring	Ring Dir	Facility ID	Prod Stat	API Well Code	MMS Prod Interval	MMS Leq Agr Number	Lease Date	Lease ID	Oper ID	Compl D	Int Prod D	1st Sale D
SAN JUAN 28-4 #11 MV	BLANCO::MESAVENDE	31	28	N	4	W	2177959	11	300390725600501	S01	8910009330	7459	A72814	216600	5/15/1957	8/29/1957	8/29/1957
SAN JUAN 28-4 #12 MV	BLANCO::MESAVENDE	33	28	N	4	W	2178021	11	300390724500501	S01	8910009330	7459	A72814	216600	7/7/1957	8/1/1957	8/1/1957
SAN JUAN 28-4 #13 MV	BLANCO::MESAVENDE	29	28	N	4	W	2177572	11	300390735700501	S01	8910009330	7459	A74705	216600	11/7/1957	5/19/1958	5/19/1958
SAN JUAN 28-4 #14A MV	BLANCO::MESAVENDE	20	28	N	4	W	2182127	41	300392765700501	S01	8910009330	7459	A74798	216600	9/26/2006		
SAN JUAN 28-4 #16R DK	BASIN::DAKOTA	30	28	N	4	W	2182135	11	300392782000001	C01	NNMM033662	7459	A730410	216600	10/19/2006	11/2/2006	11/2/2006
SAN JUAN 28-4 #16R MV	BLANCO::MESAVENDE	30	28	N	4	W	2182135	11	300392782000002	C02	8910009330	7459	A72814	216600	8/29/1958	10/22/1958	10/22/1958
SAN JUAN 28-4 #18 MV	BLANCO::MESAVENDE	31	28	N	4	W	2182135	11	300390722500501	S01	8910009330	7459	A72814	216600	10/16/2000	11/2/2000	11/2/2000
SAN JUAN 28-4 #1A MV	BLANCO::MESAVENDE	18	28	N	4	W	2180679	11	300392645500501	S01	8910009330	7459	A74703	216600	10/29/1954	10/29/1954	10/29/1954
SAN JUAN 28-4 #1 MV	BLANCO::MESAVENDE	18	28	N	4	W	2179365	11	300390744301 S01	S01	NNMM033662	7459	A74703	216600	10/29/1954	11/22/1994	11/22/1994
SAN JUAN 28-4 #201 FR	BASIN CB::FRUITLAND COAL	18	28	N	4	W	2179908	11	300392543100001	C02	NNMM033662	7459	A720961	216600	9/2/1994	11/22/1994	11/22/1994
SAN JUAN 28-4 #201 PC	GOBERNADOR::PICTURED CLIF	18	28	N	4	W	2179908	11	3003907281000501	S01	8910009330	7459	A74706	216600	10/21/1959	4/21/1960	4/21/1960
SAN JUAN 28-4 #20 MV	BLANCO::MESAVENDE	30	28	N	4	W	2178023	11	300390746200501	S01	8910009330	7459	A74707	216600	11/24/1959	5/3/1960	5/3/1960
SAN JUAN 28-4 #21 MV	BLANCO::MESAVENDE	7	28	N	4	W	2177029	11	300392765600002	S01	8910009330	7459	A72814	216600	10/30/2002	11/8/2002	11/8/2002
SAN JUAN 28-4 #26A MV	BLANCO::MESAVENDE	18	28	N	4	W	2181865	11	3003926785000501	S01	8910009330	7459	A74708	216600	8/2/2005	8/2/2005	8/2/2005
SAN JUAN 28-4 #26 MV	BLANCO::MESAVENDE	18	28	N	4	W	2177751	11	300392742000501	S01	8910009330	7459	A74708	216600	8/20/1960	11/8/1960	11/8/1960
SAN JUAN 28-4 #27A DK	BASIN::DAKOTA	19	28	N	4	W	2181322	11	300392678500002	C02	8910009330	7459	A72814	216600	10/30/2002	11/8/2002	11/8/2002
SAN JUAN 28-4 #27A MV	BLANCO::MESAVENDE	19	28	N	4	W	2177892	11	3003907388000501	S01	8910009330	7459	A74709	216600	9/23/1961	5/4/1962	5/4/1962
SAN JUAN 28-4 #28A DK	BLANCO::MESAVENDE	19	28	N	4	W	2182148	11	300392762600002	C02	8910009330	7459	A74727	216600	10/19/2006	10/19/2006	10/19/2006
SAN JUAN 28-4 #28A MV	BLANCO::MESAVENDE	19	28	N	4	W	2181322	11	300392762600001	S01	8910009330	7459	A74710	216600	10/8/1962	7/1/1963	7/1/1963
SAN JUAN 28-4 #28 MV	BLANCO::MESAVENDE	19	28	N	4	W	2178042	11	300392007000501	S01	8910009338	7459	A72813	216600	10/10/1967	2/1/1968	2/1/1968
SAN JUAN 28-4 #29 DK	BASIN::DAKOTA	31	28	N	4	W	2177423	11	300390741901501	S01	8910009330	7459	A74704	216600	8/31/1953	10/29/1954	10/29/1954
SAN JUAN 28-4 #2 MV	BLANCO::MESAVENDE	17	28	N	4	W	2177641	11	3003926078000501	S01	8910009338	7459	A72813	216600	11/29/1967	5/11/1968	5/11/1968
SAN JUAN 28-4 #30 DK	BASIN::DAKOTA	31	28	N	4	W	2182128	11	300392433000501	S01	8910009338	7459	A72813	216600	10/29/2006	10/20/2006	10/20/2006
SAN JUAN 28-4 #30 MV	BLANCO::MESAVENDE	31	28	N	4	W	2182128	11	300392594500002	C01	8910009338	7459	A72813	216600	10/29/1998	3/31/1999	3/31/1999
SAN JUAN 28-4 #30M DK	BLANCO::MESAVENDE	31	28	N	4	W	2180408	11	300392945000002	C02	8910009330	7459	A72814	216600	10/29/1998	9/15/1968	9/15/1968
SAN JUAN 28-4 #30M MV	BLANCO::MESAVENDE	31	28	N	4	W	2180408	11	300392945000001	S01	8910009338	7459	A72813	216600	10/29/1998	9/15/1968	9/15/1968
SAN JUAN 28-4 #31 DK	BASIN::DAKOTA	32	28	N	4	W	2177642	11	300392992100001	S01	8910009338	7459	A72813	216600	9/25/1998	10/21/1998	10/21/1998
SAN JUAN 28-4 #31M DK	BLANCO::MESAVENDE	32	28	N	4	W	2180396	11	300392992100002	C02	8910009338	7459	A72813	216600	9/25/1998	10/21/1998	10/21/1998
SAN JUAN 28-4 #31M MV	BLANCO::MESAVENDE	32	28	N	4	W	2180396	11	300392992100001	S01	8910009338	7459	A72813	216600	9/25/1998	10/21/1998	10/21/1998
SAN JUAN 28-4 #32 DK	BASIN::DAKOTA	32	28	N	4	W	2178052	11	300392610000002	S01	8910009338	7459	A72813	216600	5/19/1969	6/25/1969	6/25/1969
SAN JUAN 28-4 #32M DK	BLANCO::MESAVENDE	32	28	N	4	W	2180469	11	300392609000001	S01	8910009338	7459	A72813	216600	7/13/1999	7/29/1999	7/29/1999
SAN JUAN 28-4 #32M MV	BLANCO::MESAVENDE	32	28	N	4	W	2180469	11	300392609000002	C02	8910009330	7459	A72814	216600	7/13/1999	7/29/1999	7/29/1999
SAN JUAN 28-4 #32N DK	BASIN::DAKOTA	32	28	N	4	W	2180469	11	300392659600002	C02	8910009338	7459	A72814	216600	9/15/2004	9/27/2004	9/27/2004
SAN JUAN 28-4 #32N MV	BLANCO::MESAVENDE	32	28	N	4	W	2180469	11	300392659600001	S01	8910009338	7459	A72814	216600	12/30/1968	4/9/1969	4/9/1969
SAN JUAN 28-4 #33 DK	BASIN::DAKOTA	33	28	N	4	W	2181701	11	300392615000501	C02	8910009338	7459	A72813	216600	9/14/2006	10/20/2006	10/20/2006
SAN JUAN 28-4 #33E DK	BLANCO::MESAVENDE	33	28	N	4	W	2181701	11	300392615000002	C02	8910009338	7459	A72813	216600	9/14/2006	10/20/2006	10/20/2006
SAN JUAN 28-4 #33E MV	BLANCO::MESAVENDE	33	28	N	4	W	2181701	11	300392615000001	S01	8910009338	7459	A72813	216600	9/14/2006	10/20/2006	10/20/2006
SAN JUAN 28-4 #34 DK	BASIN::DAKOTA	30	28	N	4	W	2177644	11	3003928469000501	S01	8910009338	7459	A74723	216600	5/31/1972	6/22/1972	6/22/1972
SAN JUAN 28-4 #34M DK	BLANCO::MESAVENDE	30	28	N	4	W	2182133	11	300392846900002	C02	NNMSFO79731A	7459	A746866	216600	9/22/2006		
SAN JUAN 28-4 #34M MV	BLANCO::MESAVENDE	30	28	N	4	W	2182133	11	300392846900001	S01	8910009330	7459	A72813	216600	9/14/2006	10/20/2006	10/20/2006
SAN JUAN 28-4 #34N DK	BASIN::DAKOTA	30	28	N	4	W	2182144	41	300392761000002	C02	8910009330	7459	A74769	216600	9/22/2006		
SAN JUAN 28-4 #34N MV	BLANCO::MESAVENDE	30	28	N	4	W	2182144	41	300392761000001	S01	8910009330	7459	A72813	216600	7/10/2001	7/20/2001	7/20/2001
SAN JUAN 28-4 #35B DK	BLANCO::MESAVENDE	33	28	N	4	W	2180800	11	300392647300501	S01	8910009330	7459	A72813	216600	6/13/1999	6/29/1999	6/29/1999
SAN JUAN 28-4 #35B MV	BLANCO::MESAVENDE	33	28	N	4	W	2180800	11	300392647300501	S01	8910009330	7459	A72813	216600	6/13/1999	6/29/1999	6/29/1999
SAN JUAN 28-4 #35M DK	BASIN::DAKOTA	33	28	N	4	W	2180474	11	300392594900002	C02	8910009330	7459	A72814	216600	6/13/1999	6/29/1999	6/29/1999
SAN JUAN 28-4 #35M MV	BLANCO::MESAVENDE	33	28	N	4	W	2180474	11	300392594900001	S01	8910009330	7459	A72814	216600	6/13/1999	6/29/1999	6/29/1999
SAN JUAN 28-4 #35N DK	BLANCO::MESAVENDE	33	28	N	4	W	2180474	11	300392594900002	C02	8910009330	7459	A72814	216600	6/13/1999	6/29/1999	6/29/1999
SAN JUAN 28-4 #35N MV	BLANCO::MESAVENDE	33	28	N	4	W	2180474	11	300392594900001	S01	8910009330	7459	A72814	216600	6/13/1999	6/29/1999	6/29/1999
SAN JUAN 28-4 #36 DK	BASIN::DAKOTA	29	28	N	4	W	2178063	11	3003928067400001	C01	8910009338	7459	A74722	216600	11/21/1973	11/10/1998	11/10/1998
SAN JUAN 28-4 #36 MV	BLANCO::MESAVENDE	29	28	N	4	W	2178063	11	3003928067400002	C02	8910009330	7459	A74722	216600	11/21/1973	11/10/1998	11/10/1998
SAN JUAN 28-4 #36 MV	BLANCO::MESAVENDE	29	28	N	4	W	2178063	11	3003928067400001	S01	8910009330	7459	A74722	216600	11/21/1973	11/10/1998	11/10/1998
SAN JUAN 28-4 #37 DK	BASIN::DAKOTA	29	28	N	4	W	2178068	11	30039267300501	S01	8910009338	7459	A74724	216600	12/10/1957	12/31/1957	12/31/1957
SAN JUAN 28-4 #37 MV	BLANCO::MESAVENDE	29	28	N	4	W	2178068	11	30039267300501	S01	8910009330	7459	A72814	216600	12/10/1957	12/31/1957	12/31/1957
SAN JUAN 28-4 #5B MV	BLANCO::MESAVENDE	32	28	N	4	W	2180641	11	3003926289000501	S01	8910009330	7459	A72814	216600	9/16/1954	9/11/1957	9/11/1957
SAN JUAN 28-4 #5C MV	BLANCO::MESAVENDE	32	28	N	4	W	2180641	11	300392628900001	S01	8910009330	7459	A72814	216600	9/16/1954	9/11/1957	9/11/1957
SAN JUAN 28-4 #5 MV	BLANCO::MESAVENDE	32	28	N	4	W	2177955										

San Juan 28-4 Unit Wells Status as of 2/22/2007

Well Name	Raw Name	Sec Num	Township	Township Dir	Ring	Ring Dir	Facility ID	Prod Stat	API Well Code	MMS Prod Interval	MMS Lease Number	State Lease Code	Lease ID	Oper ID	Compl Dt	Int Prod Dt	1st Sale Dt
SAN JUAN 28-4 UNIT 17R PC CHOZA MESA:PICTURED CLIF								71	300392538100C01				A720980	216900	9/27/1994	1/25/1995	1/25/1995

Prod Stat : 11 Flowing Well
21 Pumping Well

61 Temp Abandoned
71 Perm Abandoned Well

R4W

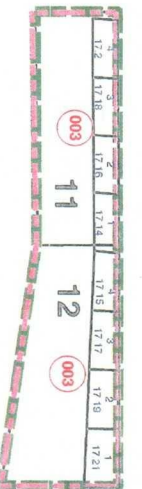

San Juan 28-4 Unit



T 28
N

Well Formation

- FRUITLAND COAL
- PICTURED CLIFFS
- MESAVERDE
- DAKOTA

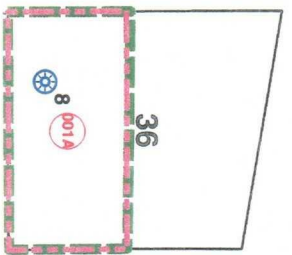

BURLINGTON
RESOURCES
 Inventory Management
 San Juan Business Unit
 Farmington, New Mexico
 2107