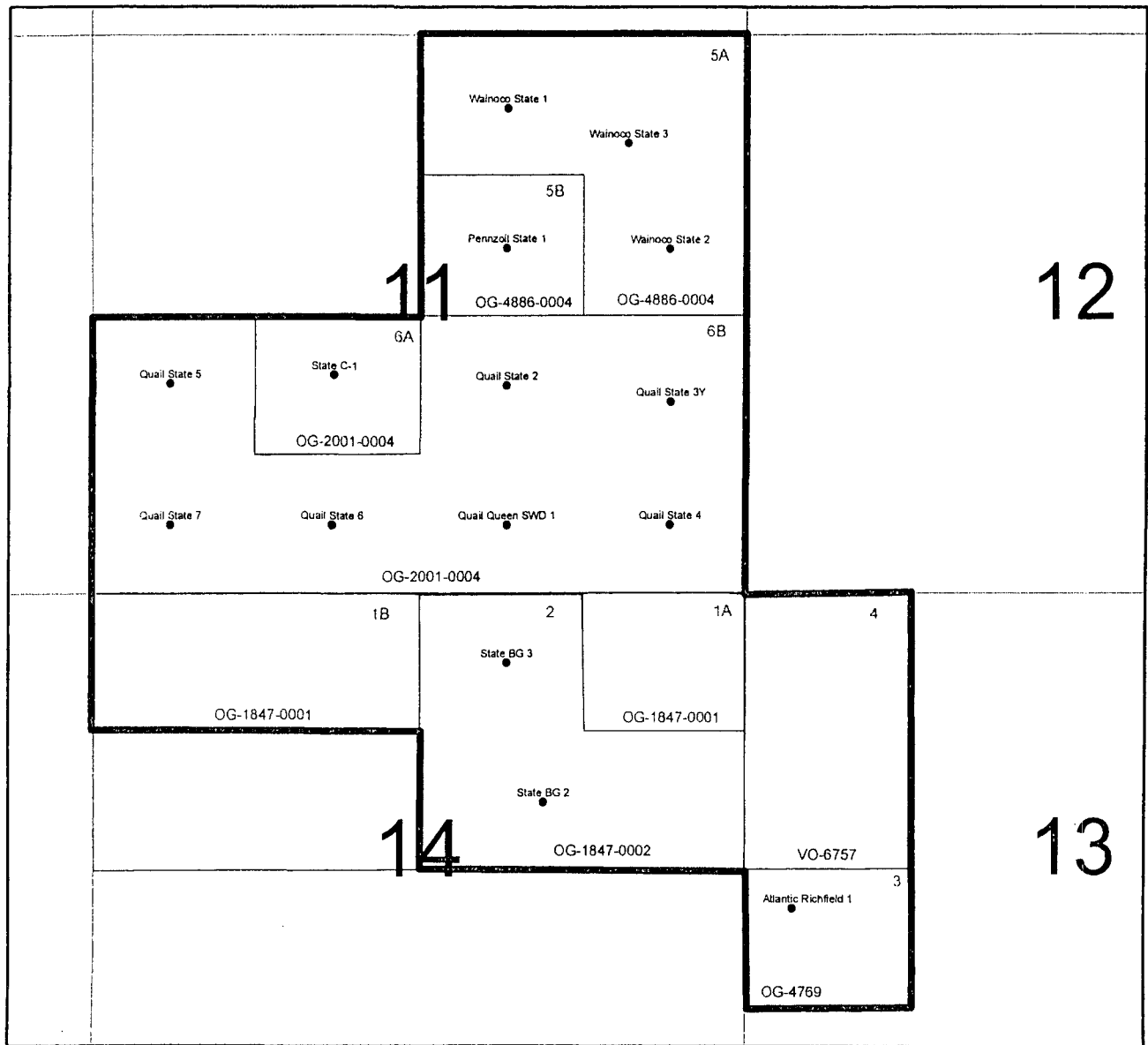

EXHIBIT "A"



TOWNSHIP 19 SOUTH, RANGE 34 EAST
LEA COUNTY, NEW MEXICO

PROPOSED QUAIL QUEEN UNIT CHESAPEAKE EXPLORATION, L.L.C.,



Proposed Waterflood Unit Boundary



Queen Wells



Federal Acreage = 0 acres



State Acreage = 840 acres



Fee Acreage = 0 acres

Total Acreage = 840 acres

BEFORE THE OIL CONSERVATION DIVISION

Santa Fe, New Mexico

Case No. 14001 & 14002

(Consolidated)...Exhibit No. 1

Submitted by:

CHESAPEAKE OPERATING, INC.

Hearing Date: November 1, 2007