

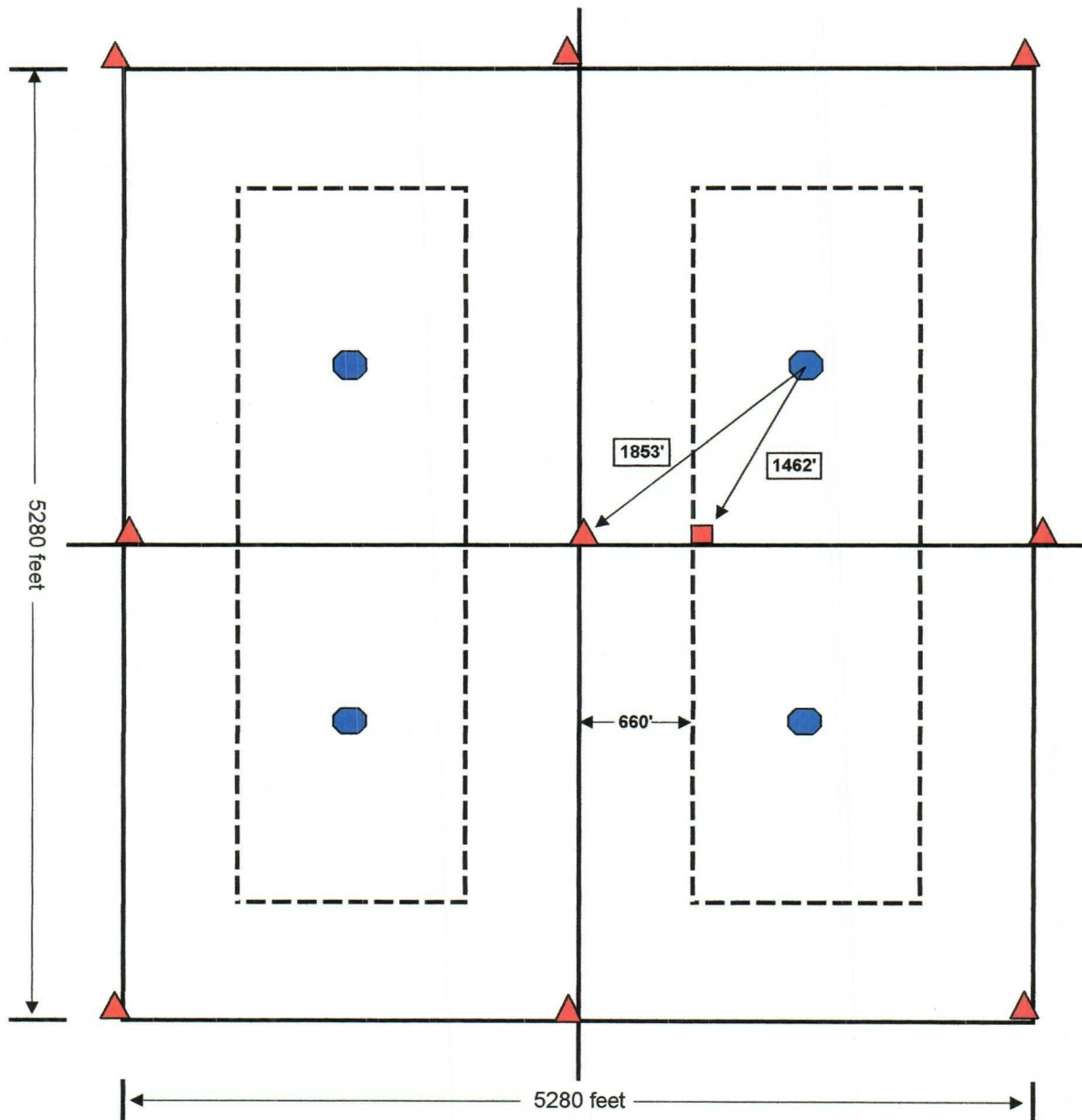



Rincon Unit
 Rio Arriba County, New Mexico
 Application for Blanket Exception to Well Location
 Blanco-Mesaverde Gas Pool
 Case No. 13112
 Exhibit 11



-  Existing Producer
-  Infill Well Location Based on Current Mesaverde Setback Rules
-  Desired Infill Location to Optimize Spacing

BEFORE THE OIL CONSERVATION DIVISION
 Santa Fe, New Mexico
 Case No. 13112 Exhibit No. 11
 Submitted by:
PURE RESOURCES, L.P.
 Hearing Date: September 18, 2003