

T 11 N - R 26 E

Exxon strat test well will be water supply well

1, 3, 4 & 6 will be prod wells & 5 will be 5 1/2 am inj well

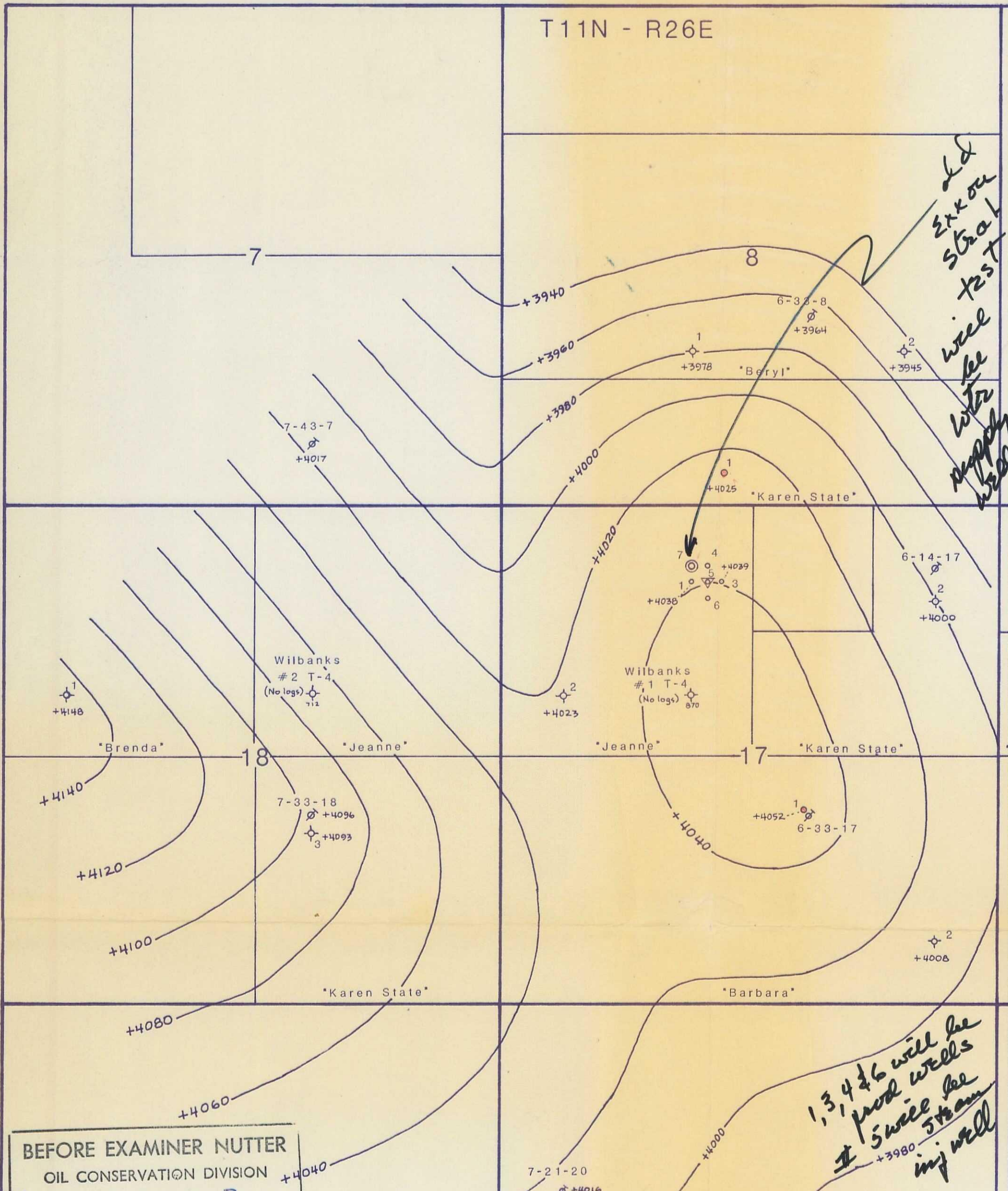

BEFORE EXAMINER NUTTER
 OIL CONSERVATION DIVISION
Corona EXHIBIT NO. 3
 CASE NO. 7354

Structural Map, Contoured on top of the O'Connell Sand of the Santa Rosa Fm. C.I. : 20'

Corona Oil Co.
 T-4 Ranch Steam Flood Prospect
 Guadalupe Co., N.M.
 Scale 1" = 1000'
 George L. Scott Sept., 1981

Explanation

- ⊕ Dry holes.
- Wells outside Pilot Steam Flood with production casing run through pay sand.
- Steam Flood producing wells.
- ▽ Steam Injection well.
- ⊙ Water Supply well.
- ⊕ Exxon (Humble) stratigraphic test wells.