



ConocoPhillips
San Juan Business Unit
P.O. Box 4289
Farmington, NM 87499-4289

February 22, 2010

Burlington Resources Oil & Gas Co LP
"An affiliate of ConocoPhillips Company"

Bureau of Land Management
Farmington Resource Area
1235 La Plata Highway
Farmington, NM 87401

Commissioner of Public Lands
State of New Mexico
P. O. Box 1148
Santa Fe, NM 87501-1148

Oil Conservation Division
State of New Mexico
1220 S. Saint Francis Drive
Santa Fe, NM 87505

**RE: 2010 Plan of Development
SAN JUAN 32-9 UNIT 14-08-001-569
SAN JUAN COUNTY, NEW MEXICO**

Ladies and Gentlemen:

The following Participating Areas currently exist in the SAN JUAN 32-9 UNIT:

FORMATION	EXPANSION	EFFECTIVE DATE
NACIMIENTO	000	04-AUG-75
FRUITLAND COAL	019	01-OCT-05
PICTURED CLIFFS	012	01-DEC-97
MESAVERDE	032	01-AUG-60

The 2009 Plan of Development (or amendments thereto) provided for the following activity:

WELL NAME	FORMATION	TYPE	DEDICATION	STATUS
SAN JUAN 32-9 UNIT 124*	PICTURED CLIFFS	New Drill - Single	NSP 10-032N-009W	CARRYOVER
SAN JUAN 32-9 UNIT 123	FRUITLAND COAL/ PICTURED CLIFFS	New Drill - Commingle	FTC W2 14-032N-009W PC NW4 14-032N-009W	CARRYOVER
* Dedication corrected.				

Pursuant to Section 10 of the SAN JUAN 32-9 UNIT Agreement, Burlington Resources Oil & Gas Company LP, as Unit Operator, hereby submits the 2010 Plan of Development as follows:

WELL NAME	FORMATION	TYPE	DEDICATION
SAN JUAN 32-9 UNIT 124	PICTURED CLIFFS	New Drill - Single	NSP 10-032N-009W
SAN JUAN 32-9 UNIT 123	FRUITLAND COAL/ PICTURED CLIFFS	New Drill - Commingle	FTC W2 14-032N-009W PC NW4 14-032N-009W

The working interest owners are being furnished a copy of this letter, well status listing and enclosed map. Burlington, as Unit Operator, will drill any offset wells required to prevent drainage of unitized substances and any other wells deemed necessary by the working interest owners or Unit Operator.

SAN JUAN 32-9 UNIT
2009 PLAN OF DEVELOPMENT

In accordance to Section 10 of the Unit Agreement, please provide your approvals by executing and returning a copy of the attached approval page to the undersigned.

Please contact me at (505) 326-9749 if there are any questions regarding this letter.

Sincerely,



Ben Malone
Land Supervisor, SJBUS E

BMW/vw
xc: San Juan 32-9 Unit, 3.0 (2010)
San Juan 32-9 Unit Working Interest Owners

**SAN JUAN 32-9 UNIT
2009 PLAN OF DEVELOPMENT APPROVALS**

Bureau of Land Management

Date

New Mexico Oil Conservation Division

Date

New Mexico Commissioner of Public Lands

Date

**WORKING INTEREST OWNERS
SAN JUAN 32-9 UNIT**

BP AMERICA PRODUCTION COMPANY

BURLINGTON RESOURCES OIL & GAS COMPANY LP

CONOCOPHILLIPS COMPANY

DEVON ENERGY PRODUCTION CO LP

ENERGEN RESOURCES CORP

FOUR STAR OIL & GAS COMPANY

J&M RAYMOND LTD

JOHN S BROWN JR.

PHILLIPS - SAN JUAN LTD PARTNERSHIP

PRODUCTION GATHERING CO LP

ROBERT UMBACH CANCER FOUNDATION

T H MCELVAIN OIL & GAS LTD

XTO ENERGY INC.

WILLIAMS PRODUCTION COMPANY

San Juan 32-9 Unit Wells Status as of 2-8-09

Well Name	Resv. Name	Sec	Twn	Dir	Rng	ST	Prod Stat	API Well Code	MMS Prod	MMS Lease Agr	Use ID	Oper ID	Compl Dt	Int Prod Dt	1st Sale Dt
SAN JUAN 32-9 UT 100 FC	BLANCO:PICTURED CLIFFS	12	31	N	10	W	NM	300452327500S01	S01	891000569A	A728867	216600	7/23/1979	9/1/1979	9/1/1979
SAN JUAN 32-9 UT 101 FC	BLANCO:PICTURED CLIFFS	8	31	N	9	W	NM	300452749200S01	S01	891000569A	A728866	216600	11/6/1989	3/1/1990	3/1/1990
SAN JUAN 32-9 UT 102 FC	BLANCO:PICTURED CLIFFS	17	31	N	9	W	NM	300452748800S01	S01	891000569A	A728868	216600	11/6/1989	3/1/1990	3/1/1990
SAN JUAN 32-9 UT 103 FC	BLANCO:PICTURED CLIFFS	18	31	N	9	W	NM	300452747400S01	S01	891000569A	A728868	216600	12/11/1989	5/23/1990	5/23/1990
SAN JUAN 32-9 UT 104 FC	BASIN CB:FRUITLAND COAL	24	32	N	10	W	NM	300452751700S01	S01	891000569C	A728870	216600	11/28/1989	11/30/1989	11/30/1989
SAN JUAN 32-9 UT 104S FC	BASIN CB:FRUITLAND COAL	24	32	N	10	W	NM	300453325300S01	S01	891000569C	A728870	216600	10/19/2006	11/2/2006	11/2/2006
SAN JUAN 32-9 UT 105 FC	BASIN CB:FRUITLAND COAL	8	31	N	9	W	NM	300452751800S01	S01	891000569C	A728870	216600	12/15/1989	12/15/1989	12/15/1989
SAN JUAN 32-9 UT 106 FC	BLANCO:PICTURED CLIFFS	17	31	N	9	W	NM	300452809000S01	S01	891000569A	A728868	216600	12/30/1991	3/24/1993	3/24/1993
SAN JUAN 32-9 UT 107 FC	BLANCO:PICTURED CLIFFS	9	31	N	9	W	NM	300452809600S01	S01	891000569A	A728868	216600	3/13/1992	3/24/1993	3/24/1993
SAN JUAN 32-9 UT 111 FC	BLANCO:PICTURED CLIFFS	8	31	N	9	W	NM	300452867200S01	S01	891000569A	A728868	216600	9/27/1992	8/1/1993	8/1/1993
SAN JUAN 32-9 UT 112 FC	BLANCO:PICTURED CLIFFS	9	31	N	9	W	NM	300452867300S01	S01	891000569A	A728868	216600	10/28/1992	8/1/1993	8/1/1993
SAN JUAN 32-9 UT 114 MV	BLANCO:PICTURED CLIFFS	17	31	N	9	W	NM	300452868800S02	S02	891000569A	A728867	216600	9/12/2000	9/21/2000	9/21/2000
SAN JUAN 32-9 UT 115 FC	BLANCO:PICTURED CLIFFS	1	31	N	10	W	NM	300452915200S01	S01	891000569A	A728868	216600	7/11/1994	10/4/1994	10/4/1994
SAN JUAN 32-9 UT 123 FC	BASIN CB:FRUITLAND COAL	15	32	N	9	W	NM	WO/API							
SAN JUAN 32-9 UT 123 FC	BASIN:PICTURED CLIFFS	15	32	N	9	W	NM	WO/API							
SAN JUAN 32-9 UT 124 MV	BLANCO:PICTURED CLIFFS	10	31	N	9	W	NM	300452406700S01	S01	891000569A	A728867	216600	1/28/1981	4/1/1981	4/1/1981
SAN JUAN 32-9 UT 124 MV	BLANCO:PICTURED CLIFFS	10	31	N	9	W	NM	300451086600S01	S01	891000569A	A728867	216600	10/1/1953	11/1/1953	11/1/1953
SAN JUAN 32-9 UT 134 MV	BLANCO:PICTURED CLIFFS	14	31	N	10	W	NM	300452291200S01	S01	891000569A	A728867	216600	5/16/1979	7/1/1979	7/1/1979
SAN JUAN 32-9 UT 13 MV	BLANCO:PICTURED CLIFFS	14	31	N	10	W	NM	300451076100C01	C01	891000569A	A728867	216600	3/29/1953	5/19/1953	5/19/1953
SAN JUAN 32-9 UT 13 FC	BLANCO:PICTURED CLIFFS	14	31	N	10	W	NM	300451076100C02	C02	891000569A	A728868	216600	11/17/1996	11/17/1996	11/17/1996
SAN JUAN 32-9 UT 14B MV	BLANCO:PICTURED CLIFFS	9	31	N	9	W	NM	300452425100S01	S01	891000569A	A728867	216600	3/20/1981	4/1/1981	4/1/1981
SAN JUAN 32-9 UT 14C MV	BLANCO:PICTURED CLIFFS	9	31	N	9	W	NM	300453011200S01	S01	891000569A	A728867	216600	8/28/2000	9/17/2000	9/17/2000
SAN JUAN 32-9 UT 14 MV	BLANCO:PICTURED CLIFFS	9	31	N	9	W	NM	300453011200S01	S01	891000569A	A728867	216600	10/26/1953	11/1/1953	11/1/1953
SAN JUAN 32-9 UT 15A MV	BLANCO:PICTURED CLIFFS	9	31	N	9	W	NM	300452927900S01	S01	891000569A	A728867	216600	11/28/1995	2/2/1996	2/2/1996
SAN JUAN 32-9 UT 15B DK	BASIN:DKOTA	9	31	N	9	W	NM	WO/API							
SAN JUAN 32-9 UT 15B MV	BLANCO:PICTURED CLIFFS	9	31	N	9	W	NM	WO/API							
SAN JUAN 32-9 UT 15 MV	BLANCO:PICTURED CLIFFS	9	31	N	9	W	NM	300451088400S01	S01	891000569A	A728867	216600	12/4/1953	2/1/1954	2/1/1954
SAN JUAN 32-9 UT 16A MV	BLANCO:PICTURED CLIFFS	8	31	N	9	W	NM	300452931400S01	S01	891000569A	A728867	216600	1/10/1980	4/1/1980	4/1/1980
SAN JUAN 32-9 UT 16 MV	BLANCO:PICTURED CLIFFS	8	31	N	9	W	NM	300456025300S01	S01	891000569A	A728867	216600	4/1/1954	4/1/1954	4/1/1954
SAN JUAN 32-9 UT 17A MV	BLANCO:PICTURED CLIFFS	8	31	N	9	W	NM	300452293300S01	S01	891000569A	A728867	216600	1/1/1979	1/1/1979	1/1/1979
SAN JUAN 32-9 UT 17 MV	BLANCO:PICTURED CLIFFS	8	31	N	9	W	NM	300451088900S01	S01	891000569A	A728867	216600	3/17/1954	4/1/1954	4/1/1954
SAN JUAN 32-9 UT 17R MV	BLANCO:PICTURED CLIFFS	8	31	N	9	W	NM	300452940400C01	C01	891000569A	A728867	216600	12/13/1996	1/13/1997	1/13/1997
SAN JUAN 32-9 UT 17R PC	BLANCO:PICTURED CLIFFS	8	31	N	9	W	NM	300452940400C02	C02	891000569A	A728868	216600	12/13/1996	1/13/1997	1/13/1997
SAN JUAN 32-9 UT 18A MV	BLANCO:PICTURED CLIFFS	17	31	N	9	W	NM	300452331300S01	S01	891000569A	A728867	216600	2/12/1980	4/1/1980	4/1/1980
SAN JUAN 32-9 UT 18R MV	BLANCO:PICTURED CLIFFS	17	31	N	9	W	NM	300452894200S01	S01	891000569A	A728867	216600	7/14/1993	10/28/1993	10/1/1993
SAN JUAN 32-9 UT 19A MV	BLANCO:PICTURED CLIFFS	17	31	N	9	W	NM	300452299300S01	S01	891000569A	A728867	216600	8/1/1978	5/1/1978	5/1/1978
SAN JUAN 32-9 UT 19 MV	BLANCO:PICTURED CLIFFS	17	31	N	9	W	NM	300451076000S01	S01	891000569A	A728867	216600	4/7/1954	7/1/1954	7/1/1954
SAN JUAN 32-9 UT 14 MV	BLANCO:PICTURED CLIFFS	18	31	N	9	W	NM	300452289600S01	S01	891000569A	A728867	216600	8/1/1978	10/1/1978	10/1/1978
SAN JUAN 32-9 UT 14 MV	BLANCO:PICTURED CLIFFS	18	31	N	9	W	NM	300451321800S01	S01	891000569A	A728867	216600	8/8/1952	8/10/1952	8/10/1952
SAN JUAN 32-9 UT 201 FC	BASIN CB:FRUITLAND COAL	2	31	N	9	W	NM	300452759300S01	S01	891000569C	A728870	216600	4/1/1990	3/9/1992	3/9/1992
SAN JUAN 32-9 UT 201 FC	BASIN CB:FRUITLAND COAL	2	31	N	9	W	NM	300453193000S01	S01	891000569C	A728870	216600	4/26/2005	6/24/2005	6/24/2005
SAN JUAN 32-9 UT 202 FC	BASIN CB:FRUITLAND COAL	2	31	N	9	W	NM	300452759600S01	S01	891000569C	A728870	216600	6/13/1990	12/1/1992	12/1/1992
SAN JUAN 32-9 UT 202S FC	BASIN CB:FRUITLAND COAL	2	31	N	9	W	NM	300453193400S01	S01	891000569C	A728870	216600	1/20/2005	3/28/2005	3/28/2005
SAN JUAN 32-9 UT 209 FC	BASIN CB:FRUITLAND COAL	2	31	N	10	W	NM	300452759700S01	S01	891000569C	A728870	216600	4/14/1990	3/9/1992	3/9/1992
SAN JUAN 32-9 UT 20A MV	BLANCO:PICTURED CLIFFS	18	31	N	9	W	NM	300452289600S01	S01	891000569A	A728867	216600	8/10/1978	10/1/1978	10/1/1978
SAN JUAN 32-9 UT 20 MV	BLANCO:PICTURED CLIFFS	18	31	N	9	W	NM	300451079700S01	S01	891000569A	A728867	216600	4/12/1954	2/1/1965	2/1/1965
SAN JUAN 32-9 UT 215 FC	BASIN CB:FRUITLAND COAL	10	32	N	9	W	NM	300452793200S01	S01	891000569C	A728870	216600	8/12/1990	4/8/1992	4/8/1992
SAN JUAN 32-9 UT 215 FC	BASIN CB:FRUITLAND COAL	10	32	N	9	W	NM	300453329300S01	S01	891000569C	A728870	216600	9/16/2006	10/3/2006	10/3/2006
SAN JUAN 32-9 UT 215 FC	BASIN CB:FRUITLAND COAL	16	32	N	9	W	NM	300452785900S01	S01	891000569C	A728870	216600	9/27/1991	3/30/1992	3/30/1992
SAN JUAN 32-9 UT 217 FC	BASIN CB:FRUITLAND COAL	16	32	N	9	W	NM	300453032400S01	S01	891000569C	A728870	216600	11/1/2005	11/30/2005	11/30/2005
SAN JUAN 32-9 UT 217S FC	BASIN CB:FRUITLAND COAL	16	32	N	9	W	NM	300452290200S01	S01	891000569A	A728867	216600	11/1/1978	12/1/1978	12/1/1978
SAN JUAN 32-9 UT 21A MV	BLANCO:PICTURED CLIFFS	11	31	N	10	W	NM	300451085900S01	S01	891000569A	A728867	216600	2/23/1955	4/1/1955	4/1/1955
SAN JUAN 32-9 UT 21 MV	BLANCO:PICTURED CLIFFS	11	31	N	10	W	NM	300452884400S01	S01	891000569C	A728870	216600	2/18/1993	9/1/1993	9/1/1993
SAN JUAN 32-9 UT 220 FC	BASIN CB:FRUITLAND COAL	11	31	N	10	W	NM	300452885000S01	S01	891000569C	A728870	216600	2/24/1993	9/1/1993	9/1/1993
SAN JUAN 32-9 UT 221 FC	BASIN CB:FRUITLAND COAL	11	31	N	10	W	NM	300452886000S01	S01	891000569C	A728870	216600	2/5/1993	8/17/1993	8/17/1993
SAN JUAN 32-9 UT 222 FC	BASIN CB:FRUITLAND COAL	12	31	N	10	W	NM	300452888700S01	S01	891000569C	A728870	216600	8/17/1993	8/17/1993	8/17/1993
SAN JUAN 32-9 UT 223 FC	BASIN CB:FRUITLAND COAL	12	31	N	10	W	NM	300452759900S01	S01	891000569C	A728870	216600	6/23/1990	4/16/1992	4/16/1992
SAN JUAN 32-9 UT 226 FC	BASIN CB:FRUITLAND COAL	32	32	N	9	W	NM	300453333100S01	S01	891000569C	A728870	216600	11/29/2005	12/21/2005	12/21/2005
SAN JUAN 32-9 UT 226S FC	BASIN CB:FRUITLAND COAL	32	32	N	9	W	NM	300452760000S01	S01	891000569C	A728870	216600	4/9/1990	12/21/1992	12/21/1992
SAN JUAN 32-9 UT 228 FC	BASIN CB:FRUITLAND COAL	36	32	N	9	W	NM	300453217300S01	S01	891000569C	A728870	216600	4/4/2005	6/24/2005	6/24/2005
SAN JUAN 32-9 UT 228S FC	BASIN CB:FRUITLAND COAL	36	32	N	9	W	NM	300452760100S01	S01	891000569C	A728870	216600	4/28/1990	3/24/1992	3/24/1992

Prod Stat: 11 Flowing Well

21 Pumping Well

41 Shut-in

61 Temp Abandoned

71 Perm Abandoned Well

82 Drilling (Developmental)

PM - Pressure Monitoring

San Juan 32-9 Unit Wells Status as of 2-8-09

Well Name	Resv. Name	Sec	Turn	Turn Dir	Ring Dir	ST	Prod Stat	Rpt Well Code	MMS Prod Interval	MMS Lease Agr Number	Use ID	Oper ID	Compl Dt	Int Prod Dt	1st Sale Dt
SAN JUAN 32-9 UT 229S FC	BASIN CB: FRUITLAND COAL	36	32	N	W	NM	11	300453331300501	S01	891000569C	A728870	216600	5/4/2006	5/24/2006	5/24/2006
SAN JUAN 32-9 UT 22A MV	BLANCO: MESAVERTIDE	14	31	N	W	NM	11	30045278900501	S01	891000569C	A728867	216600	12/1/1978	1/10/1979	1/10/1979
SAN JUAN 32-9 UT 22H MV	BLANCO: MESAVERTIDE	14	31	N	W	NM	11	30045278900501	S01	891000569C	A728867	216600	7/26/1954	9/20/1954	9/20/1954
SAN JUAN 32-9 UT 230 FC	BASIN CB: FRUITLAND COAL	36	32	N	W	NM	11	300452892900501	S01	891000569C	A728867	216600	6/28/1993	10/1/1993	10/1/1993
SAN JUAN 32-9 UT 230S FC	BASIN CB: FRUITLAND COAL	36	32	N	W	NM	11	300453382800501	S01	891000569C	A728870	216600	1/13/2006	2/8/2006	2/8/2006
SAN JUAN 32-9 UT 235 FC	BASIN CB: FRUITLAND COAL	36	32	N	W	NM	11	30045276300501	S01	891000569C	A728870	216600	6/20/1990	12/1/1992	12/1/1992
SAN JUAN 32-9 UT 235S FC	BASIN CB: FRUITLAND COAL	36	32	N	W	NM	11	30045319300501	S01	891000569C	A728870	216600	3/2/2005	6/24/2005	6/24/2005
SAN JUAN 32-9 UT 23A MV	BLANCO: MESAVERTIDE	5	31	N	W	NM	11	300452382000501	C01	891000569C	A728867	216600	1/3/1980	3/1/1980	3/1/1980
SAN JUAN 32-9 UT 23A PC	BLANCO: PICTURED CLIFFS	5	31	N	W	NM	11	300452382000501	C02	NMS-F078509	A726739	216600	9/29/1997	10/1/1997	10/1/1997
SAN JUAN 32-9 UT 241 FC	BASIN CB: FRUITLAND COAL	13	32	N	W	NM	11	30045310200501	S01	891000569C	A728870	216600	6/28/1954	7/1/1954	7/1/1954
SAN JUAN 32-9 UT 241S FC	BASIN CB: FRUITLAND COAL	13	32	N	W	NM	11	30045317100501	S01	891000569C	A728870	216600	11/8/2002	12/6/2002	12/6/2002
SAN JUAN 32-9 UT 242 FC	BASIN CB: FRUITLAND COAL	14	32	N	W	NM	11	30045285100501	S01	891000569C	A728870	216600	11/15/2006	11/15/2006	11/15/2006
SAN JUAN 32-9 UT 24A MV	BLANCO: MESAVERTIDE	5	31	N	W	NM	11	300452968000501	C01	891000569C	A728867	216600	12/1/1995	2/1/1996	2/1/1996
SAN JUAN 32-9 UT 24A PC	BLANCO: PICTURED CLIFFS	5	31	N	W	NM	11	300452968000501	C02	NMS-M99320	A726740	216600	11/20/1997	12/1/1997	12/1/1997
SAN JUAN 32-9 UT 24B DK	BASIN: DAKOTA	5	31	N	W	NM	88	WO/API							
SAN JUAN 32-9 UT 24B MV	BLANCO: MESAVERTIDE	5	31	N	W	NM	88	WO/API							
SAN JUAN 32-9 UT 24 MV	BLANCO: MESAVERTIDE	5	31	N	W	NM	11	300451109800501	S01	891000569C	A728867	216600	7/8/1954	10/1/1954	10/1/1954
SAN JUAN 32-9 UT 250 FC	BASIN CB: FRUITLAND COAL	4	31	N	W	NM	11	30045280900501	S01	891000569C	A728870	216600	3/13/1991	3/27/1992	3/27/1992
SAN JUAN 32-9 UT 250S FC	BASIN CB: FRUITLAND COAL	4	31	N	W	NM	11	30045280800501	S01	891000569C	A728870	216600	8/9/2004	9/3/2004	9/3/2004
SAN JUAN 32-9 UT 251 FC	BASIN CB: FRUITLAND COAL	4	31	N	W	NM	11	300452784700501	S01	891000569C	A728870	216600	9/8/1990	3/3/1992	3/3/1992
SAN JUAN 32-9 UT 251S FC	BASIN CB: FRUITLAND COAL	4	31	N	W	NM	11	300453287800501	S01	891000569C	A728870	216600	6/30/2006	7/28/2006	7/28/2006
SAN JUAN 32-9 UT 252 FC	BASIN CB: FRUITLAND COAL	5	31	N	W	NM	11	300452784801501	S01	891000569C	A728870	216600	8/10/1990	3/3/1992	3/3/1992
SAN JUAN 32-9 UT 252S FC	BASIN CB: FRUITLAND COAL	5	31	N	W	NM	11	30045332300501	S01	891000569C	A728870	216600	10/4/2005	10/28/2005	10/28/2005
SAN JUAN 32-9 UT 253 FC	BASIN CB: FRUITLAND COAL	5	31	N	W	NM	11	300452793300501	S01	891000569C	A728870	216600	7/24/1990	3/6/1992	3/6/1992
SAN JUAN 32-9 UT 253S FC	BASIN CB: FRUITLAND COAL	5	31	N	W	NM	11	300453287800501	S01	891000569C	A728870	216600	9/27/2005	12/7/2005	12/7/2005
SAN JUAN 32-9 UT 254 FC	BASIN CB: FRUITLAND COAL	6	31	N	W	NM	11	30045278600501	S01	891000569C	A728870	216600	8/2/1990	4/20/1992	4/20/1992
SAN JUAN 32-9 UT 254S FC	BASIN CB: FRUITLAND COAL	6	31	N	W	NM	11	30045232300501	S01	891000569C	A728870	216600	12/1/2004	1/20/2005	1/20/2005
SAN JUAN 32-9 UT 255 FC	BASIN CB: FRUITLAND COAL	6	31	N	W	NM	11	300452789600501	S01	891000569C	A728870	216600	8/23/1990	3/3/1992	3/3/1992
SAN JUAN 32-9 UT 255S FC	BASIN CB: FRUITLAND COAL	6	31	N	W	NM	11	300453322000501	S01	891000569C	A728870	216600	10/12/2005	11/4/2005	11/4/2005
SAN JUAN 32-9 UT 257 FC	BASIN CB: FRUITLAND COAL	8	31	N	W	NM	11	300452822400501	S01	891000569C	A728870	216600	3/7/1991	3/2/1992	3/2/1992
SAN JUAN 32-9 UT 257S FC	BASIN CB: FRUITLAND COAL	8	31	N	W	NM	11	300452325200501	S01	891000569C	A728870	216600	12/1/2004	3/17/2005	3/17/2005
SAN JUAN 32-9 UT 258 FC	BASIN CB: FRUITLAND COAL	9	31	N	W	NM	11	300452796100501	S01	891000569C	A728870	216600	3/17/1991	3/6/1992	3/6/1992
SAN JUAN 32-9 UT 258S FC	BASIN CB: FRUITLAND COAL	9	31	N	W	NM	11	300452789700501	S01	891000569C	A728870	216600	7/6/1990	3/6/1992	3/6/1992
SAN JUAN 32-9 UT 259 FC	BASIN CB: FRUITLAND COAL	9	31	N	W	NM	41	30045335900501	S01	891000569C	A728870	216600	6/2/2006	6/16/2006	6/16/2006
SAN JUAN 32-9 UT 259S FC	BASIN CB: FRUITLAND COAL	9	31	N	W	NM	11	300452504100501	S01	891000569C	A728867	216600	10/12/1981	12/1/1991	12/1/1991
SAN JUAN 32-9 UT 25A MV	BLANCO: MESAVERTIDE	2	31	N	W	NM	11	300452812000501	S01	891000569C	A728870	216600	7/3/1990	3/4/1992	3/4/1992
SAN JUAN 32-9 UT 25 MV	BLANCO: MESAVERTIDE	2	31	N	W	NM	11	300452786100501	S01	891000569C	A728870	216600	6/10/2006	6/29/2006	6/29/2006
SAN JUAN 32-9 UT 260 FC	BASIN CB: FRUITLAND COAL	10	31	N	W	NM	11	30045336200501	S01	891000569C	A728870	216600	3/25/1991	4/7/1992	4/7/1992
SAN JUAN 32-9 UT 260S FC	BASIN CB: FRUITLAND COAL	10	31	N	W	NM	11	30045277500501	S01	891000569C	A728870	216600	7/6/2005	7/22/2005	7/22/2005
SAN JUAN 32-9 UT 261 FC	BASIN CB: FRUITLAND COAL	10	31	N	W	NM	11	30045278900501	S01	891000569C	A728870	216600	6/24/2006	8/2/2006	8/2/2006
SAN JUAN 32-9 UT 261S FC	BASIN CB: FRUITLAND COAL	15	31	N	W	NM	11	30045336000501	S01	891000569C	A728870	216600	7/14/1990	4/8/1992	4/8/1992
SAN JUAN 32-9 UT 262 FC	BASIN CB: FRUITLAND COAL	15	31	N	W	NM	11	300452789900501	S01	891000569C	A728870	216600	7/24/1990	3/4/1992	3/4/1992
SAN JUAN 32-9 UT 262S FC	BASIN CB: FRUITLAND COAL	15	31	N	W	NM	11	300452786200501	S01	891000569C	A728870	216600	6/24/2006	8/2/2006	8/2/2006
SAN JUAN 32-9 UT 263 FC	BASIN CB: FRUITLAND COAL	15	31	N	W	NM	11	300452786200501	S01	891000569C	A728870	216600	7/14/1990	4/8/1992	4/8/1992
SAN JUAN 32-9 UT 263S FC	BASIN CB: FRUITLAND COAL	17	31	N	W	NM	11	300452799200501	S01	891000569C	A728870	216600	3/3/1991	3/2/1992	3/2/1992
SAN JUAN 32-9 UT 264 FC	BASIN CB: FRUITLAND COAL	17	31	N	W	NM	11	30045278200501	S01	891000569C	A728870	216600	3/3/1991	3/2/1992	3/2/1992
SAN JUAN 32-9 UT 264S FC	BASIN CB: FRUITLAND COAL	17	31	N	W	NM	11	30045278200501	S01	891000569C	A728870	216600	5/23/2006	7/18/2006	7/18/2006
SAN JUAN 32-9 UT 268 FC	BASIN CB: FRUITLAND COAL	1	31	N	W	NM	11	30045335700501	S01	891000569C	A728870	216600	10/8/1990	3/24/1992	3/24/1992
SAN JUAN 32-9 UT 268S FC	BASIN CB: FRUITLAND COAL	1	31	N	W	NM	11	30045280200501	S01	891000569C	A728870	216600	10/8/1990	3/24/1992	3/24/1992
SAN JUAN 32-9 UT 269 FC	BASIN CB: FRUITLAND COAL	1	31	N	W	NM	11	300452895200501	S01	891000569C	A728867	216600	7/4/1993	10/28/1993	10/1/1993
SAN JUAN 32-9 UT 26A MV	BLANCO: MESAVERTIDE	1	31	N	W	NM	11	300451102900501	S01	891000569C	A728867	216600	5/22/1956	6/1/1956	6/1/1956
SAN JUAN 32-9 UT 26 MV	BLANCO: MESAVERTIDE	1	31	N	W	NM	11	300452964600501	S01	891000569C	A728867	216600	9/17/1997	9/26/1997	9/26/1997
SAN JUAN 32-9 UT 270 FC	BASIN CB: FRUITLAND COAL	18	32	N	W	NM	11	30045280300501	S01	891000569C	A728870	216600	9/30/1990	4/1/1992	4/1/1992
SAN JUAN 32-9 UT 270S FC	BASIN CB: FRUITLAND COAL	18	32	N	W	NM	11	300453251900501	S01	891000569C	A728870	216600	8/5/2005	11/22/2005	11/22/2005
SAN JUAN 32-9 UT 271 FC	BASIN CB: FRUITLAND COAL	18	32	N	W	NM	11	30045317700501	S01	891000569C	A728870	216600	3/12/1992	1/24/2004	1/24/2004
SAN JUAN 32-9 UT 271S FC	BASIN CB: FRUITLAND COAL	18	32	N	W	NM	11	300453086200501	S01	891000569C	A728870	216600	6/24/2001	8/9/2001	8/9/2001
SAN JUAN 32-9 UT 272 FC	BASIN CB: FRUITLAND COAL	21	32	N	W	NM	11	30045335200501	S01	891000569C	A728870	216600	8/1/4/2006	9/1/2006	9/1/2006
SAN JUAN 32-9 UT 272S FC	BASIN CB: FRUITLAND COAL	21	32	N	W	NM	11	30045335200501	S01	891000569C	A728870	216600	9/1/2006	3/9/1992	3/9/1992
SAN JUAN 32-9 UT 273 FC	BASIN CB: FRUITLAND COAL	19	32	N	W	NM	11	30045282100501	S01	891000569C	A728870	216600	8/29/2005	10/14/2005	10/14/2005
SAN JUAN 32-9 UT 273S FC	BASIN CB: FRUITLAND COAL	19	32	N	W	NM	11	30045282100501	S01	891000569C	A728870	216600	4/10/1991	3/17/1992	3/17/1992
SAN JUAN 32-9 UT 274 FC	BASIN CB: FRUITLAND COAL	28	32	N	W	NM	11	30045282100501	S01	891000569C	A728870	216600	4/10/1991	3/17/1992	3/17/1992

San Juan 32-9 Unit Wells Status as of 2-6-09

Well Name	Resv. Name	Sec	Twn	Dir	Rng	Dir	ST	Prod Stat	Api Well Code	MMS Prod Interval	MMS Lease Agr Number	Use ID	Oper ID	Compl Dt	Int Prod Dt	1st Sale Dt		
SAN JUAN 32-9 UT 274S FC	BASIN CB: FRUITLAND COAL	28	32	N	9	W	NM	11	300453254700501	S01	891000569C	A728870	216600	12/20/2004	1/25/2005	1/25/2005		
SAN JUAN 32-9 UT 275S FC	BASIN CB: FRUITLAND COAL	29	32	N	9	W	NM	11	3004532812900501	S01	891000569C	A728870	216600	4/5/1991	4/15/1992	4/15/1992		
SAN JUAN 32-9 UT 276S FC	BASIN CB: FRUITLAND COAL	27	32	N	9	W	NM	11	3004532844401501	S01	891000569C	A728870	216600	11/26/2004	3/18/2005	3/18/2005		
SAN JUAN 32-9 UT 276S FC	BASIN CB: FRUITLAND COAL	27	32	N	9	W	NM	11	3004532844401501	S01	891000569C	A728870	216600	10/21/1991	4/21/1992	4/21/1992		
SAN JUAN 32-9 UT 276S FC	BASIN CB: FRUITLAND COAL	27	32	N	9	W	NM	11	3004532844401501	S01	891000569C	A728870	216600	12/3/2004	1/17/2005	1/17/2005		
SAN JUAN 32-9 UT 277S FC	BASIN CB: FRUITLAND COAL	30	32	N	9	W	NM	11	3004532813700501	S01	891000569C	A728870	216600	9/6/1990	4/14/1992	4/14/1992		
SAN JUAN 32-9 UT 277S FC	BASIN CB: FRUITLAND COAL	30	32	N	9	W	NM	11	3004532813700501	S01	891000569C	A728870	216600	9/24/2004	11/3/2004	11/3/2004		
SAN JUAN 32-9 UT 278S FC	BASIN CB: FRUITLAND COAL	31	32	N	9	W	NM	11	3004532813700501	S01	891000569C	A728870	216600	9/13/1990	4/14/1992	4/14/1992		
SAN JUAN 32-9 UT 278S FC	BASIN CB: FRUITLAND COAL	31	32	N	9	W	NM	11	3004532813700501	S01	891000569C	A728870	216600	5/13/2006	6/5/2006	6/5/2006		
SAN JUAN 32-9 UT 279S FC	BASIN CB: FRUITLAND COAL	31	32	N	9	W	NM	11	3004532813700501	S01	891000569C	A728870	216600	9/15/1990	4/16/1992	4/16/1992		
SAN JUAN 32-9 UT 281 FC	BLANCO: MESAVIERDE	23	32	N	9	W	NM	11	3004531131400501	S01	891000569C	A728867	216600	11/11/1955	3/1/1956	3/1/1956		
SAN JUAN 32-9 UT 281 FC	BLANCO: MESAVIERDE	23	32	N	9	W	NM	11	300453275200501	S01	891000569C	A728870	216600	7/20/1990	3/6/1992	3/6/1992		
SAN JUAN 32-9 UT 281S FC	BASIN CB: FRUITLAND COAL	32	32	N	9	W	NM	11	300453304100501	S01	891000569C	A728870	216600	12/17/2005	1/6/2006	1/6/2006		
SAN JUAN 32-9 UT 282S FC	BASIN CB: FRUITLAND COAL	33	32	N	9	W	NM	11	3004532830400501	S01	891000569C	A728870	216600	3/19/1991	4/21/1992	4/21/1992		
SAN JUAN 32-9 UT 282S FC	BASIN CB: FRUITLAND COAL	33	32	N	9	W	NM	11	3004532830400501	S01	891000569C	A728870	216600	9/17/2004	10/15/2004	10/15/2004		
SAN JUAN 32-9 UT 283S FC	BASIN CB: FRUITLAND COAL	33	32	N	9	W	NM	11	3004532830400501	S01	891000569C	A728870	216600	9/21/1990	4/20/1992	4/20/1992		
SAN JUAN 32-9 UT 283S FC	BASIN CB: FRUITLAND COAL	33	32	N	9	W	NM	11	3004532830400501	S01	891000569C	A728870	216600	2/15/2005	6/24/2005	6/24/2005		
SAN JUAN 32-9 UT 284S FC	BASIN CB: FRUITLAND COAL	13	32	N	10	W	NM	11	300453177200501	S01	891000569C	A728870	216600	1/17/2004	2/9/2004	2/9/2004		
SAN JUAN 32-9 UT 285 FC	BASIN CB: FRUITLAND COAL	13	32	N	10	W	NM	11	300453281300501	S01	891000569C	A728870	216600	4/16/1991	3/12/1992	3/12/1992		
SAN JUAN 32-9 UT 285S FC	BASIN CB: FRUITLAND COAL	13	32	N	10	W	NM	11	300453336300501	S01	891000569C	A728870	216600	11/24/2006	12/13/2006	12/13/2006		
SAN JUAN 32-9 UT 286 FC	BASIN CB: FRUITLAND COAL	14	32	N	10	W	NM	11	30045329000501	S01	891000569C	A728870	216600	7/10/1990	3/16/1992	3/16/1992		
SAN JUAN 32-9 UT 286S FC	BASIN CB: FRUITLAND COAL	14	32	N	10	W	NM	11	30045328200501	S01	891000569C	A728870	216600	9/19/2005	9/23/2005	9/23/2005		
SAN JUAN 32-9 UT 287S FC	BASIN CB: FRUITLAND COAL	14	32	N	10	W	NM	11	300452810100501	S01	891000569C	A728870	216600	3/16/1992	3/12/1992	3/12/1992		
SAN JUAN 32-9 UT 287S FC	BASIN CB: FRUITLAND COAL	14	32	N	10	W	NM	11	300452810200501	S01	891000569C	A728870	216600	10/14/2005	10/28/2005	10/28/2005		
SAN JUAN 32-9 UT 288S FC	BASIN CB: FRUITLAND COAL	23	32	N	10	W	NM	11	300453303400501	S01	891000569C	A728870	216600	9/16/1990	3/10/1992	3/10/1992		
SAN JUAN 32-9 UT 288S FC	BASIN CB: FRUITLAND COAL	23	32	N	10	W	NM	11	300453303400501	S01	891000569C	A728870	216600	10/29/2006	11/30/2006	11/30/2006		
SAN JUAN 32-9 UT 289 FC	BASIN CB: FRUITLAND COAL	23	32	N	10	W	NM	11	300453254700501	S01	891000569C	A728870	216600	4/21/1991	3/11/1992	3/11/1992		
SAN JUAN 32-9 UT 289S FC	BASIN CB: FRUITLAND COAL	23	32	N	10	W	NM	11	300453254700501	S01	891000569C	A728870	216600	9/26/2005	10/4/2005	10/4/2005		
SAN JUAN 32-9 UT 289S FC	BLANCO: MESAVIERDE	26	32	N	10	W	NM	11	300451123100501	S01	891000569C	A728867	216600	1/21/1956	3/1/1956	3/1/1956		
SAN JUAN 32-9 UT 291 FC	BASIN CB: FRUITLAND COAL	24	32	N	10	W	NM	11	300452793400501	S01	891000569C	A728870	216600	7/11/1990	3/2/1992	3/2/1992		
SAN JUAN 32-9 UT 291S FC	BASIN CB: FRUITLAND COAL	24	32	N	10	W	NM	11	300452938100501	S01	891000569C	A728870	216600	3/18/1997	9/16/2004	9/16/2004		
SAN JUAN 32-9 UT 292 FC	BASIN CB: FRUITLAND COAL	25	32	N	10	W	NM	11	300452803700501	S01	891000569C	A728870	216600	9/27/1990	3/9/1992	3/9/1992		
SAN JUAN 32-9 UT 292S FC	BASIN CB: FRUITLAND COAL	25	32	N	10	W	NM	11	30045333600501	S01	891000569C	A728870	216600	4/7/1991	4/21/1992	4/21/1992		
SAN JUAN 32-9 UT 293S FC	BASIN CB: FRUITLAND COAL	25	32	N	10	W	NM	11	3004532579100501	S01	891000569C	A728870	216600	7/12/2006	7/31/2006	7/31/2006		
SAN JUAN 32-9 UT 293S FC	BASIN CB: FRUITLAND COAL	25	32	N	10	W	NM	11	3004532579100501	S01	891000569C	A728870	216600	12/10/2004	1/27/2005	1/27/2005		
SAN JUAN 32-9 UT 294 FC	BASIN CB: FRUITLAND COAL	26	32	N	10	W	NM	11	300452807600501	S01	891000569C	A728870	216600	4/1/1991	3/9/1992	3/9/1992		
SAN JUAN 32-9 UT 295 FC	BASIN CB: FRUITLAND COAL	26	32	N	10	W	NM	11	300453256800501	S01	891000569C	A728870	216600	12/15/2004	5/27/2005	5/27/2005		
SAN JUAN 32-9 UT 295S FC	BASIN CB: FRUITLAND COAL	26	32	N	10	W	NM	11	300452803800501	S01	891000569C	A728870	216600	3/27/1991	3/2/1992	3/2/1992		
SAN JUAN 32-9 UT 296 FC	BASIN CB: FRUITLAND COAL	35	32	N	10	W	NM	11	3004532831500501	S01	891000569C	A728870	216600	4/13/1991	3/4/1992	3/4/1992		
SAN JUAN 32-9 UT 296 FC	BASIN CB: FRUITLAND COAL	35	32	N	10	W	NM	11	3004532831500501	S01	891000569C	A728870	216600	12/9/2004	12/30/2004	12/30/2004		
SAN JUAN 32-9 UT 297 FC	BASIN CB: FRUITLAND COAL	35	32	N	10	W	NM	11	300452803900501	S01	891000569C	A728870	216600	9/17/1990	3/4/1992	3/4/1992		
SAN JUAN 32-9 UT 297S FC	BASIN CB: FRUITLAND COAL	35	32	N	10	W	NM	11	300453353500501	S01	891000569C	A728870	216600	11/6/2006	12/13/2007	12/13/2007		
SAN JUAN 32-9 UT 298 MV	BLANCO: MESAVIERDE	36	32	N	10	W	NM	11	300453247300501	S01	891000569C	A728867	216600	7/16/1979	9/11/1979	9/11/1979		
SAN JUAN 32-9 UT 29 MV	BLANCO: MESAVIERDE	36	32	N	10	W	NM	11	30045113100501	S01	891000569C	A728867	216600	9/12/1955	1/1/1956	1/1/1956		
SAN JUAN 32-9 UT 300 FC	BASIN CB: FRUITLAND COAL	11	32	N	10	W	NM	11	300452796601501	S01	891000569C	A728870	216600	7/27/1990	3/16/1992	3/16/1992		
SAN JUAN 32-9 UT 300S FC	BASIN CB: FRUITLAND COAL	11	32	N	10	W	NM	11	300453256200501	S01	891000569C	A728870	216600	12/16/2004	12/31/2004	12/31/2004		
SAN JUAN 32-9 UT 301 FC	BASIN CB: FRUITLAND COAL	12	32	N	10	W	NM	11	300452796701501	S01	891000569C	A728870	216600	8/4/1990	3/17/1992	3/17/1992		
SAN JUAN 32-9 UT 301S FC	BASIN CB: FRUITLAND COAL	12	32	N	10	W	NM	11	300453225100501	S01	891000569C	A728870	216600	10/17/2004	11/7/2004	11/7/2004		
SAN JUAN 32-9 UT 302 FC	BASIN CB: FRUITLAND COAL	9	32	N	9	W	NM	11	300452803900501	S01	891000569C	A728870	216600	10/19/1998	12/14/1999	12/14/1999		
SAN JUAN 32-9 UT 302S FC	BASIN CB: FRUITLAND COAL	9	32	N	9	W	NM	11	300453321900501	S01	891000569C	A728870	216600	11/15/2005	11/29/2005	11/29/2005		
SAN JUAN 32-9 UT 303 FC	BASIN CB: FRUITLAND COAL	14	31	N	10	W	NM	11	300453054800501	S01	891000569C	A728870	216600	7/10/2001	7/14/2001	7/14/2001		
SAN JUAN 32-9 UT 304 MV	BLANCO: MESAVIERDE	36	32	N	10	W	NM	11	30045117400501	S01	891000569C	A728867	216600	7/19/1979	9/1/1979	9/1/1979		
SAN JUAN 32-9 UT 30 MV	BLANCO: MESAVIERDE	36	32	N	10	W	NM	11	30045117400501	S01	891000569C	A728867	216600	10/11/1955	1/1/1956	1/1/1956		
SAN JUAN 32-9 UT 31A MV	BLANCO: MESAVIERDE	13	31	N	10	W	NM	11	300452290800501	S01	891000569C	A728867	216600	5/30/1979	7/21/1979	7/21/1979		
SAN JUAN 32-9 UT 31 MV	BLANCO: MESAVIERDE	13	31	N	10	W	NM	11	300451071700501	S01	891000569C	A728867	216600	4/24/1955	6/1/1955	6/1/1955		
SAN JUAN 32-9 UT 32A MV	BLANCO: MESAVIERDE	31	32	N	9	W	NM	11	300452329800501	S01	891000569C	A728867	216600	7/10/1979	9/1/1979	9/1/1979		
SAN JUAN 32-9 UT 32R MV	BLANCO: MESAVIERDE	31	32	N	9	W	NM	11	3004520398700501	S01	891000569C	A728867	216600	7/24/1972	8/1/1972	8/1/1972		
SAN JUAN 32-9 UT 33A MV	BLANCO: MESAVIERDE	6	31	N	9	W	NM	11	300452331200501	S01	891000569C	A728867	216600	7/31/1979	9/1/1979	9/1/1979		

San Juan 32-9 Unit Wells Status as of 2-8-09

Well Name	Resv. Name	Sec	Tw	Tw Dir	Rng Dir	ST	Prod Stat	Api Well Code	MMS Prod Interval	MMS Lease Agr Number	Lee ID	Oper ID	Compl Dt	Int Prod Dt	1st Sale Dt
SAN JUAN 32-9 UT 33 MW	BLANCO-MESAVERDE	6	31	N	9	W	NM	11	300451101600S01	S01	8910005690	A728867	216600	6/19/1955	7/1/1955
SAN JUAN 32-9 UT 34A MW	BLANCO-MESAVERDE	35	32	N	10	W	NM	11	3004522962700S01	S01	8910005690	A728867	216600	7/17/1978	9/1/1978
SAN JUAN 32-9 UT 34B DK	BASIN-DAKOTA	35	32	N	10	W	NM	88	WO/API						
SAN JUAN 32-9 UT 34B MW	BLANCO-MESAVERDE	35	32	N	10	W	NM	88	WO/API						
SAN JUAN 32-9 UT 34 MW	BLANCO-MESAVERDE	35	32	N	10	W	NM	11	3004522962700S01	S01	8910005690	A728867	216600	3/21/1955	6/1/1955
SAN JUAN 32-9 UT 35A MW	BLANCO-MESAVERDE	10	31	N	9	W	NM	11	300453089600S01	S01	8910005690	A728867	216600	2/19/2002	3/7/2002
SAN JUAN 32-9 UT 35B MW	BLANCO-MESAVERDE	10	31	N	9	W	NM	11	300453089600S01	S01	8910005690	A728867	216600	12/8/1998	12/18/1998
SAN JUAN 32-9 UT 36A MW	BLANCO-MESAVERDE	33	32	N	9	W	NM	11	300452962700S01	S01	8910005690	A728867	216600	10/15/1955	11/1/1955
SAN JUAN 32-9 UT 36 MW	BLANCO-MESAVERDE	33	32	N	9	W	NM	11	300452962700S01	S01	8910005690	A728867	216600	5/14/1996	7/29/1996
SAN JUAN 32-9 UT 37A MW	BLANCO-MESAVERDE	32	32	N	9	W	NM	11	300452931100C01	C01	8910005690	A728867	216600	5/14/1996	7/29/1996
SAN JUAN 32-9 UT 37A PC	BLANCO-PICTURED CLIFFS	32	32	N	9	W	NM	11	300452931100C02	C02	8910005690	A728867	216600	10/12/1956	4/1/1957
SAN JUAN 32-9 UT 37 MW	BLANCO-MESAVERDE	32	32	N	9	W	NM	11	30045117600S01	S01	8910005690	A728867	216600	10/17/1956	4/1/1957
SAN JUAN 32-9 UT 38A MW	BLANCO-MESAVERDE	35	32	N	10	W	NM	11	30045230000S01	S01	8910005690	A728867	216600	7/6/1979	9/1/1979
SAN JUAN 32-9 UT 38 MW	BLANCO-MESAVERDE	35	32	N	10	W	NM	11	30045230000S01	S01	8910005690	A728867	216600	9/22/1956	4/1/1957
SAN JUAN 32-9 UT 39A MW	BLANCO-MESAVERDE	26	32	N	10	W	NM	11	300452946300S01	S01	8910005690	A728867	216600	8/13/1997	9/3/1997
SAN JUAN 32-9 UT 39 MW	BLANCO-MESAVERDE	26	32	N	10	W	NM	11	300451128600S01	S01	8910005690	A728867	216600	10/17/1956	4/1/1957
SAN JUAN 32-9 UT 3A MW	BLANCO-MESAVERDE	1	31	N	10	W	NM	11	300452289600S01	S01	8910005690	A728867	216600	9/20/1978	5/1/1979
SAN JUAN 32-9 UT 3 MW	BLANCO-MESAVERDE	1	31	N	10	W	NM	11	300451108300C01	C01	8910005690	A728867	216600	6/5/1953	11/1/1954
SAN JUAN 32-9 UT 3 PC	BLANCO-PICTURED CLIFFS	1	31	N	10	W	NM	11	300451108300C02	C02	8910005690	A728867	216600	11/7/1996	11/22/1996
SAN JUAN 32-9 UT 40A MW	BLANCO-MESAVERDE	30	32	N	9	W	NM	11	3004522962700S01	S01	8910005690	A728867	216600	12/23/1998	1/13/1999
SAN JUAN 32-9 UT 41A MW	BLANCO-MESAVERDE	30	32	N	9	W	NM	11	300451122000S01	S01	8910005690	A728867	216600	11/9/1956	4/1/1956
SAN JUAN 32-9 UT 41A PC	BLANCO-PICTURED CLIFFS	31	32	N	9	W	NM	11	300452912900C02	C02	8910005690	A728867	216600	7/28/1994	12/1/1994
SAN JUAN 32-9 UT 41A MW	BLANCO-MESAVERDE	31	32	N	9	W	NM	11	300452912900C01	C01	8910005690	A728867	216600	7/28/1994	12/1/1994
SAN JUAN 32-9 UT 42A MW	BLANCO-MESAVERDE	31	32	N	9	W	NM	11	300452313000S01	S01	8910005690	A728867	216600	11/9/1956	4/1/1956
SAN JUAN 32-9 UT 42A MW	BLANCO-MESAVERDE	6	31	N	9	W	NM	11	300451108700S01	S01	8910005690	A728867	216600	6/28/1956	9/1/1956
SAN JUAN 32-9 UT 42 MW	BLANCO-MESAVERDE	6	31	N	9	W	NM	11	300452290000S01	S01	8910005690	A728867	216600	2/1/1979	2/1/1979
SAN JUAN 32-9 UT 43A MW	BLANCO-MESAVERDE	2	31	N	10	W	NM	11	300451100800S01	S01	8910005690	A728867	216600	5/9/1956	6/1/1956
SAN JUAN 32-9 UT 43 MW	BLANCO-MESAVERDE	2	31	N	10	W	NM	11	300452894000S01	S01	8910005690	A728867	216600	6/7/1993	10/21/1993
SAN JUAN 32-9 UT 44 MW	BLANCO-MESAVERDE	11	31	N	10	W	NM	11	300451092700S01	S01	8910005690	A728867	216600	4/6/1956	6/1/1956
SAN JUAN 32-9 UT 44 MW	BLANCO-MESAVERDE	12	31	N	10	W	NM	11	300452487600S01	S01	8910005690	A728867	216600	9/22/1981	11/1/1981
SAN JUAN 32-9 UT 45A MW	BLANCO-MESAVERDE	12	31	N	10	W	NM	11	300451086300S01	S01	8910005690	A728867	216600	6/21/1956	9/1/1956
SAN JUAN 32-9 UT 45 MW	BLANCO-MESAVERDE	12	31	N	10	W	NM	11	300451086300S01	S01	8910005690	A728867	216600	6/21/1956	9/1/1956
SAN JUAN 32-9 UT 46A MW	BLANCO-MESAVERDE	4	31	N	9	W	NM	11	300452927000S01	S01	8910005690	A728867	216600	12/5/1995	4/1/1957
SAN JUAN 32-9 UT 46 MW	BLANCO-MESAVERDE	4	31	N	9	W	NM	11	300456026100S01	S01	8910005690	A728867	216600	11/26/1956	4/1/1957
SAN JUAN 32-9 UT 47A MW	BLANCO-MESAVERDE	4	31	N	9	W	NM	11	300452932000C01	C01	8910005690	A728867	216600	5/21/1996	8/6/1996
SAN JUAN 32-9 UT 47A PC	BLANCO-PICTURED CLIFFS	4	31	N	9	W	NM	11	300452932000C02	C02	8910005690	A728867	216600	5/21/1996	8/6/1996
SAN JUAN 32-9 UT 47 MW	BLANCO-MESAVERDE	4	31	N	9	W	NM	11	300451101100C01	C01	8910005690	A728867	216600	11/7/1956	4/1/1957
SAN JUAN 32-9 UT 47 PC	BLANCO-PICTURED CLIFFS	4	31	N	9	W	NM	11	300451101100C02	C02	8910005690	A728867	216600	11/5/1997	12/1/1997
SAN JUAN 32-9 UT 47 MW	BLANCO-MESAVERDE	4	31	N	9	W	NM	11	300451101100C01	C01	8910005690	A728867	216600	11/5/1997	12/1/1997
SAN JUAN 32-9 UT 47 PC	BLANCO-PICTURED CLIFFS	4	31	N	9	W	NM	11	300451101100C02	C02	8910005690	A728867	216600	8/23/1957	12/1/1957
SAN JUAN 32-9 UT 48 MW	BLANCO-MESAVERDE	23	32	N	10	W	NM	11	300451142800S01	S01	8910005690	A728867	216600	8/23/1957	9/3/1957
SAN JUAN 32-9 UT 49A MW	BLANCO-MESAVERDE	23	32	N	10	W	NM	11	300452944300S01	S01	8910005690	A728867	216600	7/16/1957	12/1/1957
SAN JUAN 32-9 UT 49 MW	BLANCO-MESAVERDE	23	32	N	10	W	NM	11	300451137501S01	S01	8910005690	A728867	216600	5/8/1996	5/28/1996
SAN JUAN 32-9 UT 48 MW	BLANCO-MESAVERDE	12	31	N	10	W	NM	11	300452935000S01	S01	8910005690	A728867	216600	7/20/1993	10/26/1993
SAN JUAN 32-9 UT 4R MW	BLANCO-MESAVERDE	12	31	N	10	W	NM	11	300452985500S01	S01	8910005690	A728867	216600	12/18/1998	12/31/1998
SAN JUAN 32-9 UT 50A MW	BLANCO-MESAVERDE	25	32	N	10	W	NM	11	300452985500S01	S01	8910005690	A728867	216600	11/8/2006	12/1/2006
SAN JUAN 32-9 UT 50A MW	BLANCO-MESAVERDE	25	32	N	10	W	NM	11	300453335000C01	C01	8910005690	A728867	216600	11/8/2006	12/1/2006
SAN JUAN 32-9 UT 50B DK	BASIN-DAKOTA	25	32	N	10	W	NM	11	300453335000C02	C02	8910005690	A728867	216600	8/2/1957	12/1/1957
SAN JUAN 32-9 UT 50B MW	BLANCO-MESAVERDE	25	32	N	10	W	NM	11	300453335000C01	C01	8910005690	A728867	216600	6/25/1957	12/1/1957
SAN JUAN 32-9 UT 51A MW	BLANCO-MESAVERDE	29	32	N	9	W	NM	11	300452962700S01	S01	8910005690	A728867	216600	8/23/1957	11/1/1958
SAN JUAN 32-9 UT 51 MW	BLANCO-MESAVERDE	29	32	N	9	W	NM	11	300451122500S01	S01	8910005690	A728867	216600	10/7/1957	12/1/1957
SAN JUAN 32-9 UT 53 MW	BLANCO-MESAVERDE	27	32	N	9	W	NM	11	300451143200S01	S01	8910005690	A728867	216600	10/7/1957	12/1/1957
SAN JUAN 32-9 UT 54 MW	BLANCO-MESAVERDE	14	32	N	10	W	NM	41	300451149700S01	S01	8910005690	A728867	216600	11/3/1981	3/1/1981
SAN JUAN 32-9 UT 56 MW	BLANCO-MESAVERDE	2	31	N	9	W	NM	11	3004529419600S01	S01	8910005690	A728867	216600	5/18/1958	9/1/1958
SAN JUAN 32-9 UT 57A MW	BLANCO-MESAVERDE	2	31	N	9	W	NM	11	300451105900S01	S01	8910005690	A728867	216600	6/26/1969	6/1/1968
SAN JUAN 32-9 UT 57 MW	BLANCO-MESAVERDE	16	32	N	9	W	NM	11	300452342600S01	S01	8910005690	A728867	216600	7/6/1993	10/1/1993
SAN JUAN 32-9 UT 58 MW	BLANCO-MESAVERDE	15	31	N	9	W	NM	11	300452994100S01	S01	8910005690	A728867	216600	4/26/1958	4/1/1958
SAN JUAN 32-9 UT 5R MW	BLANCO-MESAVERDE	15	31	N	9	W	NM	11	300451127000S01	S01	8910005690	A72867	216600	11/9/1981	4/1/1981
SAN JUAN 32-9 UT 60 MW	BLANCO-MESAVERDE	36	32	N	9	W	NM	11	300452419900S01	S01	8910005690	A728867	216600	7/12/1958	11/1/1958
SAN JUAN 32-9 UT 61 MW	BLANCO-MESAVERDE	36	32	N	9	W	NM	11	300451128000S01	S01	8910005690	A728867	216600	4/22/1958	6/1/1958
SAN JUAN 32-9 UT 62 MW	BLANCO-MESAVERDE	14	32	N	10	W	NM	11	300451145000S01	S01	8910005690	A728867	216600	4/22/1958	6/1/1958

San Juan 32-9 Unit Wells Status as of 2-9-09

Well Name	Resv. Name	Sec	Tw	Tw Dir	Ring	Ring Dir	ST	Prod Stat	Api Well Code	MMS Prod Interval	MMS Lease Agr Number	Lse ID	Oper ID	Compl Dt	Int Prod Dt	1st Sale Dt		
SAN JUAN 32-9 UT 63 MV	BLANCO-MESAVERDE	36	32	N	9	W	NM	11	30045117700501	S01	8910005690	A728867	216600	5/13/1958	9/1/1958	9/1/1958		
SAN JUAN 32-9 UT 64A MV	BLANCO-MESAVERDE	2	31	N	9	W	NM	11	300452419500501	S01	8910005690	A728867	216600	1/26/1981	6/1/1981	6/1/1981		
SAN JUAN 32-9 UT 64 MV	BLANCO-MESAVERDE	2	31	N	9	W	NM	41	30045109800501	S01	8910005690	A728867	216600	4/19/1958	8/1/1958	8/1/1958		
SAN JUAN 32-9 UT 65 MV	BLANCO-MESAVERDE	9	32	N	9	W	NM	11	300451149900501	S01	8910005690	A728867	216600	6/27/1958	10/1/1958	10/1/1958		
SAN JUAN 32-9 UT 66 MV	BLANCO-MESAVERDE	10	32	N	9	W	NM	11	300451149100501	S01	8910005690	A728867	216600	6/14/1958	1/1/1959	1/1/1959		
SAN JUAN 32-9 UT 66A MV	BLANCO-MESAVERDE	24	32	N	10	W	NM	11	30045296900501	S01	8910005690	A728867	216600	9/23/1998	10/5/1998	10/5/1998		
SAN JUAN 32-9 UT 68 MV	BLANCO-MESAVERDE	24	32	N	10	W	NM	11	300451131600501	S01	8910005690	A728867	216600	4/15/1959	7/1/1959	7/1/1959		
SAN JUAN 32-9 UT 69 MV	BLANCO-MESAVERDE	13	32	N	10	W	NM	11	300451140900501	S01	8910005690	A728867	216600	6/8/1959	7/1/1959	7/1/1959		
SAN JUAN 32-9 UT 64 MV	BLANCO-MESAVERDE	15	31	N	9	W	NM	11	300452289400501	S01	8910005690	A728867	216600	8/21/1978	10/1/1978	10/1/1978		
SAN JUAN 32-9 UT 67 MV	BLANCO-MESAVERDE	15	31	N	9	W	NM	11	300452897200501	S01	8910005690	A728867	216600	8/12/1993	10/1/1993	10/1/1993		
SAN JUAN 32-9 UT 70X MV	BLANCO-MESAVERDE	21	32	N	9	W	NM	11	300451136400501	S01	8910005690	A728867	216600	9/10/1959	12/1/1959	12/1/1959		
SAN JUAN 32-9 UT 71 MV	BLANCO-MESAVERDE	33	32	N	9	W	NM	41	300451119500501	S01	8910005690	A728867	216600	6/15/1959	8/1/1959	8/1/1959		
SAN JUAN 32-9 UT 75 MV	BLANCO-MESAVERDE	18	32	N	9	W	NM	11	300451142700501	S01	8910005690	A728867	216600	6/16/1960	8/1/1960	8/1/1960		
SAN JUAN 32-9 UT 76 MV	BLANCO-MESAVERDE	13	32	N	10	W	NM	11	300451147100501	S01	8910005690	A728867	216600	5/28/1960	8/1/1960	8/1/1960		
SAN JUAN 32-9 UT 74 MV	BLANCO-MESAVERDE	32	32	N	9	W	NM	11	300452926900501	S01	8910005690	A728867	216600	11/28/1995	3/14/1996	3/14/1996		
SAN JUAN 32-9 UT 78 MV	BLANCO-MESAVERDE	32	32	N	9	W	NM	11	300452983900501	S01	8910005690	A728867	216600	8/14/1999	8/24/1999	8/24/1999		
SAN JUAN 32-9 UT 83 PC	BLANCO-PICTURED CLIFFS	14	31	N	10	W	NM	11	300452250100501	S01	891000569A	A728868	216600	9/20/1978	11/9/1978	11/9/1978		
SAN JUAN 32-9 UT 85 PC	BLANCO-PICTURED CLIFFS	13	31	N	10	W	NM	11	300452327600501	S01	891000569A	A728868	216600	7/23/1979	8/21/1979	8/21/1979		
SAN JUAN 32-9 UT 86 PC	BLANCO-PICTURED CLIFFS	14	31	N	10	W	NM	11	300452159100501	S01	891000569A	A728868	216600	7/4/1975	8/8/1975	8/8/1975		
SAN JUAN 32-9 UT 89 PC	BLANCO-PICTURED CLIFFS	2	31	N	10	W	NM	11	300452290400501	S01	891000569A	A728868	216600	9/12/1977	3/1/1978	3/1/1978		
SAN JUAN 32-9 UT 91 PC	BLANCO-PICTURED CLIFFS	11	31	N	10	W	NM	11	300452290400501	S01	891000569A	A728868	216600	8/2/1979	2/26/1982	2/26/1982		
SAN JUAN 32-9 UT 93 PC	BLANCO-PICTURED CLIFFS	12	31	N	10	W	NM	11	300452290600501	S01	891000569A	A728868	216600	9/20/1978	10/1/1978	10/1/1978		
SAN JUAN 32-9 UT 94 PC	BLANCO-PICTURED CLIFFS	18	31	N	9	W	NM	11	300452289700501	S01	891000569A	A728868	216600	1/1/1979	11/1/1978	11/1/1978		
SAN JUAN 32-9 UT 95A PC	BLANCO-PICTURED CLIFFS	11	31	N	10	W	NM	11	300452487500501	S01	891000569A	A728868	216600	7/16/1981	11/1/1981	11/1/1981		
SAN JUAN 32-9 UT 96 PC	BLANCO-PICTURED CLIFFS	2	31	N	10	W	NM	11	300452290100501	S01	891000569A	A728868	216600	9/13/1978	10/1/1978	10/1/1978		
SAN JUAN 32-9 UT 97 PC	BLANCO-PICTURED CLIFFS	12	31	N	10	W	NM	11	300452290500501	S01	891000569A	A728868	216600	10/1/1978	10/1/1978	10/1/1978		
SAN JUAN 32-9 UT 98J PC	BLANCO-PICTURED CLIFFS	2	31	N	10	W	NM	11	300453110400501	S01	891000569A	A728868	216600	9/13/2002	2/12/2003	2/12/2003		
SAN JUAN 32-9 UT 98 PC	BLANCO-PICTURED CLIFFS	2	31	N	10	W	NM	11	300452344000501	S01	891000569A	A728868	216600	3/1/1980	3/1/1980	3/1/1980		
SAN JUAN 32-9 UT 99 PC	BLANCO-PICTURED CLIFFS	11	31	N	10	W	NM	11	300452327400501	S01	891000569A	A728868	216600	8/2/1979	9/1/1979	9/1/1979		
SAN JUAN 32-9 UT 9A MV	BLANCO-MESAVERDE	25	32	N	10	W	NM	11	300452973600501	S01	8910005690	A728867	216600	10/22/1999	11/1/1999	11/1/1999		
SAN JUAN 32-9 UT 9 MV	BLANCO-MESAVERDE	25	32	N	10	W	NM	11	300451121900501	S01	8910005690	A728867	216600	7/10/1954	9/1/1954	9/1/1954		
SAN JUAN 32-9 UT NP 210 F	BASIN CB: FRUITLAND COAL	2	31	N	10	W	NM	11	300452759800501	S01	NM5-F078509	A722502	216600	4/23/1990	3/9/1992	3/9/1992		
SAN JUAN 32-9 UT NP 2A MV	BLANCO-MESAVERDE	30	32	N	9	W	NM	11	300452955700501	S01	NM5-F078509	A720703	216600	11/14/1998	11/25/1998	11/25/1998		
SAN JUAN 32-9 UT NP 79 MV	BLANCO-MESAVERDE	17	32	N	9	W	NM	11	300451145800501	S01	NM5-F078513	A720703	216600	8/12/1960	2/26/1982	2/26/1982		
SAN JUAN 32-9 UT SWD 5 ME	UNK-MORRISON ENTRADA	18	31	N	9	W	NM	31	30045286300501	S01	NM5-F078438	A068948	216600	10/11/1991	3/6/1992	3/6/1992		

Prod Stat: 11 Flowing Well

21 Pumping Well

41 Shut-in

61 Temp Abandoned
71 Perm Abandoned Well
82 Drilling (Developmental)
PM - Pressure Monitoring

R10W

R9W

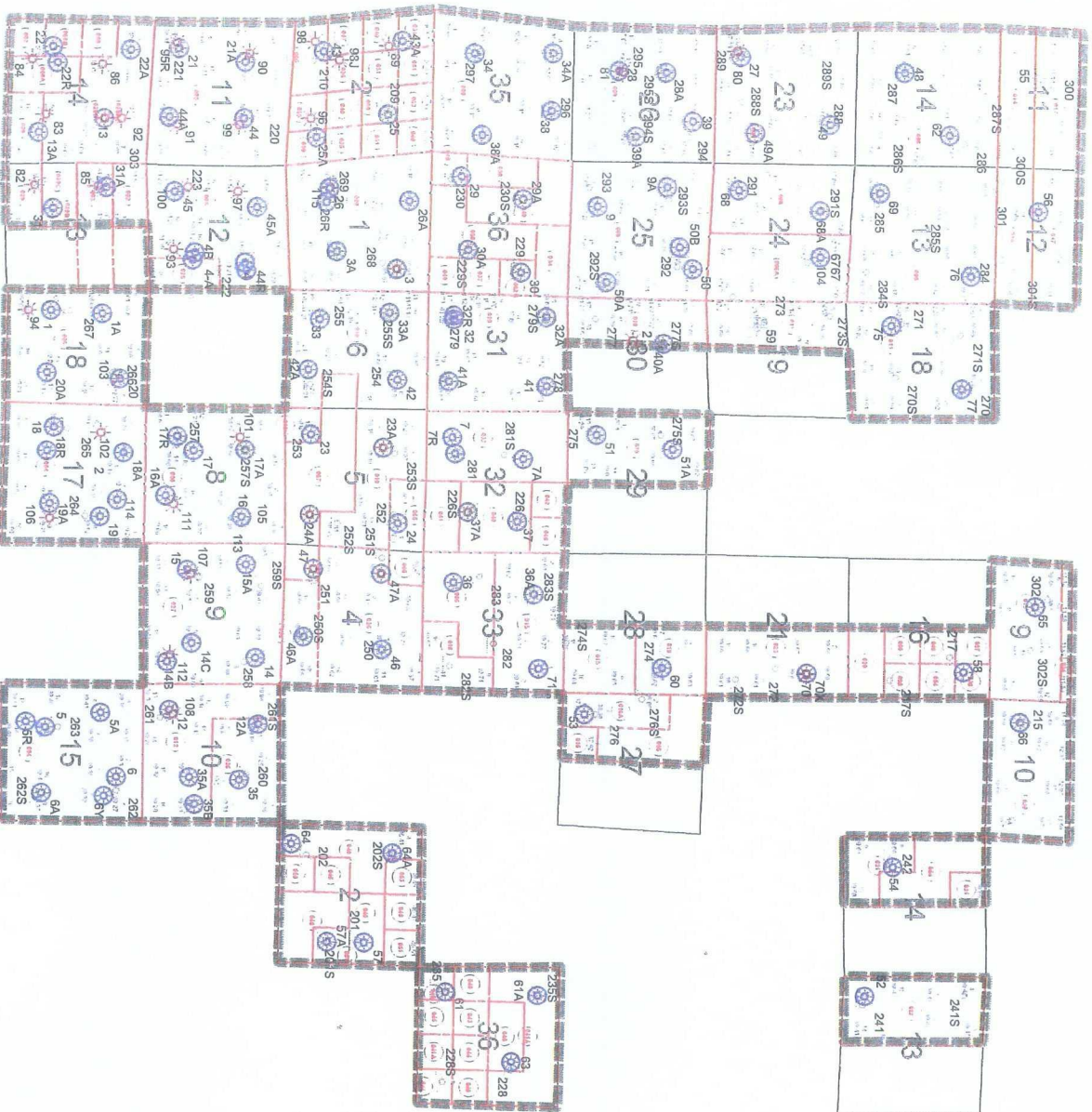

San Juan 32-9 Unit

Well Formation

T 32 N

DAKOTA

FRUITLAND

FRUITLAND COAL

MESAVERDE

PICTURED CLIFFS

SHALLOW

T 31 N

BURLINGTON

RESOURCES

Inventory Management
San Juan Business Unit
Farmington, New Mexico