



February 22, 2010

159
ConocoPhillips
San Juan Business Unit
P.O. Box 4289
Farmington, NM 87499-4289

Bureau of Land Management
Farmington Resource Area
1235 La Plata Highway
Farmington, NM 87401

Commissioner of Public Lands
State of New Mexico
P. O. Box 1148
Santa Fe, NM 87501-1148

Oil Conservation Division
State of New Mexico
1220 S. Saint Francis Drive
Santa Fe, NM 87505

RE: **2010 Plan of Development
Lindrith "B" Unit, I SEC. #713
Rio Arriba County, New Mexico**

Ladies and Gentlemen:

The following Participating Areas currently exist in the Lindrith Unit:

FORMATION	EXPANSION	EFFECTIVE DATE
GALLUP	000	01-JAN-86
DAKOTA	004	01-NOV-84

The 2009 Plan of Development (or amendments thereto) provided for no wells to be drilled during 2009.

Pursuant to Section 9 of the Lindrith Unit Agreement, ConocoPhillips Company, as Unit Operator, hereby submits no wells for the 2010 Plan of Development.

The working interest owners are being furnished a copy of this letter, well status listing and enclosed map. ConocoPhillips, as Unit Operator, will drill any offset wells required to prevent drainage of unitized substances and any other wells deemed necessary by the working interest owners or Unit Operator.

In accordance to Section 10 of the Unit Agreement, please provide your approvals by executing and returning a copy of this letter to the undersigned.

Please contact me at (505) 326-9749 if there are any questions regarding this letter.

Sincerely,

Ben Malone,
Land Supervisor, SE

BM/aer
xc: Lindrith Unit, 3.0 (2010)
Lindrith Unit Working Interest Owners

LINDRITH UNIT
2010 PLAN OF DEVELOPMENT

LINDRITH UNIT
2010 PLAN OF DEVELOPMENT APPROVALS

Bureau of Land Management

Date

New Mexico Oil Conservation Division

Date

New Mexico Commissioner of Public Lands

Date

LINDRITH UNIT
2010 PLAN OF DEVELOPMENT

**WORKING INTEREST OWNER
LINDRITH UNIT**

CONOCOPHILLIPS COMPANY

Well Name	Resv Name	Sec	Twnship	Twnship Dir	Ring	Ring Dir	ST	Prod Stat	Api Well Code	MMS Prod Interval	MMS Lse Agr Number	Lse ID	Oper ID	Compl Dt	Int Prod Dt	1st Sale Dt
LINDRITH B UNIT 103 DK	LINDRITH GALLUP DAKOTA WS	18	24	N	2	W	NM	11	300392572200S01	S01	8920007130	A706737	12001	4/17/1998	1/1/1994	4/1/1998
LINDRITH B UNIT 108 DK	LINDRITH GALLUP DAKOTA WS	15	24	N	3	W	NM	11	300392679100S01	S01	820789130	A706794	12001			
LINDRITH B UNIT 10 DK	LINDRITH GALLUP DAKOTA WS	34	24	N	3	W	NM	41	300392240200S01	S01	820789150	A706422	12001	9/15/1980	1/1/1994	9/15/1980
LINDRITH B UNIT 110 DK	LINDRITH GALLUP DAKOTA WS	15	24	N	3	W	NM	11	300392682000S01	S01	892000713X	A706794	12001		2/25/2002	2/25/2002
LINDRITH B UNIT 113 DK	LINDRITH GALLUP DAKOTA WS	10	24	N	3	W	NM	11	300392676600S01	S01	820789120	A706425	12001	11/20/2001	1/20/2001	1/31/1981
LINDRITH B UNIT 11 DK	LINDRITH GALLUP DAKOTA WS	16	24	N	3	W	NM	11	300392538000S01	S01	892000713A	A706424	12001		1/1/1994	3/12/1981
LINDRITH B UNIT 12 DK	LINDRITH GALLUP DAKOTA WS	22	24	N	3	W	NM	11	3003925000S01	S01	820789130	A706418	12001		1/1/1994	4/3/1981
LINDRITH B UNIT 13 DK	LINDRITH GALLUP DAKOTA WS	27	24	N	3	W	NM	11	300392551000S01	S01	892000713A	A706416	12001		1/1/1994	4/6/1981
LINDRITH B UNIT 14 DK	LINDRITH GALLUP DAKOTA WS	16	24	N	3	W	NM	11	300392254000S01	S01	892000713A	A706416	12001		1/1/1994	2/19/1981
LINDRITH B UNIT 15 DK	LINDRITH GALLUP DAKOTA WS	21	24	N	3	W	NM	11	300392255000S01	S01	892000713A	A706416	12001		1/1/1994	1/22/1981
LINDRITH B UNIT 16 DK	LINDRITH GALLUP DAKOTA WS	21	24	N	3	W	NM	11	300392294900S01	S01	892000713A	A706416	12001		1/1/1994	7/27/1981
LINDRITH B UNIT 17 DK	LINDRITH GALLUP DAKOTA WS	16	24	N	3	W	NM	11	300392271200S01	S01	892000713A	A706416	12001		1/1/1994	6/30/1981
LINDRITH B UNIT 18 DK	LINDRITH GALLUP DAKOTA WS	22	24	N	3	W	NM	11	300392271300S01	S01	892000713A	A706416	12001		1/1/1994	6/1/1981
LINDRITH B UNIT 19 DK	LINDRITH GALLUP DAKOTA WS	27	24	N	3	W	NM	11	300392271500S01	S01	820789140	A706421	12001		1/1/1994	
LINDRITH B UNIT 1 DK	LINDRITH GALLUP DAKOTA WS	28	24	N	3	W	NM	11	300392271700S01	S01	892000713A	A706416	12001		1/1/1994	2/20/1980
LINDRITH B UNIT 20 DK	LINDRITH GALLUP DAKOTA WS	26	24	N	3	W	NM	11	300392271300S01	S01	820789140	A706421	12001		1/1/1994	5/11/1981
LINDRITH B UNIT 21 DK	LINDRITH GALLUP DAKOTA WS	15	24	N	3	W	NM	11	300392271100S01	S01	892000713A	A706416	12001		1/1/1994	10/19/1982
LINDRITH B UNIT 22 DK	LINDRITH GALLUP DAKOTA WS	15	24	N	3	W	NM	11	300392303000S01	S01	892000713A	A706416	12001		1/1/1994	10/5/1982
LINDRITH B UNIT 23 DK	LINDRITH GALLUP DAKOTA WS	16	24	N	3	W	NM	11	300392303700S01	S01	892000713A	A706416	12001		1/1/1994	11/22/1983
LINDRITH B UNIT 25 DK SWD	LINDRITH GALLUP DAKOTA WS	9	24	N	3	W	NM	31	300392347000S01							
LINDRITH B UNIT 26 DK	LINDRITH GALLUP DAKOTA WS	9	24	N	3	W	NM	11	300392346500S01	S01	892000713A	A706416	12001		1/1/1994	10/31/1984
LINDRITH B UNIT 27 DK	LINDRITH GALLUP DAKOTA WS	10	24	N	3	W	NM	41	300392360900S01	S01	820789120	A706425	12001		1/1/1994	1/24/1985
LINDRITH B UNIT 29 DK	LINDRITH GALLUP DAKOTA WS	16	24	N	3	W	NM	11	300392386800S01	S01	892000713A	A706416	12001		1/1/1994	3/21/1986
LINDRITH B UNIT 2 DK	LINDRITH GALLUP DAKOTA WS	28	24	N	3	W	NM	11	300392213800S01	S01	892000713A	A706416	12001		1/1/1994	3/7/1980
LINDRITH B UNIT 30 DK	LINDRITH GALLUP DAKOTA WS	16	24	N	3	W	NM	11	300392385900S01	S01	892000713A	A706416	12001		1/1/1994	4/1/1986
LINDRITH B UNIT 31 DK	LINDRITH GALLUP DAKOTA WS	21	24	N	3	W	NM	41	300392396800S01	S01	892000713A	A706416	12001		1/1/1994	4/21/1986
LINDRITH B UNIT 32 DK	LINDRITH GALLUP DAKOTA WS	21	24	N	3	W	NM	11	300392392400S01	S01	892000713A	A706416	12001		1/1/1994	3/5/1986
LINDRITH B UNIT 34 GM	GAVILAN:MANCOS	32	25	N	2	W	NM	11	300392373600S01	S01	892000713B	A706428	12001		1/1/1994	6/30/1986
LINDRITH B UNIT 35 GM	LINDRITH GALLUP DAKOTA WS	9	24	N	3	W	NM	41	300392375500S01	S01	892000713B	A706423	12001	12/12/1985	1/1/1994	12/12/1985
LINDRITH B UNIT 37 GM	GAVILAN:MANCOS	4	24	N	2	W	NM	11	300392381600S01	S01	892000713A	A706416	12001		1/1/1994	9/30/1986
LINDRITH B UNIT 40 DK	LINDRITH GALLUP DAKOTA WS	15	24	N	3	W	NM	11	300392379700S01	S01	892000713A	A706416	12001		1/1/1994	3/13/1986
LINDRITH B UNIT 41 DK	LINDRITH GALLUP DAKOTA WS	16	24	N	3	W	NM	11	300392384000S01	S01	892000713A	A706416	12001		1/1/1994	2/24/1986
LINDRITH B UNIT 42 DK	LINDRITH GALLUP DAKOTA WS	15	24	N	3	W	NM	11	300392377800S01	S01	892000713A	A706416	12001		1/1/1994	12/22/1985
LINDRITH B UNIT 44 DK	LINDRITH GALLUP DAKOTA WS	21	24	N	3	W	NM	11	300392386600S01	S01	892000713A	A706416	12001		1/1/1994	4/5/1986
LINDRITH B UNIT 45 DK	LINDRITH GALLUP DAKOTA WS	28	24	N	3	W	NM	11	300392387200S01	S01	892000713A	A706416	12001		1/1/1994	5/21/1986
LINDRITH B UNIT 46 DK	LINDRITH GALLUP DAKOTA WS	28	24	N	3	W	NM	11	300392386100S01	S01	892000713A	A706416	12001	5/15/1986	5/15/1986	
LINDRITH B UNIT 5 DK	LINDRITH GALLUP DAKOTA WS	21	24	N	3	W	NM	11	300392284400S01	S01	892000713A	A706416	12001		1/1/1994	9/4/1980
LINDRITH B UNIT 6 DK	LINDRITH GALLUP DAKOTA WS	28	24	N	3	W	NM	11	300392284200S01	S01	820789140	A706421	12001		1/1/1994	10/5/1980
LINDRITH B UNIT 73 GM	GAVILAN:MANCOS	6	24	N	2	W	NM	41	300392408900S01	S01	820789070	A706417	12001		1/1/1994	3/31/1987
LINDRITH B UNIT 78 DK	LINDRITH GALLUP DAKOTA WS	6	24	N	2	W	NM	41	300392506600S01	S01	820789070	A706426	12001		1/1/1994	8/1/1991
LINDRITH B UNIT 79 DK	LINDRITH GALLUP DAKOTA WS	7	24	N	2	W	NM	41	300392510500S01	S01	820789080	A706427	12001		1/1/1994	1/6/1992
LINDRITH B UNIT 7 DK	LINDRITH GALLUP DAKOTA WS	28	24	N	3	W	NM	11	300392245000S01	S01	892000713A	A706416	12001		1/1/1994	12/9/1980
LINDRITH B UNIT 8 DK	LINDRITH GALLUP DAKOTA WS	8	24	N	2	W	NM	11	300392515400S01	S01	820789080	A706419	12001		1/1/1994	4/3/1992
LINDRITH B UNIT 8 DK	LINDRITH GALLUP DAKOTA WS	27	24	N	3	W	NM	41	300392242000S01	S01	892000713A	A706416	12001		1/1/1994	11/5/1980
LINDRITH B UNIT 9 DK	LINDRITH GALLUP DAKOTA WS	27	24	N	3	W	NM	11	300392242300S01	S01	820789140	A706421	12001	1/1/1994	1/1/1994	11/4/1980

Lindrith Unit

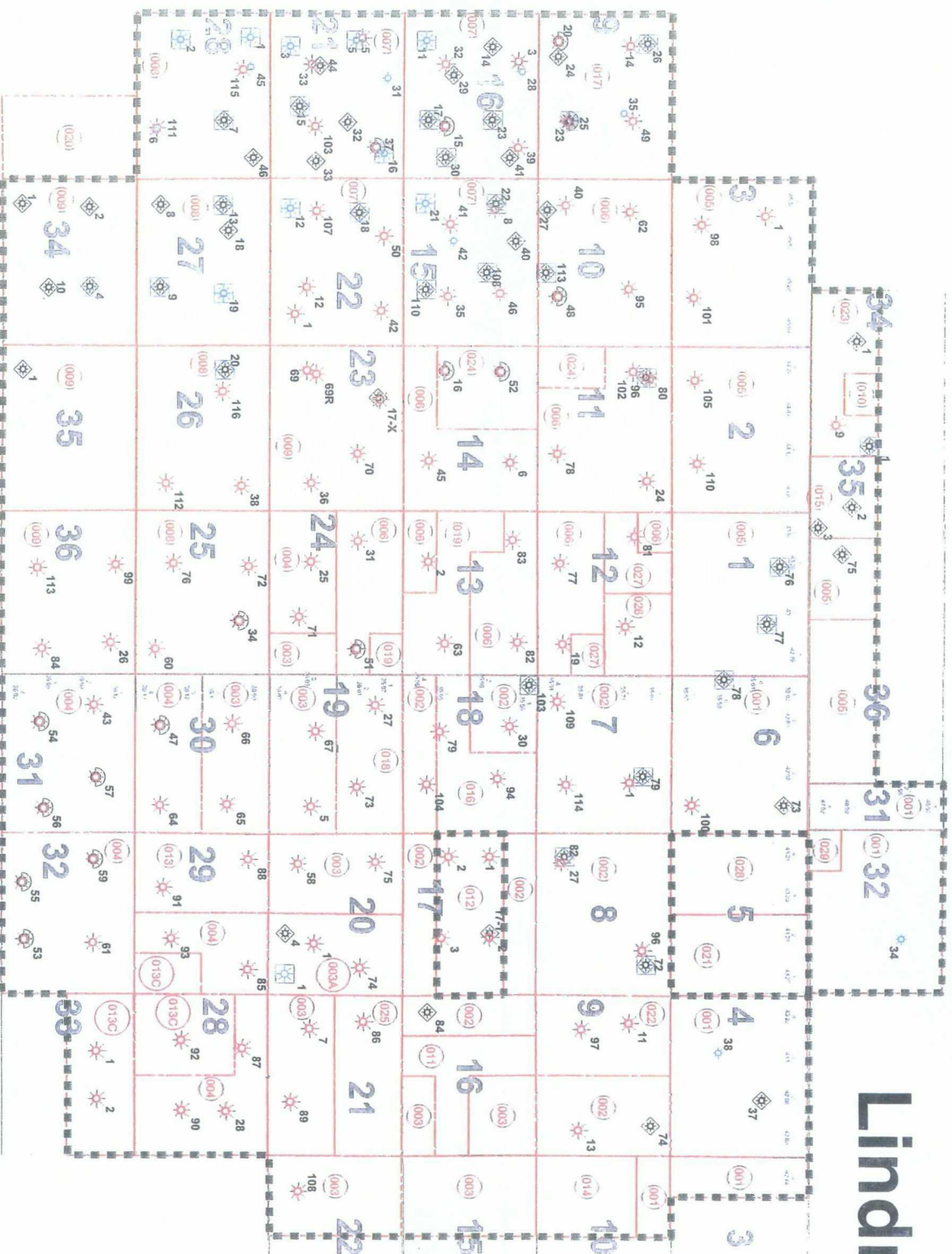

Well Formation

- ★ PICTURED CLIFFS
- ◆ CHACRA
- ◆ MANCOS
- ◆ GALLUP /SD/ SH/
- ◆ DAKOTA

ConocoPhillips

Inventory Management
San Juan Business Unit
Farmington, New Mexico