



RECEIVED

2010 MAR 16 5 23 PM

ConocoPhillips
San Juan Business Unit
P.O. Box 4289
Farmington, NM 87499-4289

Bureau of Land Management (3)
Attn: Mr. Wayne Townsend
1235 La Plata Highway
Farmington, NM 87401

State of New Mexico (2)
Commissioner of Public Lands
Attn: Mr. Pete Martinez
P.O. Box 1148
Santa Fe, NM 87501-1148

419

State of New Mexico (2)
Oil Conservation Division
Energy & Minerals Department
Attn: Ms. Lori Wrotenbery
1220 S. Saint Francis Drive
Santa Fe, NM 87505-4000

RE: **SAN JUAN 29-6 UNIT, - UA -14-08-001-439**
Rio Arriba County, New Mexico
Dakota Participating Area
REVISED 13th EXPANSION, Effective 5/1/2004
14th EXPANSION, Effective 5/1/2005

Dear Sir or Madam:

Pursuant to Section 11(a) of the above referenced Unit Agreement, approved September 8, 1952, **CONOCOPHILLIPS**, as **Unit Operator**, has determined that the following wells are capable of producing unitized substances in paying quantities from the Dakota formation, thereby should be admitted to the Dakota Participating Area. Pursuant to BLM letters, attached are the wells that have been deemed commercial.

The Schedules for the Revised Twelfth and Thirteenth Expansions were approved by the BLM April 11, 2008. Since that approval, it has come to light that the SJ 29-6 Unit #109 was never submitted for commerciality. It has since been deemed commercial; therefore, revised schedules are being submitted. We are sorry for any confusion this may cause.

REVISED THIRTEENTH EXPANSION - EFFECTIVE 5/1/2004

<u>Well Name</u>	<u>Tract/Acres</u>	<u>Tr. Description</u>	<u>Compl. Date</u>
San Juan 29-6 Unit #109	Tr.17F / 240.00	SW/4, E/2NW/4	4/26/04
Section 32, T29N, R06W	Tr. 17G / 80.00	W/2NW/4	

FOURTEENTH EXPANSION - EFFECTIVE 5/1/2005

<u>Well Name</u>	<u>Tract/Acres</u>	<u>Tr. Description</u>	<u>Compl. Date</u>
San Juan 29-6 Unit #33M	Tr.2A / 232.16	Lots 1-4, W/2E/2	4/20/05
Section 13, T29N, R06W			

The Schedules for the Revised Thirteenth and Fourteenth Expansions are enclosed. The schedules describe the Participating Area and show the percentage of unitized substances allocated to the tracts according to the ConocoPhillips would appreciate consideration of these Expansions by written response.

Please contact the undersigned at (505) 599-4030 if there are any questions regarding this matter. Copies of this letter and attachments are being furnished to the working interest owners on the attached list.

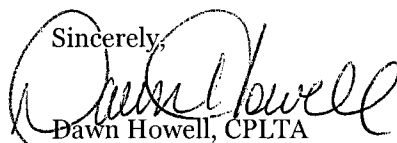
Sincerely,

Dawn Howell, CPLTA
Land Analyst



United States Department of the Interior

BUREAU OF LAND MANAGEMENT

Farmington Field Office
1235 La Plata Highway - Suite A
Farmington, New Mexico 87401
www.blm.gov/nm



IN REPLY REFER TO:

San Juan 29-6 Unit DK PA
3162.7 (F0111)

February 10, 2010

Ms. Dawn Howell
ConocoPhillips Company
P.O. Box 4289
Farmington, NM 87499-4289

RE: San Juan 29-6 Unit
Commerciality Determination
Dakota Formation
Rio Arriba County, NM

Dear Ms. Howell:

In response to your letter dated February 3, 2010, the Farmington Field Office has reviewed the data you submitted for a commerciality determination for the following well completed in the Dakota formation.

Well Name & Number	Dedication	Lease	Completion Date	Determination
San Juan 29-6 Unit #109	W/2 Sec. 32, T29N, R6W	STATE	4/26/2004	Commercial

After completing our economic evaluation, we are in concurrence with the above determination.

The well was determined to be commercial in the Dakota formation and is to be included in the Dakota participating area. It is required that a revision be submitted to include this well in the San Juan 29-6 Unit Dakota Participating Area.

Under provisions of 43 CFR 3165.3, you may request an Administrative Review of the order(s) described above. Such request, including all supporting documents, must be filed in writing within 20 business days of receipt of this notice and must be filed with the State Director, Bureau of Land Management (NM-92000), P. O. Box 27115, Santa Fe, New Mexico 87502-0115. Such requests shall not result in a suspension of the order(s) unless the reviewing official so determines. Procedures governing appeals from instructions, orders or decisions are contained in 43 CFR 3165.4 and 43 CFR 4.400 et seq.

If you have any questions concerning this matter, please contact Wayne Townsend at the above address or telephone (505) 599-6359.

Sincerely,

Wayne Townsend
Petroleum Engineer
Branch of Petroleum Management



United States Department of the Interior

BUREAU OF LAND MANAGEMENT

Farmington Field Office
1235 La Plata Highway, Suite A
Farmington, New Mexico 87401

IN REPLY REFER TO:
San Juan 29-6 Unit Dakota PA
3162.7 (21110)

September 20, 2007

Ms. Dawn Howell
ConocoPhillips Company
P.O. Box 4289
Farmington, NM 87499-4289

RE: San Juan 29-6 Unit
Commerciality Determinations
Dakota Formation
Rio Arriba County, NM

Dear Ms. Howell:

In response to your letter dated September 10, 2007, the Farmington Field Office has reviewed the data you submitted for a commerciality determination for the following wells completed in the Dakota formation.

Well Name & Number	Dedication	Lease	Completion Date	Determination
San Juan 29-6 Unit #8B	W/2 Sec. 1, T29N, R6W	NMNM012698	10/13/1999	Non-Commercial
San Juan 29-6 Unit #22M	E/2 Sec. 12, T29N, R6W	NMNM012698	1/16/2004	Commercial
San Juan 29-6 Unit #29B	W/2 Sec. 3, T29N, R6W	FEE	10/13/1999	Non-Commercial
San Juan 29-6 Unit #33M	E/2 Sec. 13, T29N, R6W	NMSF078278	4/20/2005	Commercial

After completing our economic evaluations, we are in concurrence with the above determinations.

The wells that were determined to be commercial in the Dakota formation are to be included in the Dakota participating area. It is required that revisions be submitted to include these wells in the San Juan 29-6 Unit Dakota Participating Area. The wells that were determined to be non-commercial are to report their production to the lease number or communitization agreement number.

Under provisions of 43 CFR 3165.3, you may request an Administrative Review of the order(s) described above. Such request, including all supporting documents, must be filed in writing within 20 business days of receipt of this notice and must be filed with the State Director, Bureau of Land Management (NM-92000), P. O. Box 27115, Santa Fe, New Mexico 87502-0115. Such requests shall not result in a suspension of the order(s) unless the reviewing official so determines. Procedures governing appeals from instructions, orders or decisions are contained in 43 CFR 3165.4 and 43 CFR 4.400 et seq.

If you have any questions concerning this matter, please contact Wayne Townsend at the above address or telephone (505) 599-6359.

Sincerely,

Wayne Townsend
Petroleum Engineer
Branch of Petroleum Management

**SAN JUAN 29-6 UNIT
DAKOTA FORMATION
WORKING INTEREST OWNERS**

Betty T. Johnston Marital Trust

Burlington Resources Oil & Gas Co, LP

Charles W. Gay

ConocoPhillips Company

Eula May Johnston Trust

J&M Raymond LTD

Lorrayn Gay Hacker

TAMACAM

McElvain Oil Company

Pintail Production Co, Inc.

Sable Energy, Ltd.

T.H. McElvain Oil & Gas Limited

V A Johnston Family Trust

Vaughan-McElvain Energy Inc.

Veva Jean Gibbard

CONOCOPHILLIPS COMPANY - OPERATOR

Thirteenth Expanded Participating Area for the Dakota Formation

San Juan 29-6 Unit Area, Effective 5/01/2004

Serial Number	Description	Number of Acres	Drilling Block Ownership	Percentage	Percentage Committed	Present Actual Participation
NM 012698	<u>T-29-N, R-6-W</u>	950.34	Royalty:	0.000000 %	12.500000 %	<u>8.757982 %</u>
	Section 11: E/2, SW/4, E/2NW/4, SW/4NW/4		ORRI:	0.000000 %	7.500000 %	
	Lot 1		Working Interest:	50.000000 %	40.000000 %	
	Section 12: N/2, W/2NW/4 SE/4NW/4, SW/4		Burlington Resources Oil & Gas Company	50.000000 %	40.000000 %	
			ConocoPhillips Company	<u>100.000000 %</u>	<u>100.000000 %</u>	
Tract 1						
NM 012698	<u>T-29-N, R-6-W</u>	229.85	Royalty:	0.000000 %	12.500000 %	<u>2.118213 %</u>
	Section 12: Lot 1, 3-6 W/2SE/4		ORRI:	0.000000 %	4.000000 %	
	82.43 acres in Tr. 37		Working Interest:	100.000000 %	83.500000 %	
	All Tract 43 in Sec. 12		ConocoPhillips Company	<u>100.000000 %</u>	<u>100.000000 %</u>	
Tract 1A						
SF 078278	<u>T-29-N, R-6-W</u>	955.87	Royalty:	0.000000 %	12.500000 %	<u>8.808943 %</u>
	Section 13: W/2 SE/4, W/2		ORRI:	0.000000 %	7.500000 %	
	Section 10: Lots 1,2,3,4		Working Interest:	50.000000 %	40.000000 %	
	Section 15: N/2 NW/4		Burlington Resources Oil & Gas Company	50.000000 %	40.000000 %	
			ConocoPhillips Company	<u>100.000000 %</u>	<u>100.000000 %</u>	
Tract 2						
SF 078278	<u>T-29-N, R-6-W</u>	80.00	Royalty:	0.000000 %	12.500000 %	<u>0.737250 %</u>
	Section 15: N/2 SE/4		ORRI:	0.000000 %	4.000000 %	
			Working Interest:	100.000000 %	83.500000 %	
			Burlington Resources Oil & Gas Company	<u>100.000000 %</u>	<u>100.000000 %</u>	
Tract 2A						
SF 078278	<u>T-29-N, R-6-W</u>	40.00	Royalty:	0.000000 %	12.500000 %	<u>0.368625 %</u>
	Section 15: SE/4 SE/4		ORRI:	0.000000 %	5.000000 %	
			Working Interest:	100.000000 %	82.500000 %	
			Burlington Resources Oil & Gas Company	<u>100.000000 %</u>	<u>100.000000 %</u>	
Tract 2B						

CONOCOPHILLIPS COMPANY - OPERATOR
Thirteenth Expanded Participating Area for the Dakota Formation
San Juan 29-6 Unit Area, Effective 5/01/2004

Serial Number	Description	Number of Acres	Drilling Block Ownership	Percentage	Percentage Committed	Present Actual Participation
Tract 2C						
SF 078278	T-29-N, R-6-W Section 14: All	640.00	Royalty: ORRI: Working Interest: Burlington Resources Oil & Gas Company ConocoPhillips Company Total	0.000000 % 0.000000 % 50.000000 % 50.000000 % 100.000000 %	12.500000 % 8.500000 % 39.500000 % 39.500000 % 100.000000 %	5.898003 %
Tract 2D						
SF 078278	T-29-N, R-6-W Section 15: NE/4	160.00	Royalty: ORRI: Working Interest: Burlington Resources Oil & Gas Company ConocoPhillips Company Total	0.000000 % 0.000000 % 50.000000 % 50.000000 % 100.000000 %	12.500000 % 8.000000 % 39.750000 % 39.750000 % 100.000000 %	1.474501 %
Tract 3						
SF 078284	T-29-N, R-6-W Section 24: Lots 1-4, W/2E/2	233.24	Royalty: ORRI: Working Interest: Burlington Resources Oil & Gas Company ConocoPhillips Company Total	0.000000 % 0.000000 % 50.000000 % 50.000000 % 100.000000 %	12.500000 % 7.500000 % 40.000000 % 40.000000 % 100.000000 %	2.149454 %
Tract 3A						
SF 078284	T-29-N, R-6-W Section 23: All Section 24: W/2 Section 26: W/2 NE/2 Total	1,040.00	Royalty: ORRI: Working Interest: Burlington Resources Oil & Gas Company ConocoPhillips Company Total	0.000000 % 0.000000 % 50.000000 % 50.000000 % 100.000000 %	12.500000 % 8.000000 % 39.750000 % 39.750000 % 100.000000 %	9.584255 %

CONOCOPHILLIPS COMPANY - OPERATOR

**Thirteenth Expanded Participating Area for the Dakota Formation
San Juan 29-6 Unit Area, Effective 5/01/2004**

891000439A

Serial Number	Description	Number of Acres	Drilling Block Ownership	Percentage	Percentage Committed	Present Actual Participation
Tract 4						
NM 012670	T-29-N, R-6-W Section 35: N/2 S/2, S/2 N/2	320.00	Royalty: ORRI: Working Interest: Burlington Resources Oil & Gas Company	0.000000 % 0.000000 % 100.000000 % <u>100.000000 %</u>	12.500000 % 5.000000 % 82.500000 % <u>100.000000 %</u>	2.949002 %
Tract 5						
SF 078960	T-29-N, R-6-W Section 35: S/2 S/2	160.00	Royalty: ORRI: Working Interest: Burlington Resources Oil & Gas Company ConocoPhillips Company	0.000000 % 0.000000 % 50.000000 % 50.000000 % <u>100.000000 %</u>	12.500000 % 7.500000 % 40.000000 % 40.000000 % <u>100.000000 %</u>	1.474501 %
Tract 7						
NM 012671	T-29-N, R-6-W Section 25: W/2 Section 26: E/2 E/2	480.00	Royalty: ORRI: Working Interest: Burlington Resources Oil & Gas Company ConocoPhillips Company	0.000000 % 0.000000 % 50.000000 % 50.000000 % <u>100.000000 %</u>	12.500000 % 8.000000 % 39.750000 % 39.750000 % <u>100.000000 %</u>	4.423502 %
Tract 7A						
NM 012671	T-29-N, R-6-W Section 25: Lots 1,2,3,4 W/2 E/2	233.88	Royalty: ORRI: Working Interest: Burlington Resources Oil & Gas Company ConocoPhillips Company	0.000000 % 0.000000 % 50.000000 % 50.000000 % <u>100.000000 %</u>	12.500000 % 7.500000 % 40.000000 % 40.000000 % <u>100.000000 %</u>	2.155352 %

CONOCOPHILLIPS COMPANY - OPERATOR
Thirteenth Expanded Participating Area for the Dakota Formation
San Juan 29-6 Unit Area, Effective 5/01/2004

Serial Number	Description	Number of Acres	Drilling Block Ownership	Percentage	Percentage Committed	Present Actual Participation
Tract 8						
SF 080146	T-29-N, R-6-W Section 34: All	640.00	Royalty: ORRI: Working Interest: Burlington Resources Oil & Gas Company Betty T. Johnston Marital Trust Eula May Johnston Trust Pintail Production Co., Inc. V.A. Johnston Family Trust Veva Jean Gibbard Total	0.000000 % 0.000000 % 75.000000 % 4.166670 % 8.333335 % 8.333334 % 2.083331 % 2.083330 % 100.000000 %	12.500000 % 2.500000 % 63.750011 % 3.541672 % 7.083326 % 7.083336 % 1.770827 % 1.770827 % 100.000000 %	5.898003 %
Tract 9						
SF 080180	T-29-N, R-6-W Section 9: E/2 SE/4 Section 22: W/2 E/2, E/2 SE/4	320.00	Royalty: ORRI: Working Interest: Burlington Resources Oil & Gas Company ConocoPhillips Company Total	0.000000 % 0.000000 % 50.000000 % 50.000000 % 100.000000 %	12.500000 % 8.500000 % 39.500000 % 39.500000 % 100.000000 %	2.949002 %
Tract 10						
SF 080377	T-29-N, R-6-W Section 15: S/2 SW/4, SW/4 SE/4	120.00	Royalty: ORRI: Working Interest: Burlington Resources Oil & Gas Company Total	0.000000 % 0.000000 % 100.000000 % 100.000000 %	12.500000 % 5.000000 % 82.500000 % 100.000000 %	1.105876 %
Tract 10A						
SF 080377	T-29-N, R-6-W Section 9: W/2 SE/4 Section 22: W/2 Section 26: W/2 NW/4 Section 27: E/2 NE/4 Total	560.00	Royalty: ORRI: Working Interest: Burlington Resources Oil & Gas Company ConocoPhillips Company Total	0.000000 % 0.000000 % 50.000000 % 50.000000 % 100.000000 %	12.500000 % 8.500000 % 39.500000 % 39.500000 % 100.000000 %	5.160753 %

CONOCOPHILLIPS COMPANY - OPERATOR
Thirteenth Expanded Participating Area for the Dakota Formation
San Juan 29-6 Unit Area, Effective 5/01/2004

Serial Number	Description	Number of Acres	Drilling Block Ownership	Percentage	Percentage Committed	Present Actual Participation
SF 080379-A						
	T-29-N, R-6-W Section 21: E/2	320.00	Royalty: ORRI: Working Interest: Burlington Resources Oil & Gas Company ConocoPhillips Company <u>Total</u>	0.000000 % 0.000000 % 50.000000 % 50.000000 % <u>100.000000 %</u>	12.500000 % 8.500000 % 39.500000 % 39.500000 % <u>100.000000 %</u>	2.949002 %
Tract 11						
SF 080596						
	T-29-N, R-6-W Section 33: SE/4	160.00	Royalty: ORRI: Working Interest: Burlington Resources Oil & Gas Company ConocoPhillips Company <u>Total</u>	0.000000 % 0.000000 % 50.000000 % 50.000000 % <u>100.000000 %</u>	12.500000 % 8.500000 % 39.500000 % 39.500000 % <u>100.000000 %</u>	1.474501 %
Tract 12						
NM 03040-A						
	T-29-N, R-6-W Section 27: W/2	320.00	Royalty: ORRI: Working Interest: Burlington Resources Oil & Gas Company ConocoPhillips Company <u>Total</u>	0.000000 % 0.000000 % 50.000000 % 50.000000 % <u>100.000000 %</u>	12.500000 % 8.500000 % 39.500000 % 39.500000 % <u>100.000000 %</u>	2.949002 %
Tract 14-A						
NM 03471-A						
	T-29-N, R-6-W Section 33: NE/4	160.00	Royalty: ORRI: Working Interest: Burlington Resources Oil & Gas Company ConocoPhillips Company <u>Total</u>	0.000000 % 0.000000 % 50.000000 % 50.000000 % <u>100.000000 %</u>	12.500000 % 8.500000 % 39.500000 % 39.500000 % <u>100.000000 %</u>	1.474501 %
Tract 15						
NM 03471						
	T-29-N, R-6-W Section 27: W/2 E/2	160.00	Royalty: ORRI: Working Interest: Burlington Resources Oil & Gas Company ConocoPhillips Company <u>Total</u>	0.000000 % 0.000000 % 50.000000 % 50.000000 % <u>100.000000 %</u>	12.500000 % 8.500000 % 39.500000 % 39.500000 % <u>100.000000 %</u>	1.474501 %
Tract 15-A						

CONOCOPHILLIPS COMPANY - OPERATOR

**Thirteenth Expanded Participating Area for the Dakota Formation
San Juan 29-6 Unit Area, Effective 5/01/2004**

891000439A

Serial Number	Description	Number of Acres	Drilling Block Ownership	Percentage	Percentage Committed	Present Actual Participation
---------------	-------------	-----------------	--------------------------	------------	----------------------	------------------------------

NM 03471	T-29-N, R-6-W Section 28: SE/4	160.00	Royalty:	0.000000 %	12.500000 %	<u>1.474501 %</u>
			ORRI:	0.000000 %	5.000000 %	
			Working Interest:	100.000000 %	82.500000 %	
			<i>Burlington Resources Oil & Gas Company</i>	<u>100.000000 %</u>	<u>100.000000 %</u>	
<i>Total</i>						

NM 03471	T-29-N, R-6-W Section 35: NW/4 NW/4	40.00	Royalty:	0.000000 %	12.500000 %	<u>0.368625 %</u>
			ORRI:	0.000000 %	8.500000 %	
			Working Interest:	50.000000 %	39.500000 %	
			<i>Burlington Resources Oil & Gas Company</i>	<u>50.000000 %</u>	<u>39.500000 %</u>	
<i>Total</i>						

NM 05220	T-29-N, R-6-W Section 15: N/2 SW/4	80.00	Royalty:	0.000000 %	12.500000 %	<u>0.737250 %</u>
			ORRI:	0.000000 %	5.000000 %	
			Working Interest:	100.000000 %	82.500000 %	
			<i>Burlington Resources Oil & Gas Company</i>	<u>100.000000 %</u>	<u>100.000000 %</u>	
<i>Total</i>						

NM 05220	T-29-N, R-6-W Section 15: S/2 NW/4 Section 22: E/2 NE/4 Section 26: E/2 NW/4	240.00	Royalty:	0.000000 %	12.500000 %	<u>2.211751 %</u>
			ORRI:	0.000000 %	8.500000 %	
			Working Interest:	50.000000 %	39.500000 %	
			<i>Burlington Resources Oil & Gas Company</i>	<u>50.000000 %</u>	<u>39.500000 %</u>	
<i>Total</i>						

E-289-3	T-29-N, R-6-W Section 36: W/2	320.00	Royalty:	0.000000 %	12.500000 %	<u>2.949002 %</u>
			Working Interest:	100.000000 %	87.500000 %	
			<i>ConocoPhillips Company</i>	<u>100.000000 %</u>	<u>100.000000 %</u>	
			<i>Total</i>			

CONOCOPHILLIPS COMPANY - OPERATOR
Thirteenth Expanded Participating Area for the Dakota Formation
San Juan 29-6 Unit Area, Effective 5/01/2004

Serial Number	Description	Number of Acres	Drilling Block Ownership	Percentage	Percentage Committed	Present Actual Participation
Tract 17-B						
E-289-30	T-29-N, R-6-W Section 16: N/2, SW/4, NW/4 SE/4	520.00	Royalty: ORRI: Working Interest: Burlington Resources Oil & Gas Company ConocoPhillips Company <i>Total</i>	0.000000 % 0.000000 % 50.000000 % 50.000000 % <u>100.000000 %</u>	12.500000 % 8.500000 % 39.500000 % 39.500000 % <u>100.000000 %</u>	4.792128 %
Tract 17-C						
E-289-36	T-29-N, R-6-W Section 36: Lots 1,2,3,4	74.16	Royalty: ORRI: Working Interest: Burlington Resources Oil & Gas Company ConocoPhillips Company <i>Total</i>	0.000000 % 0.000000 % 50.000000 % 50.000000 % <u>100.000000 %</u>	12.500000 % 8.500000 % 39.500000 % 39.500000 % <u>100.000000 %</u>	0.683431 %
Tract 17-D						
E-289-31	T-29-N, R-6-W Section 36: W/2 E/2	160.00	Royalty: ORRI: Working Interest: Burlington Resources Oil & Gas Company ConocoPhillips Company <i>Total</i>	0.000000 % 0.000000 % 50.000000 % 50.000000 % <u>100.000000 %</u>	12.500000 % 8.500000 % 39.500000 % 39.500000 % <u>100.000000 %</u>	1.474501 %
Tract 17-E						
E-289-33	T-29-N, R-6-W Section 16: S/2 SE/4	80.00	Royalty: ORRI: Working Interest: Burlington Resources Oil & Gas Company ConocoPhillips Company <i>Total</i>	0.000000 % 0.000000 % 50.000000 % 50.000000 % <u>100.000000 %</u>	12.500000 % 8.500000 % 39.500000 % 39.500000 % <u>100.000000 %</u>	0.737250 %
Tract 17-F						
E-289-	T-29-N, R-6-W Section 32: E/2NW/4, SW/4	240.00	Royalty: ORRI: Working Interest: ConocoPhillips Company	0.000000 % 0.000000 % 100.000000 %	12.500000 % 0.000000 % 87.500000 %	2.211751 %

CONOCOPHILLIPS COMPANY - OPERATOR

Thirteenth Expanded Participating Area for the Dakota Formation San Juan 29-6 Unit Area, Effective 5/01/2004

Serial Number	Description	Number of Acres	Drilling Block Ownership	Percentage	Percentage Committed	Present Actual Participation
---------------	-------------	-----------------	-----------------------------	------------	----------------------	------------------------------

E-289-50	T-29-N, R-6-W Section 32: W/2NW/4	80.00				
			Tract 17-G			<u>0.737250 %</u>
			Royalty:	0.000000 %	12.500000 %	
			ORRI:	0.000000 %	5.000000 %	
			Working Interest:			
			ConocoPhillips Company	100.000000 %	82.500000 %	
			Total	<u>100.000000 %</u>	<u>100.000000 %</u>	

E 4083-2	T-29-N, R-6-W Section 16: NE/4 SE/4	40.00				
			Tract 18			<u>0.368625 %</u>
			Royalty:	0.000000 %	12.500000 %	
			Working Interest:			
			McElvain Oil Company	16.666666 %	14.583328 %	
			Charles W. Gay	1.041667 %	0.911461 %	
			J&M Raymond Ltd.	20.833333 %	18.229164 %	
			TAMACAM LLC	2.083334 %	1.822923 %	
			Lorrain Gay Hacker	1.041667 %	0.911461 %	
			T. H. McElvain Oil & Gas Ltd. Partnership	25.000000 %	21.875000 %	
			Vaughan-McElvain Energy Inc.	33.333333 %	29.1666375 %	
			Total	<u>100.000000 %</u>	<u>100.000000 %</u>	

Fee	T-29-N, R-6-W Section 10: That portion of Tract #42 in NE/4 Section 11: That portion of Tract #42 in NW/4	93.79				
			Tract 20			<u>0.864334 %</u>
			Royalty:	0.000000 %	12.500000 %	
			ORRI:	0.000000 %	7.500000 %	
			Working Interest:			
			Burlington Resources Oil & Gas Company	50.000000 %	40.000000 %	
			ConocoPhillips Company	50.000000 %	40.000000 %	
			Total	<u>100.000000 %</u>	<u>100.000000 %</u>	

Fee	T-29-N, R-6-W Section 26: W/2 SE/4	80.00				
			Tract 21			<u>0.737250 %</u>
			Royalty:	0.000000 %	12.500000 %	
			ORRI:	0.000000 %	7.500000 %	
			Working Interest:			
			Burlington Resources Oil & Gas Company	50.000000 %	40.000000 %	
			ConocoPhillips Company	50.000000 %	40.000000 %	

CONOCOPHILLIPS COMPANY - OPERATOR
Thirteenth Expanded Participating Area for the Dakota Formation
San Juan 29-6 Unit Area, Effective 5/01/2004

Serial Number	Description	Number of Acres	Drilling Block Ownership	Percentage	Percentage Committed	Present Actual Participation
Total				100.000000 %	100.000000 %	

<u>Tract 24</u>						
Fee	T-29-N, R-6-W Section 26: E/2 SW/4	80.00	Royalty: Working Interest: Burlington Resources Oil & Gas Company Sable Energy, Ltd.	0.000000 %	12.500000 %	0.737250 %
				75.000000 %	65.625000 %	
				25.000000 %	21.875000 %	
			Total	<u>100.000000 %</u>	<u>100.000000 %</u>	

<u>Tract 24-A</u>						
Fee	T-29-N, R-6-W Section 35: N/2 NE/4, NE/4 NW/4	120.00	Royalty: Working Interest: Burlington Resources Oil & Gas Company Sable Energy, Ltd.	0.000000 %	12.500000 %	1.105876 %
				75.000000 %	65.625000 %	
				25.000000 %	21.875000 %	
			Total	<u>100.000000 %</u>	<u>100.000000 %</u>	

<u>Tract 28</u>						
Fee	T-29-N, R-6-W Section 26: W/2 SW/4 E/2 SE/4	160.00	Royalty: ORRI: Working Interest: Burlington Resources Oil & Gas Company ConocoPhillips Company	0.000000 %	12.500000 %	1.474501 %
				0.000000 %	3.500000 %	
				50.000000 %	42.000000 %	
				50.000000 %	42.000000 %	
			Total	<u>100.000000 %</u>	<u>100.000000 %</u>	

CONOCOPHILLIPS COMPANY - OPERATOR
 RECAPITULATION
 THE 013 EXPANDED PARTICIPATING AREA FOR DAKOTA FORMATION
 SAN JUAN 29-6 UNIT AREA

Description of Committed Lands in PA				Description of Non-Committed Lands in PA							
Township	Range	Section	Description	Lot	Acreage	Township	Range	Section	Description	Lot	Acreage
026N	006W	SEC.011	E/2, SW/4, E/2 NW/4, SW/4 NW/4								
026N	006W	SEC.012	N/2, W/2 NW/4, SE/4 NW/4, SW/4	LOT.2	15.47000						
026N	006W	SEC.012									
029N	006W	SEC.009	E/2 SE/4								
029N	006W	SEC.009	W/2 SE/4								
029N	006W	SEC.010	N/2								
029N	006W	SEC.010	SE/4, W/2								
029N	006W	SEC.010		LOT.1	8.41000						
029N	006W	SEC.010		LOT.2	14.30000						
029N	006W	SEC.010		LOT.3	22.76000						
029N	006W	SEC.010		LOT.4	30.40000						
029N	006W	SEC.011	E/2								
029N	006W	SEC.011		LOT.1	30.34000						
029N	006W	SEC.012	82.43 acres in Tract 37								
029N	006W	SEC.012	ALL of Tract 43 in Sec. 12								
029N	006W	SEC.012	W/2 SE/4								
029N	006W	SEC.012		LOT.1	6.50000						
029N	006W	SEC.012		LOT.3	18.60000						
029N	006W	SEC.012		LOT.4	5.60000						
029N	006W	SEC.012		LOT.5	12.30000						
029N	006W	SEC.012		LOT.6	17.90000						
029N	006W	SEC.013	W/2								
029N	006W	SEC.014	ALL								
029N	006W	SEC.015	N/2 NW/4								
029N	006W	SEC.015	N/2 SE/4								
029N	006W	SEC.015	N/2 SW/4								

Total Acres Non-Committed: 0.000000

CONOCOPHILLIPS COMPANY - OPERATOR
RECAPITULATION
THE 013 EXPANDED PARTICIPATING AREA FOR DAKOTA FORMATION
SAN JUAN 29-6 UNIT AREA

Description of Committed Lands in PA

Township	Range	Section	Description	Lot	Acreage
029N	006W	SEC.015	NE/4		
029N	006W	SEC.015	S/2 NW/4		
029N	006W	SEC.015	S/2 SW/4, SW/4 SE/4		
029N	006W	SEC.015	SE/4 SE/4		
029N	006W	SEC.016	NE/4 SE/4		
029N	006W	SEC.016	NE/4, NW/4 SE/4, W/2		
029N	006W	SEC.016	S/2 SE/4		
029N	006W	SEC.021	E/2		
029N	006W	SEC.022	E/2 NE/4		
029N	006W	SEC.022	W/2		
029N	006W	SEC.022	W/2 E/2, E/2 SE/4		
029N	006W	SEC.023	ALL		
029N	006W	SEC.024	W/2		
029N	006W	SEC.024	W/2 E/2		
029N	006W	SEC.024		LOT.1	18.21000
029N	006W	SEC.024		LOT.2	18.28000
029N	006W	SEC.024		LOT.3	18.34000
029N	006W	SEC.024		LOT.4	18.41000
029N	006W	SEC.025	W/2		
029N	006W	SEC.025	W/2 E/2		
029N	006W	SEC.025		LOT.1	18.45000
029N	006W	SEC.025		LOT.2	18.46000
029N	006W	SEC.025		LOT.3	18.48000
029N	006W	SEC.025		LOT.4	18.49000
029N	006W	SEC.026	E/2 E/2		
029N	006W	SEC.026	E/2 NW/4		
029N	006W	SEC.026	E/2 SW/4		
029N	006W	SEC.026	W/2 NE/4		

CONOCOPHILLIPS COMPANY - OPERATOR
RECAPITULATION
THE 013 EXPANDED PARTICIPATING AREA FOR DAKOTA FORMATION
SAN JUAN 29-6 UNIT AREA

Description of Committed Lands in PA

Township	Range	Section	Description	Lot	Acreage
029N	006W	SEC.026	W/2NW/4		
029N	006W	SEC.026	W/2SE/4		
029N	006W	SEC.026	W/2SW/4		
029N	006W	SEC.027	E/2NE/4		
029N	006W	SEC.027	E/2SE/4		
029N	006W	SEC.027	W/2		
029N	006W	SEC.027	W/2E/2		
029N	006W	SEC.028	SE/4		
029N	006W	SEC.032	SW/4, E/2NW/4		
029N	006W	SEC.032	W/2NW/4		
029N	006W	SEC.033	NE/4		
029N	006W	SEC.033	SE/4		
029N	006W	SEC.034	ALL		
029N	006W	SEC.035	N/2NE/4, NE/4NW/4		
029N	006W	SEC.035	N/2S/2, S/2N/2		
029N	006W	SEC.035	NW/4NW/4		
029N	006W	SEC.036	S/2S/2		
029N	006W	SEC.036	LOT.1		18.51000
029N	006W	SEC.036	LOT.2		18.53000
029N	006W	SEC.036	LOT.3		18.55000
029N	006W	SEC.036	LOT.4		18.57000
029N	006W	SEC.036	W/2		
029N	006W	SEC.036	W/2E/2		

Total Acres Committed: 10851.13000

CONOCOPHILLIPS COMPANY - OPERATOR

Fourteenth Expanded Participating Area for the Dakota Formation San Juan 29-6 Unit Area, Effective 5/01/2005

Serial Number	Description	Number of Acres	Drilling Block Ownership	Percentage	Percentage Committed	Present Actual Participation
Tract 1						
NM 012698	T-29-N, R-6-W Section 11: E/2, SW/4, E/2NW/4, SW/4NW/4, Lot 1 Section 12: N/2, W/2NW/4, SE/4NW/4, SW/4	950.34	Royalty: ORRI: Working Interest: Burlington Resources Oil & Gas Company ConocoPhillips Company Total	0.000000 % 0.000000 % 50.000000 % 50.000000 % 100.000000 %	12.500000 % 7.500000 % 40.000000 % 40.000000 % 100.000000 %	8.574530 %
Tract 1A						
NM 012698	T-29-N, R-6-W Section 12: Lot 1, 3-6, W/2SE/4 82.43 acres in Tr. 37 All Tract 43 in Sec. 12	229.85	Royalty: ORRI: Working Interest: ConocoPhillips Company Total	0.000000 % 0.000000 % 100.000000 % 100.000000 %	12.500000 % 4.000000 % 83.500000 % 100.000000 %	2.073843 %
Tract 2						
SF 078278	T-29-N, R-6-W Section 13: W/2 Section 10: Lots 1,2,3,4, SE/4, W/2 Section 15: N/2 NW/4	955.87	Royalty: ORRI: Working Interest: Burlington Resources Oil & Gas Company ConocoPhillips Company Total	0.000000 % 0.000000 % 50.000000 % 50.000000 % 100.000000 %	12.500000 % 7.500000 % 40.000000 % 40.000000 % 100.000000 %	8.624425 %
Tract 2A						
SF 078278	T-29-N, R-6-W Section 13: Lots 1-4, W/2E/2 Section 15: N/2 SE/4	312.16	Royalty: ORRI: Working Interest: Burlington Resources Oil & Gas Company Total	0.000000 % 0.000000 % 100.000000 % 100.000000 %	12.500000 % 4.500000 % 83.000000 % 100.000000 %	2.816492 %
Tract 2B						
SF 078278	T-29-N, R-6-W Section 15: SE/4 SE/4	40.00	Royalty: ORRI: Working Interest: Burlington Resources Oil & Gas Company Total	0.000000 % 0.000000 % 100.000000 % 100.000000 %	12.500000 % 5.000000 % 82.500000 % 100.000000 %	0.360904 %

CONOCOPHILLIPS COMPANY - OPERATOR
Fourteenth Expanded Participating Area for the Dakota Formation
San Juan 29-6 Unit Area, Effective 5/01/2005

Serial Number	Description	Number of Acres	Drilling Block Ownership	Percentage	Percentage Committed	Present Actual Participation
Tract 2C						
SF 078278	T-29-N, R-6-W Section 14: All	640.00	Royalty: ORRI: Working Interest: Burlington Resources Oil & Gas Company ConocoPhillips Company <i>Total</i>	0.000000 % 0.000000 % 50.000000 % 50.000000 % <u>100.000000 %</u>	12.500000 % 8.500000 % 39.500000 % 39.500000 % <u>100.000000 %</u>	5.774459 %
Tract 2D						
SF 078278	T-29-N, R-6-W Section 15: NE/4	160.00	Royalty: ORRI: Working Interest: Burlington Resources Oil & Gas Company ConocoPhillips Company <i>Total</i>	0.000000 % 0.000000 % 50.000000 % 50.000000 % <u>100.000000 %</u>	12.500000 % 8.000000 % 39.750000 % 39.750000 % <u>100.000000 %</u>	1.443615 %
Tract 3						
SF 078284	T-29-N, R-6-W Section 24: Lots 1-4, W/2E/2	233.24	Royalty: ORRI: Working Interest: Burlington Resources Oil & Gas Company ConocoPhillips Company <i>Total</i>	0.000000 % 0.000000 % 50.000000 % 50.000000 % <u>100.000000 %</u>	12.500000 % 7.500000 % 40.000000 % 40.000000 % <u>100.000000 %</u>	2.104429 %
Tract 3A						
SF 078284	T-29-N, R-6-W Section 23: All Section 24: W/2 Section 26: W/2 NE/2 <i>Total</i>	1,040.00	Royalty: ORRI: Working Interest: Burlington Resources Oil & Gas Company ConocoPhillips Company <i>Total</i>	0.000000 % 0.000000 % 50.000000 % 50.000000 % <u>100.000000 %</u>	12.500000 % 8.000000 % 39.750000 % 39.750000 % <u>100.000000 %</u>	9.383494 %

CONOCOPHILLIPS COMPANY - OPERATOR
Fourteenth Expanded Participating Area for the Dakota Formation
San Juan 29-6 Unit Area, Effective 5/01/2005

Serial Number	Description	Number of Acres	Drilling Block Ownership	Percentage	Percentage Committed	Present Actual Participation
NM 012670						
	<u>T-29-N, R-6-W</u>	320.00				
	Section 35: N/2 S/2, S/2 N/2		Royalty: ORRI: Working Interest: Burlington Resources Oil & Gas Company	0.000000 % 0.000000 % 100.000000 % 100.000000 %	12.500000 % 5.000000 % 82.500000 %	2.887229 %
Tract 4						
				<u>100.000000 %</u>	<u>100.000000 %</u>	
<hr/>						
SF 078960						
	<u>T-29-N, R-6-W</u>	160.00				
	Section 35: S/2 S/2		Royalty: ORRI: Working Interest: Burlington Resources Oil & Gas Company ConocoPhillips Company	0.000000 % 0.000000 % 50.000000 % 50.000000 % 100.000000 %	12.500000 % 7.500000 % 40.000000 % 40.000000 % 100.000000 %	1.443615 %
Tract 6						
				<u>100.000000 %</u>	<u>100.000000 %</u>	
<hr/>						
NM 012671						
	<u>T-29-N, R-6-W</u>	480.00				
	Section 25: W/2 Section 26: E/2 E/2		Royalty: ORRI: Working Interest: Burlington Resources Oil & Gas Company ConocoPhillips Company	0.000000 % 0.000000 % 50.000000 % 50.000000 % 100.000000 %	12.500000 % 8.000000 % 39.750000 % 39.750000 % 100.000000 %	4.330844 %
Tract 7						
				<u>100.000000 %</u>	<u>100.000000 %</u>	
<hr/>						
NM 012671						
	<u>T-29-N, R-6-W</u>	233.88				
	Section 25: Lots 1,2,3,4, W/2 E/2		Royalty: ORRI: Working Interest: Burlington Resources Oil & Gas Company ConocoPhillips Company	0.000000 % 0.000000 % 50.000000 % 50.000000 % 100.000000 %	12.500000 % 7.500000 % 40.000000 % 40.000000 % 100.000000 %	2.110204 %
Tract 7A						
				<u>100.000000 %</u>	<u>100.000000 %</u>	

CONOCOPHILLIPS COMPANY - OPERATOR
Fourteenth Expanded Participating Area for the Dakota Formation
San Juan 29-6 Unit Area, Effective 5/01/2005

Serial Number	Description	Number of Acres	Drilling Block Ownership	Percentage	Percentage Committed	Present Actual Participation
Tract g						
SF 080146	T-29-N, R-6-W Section 34: All	640.00	Royalty: ORRI: Working Interest: Burlington Resources Oil & Gas Company Betty T. Johnston Marital Trust Eula May Johnston Trust Pintail Production Co., Inc. V.A. Johnston Family Trust Veva Jean Gibbard Total	0.000000 % 0.000000 % 75.000000 % 4.166670 % 8.333335 % 8.333334 % 2.083331 % 2.083330 % 100.000000 %	12.500000 % 2.500000 % 63.750011 % 3.541672 % 7.083326 % 7.083336 % 1.770827 % 1.770827 % 100.000000 %	5.774459 %
Tract g						
SF 080180	T-29-N, R-6-W Section 9: E/2 SE/4 Section 22: W/2 E/2, E/2 SE/4	320.00	Royalty: ORRI: Working Interest: Burlington Resources Oil & Gas Company ConocoPhillips Company Total	0.000000 % 0.000000 % 50.000000 % 50.000000 % 100.000000 %	12.500000 % 8.500000 % 39.500000 % 39.500000 % 100.000000 %	2.887229 %
Tract 10						
SF 080377	T-29-N, R-6-W Section 15: S/2 SW/4, SW/4 SE/4	120.00	Royalty: ORRI: Working Interest: Burlington Resources Oil & Gas Company Total	0.000000 % 0.000000 % 100.000000 % 100.000000 %	12.500000 % 5.000000 % 82.500000 % 100.000000 %	1.082711 %
Tract 10A						
SF 080377	T-29-N, R-6-W Section 9: W/2 SE/4 Section 22: W/2 Section 26: W/2 NW/4 Section 27: E/2 NE/4 Total	560.00	Royalty: ORRI: Working Interest: Burlington Resources Oil & Gas Company ConocoPhillips Company Total	0.000000 % 0.000000 % 50.000000 % 50.000000 % 100.000000 %	12.500000 % 8.500000 % 39.500000 % 39.500000 % 100.000000 %	5.052651 %

CONOCOPHILLIPS COMPANY - OPERATOR
Fourteenth Expanded Participating Area for the Dakota Formation
San Juan 29-6 Unit Area, Effective 5/01/2005

Serial Number	Description	Number of Acres	Drilling Block Ownership	Percentage	Percentage Committed	Present Actual Participation
SF 080379-A						
	<u>T-29-N, R-6-W</u> Section 21: E/2	320.00				
			Royalty:	0.000000 %	12.500000 %	2.887229 %
			ORRI:	0.000000 %	8.500000 %	
			Working Interest:			
			Burlington Resources Oil & Gas Company	50.000000 %	39.500000 %	
			ConocoPhillips Company	50.000000 %	39.500000 %	
			Total	<u>100.000000 %</u>	<u>100.000000 %</u>	
						<u>1.443615 %</u>
SF 080596						
	<u>T-29-N, R-6-W</u> Section 33: SE/4	160.00				
			Royalty:	0.000000 %	12.500000 %	2.887229 %
			ORRI:	0.000000 %	8.500000 %	
			Working Interest:			
			Burlington Resources Oil & Gas Company	50.000000 %	39.500000 %	
			ConocoPhillips Company	50.000000 %	39.500000 %	
			Total	<u>100.000000 %</u>	<u>100.000000 %</u>	
						<u>1.443615 %</u>
NM 03040-A						
	<u>T-29-N, R-6-W</u> Section 27: W/2	320.00				
			Royalty:	0.000000 %	12.500000 %	2.887229 %
			ORRI:	0.000000 %	8.500000 %	
			Working Interest:			
			Burlington Resources Oil & Gas Company	50.000000 %	39.500000 %	
			ConocoPhillips Company	50.000000 %	39.500000 %	
			Total	<u>100.000000 %</u>	<u>100.000000 %</u>	
						<u>1.443615 %</u>
NM 03471-A						
	<u>T-29-N, R-6-W</u> Section 27: W/2 E/2	160.00				
			Royalty:	0.000000 %	12.500000 %	1.443615 %
			ORRI:	0.000000 %	8.500000 %	
			Working Interest:			
			Burlington Resources Oil & Gas Company	50.000000 %	39.500000 %	
			ConocoPhillips Company	50.000000 %	39.500000 %	
			Total	<u>100.000000 %</u>	<u>100.000000 %</u>	
						<u>1.443615 %</u>

CONOCOPHILLIPS COMPANY - OPERATOR
Fourteenth Expanded Participating Area for the Dakota Formation
San Juan 29-6 Unit Area, Effective 5/01/2005

Serial Number	Description	Number of Acres	Drilling Block Ownership	Percentage	Percentage Committed	Present Actual Participation
<u>Tract 15-B</u>						
NM 03471	T-29-N, R-6-W Section 28: SE/4	160.00	Royalty: ORRI: Working Interest: Burlington Resources Oil & Gas Company Total	0.000000 % 0.000000 % 100.000000 % 100.000000 %	12.500000 % 5.000000 % 82.500000 % 100.000000 %	1.443615 %
<u>Tract 15-C</u>						
NM 03471	T-29-N, R-6-W Section 35: NW/4 NW/4	40.00	Royalty: ORRI: Working Interest: Burlington Resources Oil & Gas Company ConocoPhillips Company Total	0.000000 % 0.000000 % 50.000000 % 50.000000 % 100.000000 %	12.500000 % 8.500000 % 39.500000 % 39.500000 % 100.000000 %	0.360904 %
<u>Tract 16</u>						
NM 05220	T-29-N, R-6-W Section 15: N/2 SW/4	80.00	Royalty: ORRI: Working Interest: Burlington Resources Oil & Gas Company Total	0.000000 % 0.000000 % 100.000000 % 100.000000 %	12.500000 % 5.000000 % 82.500000 % 100.000000 %	0.721807 %
<u>Tract 16A</u>						
NM 05220	T-29-N, R-6-W Section 15: S/2 NW/4 Section 22: E/2 NE/4 Section 26: E/2 NW/4 Total	240.00	Royalty: ORRI: Working Interest: Burlington Resources Oil & Gas Company ConocoPhillips Company Total	0.000000 % 0.000000 % 50.000000 % 50.000000 % 100.000000 %	12.500000 % 8.500000 % 39.500000 % 39.500000 % 100.000000 %	2.165422 %
<u>Tract 17</u>						
E-289-3	T-29-N, R-6-W Section 36: W/2	320.00	Royalty: Working Interest: ConocoPhillips Company Total	0.000000 % 100.000000 % 100.000000 % 100.000000 %	12.500000 % 87.500000 % ##### #####	2.887229 %

CONOCOPHILLIPS COMPANY - OPERATOR
Fourteenth Expanded Participating Area for the Dakota Formation
San Juan 29-6 Unit Area, Effective 5/01/2005

Serial Number	Description	Number of Acres	Drilling Block Ownership	Percentage	Percentage Committed	Present Actual Participation
E-289-30						
	<u>T-29-N, R-6-W</u>	520.00				
	Section 16: N/2, SW/4, NW/4 SE/4		Royalty: ORRI: Working Interest: Burlington Resources Oil & Gas Company ConocoPhillips Company <u>Total</u>	0.000000 % 0.000000 % 50.000000 % 50.000000 % <u>100.000000 %</u>	12.500000 % 8.500000 % 39.500000 % 39.500000 % <u>100.000000 %</u>	4.691748 %
Tract 17-B						
<hr/>						
E-289-36						
	<u>T-29-N, R-6-W</u>	74.16				
	Section 36: Lots 1,2,3,4		Royalty: ORRI: Working Interest: Burlington Resources Oil & Gas Company ConocoPhillips Company <u>Total</u>	0.000000 % 0.000000 % 50.000000 % 50.000000 % <u>100.000000 %</u>	12.500000 % 8.500000 % 39.500000 % 39.500000 % <u>100.000000 %</u>	0.669115 %
Tract 17-C						
<hr/>						
E-289-31						
	<u>T-29-N, R-6-W</u>	160.00				
	Section 36: W/2 E/2		Royalty: ORRI: Working Interest: Burlington Resources Oil & Gas Company ConocoPhillips Company <u>Total</u>	0.000000 % 0.000000 % 50.000000 % 50.000000 % <u>100.000000 %</u>	12.500000 % 8.500000 % 39.500000 % 39.500000 % <u>100.000000 %</u>	1.443615 %
Tract 17-D						
<hr/>						
E-289-33						
	<u>T-29-N, R-6-W</u>	80.00				
	Section 16: S/2 SE/4		Royalty: ORRI: Working Interest: Burlington Resources Oil & Gas Company ConocoPhillips Company <u>Total</u>	0.000000 % 0.000000 % 50.000000 % 50.000000 % <u>100.000000 %</u>	12.500000 % 8.500000 % 39.500000 % 39.500000 % <u>100.000000 %</u>	0.721807 %
Tract 17-E						
<hr/>						
E-289-52						
	<u>T-29-N, R-6-W</u>	240.00				
	Section 32: E/2NW/4, SW/4		Royalty: ORRI: Working Interest: ConocoPhillips Company <u>Total</u>	0.000000 % 0.000000 % 100.000000 % <u>100.000000 %</u>	12.500000 % 0.000000 % 87.500000 % <u>100.000000 %</u>	2.165422 %
Tract 17-F						

CONOCOPHILLIPS COMPANY - OPERATOR
Fourteenth Expanded Participating Area for the Dakota Formation
San Juan 29-6 Unit Area, Effective 5/01/2005

Serial Number	Description	Number of Acres	Drilling Block Ownership	Percentage	Percentage Committed	Present Actual Participation
Tract 17-G						
E-289-50	T-29-N, R-6-W Section 32: W/2NW/4	80.00	Royalty: ORRI: Working Interest: ConocoPhillips Company	0.000000 % 0.000000 % 100.000000 % <u>100.000000 %</u>	12.500000 % 5.000000 % 82.500000 % <u>100.000000 %</u>	<u>0.721807 %</u>
Tract 18						
E 4083-2	T-29-N, R-6-W Section 16: NE/4 SE/4	40.00	Royalty: Working Interest: McElvain Oil Company Charles W. Gay J&M Raymond Ltd. TAMACAM LLC Lorravn Gay Hacker T. H. McElvain Oil & Gas Ltd. Partnership Vaughan-McElvain Energy Inc. Total	0.000000 % 16.666666 % 1.041667 % 20.833333 % 2.083334 % 1.041667 % 25.000000 % 33.333333 % <u>100.000000 %</u>	12.500000 % 14.583328 % 0.911461 % 18.229164 % 1.822923 % 0.911461 % 21.875000 % 29.1666375 % <u>100.000000 %</u>	<u>0.360904 %</u>
Tract 20						
Fee	T-29-N, R-6-W Section 10: That portion of Tract #42 in NE/4 Section 11: That portion of Tract #42 in NW/4	93.79	Royalty: ORRI: Working Interest: Burlington Resources Oil & Gas Company ConocoPhillips Company Total	0.000000 % 0.000000 % 50.000000 % 50.000000 % <u>100.000000 %</u>	12.500000 % 7.500000 % 40.000000 % 40.000000 % <u>100.000000 %</u>	<u>0.846229 %</u>
Tract 21						
Fee	T-29-N, R-6-W Section 26: W/2 SE/4	80.00	Royalty: ORRI: Working Interest: Burlington Resources Oil & Gas Company ConocoPhillips Company Total	0.000000 % 0.000000 % 50.000000 % 50.000000 % <u>100.000000 %</u>	12.500000 % 7.500000 % 40.000000 % 40.000000 % <u>100.000000 %</u>	<u>0.721807 %</u>

CONOCOPHILLIPS COMPANY - OPERATOR
Fourteenth Expanded Participating Area for the Dakota Formation
San Juan 29-6 Unit Area, Effective 5/01/2005

Serial Number	Description	Number of Acres	Drilling Block Ownership	Percentage	Percentage Committed	Present Actual Participation
Fee	T-29-N, R-6-W Section 26: E/2 SW/4	80.00	Royalty: Working Interest: Burlington Resources Oil & Gas Company Sable Energy, Ltd.	0.000000 % 75.000000 % 25.000000 % <u>100.000000 %</u>	12.500000 % 65.625000 % 21.875000 % <u>100.000000 %</u>	<u>0.721807 %</u>
Tract 24						

Fee	T-29-N, R-6-W Section 35: N/2 NE/4, NE/4 NW/4	120.00	Royalty: Working Interest: Burlington Resources Oil & Gas Company Sable Energy, Ltd.	0.000000 % 75.000000 % 25.000000 % <u>100.000000 %</u>	12.500000 % 65.625000 % 21.875000 % <u>100.000000 %</u>	<u>1.082711 %</u>
Tract 24-A						

Fee	T-29-N, R-6-W Section 26: W/2 SW/4, E/2 SE/4	160.00	Royalty: ORRI: Working Interest: Burlington Resources Oil & Gas Company ConocoPhillips Company	0.000000 % 0.000000 % 50.000000 % 50.000000 % <u>100.000000 %</u>	12.500000 % 3.500000 % 42.000000 % 42.000000 % <u>100.000000 %</u>	<u>1.443615 %</u>
Tract 28						

CONOCOPHILLIPS COMPANY - OPERATOR
RECAPITULATION
THE 014 EXPANDED PARTICIPATING AREA FOR DAKOTA FORMATION
SAN JUAN 29-6 UNIT AREA

Description of Committed Lands in PA				Description of Non-Committed Lands in PA							
Township	Range	Section	Description	Lot	Acreage	Township	Range	Section	Description	Lot	Acreage
026N	006W	SEC.011	E/2 SW/4, E/2 NW/4, SW/4 NW/4								
026N	006W	SEC.012	N/2, W/2 NW/4, SE/4 NW/4, SW/4	LOT.2	15.47000						
026N	006W	SEC.012									
026N	009W	SEC.013	W/2 E/2								
029N	006W	SEC.009	E/2 SE/4								
029N	006W	SEC.009	W/2 SE/4								
029N	006W	SEC.010	N/2								
029N	006W	SEC.010	SE/4, W/2	LOT.1	8.41000						
029N	006W	SEC.010		LOT.2	14.30000						
029N	006W	SEC.010		LOT.3	22.76000						
029N	006W	SEC.010		LOT.4	30.40000						
029N	006W	SEC.011	E/2								
029N	006W	SEC.011		LOT.1	30.34000						
029N	006W	SEC.012	82.43 acres in Tract 37								
029N	006W	SEC.012	ALL of Tract 43 in Sec. 12								
029N	006W	SEC.012	W/2 SE/4	LOT.1	6.50000						
029N	006W	SEC.012		LOT.3	18.60000						
029N	006W	SEC.012		LOT.4	5.60000						
029N	006W	SEC.012		LOT.5	12.30000						
029N	006W	SEC.012		LOT.6	17.90000						
029N	006W	SEC.013	W/2								
029N	006W	SEC.013		LOT.1	17.93000						
029N	006W	SEC.013		LOT.2	18.01000						
029N	006W	SEC.013		LOT.3	18.07000						

Total Acres Non-Committed: 0.000000

CONOCOPHILLIPS COMPANY - OPERATOR
RECAPITULATION
THE 014 EXPANDED PARTICIPATING AREA FOR DAKOTA FORMATION
SAN JUAN 29-6 UNIT AREA

Description of Committed Lands in PA

Township	Range	Section	Description	Lot	Acreage
029N	006W	SEC.013		LOT.4	18.15000
029N	006W	SEC.014	ALL		
029N	006W	SEC.015	N/2 NW/4		
029N	006W	SEC.015	N/2 SE/4		
029N	006W	SEC.015	N/2 SW/4		
029N	006W	SEC.015	NE/4		
029N	006W	SEC.015	S/2 NW/4		
029N	006W	SEC.015	S/2 SW/4, SW/4 SE/4		
029N	006W	SEC.015	SE/4 SE/4		
029N	006W	SEC.016	NE/4 SE/4		
029N	006W	SEC.016	NE/4, NW/4 SE/4, W/2		
029N	006W	SEC.016	S/2 SE/4		
029N	006W	SEC.021	E/2		
029N	006W	SEC.022	E/2 NE/4		
029N	006W	SEC.022	W/2		
029N	006W	SEC.022	W/2 E/2, E/2 SE/4		
029N	006W	SEC.023	ALL		
029N	006W	SEC.024	W/2		
029N	006W	SEC.024	W/2 E/2		
029N	006W	SEC.024		LOT.1	18.21000
029N	006W	SEC.024		LOT.2	18.28000
029N	006W	SEC.024		LOT.3	18.34000
029N	006W	SEC.024		LOT.4	18.41000
029N	006W	SEC.025	W/2		
029N	006W	SEC.025	W/2 E/2		
029N	006W	SEC.025		LOT.1	18.45000
029N	006W	SEC.025		LOT.2	18.46000
029N	006W	SEC.025		LOT.3	18.48000

CONOCOPHILLIPS COMPANY - OPERATOR
RECAPITULATION
THE 014 EXPANDED PARTICIPATING AREA FOR DAKOTA FORMATION
SAN JUAN 29-6 UNIT AREA

Description of Committed Lands in PA

Township	Range	Section	Description	Lot	Acreage
029N	006W	SEC.025		LOT.4	18.49000
029N	006W	SEC.026	E/2 E/2		
029N	006W	SEC.026	E/2 NW/4		
029N	006W	SEC.026	E/2 SW/4		
029N	006W	SEC.026	W/2 NE/4		
029N	006W	SEC.026	W/2 NW/4		
029N	006W	SEC.026	W/2 SE/4		
029N	006W	SEC.026	W/2 SW/4		
029N	006W	SEC.027	E/2 NE/4		
029N	006W	SEC.027	E/2 SE/4		
029N	006W	SEC.027	W/2		
029N	006W	SEC.027	W/2 E/2		
029N	006W	SEC.028	SE/4		
029N	006W	SEC.032	SW/4, E/2 NW/4		
029N	006W	SEC.032	W/2 NW/4		
029N	006W	SEC.033	NE/4		
029N	006W	SEC.033	SE/4		
029N	006W	SEC.034	ALL		
029N	006W	SEC.035	N/2 NE/4, NE/4 NW/4		
029N	006W	SEC.035	N/2 S/2, S/2 N/2		
029N	006W	SEC.035	NW/4 NW/4		
029N	006W	SEC.035	S/2 S/2		
029N	006W	SEC.036		LOT.1	18.51000
029N	006W	SEC.036		LOT.2	18.53000
029N	006W	SEC.036		LOT.3	18.55000
029N	006W	SEC.036		LOT.4	18.57000
029N	006W	SEC.036	W/2		
029N	006W	SEC.036	W/2 E/2		

Report Name: fuels_expansion_sch_recap.rep

Universe: Fed One

Database: oratlp01

CONOCOPHILLIPS COMPANY - OPERATOR

RECAPITULATION

THE 014 EXPANDED PARTICIPATING AREA FOR DAKOTA FORMATION

SAN JUAN 29-6 UNIT AREA

Page 4 of 4

Run Date: 03/15/2010

Run Time: 12:59:17 PM

User: HOWELDM

Description of Committed Lands in PA

Township Range Section Description Lot

Acreage

Total Acres Committed: 11083.29000

R6W



San Juan 29-6 Unit

Dakota PA

- Approved 11th Expan., Effective 10/1/2005
- Proposed 12th Expan., Effective 2/1/2004
- Revised 13th Expan., Effective 5/1/2004
- Proposed 14th., Expan., Effective 5/1/2005

T
29
N

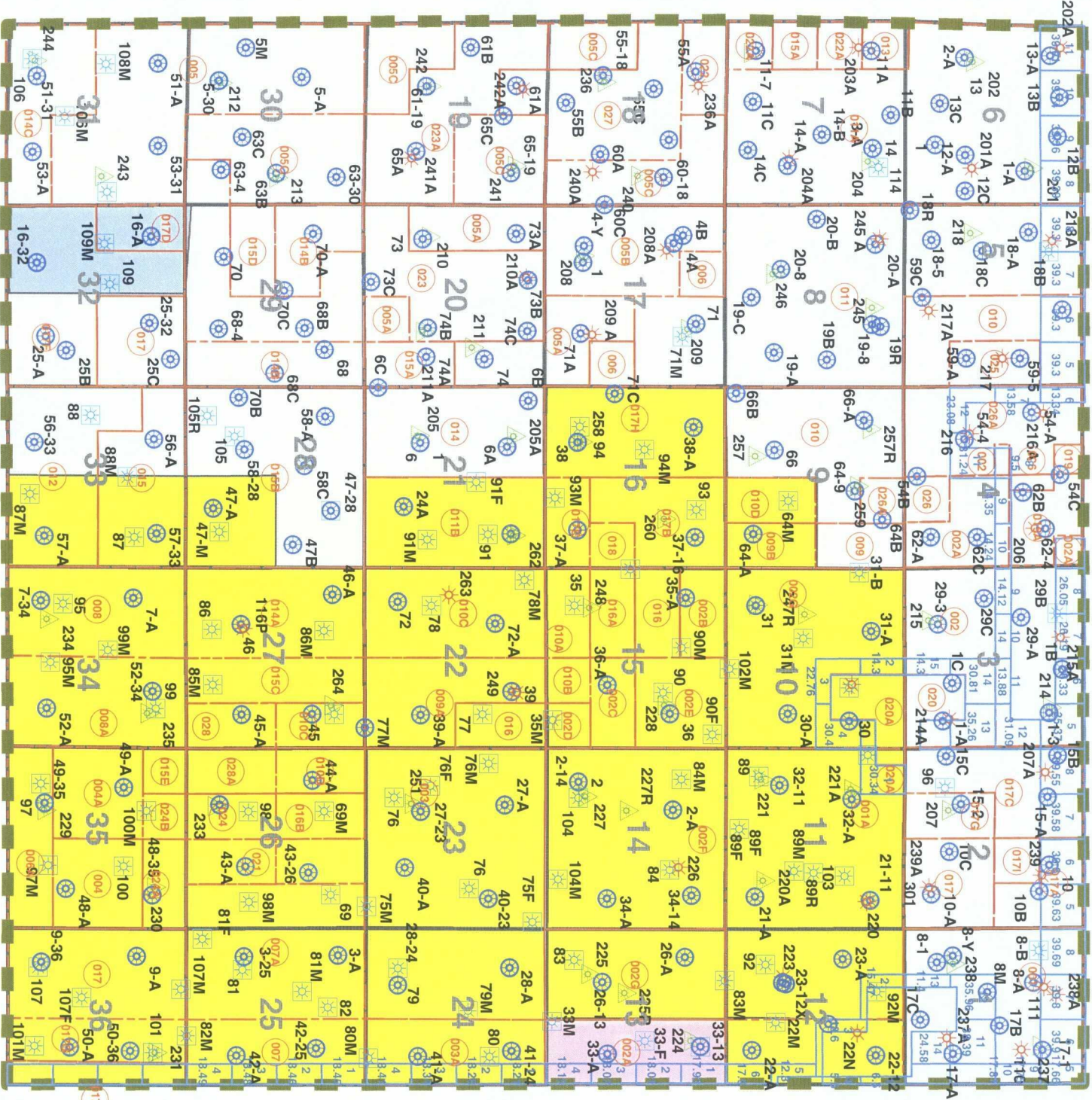

Well Formation

- FRUITLAND COAL
- PICTURED CLIFFS
- MESAVERDE
- DAKOTA

LAND DEPARTMENT
San Juan Business Unit
Farmington, New Mexico
2009