



ConocoPhillips  
San Juan Business Unit  
P.O. Box 4289  
Farmington, NM 87499-4289

October 19, 2010

Bureau of Land Management (3)  
Attn: Mr. Jim Lovato  
1235 La Plata Highway  
Farmington, NM 87401

State of New Mexico (2)  
Commissioner of Public Lands  
Attn: Mr. Pete Martinez  
P.O. Box 1148  
Santa Fe, NM 87501-1148

State of New Mexico (2)  
Oil Conservation Division  
Energy & Minerals Department  
Attn: Ms. Lori Wrotenbery  
1220 S. Saint Francis Drive  
Santa Fe, NM 87505-4000

2010 OCT 20 P 12:46  
RECEIVED OGD

RE: Huerfano Unit (I Sec. No. 731)  
**Dakota Participating Area**  
52<sup>nd</sup> Expansion effective 10-1-08  
53<sup>rd</sup> Expansion, effective 12-1-08  
54<sup>th</sup> Expansion, effective 2-1-09  
55<sup>th</sup> Expansion, effective 3-1-09  
San Juan County, New Mexico  
Contract: 255185 Prop. Code: A728748

Gentlemen:

Pursuant to the provisions of Section 11(a) of the Huerfano Unit Agreement, #I Sec. No. 731, approved June 6, 1950, Burlington Resources Oil & Gas Company LP, as Operator, has determined that the following wells are capable of producing unitized substances in paying quantities from the Dakota formation, thereby should be admitted to the Dakota Participating Area. Pursuant to the attached BLM letters, the wells listed below have been deemed commercial.

**FIFTY-SECOND EXPANSION - EFFECTIVE 10/1/08**

<u>Well Name</u>	<u>Tract/Acres</u>	<u>Tr. Description</u>	<u>Compl. Date</u>
Huerfano Unit #308 Sec. 3-T25N-R9W 320.21 Acres	Tr. 90 / 320.21	Lots 1-2, S/2NE/4, SE/4	9/26/2008

**FIFTY-THIRD EXPANSION - EFFECTIVE 12/1/08**

<u>Well Name</u>	<u>Tract/Acres</u>	<u>Tr. Description</u>	<u>Compl. Date</u>
Huerfano Unit Com #309 Sec. 2-T25N-R9W 240.00 Acres Committed 80.21 Acres Non-Committed	Tr. 124 / 80.21 Tr. 126 / 160.00 Tr. 139A / 80.00	Lots 3-4 - Non-Committed SE/4NW/4, N/2SW/4, SW/4SW/4 SW/4NW/4, SE/4SW/4	11/12/2008

Attached to Huerfano Unit 52<sup>nd</sup>-55<sup>th</sup> DK PA Letter  
October 19, 2010  
Page 2

**FIFTY-FOURTH EXPANSION - EFFECTIVE 2/1/09**

<b><u>Well Name</u></b>	<b><u>Tract/Acres</u></b>	<b><u>Tr. Description</u></b>	<b><u>Compl. Date</u></b>
Huerfano Unit Com #289 Sec. 34-T25N-R9W 320.00 Acres	Tr. 85A / 320	S/2	1-26-09

**FIFTY-FIFTH EXPANSION - EFFECTIVE 3/1/09**

<b><u>Well Name</u></b>	<b><u>Tract/Acres</u></b>	<b><u>Tr. Description</u></b>	<b><u>Compl. Date</u></b>
Huerfano Unit Com #314 Sec. 34-T25N-R9W 320.00 Acres *SE/4 came in with the #289 Well under the 54 <sup>th</sup> Expansion	Tr. 85A / 160	* NE/4	2-1-09

The Expansion Schedules for the Fifty-Second through Fifty-Fifth Expansions are enclosed. The schedules describe the Participating Area and shows the percentage of unitized substances allocated to the tracts according to the ownership within the tracts.

Burlington Resources would appreciate consideration of these Expansions, by written response. Please contact the undersigned at (505) 599-4030 if there are any questions regarding this matter. Copies of this letter and attachments are being furnished to the working interest owners on the attached list.

Sincerely,

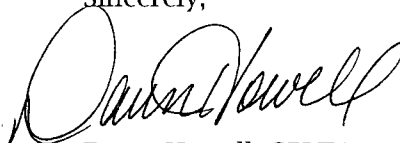

Dawn Howell, CPLTA  
Land Analyst

dh:  
attachments  
File: Huerfano Unit 4.3

**HUERFANO UNIT  
DAKOTA FORMATION  
WORKING INTEREST OWNERS**

AJM LLC  
BENSON MONTIN GREER  
BETTY T JOHNSTON MARITAL TRUST  
BURLINGTON RESOURCES O&G CO LP  
CAROLYN BEAMON TILLEY  
CATHERYN BEAMON  
CLAUDIA MARCIA LUNDELL  
CONOCOPHILLIPS COMPANY  
EULA MAY JOHNSTON TRUST  
FRANKLIN P LILLY  
GRAYFORE PARTNERS  
GROSS RESOURCES LTD PTSHP  
JAMES R BEAMON  
KELLY MINERAL INTERESTS JV  
LA PLATA GATHERING SYSTEM INC  
LANGDON D HARRISON REVOC TRUST B  
LINDA JEANNE LUNDELL  
MACDONALD HALBERSTADT  
REVOCABLE FAMILY TRUST  
MARYAN KLINGER TRUST  
MCCONNELL LTD CO  
MICHAEL R DIMOND  
PRODUCTION GATHERING CO LP  
ROBERT BEAMON TRUSTEE  
ROBERT WALTER LUNDELL  
ROGERS-GIBBARD TRUST  
SHARON BEAMON BURNS  
SUNLAND REFINING CORP  
SUSAN BEAMON PORTER  
THOMAS YATES JR  
V A JOHNSTON LTD  
WILLIAM J GREEN ESTATE  
XTO ENERGY INC  
ZZZ KELLY & TRUST LLC



# United States Department of the Interior

## BUREAU OF LAND MANAGEMENT

Farmington Field Office  
1235 La Plata Highway - Suite A  
Farmington, New Mexico 87401  
www.blm.gov/nm



IN REPLY REFER TO:  
Huerfano Unit DK PA  
3162.7 (F0111)

September 10, 2010

Ms. Dawn Howell  
Burlington Resources Oil & Gas Company LP  
P.O. Box 4289  
Farmington, NM 87499-4289

RE: Huerfano Unit  
Commerciality Determinations  
Dakota Formation  
San Juan County, NM

Dear Ms. Howell:

In response to your letter dated September 2, 2010, the Farmington Field Office has reviewed the data you submitted for a commerciality determination for the following wells completed in the Dakota formation.

Well Name & Number	Dedication	Lease	Completion Date	Determination
Huerfano Unit #304	N/2 Sec. 4, T25N, R10W	NMSF078124	3/20/2008	Non-Commercial
Huerfano Unit #320	E/2 Sec. 14, T25N, R9W	NMNM03016	11/14/2008	Non-Commercial

After completing our economic evaluations, we are in concurrence with the above determinations.

The wells were determined to be non-commercial in the Dakota formation and they are to report their production to the lease number.

Under provisions of 43 CFR 3165.3, you may request an Administrative Review of the order(s) described above. Such request, including all supporting documents, must be filed in writing within 20 business days of receipt of this notice and must be filed with the State Director, Bureau of Land Management (NM-92000), P. O. Box 27115, Santa Fe, New Mexico 87502-0115. Such requests shall not result in a suspension of the order(s) unless the reviewing official so determines. Procedures governing appeals from instructions, orders or decisions are contained in 43 CFR 3165.4 and 43 CFR 4.400 et seq.

If you have any questions concerning this matter, please contact Wayne Townsend at the above address or telephone (505) 599-6359.

Sincerely,

Wayne Townsend  
Petroleum Engineer  
Branch of Petroleum Management



# United States Department of the Interior

## BUREAU OF LAND MANAGEMENT

Farmington Field Office  
1235 La Plata Highway - Suite A  
Farmington, New Mexico 87401  
www.blm.gov/nm



IN REPLY REFER TO:  
Huerfano Unit DK PA  
3162.7 (F0111)

August 5, 2010

Ms. Dawn Howell  
Burlington Resources Oil & Gas Company LP  
P.O. Box 4289  
Farmington, NM 87499-4289

RE: Huerfano Unit  
Commerciality Determination  
Dakota Formation  
San Juan County, NM

Dear Ms. Howell:

In response to your letter dated July 30, 2010, the Farmington Field Office has reviewed the data you submitted for a commerciality determination for the following well completed in the Dakota formation.

Well Name & Number	Dedication	Lease	Completion Date	Determination
Huerfano Unit #314	E/2 Sec. 34, T26N, R9W	NMSF078103A	2/1/2009	Commercial

After completing our economic evaluation, we are in concurrence with the above determination.

The well was determined to be commercial in the Dakota formation and is to be included in the Dakota participating area. It is required that a revision be submitted to include this well in the Huerfano Unit Dakota Participating Area.

Under provisions of 43 CFR 3165.3, you may request an Administrative Review of the order(s) described above. Such request, including all supporting documents, must be filed in writing within 20 business days of receipt of this notice and must be filed with the State Director, Bureau of Land Management (NM-92000), P. O. Box 27115, Santa Fe, New Mexico 87502-0115. Such requests shall not result in a suspension of the order(s) unless the reviewing official so determines. Procedures governing appeals from instructions, orders or decisions are contained in 43 CFR 3165.4 and 43 CFR 4.400 et seq.

If you have any questions concerning this matter, please contact Wayne Townsend at the above address or telephone (505) 599-6359.

Sincerely,

Wayne Townsend  
Petroleum Engineer  
Branch of Petroleum Management



# United States Department of the Interior

## BUREAU OF LAND MANAGEMENT

Farmington Field Office  
1235 La Plata Highway - Suite A  
Farmington, New Mexico 87401  
www.blm.gov/nm



IN REPLY REFER TO:  
Huerfano Unit DK PA  
3162.7 (F0111)

March 4, 2010

Ms. Dawn Howell  
Burlington Resources Oil & Gas Company LP  
P.O. Box 4289  
Farmington, NM 87499-4289

RE: Huerfano Unit  
Commerciality Determinations  
Dakota Formation  
San Juan County, NM

Dear Ms. Howell:

In response to your letter dated March 1, 2010, the Farmington Field Office has reviewed the data you submitted for a commerciality determination for the following wells completed in the Dakota formation.

Well Name & Number	Dedication	Lease	Completion Date	Determination
Huerfano Unit #289	S/2 Sec. 34, T26N, R9W	NMSF078103A	1/26/2009	Commercial
Huerfano Unit #308	E/2 Sec. 3, T25N, R9W	NMNM03039	9/26/2008	Commercial

After completing our economic evaluations, we are in concurrence with the above determinations.

The wells were determined to be commercial in the Dakota formation and are to be included in the Dakota participating area. It is required that revisions be submitted to include these wells in the Huerfano Unit Dakota Participating Area.

Under provisions of 43 CFR 3165.3, you may request an Administrative Review of the order(s) described above. Such request, including all supporting documents, must be filed in writing within 20 business days of receipt of this notice and must be filed with the State Director, Bureau of Land Management (NM-92000), P. O. Box 27115, Santa Fe, New Mexico 87502-0115. Such requests shall not result in a suspension of the order(s) unless the reviewing official so determines. Procedures governing appeals from instructions, orders or decisions are contained in 43 CFR 3165.4 and 43 CFR 4.400 et seq.

If you have any questions concerning this matter, please contact Wayne Townsend at the above address or telephone (505) 599-6359.

Sincerely,

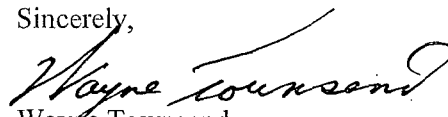
  
Wayne Townsend  
Petroleum Engineer  
Branch of Petroleum Management



# United States Department of the Interior



## BUREAU OF LAND MANAGEMENT

Farmington Field Office  
1235 La Plata Highway - Suite A  
Farmington, New Mexico 87401  
www.blm.gov/nm

IN REPLY REFER TO:  
Huerfano Unit DK PA  
3162.7 (F0111)

July 29, 2010

Ms. Dawn Howell  
Burlington Resources Oil & Gas Company LP  
P.O. Box 4289  
Farmington, NM 87499-4289

RE: Huerfano Unit  
Commerciality Determinations  
Dakota Formation  
San Juan County, NM

Dear Ms. Howell:

In response to your letters dated July 20, 2010, the Farmington Field Office has reviewed the data you submitted for a commerciality determination for the following wells completed in the Dakota formation.

Well Name & Number	Dedication	Lease	Completion Date	Determination
Huerfano Unit #307	W/2 Sec. 35, T26N, R9W	NMSF078103B	9/4/2008	Non-Commercial
Huerfano Unit Com #309	W/2 Sec. 2, T25N, R9W*	STATE	11/12/2008	Commercial

\* Lots 3 and 4 (N/2NW/4) non-committed acreage

After completing our economic evaluations, we are in concurrence with the above determinations.

The well that was determined to be commercial in the Dakota formation is to be included in the Dakota participating area. It is required that a revision be submitted to include this well in the Huerfano Unit Dakota Participating Area. The well that was determined non-commercial in the Dakota formation is to report its production to the lease number.

Under provisions of 43 CFR 3165.3, you may request an Administrative Review of the order(s) described above. Such request, including all supporting documents, must be filed in writing within 20 business days of receipt of this notice and must be filed with the State Director, Bureau of Land Management (NM-92000), P. O. Box 27115, Santa Fe, New Mexico 87502-0115. Such requests shall not result in a suspension of the order(s) unless the reviewing official so determines. Procedures governing appeals from instructions, orders or decisions are contained in 43 CFR 3165.4 and 43 CFR 4.400 et seq.

If you have any questions concerning this matter, please contact Wayne Townsend at the above address or telephone (505) 599-6359.

Sincerely,

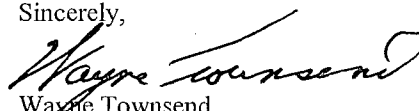
  
Wayne Townsend  
Petroleum Engineer  
Branch of Petroleum Management



# HUERFANO UNIT

## DAKOTA PARTICIPATING AREA

- Approved 51st Expan., Effective 2/1/1985
- Proposed 52nd Expan., Effective 10/1/2008
- Proposed 53rd Expan., Effective 12/1/2008
- Proposed 54th Expan., Effective 2/1/2009
- Proposed 55th Expan., Effective 3/1/2009

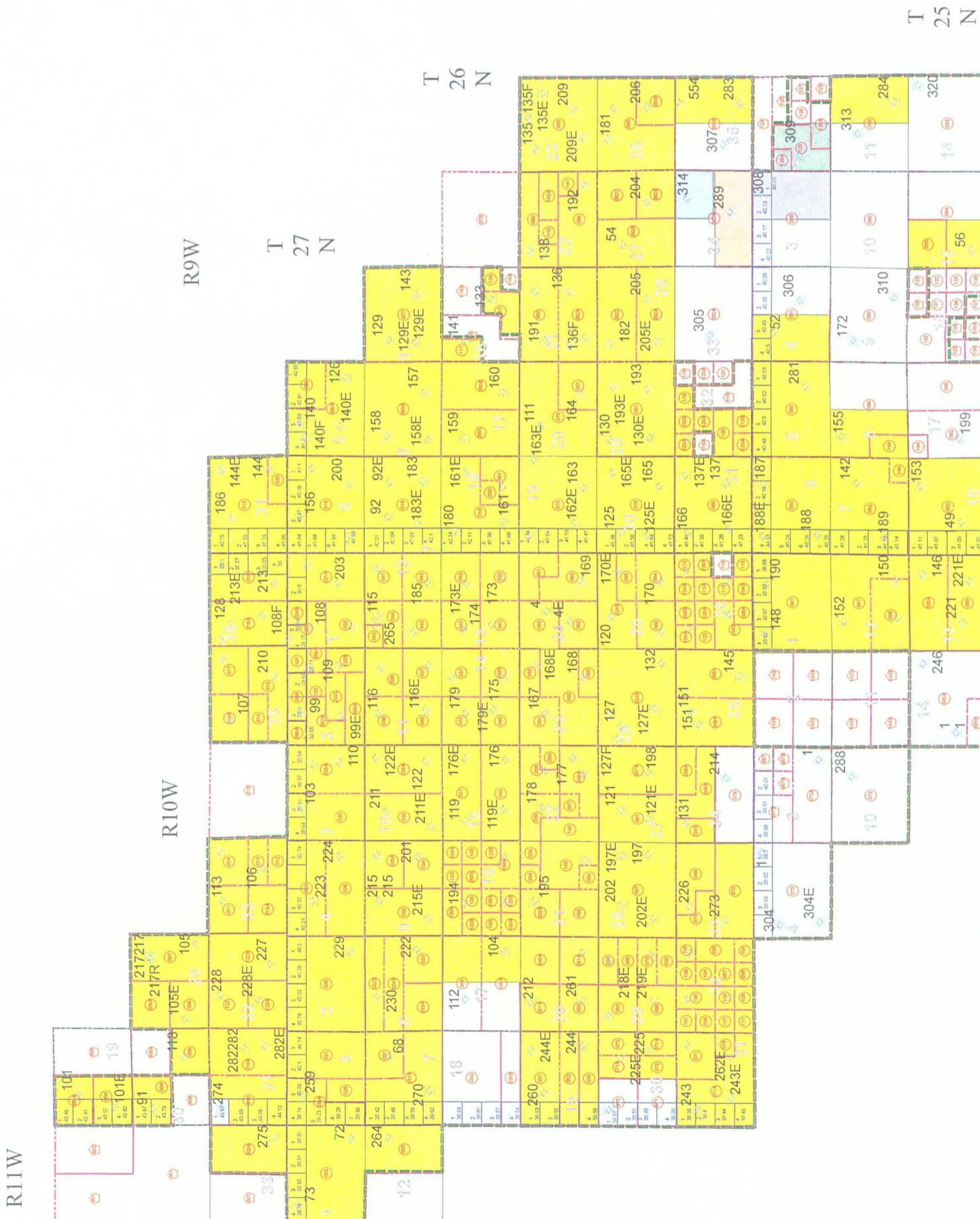



BURLINGTON RESOURCES O&G CO LP - OPERATOR  
 RECAPTULATION  
 THE 052 EXPANDED PARTICIPATING AREA FOR DAKOTA FORMATION  
 HUERFANO UNIT AREA

Description of Committed Lands in PA				Description of Non-Committed Lands in PA							
Township	Range	Section	Description	Lot	Acres	Township	Range	Section	Description	Lot	Acres
025N	009W	SEC.003	SE/4, S/2 NE/4	LOT.1	40.08000	025N	010W	SEC.002	S/2 NE/4		
025N	009W	SEC.003		LOT.2	40.13000	025N	010W	SEC.002	S/2 NW/4		
025N	009W	SEC.003				025N	010W	SEC.002	SE/4		
025N	009W	SEC.004	SW/4, S/2 NW/4	LOT.3	40.43000	025N	010W	SEC.002	SW/4	LOT.1	39.85000
025N	009W	SEC.004		LOT.4	40.50000	025N	010W	SEC.002		LOT.2	39.94000
025N	009W	SEC.004				025N	010W	SEC.002		LOT.3	40.04000
025N	009W	SEC.005	S/2, S/2 N/2	LOT.1	40.53000	025N	010W	SEC.002		LOT.4	40.13000
025N	009W	SEC.005		LOT.2	40.52000	025N	010W	SEC.011	NE/4		
025N	009W	SEC.005		LOT.3	40.50000	025N	010W	SEC.011	NW/4		
025N	009W	SEC.005		LOT.4	40.49000	025N	010W	SEC.011	SE/4		
025N	009W	SEC.006	SE/4, E/2 SW/4, SE/4 NW/4, S/2 NE/4			025N	010W	SEC.011	SW/4		
025N	009W	SEC.006		LOT.1	40.30000	026N	009W	SEC.015	ALL		
025N	009W	SEC.006		LOT.2	40.18000	026N	009W	SEC.016	E/2 NW/4, SW/4 SW/4, N/2 SW		
025N	009W	SEC.006		LOT.3	40.06000	026N	009W	SEC.016	SE/4 SE/4, NE/4		
025N	009W	SEC.006		LOT.4	44.63000	026N	009W	SEC.032	SW/4 NW/4		
025N	009W	SEC.006		LOT.5	40.24000	026N	010W	SEC.036	NW/4 SE/4		
025N	009W	SEC.006		LOT.6	40.26000	027N	010W	SEC.019	E/2		
025N	009W	SEC.006		LOT.7	40.29000	027N	010W	SEC.030	NE/4, E/2 SW/4	LOT.3	43.79000
025N	009W	SEC.007	NE/4, E/2 W/2, N/2 SE/4, SW/4 SE/4			027N	010W	SEC.030		LOT.4	43.85000
025N	009W	SEC.007	SE/4 SE/4	LOT.1	41.28000	027N	010W	SEC.034	ALL		
025N	009W	SEC.007		LOT.2	41.23000	027N	011W	SEC.024	E/2		
025N	009W	SEC.007		LOT.3	41.19000	027N	011W	SEC.024	W/2		
025N	009W	SEC.007		LOT.4	41.14000	027N	011W	SEC.025	ALL		

Total Acres Non-Committed: 4967.60000

BURLINGTON RESOURCES O&G CO LP - OPERATOR  
 RECAPITULATION  
 THE 052 EXPANDED PARTICIPATING AREA FOR DAKOTA FORMATION  
 HUERFANO UNIT AREA

Description of Committed Lands in PA

Township	Range	Section	Description	Lot	Acreage
026N	009W	SEC.008	W/2 SW/4		
026N	009W	SEC.011	E/2		
025N	009W	SEC.015	NW/4		
025N	009W	SEC.015	SW/4		
025N	009W	SEC.018	E/2, E/2 W/2		
025N	009W	SEC.018		LOT 1	41.11000
025N	009W	SEC.018		LOT 2	41.07000
025N	009W	SEC.018		LOT 3	41.05000
025N	009W	SEC.018		LOT 4	41.01000
025N	010W	SEC.001	S/2, S/2 N/2		
025N	010W	SEC.001		LOT 1	39.98000
025N	010W	SEC.001		LOT 2	39.93000
025N	010W	SEC.001		LOT 3	39.87000
025N	010W	SEC.001		LOT 4	39.82000
025N	010W	SEC.012	N/2, E/2 SE/4		
025N	010W	SEC.012	W/2 SE/4, SW/4		
025N	010W	SEC.013	N/2		
025N	010W	SEC.013	S/2		
026N	009W	SEC.005	S/2 NE/4		
026N	009W	SEC.005	S/2, S/2 NW/4		
026N	009W	SEC.005		LOT 1	40.85000
026N	009W	SEC.005		LOT 2	40.97000
026N	009W	SEC.005		LOT 3	41.08000
026N	009W	SEC.005		LOT 4	41.20000
026N	009W	SEC.006	SE/4 NW/4, SE/4, E/2 SW/4, S/2 NE/4		
026N	009W	SEC.006		LOT 1	41.10000
026N	009W	SEC.006		LOT 2	40.79000
026N	009W	SEC.006		LOT 3	40.47000

BURLINGTON RESOURCES O&G CO LP - OPERATOR  
 RECAPITULATION  
 THE 052 EXPANDED PARTICIPATING AREA FOR DAKOTA FORMATION  
 HUERFANO UNIT AREA

Description of Committed Lands in PA

Township	Range	Section	Description	Lot	Acreage
026N	009W	SEC.006		LOT.4	41.94000
026N	009W	SEC.006		LOT.5	41.88000
026N	009W	SEC.006		LOT.6	41.94000
026N	009W	SEC.006		LOT.7	41.99000
026N	009W	SEC.007	E/2, E/2 W/2		
026N	009W	SEC.007		LOT.1	42.01000
026N	009W	SEC.007		LOT.2	42.04000
026N	009W	SEC.007		LOT.3	42.06000
026N	009W	SEC.007		LOT.4	42.10000
026N	009W	SEC.008	ALL		
026N	009W	SEC.009	ALL		
026N	009W	SEC.013	NW/4		
026N	009W	SEC.016	NE/4 SE/4		
026N	009W	SEC.016	SE/4 SW/4, W/2 SE/4, W/2 NW/4		
026N	009W	SEC.017	E/2		
026N	009W	SEC.017	W/2		
026N	009W	SEC.018	NE/4, E/2 W/2		
026N	009W	SEC.018	NW/4 SE/4		
026N	009W	SEC.018	S/2 SE/4, NE/4 SE/4		
026N	009W	SEC.018		LOT.1	42.24000
026N	009W	SEC.018		LOT.2	42.11000
026N	009W	SEC.018		LOT.3	41.99000
026N	009W	SEC.018		LOT.4	41.86000
026N	009W	SEC.019	E/2, E/2 W/2		
026N	009W	SEC.019		LOT.1	41.76000
026N	009W	SEC.019		LOT.2	41.64000
026N	009W	SEC.019		LOT.3	41.53000
026N	009W	SEC.019		LOT.4	41.41000

**BURLINGTON RESOURCES O&G CO LP - OPERATOR**  
**RECAPITULATION**  
**THE 052 EXPANDED PARTICIPATING AREA FOR DAKOTA FORMATION**  
**HUERFANO UNIT AREA**

**Description of Committed Lands in PA**

Township	Range	Section	Description	Lot	Acreage
026N	009W	SEC.020	N/2, SW/4		
026N	009W	SEC.020	SE/4		
026N	009W	SEC.021	N/2		
026N	009W	SEC.021	S/2		
026N	009W	SEC.022	N/2 N/2, SW/4 NW/4		
026N	009W	SEC.022	NE/4 SE/4		
026N	009W	SEC.022	S/2 NE/4		
026N	009W	SEC.022	S/2 SE/4, SW/4, NW/4 SE/4		
026N	009W	SEC.022	SE/4 NW/4		
026N	009W	SEC.023	ALL		
026N	009W	SEC.026	N/2, SW/4		
026N	009W	SEC.026	SE/4		
026N	009W	SEC.027	ALL		
026N	009W	SEC.028	ALL		
026N	009W	SEC.029	ALL		
026N	009W	SEC.030	E/2, E/2 W/2		
026N	009W	SEC.030		LOT.1	41.48000
026N	009W	SEC.030		LOT.2	41.56000
026N	009W	SEC.030		LOT.3	41.64000
026N	009W	SEC.030		LOT.4	41.72000
026N	009W	SEC.031	E/2, E/2 W/2		
026N	009W	SEC.031		LOT.1	41.41000
026N	009W	SEC.031		LOT.2	41.35000
026N	009W	SEC.031		LOT.3	41.29000
026N	009W	SEC.031		LOT.4	41.23000
026N	009W	SEC.032	N/2 SW/4		
026N	009W	SEC.032	NE/4 NW/4		
026N	009W	SEC.032	NW/4 NW/4, SE/4 NW/4, SW/4 SW/4		

BURLINGTON RESOURCES O&G CO LP - OPERATOR  
 RECAPITULATION  
 THE 052 EXPANDED PARTICIPATING AREA FOR DAKOTA FORMATION  
 HUERFANO UNIT AREA

Description of Committed Lands in PA

Township	Range	Section	Description	Lot	Acreage
026N	009W	SEC.032	SE/4 SW/4		
026N	009W	SEC.035	E/2		
026N	010W	SEC.001	S/2 NW/4		
026N	010W	SEC.001	SE/4, S/2 NE/4		
026N	010W	SEC.001	SW/4		
026N	010W	SEC.001		LOT.1	39.97000
026N	010W	SEC.001		LOT.2	39.90000
026N	010W	SEC.001		LOT.3	39.84000
026N	010W	SEC.001		LOT.4	39.77000
026N	010W	SEC.002	E/2 SE/4		
026N	010W	SEC.002	NE/4 SW/4, NW/4 SE/4		
026N	010W	SEC.002	NENE	LOT.1	39.71000
026N	010W	SEC.002	S/2 NW/4, NW/4 SW/4		
026N	010W	SEC.002	S/2 SW/4, SW/4 SE/4		
026N	010W	SEC.002	SE/4 NE/4		
026N	010W	SEC.002	SW/4 NE/4		
026N	010W	SEC.002		LOT.2	39.66000
026N	010W	SEC.002		LOT.3	39.60000
026N	010W	SEC.002		LOT.4	39.55000
026N	010W	SEC.003	SE/4, S/2 NE/4		
026N	010W	SEC.003	SW/4, S/2 NW/4		
026N	010W	SEC.003		LOT.1	39.54000
026N	010W	SEC.003		LOT.2	39.57000
026N	010W	SEC.003		LOT.3	39.61000
026N	010W	SEC.003		LOT.4	39.64000
026N	010W	SEC.004	S/2		
026N	010W	SEC.004	S/2 N/2		
026N	010W	SEC.004		LOT.1	39.74000

**BURLINGTON RESOURCES O&G CO LP - OPERATOR  
 RECAPITULATION  
 THE 052 EXPANDED PARTICIPATING AREA FOR DAKOTA FORMATION  
 HUERFANO UNIT AREA**

**Description of Committed Lands in PA**

Township	Range	Section	Description	Lot	Acreage
026N	010W	SEC.004		LOT.2	39.91000
026N	010W	SEC.004		LOT.3	40.07000
026N	010W	SEC.004		LOT.4	40.24000
026N	010W	SEC.006	E/2 SW/4		
026N	010W	SEC.006	SE/4 NW/4		
026N	010W	SEC.006		LOT.3	40.06000
026N	010W	SEC.006		LOT.4	39.18000
026N	010W	SEC.006		LOT.5	39.23000
026N	010W	SEC.006		LOT.6	39.29000
026N	010W	SEC.006		LOT.7	39.35000
026N	010W	SEC.007	NE/4		
026N	010W	SEC.007	SE/4, E/2 W/2		
026N	010W	SEC.007		LOT.1	39.42000
026N	010W	SEC.007		LOT.2	39.48000
026N	010W	SEC.007		LOT.3	39.56000
026N	010W	SEC.007		LOT.4	39.62000
026N	010W	SEC.008	N/2 N/2		
026N	010W	SEC.008	S/2 N/2		
026N	010W	SEC.008	SE/4		
026N	010W	SEC.008	SW/4		
026N	010W	SEC.009	NE/4		
026N	010W	SEC.009	W/2		
026N	010W	SEC.010	E/2		
026N	010W	SEC.010	W/2		
026N	010W	SEC.011	NE/4		
026N	010W	SEC.011	NW/4		
026N	010W	SEC.011	SE/4		
026N	010W	SEC.011	SW/4		

**BURLINGTON RESOURCES O&G CO LP - OPERATOR**  
**RECAPITULATION**  
**THE 052 EXPANDED PARTICIPATING AREA FOR DAKOTA FORMATION**  
**HUERFANO UNIT AREA**

**Description of Committed Lands in PA**

Township	Range	Section	Description	Lot	Acreage
026N	010W	SEC.012	E/2 NW/4, SW/4 NW/4		
026N	010W	SEC.012	NE/4		
026N	010W	SEC.012	NW/4 NW/4, SE/4		
026N	010W	SEC.012	SW/4		
026N	010W	SEC.013	NE/4, SW/4		
026N	010W	SEC.013	SE/4		
026N	010W	SEC.014	NE/4		
026N	010W	SEC.014	NW/4		
026N	010W	SEC.014	SE/4		
026N	010W	SEC.014	SW/4		
026N	010W	SEC.015	N/2		
026N	010W	SEC.015	S/2		
026N	010W	SEC.016	NE/4 SW/4, SW/4 SW/4, N/2 NW/4		
026N	010W	SEC.016	NW/4 NE/4, NW/4 SW/4		
026N	010W	SEC.016	SE/4 NE/4		
026N	010W	SEC.016	SE/4 NW/4		
026N	010W	SEC.016	SW/4 NE/4		
026N	010W	SEC.016	SW/4 NW/4, SE/4 SW/4, NE/4 SE/4		
026N	010W	SEC.016	W/2 SE/4, SE/4 SE/4, NE/4 NE/4		
026N	010W	SEC.017	NE/4		
026N	010W	SEC.017	SE/4		
026N	010W	SEC.019	NE/4 SW/4, N/2 SE/4		
026N	010W	SEC.019	NE/4, E/2 NW/4		
026N	010W	SEC.019	S/2 SE/4, SE/4 SW/4		
026N	010W	SEC.019		LOT.1	39.53000
026N	010W	SEC.019		LOT.2	39.55000
026N	010W	SEC.019		LOT.3	39.57000



**BURLINGTON RESOURCES O&G CO LP - OPERATOR  
 RECAPITULATION  
 THE 052 EXPANDED PARTICIPATING AREA FOR DAKOTA FORMATION  
 HUERFANO UNIT AREA**

**Description of Committed Lands in PA**

Township	Range	Section	Description	Lot	Acreage
026N	010W	SEC.019		LOT:4	39.59000
026N	010W	SEC.020	NE/4		
026N	010W	SEC.020	SE/4, W/2 NW/4, SE/4 NW/4		
026N	010W	SEC.020	SW/4		
026N	010W	SEC.021	NE/4 NE/4		
026N	010W	SEC.021	NW/4		
026N	010W	SEC.021	NW/4 NE/4, SW/4 SE/4		
026N	010W	SEC.021	S/2 NE/4, N/2 SE/4, SE/4 SE/4		
026N	010W	SEC.021	SW/4		
026N	010W	SEC.022	N/2 NE/4, SW/4 NE/4		
026N	010W	SEC.022	N/2 NW/4, SE/4 NW/4		
026N	010W	SEC.022	NE/4 SW/4		
026N	010W	SEC.022	SE/4 NE/4		
026N	010W	SEC.022	SE/4, SE/4 SW/4		
026N	010W	SEC.022	W/2 SW/4, SW/4 NW/4		
026N	010W	SEC.023	N/2 NE/4		
026N	010W	SEC.023	NW/4		
026N	010W	SEC.023	S/2 NE/4, SW/4, N/2 SE/4		
026N	010W	SEC.023	S/2 SE/4		
026N	010W	SEC.024	E/2 NE/4, NW/4 NE/4		
026N	010W	SEC.024	NW/4		
026N	010W	SEC.024	SW/4 NE/4, SE/4		
026N	010W	SEC.025	NW/4, N/2 NE/4		
026N	010W	SEC.025	S/2 NE/4		
026N	010W	SEC.025	SE/4		
026N	010W	SEC.025	SW/4		
026N	010W	SEC.026	ALL		

BURLINGTON RESOURCES O&G CO LP - OPERATOR  
 RECAPTULATION  
 THE 052 EXPANDED PARTICIPATING AREA FOR DAKOTA FORMATION  
 HUERFANO UNIT AREA

Description of Committed Lands in PA

Township	Range	Section	Description	Lot	Acreage
026N	010W	SEC.027	E/2		
026N	010W	SEC.027	W/2		
026N	010W	SEC.028	ALL		
026N	010W	SEC.029	N/2 NE/4		
026N	010W	SEC.029	N/2 SE/4		
026N	010W	SEC.029	NW/4		
026N	010W	SEC.029	S/2 NE/4, SW/4		
026N	010W	SEC.029	S/2 SE/4		
026N	010W	SEC.029	SE/4		
026N	010W	SEC.030	E/2 NE/4, W/2 SE/4		
026N	010W	SEC.031	W/2 NE/4, E/2 SE/4		
026N	010W	SEC.031	E/2 W/2, W/2 SE/4, SE/4 SE/4		
026N	010W	SEC.031	NE/4		
026N	010W	SEC.031	NE/4 SE/4		
026N	010W	SEC.031		LOT.1	39.38000
026N	010W	SEC.031		LOT.2	39.40000
026N	010W	SEC.031		LOT.3	39.44000
026N	010W	SEC.031		LOT.4	39.46000
026N	010W	SEC.032	E/2 NW/4		
026N	010W	SEC.032	NE/4 NE/4, SE/4 SW/4		
026N	010W	SEC.032	NE/4 SW/4		
026N	010W	SEC.032	NW/4 NE/4		
026N	010W	SEC.032	NW/4 NW/4, NW/4 SW/4		
026N	010W	SEC.032	NW/4 SE/4		
026N	010W	SEC.032	SE/4 NE/4, NE/4 SE/4, SW/4 SE/4		
026N	010W	SEC.032	SW/4 NE/4, SE/4 SE/4		
026N	010W	SEC.032	SW/4 NW/4		
026N	010W	SEC.032	SW/4 SW/4		

BURLINGTON RESOURCES O&G CO LP - OPERATOR  
 RECAPTULATION  
 THE 052 EXPANDED PARTICIPATING AREA FOR DAKOTA FORMATION  
 HUERFANO UNIT AREA

Description of Committed Lands in PA

Township	Range	Section	Description	Lot	Acreage
026N	010W	SEC.033	NE/4 NW/4, NE/4		
026N	010W	SEC.033	S/2		
026N	010W	SEC.033	W/2 NW/4, SE/4 NW/4		
026N	010W	SEC.034	E/2 NW/4, S/2 NE/4		
026N	010W	SEC.034	N/2 NE/4		
026N	010W	SEC.034	W/2 NW/4		
026N	010W	SEC.035	E/2		
026N	010W	SEC.035	W/2		
026N	010W	SEC.036	N/2 SW/4, SW/4 SW/4, SW/4 SE/4		
026N	010W	SEC.036	NE/4 NE/4		
026N	010W	SEC.036	NE/4 NW/4		
026N	010W	SEC.036	NW/4 NE/4, NW/4 NW/4		
026N	010W	SEC.036	NW/4 SE/4		
026N	010W	SEC.036	SE/4 NW/4, SE/4 NE/4		
026N	010W	SEC.036	SE/4 SE/4		
026N	010W	SEC.036	SE/4 SW/4		
026N	010W	SEC.036	SW/4 NE/4		
026N	010W	SEC.036	SW/4 NW/4		
026N	011W	SEC.001	S/2, S/2 N/2		
026N	011W	SEC.001		LOT.1	39.97000
026N	011W	SEC.001		LOT.2	39.91000
026N	011W	SEC.001		LOT.3	39.85000
026N	011W	SEC.001		LOT.4	39.79000
026N	011W	SEC.012	E/2		
027N	009W	SEC.031	NE/4, N/2 SE/4, E/2 W/2		
027N	009W	SEC.031	S/2 SE/4		
027N	009W	SEC.031		LOT.1	40.75000
027N	009W	SEC.031		LOT.2	41.05000

**BURLINGTON RESOURCES O&G CO LP - OPERATOR  
 RECAPITULATION  
 THE 052 EXPANDED PARTICIPATING AREA FOR DAKOTA FORMATION  
 HUERFANO UNIT AREA**

Description of Committed Lands in PA				Lot	Acreage
Township	Range	Section	Description		
027N	009W	SEC.031		LOT.3	41.35000
027N	009W	SEC.031		LOT.4	41.65000
027N	010W	SEC.019	E/2 W/2		
027N	010W	SEC.019		LOT.1	43.48000
027N	010W	SEC.019		LOT.2	43.41000
027N	010W	SEC.019		LOT.3	43.57000
027N	010W	SEC.019		LOT.4	43.62000
027N	010W	SEC.029	E/2		
027N	010W	SEC.029	W/2		
027N	010W	SEC.030	SE/4, E/2 NW/4		
027N	010W	SEC.030		LOT.1	43.67000
027N	010W	SEC.030		LOT.2	43.73000
027N	010W	SEC.031	E/2 W/2, E/2		
027N	010W	SEC.031		LOT.2	43.99000
027N	010W	SEC.031		LOT.3	44.05000
027N	010W	SEC.031		LOT.4	44.13000
027N	010W	SEC.032	E/2		
027N	010W	SEC.032	NW/4		
027N	010W	SEC.032	SW/4		
027N	010W	SEC.033	N/2 SE/4, SW/4		
027N	010W	SEC.033	NE/4		
027N	010W	SEC.033	NW/4		
027N	010W	SEC.033	S/2 SE/4		
027N	010W	SEC.035	N/2 SE/4, S/2 S/2		
027N	010W	SEC.035	N/2 SW/4, NW/4		
027N	010W	SEC.035	NE/4		
027N	010W	SEC.036	W/2, W/2 E/2		
027N	010W	SEC.036		LOT.1	35.10000

**BURLINGTON RESOURCES O&G CO LP - OPERATOR**  
**RECAPITULATION**  
**THE 052 EXPANDED PARTICIPATING AREA FOR DAKOTA FORMATION**  
**HUERFANO UNIT AREA**

**Description of Committed Lands in PA**

Township	Range	Section	Description	Lot	Acreage
027N	010W	SEC.036		LOT.2	35.07000
027N	010W	SEC.036		LOT.3	35.03000
027N	010W	SEC.036		LOT.4	35.00000
027N	011W	SEC.036	E/2		
<b>Total Acres Committed:</b>					<b>45272.06000</b>

**BURLINGTON RESOURCES O&G CO LP - Operator**  
 The 052 Expanded Participating Area for Dakota Formation  
 Huerfano Unit Area  
 San Juan, New Mexico  
 Effective 10/01/2008

Serial Num	Description	Number of Acres	Ownership	Drilling Block	GW/Percentage	NRI/Percentage	Participation Factor
	T-027N R-011W			Tract: 001			
	SEC.024 W/2						
	SEC.025 ALL						
		TOTAL					

Tract Remarks:  
 TRACT NOT COMMITTED TO UNIT.

Serial Num	Description	Number of Acres	Ownership	Drilling Block	GW/Percentage	NRI/Percentage	Participation Factor
	T-027N R-011W			Tract: 002			
	SEC.024 E/2						
		TOTAL					

Tract Remarks:  
 TRACT NOT COMMITTED TO UNIT.

**BURLINGTON RESOURCES O&G CO LP - Operator**  
 The 052 Expanded Participating Area for Dakota Formation

Huerfano Unit Area  
 San Juan, New Mexico  
 Effective 10/01/2008

Serial Num	Description	Number of Acres	Ownership	Drilling Block	GWI Percentage	NRI Percentage	Participation Factor
NM-01074	T-026N R-011W	1,279.52	ORRI:	<b>Tract: 003</b>	0.00000000	12.57562200	2.82628400
	SEC:001 LOT 1	39.97	ROYALTY:		0.00000000	12.50000000	
	SEC:001 LOT 2	39.91	WORKING INTEREST:	BURLINGTON RESOURCES O&G CO LP	99.60041800	74.58131100	
	SEC:001 LOT 3	39.85		KELLY MINERALS INTERESTS JV	0.05435000	0.04756400	
	SEC:001 LOT 4	39.79		LANGDON D HARRISON REVOC TRUST E	0.03261700	0.02854000	
	SEC:001 S/2, S/2 N/2			MARYAN KLINGER TRUST	0.04323100	0.03553100	
	SEC:012 E/2			PRODUCTION GATHERING COMPANY LE	0.08644900	0.07304900	
	T-027N R-011W			XTO ENERGY INC	0.06484000	0.05479000	
	SEC:036 E/2			ZZZ KELLY & TRUST LLC	0.11808500	0.10259300	
	TOTAL				100.00000000	100.00000000	
SF-078022	T-027N R-010W	334.08	ORRI:	<b>Tract: 004</b>	0.00000000	10.10964300	0.73793900
	SEC:019 E/2 W/2		ROYALTY:		0.00000000	12.50000000	
	SEC:019 LOT 1	43.48	WORKING INTEREST:	BURLINGTON RESOURCES O&G CO LP	65.04244300	46.81562700	
	SEC:019 LOT 2	43.41		KELLY MINERALS INTERESTS JV	0.17440400	0.15260400	
	SEC:019 LOT 3	43.57		LANGDON D HARRISON REVOC TRUST E	0.10463900	0.09155900	
	SEC:019 LOT 4	43.62		MARYAN KLINGER TRUST	0.08644900	0.07305000	
	TOTAL			PRODUCTION GATHERING COMPANY LE	0.17291000	0.14610700	
				XTO ENERGY INC	34.06968000	29.80708000	
				ZZZ KELLY & TRUST LLC	0.34947500	0.30433000	
				TOTAL	100.00000000	100.00000000	

Tract Remarks:  
 BR AND HUDSON POOL BEAR A 3.0% ORRI. BR BEARS THE REMAINING ORRI.

Tract Remarks:  
 BR AND HUDSON POOL BEAR A 3.0% ORRI. BR BEARS THE REMAINING ORRI.



**BURLINGTON RESOURCES O&G CO LP - Operator**  
 The 052 Expanded Participating Area for Dakota Formation  
 Huertano Unit Area  
 San Juan, New Mexico  
 Effective 10/01/2008

Serial Num	Description	Number of Acres	Ownership	Drilling Block	GW/Percentage	NRI/Percentage	Participation Factor
	T-027N R-010W			<b>Tract: 005</b>			
	SEC 019 E/2						
	TOTAL						

Tract Remarks:  
 TRACT NOT COMMITTED TO UNIT.

Serial Num	Description	Number of Acres	Ownership	Drilling Block	GW/Percentage	NRI/Percentage	Participation Factor
SF-076566	T-027N R-010W	320.00	ORRI:	<b>Tract: 006</b>	0.00000000	7.11409900	0.70683800
	SEC 029 W/2		ROYALTY:		0.00000000	12.50000000	
			WORKING INTEREST:		63.61616900	48.55005000	
			BURLINGTON RESOURCES O&G CO LP		0.41907500	0.36669100	
			KELLY MINERALS INTERESTS JV		0.25143900	0.22000900	
			LANGDON D HARRISON REVOC TRUST E		0.20748500	0.18154900	
			MARYAN KLINGER TRUST		0.41498200	0.36310900	
			PRODUCTION GATHERING COMPANY LF		34.25123400	29.96983000	
			XTO ENERGY INC		0.83961600	0.73466300	
			ZZZ KELLY & TRUST LLC				
			TOTAL		100.00000000	100.00000000	

Tract Remarks:  
 BR BEARS 100% OF THE TOTAL ORRI.

**BURLINGTON RESOURCES O&G CO LP - Operator**  
 The 052 Expanded Participating Area for Dakota Formation  
 Huertano Unit Area  
 San Juan, New Mexico  
 Effective 10/01/2008

Serial Num	Description	Number of Acres	Ownership	Drilling Block	GWI Percentage	NRI Percentage	Participation Factor
SF-080810	T-027N R-010W	320.00	ORRI:	<b>Tract: 007</b>	0.00000000	6.94382000	0.70683800
	SEC.029 E/2		ROYALTY:		0.00000000	12.50000000	
			WORKING INTEREST:		51.06000100	37.73368100	
			PRODUCTION GATHERING COMPANY LF	14.99999900	13.12499900		
			XTO ENERGY INC	33.94000000	29.69750000		
			TOTAL		100.00000000	100.00000000	

Tract Remarks:  
 BR BEARS 100% OF THE TOTAL ORRI.

Serial Num	Description	Number of Acres	Ownership	Drilling Block	GWI Percentage	NRI Percentage	Participation Factor
	T-027N R-010W			<b>Tract: 008</b>			
	SEC.030 LOT.3	43.79					
	SEC.030 LOT.4	43.85					
	SEC.030 NE/4, E/2 SW/4						
			TOTAL				

Tract Remarks:  
 TRACT NOT COMMITTED TO UNIT.

**BURLINGTON RESOURCES O&G CO LP - Operator**  
 The 052 Expanded Participating Area for Dakota Formation  
 Huerfano Unit Area  
 San Juan, New Mexico  
 Effective 10/01/2008

Serial Num	Description	Number of Acres	Ownership	Drilling Block	GWl Percentage	NRI Percentage	Participation Factor
SF-077384	T-027N R-010W	327.40	ORRI:	<b>Tract: 009</b>	0.00000000	6.82816000	0.72318300
	SEC.030 LOT.1	43.67	ROYALTY:		0.00000000	12.50000000	
	SEC.030 LOT.2	43.73	WORKING INTEREST:		58.03000000	45.44809000	
	SEC.030 SE/4, E/2 NW/4		BURLINGTON RESOURCES O&G CO LP		25.00000000	21.37500000	
			CONOCOPHILLIPS COMPANY		16.97000000	13.84875000	
			XTO ENERGY INC		100.00000000	100.00000000	
			TOTAL				

Tract Remarks:  
 BR BEARS 1/4 OF A 2.0% ORRI. XTO BEARS 1/2 OF THE 2% ORRI AND  
 CONOCOPHILLIPS BEARS 1/4 OF THE 2.0% ORRI. BR BEARS ALL OF THE  
 REST OF THE ORRI.

Serial Num	Description	Number of Acres	Ownership	Drilling Block	GWl Percentage	NRI Percentage	Participation Factor
SF-078422	T-027N R-010W	612.17	ORRI:	<b>Tract: 010</b>	0.00000000	9.70632000	1.35220300
	SEC.031 E/2 W/2, E/2		ROYALTY:		0.00000000	12.50000000	
	SEC.031 LOT.2	43.99	WORKING INTEREST:		66.06000000	50.59618000	
	SEC.031 LOT.3	44.05	BURLINGTON RESOURCES O&G CO LP		33.94000000	27.19750000	
	SEC.031 LOT.4	44.13	XTO ENERGY INC		100.00000000	100.00000000	
			TOTAL				

Tract Remarks:  
 XTO BEARS 2.5% OF ORRI AND BR BEARS REMAINDER. DKWELL#274  
 NPWILL REMAIN ON A DRILL-BLOCK BASIS OWNERSHIP BASED ON  
 THE 38TH P/A. EXCLUDED LOT 1

**BURLINGTON RESOURCES O&G CO LP - Operator**  
 The 052 Expanded Participating Area for Dakota Formation  
 Huerfano Unit Area  
 San Juan, New Mexico  
 Effective 10/01/2008

Serial Num	Description	Number of Acres	Ownership	Drilling Block	GWI Percentage	NRI Percentage	Participation Factor
SF-078233	T-027N R-010W	160.00	ORRI:	<b>Tract: O11</b>	0.00000000	7.15131800	0.35341900
	SEC.033 NW/4		ROYALTY:		0.00000000	12.50000000	
			WORKING INTEREST:	BURLINGTON RESOURCES O&G CO LP	64.66658300	49.43194200	
				KELLY MINERALS INTERESTS JV	0.41907500	0.36669100	
				LANGDON D HARRISON REVOC TRUST E	0.25143800	0.22000800	
				XTO ENERGY INC	33.94000000	29.69750000	
				ZZZ KELLY & TRUST LLC	0.72290400	0.63254100	
			<b>TOTAL</b>		<b>100.00000000</b>	<b>100.00000000</b>	

Serial Num	Description	Number of Acres	Ownership	Drilling Block	GWI Percentage	NRI Percentage	Participation Factor
SF-078354	T-027N R-010W	80.00	ROYALTY:	<b>Tract: O12</b>	0.00000000	12.50000000	0.17670900
	SEC.033 S/2 SE/4		WORKING INTEREST:		100.00000000	87.50000000	
				BURLINGTON RESOURCES O&G CO LP	100.00000000	100.00000000	
			<b>TOTAL</b>		<b>100.00000000</b>	<b>100.00000000</b>	

**BURLINGTON RESOURCES O&G CO LP - Operator**  
 The 052 Expanded Participating Area for Dakota Formation  
 Huertano Unit Area  
 San Juan, New Mexico  
 Effective 10/01/2008

Serial Num	Description	Number of Acres	Ownership	Drilling Block	GW/Percentage	NRI/Percentage	Participation Factor
NM-02516	T-027N R-010W	240.00	ORRI:	<b>Tract: 013</b>	0.00000000	14.38881800	0.53012800
	SEC.033 N/2 SE/4, SW/4		ROYALTY:		0.00000000	12.50000000	
			WORKING INTEREST:	BURLINGTON RESOURCES O&G COLP	64.66658300	42.19444200	
				KELLY MINERALS INTERESTS JV	0.41907500	0.36669100	
				LANGDON D HARRISON REVOC TRUST	0.25143800	0.22000800	
				XTO ENERGY INC	33.94000000	29.69750000	
				ZZZ KELLY & TRUST LLC	0.72290400	0.63254100	
			TOTAL		100.00000000	100.00000000	

Tract Remarks:  
 BR BEARS 100% OF THE TOTAL ORRI.

Serial Num	Description	Number of Acres	Ownership	Drilling Block	GW/Percentage	NRI/Percentage	Participation Factor
SF-077950	T-027N R-010W	400.00	ORRI:	<b>Tract: 014</b>	0.00000000	6.07816000	0.88354700
	SEC.033 NE/4		ROYALTY:		0.00000000	12.50000000	
			WORKING INTEREST:	BURLINGTON RESOURCES O&G COLP	58.03000000	45.44809000	
				CONOCOPHILLIPS COMPANY	25.00000000	21.62500000	
				XTO ENERGY INC	16.97000000	14.34875000	
			TOTAL		100.00000000	100.00000000	

Tract Remarks:  
 DUGAN PRODUCTION CO. OWNS 21.375% (OIL ONLY) OUT OF BR'S  
 45.448090% WL BR BEARS 1/4 OF A 2.0% ORRI. XTO BEARS 1/2 OF THE  
 2% ORRI AND CONOCOPHILLIPS BEARS 1/4 OF THE 2.0% ORI. BR  
 BEARS ALL OF THE REST OF THE ORRI.

Serial Num	Description	Number of Acres	Ownership	Drilling Block	GW/Percentage	NRI/Percentage	Participation Factor
	T-027N R-010W			<b>Tract: 015</b>			
	SEC.034 ALL						
			TOTAL				

Tract Remarks:  
 TRACT NOT COMMITTED TO UNIT.

**BURLINGTON RESOURCES O&G CO LP - Operator**  
 The 052 Expanded Participating Area for Dakota Formation  
 Huerfano Unit Area  
 San Juan, New Mexico  
 Effective 10/01/2008

Serial Num	Description	Number of Acres	Ownership	Drilling Block	GW/Percentage	NRI/Percentage	Participation Factor
SF-079917	T-027N R-010W SEC.035 N1/2SE/4,S1/2S/2	240.00		<b>Tract: 016</b>			0.53012800
			ORRI:		0.00000000	7.11409900	
			ROYALTY:		0.00000000	12.50000000	
			WORKING INTEREST:	BURLINGTON RESOURCES O&G CO LP	63.61617000	48.55005000	
				KELLY MINERALS INTERESTS JV	0.41907500	0.36689100	
				LANGDON D HARRISON REVOC TRUST E	0.25143900	0.22000900	
				MARYAN KLINGER TRUST	0.20748600	0.18155000	
				PRODUCTION GATHERING COMPANY LP	0.41498200	0.36310900	
				XTO ENERGY INC	34.25123400	29.96983000	
				ZZZ KELLY & TRUST LLC	0.83961400	0.73466200	
			<b>TOTAL</b>		<b>100.00000000</b>	<b>100.00000000</b>	

Serial Num	Description	Number of Acres	Ownership	Drilling Block	GW/Percentage	NRI/Percentage	Participation Factor
SF-080017	T-027N R-010W SEC.035 NE/4	160.00		<b>Tract: 017</b>			0.35341900
			ORRI:		0.00000000	5.00000000	
			ROYALTY:		0.00000000	12.50000000	
			WORKING INTEREST:	XTO ENERGY INC	100.00000000	82.50000000	
			<b>TOTAL</b>		<b>100.00000000</b>	<b>100.00000000</b>	

**BURLINGTON RESOURCES O&G CO LP - Operator**  
 The 052 Expanded Participating Area for Dakota Formation  
 Huertano Unit Area  
 San Juan, New Mexico  
 Effective 10/01/2008

Serial Num	Description	Number of Acres	Ownership	Drilling Block	GWI Percentage	NRI Percentage	Participation Factor
NM-03017	T-026N R-009W	2,406.72		Tract: 018			5.31612700
	SEC.006 LOT.1	41.10	ORRI:		0.00000000	9.70632000	
	SEC.006 LOT.2	40.79	ROYALTY:		0.00000000	12.50000000	
	SEC.006 LOT.3	40.47	WORKING INTEREST:	BURLINGTON RESOURCES O&G CO LP	66.06000000	50.59618000	
	SEC.006 LOT.4	41.94		XTO ENERGY INC	33.94000000	27.19750000	
	SEC.006 LOT.5	41.88	TOTAL		100.00000000	100.00000000	
	SEC.006 LOT.6	41.94					
	SEC.006 LOT.7	41.99					
	SEC.006 SE/4 NW/4, SE/4 E/2 SW/4, S/2 NE/4						
	SEC.007 E/2, E/2 W/2						
	SEC.007 LOT.1	42.01					
	SEC.007 LOT.2	42.04					
	SEC.007 LOT.3	42.06					
	SEC.007 LOT.4	42.10					
	SEC.018 LOT.1	42.24					
	SEC.018 LOT.2	42.11					
	SEC.018 LOT.3	41.99					
	SEC.018 LOT.4	41.86					
	SEC.018 NE/4, E/2 W/2						



**BURLINGTON RESOURCES O&G CO LP - Operator**  
 The 052 Expanded Participating Area for Dakota Formation  
 Huerfano Unit Area  
 San Juan, New Mexico  
 Effective 10/01/2008

T-027N R-010W

SEC.036	LOT 1	35.10
SEC.036	LOT 2	35.07
SEC.036	LOT 3	35.03
SEC.036	LOT 4	35.00
SEC.036	W/2, W/2 E/2	

Tract Remarks:  
 XTO BEARS 2.5% ORRI AND BR BEARS THE REMAINDER.

Serial Num	Description	Number of Acres	Ownership	Drilling Block	GWl Percentage	NRI Percentage	Participation Factor
NW-01051	T-027N R-009W	564.80	ORRI:	<b>Tract: 019</b>	0.00000000	10.13470000	1.24756900
	SEC.031 LOT 1	40.75	ROYALTY:		0.00000000	12.50000000	
	SEC.031 LOT 2	41.05	WORKING INTEREST:		65.73469000	47.38972000	
	SEC.031 LOT 3	41.35	BURLINGTON RESOURCES O&G CO LP		0.05436000	0.04756400	
	SEC.031 LOT 4	41.65	KELLY MINERALS INTERESTS JV		0.03261700	0.02854000	
	NE/4, N/2 SE/4, E/2		LANGDON D HARRISON REVOC TRUST		0.02855600	0.02369000	
	W/2		MARYANKLINGER TRUST		0.05711000	0.04737800	
			PRODUCTION GATHERING COMPANY LP		33.98283300	29.73303400	
			XTO ENERGY INC		0.10993400	0.09537400	
			ZZZ KELLY & TRUST LLC		100.00000000	100.00000000	
	<b>TOTAL</b>						

Tract Remarks:  
 BRAND HUDSON POOL BEAR A 3.0% ORRI. BR BEARS THE REMAINING ORRI.

**BURLINGTON RESOURCES O&G CO LP - Operator**  
 The 052 Expanded Participating Area for Dakota Formation  
 Huertano Unit Area  
 San Juan, New Mexico  
 Effective 10/01/2008

Serial Num	Description	Number of Acres	Ownership	Drilling Block	GWI Percentage	NRI Percentage	Participation Factor
SF-078007		120.00		<b>Tract: 020</b>			0.26506400
	T-026N R-009W		ORRI:		0.00000000		9.70632000
	SEC 018 NW/4 SE/4		ROYALTY:		0.00000000		12.50000000
	T-027N R-009W		WORKING INTEREST:	BURLINGTON RESOURCES O&G COLP	66.06000000		50.59618000
	SEC 031 S/2 SE/4			XTO ENERGY INC	33.94000000		27.19750000
			<b>TOTAL</b>		<b>100.00000000</b>		<b>100.00000000</b>

Tract Remarks:  
 XTO BEARS 2.5% ORRI AND BR BEARS THE REMAINDER.

Serial Num	Description	Number of Acres	Ownership	Drilling Block	GWI Percentage	NRI Percentage	Participation Factor
SF-077936-A		319.87		<b>Tract: 021A</b>			0.70655100
	T-026N R-010W		ORRI:		0.00000000		7.11410000
	SEC 001 LOT 1		ROYALTY:		0.00000000		12.50000000
	SEC 001 LOT 2		WORKING INTEREST:	BURLINGTON RESOURCES O&G COLP	63.61617000		48.55004900
	SEC 001 SE/4, S/2 NE/4			KELLY MINERALS INTERESTS JV	0.41907500		0.36669100
				LANGDON D HARRISON REVOC TRUST E	0.25143900		0.22000900
				MARYANN KLINGER TRUST	0.20748600		0.18155000
				PRODUCTION GATHERING COMPANY LP	0.41498200		0.36310900
				XTO ENERGY INC	34.25123400		29.96983000
				ZZZ KELLY & TRUST LLC	0.83961400		0.73466200
			<b>TOTAL</b>		<b>100.00000000</b>		<b>100.00000000</b>

Tract Remarks:  
 BR BEARS 100% OF THE TOTAL ORRI.

**BURLINGTON RESOURCES O&G CO LP - Operator**  
 The 052 Expanded Participating Area for Dakota Formation  
 Huerfano Unit Area  
 San Juan, New Mexico  
 Effective 10/01/2008

Serial Num	Description	Number of Acres	Ownership	Drilling Block	GW% Percentage	NRI Percentage	Participation Factor
SF-078014	T-026N R-010W SEC.001 SW/4	320.00	ORRI: ROYALTY:	<b>Tract: 022</b>	0.00000000 0.00000000	7.11409900 12.50000000	0.70683800
	SEC.013 SE/4		WORKING INTEREST:	BURLINGTON RESOURCES O&G CO LP	63.61617000	48.55005000	
				KELLY MINERALS INTERESTS JV	0.41907500	0.36669100	
				LANGDON D HARRISON REVOC TRUST E	0.25143900	0.22000900	
				MARYANKLINGER TRUST	0.20748600	0.18155000	
				PRODUCTION GATHERING COMPANY LP	0.41498200	0.36310900	
				XTO ENERGY INC	34.25123400	29.96983000	
				ZZZ KELLY & TRUST LLC	0.83961400	0.73466200	
			<b>TOTAL</b>		<b>100.00000000</b>	<b>100.00000000</b>	
SF-077961	T-026N R-010W SEC.001 LOT 4	119.77	ORRI: ROYALTY:	<b>Tract: 023</b>	0.00000000 0.00000000	7.11409900 12.50000000	0.26455600
	SEC.001 S/2 NW/4	39.77	WORKING INTEREST:	BURLINGTON RESOURCES O&G CO LP	63.61617000	48.55005000	
				KELLY MINERALS INTERESTS JV	0.41907500	0.36669100	
				LANGDON D HARRISON REVOC TRUST E	0.25143900	0.22000900	
				MARYANKLINGER TRUST	0.20748600	0.18155000	
				PRODUCTION GATHERING COMPANY LP	0.41498200	0.36310900	
				XTO ENERGY INC	34.25123400	29.96983000	
				ZZZ KELLY & TRUST LLC	0.83961400	0.73466200	
			<b>TOTAL</b>		<b>100.00000000</b>	<b>100.00000000</b>	

Tract Remarks:  
 BR BEARS 100% OF THE TOTAL ORRI.

**BURLINGTON RESOURCES O&G CO LP - Operator**  
 The 052 Expanded Participating Area for Dakota Formation  
 Huertano Unit Area  
 San Juan, New Mexico  
 Effective 10/01/2008

Serial Num	Description	Number of Acres	Ownership	Drilling Block	GW/Percentage	NRI/Percentage	Participation Factor
SF-078001	T-026N R-010W SEC.029 N1/2NE/4	80.00		<b>Tract: 024</b>			0.17670900
			ORRI:		0.00000000	9.55777900	
			ROYALTY:		0.00000000	12.50000000	
			WORKING INTEREST:	BURLINGTON RESOURCES O&G CO LP	97.55617400	75.80387000	
				KELLY MINERALS INTERESTS JV	0.41907500	0.36669100	
				LANGDON D HARRISON REVOC TRUST E	0.25143900	0.22000900	
				MARYANKLINGER TRUST	0.20748200	0.18154900	
				PRODUCTION GATHERING COMPANY LF	0.41498200	0.36311000	
				XTO ENERGY INC	0.31123400	0.27233000	
				ZZZ KELLY & TRUST LLC	0.83961400	0.73466200	
			<b>TOTAL</b>		<b>100.00000000</b>	<b>100.00000000</b>	
SF-078001-A	T-026N R-010W SEC.008 S1/2N1/2	160.00		<b>Tract: 024A</b>			0.35341900
			ORRI:		0.00000000	7.11409900	
			ROYALTY:		0.00000000	12.50000000	
			WORKING INTEREST:	BURLINGTON RESOURCES O&G CO LP	63.61616700	48.55004700	
				KELLY MINERALS INTERESTS JV	0.41907500	0.36669200	
				LANGDON D HARRISON REVOC TRUST E	0.25143900	0.22000900	
				MARYANKLINGER TRUST	0.20748600	0.18155000	
				PRODUCTION GATHERING COMPANY LF	0.41498200	0.36310900	
				XTO ENERGY INC	34.25123400	29.96983000	
				ZZZ KELLY & TRUST LLC	0.83961600	0.73466400	
			<b>TOTAL</b>		<b>100.00000000</b>	<b>100.00000000</b>	

Tract Remarks:  
 BR BEARS 100% OF THE TOTAL ORRI.

**BURLINGTON RESOURCES O&G CO LP - Operator**  
 The 052 Expanded Participating Area for Dakota Formation  
 Huerfano Unit Area  
 San Juan, New Mexico  
 Effective 10/01/2008

Serial Num	Description	Number of Acres	Ownership	Drilling Block	GWI Percentage	NRI Percentage	Participation Factor
SF-078001-B	T-026N R-010W	999.84	ORRI:	<b>Tract: 024B</b>	0.00000000	7.11409900	2.20851500
	SEC.001 LOT 3	39.84	ROYALTY:		0.00000000	12.50000000	
	SEC.025 NW/4, N/2 NE/4		WORKING INTEREST:	BURLINGTON RESOURCES O&G CO LP	63.61616500	48.55004500	
	SEC.026 ALL			KELLY MINERALS INTERESTS JV	0.41907600	0.36669200	
	SEC.034 W/2 NW/4			LANGDON D HARRISON REVOC TRUST E	0.25143900	0.22000900	
				MARYANKLINGER TRUST	0.20748600	0.18153000	
				PRODUCTION GATHERING COMPANY LP	0.41498300	0.36311000	
				XTO ENERGY INC	34.25123400	29.96983000	
				ZZZ KELLY & TRUST LLC	0.83961700	0.73466500	
			TOTAL		100.00000000	100.00000000	

Serial Num	Description	Number of Acres	Ownership	Drilling Block	GWI Percentage	NRI Percentage	Participation Factor
SF-078267	T-026N R-010W	319.25	ORRI:	<b>Tract: 025</b>	0.00000000	7.11409900	0.70518100
	SEC.003 LOT 3	39.61	ROYALTY:		0.00000000	12.50000000	
	SEC.003 LOT 4	39.64	WORKING INTEREST:	BURLINGTON RESOURCES O&G CO LP	63.61616900	48.55004900	
	SEC.003 SW/4, S/2 NW/4			KELLY MINERALS INTERESTS JV	0.41907500	0.36669100	
				LANGDON D HARRISON REVOC TRUST E	0.25143900	0.22000900	
				MARYANKLINGER TRUST	0.20748600	0.18155000	
				PRODUCTION GATHERING COMPANY LP	0.41498300	0.36311000	
				XTO ENERGY INC	34.25123400	29.96983000	
				ZZZ KELLY & TRUST LLC	0.83961400	0.73466200	
			TOTAL		100.00000000	100.00000000	

Tract Remarks:  
 BR BEARS 100% OF THE TOTAL ORRI.

TOTAL

100.00000000

100.00000000

**BURLINGTON RESOURCES O&G CO LP - Operator**  
 The 052 Expanded Participating Area for Dakota Formation  
 Huerfano Unit Area  
 San Juan, New Mexico  
 Effective 10/01/2008

Serial Num	Description	Number of Acres	Ownership	Drilling Block	GWl Percentage	NRI Percentage	Participation Factor
SF-078267A	T-026N R-010W	319.11	ORRI:	<b>Tract: 025A</b>	0.00000000	7.11409900	0.70487200
	SEC.003 LOT.1	39.54	ROYALTY:		0.00000000	12.50000000	
	SEC.003 LOT.2	39.57	WORKING INTEREST:	BURLINGTON RESOURCES O&G CO LP	63.61616900	48.55004900	
	SEC.003 SE/4, S/2 NE/4			KELLY MINERALS INTERESTS JV	0.41907500	0.36669100	
				LANGDON D HARRISON REVOC TRUST E	0.25143900	0.22000900	
				MARYANKLINGER TRUST	0.20748600	0.18155000	
				PRODUCTION GATHERING COMPANY LF	0.41498300	0.36311000	
				XTO ENERGY INC	34.25123400	29.96983000	
				ZZZ KELLY & TRUST LLC	0.83961400	0.73466200	
			<b>TOTAL</b>		<b>100.00000000</b>	<b>100.00000000</b>	

Tract Remarks:  
 BR BEARS 100% OF THE TOTAL ORRI.

Serial Num	Description	Number of Acres	Ownership	Drilling Block	GWl Percentage	NRI Percentage	Participation Factor
NM-01366	T-026N R-010W	320.00	ORRI:	<b>Tract: 026</b>	0.00000000	14.38884800	0.70683800
	SEC.004 S/2		ROYALTY:		0.00000000	12.50000000	
			WORKING INTEREST:	BURLINGTON RESOURCES O&G CO LP	64.66658300	42.19444200	
				KELLY MINERALS INTERESTS JV	0.41907500	0.36669100	
				LANGDON D HARRISON REVOC TRUST E	0.25143900	0.22000900	
				XTO ENERGY INC	33.94000000	29.69750000	
				ZZZ KELLY & TRUST LLC	0.72290300	0.63254000	
			<b>TOTAL</b>		<b>100.00000000</b>	<b>100.00000000</b>	

Tract Remarks:  
 BR BEARS 100% OF THE TOTAL ORRI.

**BURLINGTON RESOURCES O&G CO LP - Operator**  
 The 052 Expanded Participating Area for Dakota Formation  
 Huertano Unit Area  
 San Juan, New Mexico  
 Effective 10/01/2008

Serial Num	Description	Number of Acres	Ownership	Drilling Block	GWI Percentage	NRI Percentage	Participation Factor
NM-0396	T-026N R-010W	319.96		<b>Tract: 027</b>			0.70674900
	SEC.004 LOT.1	39.74	ORRI:		0.00000000	10.10964200	
	SEC.004 LOT.2	39.91	ROYALTY:		0.00000000	12.50000000	
	SEC.004 LOT.3	40.07	WORKING INTEREST:	BURLINGTON RESOURCES O&G COLP	65.04244200	46.81562500	
	SEC.004 LOT.4	40.24		KELLY MINERALS INTERESTS JV	0.17440400	0.15260400	
				LANGDON D HARRISON REVOC TRUST E	0.10463900	0.09155900	
				MARYAN KLINGER TRUST	0.08645000	0.07305000	
				PRODUCTION GATHERING COMPANY LP	0.17291100	0.14610900	
				XTO ENERGY INC	34.06968000	29.80708000	
				ZZZ KELLY & TRUST LLC	0.34947400	0.30433100	
			<b>TOTAL</b>		<b>100.00000000</b>	<b>100.00000000</b>	

Serial Num	Description	Number of Acres	Ownership	Drilling Block	GWI Percentage	NRI Percentage	Participation Factor
SF-077934	T-026N R-010W	80.00		<b>Tract: 029</b>			0.17670900
	SEC.006 E/2 SW/4		ORRI:		0.00000000	7.11409900	
			ROYALTY:		0.00000000	12.50000000	
			WORKING INTEREST:	BURLINGTON RESOURCES O&G COLP	63.61619300	48.55004800	
				KELLY MINERALS INTERESTS JV	0.41906800	0.36669100	
				LANGDON D HARRISON REVOC TRUST E	0.25143500	0.22000900	
				MARYAN KLINGER TRUST	0.20748700	0.18155100	
				PRODUCTION GATHERING COMPANY LP	0.41498200	0.36311000	
				XTO ENERGY INC	34.25123400	29.96983000	
				ZZZ KELLY & TRUST LLC	0.83960100	0.73466200	
			<b>TOTAL</b>		<b>100.00000000</b>	<b>100.00000000</b>	

Tract Remarks:  
 BR BEARS 100% OF THE TOTAL ORRI.

**BURLINGTON RESOURCES O&G CO LP - Operator**  
 The 052 Expanded Participating Area for Dakota Formation  
 Huertano Unit Area  
 San Juan, New Mexico  
 Effective 10/01/2008

Serial Num	Description	Number of Acres	Ownership	Drilling Block	GWI Percentage	NRI Percentage	Participation Factor
SF-080425	T-026N R-010W	159.59	ORRI:	<b>Tract: 030</b>	0.00000000	12.40633700	0.35251300
	SEC.019 LOT.4	39.59	ROYALTY:		0.00000000	12.50000000	
	SEC.019 S/2SE/4, SE/4 SW/4		WORKING INTEREST:	BURLINGTON RESOURCES O&G CO LP	83.60675900	61.21832700	
				KELLY MINERALS INTERESTS JV	0.41902100	0.36664300	
				LANGDON D HARRISON REVOC TRUSTE	0.25140900	0.21998300	
				MACDONALD HALBERSTADT REVOCABL	15.00000000	12.65625000	
				ZZZ KELLY & TRUST LLC	0.72281100	0.63246000	
			<b>TOTAL</b>		<b>100.00000000</b>	<b>100.00000000</b>	

Tract Remarks:  
 BR BEARS 15% OF A 3.125% ORRI. BR BEARS ALL THE REMAINING ORRI.

Serial Num	Description	Number of Acres	Ownership	Drilling Block	GWI Percentage	NRI Percentage	Participation Factor
SF-080425-A	T-026N R-010W	237.11	ORRI:	<b>Tract: 030A</b>	0.00000000	9.96366600	0.52374500
	SEC.006 LOT.3	40.06	ROYALTY:		0.00000000	12.50000000	
	SEC.006 LOT.4	39.18	WORKING INTEREST:	BURLINGTON RESOURCES O&G CO LP	49.66658300	33.96334400	
	SEC.006 LOT.5	39.23		KELLY MINERALS INTERESTS JV	0.41907500	0.36669100	
	SEC.006 LOT.6	39.29		LANGDON D HARRISON REVOC TRUSTE	0.25143800	0.22000800	
	SEC.006 LOT.7	39.35		MACDONALD HALBERSTADT REVOCABL	15.00000000	12.65625000	
	SEC.006 SE/4 NW/4			XTO ENERGY INC	33.94000000	29.69750000	
				ZZZ KELLY & TRUST LLC	0.72290400	0.63254100	
			<b>TOTAL</b>		<b>100.00000000</b>	<b>100.00000000</b>	

Tract Remarks:  
 BR BEARS 15% OF A 3.125% ORRI. BR BEARS ALL THE REMAINING ORRI.



**BURLINGTON RESOURCES O&G CO LP - Operator**  
 The 052 Expanded Participating Area for Dakota Formation  
 Huerfano Unit Area  
 San Juan, New Mexico  
 Effective 10/01/2008

Serial Num	Description	Number of Acres	Ownership	Drilling Block	GWI Percentage	NRI Percentage	Participation Factor
SF-077942	T-028N R-010W	160.00	ORRI:	<b>Tract: 031</b>	0.00000000	7.11410600	0.35341900
	SEC.007 NE/4		ROYALTY:		0.00000000	12.50000000	
			WORKING INTEREST:		63.61635100	48.55019900	
					0.41902000	0.36664300	
					0.25140800	0.21998200	
					0.20748900	0.18155300	
					0.41497800	0.36310600	
					34.25123200	29.96982800	
					0.83952200	0.73458300	
			<b>TOTAL</b>		<b>100.00000000</b>	<b>100.00000000</b>	

Tract Remarks:  
 BR BEARS 100% OF THE TOTAL ORRI.

Serial Num	Description	Number of Acres	Ownership	Drilling Block	GWI Percentage	NRI Percentage	Participation Factor
SF-077942-A	T-028N R-010W	478.08	ORRI:	<b>Tract: 031A</b>	0.00000000	7.11410000	1.05601600
	SEC.007 LOT.1	39.42	ROYALTY:		0.00000000	12.50000000	
	SEC.007 LOT.2	39.48	WORKING INTEREST:		63.61617000	48.55004900	
	SEC.007 LOT.3	39.56			0.41907600	0.36669200	
	SEC.007 LOT.4	39.62			0.25143900	0.22000900	
					0.20748600	0.18155000	
					0.41498200	0.36310900	
					34.25123400	29.96983000	
					0.83961300	0.73466100	
			<b>TOTAL</b>		<b>100.00000000</b>	<b>100.00000000</b>	

Tract Remarks:  
 BR BEARS 100% OF THE TOTAL ORRI.

**BURLINGTON RESOURCES O&G CO LP - Operator**  
 The 052 Expanded Participating Area for Dakota Formation  
 Huerfano Unit Area  
 San Juan, New Mexico  
 Effective 10/01/2008

Serial Num	Description	Number of Acres	Ownership	Drilling Block	GW/Percentage	NRI/Percentage	Participation Factor
NM-0433	T-026N R-010W	480.00	ORRI:	<b>Tract: 032</b>	0.00000000	14.38881800	1.06025700
	SEC.008 N/2 N/2		ROYALTY:		0.00000000	12.50000000	
	SEC.009 W/2		WORKING INTEREST:	BURLINGTON RESOURCES O&G CO LP	64.66658200	42.19444100	
				KELLY MINERALS INTERESTS JV	0.41907500	0.36669100	
				LANGDON D HARRISON REVOC TRUST E	0.25143900	0.22000900	
				XTO ENERGY INC	33.94000000	29.69750000	
				ZZZ KELLY & TRUST LLC	0.72290400	0.63254100	
			<b>TOTAL</b>		<b>100.00000000</b>	<b>100.00000000</b>	
NM-0433-A	T-026N R-010W	160.00	ORRI:	<b>Tract: 032A</b>	0.00000000	14.38881800	0.35341900
	SEC.021 NW/4		ROYALTY:		0.00000000	12.50000000	
			WORKING INTEREST:	BURLINGTON RESOURCES O&G CO LP	64.66658200	42.19444100	
				KELLY MINERALS INTERESTS JV	0.41907500	0.36669100	
				LANGDON D HARRISON REVOC TRUST E	0.25143900	0.22000900	
				XTO ENERGY INC	33.94000000	29.69750000	
				ZZZ KELLY & TRUST LLC	0.72290400	0.63254100	
			<b>TOTAL</b>		<b>100.00000000</b>	<b>100.00000000</b>	

Tract Remarks:  
 BR BEARS 100% OF THE TOTAL ORRI.

**BURLINGTON RESOURCES O&G CO LP - Operator**

The 052 Expanded Participating Area for Dakota Formation

Huerfano Unit Area  
 San Juan, New Mexico  
 Effective 10/01/2008

Serial Num	Description	Number of Acres	Ownership	Drilling Block	GWl Percentage	NRI Percentage	Participation Factor
SF-080374	T-026N R-010W SEC.008 SE/4	160.00	ORRI: ROYALTY: WORKING INTEREST:	<b>Tract: 033</b>	0.00000000 0.00000000 63.61616900	7.11409900 12.50000000 48.55004900	0.35341900
			BURLINGTON RESOURCES O&G CO LP KELLY MINERALS INTERESTS JV LANGDON D HARRISON REVOC TRUSTE MARYAN KLINGER TRUST PRODUCTION GATHERING COMPANY LF XTO ENERGY INC ZZZ KELLY & TRUST LLC		0.41907500 0.25143900 0.20748600 0.41498300 34.25123400 0.83961400	0.36669100 0.22000900 0.18155000 0.36311000 29.96983000 0.73466200	
			TOTAL		100.00000000	100.00000000	0.35341900
SF-080374	T-026N R-010W SEC.008 SW/4	160.00	ORRI: ROYALTY: WORKING INTEREST:	<b>Tract: 033A</b>	0.00000000 0.00000000 63.61617000	7.11410000 12.50000000 48.55004900	0.35341900
			BURLINGTON RESOURCES O&G CO LP KELLY MINERALS INTERESTS JV LANGDON D HARRISON REVOC TRUSTE MARYAN KLINGER TRUST PRODUCTION GATHERING COMPANY LF XTO ENERGY INC ZZZ KELLY & TRUST LLC		0.41907600 0.25143900 0.20748600 0.41498200 34.25123400 0.83961300	0.36669200 0.22000900 0.18155000 0.36310900 29.96983000 0.73466100	
			TOTAL		100.00000000	100.00000000	0.35341900

Tract Remarks:  
 BR BEARS 100% OF THE TOTAL ORRI.

**BURLINGTON RESOURCES O&G CO LP - Operator**  
 The 052 Expanded Participating Area for Dakota Formation  
 Huerfano Unit Area  
 San Juan, New Mexico  
 Effective 10/01/2008

Serial Num	Description	Number of Acres	Ownership	Drilling Block	GWl Percentage	NRI Percentage	Participation Factor
SF-080456	T-026N R-010W SEC:029 SE/4	160.00	ORRI: ROYALTY: WORKING INTEREST:	<b>Tract: 034</b>	0.00000000 0.00000000 64.66658200	14.38881800 12.50000000 42.19444100	0.35341900
			BURLINGTON RESOURCES O&G CO LP KELLY MINERALS INTERESTS JV LANGDON D HARRISON REVOC TRUST E XTO ENERGY INC ZZZ KELLY & TRUST LLC		0.41907500 0.25143900 0.22000900 33.94000000 0.72290400	0.36669100 0.22000900 0.22000900 29.69750000 0.63254100	
			TOTAL		100.00000000	100.00000000	

Serial Num	Description	Number of Acres	Ownership	Drilling Block	GWl Percentage	NRI Percentage	Participation Factor
SF-080120	T-026N R-010W SEC:029 S/2 SE/4	80.00	ORRI: ROYALTY: WORKING INTEREST:	<b>Tract: 035</b>	0.00000000 0.00000000 98.98244200	12.55291900 12.50000000 74.06984800	0.17670900
			BURLINGTON RESOURCES O&G CO LP KELLY MINERALS INTERESTS JV LANGDON D HARRISON REVOC TRUST E MARYAN KLINGER TRUST PRODUCTION GATHERING COMPANY LF XTO ENERGY INC ZZZ KELLY & TRUST LLC		0.17440400 0.10463900 0.08644900 0.17291100 0.12968000 0.34947500	0.15260400 0.09155900 0.07305000 0.14610900 0.10958000 0.30433100	
			TOTAL		100.00000000	100.00000000	

Tract Remarks:  
 BR AND HUDSON POOL BEAR A 3.0% ORRI. BR BEARS THE REMAINING ORRI.

**BURLINGTON RESOURCES O&G CO LP - Operator**  
 The 052 Expanded Participating Area for Dakota Formation  
 Huerfano Unit Area  
 San Juan, New Mexico  
 Effective 10/01/2008

Serial Num	Description	Number of Acres	Ownership	Drilling Block	GWI Percentage	NRI Percentage	Participation Factor
SF-080120-A	T-026N R-010W	160.00	ORRI:	<b>Tract: 035A</b>	0.00000000	10.10964200	0.35341900
	SEC.009 NE/4		ROYALTY:		0.00000000	12.50000000	
			WORKING INTEREST:	BURLINGTON RESOURCES O&G CO LP	65.04244200	46.81562500	
				KELLY MINERALS INTERESTS JV	0.17440400	0.15260400	
				LANGDON D HARRISON REVOC TRUST E	0.10463900	0.09155900	
				MARYANKLINGER TRUST	0.08644900	0.07305000	
				PRODUCTION GATHERING COMPANY LF	0.17291000	0.14610800	
				XTO ENERGY INC	34.06968000	29.80708000	
				ZZZ KELLY & TRUST LLC	0.34947600	0.30433200	
			<b>TOTAL</b>		<b>100.00000000</b>	<b>100.00000000</b>	<b>0.70683800</b>

Tract Remarks:  
 BR AND HUDSON POOL BEAR A 3.0% ORRI. BR BEARS THE REMAINING ORRI.

Serial Num	Description	Number of Acres	Ownership	Drilling Block	GWI Percentage	NRI Percentage	Participation Factor
SF-079658	T-026N R-010W	320.00	ORRI:	<b>Tract: 036</b>	0.00000000	7.11409900	0.70683800
	SEC.010 W/2		ROYALTY:		0.00000000	12.50000000	
			WORKING INTEREST:	BURLINGTON RESOURCES O&G CO LP	63.61616900	48.55004900	
				KELLY MINERALS INTERESTS JV	0.41907500	0.36669100	
				LANGDON D HARRISON REVOC TRUST E	0.25143900	0.22000900	
				MARYANKLINGER TRUST	0.20748600	0.18155000	
				PRODUCTION GATHERING COMPANY LF	0.41498300	0.36311000	
				XTO ENERGY INC	34.25123400	29.96983000	
				ZZZ KELLY & TRUST LLC	0.83961400	0.73466200	
			<b>TOTAL</b>		<b>100.00000000</b>	<b>100.00000000</b>	<b>0.70683800</b>

Tract Remarks:  
 BR BEARS 100% OF THE TOTAL ORRI.

SF-079658

**BURLINGTON RESOURCES O&G CO LP - Operator**  
 The 052 Expanded Participating Area for Dakota Formation  
 Huerfano Unit Area  
 San Juan, New Mexico  
 Effective 10/01/2008

Serial Num	Description	Number of Acres	Ownership	Drilling Block	GWI Percentage	NRI Percentage	Participation Factor
SF-079658-A	T-026N R-010W SEC.010 E/2	320.00		<b>Tract: 036A</b>			0.70683800
Tract Remarks: BR BEARS 100% OF THE TOTAL ORRI.			ORRI:		0.00000000	7.14409900	
			ROYALTY:		0.00000000	12.50000000	
			WORKING INTEREST:	BURLINGTON RESOURCES O&G COLP	63.61616900	48.55004900	
				KELLY MINERALS INTERESTS JV	0.41907500	0.36669100	
				LANGDON D HARRISON REVOC TRUST E	0.25143900	0.22000900	
				MARYAN KLINGER TRUST	0.20748500	0.18154900	
				PRODUCTION GATHERING COMPANY LP	0.41498300	0.36311000	
				XTO ENERGY INC	34.25123400	29.96983000	
				ZZZ KELLY & TRUST LLC	0.83961500	0.73466300	
			<b>TOTAL</b>		<b>100.00000000</b>	<b>100.00000000</b>	
NM-01365	T-026N R-010W SEC.011 SE/4 SEC.014 NE/4 SEC.015 N/2	640.00		<b>Tract: 037</b>			1.41367500
Tract Remarks: BR BEARS 100% OF THE TOTAL ORRI.			ORRI:		0.00000000	14.38881800	
			ROYALTY:		0.00000000	12.50000000	
			WORKING INTEREST:	BURLINGTON RESOURCES O&G COLP	64.66668200	42.19444100	
				KELLY MINERALS INTERESTS JV	0.41907500	0.36669100	
				LANGDON D HARRISON REVOC TRUST E	0.25143900	0.22000900	
				XTO ENERGY INC	33.94000000	29.69750000	
				ZZZ KELLY & TRUST LLC	0.72290400	0.63254100	
			<b>TOTAL</b>		<b>100.00000000</b>	<b>100.00000000</b>	

**BURLINGTON RESOURCES O&G CO LP - Operator**  
 The 052 Expanded Participating Area for Dakota Formation  
 Huertano Unit Area  
 San Juan, New Mexico  
 Effective 10/01/2008

Serial Num	Description	Number of Acres	Ownership	Drilling Block	GWl Percentage	NRI Percentage	Participation Factor
SF-080646	T-026N R-010W SEC.011 NW/4	160.00		<b>Tract: 038</b>			
			ORRI:		0.00000000	7.11409900	0.35341900
			ROYALTY:		0.00000000	12.50000000	
			WORKING INTEREST:	BURLINGTON RESOURCES O&G CO LP	63.61616900	48.55004900	
				KELLY MINERALS INTERESTS JV	0.41907500	0.36669100	
				LANGDON D HARRISON REVOC TRUST E	0.25143900	0.22000900	
				MARYAN KLINGER TRUST	0.20748500	0.18154900	
				PRODUCTION GATHERING COMPANY LF	0.41498300	0.36311000	
				XTO ENERGY INC	34.25123400	29.96983000	
				ZZZ KELLY & TRUST LLC	0.83961500	0.73466300	
			<b>TOTAL</b>		<b>100.00000000</b>	<b>100.00000000</b>	

Serial Num	Description	Number of Acres	Ownership	Drilling Block	GWl Percentage	NRI Percentage	Participation Factor
SF-080795	T-026N R-010W SEC.011 NE/4	160.00		<b>Tract: 039</b>			
			ORRI:		0.00000000	7.11409900	0.35341900
			ROYALTY:		0.00000000	12.50000000	
			WORKING INTEREST:	BURLINGTON RESOURCES O&G CO LP	63.61616900	48.55004900	
				KELLY MINERALS INTERESTS JV	0.41907500	0.36669100	
				LANGDON D HARRISON REVOC TRUST E	0.25143900	0.22000900	
				MARYAN KLINGER TRUST	0.20748500	0.18154900	
				PRODUCTION GATHERING COMPANY LF	0.41498300	0.36311000	
				XTO ENERGY INC	34.25123400	29.96983000	
				ZZZ KELLY & TRUST LLC	0.83961500	0.73466300	
			<b>TOTAL</b>		<b>100.00000000</b>	<b>100.00000000</b>	

Tract Remarks:  
 BR BEARS 100% OF THE TOTAL ORRI

**BURLINGTON RESOURCES O&G CO LP - Operator**  
 The 052 Expanded Participating Area for Dakota Formation  
 Huertano Unit Area  
 San Juan, New Mexico  
 Effective 10/01/2008

Serial Num	Description	Number of Acres	Ownership	Drilling Block	GWl Percentage	NRI Percentage	Participation Factor
SF-080433	T-026N R-010W SEC.011 SW/4	160.00		<b>Tract: 040</b>			0.35341900
			ORRI:		0.00000000	7.11409900	
			ROYALTY:		0.00000000	12.50000000	
			WORKING INTEREST:	BURLINGTON RESOURCES O&G CO LP	63.61616900	48.55049900	
				KELLY MINERALS INTERESTS JV	0.41907500	0.36669100	
				LANGDON D HARRISON REVOC TRUST E	0.25143900	0.22000900	
				MARYAN KLINGER TRUST	0.20748500	0.18154900	
				PRODUCTION GATHERING COMPANY LP	0.41498300	0.36311000	
				XTO ENERGY INC	34.25123400	29.96983000	
				ZZZ KELLY & TRUST LLC	0.83961500	0.73466300	
			<b>TOTAL</b>		<b>100.00000000</b>	<b>100.00000000</b>	
SF-081024	T-026N R-010W SEC.012 NE/4	160.00		<b>Tract: 041</b>			0.35341900
			ORRI:		0.00000000	14.38881800	
			ROYALTY:		0.00000000	12.50000000	
			WORKING INTEREST:	BURLINGTON RESOURCES O&G CO LP	64.66668200	42.19444100	
				KELLY MINERALS INTERESTS JV	0.41907500	0.36669100	
				LANGDON D HARRISON REVOC TRUST E	0.25143900	0.22000900	
				XTO ENERGY INC	33.94000000	29.69750000	
				ZZZ KELLY & TRUST LLC	0.72290400	0.63254100	
			<b>TOTAL</b>		<b>100.00000000</b>	<b>100.00000000</b>	

Tract Remarks:  
 BR BEARS 100% OF THE TOTAL ORRI.



**BURLINGTON RESOURCES O&G CO LP - Operator**

The 052 Expanded Participating Area for Dakota Formation  
 Huerfano Unit Area  
 San Juan, New Mexico  
 Effective 10/01/2008

892000731A

Serial Num	Description	Number of Acres	Ownership	Drilling Block	GWI Percentage	NRI Percentage	Participation Factor
SF-077935	T-026N R-010W	520.00	ORRI:	<b>Tract: 042</b>	0.00000000	7.11409900	1.14861100
	SEC.012 NW/4NW/4, SE/4		ROYALTY:		0.00000000	12.50000000	
	SEC.013 NE/4, SW/4		WORKING INTEREST:	BURLINGTON RESOURCES O&G CO LP	63.61616900	48.55004900	
				KELLY MINERALS INTERESTS JV	0.41907500	0.36669100	
				LANGDON D HARRISON REVOC TRUST E	0.25143900	0.22000900	
				MARYANKLINGER TRUST	0.20748500	0.18154900	
				PRODUCTION GATHERING COMPANY LF	0.41498300	0.36311000	
				XTO ENERGY INC	34.25123400	29.96983000	
				ZZZ KELLY & TRUST LLC	0.83961500	0.73466300	
			<b>TOTAL</b>		<b>100.00000000</b>	<b>100.00000000</b>	
SF-077806	T-026N R-010W	640.00	ORRI:	<b>Tract: 043</b>	0.00000000	7.11409900	1.14367500
	SEC.012 SW/4		ROYALTY:		0.00000000	12.50000000	
	SEC.014 NW/4		WORKING INTEREST:	BURLINGTON RESOURCES O&G CO LP	63.61616900	48.55004900	
	SEC.015 S/2			KELLY MINERALS INTERESTS JV	0.41907500	0.36669100	
				LANGDON D HARRISON REVOC TRUST E	0.25143900	0.22000900	
				MARYANKLINGER TRUST	0.20748500	0.18154900	
				PRODUCTION GATHERING COMPANY LF	0.41498300	0.36311000	
				XTO ENERGY INC	34.25123400	29.96983000	
				ZZZ KELLY & TRUST LLC	0.83961500	0.73466300	
			<b>TOTAL</b>		<b>100.00000000</b>	<b>100.00000000</b>	

Tract Remarks:  
 BR BEARS 100% OF THE TOTAL ORRI.

**BURLINGTON RESOURCES O&G CO LP - Operator**  
 The 052 Expanded Participating Area for Dakota Formation  
 Huerfano Unit Area  
 San Juan, New Mexico  
 Effective 10/01/2008

Serial Num	Description	Number of Acres	Ownership	Drilling Block	GWI Percentage	NRI Percentage	Participation Factor
NM-015151	T-026N R-010W	120.00	ORRI:	<b>Tract: 044</b>	0.00000000	5.00000000	0.26506400
	SEC.012 E/2 NW/4, SW/4 NW/4		ROYALTY:		0.00000000	12.50000000	
			WORKING INTEREST: XTO ENERGY INC		100.00000000	82.50000000	
			<b>TOTAL</b>		100.00000000	100.00000000	

Serial Num	Description	Number of Acres	Ownership	Drilling Block	GWI Percentage	NRI Percentage	Participation Factor
NM-01368	T-026N R-009W	160.00	ORRI:	<b>Tract: 045</b>	0.00000000	7.11409900	0.35341900
	SEC.013 NW/4		ROYALTY:		0.00000000	12.50000000	
			WORKING INTEREST: BURLINGTON RESOURCES O&G CO LP		63.61616900	48.55004900	
			KELLY MINERALS INTERESTS JV		0.41907500	0.3669100	
			LANGDON D HARRISON REVOC TRUST		0.25143900	0.22000900	
			MARYAN KLINGER TRUST		0.20748500	0.18154900	
			PRODUCTION GATHERING COMPANY LP		0.41498300	0.36311000	
			XTO ENERGY INC		34.25123400	29.96983000	
			ZZZ KELLY & TRUST LLC		0.83961500	0.73468300	
			<b>TOTAL</b>		100.00000000	100.00000000	

Tract Remarks:  
 BR BEARS 100% OF THE TOTAL ORRI.

**BURLINGTON RESOURCES O&G CO LP - Operator**  
 The 052 Expanded Participating Area for Dakota Formation  
 Huerfano Unit Area  
 San Juan, New Mexico  
 Effective 10/01/2008

Serial Num	Description	Number of Acres	Ownership	Drilling Block	GWl Percentage	NRI Percentage	Participation Factor
SF-079617	T-026N R-010W	160.00	ORRI:	<b>Tract: 046</b>	0.00000000	14.38881800	0.35341900
	SEC.014 SW/4		ROYALTY:		0.00000000	12.50000000	
			WORKING INTEREST:		64.66658200	42.19444100	
			BURLINGTON RESOURCES O&G CO LP		0.41907500	0.36669100	

Tract Remarks:  
 BR BEARS 100% OF THE TOTAL ORRI.

			BURLINGTON RESOURCES O&G CO LP	0.25143900	0.22000900	
			KELLY MINERALS INTERESTS JV	33.94000000	29.69750000	
			LANGDON D HARRISON REVOC TRUST E	0.72290400	0.63254100	
			XTO ENERGY INC	100.00000000	100.00000000	
			ZZZ KELLY & TRUST LLC			
			<b>TOTAL</b>			

Serial Num	Description	Number of Acres	Ownership	Drilling Block	GWl Percentage	NRI Percentage	Participation Factor
SF-078020	T-025N R-010W	1,039.60	ORRI:	<b>Tract: 047</b>	0.00000000	11.45000000	2.29633900
	SEC.001 LOT 1		ROYALTY:		0.00000000	12.50000000	
	SEC.001 LOT 2		WORKING INTEREST:		100.00000000	76.05000000	
	SEC.001 LOT 3		BURLINGTON RESOURCES O&G CO LP		100.00000000	100.00000000	
	SEC.001 LOT 4						
	SEC.001 S/2, S/2 N/2						
	SEC.012 N/2, E/2 SE/4						
			<b>TOTAL</b>				

Tract Remarks:  
 BR BEARS 100% OF THE TOTAL ORRI.

**BURLINGTON RESOURCES O&G CO LP - Operator**  
 The 052 Expanded Participating Area for Dakota Formation

Huerfano Unit Area  
 San Juan, New Mexico  
 Effective 10/01/2008

Serial Num	Description	Number of Acres	Ownership	Drilling Block	GWI Percentage	NRI Percentage	Participation Factor
NM-02874	T-028N R-010W	200.00	ORRI:	<b>Tract: 048</b>	0.00000000	16.62500000	0.44177400
	SEC.033 NE/4 NW/4, NE/4		ROYALTY:		0.00000000	12.50000000	
			WORKING INTEREST:		100.00000000	70.87500000	
					100.00000000	100.00000000	
			<b>TOTAL</b>		<b>100.00000000</b>	<b>100.00000000</b>	

Tract Remarks:  
 BR BEARS 100% OF THE TOTAL ORRI.

Serial Num	Description	Number of Acres	Ownership	Drilling Block	GWI Percentage	NRI Percentage	Participation Factor
NM-02874-A	T-028N R-010W	1,160.00	ORRI:	<b>Tract: 048A</b>	0.00000000	14.18132000	2.56228700
	SEC.014 SE/4		ROYALTY:		0.00000000	12.50000000	
	SEC.017 SE/4		WORKING INTEREST:		66.06000000	43.62118000	
	SEC.020 NE/4				33.94000000	29.69750000	
	SEC.022 SE/4, SE/4 SW/4				100.00000000	100.00000000	
	SEC.034 E/2 NW/4, S/2 NE/4						
	SEC.035 W/2						
			<b>TOTAL</b>		<b>100.00000000</b>	<b>100.00000000</b>	

Tract Remarks:  
 BR BEARS 100% OF THE TOTAL ORRI.

**BURLINGTON RESOURCES O&G CO LP - Operator**  
 The 052 Expanded Participating Area for Dakota Formation

Huerfano Unit Area  
 San Juan, New Mexico  
 Effective 10/01/2008

Serial Num	Description	Number of Acres	Ownership	Drilling Block	GW/Percentage	NRI/Percentage	Participation Factor
SF-078012	T-026N R-010W SEC.017 NE/4	160.00	ORRI: ROYALTY: WORKING INTEREST:	<b>Tract: 049</b>	0.00000000 0.00000000 63.61616900	7.11409900 12.50000000 48.65004900	0.35341900
					0.41907500 0.25143900 0.20748500	0.36669100 0.22000900 0.18154900	
					0.41498300 34.25123400 0.83961500	0.36311000 29.96983000 0.73466300	
					0.00000000 0.00000000 97.56350000	9.55778600 12.50000000 75.80402000	0.70480600
SF-077933	T-026N R-010W SEC.019 LOT.1 SEC.019 LOT.2 SEC.019 NE/4, E/2NW/4	319.08	ORRI: ROYALTY: WORKING INTEREST:	<b>Tract: 051</b>	0.00000000 0.00000000 97.56350000	9.55778600 12.50000000 75.80402000	0.70480600
					0.25140800 0.20749000 0.41497800	0.21998200 0.18155400 0.36310600	
					0.31123200 0.83952100	0.27232800 0.73458100	
					100.00000000	100.00000000	

Tract Remarks:  
 BR BEARS 100% OF THE TOTAL ORRI.

**BURLINGTON RESOURCES O&G CO LP - Operator**  
 The 052 Expanded Participating Area for Dakota Formation  
 Huerfano Unit Area  
 San Juan, New Mexico  
 Effective 10/01/2008

Serial Num	Description	Number of Acres	Ownership	Drilling Block	GWI Percentage	NRI Percentage	Participation Factor
SF-077933-A	T-026N R-010W SEC.020 SE/4, W/2 NW/4, SE/4 NW/4	280.00	ORRI: ROYALTY: WORKING INTEREST:	<b>Tract: 051A</b> BURLINGTON RESOURCES O&G CO LP KELLY MINERALS INTERESTS JV LANGDON D HARRISON REVOC TRUST E MARYAN KLINGER TRUST PRODUCTION GATHERING COMPANY LP XTO ENERGY INC ZZZ KELLY & TRUST LLC	0.00000000 0.00000000 63.61616900 0.41907500 0.25143900 0.20748600 0.41498300 34.25123400 0.83961400	7.11409900 12.50000000 48.55004900 0.36689100 0.22000900 0.18155000 0.36311000 29.96983000 0.73466200	0.61848300
			TOTAL		100.00000000	100.00000000	
SF-081051	T-026N R-010W SEC.019 LOT.3 SEC.019 NE/4 SW/4, N/2 SE/4	159.57 39.57	ORRI: ROYALTY: WORKING INTEREST:	<b>Tract: 052</b> BURLINGTON RESOURCES O&G CO LP KELLY MINERALS INTERESTS JV LANGDON D HARRISON REVOC TRUST E MARYAN KLINGER TRUST PRODUCTION GATHERING COMPANY LP XTO ENERGY INC ZZZ KELLY & TRUST LLC	0.00000000 0.00000000 63.61634600 0.41902100 0.25140800 0.20749000 0.41497900 34.25123200 0.83952400	7.11410600 12.49998800 48.55019600 0.36664300 0.21998200 0.18155400 0.36310700 29.96983000 0.73458400	0.35246900
			TOTAL		100.00000000	100.00000000	

Tract Remarks:  
 BR BEARS 100% OF THE TOTAL ORRI.

**BURLINGTON RESOURCES O&G CO LP - Operator**  
 The 052 Expanded Participating Area for Dakota Formation  
 Huertano Unit Area  
 San Juan, New Mexico  
 Effective 10/01/2008

Serial Num	Description	Number of Acres	Ownership	Drilling Block	GWI Percentage	NRI Percentage	Participation Factor
SF-080893	T-026N R-010W	160.00	ORRI:	<b>Tract: 053</b>	0.00000000	7.11410600	0.35341900
	SEC.020 SW/4		ROYALTY:		0.00000000	12.49999800	
			WORKING INTEREST:		BURLINGTON RESOURCES O&G CO LP	63.61634600	
				KELLY MINERALS INTERESTS JV	0.41902100	0.36664300	
				LANGDON D HARRISON REVOC TRUST E	0.25140800	0.21998200	
				MARYANKLINGER TRUST	0.20749000	0.18155400	
				PRODUCTION GATHERING COMPANY LP	0.41497900	0.36310700	
				XTO ENERGY INC	34.25123200	29.96983000	
				ZZZ KELLY & TRUST LLC	0.83952400	0.73458400	
			TOTAL		100.00000000	100.00000000	

Serial Num	Description	Number of Acres	Ownership	Drilling Block	GWI Percentage	NRI Percentage	Participation Factor
SF-081363	T-026N R-010W	280.00	ORRI:	<b>Tract: 054</b>	0.00000000	14.38881800	0.61848300
	SEC.021 NW/4 NE/4, SW/4		ROYALTY:		0.00000000	12.50000000	
	SEC.022 SE/4 NE/4		WORKING INTEREST:		BURLINGTON RESOURCES O&G CO LP	64.66668200	
				KELLY MINERALS INTERESTS JV	0.41907500	0.36669100	
				LANGDON D HARRISON REVOC TRUST E	0.25143900	0.22000900	
				XTO ENERGY INC	33.94000000	29.69750000	
				ZZZ KELLY & TRUST LLC	0.72290400	0.63254100	
			TOTAL		100.00000000	100.00000000	

Tract Remarks:  
 BR BEARS 100% OF THE TOTAL ORRI.

**BURLINGTON RESOURCES O&G CO LP - Operator**  
 The 052 Expanded Participating Area for Dakota Formation  
 Huertano Unit Area  
 San Juan, New Mexico  
 Effective 10/01/2008

Serial Num	Description	Number of Acres	Ownership	Drilling Block	GWI Percentage	NRI Percentage	Participation Factor
SF-077938	T-026N R-010W	640.00	ORRI:	<b>Tract: 055</b>	0.00000000	7.11409900	1.41367500
	SEC.021 SW/4		ROYALTY:		0.00000000	12.50000000	
	SEC.023 S/2 NE/4, SW/4, N/2 SE/4		WORKING INTEREST:	BURLINGTON RESOURCES O&G CO LP	63.61616900	48.55004900	
	SEC.024 NW/4			KELLY MINERALS INTERESTS JV	0.41907500	0.36669100	
				LANGDON D HARRISON REVOC TRUST E	0.25143900	0.22000900	
				MARYAN KLINGER TRUST	0.20748600	0.18155000	
				PRODUCTION GATHERING COMPANY LF	0.41498300	0.36311000	
				XTO ENERGY INC	34.25123400	29.96983000	
				ZZZ KELLY & TRUST LLC	0.83961400	0.73466200	
			TOTAL		100.00000000	100.00000000	

Tract Remarks:  
 BR BEARS 100% OF THE TOTAL ORRI.

Serial Num	Description	Number of Acres	Ownership	Drilling Block	GWI Percentage	NRI Percentage	Participation Factor
SF-078429	T-026N R-010W	160.00	ORRI:	<b>Tract: 056</b>	0.00000000	6.88881800	0.35341900
	SEC.021 NE/4 NE/4		ROYALTY:		0.00000000	12.50000000	
	SEC.022 N/2 NW/4, SE/4 NW/4		WORKING INTEREST:	BURLINGTON RESOURCES O&G CO LP	64.66658300	49.69444200	
				KELLY MINERALS INTERESTS JV	0.41907600	0.36669200	
				LANGDON D HARRISON REVOC TRUST E	0.25143700	0.22000700	
				XTO ENERGY INC	33.94000000	29.69750000	
				ZZZ KELLY & TRUST LLC	0.72290400	0.63254100	
			TOTAL		100.00000000	100.00000000	

Tract Remarks:  
 BR BEARS 100% OF THE TOTAL ORRI.



**BURLINGTON RESOURCES O&G CO LP - Operator**  
 The 052 Expanded Participating Area for Dakota Formation  
 Huerfano Unit Area  
 San Juan, New Mexico  
 Effective 10/01/2008

Serial Num	Description	Number of Acres	Ownership	Drilling Block	GW/Percentage	NRI/Percentage	Participation Factor
SF-077812	T-026N R-010W	40.00		<b>Tract: 057</b>			0.08835500

	SEC.022 NE/4 SW/4		ORRI:		0.00000000	7.11409900	
			ROYALTY:		0.00000000	12.50000000	
			WORKING INTEREST:	BURLINGTON RESOURCES O&G CO LP	63.61616900	48.55004900	
				KELLY MINERALS INTERESTS JV	0.41907500	0.36659100	
				LANGDON D HARRISON REVOC TRUST E	0.25143900	0.22000900	
				MARYANKLINGER TRUST	0.20748600	0.18155000	
				PRODUCTION GATHERING COMPANY LP	0.41498300	0.36311000	
				XTO ENERGY INC	34.25123400	29.96983000	
				ZZZ KELLY & TRUST LLC	0.83961400	0.73466200	
			<b>TOTAL</b>		<b>100.00000000</b>	<b>100.00000000</b>	

Serial Num	Description	Number of Acres	Ownership	Drilling Block	GW/Percentage	NRI/Percentage	Participation Factor
SF-077981	T-026N R-010W	120.00		<b>Tract: 058</b>			0.26506400
	SEC.022 N/2 NE/4, SW/4 NE/4		ORRI:		0.00000000	4.00000000	
			ROYALTY:		0.00000000	12.50000000	
			WORKING INTEREST:	XTO ENERGY INC	100.00000000	83.50000000	
			<b>TOTAL</b>		<b>100.00000000</b>	<b>100.00000000</b>	





**BURLINGTON RESOURCES O&G CO LP - Operator**  
 The 052 Expanded Participating Area for Dakota Formation  
 Huerfano Unit Area  
 San Juan, New Mexico  
 Effective 10/01/2008

Serial Num	Description	Number of Acres	Ownership	Drilling Block	GWI Percentage	NRI Percentage	Participation Factor
SF-079942	T-026N R-010W SEC.024 SW/4 NE/4, SE/4	200.00	ORRI: ROYALTY: WORKING INTEREST:	<b>Tract: 063</b>	0.00000000 0.00000000 63.61617100	10.18090200 12.50000000 45.51607300	0.44177400
Tract Remarks: BR AND HUDSON POOL BEARS 15% OF A 3.125% ORRI. BR BEARS ALL THE REMAINING ORRI.							
Ownership Breakdown for Tract 063:							
			BURLINGTON RESOURCES O&G CO LP		0.41907500	0.3669200	
			KELLY MINERALS INTERESTS JV		0.25143900	0.22000900	
			LANGDON D HARRISON REVOC TRUST E		0.20748900	0.17506900	
			MARYAN KLINGER TRUST		0.41497800	0.35013800	
			PRODUCTION GATHERING COMPANY LF		34.25123200	29.96010200	
			XTO ENERGY INC		0.83961500	0.73101500	
			ZZZ KELLY & TRUST LLC		100.00000000	100.00000000	
TOTAL 100.00000000 100.00000000							
SF-076605	T-026N R-010W SEC.025 SE/4	160.00	ORRI: ROYALTY: WORKING INTEREST:	<b>Tract: 064</b>	0.00000000 0.00000000 63.61616900	7.11409900 12.50000000 48.55004900	0.35341900
Tract Remarks: BR BEARS 100% OF THE TOTAL ORRI.							
Ownership Breakdown for Tract 064:							
			BURLINGTON RESOURCES O&G CO LP		0.41907500	0.3669100	
			KELLY MINERALS INTERESTS JV		0.25143900	0.22000900	
			LANGDON D HARRISON REVOC TRUST E		0.20748600	0.18155000	
			MARYAN KLINGER TRUST		0.41498300	0.36311000	
			PRODUCTION GATHERING COMPANY LF		34.25123400	29.96983000	
			XTO ENERGY INC		0.83961400	0.73466200	
			ZZZ KELLY & TRUST LLC		100.00000000	100.00000000	
TOTAL 100.00000000 100.00000000							

**BURLINGTON RESOURCES O&G CO LP - Operator**  
 The 052 Expanded Participating Area for Dakota Formation  
 Huerfano Unit Area  
 San Juan, New Mexico  
 Effective 10/01/2008

Serial Num	Description	Number of Acres	Ownership	Drilling Block	GWl Percentage	NRI Percentage	Participation Factor
SF-080894	T-026N R-010W SEC.025 S/2 NE/4	80.00	ORRI: ROYALTY: WORKING INTEREST:	<b>Tract: 065</b> BURLINGTON RESOURCES O&G CO LP KELLY MINERALS INTERESTS JV LANGDON D HARRISON REVOC TRUST MACDONALD HALBERSTADT REVOCABL XTO ENERGY INC ZZZ KELLY & TRUST LLC	0.00000000 0.00000000 49.66658200 0.41907500 0.25143900 15.00000000 33.94000000 0.72290400	6.88881800 12.50000000 36.56944100 0.36669100 0.22000900 13.12500000 29.69750000 0.63254100	0.17670900
SF-077949	T-026N R-010W SEC.025 SW/4	160.00	ORRI: ROYALTY: WORKING INTEREST:	<b>Tract: 066</b> BURLINGTON RESOURCES O&G CO LP KELLY MINERALS INTERESTS JV LANGDON D HARRISON REVOC TRUST MARYAN KLINGER TRUST PRODUCTION GATHERING COMPANY LF XTO ENERGY INC ZZZ KELLY & TRUST LLC	0.00000000 0.00000000 63.61616900 0.41907500 0.25143900 0.20748600 0.41498300 34.25123400 0.83961400	7.11409900 12.50000000 48.55004900 0.36669100 0.22000900 0.16155000 0.36311000 29.96983000 0.73466200	0.35341900
<b>TOTAL</b>					<b>100.00000000</b>	<b>100.00000000</b>	

Tract Remarks:  
 BR BEARS 100% OF THE TOTAL ORRI.

**BURLINGTON RESOURCES O&G CO LP - Operator**  
 The 052 Expanded Participating Area for Dakota Formation  
 Huertano Unit Area  
 San Juan, New Mexico  
 Effective 10/01/2008

Serial Num	Description	Number of Acres	Ownership	Drilling Block	GWL Percentage	NRI Percentage	Participation Factor	
NM-02515	T-026N R-010W	960.00	ORRI:	<b>Tract: 067</b>	0.00000000	7.11409900	2.12051300	
	SEC:027 W/2		ROYALTY:		0.00000000	12.50000000		
	SEC:028 ALL		WORKING INTEREST:		BURLINGTON RESOURCES O&G CO LP	63.61616900	48.55004900	
					KELLY MINERALS INTERESTS JV	0.41907500	0.36669100	
					LANGDON D HARRISON REVOC TRUST E	0.25143900	0.22000900	
					MARYAN KLINGER TRUST	0.20748600	0.18155000	
					PRODUCTION GATHERING COMPANY LF	0.41498300	0.36311000	
					XTO ENERGY INC	34.25123400	29.96983000	
					ZZZ KELLY & TRUST LLC	0.83961400	0.73466200	
			TOTAL			100.00000000	100.00000000	
NM-02515	T-026N R-010W	320.00	ORRI:	<b>Tract: 067A</b>	0.00000000	3.51383000	0.70683800	
	SEC:027 E/2		ROYALTY:		0.00000000	12.50000000		
			WORKING INTEREST:		BURLINGTON RESOURCES O&G CO LP	81.76790900	68.61872800	
					KELLY MINERALS INTERESTS JV	0.41902300	0.36664500	
					LANGDON D HARRISON REVOC TRUST E	0.25140800	0.21998200	
					MARYAN KLINGER TRUST	0.20748900	0.18155300	
					PRODUCTION GATHERING COMPANY LF	0.41497800	0.36310600	
					WILLIAM J GREEN ESTATE	15.78844000	13.22924700	
					XTO ENERGY INC	0.31123100	0.27232800	
					ZZZ KELLY & TRUST LLC	0.83952200	0.73458100	
			TOTAL		100.00000000	100.00000000		

Tract Remarks:  
 BR BEARS 100% OF THE TOTAL ORRI.

**BURLINGTON RESOURCES O&G CO LP - Operator**  
 The 052 Expanded Participating Area for Dakota Formation  
 Huerfano Unit Area  
 San Juan, New Mexico  
 Effective 10/01/2008

Serial Num	Description	Number of Acres	Ownership	Drilling Block	GW/Percentage	NRI/Percentage	Participation Factor
SF-078002	T-028N R-010W SEC.029 S/2 NE/4, SW/4	240.00	ORRI: ROYALTY: WORKING INTEREST:	<b>Tract: 068</b>	0.00000000 0.00000000 97.55617000	9.55777900 12.50000000 75.80387000	0.53012800
Tract Remarks: BR BEARS 100% OF THE TOTAL ORRI.							
SF-078002-A	T-028N R-010W SEC.034 N/2 NE/4 SEC.035 E/2	400.00	ORRI: ROYALTY: WORKING INTEREST:	<b>Tract: 068A</b>	0.00000000 0.00000000 63.61616900	7.11409900 12.50000000 48.55004900	0.88354700
Tract Remarks: BR BEARS 100% OF THE TOTAL ORRI.							
TOTAL					0.83961400 100.00000000	0.73466200 100.00000000	
TOTAL					0.83961400 100.00000000	0.73466200 100.00000000	

**BURLINGTON RESOURCES O&G CO LP - Operator**  
 The 052 Expanded Participating Area for Dakota Formation  
 Huerfano Unit Area  
 San Juan, New Mexico  
 Effective 10/01/2008

Serial Num	Description	Number of Acres	Ownership	Drilling Block	GWl Percentage	NRl Percentage	Participation Factor
SF-078557	T-026N R-010W SEC.029 NW/4	160.00	ORRI: ROYALTY: WORKING INTEREST:	<b>Tract: 069</b>	0.00000000 0.00000000 97.55616900	9.55777900 12.50000000 75.80386900	0.35341900
Tract Remarks: BR BEARS 100% OF THE TOTAL ORRI.							
SF-080636	T-026N R-010W SEC.029 N2SE4	80.00	ORRI: ROYALTY: WORKING INTEREST:	<b>Tract: 070</b>	0.00000000 0.00000000 97.55616900	9.55777900 12.50000000 75.80386900	0.17670900
Tract Remarks: BR BEARS 100% OF THE TOTAL ORRI.							
TOTAL					100.00000000	100.00000000	
TOTAL					100.00000000	100.00000000	



**BURLINGTON RESOURCES O&G CO LP - Operator**  
 The 052 Expanded Participating Area for Dakota Formation  
 Huertano Unit Area  
 San Juan, New Mexico  
 Effective 10/01/2008

Serial Num	Description	Number of Acres	Ownership	Drilling Block	GW/Percentage	NRI Percentage	Participation Factor	
SF-078372	T-026N R-010W	160.00	ORRI:	<b>Tract: 071</b>	0.00000000	12.55291900	0.35341900	
	SEC.031 NE/4		ROYALTY:		0.00000000	12.50000000		
			WORKING INTEREST:		BURLINGTON RESOURCES O&G CO LP	98.98244200	74.06984700	
					KELLY MINERALS INTERESTS JV	0.17440400	0.15260400	
					LANGDON D HARRISON REVOC TRUST E	0.10463900	0.09155900	
					MARYANKLINGER TRUST	0.08644900	0.07305000	
					PRODUCTION GATHERING COMPANY LF	0.17291000	0.14610900	
					XTO ENERGY INC	0.12968000	0.10958000	
					ZZZ KELLY & TRUST LLC	0.34947600	0.30433200	
			<b>TOTAL</b>			<b>100.00000000</b>	<b>100.00000000</b>	

Serial Num	Description	Number of Acres	Ownership	Drilling Block	GW/Percentage	NRI Percentage	Participation Factor	
SF-078372	T-026N R-010W	597.68	ORRI:	<b>Tract: 071A</b>	0.00000000	11.57248000	1.32019600	
	SEC.030 W/2 NE/4, E/2 SE/4		ROYALTY:		0.00000000	12.50000000		
			WORKING INTEREST:		BURLINGTON RESOURCES O&G CO LP	98.98244200	75.04591100	
					KELLY MINERALS INTERESTS JV	0.17440400	0.15260400	
					LANGDON D HARRISON REVOC TRUST E	0.10463900	0.09155900	
					MARYANKLINGER TRUST	0.08645300	0.07391700	
					PRODUCTION GATHERING COMPANY LF	0.17290700	0.14783600	
					XTO ENERGY INC	0.12967900	0.11087600	
					ZZZ KELLY & TRUST LLC	0.34947600	0.30481700	
			<b>TOTAL</b>			<b>100.00000000</b>	<b>100.00000000</b>	

Tract Remarks:  
 BR AND HUDSON POOL BEAR A 2.0% ORRI BR BEARS REMAINING  
 ORRI.

**BURLINGTON RESOURCES O&G CO LP - Operator**

The 052 Expanded Participating Area for Dakota Formation

Huerfano Unit Area  
 San Juan, New Mexico  
 Effective 10/01/2008

Serial Num	Description	Number of Acres	Ownership	Drilling Block	GWl Percentage	NRI Percentage	Participation Factor
NM-02890	T-026N R-010W	160.00	ORRI:	<b>Tract: 072</b>	0.00000000	16.62500000	0.35341900
	SEC.030 E/2 NE/4, W/2 SE/4		ROYALTY:		0.00000000	12.50000000	
			WORKING INTEREST:		100.00000000	70.87500000	
			TOTAL		100.00000000	100.00000000	

Tract Remarks:  
 BR BEARS 100% OF THE TOTAL ORRI.

Serial Num	Description	Number of Acres	Ownership	Drilling Block	GWl Percentage	NRI Percentage	Participation Factor
SF-079203	T-026N R-010W	160.00	ORRI:	<b>Tract: 074</b>	0.00000000	9.557777900	0.35341900
	SEC.031 NE/4 SE/4		ROYALTY:		0.00000000	12.50000000	
	SEC.033 W/2 NW/4, SE/4 NW/4		WORKING INTEREST:		97.55616900	75.80386900	
					0.41907500	0.36669100	
			BURLINGTON RESOURCES O&G CO LP		0.25143900	0.22000900	
			KELLY MINERALS INTERESTS JV		0.20748600	0.18156000	
			LANGDON D HARRISON REVOC TRUST E		0.41498300	0.36311000	
			MARYAN KLINGER TRUST		0.31123400	0.27233000	
			PRODUCTION GATHERING COMPANY LF		0.83961400	0.73466200	
			XTO ENERGY INC				
			ZZZ KELLY & TRUST LLC				
			TOTAL		100.00000000	100.00000000	

Tract Remarks:  
 BR BEARS 100% OF THE TOTAL ORRI.

**BURLINGTON RESOURCES O&G CO LP - Operator**  
 The 052 Expanded Participating Area for Dakota Formation  
 Huertano Unit Area  
 San Juan, New Mexico  
 Effective 10/01/2008

Serial Num	Description	Number of Acres	Ownership	Drilling Block	GW/ Percentage	NRI Percentage	Participation Factor	
SF-078005	T-026N R-010W	320.00	ORRI:	<b>Tract: 075</b>	0.00000000	16.83249800	0.7063800	
	SEC.033 S/2		ROYALTY:		0.00000000	12.50000000		
			WORKING INTEREST:		BURLINGTON RESOURCES O&G CO LP	98.60676000	69.44841700	
					KELLY MINERALS INTERESTS JV	0.41902100	0.36664300	
					LANGDON D HARRISON REVOC TRUST E	0.25140800	0.21998200	
				ZZZ KELLY & TRUST LLC	0.72281100	0.63246000		
			<b>TOTAL</b>		100.00000000	100.00000000		

Serial Num	Description	Number of Acres	Ownership	Drilling Block	GW/ Percentage	NRI Percentage	Participation Factor	
SF-078000	T-026N R-009W	640.00	ORRI:	<b>Tract: 077</b>	0.00000000	2.50000000	1.41367500	
	SEC.009 ALL		ROYALTY:		0.00000000	12.50000000		
			WORKING INTEREST:		XTO ENERGY INC	100.00000000	85.00000000	
						100.00000000	100.00000000	
			<b>TOTAL</b>			100.00000000	100.00000000	

Serial Num	Description	Number of Acres	Ownership	Drilling Block	GW/ Percentage	NRI Percentage	Participation Factor
	T-026N R-009W			<b>Tract: 078</b>			
	SEC.015 ALL						
			<b>TOTAL</b>				

Tract Remarks:  
 TRACT NOT COMMITTED TO UNIT.

**BURLINGTON RESOURCES O&G CO LP - Operator**  
 The 052 Expanded Participating Area for Dakota Formation  
 Huerfano Unit Area  
 San Juan, New Mexico  
 Effective 10/01/2008

Serial Num	Description	Number of Acres	Ownership	Drilling Block	GWJ Percentage	NRI Percentage	Participation Factor
NM-03493	T-026N R-009W	1,772.74	ORRI:	<b>Tract: 079</b>	0.00000000	9.70632000	3.91574900
	SEC.019 E/2, E/2 W/2		ROYALTY:				
	SEC.019 LOT 1	41.76	WORKING INTEREST:				
	SEC.019 LOT 2	41.64	BURLINGTON RESOURCES O&G CO LP				
	SEC.019 LOT 3	41.53	XTO ENERGY INC				
	SEC.019 LOT 4	41.41	TOTAL				
	SEC.020 N/2, SW/4						
	SEC.030 E/2, E/2 W/2						
	SEC.030 LOT 1	41.48					
	SEC.030 LOT 2	41.56					
	SEC.030 LOT 3	41.64					
	SEC.030 LOT 4	41.72					

Tract Remarks:  
 XTO BEARS 2.5% ORRI AND BR BEARS THE REMAINDER.

Serial Num	Description	Number of Acres	Ownership	Drilling Block	GWJ Percentage	NRI Percentage	Participation Factor
SF-077980	T-026N R-009W	161.82	ORRI:	<b>Tract: 080</b>	0.00000000	9.70632000	0.35743900
	SEC.005 LOT 1	40.85	ROYALTY:				
	SEC.005 LOT 2	40.97	WORKING INTEREST:				
	SEC.005 S/2 NE/4		BURLINGTON RESOURCES O&G CO LP				
			XTO ENERGY INC				
	TOTAL		TOTAL				

Tract Remarks:  
 XTO BEARS 2.5% OF ORRI, BR BEARS REMAINDER.

Run Date: 10/18/2010  
 Run Time: 12:22:47 PM  
 User: HOWELDM

**BURLINGTON RESOURCES O&G CO LP - Operator**

The 052 Expanded Participating Area for Dakota Formation

Huerfano Unit Area  
 San Juan, New Mexico  
 Effective 10/01/2008

Serial Num	Description	Number of Acres	Ownership	Drilling Block	GWI Percentage	NRI Percentage	Participation Factor
SF-077980-A	T-026N R-009W	1,442.28		<b>Tract: 080A</b>			3.18580600
	SEC.005 LOT 3	41.08	ORRI:		0.00000000	9.70632000	
	SEC.005 LOT 4	41.20	ROYALTY:		0.00000000	12.50000000	
	SEC.005 S/2, S/2 NW/4		WORKING INTEREST:	BURLINGTON RESOURCES O&G CO LP	66.06000000	50.59618000	
	SEC.008 ALL			XTO ENERGY INC	33.94000000	27.19750000	
	SEC.017 W/2		TOTAL		100.00000000	100.00000000	

Tract Remarks:  
 XTO BEARS 2.5% OF ORRI, EPPG BEARS REMAINDER.

Serial Num	Description	Number of Acres	Ownership	Drilling Block	GWI Percentage	NRI Percentage	Participation Factor
SF-077980	T-026N R-009W	320.00		<b>Tract: 080B</b>			0.70683800
	SEC.017 E/2		ORRI:		0.00000000	9.70632000	
			ROYALTY:		0.00000000	12.50000000	
			WORKING INTEREST:	BURLINGTON RESOURCES O&G CO LP	66.06000000	50.59618000	
				XTO ENERGY INC	33.94000000	27.19750000	
			TOTAL		100.00000000	100.00000000	

Tract Remarks:  
 XTO BEARS 2.5% OF ORRI, BR BEARS REMAINDER.

**BURLINGTON RESOURCES O&G CO LP - Operator**  
 The 052 Expanded Participating Area for Dakota Formation  
 Huerfano Unit Area  
 San Juan, New Mexico  
 Effective 10/01/2008

Serial Num	Description	Number of Acres	Ownership	Drilling Block	GWI Percentage	NRI Percentage	Participation Factor
SF-078000-A	T-026N R-009W	920.00	ORRI:	<b>Tract: 081</b>	0.00000000	9.70632000	2.03215900
	SEC.018 S/2 SE/4, NE/4 SE/4		ROYALTY:		0.00000000	12.50000000	
	SEC.020 SE/4		WORKING INTEREST:		66.06000000	50.59618000	
	SEC.029 ALL		BURLINGTON RESOURCES O&G CO LP		33.94000000	27.19750000	
			XTO ENERGY INC		100.00000000	100.00000000	
			<b>TOTAL</b>				

Tract Remarks:  
 XTO BEARS 2.5% OF ORRI. BR BEARS REMAINDER.

Serial Num	Description	Number of Acres	Ownership	Drilling Block	GWI Percentage	NRI Percentage	Participation Factor
SF-078060	T-026N R-009W	960.00	ORRI:	<b>Tract: 082</b>	0.00000000	8.51430400	2.12051300
	SEC.021 N/2		ROYALTY:		0.00000000	12.50000000	
	SEC.027 ALL		WORKING INTEREST:		49.70983400	36.23455500	
			BURLINGTON RESOURCES O&G CO LP		0.05436000	0.04756400	
			KELLY MINERALS INTERESTS JV		0.03261700	0.02854000	
			LANGDON D HARRISON REVOC TRUST E	0.02161200	0.01836300		
			MARYAN KLINGER TRUST	0.04322200	0.03673000		
			PRODUCTION GATHERING COMPANY LP	50.03242400	42.52755500		
			XTO ENERGY INC	0.10593100	0.09238900		
			ZZZ KELLY & TRUST LLC				
			<b>TOTAL</b>		100.00000000	100.00000000	

Tract Remarks:  
 BR AND HUDSON POOL BEAR 1/2 OF A 2.5% ORRI AND XTO BEARS 1/2.  
 BR BEARS THE REMAINING ORRI.

**BURLINGTON RESOURCES O&G COLP - Operator**  
 The 052 Expanded Participating Area for Dakota Formation  
 Huerfano Unit Area  
 San Juan, New Mexico  
 Effective 10/01/2008

Serial Num	Description	Number of Acres	Ownership	Drilling Block	GWI Percentage	NRI Percentage	Participation Factor
SF-078060-A	T-026N R-009W SEC.021 S1/2 SEC.028 ALL	960.00	ORRI: ROYALTY: WORKING INTEREST:	<b>Tract: 082A</b>	0.00000000 0.00000000 49.70983200	8.51430400 12.50000000 36.23455300	2.12051300
Tract Remarks: BR AND HUDSON POOL BEAR 1/2 OF A 2.5% ORRI AND XTO BEARS 1/2. BR BEARS THE REMAINING ORRI.							
Ownership Breakdown for Tract 082A: <ul style="list-style-type: none"> <li>BURLINGTON RESOURCES O&amp;G COLP: 49.70983200 (36.23455300 NRI)</li> <li>KELLY MINERALS INTERESTS JV: 0.05436000 (0.04756400 NRI)</li> <li>LANGDON D HARRISON REVOC TRUST E: 0.03261700 (0.02854000 NRI)</li> <li>MARYANKLINGER TRUST: 0.02161200 (0.01836300 NRI)</li> <li>PRODUCTION GATHERING COMPANY LP: 0.04322400 (0.03673200 NRI)</li> <li>XTO ENERGY INC: 50.03242400 (42.52755500 NRI)</li> <li>ZZZ KELLY &amp; TRUST LLC: 0.10593100 (0.09238900 NRI)</li> </ul>							
<b>TOTAL</b>					<b>100.00000000</b>	<b>100.00000000</b>	
NM-012736	T-026N R-009W SEC.022 N1/2 N1/2 SW1/4 NW1/4	200.00	ORRI: ROYALTY: WORKING INTEREST:	<b>Tract: 083</b>	0.00000000 0.00000000 0.47896800	23.93750000 12.50000000 0.30444300	0.44177400
Tract Remarks: ALL ORRI BORNE PROPORTIONATELY BY ALL WORKING INTEREST OWNERS.							
<b>TOTAL</b>					<b>100.00000000</b>	<b>100.00000000</b>	

**BURLINGTON RESOURCES O&G CO LP - Operator**

The 052 Expanded Participating Area for Dakota Formation

Huertano Unit Area  
 San Juan, New Mexico  
 Effective 10/01/2008

Serial Num	Description	Number of Acres	Ownership	Drilling Block	GWl Percentage	NRI Percentage	Participation Factor
SF-080127	T-026N R-009W	280.00	ORRI:	<b>Tract: 084</b>	0.00000000	12.50000000	0.61848300
	SEC:022 S/2 SE/4, SW/4, NW/4 SE/4		ROYALTY:		0.00000000	12.50000000	
			WORKING INTEREST:	BURLINGTON RESOURCES O&G CO LP	100.00000000	75.00000000	
			TOTAL		100.00000000	100.00000000	

Tract Remarks:  
 BR BEARS 100% OF THE TOTAL ORRI.

Serial Num	Description	Number of Acres	Ownership	Drilling Block	GWl Percentage	NRI Percentage	Participation Factor
SF-078103	T-026N R-009W	1,120.00	ORRI:	<b>Tract: 085</b>	0.00000000	8.51430400	2.47393200
	SEC:023 ALL		ROYALTY:		0.00000000	12.50000000	
	SEC:026 N/2, SW/4		WORKING INTEREST:	BURLINGTON RESOURCES O&G CO LP	49.70983200	36.23455500	
				KELLY MINERALS INTERESTS JV	0.05436000	0.04756400	
				LANGDON D HARRISON REVOC TRUST	0.03261700	0.02854000	
				MARYAN KLINGER TRUST	0.02161200	0.01836300	
				PRODUCTION GATHERING COMPANY LP	0.04322400	0.03673000	
				XTO ENERGY INC	50.03242400	42.52755400	
				ZZZ KELLY & TRUST LLC	0.10593100	0.09239000	
			TOTAL		100.00000000	100.00000000	

Tract Remarks:  
 BR AND HUDSON POOL BEAR 1/2 OF A 2.5% ORRI AND XTO BEARS 1/2.  
 BR BEARS THE REMAINING ORRI.



Run Date: 10/18/2010  
 Run Time: 12:22:47 PM  
 User: HOWELDM

**BURLINGTON RESOURCES O&G CO LP - Operator**  
 The 052 Expanded Participating Area for Dakota Formation  
 Huerfano Unit Area  
 San Juan, New Mexico  
 Effective 10/01/2008

Serial Num	Description	Number of Acres	Ownership	Drilling Block	GWI Percentage	NRI Percentage	Participation Factor
SF-078103-B	T-026N R-009W SEC.026 SE#4 SEC.035 E/2	480.00	ORRI: ROYALTY: WORKING INTEREST:	<b>Tract: 085B</b> BURLINGTON RESOURCES O&G CO LP KELLY MINERALS INTERESTS JV LANGDON D HARRISON REVOC TRUST MARYAN KLINGER TRUST PRODUCTION GATHERING COMPANY LF XTO ENERGY INC ZZZ KELLY & TRUST LLC	0.00000000 0.00000000 49.70983200 0.05436000 0.03261700 0.02161200 0.04322400 50.03242400 0.10593100	8.51430300 12.50000000 36.23455600 0.04756400 0.02854000 0.01836300 0.03673000 42.52755400 0.09239000	1.06025700
TOTAL					100.00000000	100.00000000	

Tract Remarks:  
 BR AND HUDSON POOL BEAR 1/2 OF A 2.5% ORRI AND XTO BEARS 1/2.  
 BR BEARS THE REMAINING ORRI.

**BURLINGTON RESOURCES O&G CO LP - Operator**  
 The 052 Expanded Participating Area for Dakota Formation  
 Huerfano Unit Area  
 San Juan, New Mexico  
 Effective 10/01/2008

Serial Num	Description	Number of Acres	Ownership	Drilling Block	GW/ Percentage	NRI Percentage	Participation Factor
SF-078518-A		1,527.32		<b>Tract: 086</b>			3.37364800
	T-025N R-009W		ORRI:		0.00000000	7.20632000	
	SEC.005 LOT 1	40.53	ROYALTY:		0.00000000	12.50000000	
	SEC.005 LOT 2	40.52	WORKING INTEREST:	BURLINGTON RESOURCES O&G CO LP	66.06000000	50.59618000	
	SEC.005 LOT 3	40.50		XTO ENERGY INC	33.94000000	29.69750000	
	SEC.005 LOT 4	40.49	<b>TOTAL</b>		<b>100.00000000</b>	<b>100.00000000</b>	
	SEC.005 S/2, S/2 N/2						
	SEC.008 NW/4, E/2 SW/4						
	T-026N R-009W						
	SEC.031 E/2, E/2 W/2						
	SEC.031 LOT 1	41.41					
	SEC.031 LOT 2	41.35					
	SEC.031 LOT 3	41.29					
	SEC.031 LOT 4	41.23					

Tract Remarks:  
 BR BEARS 100% OF THE TOTAL ORRI.

Serial Num	Description	Number of Acres	Ownership	Drilling Block	GW/ Percentage	NRI Percentage	Participation Factor
SF-078077-A		240.00		<b>Tract: 088</b>			0.53012800
	T-025N R-010W		ORRI:		0.00000000	12.50000000	
	SEC.012 W/2 SE/4, SW/4		ROYALTY:		0.00000000	12.50000000	
			WORKING INTEREST:	BURLINGTON RESOURCES O&G CO LP	100.00000000	75.00000000	
			<b>TOTAL</b>		<b>100.00000000</b>	<b>100.00000000</b>	

Tract Remarks:  
 BR BEARS 100% OF THE TOTAL ORRI.

**BURLINGTON RESOURCES O&G CO LP - Operator**  
 The 052 Expanded Participating Area for Dakota Formation  
 Huerfano Unit Area  
 San Juan, New Mexico  
 Effective 10/01/2008

Serial Num	Description	Number of Acres	Ownership	Drilling Block	GWIPercentage	NRI Percentage	Participation Factor
SF-079787		320.00		<b>Tract: 089</b>			0.70683800
	T-025N R-010W		ORRI:		0.00000000	10.00000000	
	SEC.013 S/2		ROYALTY:		0.00000000	12.50000000	
			WORKING INTEREST:	BURLINGTON RESOURCES O&G COLP	62.50000000	48.43750000	
				GROSS RESOURCES LTD PTSHP	37.50000000	29.06250000	
			<b>TOTAL</b>		<b>100.00000000</b>	<b>100.00000000</b>	

Tract Remarks:  
 ALL ORRI BORNE PROPORTIONATELY BY ALL WORKING INTEREST OWNERS.

Serial Num	Description	Number of Acres	Ownership	Drilling Block	GWIPercentage	NRI Percentage	Participation Factor
SF-079787		320.00		<b>Tract: 089A</b>			0.70683800
	T-025N R-010W		ORRI:		0.00000000	10.00000000	
	SEC.013 N/2		ROYALTY:		0.00000000	12.50000000	
			WORKING INTEREST:	BURLINGTON RESOURCES O&G COLP	62.50000000	48.43750000	
				GROSS RESOURCES LTD PTSHP	37.50000000	29.06250000	
			<b>TOTAL</b>		<b>100.00000000</b>	<b>100.00000000</b>	

Tract Remarks:  
 ALL ORRI BORNE PROPORTIONATELY BY ALL WORKING INTEREST OWNERS.

Serial Num	Description	Number of Acres	Ownership	Drilling Block	GWIPercentage	NRI Percentage	Participation Factor
NW-03039		480.21		<b>Tract: 090</b>			1.06072000
	T-025N R-009W		ROYALTY:		0.00000000	12.50000000	
	SEC.003 LOT.1		WORKING INTEREST:	XTO ENERGY INC	100.00000000	87.50000000	
	SEC.003 LOT.2				100.00000000	100.00000000	
	SEC.003 SE/4, S/2 NE/4						
	SEC.015 NW/4						

**BURLINGTON RESOURCES O&G CO LP - Operator**

The 052 Expanded Participating Area for Dakota Formation

Huerfano Unit Area  
 San Juan, New Mexico  
 Effective 10/01/2008

Serial Num	Description	Number of Acres	Ownership	Drilling Block	GW/Percentage	NRI Percentage	Participation Factor
SF-078618	T-025N R-009W	320.93		<b>Tract: 091</b>			0.70889200
	SEC.004 LOT.3	40.43	ROYALTY:		0.00000000	12.50000000	
	SEC.004 LOT.4	40.50	WORKING INTEREST:		100.00000000	87.50000000	
	SEC.004 SW/4, S/2 NW/4		TOTAL		100.00000000	100.00000000	

**BURLINGTON RESOURCES O&G CO LP - Operator**  
 The 052 Expanded Participating Area for Dakota Formation  
 Huerfano Unit Area  
 San Juan, New Mexico  
 Effective 10/01/2008

Serial Num	Description	Number of Acres	Ownership	Drilling Block	GW/Percentage	NRI/Percentage	Participation Factor
SF-079231	T-025N R-009W	1,895.04		<b>Tract: 092</b>			4.18589300
	SEC.006 LOT.1	40.30	ORRI:		0.00000000	5.00000000	
	SEC.006 LOT.2	40.18	ROYALTY:		0.00000000	12.50000000	
	SEC.006 LOT.3	40.06	WORKING INTEREST:	BURLINGTON RESOURCES O&G CO LP	1.00000000	0.82500000	
	SEC.006 LOT.4	44.63		SUNLAND REFINING CORP	99.00000000	81.67500000	
	SEC.006 LOT.5	40.24					
	SEC.006 LOT.6	40.26					
	SEC.006 LOT.7	40.29					
	SEC.006 SE/4, E/2 SW/4, SE/4 NW/4, S/2 NE/4						
	SEC.007 LOT.1	41.28					
	SEC.007 LOT.2	41.23					
	SEC.007 LOT.3	41.19					
	SEC.007 LOT.4	41.14					
	SEC.007 NE/4, E/2 W/2, N/2 SE/4, SW/4 SE/4						
	SEC.018 E/2, E/2 W/2						
	SEC.018 LOT.1	41.11					
	SEC.018 LOT.2	41.07					
	SEC.018 LOT.3	41.05					
	SEC.018 LOT.4	41.01					
	<b>TOTAL</b>				<b>100.00000000</b>	<b>100.00000000</b>	

Tract Remarks:  
 ALL ORRI BORNE PROPORTIONATELY BY ALL WORKING INTEREST OWNERS.

**BURLINGTON RESOURCES O&G CO LP - Operator**  
 The 052 Expanded Participating Area for Dakota Formation  
 Huerfano Unit Area  
 San Juan, New Mexico  
 Effective 10/01/2008

Serial Num	Description	Number of Acres	Ownership	Drilling Block	GW/Percentage	NRI/Percentage	Participation Factor
NM-03016	T-025N R-009W	320.00		<b>Tract: 093</b>			0.70683800
	SEC.011 E/2		ROYALTY:		0.00000000	12.50000000	
			WORKING INTEREST:	XTO ENERGY INC	100.00000000	87.50000000	
			TOTAL		100.00000000	100.00000000	

Serial Num	Description	Number of Acres	Ownership	Drilling Block	GW/Percentage	NRI/Percentage	Participation Factor
NM-03015	T-025N R-009W	160.00		<b>Tract: 094</b>			0.35341900
	SEC.015 SW/4		ROYALTY:		0.00000000	12.50000000	
			WORKING INTEREST:	XTO ENERGY INC	100.00000000	87.50000000	
			TOTAL		100.00000000	100.00000000	

Serial Num	Description	Number of Acres	Ownership	Drilling Block	GW/Percentage	NRI/Percentage	Participation Factor
E-921-9	T-026N R-010W	40.00		<b>Tract: 096</b>			0.08835500
	SEC.032 SW/4 NW/4		ORRI:		0.00000000	9.55777900	
			ROYALTY:		0.00000000	12.50000000	
			WORKING INTEREST:	BURLINGTON RESOURCES O&G CO LP	97.55616900	75.80386900	
				KELLY MINERALS INTERESTS JV	0.41907500	0.36669100	
				LANGDON D HARRISON REVOC TRUST E	0.25143900	0.22009900	
				MARYANKLINGER TRUST	0.20748600	0.18155000	
				PRODUCTION GATHERING COMPANY LF	0.41498300	0.36311000	
				XTO ENERGY INC	0.31123400	0.27233000	
				ZZZ KELLY & TRUST LLC	0.83961400	0.73466200	
			TOTAL		100.00000000	100.00000000	

Tract Remarks:  
 BR BEARS 100% OF THE TOTAL ORRI.

**BURLINGTON RESOURCES O&G CO LP - Operator**  
 The 052 Expanded Participating Area for Dakota Formation

Huerfano Unit Area  
 San Juan, New Mexico  
 Effective 10/01/2008

Serial Num	Description	Number of Acres	Ownership	Drilling Block	GWl Percentage	NRI Percentage	Participation Factor	
E-921-10	T-026N R-010W	79.55	ORRI:	<b>Tract: 096A</b>	0.00000000	7.11409900	0.17571500	
	SEC.002 LOT 4	39.55	ROYALTY:		0.00000000	12.50000000		
	SEC.002 SE1/4 NE/4		WORKING INTEREST:		BURLINGTON RESOURCES O&G CO LP	63.61616900	48.55004900	
					KELLY MINERALS INTERESTS JV	0.41907500	0.36669100	
					LANGDON D HARRISON REVOC TRUST E	0.25143900	0.22000900	
					MARYAN KLINGER TRUST	0.20748600	0.18155000	
					PRODUCTION GATHERING COMPANY LF	0.41498300	0.36311000	
					XTO ENERGY INC	34.25123400	29.96983000	
					ZZZ KELLY & TRUST LLC	0.83961400	0.73466200	
			<b>TOTAL</b>			<b>100.00000000</b>	<b>100.00000000</b>	
B-8801-31	T-026N R-010W	40.00	ORRI:	<b>Tract: 097</b>	0.00000000	9.55778600	0.08835500	
	SEC.032 NW/4 SE/4		ROYALTY:		0.00000000	12.50000000		
			WORKING INTEREST:		BURLINGTON RESOURCES O&G CO LP	97.55635000	75.80402000	
					KELLY MINERALS INTERESTS JV	0.41902100	0.36664300	
					LANGDON D HARRISON REVOC TRUST E	0.25140800	0.21998200	
					MARYAN KLINGER TRUST	0.20749000	0.18155400	
					PRODUCTION GATHERING COMPANY LF	0.41497800	0.36310600	
					XTO ENERGY INC	0.31123200	0.27232800	
					ZZZ KELLY & TRUST LLC	0.83952100	0.73458100	
			<b>TOTAL</b>			<b>100.00000000</b>	<b>100.00000000</b>	

Tract Remarks:  
 BR BEARS 100% OF THE TOTAL ORRI.

**BURLINGTON RESOURCES O&G CO LP - Operator**  
 The 052 Expanded Participating Area for Dakota Formation  
 Huertano Unit Area  
 San Juan, New Mexico  
 Effective 10/01/2008

Serial Num	Description	Number of Acres	Ownership	Drilling Block	GWl Percentage	NRI Percentage	Participation Factor
B-8801-32	T-028N R-010W SEC.002 S/2 NW/4, NW/4 SW/4	120.00	ORRI: ROYALTY: WORKING INTEREST:	<b>Tract: 097A</b>	0.00000000 0.00000000 63.61616900	7.11409900 12.50000000 48.55004900	0.26506400
			BURLINGTON RESOURCES O&G CO LP KELLY MINERALS INTERESTS JV LANGDON D HARRISON REVOC TRUST E MARYANKLINGER TRUST PRODUCTION GATHERING COMPANY LF XTO ENERGY INC ZZZ KELLY & TRUST LLC		0.41907500 0.25143900 0.20748600 0.41498300 34.25123400 0.83961400	0.36669100 0.22000900 0.18155000 0.36311000 29.96983000 0.73466200	
			TOTAL		100.00000000	100.00000000	
B-10815-13	T-028N R-010W SEC.032 SE/4 NE/4, NE/4 SE/4, SW/4 SE/4	120.00	ORRI: ROYALTY: WORKING INTEREST:	<b>Tract: 098</b>	0.00000000 0.00000000 97.55616900	9.55777900 12.50000000 75.80386900	0.26506400
			BURLINGTON RESOURCES O&G CO LP KELLY MINERALS INTERESTS JV LANGDON D HARRISON REVOC TRUST E MARYANKLINGER TRUST PRODUCTION GATHERING COMPANY LF XTO ENERGY INC ZZZ KELLY & TRUST LLC		0.41907500 0.25143900 0.20748600 0.41498300 0.31123400 0.83961400	0.36669100 0.22000900 0.18155000 0.36311000 0.27233000 0.73466200	
			TOTAL		100.00000000	100.00000000	



**BURLINGTON RESOURCES O&G CO LP - Operator**  
 The 052 Expanded Participating Area for Dakota Formation  
 Huertano Unit Area  
 San Juan, New Mexico  
 Effective 10/01/2008

Serial Num	Description	Number of Acres	Ownership	Drilling Block	GWI Percentage	NRI Percentage	Participation Factor	
B-10815-12	T-028N R-010W	40.00	ORRI:	<b>Tract: 098A</b>	0.00000000	7.11409900	0.08835500	
	SEC 036 SE/4 SW/4		ROYALTY:		0.00000000	12.50000000		
			WORKING INTEREST:		63.61616900	48.55004900		
					KELLY MINERALS INTERESTS JV	0.41907500	0.36669100	
					LANGDON D HARRISON REVOC TRUST E	0.25143900	0.22000900	
					MARYAN KLINGER TRUST	0.20748600	0.18155000	
					PRODUCTION GATHERING COMPANY LP	0.41498300	0.36311000	
					XTO ENERGY INC	34.25123400	29.96983000	
					ZZZ KELLY & TRUST LLC	0.83961400	0.73466200	
			TOTAL		100.00000000	100.00000000		
B-10815-9	T-028N R-010W	160.00	ORRI:	<b>Tract: 098B</b>	0.00000000	7.11409900	0.35341900	
	SEC 002 NE/4 SW/4, NW/4 SE/4		ROYALTY:		0.00000000	12.50000000		
			WORKING INTEREST:		63.61616900	48.55004900		
					KELLY MINERALS INTERESTS JV	0.41907500	0.36669100	
					LANGDON D HARRISON REVOC TRUST E	0.25143900	0.22000900	
					MARYAN KLINGER TRUST	0.20748600	0.18155000	
					PRODUCTION GATHERING COMPANY LP	0.41498300	0.36311000	
					XTO ENERGY INC	34.25123400	29.96983000	
					ZZZ KELLY & TRUST LLC	0.83961400	0.73466200	
			TOTAL		100.00000000	100.00000000		

Tract Remarks:  
 BR BEARS 100% OF THE TOTAL ORRI.

**BURLINGTON RESOURCES O&G CO LP - Operator**  
 The 052 Expanded Participating Area for Dakota Formation  
 Huerfano Unit Area  
 San Juan, New Mexico  
 Effective 10/01/2008

Serial Num	Description	Number of Acres	Ownership	Drilling Block	GWIPercentage	NRI Percentage	Participation Factor
B-11356-19	T-026N R-010W	79.26		<b>Tract: 099</b>			0.17507500
	SEC.002 LOT.2	39.66	ORRI:		0.00000000	7.11409900	
	SEC.002 LOT.3	39.60	ROYALTY:		0.00000000	12.50000000	
			WORKING INTEREST:	BURLINGTON RESOURCES O&G COLP	63.61616900	48.55004900	
				KELLY MINERALS INTERESTS JV	0.41907500	0.36669100	
				LANGDON D HARRISON REVOC TRUST E	0.25143900	0.22000900	
				MARYAN KLINGER TRUST	0.20748600	0.18155000	
				PRODUCTION GATHERING COMPANY LP	0.44498300	0.36311000	
				XTO ENERGY INC	34.25123400	29.96983000	
				ZZZ KELLY & TRUST LLC	0.83961400	0.73466200	
			<b>TOTAL</b>		<b>100.00000000</b>	<b>100.00000000</b>	

Tract Remarks:  
 BR BEARS 100% OF THE TOTAL ORRI.

Serial Num	Description	Number of Acres	Ownership	Drilling Block	GWIPercentage	NRI Percentage	Participation Factor
B-9320-10	T-026N R-010W	80.00		<b>Tract: 100</b>			0.17670900
	SEC.032 E/2 NW/4		ORRI:		0.00000000	12.55291900	
			ROYALTY:		0.00000000	12.50000000	
			WORKING INTEREST:	BURLINGTON RESOURCES O&G COLP	98.98244500	74.06985100	
				KELLY MINERALS INTERESTS JV	0.17440400	0.15260400	
				LANGDON D HARRISON REVOC TRUST E	0.10463900	0.09155900	
				MARYAN KLINGER TRUST	0.08645300	0.07305300	
				PRODUCTION GATHERING COMPANY LP	0.17290600	0.14610600	
				XTO ENERGY INC	0.12967800	0.10957800	
				ZZZ KELLY & TRUST LLC	0.34947500	0.30433000	
			<b>TOTAL</b>		<b>100.00000000</b>	<b>100.00000000</b>	

Tract Remarks:  
 BR AND HUDSON POOL BEAR A 3.0% ORRI. BR BEARS THE REMAINING ORRI.

**BURLINGTON RESOURCES O&G CO LP - Operator**

The 052 Expanded Participating Area for Dakota Formation

Huerfano Unit Area  
 San Juan, New Mexico  
 Effective 10/01/2008

Serial Num	Description	Number of Acres	Ownership	Drilling Block	GWI Percentage	NRI Percentage	Participation Factor
B-9320-12	T-026N R-010W	360.00		<b>Tract: 100A</b>			0.79519200
	SEC.002 S/2 SW/4, SW/4		ORRI:		0.00000000	10.10964200	
	SEC.016 NE/4 SW/4, SW/4 SW/4, N/2 NW/4		ROYALTY:		0.00000000	12.50000000	
	SEC.036 SE/4 NW/4, SE/4 NE/4		WORKING INTEREST:	BURLINGTON RESOURCES O&G CO LP	65.04244200	46.81562500	
				KELLY MINERALS INTERESTS JV	0.17440400	0.15260400	
				LANGDON D HARRISON REVOC TRUST E	0.10463900	0.09155900	
				MARYAN KLINGER TRUST	0.08644900	0.07305000	
				PRODUCTION GATHERING COMPANY LE	0.17291000	0.14610900	
				XTO ENERGY INC	34.06988800	29.80708000	
				ZZZ KELLY & TRUST LLC	0.34947600	0.30433100	
			<b>TOTAL</b>		<b>100.00000000</b>	<b>100.00000000</b>	

Tract Remarks:  
 BR AND HUDSON POOL BEAR A 3.0% ORRI. BR BEARS THE REMAINING ORRI.

Serial Num	Description	Number of Acres	Ownership	Drilling Block	GWI Percentage	NRI Percentage	Participation Factor
B-9320-12	T-026N R-009W	40.00		<b>Tract: 100B</b>			0.08835500
	SEC.032 NE/4 NW/4		ORRI:		0.00000000	10.13469900	
			ROYALTY:		0.00000000	12.50000000	
			WORKING INTEREST:	BURLINGTON RESOURCES O&G CO LP	65.73469000	47.38972100	
				KELLY MINERALS INTERESTS JV	0.05436100	0.04756500	
				LANGDON D HARRISON REVOC TRUST E	0.03261700	0.02854000	
				MARYAN KLINGER TRUST	0.02855600	0.02369100	
				PRODUCTION GATHERING COMPANY LE	0.05710900	0.04737600	
				XTO ENERGY INC	33.98283300	29.73303400	
				ZZZ KELLY & TRUST LLC	0.10983400	0.09537400	
			<b>TOTAL</b>		<b>100.00000000</b>	<b>100.00000000</b>	

Tract Remarks:  
 BR AND HUDSON POOL BEAR A 3.0% ORRI. BR BEARS THE REMAINING ORRI.

**BURLINGTON RESOURCES O&G CO LP - Operator**  
 The 052 Expanded Participating Area for Dakota Formation  
 Huertano Unit Area  
 San Juan, New Mexico  
 Effective 10/01/2008

Serial Num	Description	Number of Acres	Ownership	Drilling Block	GWI Percentage	NRI Percentage	Participation Factor
B-11571-39	T-026N R-010W	39.71		<b>Tract: 101</b>			
	SEC.002 LOT:1	39.71	ORRI:		0.00000000	5.00000000	0.08771400
			ROYALTY:		0.00000000	12.50000000	
			WORKING INTEREST:	XTO ENERGY INC	100.00000000	82.50000000	
			<b>TOTAL</b>		<b>100.00000000</b>	<b>100.00000000</b>	

Serial Num	Description	Number of Acres	Ownership	Drilling Block	GWI Percentage	NRI Percentage	Participation Factor
E-4493-1	T-026N R-010W	40.00		<b>Tract: 102</b>			
	SEC.002 SW/4 NE/4		ORRI:		0.00000000	5.00000000	0.08835500
			ROYALTY:		0.00000000	12.50000000	
			WORKING INTEREST:	XTO ENERGY INC	100.00000000	82.50000000	
			<b>TOTAL</b>		<b>100.00000000</b>	<b>100.00000000</b>	

Serial Num	Description	Number of Acres	Ownership	Drilling Block	GWI Percentage	NRI Percentage	Participation Factor
B-10940-6	T-026N R-010W	80.00		<b>Tract: 103</b>			
	SEC.016 NW/4 NE/4, NW/4 SW/4		ORRI:		0.00000000	7.11409900	0.17670900
			ROYALTY:		0.00000000	12.50000000	
			WORKING INTEREST:	BURLINGTON RESOURCES O&G CO LP	63.61616900	48.55004900	
				KELLY MINERALS INTERESTS JV	0.41907500	0.36669100	
				LANGDON D HARRISON REVOC TRUST E	0.25143900	0.22000900	
				MARYAN KLINGER TRUST	0.20748600	0.18155000	
				PRODUCTION GATHERING COMPANY LF	0.41498300	0.36311000	
				XTO ENERGY INC	34.25123400	29.96983000	
				ZZZKELLY & TRUST LLC	0.83961400	0.73466200	
			<b>TOTAL</b>		<b>100.00000000</b>	<b>100.00000000</b>	

Tract Remarks:  
 BR BEARS 100% OF THE TOTAL ORRI.

**BURLINGTON RESOURCES O&G CO LP - Operator**

The 052 Expanded Participating Area for Dakota Formation

Huerfano Unit Area  
 San Juan, New Mexico  
 Effective 10/01/2008

Serial Num	Description	Number of Acres	Ownership	Drilling Block	GWI Percentage	NRI Percentage	Participation Factor
B-11512-8	T-026N R-010W	80.00		<b>Tract: 104</b>			0.17670900
	SEC.032 SW/4 NE/4, SE/4 SE/4		ORRI:		0.00000000	9.55777900	
			ROYALTY:		0.00000000	12.50000000	
			WORKING INTEREST:	BURLINGTON RESOURCES O&G CO LP	97.55616900	75.80386900	
				KELLY MINERALS INTERESTS JV	0.41907500	0.36669100	
				LANGDON D HARRISON REVOC TRUST E	0.25143900	0.22000900	
				MARYANKLINGER TRUST	0.20748600	0.18155000	
				PRODUCTION GATHERING COMPANY LF	0.44498300	0.36311000	
				XTO ENERGY INC	0.31123400	0.27233000	
				ZZZ KELLY & TRUST LLC	0.83961400	0.73466200	
			TOTAL		100.00000000	100.00000000	
B-11512-10	T-026N R-010W	240.00		<b>Tract: 104A</b>			0.53012800
	SEC.016 W/2 SE/4, SE/4 SE/4 NE/4 NE/4		ORRI:		0.00000000	7.11409900	
			ROYALTY:		0.00000000	12.50000000	
			WORKING INTEREST:	BURLINGTON RESOURCES O&G CO LP	63.61616900	48.55004900	
				KELLY MINERALS INTERESTS JV	0.41907500	0.36669100	
				LANGDON D HARRISON REVOC TRUST E	0.25143900	0.22000900	
				MARYANKLINGER TRUST	0.20748600	0.18155000	
				PRODUCTION GATHERING COMPANY LF	0.44498300	0.36311000	
				XTO ENERGY INC	34.25123400	29.96983000	
				ZZZ KELLY & TRUST LLC	0.83961400	0.73466200	
			TOTAL		100.00000000	100.00000000	

Tract Remarks:  
 BR BEARS 100% OF THE TOTAL ORRI.

**BURLINGTON RESOURCES O&G CO LP - Operator**  
 The 052 Expanded Participating Area for Dakota Formation  
 Huertano Unit Area  
 San Juan, New Mexico  
 Effective 10/01/2008

Serial Num	Description	Number of Acres	Ownership	Drilling Block	GWI Percentage	NRI Percentage	Participation Factor
B-11512-9	T-026N R-010W	160.00		<b>Tract: 104B</b>			0.35341900

	ORRI:		0.00000000		7.11409900		
	ROYALTY:		0.00000000		12.50000000		
	WORKING INTEREST:		63.61616900	BURLINGTON RESOURCES O&G COLP	48.55004900		
			0.41907500	KELLY MINERALS INTERESTS JV	0.36669100		
			0.25143900	LANGDON D HARRISON REVOC TRUST E	0.22000900		
			0.20748600	MARYANN KLINGER TRUST	0.18155000		
			0.41498300	PRODUCTION GATHERING COMPANY LP	0.36311000		
			34.25123400	XTO ENERGY INC	29.96983000		
			0.83961400	ZZZ KELLY & TRUST LLC	0.73466200		
	<b>TOTAL</b>		<b>100.00000000</b>		<b>100.00000000</b>		<b>0.08835500</b>

Tract Remarks:  
 BR BEARS 100% OF THE TOTAL ORRI.

Serial Num	Description	Number of Acres	Ownership	Drilling Block	GWI Percentage	NRI Percentage	Participation Factor
E-331-20	T-026N R-010W	40.00		<b>Tract: 105</b>			0.08835500

	ORRI:		0.00000000		5.00000000		
	ROYALTY:		0.00000000		12.50000000		
	WORKING INTEREST:		100.00000000	XTO ENERGY INC	82.50000000		
	<b>TOTAL</b>		<b>100.00000000</b>		<b>100.00000000</b>		<b>0.08835500</b>

Tract Remarks:  
 ORRI BORNE 100% BY XTO.

Serial Num	Description	Number of Acres	Ownership	Drilling Block	GWI Percentage	NRI Percentage	Participation Factor
K-3348-1	T-026N R-010W	40.00		<b>Tract: 106</b>			0.08835500

	ROYALTY:		0.00000000		12.50000000		
	WORKING INTEREST:		100.00000000	BURLINGTON RESOURCES O&G COLP	87.50000000		
	<b>TOTAL</b>		<b>100.00000000</b>		<b>100.00000000</b>		<b>0.08835500</b>

**BURLINGTON RESOURCES O&G CO LP - Operator**  
 The 052 Expanded Participating Area for Dakota Formation  
 Huertano Unit Area  
 San Juan, New Mexico  
 Effective 10/01/2008

Serial Num	Description	Number of Acres	Ownership	Drilling Block	GWl Percentage	NRI Percentage	Participation Factor
B-8973-8	T-026N R-010W SEC.032 NW/4 NW/4, NW/4 SW/4	80.00	ORRI: ROYALTY: WORKING INTEREST:	<b>Tract: 107</b>	0.00000000 0.00000000 97.55616900	9.55777900 12.50000000 75.80386900	0.17670900
Tract Remarks: BR BEARS 100% OF THE TOTAL ORRI.							
B-10251-8	T-026N R-010W SEC.032 NW/4 NE/4	40.00	ORRI: ROYALTY: WORKING INTEREST:	<b>Tract: 108</b>	0.00000000 0.00000000 97.55616900	9.55777900 12.50000000 75.80386900	0.08335500
Tract Remarks: BR BEARS 100% OF THE TOTAL ORRI.							
TOTAL					100.00000000	100.00000000	
TOTAL					100.00000000	100.00000000	

**BURLINGTON RESOURCES O&G CO LP - Operator**  
 The 052 Expanded Participating Area for Dakota Formation

Huerfano Unit Area  
 San Juan, New Mexico  
 Effective 10/01/2008

Serial Num	Description	Number of Acres
B-10894-13	T-028N R-010W	80.00
	SEC.032 NE/4 NE/4, SE/4 SW/4	

Tract Remarks:  
 BR AND HUDSON POOL BEAR A 2.5% ORRI. BR BEARS REMAINING ORRI.

Ownership	Drilling Block	GW/Percentage	NRI/Percentage	Participation Factor
	<b>Tract: 109</b>			
ORRI:		0.00000000	12.01041400	0.17670900
ROYALTY:		0.00000000	12.50000000	
WORKING INTEREST:	BURLINGTON RESOURCES O&G CO LP	97.55635700	73.37765800	
	KELLY MINERALS INTERESTS JV	0.41902200	0.36664600	
	LANGDON D HARRISON REVOC TRUST E	0.25140500	0.21997900	
	MARYAN KLINGER TRUST	0.20748900	0.17636500	
	PRODUCTION GATHERING COMPANY LP	0.41497500	0.35272900	
	XTO ENERGY INC	0.31122900	0.26454500	
	ZZZ KELLY & TRUST LLC	0.83952300	0.73166400	
<b>TOTAL</b>		<b>100.00000000</b>	<b>100.00000000</b>	

Serial Num	Description	Number of Acres
E-85-37	T-028N R-010W	40.00
	SEC.032 NE/4 SW/4	

Tract Remarks:  
 ORRI BORNE 100% BY XTO.

Ownership	Drilling Block	GW/Percentage	NRI/Percentage	Participation Factor
	<b>Tract: 110</b>			
ORRI:		0.00000000	5.00000000	0.08835500
ROYALTY:		0.00000000	12.50000000	
WORKING INTEREST:	XTO ENERGY INC	100.00000000	82.50000000	
<b>TOTAL</b>		<b>100.00000000</b>	<b>100.00000000</b>	

Serial Num	Description	Number of Acres
E-85-37	T-028N R-010W	40.00
	SEC.032 SW/4 SW/4	

Tract Remarks:  
 ORRI BORNE 100% BY XTO.

Ownership	Drilling Block	GW/Percentage	NRI/Percentage	Participation Factor
	<b>Tract: 111</b>			
ORRI:		0.00000000	5.00000000	0.08835500
ROYALTY:		0.00000000	12.50000000	
WORKING INTEREST:	XTO ENERGY INC	100.00000000	82.50000000	
<b>TOTAL</b>		<b>100.00000000</b>	<b>100.00000000</b>	



**BURLINGTON RESOURCES O&G CO LP - Operator**  
 The 052 Expanded Participating Area for Dakota Formation  
 Huerfano Unit Area  
 San Juan, New Mexico  
 Effective 10/01/2008

Serial Num	Description	Number of Acres	Ownership	Drilling Block	GWI Percentage	NRI Percentage	Participation Factor
B-9096-10	T-026N R-010W SEC.036 NE4 NE4	40.00		<b>Tract: 112</b>			0.08835500
			ORRI:		0.00000000	10.05823000	
			ROYALTY:		0.00000000	12.50000000	
			WORKING INTEREST:	BURLINGTON RESOURCES O&G COLP	63.61616500	45.63743500	
				KELLY MINERALS INTERESTS JV	0.41907500	0.36669100	
				LANGDON D HARRISON REVOC TRUST E	0.25143900	0.22000900	
				MARYAN KLINGER TRUST	0.20748800	0.17532700	
				PRODUCTION GATHERING COMPANY LE	0.41497700	0.35066500	
				XTO ENERGY INC	34.25123200	29.96049000	
				ZZZ KELLY & TRUST LLC	0.83962400	0.73116200	
			<b>TOTAL</b>		<b>100.00000000</b>	<b>100.00000000</b>	

Serial Num	Description	Number of Acres	Ownership	Drilling Block	GWI Percentage	NRI Percentage	Participation Factor
B-9096-16	T-026N R-010W SEC.036 NW/4 SE/4	40.00		<b>Tract: 113</b>			0.08835500
			ORRI:		0.00000000	10.10964200	
			ROYALTY:		0.00000000	12.50000000	
			WORKING INTEREST:	BURLINGTON RESOURCES O&G COLP	65.04244100	46.81562300	
				KELLY MINERALS INTERESTS JV	0.17440400	0.15260400	
				LANGDON D HARRISON REVOC TRUST E	0.10463900	0.09156900	
				MARYAN KLINGER TRUST	0.08645100	0.07305200	
				PRODUCTION GATHERING COMPANY LE	0.17291100	0.14611000	
				XTO ENERGY INC	34.06968000	29.80708000	
				ZZZ KELLY & TRUST LLC	0.34947400	0.30433000	
			<b>TOTAL</b>		<b>100.00000000</b>	<b>100.00000000</b>	

Tract Remarks:  
 BR AND HUDSON POOL BEAR A 3.0% ORRI. BR BEARS THE REMAINING ORRI.

Serial Num	Description	Number of Acres	Ownership	Drilling Block	GWI Percentage	NRI Percentage	Participation Factor
			ORRI:		0.00000000	10.10964200	
			ROYALTY:		0.00000000	12.50000000	
			WORKING INTEREST:	BURLINGTON RESOURCES O&G COLP	65.04244100	46.81562300	
				KELLY MINERALS INTERESTS JV	0.17440400	0.15260400	
				LANGDON D HARRISON REVOC TRUST E	0.10463900	0.09156900	
				MARYAN KLINGER TRUST	0.08645100	0.07305200	
				PRODUCTION GATHERING COMPANY LE	0.17291100	0.14611000	
				XTO ENERGY INC	34.06968000	29.80708000	
				ZZZ KELLY & TRUST LLC	0.34947400	0.30433000	
			<b>TOTAL</b>		<b>100.00000000</b>	<b>100.00000000</b>	

**BURLINGTON RESOURCES O&G CO LP - Operator**  
 The 052 Expanded Participating Area for Dakota Formation

Huerfano Unit Area  
 San Juan, New Mexico  
 Effective 10/01/2008

Serial Num	Description	Number of Acres	Ownership	Drilling Block	GWI Percentage	NRI Percentage	Participation Factor
B-9096-17	T-026N R-010W	40.00	ORRI:	<b>Tract: 113A</b>	0.00000000	10.10964200	0.08835500
	SEC.036 SW/4 NE/4		ROYALTY:		0.00000000	12.50000000	
			WORKING INTEREST:	BURLINGTON RESOURCES O&G CO LP	65.04244100	46.81562300	
				KELLY MINERALS INTERESTS JV	0.17440400	0.15260400	
				LANGDON D HARRISON REVOC TRUST E	0.10463900	0.09155900	
				MARYAN KLINGER TRUST	0.08645100	0.07305200	
				PRODUCTION GATHERING COMPANY LF	0.17291100	0.14611000	
				XTO ENERGY INC	34.06968000	29.80708000	
				ZZZ KELLY & TRUST LLC	0.34947400	0.30433000	
			TOTAL		100.00000000	100.00000000	
B-9096-17	T-026N R-009W	40.00	ORRI:	<b>Tract: 113B</b>	0.00000000	10.13469900	0.08835500
	SEC.032 SE/4 SW/4		ROYALTY:		0.00000000	12.50000000	
			WORKING INTEREST:	BURLINGTON RESOURCES O&G CO LP	65.73732700	47.38971900	
				KELLY MINERALS INTERESTS JV	0.05436000	0.04756500	
				LANGDON D HARRISON REVOC TRUST E	0.03261700	0.02854000	
				MARYAN KLINGER TRUST	0.02803700	0.02369200	
				PRODUCTION GATHERING COMPANY LF	0.05607100	0.04738000	
				XTO ENERGY INC	33.98204700	29.73303000	
				ZZZ KELLY & TRUST LLC	0.10954100	0.09537500	
			TOTAL		100.00000000	100.00000000	

Tract Remarks:  
 BR AND HUDSON POOL BEAR A 3.0% ORRI, BR BEARS THE REMAINING ORRI.

**BURLINGTON RESOURCES O&G CO LP - Operator**  
 The 052 Expanded Participating Area for Dakota Formation

Huerfano Unit Area  
 San Juan, New Mexico  
 Effective 10/01/2008

Serial Num	Description	Number of Acres
	T-028N R-010W	
	SEC.036 NW/4 SE/4	

Ownership	Drilling Block	GW/Percentage	NRI/Percentage	Participation Factor
	<b>Tract: 114</b>			
TOTAL				

Tract Remarks:  
 TRACT NOT COMMITTED TO UNIT.

Serial Num	Description	Number of Acres
B-8381-27	T-028N R-010W	40.00
	SEC.036 SE4 SE/4	

Ownership	Drilling Block	GW/Percentage	NRI/Percentage	Participation Factor
	<b>Tract: 115</b>			
ORRI:		0.00000000	10.10964200	0.08835500
ROYALTY:		0.00000000	12.50000000	
WORKING INTEREST:	BURLINGTON RESOURCES O&G CO LP	65.04244100	46.81562300	
	KELLY MINERALS INTERESTS JV	0.17440400	0.15260400	
	LANGDON D HARRISON REVOC TRUST E	0.10463900	0.09155900	
	MARYANN KLINGER TRUST	0.08645100	0.07305200	
	PRODUCTION GATHERING COMPANY LF	0.17291100	0.14611000	
	XTO ENERGY INC	34.06968000	29.80708000	
	ZZZ KELLY & TRUST LLC	0.34947400	0.30433000	
TOTAL		100.00000000	100.00000000	

Serial Num	Description	Number of Acres
	T-028N R-009W	
	SEC.016 E/2 NW/4, SW/4	
	SW/4, N/2 SW/4	

Ownership	Drilling Block	GW/Percentage	NRI/Percentage	Participation Factor
	<b>Tract: 116</b>			
TOTAL				

Tract Remarks:  
 TRACT NOT COMMITTED TO UNIT.

**BURLINGTON RESOURCES O&G CO LP - Operator**

The 052 Expanded Participating Area for Dakota Formation

Huerfano Unit Area  
 San Juan, New Mexico  
 Effective 10/01/2008

Serial Num	Description	Number of Acres	Ownership	Drilling Block	GW/Percentage	NRI/Percentage	Participation Factor
------------	-------------	-----------------	-----------	----------------	---------------	----------------	----------------------

T-026N R-009W  
 SEC.016 SE/4 SE/4, NE/4

TOTAL

Tract: 116A

Tract Remarks:  
 TRACT NOT COMMITTED TO UNIT.

B-9320-10		200.00					
-----------	--	--------	--	--	--	--	--

T-026N R-009W

ORRI:  
 ROYALTY:  
 WORKING INTEREST:

Tract: 117

0.00000000 12.57562200  
 0.00000000 12.50000000  
 99.60041800 74.58131000  
 0.05436000 0.04756400  
 0.03261700 0.02854000  
 0.04323100 0.03653100  
 0.08644900 0.07304900  
 0.06484000 0.05479000  
 0.11808500 0.10259400  
 100.00000000 100.00000000

Tract Remarks:  
 BRAND HUDSON POOL BEAR A 3.0% ORRI. BR BEARS THE REMAINING ORRI.

Serial Num	Description	Number of Acres	Ownership	Drilling Block	GW/Percentage	NRI/Percentage	Participation Factor
------------	-------------	-----------------	-----------	----------------	---------------	----------------	----------------------

T-026N R-009W  
 SEC.032 SW/4 NW/4

TOTAL

Tract: 119A

Tract Remarks:  
 TRACT NOT COMMITTED TO UNIT.

**BURLINGTON RESOURCES O&G CO LP - Operator**  
 The 052 Expanded Participating Area for Dakota Formation  
 Huertano Unit Area  
 San Juan, New Mexico  
 Effective 10/01/2008

Serial Num	Description	Number of Acres	Ownership	Drilling Block	GW/Percentage	NRI Percentage	Participation Factor
E-2941-2		80.00		<b>Tract: 120</b>			0.17670900
	T-026N R-009W		ORRI:		0.00000000	7.20632000	
	SEC.032 N/2 SW/4		ROYALTY:		0.00000000	12.50000000	
			WORKING INTEREST:	BURLINGTON RESOURCES O&G CO LP	66.06000000	50.59618000	
				XTO ENERGY INC	33.94000000	29.69750000	
			TOTAL		100.00000000	100.00000000	

Serial Num	Description	Number of Acres	Ownership	Drilling Block	GW/Percentage	NRI Percentage	Participation Factor
E-2659-11		160.00		<b>Tract: 122</b>			0.35341900
	T-027N R-010W		ORRI:		0.00000000	5.00000000	
	SEC.032 NW/4		ROYALTY:		0.00000000	12.50000000	
			WORKING INTEREST:	BURLINGTON RESOURCES O&G CO LP	100.00000000	82.50000000	
			TOTAL		100.00000000	100.00000000	

Serial Num	Description	Number of Acres	Ownership	Drilling Block	GW/Percentage	NRI Percentage	Participation Factor
E-2659-11		160.00		<b>Tract: 122A</b>			0.35341900
	T-027N R-010W		ORRI:		0.00000000	5.00000000	
	SEC.032 SW/4		ROYALTY:		0.00000000	12.50000000	
			WORKING INTEREST:	BETTY T JOHNSTON MARITAL TRUST	25.00000000	20.62500000	
				EULA MAY JOHNSTON TRUST 661	50.00000000	41.24999900	
				GRAYFORE PARTNERS LP	2.08333300	1.71875000	
				ROGERS GIBBARD TRUST	12.49999800	10.31250100	
				VA JOHNSTON LTD	10.41666900	8.59375000	
			TOTAL		100.00000000	100.00000000	

Tract Remarks:  
 ORRI BORNE 100% BY OTHERS -- NOT XTO.

**BURLINGTON RESOURCES O&G CO LP - Operator**

The 052 Expanded Participating Area for Dakota Formation

Huerfano Unit Area  
 San Juan, New Mexico  
 Effective 10/01/2008

Serial Num	Description	Number of Acres
E-2659-11	T-027N R-010W	320.00
	SEC.032 E/2	

Ownership	Drilling Block	GW/Percentage	NRI/Percentage	Participation Factor
	<b>Tract: 122B</b>			
ORRI:		0.00000000	84.20000000	0.70693800
ROYALTY:		0.00000000	12.50000000	
WORKING INTEREST:	BURLINGTON RESOURCES O&G CO LP	100.00000000	3.30000000	
<b>TOTAL</b>		<b>100.00000000</b>	<b>100.00000000</b>	

Tract Remarks:  
 SUBJECT TO BEAMON GLA-77 - 79.2% NPI INCLUDED AS A W/ FOR BILLING PURPOSES. BR BEARS 100% OF THE TOTAL ORRI.

Serial Num	Description	Number of Acres
E-2942-4	T-026N R-010W	40.00
	SEC.036 SW/4 NW/4	

Ownership	Drilling Block	GW/Percentage	NRI/Percentage	Participation Factor
	<b>Tract: 123</b>			
ORRI:		0.00000000	7.20632000	0.08835500
ROYALTY:		0.00000000	12.50000000	
WORKING INTEREST:	BURLINGTON RESOURCES O&G CO LP	66.06000000	50.59618000	
	XTO ENERGY INC	33.94000000	29.69750000	
<b>TOTAL</b>		<b>100.00000000</b>	<b>100.00000000</b>	

Tract Remarks:  
 BR BEARS 100% OF THE TOTAL ORRI.

Serial Num	Description	Number of Acres
E-2941-5	T-026N R-009W	120.00
	SEC.032 NW/4 NW/4, SE/4 NW/4, SW/4 SW/4	

Ownership	Drilling Block	GW/Percentage	NRI/Percentage	Participation Factor
	<b>Tract: 123A</b>			
ORRI:		0.00000000	7.20632000	0.26506400
ROYALTY:		0.00000000	12.50000000	
WORKING INTEREST:	BURLINGTON RESOURCES O&G CO LP	66.06000000	50.59618000	
	XTO ENERGY INC	33.94000000	29.69750000	
<b>TOTAL</b>		<b>100.00000000</b>	<b>100.00000000</b>	

Tract Remarks:  
 BR BEARS 100% OF THE TOTAL ORRI.

**BURLINGTON RESOURCES O&G CO LP - Operator**  
 The 052 Expanded Participating Area for Dakota Formation  
 Huerfano Unit Area  
 San Juan, New Mexico  
 Effective 10/01/2008

Serial Num	Description	Number of Acres	Ownership	Drilling Block	GWI Percentage	NRI Percentage	Participation Factor
E-2942-4	T-026N R-010W	200.00	ORRI:	<b>Tract: 123B</b>	0.00000000	7.20632000	0.44177400
	SEC.002 E/2 SE/4		ROYALTY:		0.00000000	12.50000000	
	SEC.016 SW/4 NW/4 SE/4		WORKING INTEREST:		66.06000000	50.59618000	
	SW/4, NE/4 SE/4				33.94000000	29.69750000	
			TOTAL		100.00000000	100.00000000	

Tract Remarks:  
 BR BEARS 100% OF THE TOTAL ORRI.

Serial Num	Description	Number of Acres	Ownership	Drilling Block	GWI Percentage	NRI Percentage	Participation Factor
E-2941-1	T-026N R-009W	40.00	ROYALTY:	<b>Tract: 139</b>	0.00000000	12.50000000	0.08835500
	SEC.016 NE/4 SE/4		WORKING INTEREST:		100.00000000	87.50000000	
			TOTAL		100.00000000	100.00000000	

Serial Num	Description	Number of Acres	Ownership	Drilling Block	GWI Percentage	NRI Percentage	Participation Factor
FEE	T-026N R-010W	320.00	ORRI:	<b>Tract: 140</b>	0.00000000	5.00000000	0.70683800
	SEC.021 S/2 NE/4, N/2 SE/4, SE/4 SE/4		ROYALTY:		0.00000000	12.50000000	
	SEC.022 W/2 SW/4, SW/4 NW/4		WORKING INTEREST:		100.00000000	82.50000000	
			TOTAL		100.00000000	100.00000000	

**BURLINGTON RESOURCES O&G CO LP - Operator**  
 The 052 Expanded Participating Area for Dakota Formation  
 Huertano Unit Area  
 San Juan, New Mexico  
 Effective 10/01/2008

Serial Num	Description	Number of Acres	Ownership	Drilling Block	GWIPercentage	NRI Percentage	Participation Factor
C.E. THOMPSON, ET UX		40.00		<b>Tract: 141</b>			0.08835500
	T-026N R-009W		ORRI:		0.00000000	15.50000000	
	SEC.022 NE/4 SE/4		ROYALTY:		0.00000000	12.50000000	
			WORKING INTEREST:	AJM LLC	0.48750000	0.35099900	
				BURLINGTON RESOURCES O&G CO LP	67.50000000	48.60000000	
				MCCONNELL LTD CO	32.01249900	23.04900000	
			<b>TOTAL</b>		<b>100.00000000</b>	<b>100.00000000</b>	

Serial Num	Description	Number of Acres	Ownership	Drilling Block	GWIPercentage	NRI Percentage	Participation Factor
GLEN W. SWIRE, ET UX		40.00		<b>Tract: 142</b>			0.08835500
	T-026N R-009W		ORRI:		0.00000000	1.75000000	
	SEC.022 SE/4 NW/4		WORKING INTEREST:	BENSON MONTIN GREER DRILLING COR	9.70000000	9.53025000	
				BURLINGTON RESOURCES O&G CO LP	53.78750000	52.84621800	
				FRANKLIN P LILLY	0.16750000	0.16456900	
				LA PLATA GATHERING SYSTEM INC	0.67000000	0.65627500	
				MICHAEL R DIMOND	2.42500000	2.38256300	
				THOMAS H YATES JR	33.25000000	32.66812500	
			<b>TOTAL</b>		<b>100.00000000</b>	<b>100.00000000</b>	

Tract Remarks:  
 12.5% ROYALTY INTEREST NOT COMMITTED.



**BURLINGTON RESOURCES O&G CO LP - Operator**  
 The 052 Expanded Participating Area for Dakota Formation  
 Huerfano Unit Area  
 San Juan, New Mexico  
 Effective 10/01/2008

Serial Num	Description	Number of Acres	Ownership	Drilling Block	GWI Percentage	NRI Percentage	Participation Factor
GLEN W. SWIRE, ET UX		80.00		<b>Tract: 142A</b>			0.17670900

T-025N R-009W  
 SEC.022 S/2 NE/4

Tract Remarks:  
 12.5% ROYALTY INTEREST NOT COMMITTED.

ORRI:		0.00000000				1.75000000	
WORKING INTEREST:	BENSON MONTIN GREER DRILLING COR	9.70000000				9.53025000	
	BURLINGTON RESOURCES O&G CO LP	53.78750000				52.84621800	
	FRANKLIN P LILLY	0.16750000				0.16456900	
	LA PLATA GATHERING SYSTEM INC	0.67000000				0.65627500	
	MICHAEL R DIMOND	2.42500000				2.38256300	
	THOMAS H YATES JR	33.25000000				32.66812500	
<b>TOTAL</b>		<b>100.00000000</b>				<b>100.00000000</b>	

Serial Num	Description	Number of Acres	Ownership	Drilling Block	GWI Percentage	NRI Percentage	Participation Factor
				<b>Tract: 143</b>			

T-025N R-010W  
 SEC.002 LOT.1  
 SEC.002 LOT.2  
 SEC.002 S/2 NE/4

Tract Remarks:  
 TRACT NOT COMMITTED TO UNIT.

<b>TOTAL</b>							
--------------	--	--	--	--	--	--	--

T-025N R-010W  
 SEC.002 SE/4

Tract Remarks:  
 TRACT NOT COMMITTED TO UNIT.

Serial Num	Description	Number of Acres	Ownership	Drilling Block	GWI Percentage	NRI Percentage	Participation Factor
				<b>Tract: 143A</b>			
<b>TOTAL</b>							

**BURLINGTON RESOURCES O&G CO LP - Operator**  
 The 052 Expanded Participating Area for Dakota Formation  
 Huerfano Unit Area  
 San Juan, New Mexico  
 Effective 10/01/2008

Serial Num	Description	Number of Acres	Ownership	Drilling Block	GWI Percentage	NRI Percentage	Participation Factor
	T-025N R-010W						
	SEC.002 LOT 3	40.04					
	SEC.002 LOT 4	40.13					
	SEC.002 S/2NW/4						
TOTAL				Tract: 143B			

Tract Remarks:  
 TRACT NOT COMMITTED TO UNIT.

Serial Num	Description	Number of Acres	Ownership	Drilling Block	GWI Percentage	NRI Percentage	Participation Factor
	T-025N R-010W						
	SEC.002 SW/4						
TOTAL				Tract: 143C			

Tract Remarks:  
 TRACT NOT COMMITTED TO UNIT.

Serial Num	Description	Number of Acres	Ownership	Drilling Block	GWI Percentage	NRI Percentage	Participation Factor
	T-025N R-010W						
	SEC.011 NE/4						
TOTAL				Tract: 143D			

Tract Remarks:  
 TRACT NOT COMMITTED TO UNIT.

**BURLINGTON RESOURCES O&G CO LP - Operator**  
 The 052 Expanded Participating Area for Dakota Formation

Huerfano Unit Area  
 San Juan, New Mexico  
 Effective 10/01/2008

Serial Num	Description	Number of Acres	Ownership	Drilling Block	GW/Percentage	NRI Percentage	Participation Factor
	T-025N R-010W			Tract: 143E			
	SEC.011 SE/4						
TOTAL							

Tract Remarks:  
 TRACT NOT COMMITTED TO UNIT.

Serial Num	Description	Number of Acres	Ownership	Drilling Block	GW/Percentage	NRI Percentage	Participation Factor
	T-025N R-010W			Tract: 143F			
	SEC.011 NW/4						
TOTAL							

Tract Remarks:  
 TRACT NOT COMMITTED TO UNIT.

Serial Num	Description	Number of Acres	Ownership	Drilling Block	GW/Percentage	NRI Percentage	Participation Factor
14-20-603-1297	T-025N R-010W	160.00		Tract: 143G			
	SEC.011 SW/4						
TOTAL							0.00000000

Tract Remarks:  
 TRACT NOT COMMITTED TO UNIT.

**BURLINGTON RESOURCES O&G CO LP - Operator**  
 The 052 Expanded Participating Area for Dakota Formation  
 Huerfano Unit Area  
 San Juan, New Mexico  
 Effective 10/01/2008

Serial Num	Description	Number of Acres	Ownership	Drilling Block	GWl Percentage	NRl Percentage	Participation Factor
14-20-603-9537	T-025N R-009W	120.00		<b>Tract: 144</b>			0.26506400
	SEC.007 SE/4 SE/4		ROYALTY:		0.00000000	16.66666700	
	SEC.008 W/2 SW/4		WORKING INTEREST:	BURLINGTON RESOURCES O&G CO LP	50.00000000	41.66666600	
				XTO ENERGY INC	50.00000000	41.66666700	
			<b>TOTAL</b>		<b>100.00000000</b>	<b>100.00000000</b>	