

# Gas Composition Analysis Method of Allocation San Juan 29-5 Unit

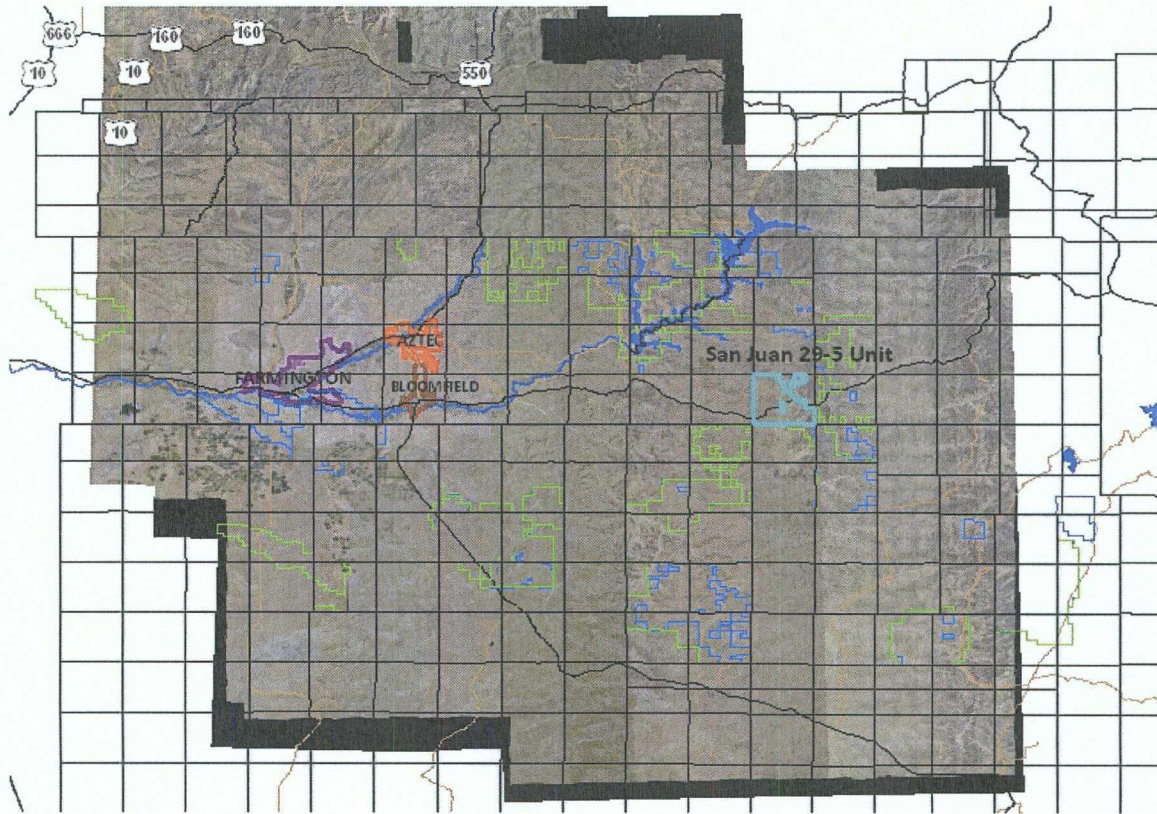

Before the Oil Conservation Division  
Burlington Resources Oil & Gas Company LP  
**Order No. R-10707 (OCD Case 11708)**  
Initial Hearing: September 30, 2010

EXHIBIT 7

## TABLE OF CONTENTS

San Juan Basin Map - San Juan 29-5 Unit

---

1

MesaVerde and Dakota Participating  
Area Maps

---

2

Order R-10707, (OCD Case 11708)

---

3

Owner Notifications Tracking  
Spreadsheets

---

4

Notice Letter and Follow-up  
Correspondence Spreadsheet

---

5

Reference to Location of Green Cards

---

6

Attorney's Certification of Mailing and  
Newspaper Notice

---

7

NMOCD Gas Composition Analysis  
Method of Allocation Approval Letter

---

8

Before the Oil Conservation Division  
Exhibit No. 1  
Burlington Resources Oil & Gas Company LP  
**ORDER R-10707, OCD CASE 11708**  
Initial Hearing: September 30, 2010



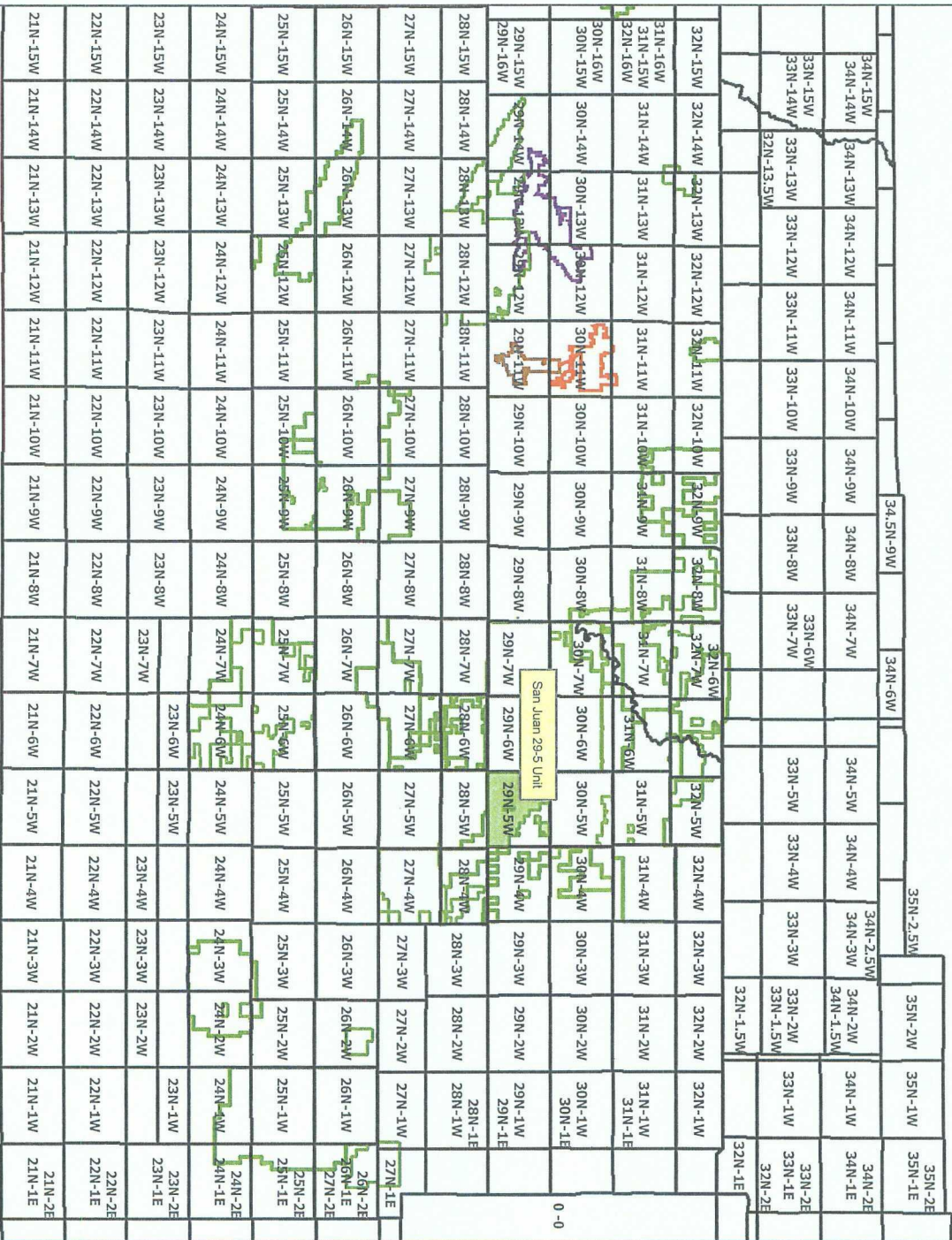

**Legend**

- San Juan 29-5 Unit
- LA8 ALL SUB FEDERAL UNITS
- AZTEC
- BLOOMFIELD
- FARMINGTON

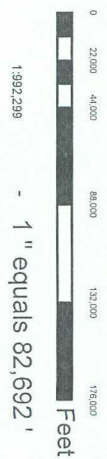

1:992,299 - 1" equals 82,692'

GCS Assumed Geographic 1

**ConocoPhillips**  
© Unpublished Work, ConocoPhillips

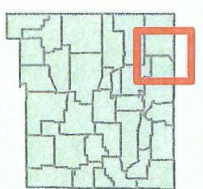

# San Juan 29-5 Unit

Author:	Richard Davis	Date:	9/20/2010
Compiled by:		Scale:	
Project File:	D:\unpublished\Projects\and\Tombaja\Tombaja 1.mxd		