

YATES PETROLEUM CORP.
BEFORE EXAMINER CATANACH
NMOCD CASE NO. 11210
DATE: 03/02/95
EXHIBIT NO. 1



Yates Petroleum Corporation		
NEW MEXICO 17-10S-25E ROSE CANNON AOR COM #1		
PRO: ROSE CANNON		2/27/95
PRES: ROSECANI	Scale 1:24000.	

MARTIN YATES, III
1912 - 1985
FRANK W. YATES
1936 - 1986



105 SOUTH FOURTH STREET
ARTESIA, NEW MEXICO 88210
TELEPHONE (505) 748-1471

S. P. YATES
CHAIRMAN OF THE BOARD
JOHN A. YATES
PRESIDENT
PEYTON YATES
EXECUTIVE VICE PRESIDENT
RANDY G. PATTERSON
SECRETARY
DENNIS G. KINSEY
TREASURER

June 10, 1994

Pam Rose Ridge
1006 Birchwood Lane
Mansfield, TX 76063

RE: Oil and Gas Lease
Township 10 South, Range 25 East
Section 17: W/2SE/4, NE/4SW/4, N/2SE/4SW/4
Chaves County, New Mexico

Dear Ms. Ridge:

After speaking with Mr. Carl Schellinger regarding your 1/56 mineral interest in the captioned acreage, I have taken the liberty of enclosing a one (1) year, 1/4 royalty, Oil and Gas Lease for your review.

If everything is in order, please execute the lease before a notary public and return one (1) original to our office for recording in Chaves County.

Please account for your marital status, single or married, at the top of the lease.

Should you have any questions, please call me collect at (505) 748-1471. Thank you.

Very truly yours,

YATES PETROLEUM CORPORATION

Robert Bullock
Landman

RB/jrw
Enclosures

YATES PETROLEUM CORP.
BEFORE EXAMINER CATANACH
NMCD CASE NO. 11210
DATE: 03/02/95
EXHIBIT NO. 2

MARTIN YATES, III
1912 - 1985
FRANK W. YATES
1936 - 1986



105 SOUTH FOURTH STREET
ARTESIA, NEW MEXICO 88210
TELEPHONE (505) 748-1471

S. P. YATES
CHAIRMAN OF THE BOARD
JOHN A. YATES
PRESIDENT
PEYTON YATES
EXECUTIVE VICE PRESIDENT
RANDY G. PATTERSON
SECRETARY
DENNIS G. KINSEY
TREASURER

June 10, 1994

Sue-Ann Rose Edwards
8815 Mountain Path Circle
Austin, TX 78759

RE: Oil and Gas Lease
Township 10 South, Range 25 East
Section 17: W/2SE/4, NE/4SW/4, N/2SE/4SW/4
Chaves County, New Mexico

Dear Ms. Edwards:

After speaking with Mr. Carl Schellinger regarding your 1/56 mineral interest in the captioned acreage, I have taken the liberty of enclosing a one (1) year, 1/4 royalty, Oil and Gas Lease for your review.

If everything is in order, please execute the lease before a notary public and return one (1) original to our office for recording in Chaves County.

Please account for your marital status, single or married, at the top of the lease.

Should you have any questions, please call me collect at (505) 748-1471. Thank you.

Very truly yours,

YATES PETROLEUM CORPORATION

Robert Bullock
Landman

RB/jrw
Enclosures

MARTIN YATES, III
1912 - 1985
FRANK W. YATES
1936 - 1986



105 SOUTH FOURTH STREET
ARTESIA, NEW MEXICO 88210
TELEPHONE (505) 748-1471

S. P. YATES
CHAIRMAN OF THE BOARD
JOHN A. YATES
PRESIDENT
PEYTON YATES
EXECUTIVE VICE PRESIDENT
RANDY G. PATTERSON
SECRETARY
DENNIS G. KINSEY
TREASURER

June 10, 1994

Julia Rose Heald
3301 Elm Street
Dallas, TX 75226

RE: Oil and Gas Lease
Township 10 South, Range 25 East
Section 17: W/2SE/4, NE/4SW/4, N/2SE/4SW/4
Chaves County, New Mexico

Dear Ms. Heald:

After speaking with Mr. Carl Schellinger regarding your 1/56 mineral interest in the captioned acreage, I have taken the liberty of enclosing a one (1) year, 1/4 royalty, Oil and Gas Lease for your review.

If everything is in order, please execute the lease before a notary public and return one (1) original to our office for recording in Chaves County.

Please account for your marital status, single or married, at the top of the lease.

Should you have any questions, please call me collect at (505) 748-1471. Thank you.

Very truly yours,

YATES PETROLEUM CORPORATION

Robert Bullock
Landman

RB/jrw
Enclosures

MARTIN YATES, III
1912 - 1985
FRANK W. YATES
1936 - 1986



105 SOUTH FOURTH STREET
ARTESIA, NEW MEXICO 88210
TELEPHONE (505) 748-1471

S. P. YATES
CHAIRMAN OF THE BOARD
JOHN A. YATES
PRESIDENT
PEYTON YATES
EXECUTIVE VICE PRESIDENT
RANDY G. PATTERSON
SECRETARY
DENNIS G. KINSEY
TREASURER

December 6, 1994

Pam Rose Ridge
1006 Birchwood Lane
Mansfield, Texas 76063

Re: Rose-Cannon "AOR" Com. #1
Township 10 South, Range 25 East
Section 17: SE/4
Chaves County, New Mexico

Dear Ms. Ridge:

Please find enclosed our Operating Agreement which will cover future operations on the captioned well in which you have a 1/56 mineral interest. As you know, this well was drilled in 1982 and your interest has never been accounted for. Yates anticipates that this well is going to be put on production in the very near future, therefore, for purposes of distributing monies payable from production we offer you the following options with respect to your interest:

1. Sign and return one copy of the extra signature page to the enclosed Operating Agreement and Designation of Pooled Unit Agreement and you will become a working interest participant; Expect to be billed for your cost of drilling and completing the well and all future operations which will include the cost of hooking the well up.
2. Sign and return the enclosed Oil and Gas Lease which will pay you a 1/4 royalty on oil and gas produced, proportionately reduced to your 1/56 mineral ownership.
3. Farmout to Yates reserving a 3/16 of 8/8ths overriding until payout of the well at which time all of your reserved overriding royalty interest will convert to a 25% working interest, subject to proportionate reduction.

In the near future, Yates will initiate Compulsory Pooling Proceedings at the New Mexico Oil Conservation Commission at which time your interest will be pooled if you have not made one of the above elections.

Please call me at (505) 748-1471 and advise me on how we can account for your interest.

Thank you.

Very truly yours,

YATES PETROLEUM CORPORATION

Robert Bullock
Landman

RB:dke
enclosure(s)

YATES PETROLEUM CORP.
BEFORE EXAMINER CATANACH
NMOCD CASE NO. 11210
DATE: 03/02/95
EXHIBIT NO. 3

SENDER: <ul style="list-style-type: none">• Complete items 1 and/or 2 for additional services.• Complete items 3, and 4a & b.• Print your name and address on the reverse of this form so that we can return this card to you.• Attach this form to the front of the mailpiece, or on the back if space does not permit.• Write "Return Receipt Requested" on the mailpiece below the article number.• The Return Receipt will show to whom the article was delivered and the date delivered.		I also wish to receive the following services (for an extra fee): 1. <input type="checkbox"/> Addressee's Address 2. <input type="checkbox"/> Restricted Delivery Consult postmaster for fee.	
3. Article Addressed to: Pam Rose Ridge 1006 Birchwood Lane Mansfield, Texas 76063		4a. Article Number Z 061 314 893	
		4b. Service Type <input type="checkbox"/> Registered <input type="checkbox"/> Insured <input checked="" type="checkbox"/> Certified <input type="checkbox"/> COD <input type="checkbox"/> Express Mail <input type="checkbox"/> Return Receipt for Merchandise	
5. Signature (Addressee) 		7. Date of Delivery 12-8-94	
6. Signature (Agent) 		8. Addressee's Address (Only if requested and fee is paid) Rose-Cannon AOR Com. #1	

Thank you for using Return Receipt Service.

Z 061 314 893
Receipt for Certified Mail
No Insurance Coverage Provided
Do not use for International Mail
(See Reverse)

Pam Rose Ridge
1006 Birchwood Lane
Mansfield, Texas 76063

P.O., State and ZIP Code	
Postage	\$
Certified Fee	
Special Delivery Fee	
Restricted Delivery Fee	
Return Receipt Showing to Whom & Date Delivered	

OIL AND GAS LEASE

THIS AGREEMENT made this 6th day of December, 1994, between
PAM ROSE RIDGE, A WOMAN, LESSOR; AND
YATES PETROLEUM CORPORATION 70%, YATES DRILLING COMPANY 10%, ABO PETROLEUM CORPORATION 10%
AND MYCO INDUSTRIES, INC. 10%, ALL NEW MEXICO CORPORATIONS, LESSEE,

WITNESSETH:

1. Lessor in consideration of Ten and no/100----- Dollars
 (\$ 10.00) in hand paid, of the royalties herein provided and of the agreements of Lessee herein contained, hereby grants, leases and lets exclusively unto Lessee for the purpose of investigating, exploring, prospecting, drilling and mining for and producing oil and gas, laying pipe lines, building roads, tanks, power stations, telephone lines and other structures thereon and on, over and across lands owned or claimed by Lessor adjacent and contiguous thereto, to produce, save, take care of, treat, transport, and own said products, and housing its employees, the following described land in Chaves County, New Mexico, to-wit:

Township 10 South, Range 25 East
Section 17: W/2SE/4
from the surface of the earth to
4245 feet below the surface

2. Without reference to the commencement, prosecution or cessation at any time of drilling or other development operations and/or to the discovery, development or cessation at any time of production of oil or gas and without further payments than the royalties herein provided, and notwithstanding anything else herein contained to the contrary, this lease shall be for a term of ONE year from this date (called "primary term") and as long thereafter as oil or gas is produced from said land or land with which said land is pooled hereunder.

3. The royalties to be paid by Lessee are: (a) on oil, 1/4th of that produced and saved from said land, the same to be delivered at the wells or to the credit of Lessor into the pipe line to which the wells may be connected; Lessee may from time to time purchase any royalty oil in its possession, paying the market price therefor prevailing for the field where produced on the date of purchase; (b) on gas, including casinghead gas or other gaseous substance, produced from said land, and sold, or used off the premises or for the extraction of gasoline or other product therefrom, the market value at the well of 1/4th

of the gas so sold or used, provided that on gas sold at the wells the royalty shall be 1/4th of the amount realized from such sale; while there is a gas well on this lease or on acreage pooled therewith but gas is not being sold or used, Lessee may pay or tender as royalty, on or before ninety (90) days after the date on which said well is shut in and thereafter at annual intervals the sum of \$1.00 per acre, and if such payment is made or tendered, this lease shall not terminate and it will be considered that gas is being produced from this lease in paying quantities. Payment or tender of said shut-in gas royalty may be made by check or draft of Lessee mailed or delivered to the parties entitled thereto on or before the date said payment is due. Lessee shall have free use of oil, gas, coal and water from said land, except water from Lessor's wells, for all operations hereunder, and the royalty on oil and gas shall be computed after deducting any so used.

4. Lessee, at its option, is hereby given the right and power to pool or combine the acreage covered by this lease, or any portion thereof as to oil and gas, or either of them, with other land, lease or leases in the immediate vicinity thereof to the extent, hereinafter stipulated, when in Lessee's judgment it is necessary or advisable to do so in order properly to explore, or to develop and operate said leased premises in compliance with the spacing rules of the New Mexico Oil Conservation Commission, or other lawful authority or when to do so would, in the judgment of Lessee, promote the conservation of oil and gas in and under and that may be produced from said premises. Units pooled for oil hereunder shall not substantially exceed 40 acres each in area, and units pooled for gas hereunder shall not substantially exceed in area 640 acres each plus a tolerance of 10% thereof, provided that should governmental authority having jurisdiction prescribe or permit the creation of units larger than those specified, units thereafter created may conform substantially in size with those prescribed by governmental regulations. Lessee under the provisions hereof may pool or combine acreage covered by this lease, or any portion thereof as above provided as to oil in any one or more strata and as to gas in any one or more strata. The units formed by pooling as to any stratum or strata need not conform in size or area with the unit or units into which the lease is pooled or combined as to any other stratum or strata, and oil units need not conform as to area with gas units. The pooling in one or more instances shall not exhaust the rights of the Lessee hereunder to pool this lease or portions thereof into other units. Lessee shall file for record in the appropriate records of the county in which the leased premises are situated an instrument describing and designating the pooled acreage as a pooled unit. Lessee may at its election exercise its pooling option after commencing operations for or completing an oil or gas well on the leased premises, and the pooled unit may include, but it is not required to include, land or leases upon which a well capable of producing oil or gas in paying quantities has theretofore been completed or upon which operations for the drilling of a well for oil or gas have theretofore been commenced. Operations for drilling on or production of oil or gas from any part of the pooled unit which includes all or a portion of the land covered by this lease regardless of whether such operations for drilling were commenced or such production was secured before or after the execution of this instrument or the instrument designating the pooled unit, shall be considered as operations for drilling on or production of oil or gas from land covered by this lease whether or not the well or wells be located on the premises covered by this lease, and the entire acreage constituting such unit or units, as to oil and gas, or either of them, as herein provided, shall be treated for all purposes, except the payment of royalties on production from the pooled unit, as if the same were included in this lease. For the purpose of computing the royalties to which owners of royalties and payments out of production and each of them, shall be entitled on production of oil and gas, or either of them, from the pooled unit, there shall be allocated to the land covered by this lease and included in said unit a pro rata portion of the oil and gas, or either of them, produced from the pooled unit after deducting that used for operations on the pooled units. Such allocation shall be on an acreage basis—that is to say, there shall be allocated to the acreage covered by this lease and included in the pooled unit that pro rata portion of the oil and gas, or either of them, produced from the pooled unit which the number of surface acres covered by this lease and included in the pooled unit bears to the total number of surface acres included in the pooled unit. Royalties hereunder shall be computed on the portion of such production, whether it be oil and gas, or either of them, so allocated to the land covered by this lease and included in the unit just as though such production were from such land. The production from an oil well will be considered production from the lease or oil pooled unit from which it is producing and not as production from a gas pooled unit; and production from a gas well will be considered as production from the lease or gas pooled unit from which it is producing and not from an oil pooled unit. In addition to the foregoing, Lessee at its option is hereby given the right and power from time to time to commit said land or any part or formation or mineral substance covered hereby to any cooperative or unit agreement or plan of development and operation, and to any modifications thereof, which have been approved by the New Mexico Oil Conservation Commission or other lawful governmental authority. In such event, the royalty payable to Lessor hereunder shall be computed and paid on the basis of the oil or gas allocated to such land under the terms of any such agreement or plan of operation, which basis shall be the same by which the royalty due the United States or the State of New Mexico is computed and paid. This lease shall not expire during the life of such agreement or plan and shall be subject to the terms thereof and said agreement or plan of operation shall be filed with the New Mexico Oil Conservation Commission, or other lawful authority, and Lessee shall record in the County in which the leased premises are situated, an instrument describing such agreement or plan of operation and reflecting the commitment thereto, and the same may be recorded either before or after the completion of wells.

5. If at the expiration of the primary term oil or gas is not being produced on said land, or from land pooled therewith, but Lessee is then engaged in drilling or reworking operations thereon, or shall have completed a dry hole thereon within 60 days prior to the end of the primary term, the lease shall remain in force so long as operations on said well or for drilling or reworking of any additional well are prosecuted with no cessation of more than 60 consecutive days, and if they result in the production of oil or gas so long thereafter as oil or gas is produced from said land, or from land pooled therewith. If, after the expiration of the primary term of this lease and after oil or gas is produced from said land, or from land pooled therewith, the production thereof should cease from any cause, this lease shall not terminate if Lessee commences operations for drilling or reworking within 60 days after the cessation of such production, but shall remain in force and effect so long as such operations are prosecuted with no cessation of more than 60 consecutive days, and if they result in the production of oil or gas, so long thereafter as oil or gas is produced from said land, or from land pooled therewith. Any pooled unit designated by Lessee in accordance with the terms hereof, may be dissolved by Lessee by instrument filed for record in the appropriate records of the county in which the leased premises are situated at any time after the completion of a dry hole or the cessation of production on said unit. In the event a well or wells producing oil or gas in paying quantities should be brought in on adjacent land and within 660 feet of and draining the lease premises, or land pooled therewith, Lessee agrees to drill such offset well or wells as a reasonably prudent operator would drill under the same or similar circumstances. Lessee may at any time execute and deliver to Lessor or place of record a release or releases covering any portion or portions of the above described premises and thereby surrender this lease as to such portion or portions and be relieved of all obligations as to the acreage surrendered.

6. Lessee shall have the right at any time during or after the expiration of this lease to remove all property and fixtures placed by Lessee on said land, including the right to draw and remove all casing. When required by Lessor, Lessee will bury all pipe lines below ordinary plow depth, and no well shall be drilled within two hundred feet of any residence or barn now on said land without Lessor's consent.

7. The rights of either party hereunder may be assigned in whole or in part, and the provisions hereof shall extend to their heirs, successors and assigns but no change or division in ownership of the land or royalties, however accomplished, shall operate to enlarge the obligations or diminish the rights of Lessee; and no change or division in such ownership shall be binding on Lessee until thirty (30) days after Lessee shall have been furnished by registered U. S. mail at Lessee's principal place of business with a certified copy of recorded instrument or instruments evidencing same. In the event of assignment hereof in whole or in part liability for breach of any obligation hereunder shall rest exclusively upon the owner of this lease or of a portion thereof who commits such breach. If six or more parties become entitled to royalty hereunder, Lessee may withhold payment thereof unless and until furnished with a recordable instrument executed by all such parties designating an agent to receive payment for all.

8. The breach by Lessee of any obligation arising hereunder shall not work a forfeiture or termination of this lease nor cause a termination or revision of the estate created hereby nor be grounds for cancellation hereof in whole or in part. In the event Lessor considers that operations are not at any time being conducted in compliance with this lease, Lessor shall notify Lessee in writing of the facts relied upon as constituting a breach hereof, and Lessee, if in default, shall have sixty days after receipt of such notice in which to commence the compliance with the obligations imposed by virtue of this instrument. After the discovery of oil or gas in paying quantities on said premises, Lessee shall develop the acreage retained hereunder as a reasonably prudent operator but in discharging this obligation it shall in no event be required to drill more than one well per forty (40) acres of the area retained hereunder and capable of producing oil in paying quantities and one well per 640 acres plus an acreage tolerance not to exceed 10% of 640 acres of the area retained hereunder and capable of producing gas in paying quantities.

9. Lessor hereby warrants and agrees to defend the title to said land and agrees that Lessee at its option may discharge any tax, mortgage or other lien upon said land either in whole or in part, and in event Lessee does so, it shall be subrogated to such lien with the right to enforce same and apply royalties accruing hereunder toward satisfying same. Without impairment of Lessee's right under the warranty in event of failure of title, it is agreed that if Lessor owns an interest in the oil or gas on, in or under said land less than the entire fee simple estate, then the royalties to be paid Lessor shall be reduced proportionately. Should any one or more of the parties named as Lessors fail to execute this lease, it shall nevertheless be binding upon the party or parties executing the same.

10. Should Lessee be prevented from complying with any express or implied covenant of this lease, from conducting drilling or reworking operations thereon or from producing oil or gas therefrom by reason of scarcity of or inability to obtain or to use equipment or material, or by operation of force majeure, any Federal or state law or any order, rule or regulation of governmental authority, then while so prevented, Lessee's obligation to comply with such covenant shall be suspended, and Lessee shall not be liable in damages for failure to comply therewith; and this lease shall be extended while and so long as Lessee is prevented by any such cause from conducting drilling or reworking operations on or from producing oil or gas from the leased premises; and the time while Lessee is so prevented shall not be counted against Lessee, anything in this lease to the contrary notwithstanding.

IN WITNESS WHEREOF, this instrument is executed on the date first above written.

PAM ROSE RIDGE

S.S./Tax I.D.#

Lessor

S.S./Tax I.D.#

Lessor

No. _____

Oil and Gas
Lease

FROM

TO

Dated _____, 19____

No. Acres _____

County, N. M.

Term _____

This instrument was filed for record on the

_____ day of _____, 19____,

at _____ o'clock _____ M., and duly

recorded in Book _____, Page _____

of the _____ records of this office.

County Clerk

by _____, Deputy

When recorded return to

My commission expires _____, 19____

Notary Public

19____ by _____

PAM ROSE RIDGE, A

WOMAN.

The foregoing instrument was acknowledged before me this _____ day of _____

STATE OF _____

County of _____

ss. _____

INDIVIDUAL ACKNOWLEDGMENT

My Commission Expires: _____

Notary Public

of _____ on behalf of said corporation.

_____ corporation

by _____

President

The foregoing instrument was acknowledged before me this _____ day of _____, 19____

County of _____

STATE OF NEW MEXICO

ss. _____

CORPORATION ACKNOWLEDGMENT

My commission expires _____, 19____

Notary Public

19____ by _____

The foregoing instrument was acknowledged before me this _____ day of _____

County of _____

STATE OF NEW MEXICO,

ss. _____

INDIVIDUAL ACKNOWLEDGMENT

MARTIN YATES, III
1912 - 1985
FRANK W. YATES
1936 - 1986



105 SOUTH FOURTH STREET
ARTESIA, NEW MEXICO 88210
TELEPHONE (505) 748-1471

S. P. YATES
CHAIRMAN OF THE BOARD
JOHN A. YATES
PRESIDENT
PEYTON YATES
EXECUTIVE VICE PRESIDENT
RANDY G. PATTERSON
SECRETARY
DENNIS G. KINSEY
TREASURER

December 6, 1994

Julia Rose Heald
3301 Elm Street
Dallas, Texas 75226

Re: Rose-Cannon "AOR" Com. #1
Township 10 South, Range 25 East
Section 17: SE/4
Chaves County, New Mexico

Dear Ms. Heald:

Please find enclosed our Operating Agreement which will cover future operations on the captioned well in which you have a 1/56 mineral interest. As you know, this well was drilled in 1982 and your interest has never been accounted for. Yates anticipates that this well is going to be put on production in the very near future, therefore, for purposes of distributing monies payable from production we offer you the following options with respect to your interest:

1. Sign and return one copy of the extra signature page to the enclosed Operating Agreement and Designation of Pooled Unit Agreement and you will become a working interest participant; Expect to be billed for your cost of drilling and completing the well and all future operations which will include the cost of hooking the well up.
2. Sign and return the enclosed Oil and Gas Lease which will pay you a 1/4 royalty on oil and gas produced, proportionately reduced to your 1/56 mineral ownership.
3. Farmout to Yates reserving a 3/16 of 8/8ths overriding until payout of the well at which time all of your reserved overriding royalty interest will convert to a 25% working interest, subject to proportionate reduction.

In the near future, Yates will initiate Compulsory Pooling Proceedings at the New Mexico Oil Conservation Commission at which time your interest will be pooled if you have not made one of the above elections.

Please call me at (505) 748-1471 and advise me on how we can account for your interest.

Thank you.

Very truly yours,

YATES PETROLEUM CORPORATION

Robert Bullock
Landman

RB:dke
enclosure(s)

YATES PETROLEUM CORP.
BEFORE EXAMINER CATANACH
NMOCD CASE NO. 11210
DATE: 03/02/95 4
EXHIBIT NO. _____

SENDER: <ul style="list-style-type: none">• Complete items 1 and/or 2 for additional services.• Complete items 3, and 4a & b.• Print your name and address on the reverse of this form so that we can return this card to you.• Attach this form to the front of the mailpiece, or on the back if space does not permit.• Write "Return Receipt Requested" on the mailpiece below the article number.• The Return Receipt will show to whom the article was delivered and the date delivered.		I also wish to receive the following services (for an extra fee): 1. <input type="checkbox"/> Addressee's Address 2. <input type="checkbox"/> Restricted Delivery Consult postmaster for fee.	
3. Article Addressed to: Julia Rose Heald 3301 Elm Street Dallas, Texas 75226		4a. Article Number Z 061 314 984	
		4b. Service Type <input type="checkbox"/> Registered <input type="checkbox"/> Insured <input checked="" type="checkbox"/> Certified <input type="checkbox"/> COD <input type="checkbox"/> Express Mail <input type="checkbox"/> Return Receipt for Merchandise	
		7. Date of Delivery	
5. Signature (Addressee) 		8. Addressee's Address (Only if requested and fee is paid)	

Z 061 314 894

Receipt for Certified Mail
No Insurance Coverage Provided
Do not use for International Mail
(See Reverse)

Sent to Julia Rose Heald	
Street and 3301 Elm Street	
City, State and ZIP Code Dallas, Texas 75226	
Postage	\$
Certified Fee	
Special Delivery Fee	
Restricted Delivery Fee	
Return Receipt Fee	

OIL AND GAS LEASE

6th

December

1994

between

THIS AGREEMENT made this
JULIA ROSE HEALD, A

WOMAN, LESSOR; AND

YATES PETROLEUM CORPORATION 70%, YATES DRILLING COMPANY 10%, ABO PETROLEUM CORPORATION 10%
AND MYCO INDUSTRIES, INC. 10%, ALL NEW MEXICO CORPORATIONS, LESSEE,

WITNESSETH:

1. Lessor in consideration of Ten and no/100----- Dollars

(\$10.00) in hand paid, of the royalties herein provided and of the agreements of Lessee herein contained, hereby grants, leases and lets exclusively unto Lessee for the purpose of investigating, exploring, prospecting, drilling and mining for and producing oil and gas, laying pipe lines, building roads, tanks, power stations, telephone lines and other structures thereon and on, over and across lands owned or claimed by Lessor adjacent and contiguous thereto, to produce, save, take care of, treat, transport, and own said products, and housing its employees, the following described land in-----

Chaves

County,

New Mexico

to-wit:

Township 10 South, Range 25 East

Section 17: W/2SE/4

from the surface of the earth of 4245 feet below the surface

2. Without reference to the commencement, prosecution or cessation at any time of drilling or other development operations and/or to the discovery, development or cessation at any time of production of oil or gas and without further payments than the royalties herein provided, and notwithstanding anything else herein contained to the contrary, this lease shall be for a term of ONE year from this date (called "primary term") and as long thereafter as oil or gas is produced from said land or land with which said land is pooled hereunder.

3. The royalties to paid by Lessee are: (a) on oil, 1/4th of that produced and saved from said land, the same to be delivered at the wells or to the credit of Lessor into the pipe line to which the wells may be connected; Lessee may from time to time purchase any royalty oil in its possession, paying the market price therefor prevailing for the field where produced on the date of purchase; (b) on gas, including casinghead gas or other gaseous substance, produced from said land, and sold, or used off the premises or for the extraction of gasoline or other product therefrom, the market value at the well of 1/4th

of the gas so sold or used, provided that on gas sold at the wells the royalty shall be 1/4th of the amount realized from such sale; while there is a gas well on this lease or on acreage pooled therewith but gas is not being sold or used, Lessee may pay or tender as royalty, on or before ninety (90) days after the date on which said well is shut in and thereafter at annual intervals the sum of \$1.00 per acre, and if such payment is made or tendered, this lease shall not terminate and it will be considered that gas is being produced from this lease in paying quantities. Payment or tender of said shut-in gas royalty may be made by check or draft of Lessee mailed or delivered to the parties entitled thereto on or before the date said payment is due. Lessee shall have free use of oil, gas, coal and water from said land, except water from Lessor's wells, for all operations hereunder, and the royalty on oil and gas shall be computed after deducting any so used.

4. Lessee, at its option, is hereby given the right and power to pool or combine the acreage covered by this lease, or any portion thereof as to oil and gas, or either of them, with other land, lease or leases in the immediate vicinity thereof to the extent, hereinafter stipulated, when in Lessee's judgment it is necessary or advisable to do so in order properly to explore, or to develop and operate said leased premises in compliance with the spacing rules of the New Mexico Oil Conservation Commission, or other lawful authority or when to do so would, in the judgment of Lessee, promote the conservation of oil and gas in and under and that may be produced from said premises. Units pooled for oil hereunder shall not substantially exceed 40 acres each in area, and units pooled for gas hereunder shall not substantially exceed in area 640 acres each plus a tolerance of 10% thereof, provided that should governmental authority having jurisdiction prescribe or permit the creation of units larger than those specified, units thereafter created may conform substantially in size with those prescribed by governmental regulations. Lessee under the provisions hereof may pool or combine acreage covered by this lease, or any portion thereof as above provided as to oil in any one or more strata and as to gas in any one or more strata. The units formed by pooling as to any stratum or strata need not conform in size or area with the unit or units into which the lease is pooled or combined as to any other stratum or strata, and oil units need not conform as to area with gas units. The pooling in one or more instances shall not exhaust the rights of the Lessee hereunder to pool this lease or portions thereof into other units. Lessee shall file for record in the appropriate records of the county in which the leased premises are situated an instrument describing and designating the pooled acreage as a pooled unit. Lessee may at its election exercise its pooling option after commencing operations for or completing an oil or gas well on the leased premises, and the pooled unit may include, but it is not required to include, land or leases upon which a well capable of producing oil or gas in paying quantities has theretofore been completed or upon which operations for the drilling of a well for oil or gas have theretofore been commenced. Operations for drilling on or production of oil or gas from any part of the pooled unit which includes all or a portion of the land covered by this lease regardless of whether such operations for drilling were commenced or such production was secured before or after the execution of this instrument or the instrument designating the pooled unit, shall be considered as operations for drilling on or production of oil or gas from land covered by this lease whether or not the well or wells be located on the premises covered by this lease, and the entire acreage constituting such unit or units, as to oil and gas, or either of them, as herein provided, shall be treated for all purposes, except the payment of royalties on production from the pooled unit, as if the same were included in this lease. For the purpose of computing the royalties to which owners of royalties and payments out of production and each of them, shall be entitled on production of oil and gas, or either of them, from the pooled unit, there shall be allocated to the land covered by this lease and included in said unit a pro rata portion of the oil and gas, or either of them, produced from the pooled unit after deducting that used for operations on the pooled units. Such allocation shall be on an acreage basis—that is to say, there shall be allocated to the acreage covered by this lease and included in the pooled unit that pro rata portion of the oil and gas, or either of them, produced from the pooled unit which the number of surface acres covered by this lease and included in the pooled unit bears to the total number of surface acres included in the pooled unit. Royalties hereunder shall be computed on the portion of such production, whether it be oil and gas, or either of them, so allocated to the land covered by this lease and included in the unit just as though such production were from such land. The production from an oil well will be considered production from the lease or oil pooled unit from which it is producing and not as production from a gas pooled unit; and production from a gas well will be considered as production from the lease or gas pooled unit from which it is producing and not from an oil pooled unit. In addition to the foregoing, Lessee at its option is hereby given the right and power from time to time to commit said land or any part or formation or mineral substance covered hereby to any cooperative or unit agreement or plan of development and operation, and to any modifications thereof, which have been approved by the New Mexico Oil Conservation Commission or other lawful governmental authority. In such event, the royalty payable to Lessor hereunder shall be computed and paid on the basis of the oil or gas allocated to such land under the terms of any such agreement or plan of operation, which basis shall be the same by which the royalty due the United States or the State of New Mexico is computed and paid. This lease shall not expire during the life of such agreement or plan and shall be subject to the terms thereof and said agreement or plan of operation shall be filed with the New Mexico Oil Conservation Commission, or other lawful authority, and Lessee shall record in the County in which the leased premises are situated, an instrument describing such agreement or plan of operation and reflecting the commitment thereto, and the same may be recorded either before or after the completion of wells.

5. If at the expiration of the primary term oil or gas is not being produced on said land, or from land pooled therewith, but Lessee is then engaged in drilling or reworking operations thereon, or shall have completed a dry hole thereon within 60 days prior to the end of the primary term, the lease shall remain in force so long as operations on said well or for drilling or reworking of any additional well are prosecuted with no cessation of more than 60 consecutive days, and if they result in the production of oil or gas so long thereafter as oil or gas is produced from said land, or from land pooled therewith. If, after the expiration of the primary term of this lease and after oil or gas is produced from said land, or from land pooled therewith, the production thereof should cease from any cause, this lease shall not terminate if Lessee commences operations for drilling or reworking within 60 days after the cessation of such production, but shall remain in force and effect so long as such operations are prosecuted with no cessation of more than 60 consecutive days, and if they result in the production of oil or gas, so long thereafter as oil or gas is produced from said land, or from land pooled therewith. Any pooled unit designated by Lessee in accordance with the terms hereof, may be dissolved by Lessee by instrument filed for record in the appropriate records of the county in which the leased premises are situated at any time after the completion of a dry hole or the cessation of production on said unit. In the event a well or wells producing oil or gas in paying quantities should be brought in on adjacent land and within 660 feet of and draining the lease premises, or land pooled therewith, Lessee agrees to drill such offset well or wells as a reasonably prudent operator would drill under the same or similar circumstances. Lessee may at any time execute and deliver to Lessor or place of record a release or releases covering any portion or portions of the above described premises and thereby surrender this lease as to such portion or portions and be relieved of all obligations as to the acreage surrendered.

6. Lessee shall have the right at any time during or after the expiration of this lease to remove all property and fixtures placed by Lessee on said land, including the right to draw and remove all casing. When required by Lessor, Lessee will bury all pipe lines below ordinary plow depth, and no well shall be drilled within two hundred feet of any residence or barn now on said land without Lessor's consent.

7. The rights of either party hereunder may be assigned in whole or in part, and the provisions hereof shall extend to their heirs, successors and assigns but no change or division in ownership of the land or royalties, however accomplished, shall operate to enlarge the obligations or diminish the rights of Lessee; and no change or division in such ownership shall be binding on Lessee until thirty (30) days after Lessee shall have been furnished by registered U. S. mail at Lessee's principal place of business with a certified copy of recorded instrument or instruments evidencing same. In the event of assignment hereof in whole or in part liability for breach of any obligation hereunder shall rest exclusively upon the owner of this lease or of a portion thereof who commits such breach. If six or more parties become entitled to royalty hereunder, Lessee may withhold payment thereof unless and until furnished with a recordable instrument executed by all such parties designating an agent to receive payment for all.

8. The breach by Lessee of any obligation arising hereunder shall not work a forfeiture or termination of this lease nor cause a termination or revision of the estate created hereby nor be grounds for cancellation hereof in whole or in part. In the event Lessor considers that operations are not at any time being conducted in compliance with this lease, Lessor shall notify Lessee in writing of the facts relied upon as constituting a breach hereof, and Lessee, if in default, shall have sixty days after receipt of such notice in which to commence the compliance with the obligations imposed by virtue of this instrument. After the discovery of oil or gas in paying quantities on said premises, Lessee shall develop the acreage retained hereunder as a reasonably prudent operator but in discharging this obligation it shall in no event be required to drill more than one well per forty (40) acres of the area retained hereunder and capable of producing oil in paying quantities and one well per 640 acres plus an acreage tolerance not to exceed 10% of 640 acres of the area retained hereunder and capable of producing gas in paying quantities.

9. Lessor hereby warrants and agrees to defend the title to said land and agrees that Lessee at its option may discharge any tax, mortgage or other lien upon said land either in whole or in part, and in event Lessee does so, it shall be subrogated to such lien with the right to enforce same and apply royalties accruing hereunder toward satisfying same. Without impairment of Lessee's right under the warranty in event of failure of title, it is agreed that if Lessor owns an interest in the oil or gas on, in or under said land less than the entire fee simple estate, then the royalties to be paid Lessor shall be reduced proportionately. Should any one or more of the parties named as Lessors fail to execute this lease, it shall nevertheless be binding upon the party or parties executing the same.

10. Should Lessee be prevented from complying with any express or implied covenant of this lease, from conducting drilling or reworking operations thereon or from producing oil or gas therefrom by reason of scarcity of or inability to obtain or to use equipment or material, or by operation of force majeure, any Federal or state law or any order, rule or regulation of governmental authority, then while so prevented, Lessee's obligation to comply with such covenant shall be suspended, and Lessee shall not be liable in damages for failure to comply therewith; and this lease shall be extended while and so long as Lessee is prevented by any such cause from conducting drilling or reworking operations on or from producing oil or gas from the leased premises; and the time while Lessee is so prevented shall not be counted against Lessee, anything in this lease to the contrary notwithstanding.

IN WITNESS WHEREOF, this instrument is executed on the date first above written.

JULIA ROSE HEALD

S.S./Tax I.D.#

Lessor

S.S./Tax I.D.#

Lessee

No. _____

Oil and Gas
Lease

FROM

TO

dated _____, 19____

o. Acres _____

County, N. M.

rm _____
This instrument was filed for record on the

day of _____, 19____

o'clock _____ M., and duly

recorded in Book _____, Page _____

the _____ records of this office.

County Clerk

Deputy

When recorded return to

My commission expires _____, 19____

Notary Public

19____ by _____

JULIA ROSE HEALD, A

WOMAN.

The foregoing instrument was acknowledged before me this _____ day of _____

STATE OF _____
County of _____ ss.

INDIVIDUAL ACKNOWLEDGMENT

My Commission Expires _____

Notary Public

of _____ on behalf of said corporation.

_____ corporation

by _____ President

The foregoing instrument was acknowledged before me this _____ day of _____, 19____

STATE OF NEW MEXICO
County of _____ ss.

CORPORATION ACKNOWLEDGMENT

My commission expires _____, 19____

Notary Public

19____ by _____

The foregoing instrument was acknowledged before me this _____ day of _____

STATE OF NEW MEXICO,
County of _____ ss.

INDIVIDUAL ACKNOWLEDGMENT

MARTIN YATES, III
1912 - 1985
FRANK W. YATES
1936 - 1986



105 SOUTH FOURTH STREET
ARTESIA, NEW MEXICO 88210
TELEPHONE (505) 748-1471

S. P. YATES
CHAIRMAN OF THE BOARD
JOHN A. YATES
PRESIDENT
PEYTON YATES
EXECUTIVE VICE PRESIDENT
RANDY G. PATTERSON
SECRETARY
DENNIS G. KINSEY
TREASURER

December 6, 1994

Sue-Ann Rose Edwards
8815 Mountain Path Circle
Austin, Texas 78759

Re: Rose-Cannon "AOR" Com. #1
Township 10 South, Range 25 East
Section 17: SE/4
Chaves County, New Mexico

Dear Ms. Edwards:

Please find enclosed our Operating Agreement which will cover future operations on the captioned well in which you have a 1/56 mineral interest. As you know, this well was drilled in 1982 and your interest has never been accounted for. Yates anticipates that this well is going to be put on production in the very near future, therefore, for purposes of distributing monies payable from production we offer you the following options with respect to your interest:

1. Sign and return one copy of the extra signature page to the enclosed Operating Agreement and Designation of Pooled Unit Agreement and you will become a working interest participant; Expect to be billed for your cost of drilling and completing the well and all future operations which will include the cost of hooking the well up.
2. Sign and return the enclosed Oil and Gas Lease which will pay you a 1/4 royalty on oil and gas produced, proportionately reduced to your 1/56 mineral ownership.
3. Farmout to Yates reserving a 3/16 of 8/8ths overriding until payout of the well at which time all of your reserved overriding royalty interest will convert to a 25% working interest, subject to proportionate reduction.

In the near future, Yates will initiate Compulsory Pooling Proceedings at the New Mexico Oil Conservation Commission at which time your interest will be pooled if you have not made one of the above elections.

Please call me at (505) 748-1471 and advise me on how we can account for your interest.

Thank you.

Very truly yours,

YATES PETROLEUM CORPORATION

Robert Bullock
Landman

RB:dke
enclosure(s)

YATES PETROLEUM CORP.
BEFORE EXAMINER CATANACH
NMOCD CASE NO. 11210
DATE: 03/02/95
EXHIBIT NO. 5

OIL AND GAS LEASE

THIS AGREEMENT made this 6th day of December, 1994, between
SUE-ANN ROSE EDWARDS, A WOMAN, LESSOR; AND
YATES PETROLEUM CORPORATION 70%, YATES DRILLING COMPANY 10%, ABO PETROLEUM CORPORATION 10%
AND MYCO INDUSTRIES, INC. 10%, ALL NEW MEXICO CORPORATIONS, LESSEE,

WITNESSETH:

1. Lessor in consideration of Ten and no/100 Dollars
(\$ 10.00) in hand paid, of the royalties herein provided and of the agreements of Lessee herein contained, hereby grants, leases and lets exclusively unto Lessee for the purpose of investigating, exploring, prospecting, drilling and mining for and producing oil and gas, laying pipe lines, building roads, tanks, power stations, telephone lines and other structures thereon and on, over and across lands owned or claimed by Lessor adjacent and contiguous thereto, to produce, save, take care of, treat, transport, and own said products, and housing its employees, the following described land in Chaves County, New Mexico, to-wit:

Township 10 South, Range 25 East
Section 17: W/2SE/4
from the surface of the earth to 4245 feet below the surface

2. Without reference to the commencement, prosecution or cessation at any time of drilling or other development operations and/or to the discovery, development or cessation at any time of production of oil or gas and without further payments than the royalties herein provided, and notwithstanding anything else herein contained to the contrary, this lease shall be for a term of ONE year from this date (called "primary term") and as long thereafter as oil or gas is produced from said land or land with which said land is pooled hereunder.

3. The royalties to be paid by Lessee are: (a) on oil, 1/4th of that produced and saved from said land, the same to be delivered at the wells or to the credit of Lessor into the pipe line to which the wells may be connected; Lessee may from time to time purchase any royalty oil in its possession, paying the market price therefor prevailing for the field where produced on the date of purchase; (b) on gas, including casinghead gas or other gaseous substance, produced from said land, and sold, or used off the premises or for the extraction of gasoline or other product therefrom, the market value at the well of 1/4th

of the gas so sold or used, provided that on gas sold at the wells the royalty shall be 1/4th of the amount realized from such sale; while there is a gas well on this lease or on acreage pooled therewith but gas is not being sold or used, Lessee may pay or tender as royalty, on or before ninety (90) days after the date on which said well is shut in and thereafter at annual intervals the sum of \$1.00 per acre, and if such payment is made or tendered, this lease shall not terminate and it will be considered that gas is being produced from this lease in paying quantities. Payment or tender of said shut-in gas royalty may be made by check or draft of Lessee mailed or delivered to the parties entitled thereto on or before the date said payment is due. Lessee shall have free use of oil, gas, coal and water from said land, except water from Lessor's wells, for all operations hereunder, and the royalty on oil and gas shall be computed after deducting any so used.

4. Lessee, at its option, is hereby given the right and power to pool or combine the acreage covered by this lease, or any portion thereof as to oil and gas, or either of them, with other land, lease or leases in the immediate vicinity thereof to the extent, hereinafter stipulated, when in Lessee's judgment it is necessary or advisable to do so in order properly to explore, or to develop and operate said leased premises in compliance with the spacing rules of the New Mexico Oil Conservation Commission, or other lawful authority or when to do so would, in the judgment of Lessee, promote the conservation of oil and gas in and under and that may be produced from said premises. Units pooled for oil hereunder shall not substantially exceed 40 acres each in area, and units pooled for gas hereunder shall not substantially exceed in area 640 acres each plus a tolerance of 10% thereof, provided that should governmental authority having jurisdiction prescribe or permit the creation of units larger than those specified, units thereafter created may conform substantially in size with those prescribed by governmental regulations. Lessee under the provisions hereof may pool or combine acreage covered by this lease, or any portion thereof as above provided as to oil in any one or more strata and as to gas in any one or more strata. The units formed by pooling as to any stratum or strata need not conform in size or area with the unit or units into which the lease is pooled or combined as to any other stratum or strata, and oil units need not conform as to area with gas units. The pooling in one or more instances shall not exhaust the rights of the Lessee hereunder to pool this lease or portions thereof into other units. Lessee shall file for record in the appropriate records of the county in which the leased premises are situated an instrument describing and designating the pooled acreage as a pooled unit. Lessee may at its election exercise its pooling option after commencing operations for or completing an oil or gas well on the leased premises, and the pooled unit may include, but it is not required to include, land or leases upon which a well capable of producing oil or gas in paying quantities has theretofore been completed or upon which operations for the drilling of a well for oil or gas have theretofore been commenced. Operations for drilling on or production of oil or gas from any part of the pooled unit which includes all or a portion of the land covered by this lease regardless of whether such operations for drilling were commenced or such production was secured before or after the execution of this instrument or the instrument designating the pooled unit, shall be considered as operations for drilling on or production of oil or gas from land covered by this lease whether or not the well or wells be located on the premises covered by this lease, and the entire acreage constituting such unit or units, as to oil and gas, or either of them, as herein provided, shall be treated for all purposes, except the payment of royalties on production from the pooled unit, as if the same were included in this lease. For the purpose of computing the royalties to which owners of royalties and payments out of production and each of them, shall be entitled on production of oil and gas, or either of them, from the pooled unit, there shall be allocated to the land covered by this lease and included in said unit a pro rata portion of the oil and gas, or either of them, produced from the pooled unit after deducting that used for operations on the pooled units. Such allocation shall be on an acreage basis—that is to say, there shall be allocated to the acreage covered by this lease and included in the pooled unit that pro rata portion of the oil and gas, or either of them, produced from the pooled unit which the number of surface acres covered by this lease and included in the pooled unit bears to the total number of surface acres included in the pooled unit. Royalties hereunder shall be computed on the portion of such production, whether it be oil and gas, or either of them, so allocated to the land covered by this lease and included in the unit just as though such production were from such land. The production from an oil well will be considered production from the lease or oil pooled unit from which it is producing and not as production from a gas pooled unit; and production from a gas well will be considered as production from the lease or gas pooled unit from which it is producing and not from an oil pooled unit. In addition to the foregoing, Lessee at its option is hereby given the right and power from time to time to commit said land or any part or formation or mineral substance covered hereby to any cooperative or unit agreement or plan of development and operation, and to any modifications thereof, which have been approved by the New Mexico Oil Conservation Commission or other lawful governmental authority. In such event, the royalty payable to Lessor hereunder shall be computed and paid on the basis of the oil or gas allocated to such land under the terms of any such agreement or plan of operation, which basis shall be the same by which the royalty due the United States or the State of New Mexico is computed and paid. This lease shall not expire during the life of such agreement or plan and shall be subject to the terms thereof and said agreement or plan of operation shall be filed with the New Mexico Oil Conservation Commission, or other lawful authority, and Lessee shall record in the County in which the leased premises are situated, an instrument describing such agreement or plan of operation and reflecting the commitment thereto, and the same may be recorded either before or after the completion of wells.

5. If at the expiration of the primary term oil or gas is not being produced on said land, or from land pooled therewith, but Lessee is then engaged in drilling or reworking operations thereon, or shall have completed a dry hole thereon within 60 days prior to the end of the primary term, the lease shall remain in force so long as operations on said well or for drilling or reworking of any additional well are prosecuted with no cessation of more than 60 consecutive days, and if they result in the production of oil or gas so long thereafter as oil or gas is produced from said land, or from land pooled therewith. If, after the expiration of the primary term of this lease and after oil or gas is produced from said land, or from land pooled therewith, the production thereof should cease from any cause, this lease shall not terminate if Lessee commences operations for drilling or reworking within 60 days after the cessation of such production, but shall remain in force and effect so long as such operations are prosecuted with no cessation of more than 60 consecutive days, and if they result in the production of oil or gas, so long thereafter as oil or gas is produced from said land, or from land pooled therewith. Any pooled unit designated by Lessee in accordance with the terms hereof, may be dissolved by Lessee by instrument filed for record in the appropriate records of the county in which the leased premises are situated at any time after the completion of a dry hole or the cessation of production on said unit. In the event a well or wells producing oil or gas in paying quantities should be brought in on adjacent land and within 660 feet of and draining the lease premises, or land pooled therewith, Lessee agrees to drill such offset well or wells as a reasonably prudent operator would drill under the same or similar circumstances. Lessee may at any time execute and deliver to Lessor or place of record a release or releases covering any portion or portions of the above described premises and thereby surrender this lease as to such portion or portions and be relieved of all obligations as to the acreage surrendered.

6. Lessee shall have the right at any time during or after the expiration of this lease to remove all property and fixtures placed by Lessee on said land, including the right to draw and remove all casing. When required by Lessor, Lessee will bury all pipe lines below ordinary plow depth, and no well shall be drilled within two hundred feet of any residence or barn now on said land without Lessor's consent.

7. The rights of either party hereunder may be assigned in whole or in part, and the provisions hereof shall extend to their heirs, successors and assigns but no change or division in ownership of the land or royalties, however accomplished, shall operate to enlarge the obligations or diminish the rights of Lessee; and no change or division in such ownership shall be binding on Lessee until thirty (30) days after Lessee shall have been furnished by registered U. S. mail at Lessee's principal place of business with a certified copy of recorded instrument or instruments evidencing same. In the event of assignment hereof in whole or in part liability for breach of any obligation hereunder shall rest exclusively upon the owner of this lease or of a portion thereof who commits such breach. If six or more parties become entitled to royalty hereunder, Lessee may withhold payment thereof unless and until furnished with a recordable instrument executed by all such parties designating an agent to receive payment for all.

8. The breach by Lessee of any obligation arising hereunder shall not work a forfeiture or termination of this lease nor cause a termination or revision of the estate created hereby nor be grounds for cancellation hereof in whole or in part. In the event Lessor considers that operations are not at any time being conducted in compliance with this lease, Lessor shall notify Lessee in writing of the facts relied upon as constituting a breach hereof, and Lessee, if in default, shall have sixty days after receipt of such notice in which to commence the compliance with the obligations imposed by virtue of this instrument. After the discovery of oil or gas in paying quantities on said premises, Lessee shall develop the acreage retained hereunder as a reasonably prudent operator but in discharging this obligation it shall in no event be required to drill more than one well per forty (40) acres of the area retained hereunder and capable of producing oil in paying quantities and one well per 640 acres plus an acreage tolerance not to exceed 10% of 640 acres of the area retained hereunder and capable of producing gas in paying quantities.

9. Lessor hereby ~~warrants and agrees to defend the title to said land and~~ agrees that Lessee at its option may discharge any tax, mortgage or other lien upon said land either in whole or in part, and in event Lessee does so, it shall be subrogated to such lien with the right to enforce same and apply royalties accruing hereunder toward satisfying same. ~~Without impairment of Lessee's right under the warranty~~ In event of failure of title, it is agreed that if Lessor owns an interest in the oil or gas on, in or under said land less than the entire fee simple estate, then the royalties to be paid Lessor shall be reduced proportionately. Should any one or more of the parties named as Lessors fail to execute this lease, it shall nevertheless be binding upon the party or parties executing the same.

10. Should Lessee be prevented from complying with any express or implied covenant of this lease, from conducting drilling or reworking operations thereon or from producing oil or gas therefrom by reason of scarcity of or inability to obtain or to use equipment or material, or by operation of force majeure, any Federal or state law or any order, rule or regulation of governmental authority, then while so prevented, Lessee's obligation to comply with such covenant shall be suspended, and Lessee shall not be liable in damages for failure to comply therewith; and this lease shall be extended while and so long as Lessee is prevented by any such cause from conducting drilling or reworking operations on or from producing oil or gas from the leased premises; and the time while Lessee is so prevented shall not be counted against Lessee, anything in this lease to the contrary notwithstanding.

IN WITNESS WHEREOF, this instrument is executed on the date first above written.

SUE-ANN ROSE EDWARDS

S.S./Tax I.D.#

Lessor

S.S./Tax I.D.#

Lessor

No. _____

Oil and Gas
Lease

FROM

TO

dated _____, 19____

to Acres _____

County, N. M.

term _____

This instrument was filed for record on the

_____ day of _____, 19____

at _____ o'clock _____ M., and duly

recorded in Book _____, Page _____

of the _____ records of this office.

County Clerk

by _____, Deputy

When recorded return to

My commission expires _____, 19____

Notary Public

19____ by _____

SUE-ANN ROSE EDWARDS, A

WOMAN.

The foregoing instrument was acknowledged before me this _____ day of _____

STATE OF _____
County of _____ ss.

INDIVIDUAL ACKNOWLEDGMENT

My Commission Expires: _____

Notary Public

of _____ on behalf of said corporation.

_____ a _____ corporation

by _____, President

The foregoing instrument was acknowledged before me this _____ day of _____, 19____

STATE OF NEW MEXICO
County of _____ ss.

CORPORATION ACKNOWLEDGMENT

My commission expires _____, 19____

Notary Public

19____ by _____

The foregoing instrument was acknowledged before me this _____ day of _____

STATE OF NEW MEXICO,
County of _____ ss.

INDIVIDUAL ACKNOWLEDGMENT

SENDER:

- Complete items 1 and/or 2 for additional services.
- Complete items 3, and 4a & b.
- Print your name and address on the reverse of this form so that we can return this card to you.
- Attach this form to the front of the mailpiece, or on the back if space does not permit.
- Write "Return Receipt Requested" on the mailpiece below the article number.
- The Return Receipt will show to whom the article was delivered and the date delivered.

I also wish to receive the following services (for an extra fee):

- ☐ Addressee's Address
- ☐ Restricted Delivery

Consult postmaster for fee.

3. Article Addressed to:

Sue-Ann Rose Edwards
8815 Mountain Path Circle
Austin, Texas 78759

4a. Article Number

Z 061 314 895

4b. Service Type

- ☐ Registered ☐ Insured
☒ Certified ☐ COD
☐ Express Mail ☐ Return Receipt for Merchandise

7. Date of Delivery

5. Signature (Addressee)

6. Signature (Agent)

8. Addressee's Address (Only if requested and fee is paid)

Rose-Cannon AOR Com. #1

PS Form 3811, December 1991

★U.S. GPO: 1993-352-714

DOMESTIC RETURN RECEIPT

Thank you for using Return Receipt Service.

Is your RETURN ADDRESS completed on the reverse side?

Z 061 314 895

Receipt for Certified Mail

No Insurance Coverage Provided
Do not use for International Mail
(See Reverse)

Sent to Sue-Ann Rose Edwards 8815 Mountain Path Circle Austin, Texas 78759	
P.O., State and ZIP Code	
Postage	\$
Certified Fee	
Special Delivery Fee	
Restricted Delivery Fee	
Return Receipt Showing to Whom & Date Delivered	
Return Receipt Showing to Whom, Date, and Addressee's Address	
TOTAL Postage & Fees	\$
Postmark or Date	

PS Form 3800, March 1993

Z 061 314 880

Receipt for Certified Mail

No Insurance Coverage Provided
Do not use for International Mail
(See Reverse)

Sent to Sue-Ann Rose Edwards 1615 Spyglass Drive #2 Austin, TX 78746	
P.O., State and ZIP Code	
Postage	\$
Certified Fee	
Special Delivery Fee	
Restricted Delivery Fee	
Return Receipt Showing to Whom & Date Delivered	
Return Receipt Showing to Whom, Date, and Addressee's Address	
TOTAL Postage & Fees	\$
Postmark or Date	

PS Form 3800, March 1993

Z 212 312 965

Receipt for Certified Mail

No Insurance Coverage Provided
Do not use for International Mail
(See Reverse)

Sent to Sue-Ann Rose Edwards 1615 Spyglass Dr #2 Austin, TX 78746	
P.O., State and ZIP Code	
Postage	\$
Certified Fee	
Special Delivery Fee	
Restricted Delivery Fee	
Return Receipt Showing to Whom & Date Delivered	
Return Receipt Showing to Whom, Date, and Addressee's Address	
TOTAL Postage & Fees	\$
Postmark or Date	

PS Form 3800, March 1993

Z 061 314 879

Receipt for Certified Mail

No Insurance Coverage Provided
Do not use for International Mail
(See Reverse)

Sent to Sanders Oil & Gas Co P.O. Box 797005 Dallas, TX 75379-7005	
P.O., State and ZIP Code	
Postage	\$
Certified Fee	
Special Delivery Fee	
Restricted Delivery Fee	
Return Receipt Showing to Whom & Date Delivered	
Return Receipt Showing to Whom, Date, and Addressee's Address	
TOTAL Postage & Fees	\$
Postmark or Date	

PS Form 3800, March 1993

Z 212 313 918

Receipt for Certified Mail

No Insurance Coverage Provided
Do not use for International Mail
(See Reverse)

Sent to Sue-Ann Rose Edwards 3712 Ben Garza Ln #4 Austin, TX 78749	
P.O., State and ZIP Code	
Postage	\$ 15.08
Certified Fee	
Special Delivery Fee	
Restricted Delivery Fee	
Return Receipt Showing to Whom & Date Delivered	
Return Receipt Showing to Whom, Date, and Addressee's Address	
TOTAL Postage & Fees	\$
Postmark or Date	

PS Form 3800, March 1993

A.A.P.L. FORM 610 - 1977
MODEL FORM OPERATING AGREEMENT

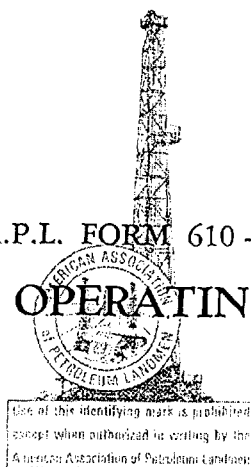

OPERATING AGREEMENT

DATED

December 5, 1994,

OPERATOR YATES PETROLEUM CORPORATION

CONTRACT AREA Township 10 South, Range 25 East
Section 17: SE/4

COUNTY OR ~~PARISH~~ OF Chaves STATE OF New Mexico

COPYRIGHT 1977 — ALL RIGHTS RESERVED
AMERICAN ASSOCIATION OF PETROLEUM LANDMEN
APPROVED FORM: A.A.P.L. NO. 610 - 1977 REVISED
MAY BE ORDERED DIRECTLY FROM THE PUBLISHER
KRAFTBILT PRODUCTS, BOX 800, TULSA 74101

YATES PETROLEUM CORP.
BEFORE EXAMINER CATANACH
NMOCD CASE NO. 11210
DATE: 03/02/95
EXHIBIT NO. 6

TABLE OF CONTENTS

<u>Article</u>	<u>Title</u>	<u>Page</u>
I.	DEFINITIONS	1
II.	EXHIBITS	1
III.	INTERESTS OF PARTIES	2
	A. OIL AND GAS INTERESTS	2
	B. INTEREST OF PARTIES IN COSTS AND PRODUCTION	2
IV.	TITLES	2
	A. TITLE EXAMINATION	2
	B. LOSS OF TITLE	2
	1. Failure of Title	2-3
	2. Loss by Non-Payment or Erroneous Payment of Amount Due	3
	3. Other Losses	3
V.	OPERATOR	3
	A. DESIGNATION AND RESPONSIBILITIES OF OPERATOR	3
	B. RESIGNATION OR REMOVAL OF OPERATOR AND SELECTION OF SUCCESSOR	4
	1. Resignation or Removal of Operator	4
	2. Selection of Successor Operator	4
	C. EMPLOYEES	4
	D. DRILLING CONTRACTS	4
VI.	DRILLING AND DEVELOPMENT	4
	A. INITIAL WELL	4
	B. SUBSEQUENT OPERATIONS	5
	1. Proposed Operations	5
	2. Operations by Less than All Parties	5-6
	C. RIGHT TO TAKE PRODUCTION IN KIND	6-7
	D. ACCESS TO CONTRACT AREA AND INFORMATION	7
	E. ABANDONMENT OF WELLS	7
	1. Abandonment of Dry Holes	7
	2. Abandonment of Wells that have Produced	7-8
VII.	EXPENDITURES AND LIABILITY OF PARTIES	8
	A. LIABILITY OF PARTIES	8
	B. LIENS AND PAYMENT DEFAULTS	8
	C. PAYMENTS AND ACCOUNTING	8
	D. LIMITATION OF EXPENDITURES	9
	1. Drill or Deepen	9
	2. Rework or Plug Back	9
	3. Other Operations	9
	E. ROYALTIES, OVERRIDING ROYALTIES AND OTHER PAYMENTS	9
	F. RENTALS, SHUT-IN WELL PAYMENTS AND MINIMUM ROYALTIES	9-10
	G. TAXES	10
	H. INSURANCE	10
VIII.	ACQUISITION, MAINTENANCE OR TRANSFER OF INTEREST	10
	A. SURRENDER OF LEASES	10-11
	B. RENEWAL OR EXTENSION OF LEASES	11
	C. ACREAGE OR CASH CONTRIBUTION	11
	D. SUBSEQUENTLY CREATED INTEREST	11-12
	E. MAINTENANCE OF UNIFORM INTEREST	12
	F. WAIVER OF RIGHT TO PARTITION	12
	G. PREFERENTIAL RIGHT TO PURCHASE	12
IX.	INTERNAL REVENUE CODE ELECTION	12-13
X.	CLAIMS AND LAWSUITS	13
XI.	FORCE MAJEURE	13
XII.	NOTICES	13
XIII.	TERM OF AGREEMENT	13-14
XIV.	COMPLIANCE WITH LAWS AND REGULATIONS	14
	A. LAWS, REGULATIONS AND ORDERS	14
	B. GOVERNING LAW	14
XV.	OTHER PROVISIONS	14
XVI.	MISCELLANEOUS	15



OPERATING AGREEMENT

THIS AGREEMENT, entered into by and between YATES PETROLEUM CORPORATION, a
New Mexico corporation, 105 S. 4th St., Artesia, N.M., hereinafter designated and
referred to as "Operator", and the signatory party or parties other than Operator, sometimes hereinafter
referred to individually herein as "Non-Operator", and collectively as "Non-Operators",

WITNESSETH:

WHEREAS, the parties to this agreement are owners of oil and gas leases and/or oil and gas in-
terests in the land identified in Exhibit "A", and the parties hereto have reached an agreement to explore
and develop these leases and/or oil and gas interests for the production of oil and gas to the extent and
as hereinafter provided:

NOW, THEREFORE, it is agreed as follows:

ARTICLE I.
DEFINITIONS

As used in this agreement, the following words and terms shall have the meanings here ascribed
to them:

A. The term "oil and gas" shall mean oil, gas, casinghead gas, gas condensate, and all other liquid
or gaseous hydrocarbons and other marketable substances produced therewith, unless an intent to
limit the inclusiveness of this term is specifically stated.

B. The terms "oil and gas lease", "lease" and "leasehold" shall mean the oil and gas leases cov-
ering tracts of land lying within the Contract Area which are owned by the parties to this agreement.

C. The term "oil and gas interests" shall mean unleased fee and mineral interests in tracts of
land lying within the Contract Area which are owned by parties to this agreement.

D. The term "Contract Area" shall mean all of the lands, oil and gas leasehold interests and oil
and gas interests intended to be developed and operated for oil and gas purposes under this agreement.
Such lands, oil and gas leasehold interests and oil and gas interests are described in Exhibit "A".

E. The term "drilling unit" shall mean the area fixed for the drilling of one well by order or rule
of any state or federal body having authority. If a drilling unit is not fixed by any such rule or order,
a drilling unit shall be the drilling unit as established by the pattern of drilling in the Contract Area
or as fixed by express agreement of the Drilling Parties.

F. The term "drillsite" shall mean the oil and gas lease or interest on which a proposed well is to
be located.

G. The terms "Drilling Party" and "Consenting Party" shall mean a party who agrees to join in
and pay its share of the cost of any operation conducted under the provisions of this agreement.

H. The terms "Non-Drilling Party" and "Non-Consenting Party" shall mean a party who elects
not to participate in a proposed operation.

Unless the context otherwise clearly indicates, words used in the singular include the plural, the
plural includes the singular, and the neuter gender includes the masculine and the feminine.

ARTICLE II.
EXHIBITS

The following exhibits, as indicated below and attached hereto, are incorporated in and made a
part hereof:

☒ A. Exhibit "A", shall include the following information:

- (1) Identification of lands subject to agreement,
- (2) Restrictions, if any, as to depths or formations,
- (3) Percentages or fractional interests of parties to this agreement,
- (4) Oil and gas leases and/or oil and gas interests subject to this agreement,
- (5) Addresses of parties for notice purposes.

☐ B. Exhibit "B", Form of Lease.

☒ C. Exhibit "C", Accounting Procedure.

☒ D. Exhibit "D", Insurance.

☒ E. Exhibit "E", Gas Balancing Agreement.

☒ F. Exhibit "F", Non-Discrimination and Certification of Non-Segregated Facilities.

If any provision of any exhibit, except Exhibit "E", is inconsistent with any provision contained
in the body of this agreement, the provisions in the body of this agreement shall prevail.

ARTICLE III.
INTERESTS OF PARTIES

A. Oil and Gas Interests:

If any party owns an unleased oil and gas interest in the Contract Area, that interest shall be treated for the purpose of this agreement and during the term hereof as if it were a leased interest under the form of oil and gas lease attached as Exhibit "B". As to such interest, the owner shall receive royalty on production as prescribed in the form of oil and gas lease attached hereto as Exhibit "B". Such party shall, however, be subject to all of the provisions of this agreement relating to lessees, to the extent that it owns the lessee interest.

B. Interest of Parties in Costs and Production:

Exhibit "A" lists all of the parties and their respective percentage or fractional interests under this agreement. Unless changed by other provisions, all costs and liabilities incurred in operations under this agreement shall be borne and paid, and all equipment and material acquired in operations on the Contract Area shall be owned by the parties as their interests are shown in Exhibit "A". All production of oil and gas from the Contract Area, subject to the payment of lessor's royalties ~~which will be borne by the Joint Account~~, shall also be owned by the parties in the same manner during the term hereof; provided, however, this shall not be deemed an assignment or cross-assignment of interests covered hereby.

ARTICLE IV.
TITLES

A. Title Examination:

Title examination shall be made on the drillsite of any proposed well prior to commencement of drilling operations or, if the Drilling Parties so request, title examination shall be made on the leases and/or oil and gas interests included, or planned to be included, in the drilling unit around such well. The opinion will include the ownership of the working interest, minerals, royalty, overriding royalty and production payments under the applicable leases. At the time a well is proposed, each party contributing leases and/or oil and gas interests to the drillsite, or to be included in such drilling unit, shall furnish to Operator all abstracts (including Federal Lease Status Reports), title opinions, title papers and curative material in its possession free of charge. All such information not in the possession of or made available to Operator by the parties, but necessary for the examination of title, shall be obtained by Operator. Operator shall cause title to be examined by attorneys on its staff or by outside attorneys. Copies of all title opinions shall be furnished to each party hereto. The cost incurred by Operator in this title program shall be borne as follows:

~~☐ Option No. 1: Costs incurred by Operator in procuring abstracts and title examination (including preliminary, supplemental, shut-in gas royalty opinions and division order title opinions) shall be a part of the administrative overhead as provided in Exhibit "C," and shall not be a direct charge, whether performed by Operator's staff attorneys or by outside attorneys.~~

☒ Option No. 2: Costs incurred by Operator in procuring abstracts and fees paid outside attorneys for title examination (including preliminary, supplemental, shut-in gas royalty opinions and division order title opinions) shall be borne by the Drilling Parties in the proportion that the interest of each Drilling Party bears to the total interest of all Drilling Parties as such interests appear in Exhibit "A". Operator shall make no charge for services rendered by its staff attorneys or other personnel in the performance of the above functions.

Each party shall be responsible for securing curative matter and pooling amendments or agreements required in connection with leases or oil and gas interests contributed by such party. The Operator shall be responsible for the preparation and recording of Pooling Designations or Declarations as well as the conduct of hearings before Governmental Agencies for the securing of spacing or pooling orders. This shall not prevent any party from appearing on its own behalf at any such hearing.

No well shall be drilled on the Contract Area until after (1) the title to the drillsite or drilling unit has been examined as above provided, and (2) the title has been approved by the examining attorney or title has been accepted by all of the parties who are to participate in the drilling of the well.

B. Loss of Title:

1. Failure of Title: Should any oil and gas interest or lease, or interest therein, be lost through failure of title, which loss results in a reduction of interest from that shown on Exhibit "A", this agreement, nevertheless, shall continue in force as to all remaining oil and gas leases and interests; and

(a) The party whose oil and gas lease or interest is affected by the title failure shall bear alone the entire loss and it shall not be entitled to recover from Operator or the other parties any development

or operating costs which it may have theretofore paid, but there shall be no monetary liability on its part to the other parties hereto for drilling, development, operating or other similar costs by reason of such title failure; and

(b) There shall be no retroactive adjustment of expenses incurred or revenues received from the operation of the interest which has been lost, but the interests of the parties shall be revised on an acreage basis, as of the time it is determined finally that title failure has occurred, so that the interest of the party whose lease or interest is affected by the title failure will thereafter be reduced in the Contract Area by the amount of the interest lost; and

(c) If the proportionate interest of the other parties hereto in any producing well theretofore drilled on the Contract Area is increased by reason of the title failure, the party whose title has failed shall receive the proceeds attributable to the increase in such interests (less costs and burdens attributable thereto) until it has been reimbursed for unrecovered costs paid by it in connection with such well; and

(d) Should any person not a party to this agreement, who is determined to be the owner of any interest in the title which has failed, pay in any manner any part of the cost of operation, development, or equipment, such amount shall be paid to the party or parties who bore the costs which are so refunded; and

(e) Any liability to account to a third party for prior production of oil and gas which arises by reason of title failure shall be borne by the party or parties in the same proportions in which they shared in such prior production; and

(f) No charge shall be made to the joint account for legal expenses, fees or salaries, in connection with the defense of the interest claimed by any party hereto, it being the intention of the parties hereto that each shall defend title to its interest and bear all expenses in connection therewith.

2. Loss by Non-Payment or Erroneous Payment of Amount Due: If, through mistake or oversight, any rental, shut-in well payment, minimum royalty or royalty payment, is not paid or is erroneously paid, and as a result a lease or interest therein terminates, there shall be no monetary liability against the party who failed to make such payment. Unless the party who failed to make the required payment secures a new lease covering the same interest within ninety (90) days from the discovery of the failure to make proper payment, which acquisition will not be subject to Article VIII.B., the interests of the parties shall be revised on an acreage basis, effective as of the date of termination of the lease involved, and the party who failed to make proper payment will no longer be credited with an interest in the Contract Area on account of ownership of the lease or interest which has terminated. In the event the party who failed to make the required payment shall not have been fully reimbursed, at the time of the loss, from the proceeds of the sale of oil and gas attributable to the lost interest, calculated on an acreage basis, for the development and operating costs theretofore paid on account of such interest, it shall be reimbursed for unrecovered actual costs theretofore paid by it (but not for its share of the cost of any dry hole previously drilled or wells previously abandoned) from so much of the following as is necessary to effect reimbursement:

(a) Proceeds of oil and gas, less operating expenses, theretofore accrued to the credit of the lost interest, on an acreage basis, up to the amount of unrecovered costs;

(b) Proceeds, less operating expenses, thereafter accrued attributable to the lost interest on an acreage basis, of that portion of oil and gas thereafter produced and marketed (excluding production from any wells thereafter drilled) which, in the absence of such lease termination, would be attributable to the lost interest on an acreage basis, up to the amount of unrecovered costs, the proceeds of said portion of the oil and gas to be contributed by the other parties in proportion to their respective interests; and

(c) Any monies, up to the amount of unrecovered costs, that may be paid by any party who is, or becomes, the owner of the interest lost, for the privilege of participating in the Contract Area or becoming a party to this agreement.

3. Other Losses: All losses incurred, other than those set forth in Articles IV.B.1. and IV.B.2. above, shall not be considered failure of title but shall be joint losses and shall be borne by all parties in proportion to their interests. There shall be no readjustment of interests in the remaining portion of the Contract Area.

ARTICLE V. OPERATOR

A. DESIGNATION AND RESPONSIBILITIES OF OPERATOR:

YATES PETROLEUM CORPORATION, 105 South 4th St., Artesia, N.M. 88210 shall be the Operator of the Contract Area, and shall conduct and direct and have full control of all operations on the Contract Area as permitted and required by, and within the limits of, this agreement. It shall conduct all such operations in a good and workmanlike manner, but it shall have no liability as Operator to the other parties for losses sustained or liabilities incurred, except such as may result from gross negligence or willful misconduct.

B. Resignation or Removal of Operator and Selection of Successor:

1. Resignation or Removal of Operator: Operator may resign at any time by giving written notice thereof to Non-Operators. If Operator terminates its legal existence, no longer owns an interest in the Contract Area, or is no longer capable of serving as Operator, it shall cease to be Operator without any action by Non-Operator, except the selection of a successor. Operator may be removed if it fails or refuses to carry out its duties hereunder, or becomes insolvent, bankrupt or is placed in receivership, by the affirmative vote of two (2) or more Non-Operators owning a majority interest based on ownership as shown on Exhibit "A", and not on the number of parties remaining after excluding the voting interest of Operator. Such resignation or removal shall not become effective until 7:00 o'clock A.M. on the first day of the calendar month following the expiration of ninety (90) days after the giving of notice of resignation by Operator or action by the Non-Operators to remove Operator, unless a successor Operator has been selected and assumes the duties of Operator at an earlier date. Operator, after effective date of resignation or removal, shall be bound by the terms hereof as a Non-Operator. A change of a corporate name or structure of Operator or transfer of Operator's interest to any single subsidiary, parent or successor corporation shall not be the basis for removal of Operator.

2. Selection of Successor Operator: Upon the resignation or removal of Operator, a successor Operator shall be selected by the Parties. The successor Operator shall be selected from the parties owning an interest in the Contract Area at the time such successor Operator is selected. If the Operator that is removed fails to vote or votes only to succeed itself, the successor Operator shall be selected by the affirmative vote of two (2) or more parties owning a majority interest based on ownership as shown on Exhibit "A", and not on the number of parties remaining after excluding the voting interest of the Operator that was removed.

C. Employees:

The number of employees used by Operator in conducting operations hereunder, their selection, and the hours of labor and the compensation for services performed, shall be determined by Operator, and all such employees shall be the employees of Operator.

D. Drilling Contracts:

All wells drilled on the Contract Area shall be drilled on a competitive contract basis at the usual rates prevailing in the area. If it so desires, Operator may employ its own tools and equipment in the drilling of wells, but its charges therefor shall not exceed the prevailing rates in the area and the rate of such charges shall be agreed upon by the parties in writing before drilling operations are commenced, and such work shall be performed by Operator under the same terms and conditions as are customary and usual in the area in contracts of independent contractors who are doing work of a similar nature.

**ARTICLE VI.
DRILLING AND DEVELOPMENT**

A. Initial Well:

On or before the _____ day of _____, 19____, Operator shall commence the drilling of a well for oil and gas at the following location:

and shall thereafter continue the drilling of the well with due diligence to

unless granite or other practically impenetrable substance or condition in the hole, which renders further drilling impractical, is encountered at a lesser depth, or unless all parties agree to complete or abandon the well at a lesser depth.

Operator shall make reasonable tests of all formations encountered during drilling which give indication of containing oil and gas in quantities sufficient to test, unless this agreement shall be limited in its application to a specific formation or formations, in which event Operator shall be required to test only the formation or formations to which this agreement may apply.

If, in Operator's judgment, the well will not produce oil or gas in paying quantities, and it wishes to plug and abandon the well as a dry hole, it shall first secure the consent of all parties, and shall plug and abandon same as provided in Article VI.E.1 hereof.

B. Subsequent Operations:

1. Proposed Operations: Should any party hereto desire to drill any well on the Contract Area other than the well provided for in Article VI.A., or to rework, deepen or plug back a dry hole drilled at the joint expense of all parties or a well jointly owned by all the parties and not then producing in paying quantities, the party desiring to drill, rework, deepen or plug back such a well shall give the other parties written notice of the proposed operation, specifying the work to be performed, the location, proposed depth, objective formation and the estimated cost of the operation. The parties receiving such a notice shall have thirty (30) days after receipt of the notice within which to notify the parties wishing to do the work whether they elect to participate in the cost of the proposed operation. If a drilling rig is on location, notice of proposal to rework, plug back or drill deeper may be given by telephone and the response period shall be limited to forty-eight (48) hours, exclusive of Saturday, Sunday or legal holidays. Failure of a party receiving such notice to reply within the period above fixed shall constitute an election by that party not to participate in the cost of the proposed operation. Any notice or response given by telephone shall be promptly confirmed in writing.

2. Operations by Less than All Parties: If any party receiving such notice as provided in Article VI.B.1. or VI.E.1. elects not to participate in the proposed operation, then, in order to be entitled to the benefits of this article, the party or parties giving the notice and such other parties as shall elect to participate in the operation shall, within sixty (60) days after the expiration of the notice period of thirty (30) days (or as promptly as possible after the expiration of the forty-eight (48) hour period where the drilling rig is on location, as the case may be) actually commence work on the proposed operation and complete it with due diligence. Operator shall perform all work for the account of the Consenting Parties; provided, however, if no drilling rig or other equipment is on location, and if Operator is a Non-Consenting Party, the Consenting Parties shall either: (a) request Operator to perform the work required by such proposed operation for the account of the Consenting Parties, or (b) designate one (1) of the Consenting Parties as Operator to perform such work. Consenting Parties, when conducting operations on the Contract Area pursuant to this Article VI.B.2., shall comply with all terms and conditions of this agreement.

If less than all parties approve any proposed operation, the proposing party, immediately after the expiration of the applicable notice period, shall advise the Consenting Parties of (a) the total interest of the parties approving such operation, and (b) its recommendation as to whether the Consenting Parties should proceed with the operation as proposed. Each Consenting Party, within forty-eight (48) hours (exclusive of Saturday, Sunday or legal holidays) after receipt of such notice, shall advise the proposing party of its desire to (a) limit participation to such party's interest as shown on Exhibit "A", or (b) carry its proportionate part of Non-Consenting Parties' interest. The proposing party, at its election, may withdraw such proposal if there is insufficient participation, and shall promptly notify all parties of such decision.

The entire cost and risk of conducting such operations shall be borne by the Consenting Parties in the proportions they have elected to bear same under the terms of the preceding paragraph. Consenting Parties shall keep the leasehold estates involved in such operations free and clear of all liens and encumbrances of every kind created by or arising from the operations of the Consenting Parties. If such an operation results in a dry hole, the Consenting Parties shall plug and abandon the well at their sole cost, risk and expense. If any well drilled, reworked, deepened or plugged back under the provisions of this Article results in a producer of oil and/or gas in paying quantities, the Consenting Parties shall complete and equip the well to produce at their sole cost and risk, and the well shall then be turned over to Operator and shall be operated by it at the expense and for the account of the Consenting Parties. Upon commencement of operations for the drilling, reworking, deepening or plugging back of any such well by Consenting Parties in accordance with the provisions of this Article, each Non-Consenting Party shall be deemed to have relinquished to Consenting Parties, and the Consenting Parties shall own and be entitled to receive, in proportion to their respective interests, all of such Non-Consenting Party's interest in the well and share of production therefrom until the proceeds of the sale of such share, calculated at the well, or market value thereof if such share is not sold (after deducting production taxes, crude oil excise taxes, royalty, overriding royalty and other interests existing on the effective date hereof, payable out of or measured by the production from such well accruing with respect to such interest until it reverts) shall equal the total of the following:

(a) 200 % of each such Non-Consenting Party's share of the cost of any newly acquired surface equipment beyond the wellhead connections (including, but not limited to, stock tanks, separators, treaters, pumping equipment and piping), plus 100 % of each such Non-Consenting Party's share of the cost of operation of the well commencing with first production and continuing until each such Non-Consenting Party's relinquished interest shall revert to it under other provisions of this Article, it being agreed that each Non-Consenting Party's share of such costs and equipment will be that interest which would have been chargeable to each Non-Consenting Party had it participated in the well from the beginning of the operation; and

(b) 500% of that portion of the costs and expenses of drilling reworking, deepening, or plugging back, testing and completing, after deducting any cash contributions received under Article VIII.C., and

1 500% of that portion of the cost of newly acquired equipment in the well (to and including the well-
2 head connections), which would have been chargeable to such Non-Consenting Party if it had partici-
3 pated therein.

4
5 Gas production attributable to any Non - Consenting Party's relinquished interest upon such Party's
6 election, shall be sold to its purchaser, if available, under the terms of its existing gas sales con-
7 tract. Such Non - Consenting Party shall direct its purchaser to remit the proceeds receivable from
8 such sale direct to the Consenting Parties until the amounts provided for in this Article are recov-
9 ered from the Non - Consenting Party's relinquished interest. If such Non - Consenting Party has not
10 contracted for sale of its gas at the time such gas is available for delivery, or has not made the elec-
11 tion as provided above, the Consenting Parties shall own and be entitled to receive and sell such Non-
12 Consenting Party's share of gas as hereinabove provided during the recoupment period.

13
14 During the period of time Consenting Parties are entitled to receive Non-Consenting Party's share
15 of production, or the proceeds therefrom, Consenting Parties shall be responsible for the payment of
16 all production, crude oil excise taxes, severance, gathering and other taxes, and all royalty, overriding royalty
17 and other burdens applicable to Non-Consenting Party's share of production.

18
19 In the case of any reworking, plugging back or deeper drilling operation, the Consenting Parties shall
20 be permitted to use, free of cost, all casing, tubing and other equipment in the well, but the ownership of
21 all such equipment shall remain unchanged; and upon abandonment of a well after such reworking,
22 plugging back or deeper drilling, the Consenting Parties shall account for all such equipment to the
23 owners thereof, with each party receiving its proportionate part in kind or in value, less cost of
24 salvage.

25
26 Within sixty (60) days after the completion of any operation under this Article, the party con-
27 ducting the operations for the Consenting Parties shall furnish each Non-Consenting Party with an in-
28 ventory of the equipment in and connected to the well, and an itemized statement of the cost of drilling,
29 deepening, plugging back, testing, completing, and equipping the well for production; or, at its option,
30 the operating party, in lieu of an itemized statement of such costs of operation, may submit a detailed
31 statement of monthly billings. Each month thereafter, during the time the Consenting Parties are being
32 reimbursed as provided above, the Party conducting the operations for the Consenting Parties shall furn-
33 ish the Non-Consenting Parties with an itemized statement of all costs and liabilities incurred in the
34 operation of the well, together with a statement of the quantity of oil and gas produced from it and the
35 amount of proceeds realized from the sale of the well's working interest production during the preceding
36 month. In determining the quantity of oil and gas produced during any month, Consenting Parties
37 shall use industry accepted methods such as, but not limited to, metering or periodic well tests. Any
38 amount realized from the sale or other disposition of equipment newly acquired in connection with any
39 such operation which would have been owned by a Non-Consenting Party had it participated therein
40 shall be credited against the total unreturned costs of the work done and of the equipment purchased,
41 in determining when the interest of such Non-Consenting Party shall revert to it as above provided;
42 and if there is a credit balance, it shall be paid to such Non-Consenting party.

43
44 If and when the Consenting Parties recover from a Non-Consenting Party's relinquished interest
45 the amounts provided for above, the relinquished interests of such Non-Consenting Party shall auto-
46 matically revert to it, and, from and after such reversion, such Non-Consenting Party shall own the same
47 interest in such well, the material and equipment in or pertaining thereto, and the production there-
48 from as such Non-Consenting Party would have been entitled to had it participated in the drilling,
49 reworking, deepening or plugging back of said well. Thereafter, such Non-Consenting Party shall be
50 charged with and shall pay its proportionate part of the further costs of the operation of said well in
51 accordance with the terms of this agreement and the Accounting Procedure, attached hereto.

52
53 Notwithstanding the provisions of this Article VI.B.2., it is agreed that without the mutual consent
54 of all parties, no wells shall be completed in or produced from a source of supply from which a well
55 located elsewhere on the Contract Area is producing, unless such well conforms to the then-existing
56 well spacing pattern for such source of supply.

57
58 The provisions of this Article shall have no application whatsoever to the drilling of the initial
59 well described in Article VI.A. except (a) when Option 2, Article VII.D.1., has been selected, or (b)
60 to the reworking, deepening and plugging back of such initial well, if such well is or thereafter shall
61 prove to be a dry hole or non-commercial well, after having been drilled to the depth specified in Article
62 VI.A.

63 64 **C. Right to Take Production in Kind:**

65 Each party electing to take in kind or separately dispose of its proportionate share of the production from the Contract Area
66 shall keep accurate records of the volume, selling price, royalty and taxes relative to its share of production. Non-Operators
67 shall, upon request, furnish Operator with true and complete copies of the records required to be kept hereunder whenever, under
68 the terms of this agreement or any agreement executed in connection herewith, it is necessary for Operator to obtain said information.
69 Any information furnished to Operator hereunder shall be used by Operator only to the extent necessary to carry out its duties
70 as Operator and shall otherwise be kept confidential.

Each party shall have the right to take in kind or separately dispose of its proportionate share of all oil and gas produced
from the Contract Area, exclusive of production which may be used in development and producing operations and in preparing and

1 treating oil for marketing purposes and production unavoidably lost. Any extra expenditure incurred in the taking in kind or separate
2 disposition by any party of its proportionate share of the production shall be borne by such party. Any party taking its share of
3 production in kind shall be required to pay for only its proportionate share of such part of Operator's surface facilities which it uses.

4 Each party shall execute such division orders and contracts as may be necessary for the sale of its
5 interest in production from the Contract Area, and, except as provided in Article VII.B., shall be entitled
6 to receive payment direct from the purchaser thereof for its share of all production.

7
8 In the event any party shall fail to make the arrangements necessary to take in kind or separately
9 dispose of its proportionate share of the oil and gas produced from the Contract Area, Operator shall have
10 the right, subject to the revocation at will by the party owning it, but not the obligation, to purchase such
11 oil and gas or sell it to others at any time and from time to time, for the account of the non-taking
12 party at the best price obtainable in the area for such production. Any such purchase or sale by Op-
13 erator shall be subject always to the right of the owner of the production to exercise at any time its
14 right to take in kind, or separately dispose of, its share of all oil and gas not previously delivered to a
15 purchaser. Any purchase or sale by Operator of any other party's share of oil and gas shall be only for
16 such reasonable periods of time as are consistent with the minimum needs of the industry under the
17 particular circumstances, but in no event for a period in excess of one (1) year. Notwithstanding the
18 foregoing, Operator shall not make a sale, including one into interstate commerce, of any other party's
19 share of gas production without first giving such other party thirty (30) days notice of such intended
20 sale.

21
22 In the event any party hereto is not at any time taking or marketing its share of gas production and Operator
23 is either (i) unwilling to purchase or sell or (ii) unable to obtain the prior written consent to purchase or sell such
24 party's share of gas production, or in the event any party has contracted to sell its share of gas produced from
25 the contract Area to a purchaser which does not at any time while this agreement is in effect take the full share
26 of gas attributable to the interest of such party, then in any such event the terms and conditions of the Gas
27 Balancing Agreement attached hereto as Exhibit "E" and incorporated herein shall automatically become
28 effective.

29 D. Access to Contract Area and Information:

30
31 Each party shall have access to the Contract Area at all reasonable times, at its sole risk to inspect
32 or observe operations, and shall have access at reasonable times to information pertaining to the de-
33 velopment or operation thereof, including Operator's books and records relating thereto. Operator, upon
34 request, shall furnish each of the other parties with copies of all forms or reports filed with govern-
35 mental agencies, daily drilling reports, well logs, tank tables, daily gauge and run tickets and reports
36 of stock on hand at the first of each month, and shall make available samples of any cores or cuttings
37 taken from any well drilled on the Contract Area. The cost of gathering and furnishing information to
38 Non-Operator, other than that specified above, shall be charged to the Non-Operator that requests the
39 information.

40 E. Abandonment of Wells:

41
42
43 1. Abandonment of Dry Holes: Except for any well drilled pursuant to Article VI.B.2., any well
44 which has been drilled under the terms of this agreement and is proposed to be completed as a dry hole
45 shall not be plugged and abandoned without the consent of all parties. Should Operator, after diligent
46 effort, be unable to contact any party, or should any party fail to reply within forty-eight (48) hours
47 (exclusive of Saturday, Sunday or legal holidays) after receipt of notice of the proposal to plug and
48 abandon such well, such party shall be deemed to have consented to the proposed abandonment. All
49 such wells shall be plugged and abandoned in accordance with applicable regulations and at the cost,
50 risk and expense of the parties who participated in the cost of drilling of such well. Any party who ob-
51 jects to the plugging and abandoning such well shall have the right to take over the well and conduct
52 further operations in search of oil and/or gas subject to the provisions of Article VI.B.

53
54 2. Abandonment of Wells that have Produced: Except for any well which has been drilled or re-
55 worked pursuant to Article VI.B.2. hereof for which the Consenting Parties have not been fully reim-
56 bursed as therein provided, any well which has been completed as a producer shall not be plugged and
57 abandoned without the consent of all parties. If all parties consent to such abandonment, the well shall
58 be plugged and abandoned in accordance with applicable regulations and at the cost, risk and expense
59 of all the parties hereto. If, within thirty (30) days after receipt of notice of the proposed abandonment
60 of such well, all parties do not agree to the abandonment of any well, those wishing to continue its op-
61 eration shall tender to each of the other parties its proportionate share of the value of the well's salvageable
62 material and equipment, determined in accordance with the provisions of Exhibit "C", less the estimated
63 cost of salvaging and the estimated cost of plugging and abandoning. Each abandoning party shall
64 assign to the non-abandoning parties, without warranty, express or implied, as to title or as to quantity,
65 quality, or fitness for use of the equipment and material, all of its interest in the well and related equip-
66 ment, together with its interest in the leasehold estate as to, but only as to, the interval or intervals of the
67 formation or formations then open to production. If the interest of the abandoning party is or includes
68 an oil and gas interest, such party shall execute and deliver to the non-abandoning party or parties an
69 oil and gas lease, limited to the interval or intervals of the formation or formations then open to produc-
70 tion, for a term of one year and so long thereafter as oil and/or gas is produced from the interval or inter-

vals of the formation or formations covered thereby, such lease to be on the form attached as Exhibit "B". The assignments or leases so limited shall encompass the "drilling unit" upon which the well is located. The payments by, and the assignments or leases to, the assignees shall be in a ratio based upon the relationship of their respective percentages of participation in the Contract Area to the aggregate of the percentages of participation in the Contract Area of all assignees. There shall be no readjustment of interest in the remaining portion of the Contract Area.

Thereafter, abandoning parties shall have no further responsibility, liability, or interest in the operation of or production from the well in the interval or intervals then open other than the royalties retained in any lease made under the terms of this Article. Upon request, Operator shall continue to operate the assigned well for the account of the non-abandoning parties at the rates and charges contemplated by this agreement, plus any additional cost and charges which may arise as the result of the separate ownership of the assigned well.

ARTICLE VII. EXPENDITURES AND LIABILITY OF PARTIES

A. Liability of Parties:

The liability of the parties shall be several, not joint or collective. Each party shall be responsible only for its obligations, and shall be liable only for its proportionate share of the costs of developing and operating the Contract Area. Accordingly, the liens granted among the parties in Article VII.B. are given to secure only the debts of each severally. It is not the intention of the parties to create, nor shall this agreement be construed as creating, a mining or other partnership or association, or to render the parties liable as partners. It is not the intention of the parties that this contract is made or intended for the benefit of any third person.

B. Liens and Payment Defaults:

Each Non-Operator grants to Operator a lien upon its oil and gas rights in the Contract Area, and a security interest in its share of oil and/or gas when extracted and its interest in all equipment, to secure payment of its share of expense, together with interest thereon at the rate provided in the Accounting Procedure attached hereto as Exhibit "C". To the extent that Operator has a security interest under the Uniform Commercial Code of the State, Operator shall be entitled to exercise the rights and remedies of a secured party under the Code. The bringing of a suit and the obtaining of judgment by Operator for the secured indebtedness shall not be deemed an election of remedies or otherwise affect the lien rights or security interest as security for the payment thereof. In addition, upon default by any Non-Operator in the payment of its share of expense, Operator shall have the right, without prejudice to other rights or remedies, to collect from the purchaser the proceeds from the sale of such Non-Operator's share of oil and/or gas until the amount owed by such Non-Operator/plus interest has been paid. Each purchaser shall be entitled to rely upon Operator's written statement concerning the amount of any default. Operator grants a like lien and security interest to the Non-Operators to secure payment of Operator's proportionate share of expense.

If any party fails or is unable to pay its share of expense within sixty (60) days after rendition of a statement therefor by Operator, the non-defaulting parties, including Operator, shall, upon request by Operator, pay the unpaid amount in the proportion that the interest of each such party bears to the interest of all such parties. Each party so paying its share of the unpaid amount shall, to obtain reimbursement thereof, be subrogated to the security rights described in the foregoing paragraph.

C. Payments and Accounting:

Except as herein otherwise specifically provided, Operator shall promptly pay and discharge expenses incurred in the development and operation of the Contract Area pursuant to this agreement and shall charge each of the parties hereto with their respective proportionate shares upon the expense basis provided in the Accounting Procedure attached hereto as Exhibit "C". Operator shall keep an accurate record of the joint account hereunder, showing expenses incurred and charges and credits made and received.

Operator, at its election, shall have the right from time to time to demand and receive from the other parties payment in advance of their respective shares of the estimated amount of the expense to be incurred in operations hereunder during the next succeeding month, which right may be exercised only by submission to each such party of an itemized statement of such estimated expense, together with an invoice for its share thereof. Each such statement and invoice for the payment in advance of estimated expense shall be submitted on or before the 20th day of the next preceding month. Each party shall pay to Operator its proportionate share of such estimate within fifteen (15) days after such estimate and invoice is received. If any party fails to pay its share of said estimate within said time, the amount due shall bear interest as provided in Exhibit "C" until paid. Proper adjustment shall be made monthly between advances and actual expense to the end that each party shall bear and pay its proportionate share of actual expenses incurred, and no more.

D. Limitation of Expenditures:

1. Drill or Deepen: Without the consent of all parties, no well shall be drilled or deepened, except any well drilled or deepened pursuant to the provisions of Article VI.B.2. of this Agreement, it being understood that the consent to the drilling or deepening shall include:

☐ Option No. 1: All necessary expenditures for the drilling or deepening, testing, completing and equipping of the well, including necessary tankage and/or surface facilities.

☒ Option No. 2: All necessary expenditures for the drilling or deepening and testing of the well. When such well has reached its authorized depth, and all tests have been completed, Operator shall give immediate notice to the Non-Operators who have the right to participate in the completion costs. The parties receiving such notice shall have forty-eight (48) hours (exclusive of Saturday, Sunday and legal holidays) in which to elect to participate in the setting of casing and the completion attempt. Such election, when made, shall include consent to all necessary expenditures for the completing and equipping of such well, including necessary tankage and/or surface facilities. Failure of any party receiving such notice to reply within the period above fixed shall constitute an election by that party not to participate in the cost of the completion attempt. If one or more, but less than all of the parties, elect to set pipe and to attempt a completion, the provisions of Article VI.B.2. hereof (the phrase "reworking, deepening or plugging back" as contained in Article VI.B.2. shall be deemed to include "completing") shall apply to the operations thereafter conducted by less than all parties.

2. Rework or Plug Back: Without the consent of all parties, no well shall be reworked or plugged back except a well reworked or plugged back pursuant to the provisions of Article VI.B.2. of this agreement, it being understood that the consent to the reworking or plugging back of a well shall include consent to all necessary expenditures in conducting such operations and completing and equipping of said well, including necessary tankage and/or surface facilities.

3. Other Operations: Operator shall not undertake any single project reasonably estimated to require an expenditure in excess of TWENTY FIVE THOUSAND----- Dollars (\$ 25,000.00) except in connection with a well, the drilling, reworking, deepening, completing, recompleting, or plugging back of which has been previously authorized by or pursuant to this agreement; provided, however, that, in case of explosion, fire, flood or other sudden emergency, whether of the same or different nature, Operator may take such steps and incur such expenses as in its opinion are required to deal with the emergency to safeguard life and property but Operator, as promptly as possible, shall report the emergency to the other parties. If Operator prepares "Authority for Expenditures" for its own use, Operator, upon request, shall furnish copies of its "Authority for Expenditures" for any single project costing in excess of FIFTEEN THOUSAND----- Dollars (\$ 15,000.00).

E. Royalties, Overriding Royalties and Other Payments:

Each party shall pay or deliver, or cause to be paid or delivered, all royalties to the extent of 1/8 of 8/8ths due on its share of production and shall hold the other parties free from any liability therefor. If the interest of any party in any oil and gas lease covered by this agreement is subject to any royalty, overriding royalty, production payment, or other charge over and above the aforesaid royalty, such party shall assume and alone bear all such obligations and shall account for or cause to be accounted for, such interest to the owners thereof.

No party shall ever be responsible, on any price basis higher than the price received by such party, to any other party's lessor or royalty owner; and if any such other party's lessor or royalty owner should demand and receive settlements on a higher price basis, the party contributing such lease shall bear the royalty burden insofar as such higher price is concerned.

It is recognized by the parties hereto that in addition to each party's share of working interest production as shown in Exhibit "A", such party shall have the right, subject to existing contracts, to market the royalty gas attributable to each lease which it contributes to the Contract Area and to receive payments due for such royalty gas produced from or allocated to such lease or leases. It is agreed that, regardless of whether each party markets or contracts for its share of gas, including the royalty gas under the leases which it contributed to the Contract Area, such party agrees to pay or cause to be paid to the royalty owners under its lease or leases the proceeds attributable to their respective royalty interest and to hold all other parties hereto harmless for its failure to do so.

F. Rentals, Shut-in Well Payments and Minimum Royalties:

Rentals, shut-in well payments and minimum royalties which may be required under the terms of any lease shall be paid by the party or parties who subjected such lease to this agreement at its or their expense. In the event two or more parties own and have contributed interests in the same lease to this agreement, such parties may designate one of such parties to make said payments for and on behalf of all such parties. Any party may request, and shall be entitled to receive, proper evidence of all such payments. In the event of failure to make proper payment of any rental, shut-in well payment or minimum royalty through mistake or oversight where such payment is required to continue the lease in force, any loss which results from such non-payment shall be borne in accordance with the provisions of Article IV.B.2.

Operator shall notify Non-Operator of the anticipated completion of a shut-in gas well, or the shutting in or return to production of a producing gas well, at least five (5) days (excluding Saturday, Sunday and holidays), or at the earliest opportunity permitted by circumstances, prior to taking such action, but assumes no liability for failure to do so. In the event of failure by Operator to so notify Non-Operator, the loss of any lease contributed hereto by Non-Operator for failure to make timely payments

1 of any shut-in well payment shall be borne jointly by the parties hereto under the provisions of Article
2 IV.B.3.

3
4 **G. Taxes:**

5
6 Beginning with the first calendar year after the effective date hereof, Operator shall render for ad
7 valorem taxation all property subject to this agreement which by law should be rendered for such
8 taxes, and it shall pay all such taxes assessed thereon before they become delinquent. Prior to the ren-
9 dition date, each Non-Operator shall furnish Operator information as to burdens (to include, but not be
10 limited to, royalties, overriding royalties and production payments) on leases and oil and gas interests con-
11 tributed by such Non-Operator. If the assessed valuation of any leasehold estate is reduced by reason of its
12 being subject to outstanding excess royalties, overriding royalties or production payments, the reduction in
13 ad valorem taxes resulting therefrom shall inure to the benefit of the owner or owners of such leasehold
14 estate, and Operator shall adjust the charge to such owner or owners so as to reflect the benefit of such
15 reduction. Operator shall bill other parties for their proportionate share of all tax payments in the man-
16 ner provided in Exhibit "C".

17
18 If Operator considers any tax assessment improper, Operator may, at its discretion, protest within
19 the time and manner prescribed by law, and prosecute the protest to a final determination, unless all
20 parties agree to abandon the protest prior to final determination. During the pendency of administrative
21 or judicial proceedings, Operator may elect to pay, under protest, all such taxes and any interest and
22 penalty. When any such protested assessment shall have been finally determined, Operator shall pay
23 the tax for the joint account, together with any interest and penalty accrued, and the total cost shall then
24 be assessed against the parties, and be paid by them, as provided in Exhibit "C".

25
26 Each party shall pay or cause to be paid all production, severance, gathering and other taxes im-
27 posed upon or with respect to the production or handling of such party's share of oil and/or gas pro-
28 duced under the terms of this agreement.

29
30 **H. Insurance:**

31
32 At all times while operations are conducted hereunder, Operator shall comply with the Workmen's
33 Compensation Law of the State where the operations are being conducted; provided, however, that Op-
34 erator may be a self-insurer for liability under said compensation laws in which event the only charge
35 that shall be made to the joint account shall be an amount equivalent to the premium which would have
36 been paid had such insurance been obtained. Operator shall also carry or provide insurance for the
37 benefit of the joint account of the parties as outlined in Exhibit "D", attached to and made a part hereof.
38 Operator shall require all contractors engaged in work on or for the Contract Area to comply with the
39 Workmen's Compensation Law of the State where the operations are being conducted and to maintain
40 such other insurance as Operator may require.

41
42 In the event Automobile Public Liability Insurance is specified in said Exhibit "D", or subsequently
43 receives the approval of the parties, no direct charge shall be made by Operator for premiums paid for
44 such insurance for Operator's fully owned automotive equipment.

45
46 **ARTICLE VIII.**
47 **ACQUISITION, MAINTENANCE OR TRANSFER OF INTEREST**

48
49 **A. Surrender of Leases:**

50
51 The leases covered by this agreement, insofar as they embrace acreage in the Contract Area, shall
52 not be surrendered in whole or in part unless all parties consent thereto.

53
54 However, should any party desire to surrender its interest in any lease or in any portion thereof, and
55 other parties do not agree or consent thereto, the party desiring to surrender shall assign, without express
56 or implied warranty of title, all of its interest in such lease, or portion thereof, and any well, material and
57 equipment which may be located thereon and any rights in production thereafter secured, to the parties
58 not desiring to surrender it. If the interest of the assigning party includes an oil and gas interest, the as-
59 signing party shall execute and deliver to the party or parties not desiring to surrender an oil and gas
60 lease covering such oil and gas interest for a term of one year and so long thereafter as oil and/or gas
61 is produced from the land covered thereby, such lease to be on the form attached hereto as Exhibit "B".
62 Upon such assignment, the assigning party shall be relieved from all obligations thereafter accruing,
63 but not theretofore accrued, with respect to the acreage assigned and the operation of any well thereon,
64 and the assigning party shall have no further interest in the lease assigned and its equipment and pro-
65 duction other than the royalties retained in any lease made under the terms of this Article. The parties
66 assignee shall pay to the party assignor the reasonable salvage value of the latter's interest in any wells
67 and equipment on the assigned acreage. The value of all material shall be determined in accordance
68 with the provisions of Exhibit "C", less the estimated cost of salvaging and the estimated cost of plug-
69 ging and abandoning. If the assignment is in favor of more than one party, the assigned interest shall
70

be shared by the parties assignee in the proportions that the interest of each bears to the interest of all parties assignee.

Any assignment or surrender made under this provision shall not reduce or change the assignor's or surrendering parties' interest, as it was immediately before the assignment, in the balance of the Contract Area; and the acreage assigned or surrendered, and subsequent operations thereon, shall not thereafter be subject to the terms and provisions of this agreement.

B. Renewal or Extension of Leases:

If any party secures a renewal of any oil and gas lease subject to this Agreement, all other parties shall be notified promptly, and shall have the right for a period of thirty (30) days following receipt of such notice in which to elect to participate in the ownership of the renewal lease, insofar as such lease affects lands within the Contract Area, by paying to the party who acquired it their several proper proportionate shares of the acquisition cost allocated to that part of such lease within the Contract Area, which shall be in proportion to the interests held at that time by the parties in the Contract Area.

If some, but less than all, of the parties elect to participate in the purchase of a renewal lease, it shall be owned by the parties who elect to participate therein, in a ratio based upon the relationship of their respective percentage of participation in the Contract Area to the aggregate of the percentages of participation in the Contract Area of all parties participating in the purchase of such renewal lease. Any renewal lease in which less than all parties elect to participate shall not be subject to this agreement.

without warranty

Each party who participates in the purchase of a renewal lease shall be given an assignment/of its proportionate interest therein by the acquiring party.

The provisions of this Article shall apply to renewal leases whether they are for the entire interest covered by the expiring lease or cover only a portion of its area or an interest therein. Any renewal lease taken before the expiration of its predecessor lease, or taken or contracted for within six (6) months after the expiration of the existing lease shall be subject to this provision; but any lease taken or contracted for more than six (6) months after the expiration of an existing lease shall not be deemed a renewal lease and shall not be subject to the provisions of this agreement.

The provisions in this Article shall apply also and in like manner to extensions of oil and gas leases. The provisions of this Article VIII-B shall only apply to leases, or portions of leases, located within the Unit Area.

C. Acreage or Cash Contributions:

While this agreement is in force, if any party contracts for a contribution of cash toward the drilling of a well or any other operation on the Contract Area, such contribution shall be paid to the party who conducted the drilling or other operation and shall be applied by it against the cost of such drilling or other operation. If the contribution be in the form of acreage, the party to whom the contribution is made shall promptly tender an assignment of the acreage, without warranty of title, to the Drilling Parties in the proportions said Drilling Parties shared the cost of drilling the well. If all parties hereto are Drilling Parties and accept such tender, such acreage shall become a part of the Contract Area and be governed by the provisions of this agreement. If less than all parties hereto are Drilling Parties and accept such tender, such acreage shall not become a part of the Contract Area. Each party shall promptly notify all other parties of all acreage or money contributions it may obtain in support of any well or any other operation on the Contract Area.

If any party contracts for any consideration relating to disposition of such party's share of substances produced hereunder, such consideration shall not be deemed a contribution as contemplated in this Article VIII.C. This paragraph shall not be applicable to the contribution of acreage by the Contributing Parties toward the Initial, Substitute, or Option Test Well.

D. Subsequently Created Interest:

Notwithstanding the provisions of Article VIII.E. and VIII.G., if any party hereto shall, subsequent to execution of this agreement, create an overriding royalty, production payment, or net proceeds interest, which such interests are hereinafter referred to as "subsequently created interest", such subsequently created interest shall be specifically made subject to all of the terms and provisions of this agreement, as follows:

1. If non-consent operations are conducted pursuant to any provision of this agreement, and the party conducting such operations becomes entitled to receive the production attributable to the interest out of which the subsequently created interest is derived, such party shall receive same free and clear of such subsequently created interest. The party creating same shall bear and pay all such subsequently created interests and shall indemnify and hold the other parties hereto free and harmless from any and all liability resulting therefrom.

2. If the owner of the interest from which the subsequently created interest is derived (1) fails to pay, when due, its share of expenses chargeable hereunder, or (2) elects to abandon a well under provisions of Article VI.E. hereof, or (3) elects to surrender a lease under provisions of Article VIII.A. hereof, the subsequently created interest shall be chargeable with the pro rata portion of all expenses hereunder in the same manner as if such interest were a working interest. For purposes of collecting such chargeable expenses, the party or parties who receive assignments as a result of (2) or (3) above shall have the right to enforce all provisions of Article VII.B. hereof against such subsequently created interest.

E. Maintenance of Uniform Interest:

For the purpose of maintaining uniformity of ownership in the oil and gas leasehold interests covered by this agreement, and notwithstanding any other provisions to the contrary, no party shall sell, encumber, transfer or make other disposition of its interest in the leases embraced within the Contract Area and in wells, equipment and production unless such disposition covers either:

1. the entire interest of the party in all leases and equipment and production; or
2. an equal undivided interest in all leases and equipment and production in the Contract Area.

Every such sale, encumbrance, transfer or other disposition made by any party shall be made expressly subject to this agreement, and shall be made without prejudice to the right of the other parties.

If, at any time the interest of any party is divided among and owned by four or more co-owners, Operator, at its discretion, may require such co-owners to appoint a single trustee or agent with full authority to receive notices, approve expenditures, receive billings for and approve and pay such party's share of the joint expenses, and to deal generally with, and with power to bind, the co-owners of such party's interests within the scope of the operations embraced in this agreement; however, all such co-owners shall have the right to enter into and execute all contracts or agreements for the disposition of their respective shares of the oil and gas produced from the Contract Area and they shall have the right to receive, separately, payment of the sale proceeds hereof.

F. Waiver of Right to Partition:

If permitted by the laws of the state or states in which the property covered hereby is located, each party hereto owning an undivided interest in the Contract Area waives any and all rights it may have to partition and have set aside to it in severalty its undivided interest therein.

~~**G. Preferential Right to Purchase:**~~

~~Should any party desire to sell all or any part of its interests under this agreement, or its rights and interests in the Contract Area, it shall promptly give written notice to the other parties, with full information concerning its proposed sale, which shall include the name and address of the prospective purchaser (who must be ready, willing and able to purchase), the purchase price, and all other terms of the offer. The other parties shall then have an optional prior right, for a period of ten (10) days after receipt of the notice, to purchase on the same terms and conditions the interest which the other party proposes to sell; and, if this optional right is exercised, the purchasing parties shall share the purchased interest in the proportions that the interest of each bears to the total interest of all purchasing parties. However, there shall be no preferential right to purchase in those cases where any party wishes to mortgage its interests, or to dispose of its interests by merger, reorganization, consolidation, or sale of all or substantially all of its assets to a subsidiary or parent company or to a subsidiary of a parent company, or to any company in which any one party owns a majority of the stock.~~

**ARTICLE IX.
INTERNAL REVENUE CODE ELECTION**

This agreement is not intended to create, and shall not be construed to create, a relationship of partnership or an association for profit between or among the parties hereto. Notwithstanding any provisions herein that the rights and liabilities hereunder are several and not joint or collective, or that this agreement and operations hereunder shall not constitute a partnership, if, for Federal income tax purposes, this agreement and the operations hereunder are regarded as a partnership, each party hereby affected elects to be excluded from the application of all of the provisions of Subchapter "K", Chapter 1, Subtitle "A", of the Internal Revenue Code of 1954, as permitted and authorized by Section 761 of the Code and the regulations promulgated thereunder. Operator is authorized and directed to execute on behalf of each party hereby affected such evidence of this election as may be required by the Secretary of the Treasury of the United States or the Federal Internal Revenue Service, including specifically, but not by way of limitation, all of the returns, statements, and the data required by Federal Regulations 1.761. Should there be any requirement that each party hereby affected give further evidence of this election, each such party shall execute such documents and furnish such other evidence as may be required by the Federal Internal Revenue Service or as may be necessary to evidence this election. No

such party shall give any notices or take any other action inconsistent with the election made hereby. If any present or future income tax laws of the state or states in which the Contract Area is located or any future income tax laws of the United States contain provisions similar to those in Subchapter "K", Chapter 1, Subtitle "A", of the Internal Revenue Code of 1954, under which an election similar to that provided by Section 761 of the Code is permitted, each party hereby affected shall make such election as may be permitted or required by such laws. In making the foregoing election, each such party states that the income derived by such party from Operations hereunder can be adequately determined without the computation of partnership taxable income.

ARTICLE X. CLAIMS AND LAWSUITS

Operator may settle any single damage claim or suit arising from operations hereunder if the expenditure does not exceed FIFTEEN THOUSAND----- Dollars (\$ 15,000.00) and if the payment is in complete settlement of such claim or suit. If the amount required for settlement exceeds the above amount, the parties hereto shall assume and take over the further handling of the claim or suit, unless such authority is delegated to Operator. All costs and expense of handling, settling, or otherwise discharging such claim or suit shall be at the joint expense of the parties. If a claim is made against any party or if any party is sued on account of any matter arising from operations hereunder over which such individual has no control because of the rights given Operator by this agreement, the party shall immediately notify Operator, and the claim or suit shall be treated as any other claim or suit involving operations hereunder.

ARTICLE XI. FORCE MAJEURE

If any party is rendered unable, wholly or in part, by force majeure to carry out its obligations under this agreement, other than the obligation to make money payments, that party shall give to all other parties prompt written notice of the force majeure with reasonably full particulars concerning it; thereupon, the obligations of the party giving the notice, so far as they are affected by the force majeure, shall be suspended during, but no longer than, the continuance of the force majeure. The affected party shall use all reasonable diligence to remove the force majeure situation as quickly as practicable.

The requirement that any force majeure shall be remedied with all reasonable dispatch shall not require the settlement of strikes, lockouts, or other labor difficulty by the party involved, contrary to its wishes; how all such difficulties shall be handled shall be entirely within the discretion of the party concerned.

The term "force majeure", as here employed, shall mean an act of God, strike, lockout, or other industrial disturbance, act of the public enemy, war, blockade, public riot, lightning, fire, storm, flood, explosion, governmental action, governmental delay, restraint or inaction, unavailability of equipment, and any other cause, whether of the kind specifically enumerated above or otherwise, which is not reasonably within the control of the party claiming suspension.

ARTICLE XII. NOTICES

All notices authorized or required between the parties, and required by any of the provisions of this agreement, unless otherwise specifically provided, shall be given in writing by United States mail or Western Union telegram, postage or charges prepaid, or by teletype, and addressed to the party to whom the notice is given at the addresses listed on Exhibit "A". The originating notice given under any provision hereof shall be deemed given only when received by the party to whom such notice is directed, and the time for such party to give any notice in response thereto shall run from the date the originating notice is received. The second or any responsive notice shall be deemed given when deposited in the United States mail or with the Western Union Telegraph Company, with postage or charges prepaid, or when sent by teletype. Each party shall have the right to change its address at any time, and from time to time, by giving written notice hereof to all other parties.

ARTICLE XIII. TERM OF AGREEMENT

This agreement shall remain in full force and effect as to the oil and gas leases and/or oil and gas interests subjected hereto for the period of time selected below; provided, however, no party hereto shall ever be construed as having any right, title or interest in or to any lease, or oil and gas interest contributed by any other party beyond the term of this agreement.

☐ ~~Option No. 1: So long as any of the oil and gas leases subject to this agreement remain or are continued in force as to any part of the Contract Area, whether by production, extension, renewal or otherwise, and/or as long as oil and/or gas production continues from any lease or oil and gas interest.~~

~~XX~~ Option No. 2: In the event the well described in Article VI.A., or any subsequent well drilled under any provision of this agreement, results in production of oil and/or gas in paying quantities, this agreement shall continue in force so long as any such well or wells produce, or are capable of production, and for an additional period of 180 days from cessation of all production; provided, however, if, prior to the expiration of such additional period, one or more of the parties hereto are engaged in drilling or reworking a well or wells hereunder, this agreement shall continue in force until such operations have been completed and if production results therefrom, this agreement shall continue in force as provided herein. In the event the well described in Article VI.A., or any subsequent well drilled hereunder, results in a dry hole, and no other well is producing, or capable of producing oil and/or gas from the Contract Area, this agreement shall terminate unless drilling or reworking operations are commenced within 120 days from the date of abandonment of said well.

It is agreed, however, that the termination of this agreement shall not relieve any party hereto from any liability which has accrued or attached prior to the date of such termination.

ARTICLE XIV. COMPLIANCE WITH LAWS AND REGULATIONS

A. Laws, Regulations and Orders:

This agreement shall be subject to the conservation laws of the state in which the committed acreage is located, to the valid rules, regulations, and orders of any duly constituted regulatory body of said state; and to all other applicable federal, state, and local laws, ordinances, rules, regulations, and orders.

B. Governing Law:

The essential validity of this agreement and all matters pertaining thereto, including, but not limited to, matters of performance, non-performance, breach, remedies, procedures, rights, duties and interpretation or construction, shall be governed and determined by the law of the state in which the Contract Area is located. If the Contract Area is in two or more states, the law of the state where most of the land in the Contract Area is located shall govern.

ARTICLE XV. OTHER PROVISIONS

A. Not included.

B. Not included.

C. Not included.

D. Notwithstanding any other provisions herein, if during the term of this agreement, a well is required to be drilled, deepened, reworked, plugged back, sidetracked, or recompleted, or any other operation that may be required in order to (1) continue a lease or leases in force and effect, or (2) maintain a unitized area or any portion thereof in force and effect, or (3) earn or preserve an interest in and to oil and/or gas and other minerals which may be owned by a third party or which, failing in such operation, may revert to a third party, or, (4) comply with an order issued by a regulatory body having jurisdiction in the premises, failing in which certain rights would terminate, the following shall apply. Should less than all of the parties hereto elect to participate and pay their proportionate part of the costs to be incurred in such operation, those parties desiring to participate shall have the right to do so at their sole cost, risk, and expense. Promptly following the conclusion of such operation, each of those parties not participating agree to execute and deliver an appropriate assignment to the total interest of each non-participating party in and to the lease, leases, or rights which would have terminated or which otherwise may have been preserved by virtue of such operation, and in and to the lease, leases or rights within the balance of the drilling unit upon which the well was drilled, excepting, however, wells theretofore completed and capable of producing in paying quantities. Such assignment shall be delivered to the participating parties in the proportion that they bore the expense attributable to the non-participating parties' interest.

E. No production, whether oil or gas, may be sold from the lease acreage, or lands pooled therewith, to any party's subsidiaries, affiliates, or associates, without each party's prior written consent. All production sold from the lease acreage, or lands pooled therewith, will be an arm's length trade with a third party purchaser. It is expressly agreed if prior written consent is given to a party selling to themselves, its subsidiaries, affiliates, or associates, the other parties to this agreement will have the option to also sell to said purchaser, at the same or better price. In the event any party hereto, makes an arm's length trade with a third party purchaser, the remaining parties will have the option to also sell at the same or higher price.

F. Prior to commencement of any well drilled under this agreement, each non-operator must tender to the operator its share of dry hole cost, as set out on Authority for Expenditure proposing such well.

Attached to and made a part of Operating Agreement dated December 5, 1994 between Yates Petroleum Corporation "Operator" and Sanders Oil & Gas Company, et al, "Non-Operators".

A.A.P.L. FORM 610 - MODEL FORM OPERATING AGREEMENT - 1977

1
2
3
4
5
6
7
8
9
10
11
12
13
14
15
16
17
18
19
20
21
22
23
24
25
26
27
28
29
30
31
32
33
34
35
36
37
38
39
40
41
42
43
44
45
46
47
48
49
50
51
52
53
54
55
56
57
58
59
60
61
62
63
64
65
66
67
68
69
70

ARTICLE XVI.
MISCELLANEOUS

This agreement shall be binding upon and shall inure to the benefit of the parties hereto and to their respective heirs, devisees, legal representatives, successors and assigns.

This instrument may be executed in any number of counterparts, each of which shall be considered an original for all purposes.

IN WITNESS WHEREOF, this agreement shall be effective as of 6th day of December, 1994.

OPERATOR

YATES PETROLEUM CORPORATION

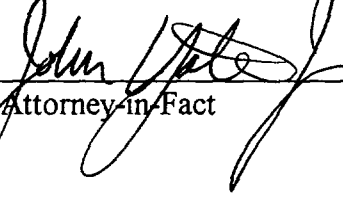
By: 
Attorney-in-Fact

NON-OPERATORS

YATES DRILLING COMPANY

By: _____
Attorney-in-Fact

ABO PETROLEUM CORPORATION

By: _____
Attorney-in-Fact

MYCO INDUSTRIES, INC.

By: _____
Attorney-in-Fact

Attest: _____

SANDERS OIL & GAS COMPANY

By: _____

Attest: _____

ENERAG, INC.

By: _____

PAM ROSE RIDGE

SUE ANN ROSE EDWARDS

JULIA ROSE HEALD

COUNTY OF EDDY

)

Notary Public

Notary Public

)

COUNTY OF

)

Notary Public

My Commission Expires:

ATTACHED TO AND MADE A PART OF OPERATING AGREEMENT
DATED DECEMBER 5, 1994, BETWEEN YATES PETROLEUM
CORPORATION "OPERATOR" AND SANDERS OIL & GAS COMPANY, ET
AL, "NON-OPERATORS", COVERING LANDS LOCATED IN CHAVES
COUNTY, NEW MEXICO.

EXHIBIT "A"

I. Lands Subject:

1. Lands Subject to Agreement:
Township 10 South, Range 25 East
Section 17: E/2SE/4
Rights below 2000 feet subsurface to 4245 feet below surface.

Township 10 South, Range 25 East
Section 17: W/2SE/4
Chaves County, New Mexico
Rights from the surface to 4245 feet below the surface.

II. Percentage Interests of Parties Under the Agreement:

Yates Petroleum Corporation	37.81252%
Myco Industries, Inc.	5.40179%
Yates Drilling Company	5.40179%
Abo Petroleum Corporation	5.40179%
Sanders Oil & Gas Company	22.47020%
Enerag, Inc.	20.83330%
Pam Rose Ridge	.89290%
Sue Ann Rose Edwards	.89290%
Julia Rose Heald	.89290%

III. Addresses of Parties to Which Notices Should be Sent:

Yates Petroleum Corporation	Sanders Oil & Gas Company
Yates Drilling Company	16200 Dallas Parkway, Suite
Abo Petroleum Corporation	Dallas, Texas 75248
Myco Industries, Inc.	
105 South Fourth Street	Enerag, Inc.
Artesia, New Mexico 88210	P.O. Box 1054
Attention: Robert Bullock	Midland, Texas 79702-1600
Julia Rose Heald	Sue-Ann Rose Edwards
3301 Elm Street	8815 Mountain Path Circle
Dallas, Texas 75226	Austin, Texas 78759
Pam Rose Ridge	
1006 Birchwood Lane	
Mansfield, Texas 76063	

EXHIBIT " C "

Attached to and made a part of Operating Agreement dated December 5, 1994 between Yates Petroleum Corporation "Operator" and Sanders Oil & Gas Company, et al, "Non-Operators".

ACCOUNTING PROCEDURE JOINT OPERATIONS

I. GENERAL PROVISIONS

1. Definitions

"Joint Property" shall mean the real and personal property subject to the agreement to which this Accounting Procedure is attached.

"Joint Operations" shall mean all operations necessary or proper for the development, operation, protection and maintenance of the Joint Property.

"Joint Account" shall mean the account showing the charges paid and credits received in the conduct of the Joint Operations and which are to be shared by the Parties.

"Operator" shall mean the party designated to conduct the Joint Operations.

"Non-Operators" shall mean the parties to this agreement other than the Operator.

"Parties" shall mean Operator and Non-Operators.

"First Level Supervisors" shall mean those employees whose primary function in Joint Operations is the direct supervision of other employees and/or contract labor directly employed on the Joint Property in a field operating capacity.

"Technical Employees" shall mean those employees having special and specific engineering, geological or other professional skills, and whose primary function in Joint Operations is the handling of specific operating conditions and problems for the benefit of the Joint Property.

"Personal Expenses" shall mean travel and other reasonable reimbursable expenses of Operator's employees.

"Material" shall mean personal property, equipment or supplies acquired or held for use on the Joint Property.

"Controllable Material" shall mean Material which at the time is so classified in the Material Classification Manual as most recently recommended by the Council of Petroleum Accountants Societies of North America.

2. Statement and Billings

Operator shall bill Non-Operators on or before the last day of each month for their proportionate share of the Joint Account for the preceding month. Such bills will be accompanied by statements which identify the authority for expenditure, lease or facility, and all charges and credits, summarized by appropriate classifications of investment and expense except that items of Controllable Material and unusual charges and credits shall be separately identified and fully described in detail.

3. Advances and Payments by Non-Operators

Unless otherwise provided for in the agreement, the Operator may require the Non-Operators to advance their share of estimated cash outlay for the succeeding month's operation. Operator shall adjust each monthly billing to reflect advances received from the Non-Operators.

Each Non-Operator shall pay its proportion of all bills within fifteen (15) days after receipt. If payment is not made within such time, the unpaid balance shall bear interest monthly at the rate of twelve percent (12%) per annum or the maximum contract rate permitted by the applicable usury laws in the state in which the Joint Property is located, whichever is the lesser, plus attorney's fees, court costs, and other costs in connection with the collection of unpaid amounts.

4. Adjustments

Payment of any such bills shall not prejudice the right of any Non-Operator to protest or question the correctness thereof; provided, however, all bills and statements rendered to Non-Operators by Operator during any calendar year shall conclusively be presumed to be true and correct after twenty-four (24) months following the end of any such calendar year, unless within the said twenty-four (24) month period a Non-Operator takes written exception thereto and makes claim on Operator for adjustment. No adjustment favorable to Operator shall be made unless it is made within the same prescribed period. The provisions of this paragraph shall not prevent adjustments resulting from a physical inventory of Controllable Material as provided for in Section V.

5. Audits

A. Non-Operator, upon notice in writing to Operator and all other Non-Operators, shall have the right to audit Operator's accounts and records relating to the Joint Account for any calendar year within the twenty-four (24) month period following the end of such calendar year; provided, however, the making of an audit shall not extend the time for the taking of written exception to and the adjustments of accounts as provided for in Paragraph 4 of this Section I. Where there are two or more Non-Operators, the Non-Operators shall make every reasonable effort to conduct joint or simultaneous audits in a manner which will result in a minimum of inconvenience to the Operator. Operator shall bear no portion of the Non-Operators' audit cost incurred under this paragraph unless agreed to by the Operator.

6. Approval by Non-Operators

Where an approval or other agreement of the Parties or Non-Operators is expressly required under other sections of this Accounting Procedure and if the agreement to which this Accounting Procedure is attached contains no contrary provisions in regard thereto, Operator shall notify all Non-Operators of the Operator's proposal, and the agreement or approval of a majority in interest of the Non-Operators shall be controlling on all Non-Operators.

II. DIRECT CHARGES

Operator shall charge the Joint Account with the following items:

1. Rentals and Royalties

Lease rentals and royalties paid by Operator for the Joint Operations.

2. Labor

- A. (1) Salaries and wages of Operator's field employees directly employed on the Joint Property in the conduct of Joint Operations.
- (2) Salaries of First Level Supervisors in the field.
- (3) Salaries and wages of Technical Employees directly employed on the Joint Property if such charges are excluded from the Overhead rates.
- B. Operator's cost of holiday, vacation, sickness and disability benefits and other customary allowances paid to employees whose salaries and wages are chargeable to the Joint Account under Paragraph 2A of this Section II. Such costs under this Paragraph 2B may be charged on a "when and as paid basis" or by "percentage assessment" on the amount of salaries and wages chargeable to the Joint Account under Paragraph 2A of this Section II. If percentage assessment is used, the rate shall be based on the Operator's cost experience.
- C. Expenditures or contributions made pursuant to assessments imposed by governmental authority which are applicable to Operator's costs chargeable to the Joint Account under Paragraphs 2A and 2B of this Section II.
- D. Personal Expenses of those employees whose salaries and wages are chargeable to the Joint Account under Paragraph 2A of this Section II.

3. Employee Benefits

Operator's current costs of established plans for employees' group life insurance, hospitalization, pension, retirement, stock purchase, thrift, bonus, and other benefit plans of a like nature, applicable to Operator's labor cost chargeable to the Joint Account under Paragraphs 2A and 2B of this Section II shall be Operator's actual cost not to exceed twenty per cent (20%).

4. Material

Material purchased or furnished by Operator for use on the Joint Property as provided under Section IV. Only such Material shall be purchased for or transferred to the Joint Property as may be required for immediate use and is reasonably practical and consistent with efficient and economical operations. The accumulation of surplus stocks shall be avoided.

5. Transportation

Transportation of employees and Material necessary for the Joint Operations but subject to the following limitations:

- A. If Material is moved to the Joint Property from the Operator's warehouse or other properties, no charge shall be made to the Joint Account for a distance greater than the distance from the nearest reliable supply store, recognized barge terminal, or railway receiving point where like material is normally available, unless agreed to by the Parties.
- B. If surplus Material is moved to Operator's warehouse or other storage point, no charge shall be made to the Joint Account for a distance greater than the distance to the nearest reliable supply store, recognized barge terminal, or railway receiving point unless agreed to by the Parties. No charge shall be made to the Joint Account for moving Material to other properties belonging to Operator, unless agreed to by the Parties.
- C. In the application of Subparagraphs A and B above, there shall be no equalization of actual gross trucking cost of \$200 or less excluding accessorial charges.

6. Services

The cost of contract services, equipment and utilities provided by outside sources, except services excluded by Paragraph 9 of Section II and Paragraph 1. ii of Section III. The cost of professional consultant services and contract services of technical personnel directly engaged on the Joint Property if such charges are excluded from the Overhead rates. The cost of professional consultant services or contract services of technical personnel not directly engaged on the Joint Property shall not be charged to the Joint Account unless previously agreed to by the Parties.

7. Equipment and Facilities Furnished by Operator

- A. Operator shall charge the Joint Account for use of Operator owned equipment and facilities at rates commensurate with costs of ownership and operation. Such rates shall include costs of maintenance, repairs, other operating expense, insurance, taxes, depreciation, and interest on investment not to exceed eight per cent (8%) per annum. Such rates shall not exceed average commercial rates currently prevailing in the immediate area of the Joint Property.
- B. In lieu of charges in Paragraph 7A above, Operator may elect to use average commercial rates prevailing in the immediate area of the Joint Property less 20%. For automotive equipment, Operator may elect to use rates published by the Petroleum Motor Transport Association.

8. Damages and Losses to Joint Property

All costs or expenses necessary for the repair or replacement of Joint Property made necessary because of damages or losses incurred by fire, flood, storm, theft, accident, or other cause, except those resulting from Operator's gross negligence or willful misconduct. Operator shall furnish Non-Operator written notice of damages or losses incurred as soon as practicable after a report thereof has been received by Operator.

9. Legal Expense

Expense of handling, investigating and settling litigation or claims, discharging of liens, payment of judgments and amounts paid for settlement of claims incurred in or resulting from operations under the agreement or necessary to protect or recover the Joint Property, except that no charge for services of Operator's legal staff or fees or expense of outside attorneys shall be made unless previously agreed to by the Parties. All other legal expense is considered to be covered by the overhead provisions of Section III unless otherwise agreed to by the Parties, except as provided in Section I, Paragraph 3.

10. Taxes

All taxes of every kind and nature assessed or levied upon or in connection with the Joint Property, the operation thereof, or the production therefrom, and which taxes have been paid by the Operator for the benefit of the Parties.

11. Insurance

Net premiums paid for insurance required to be carried for the Joint Operations for the protection of the Parties. In the event Joint Operations are conducted in a state in which Operator may act as self-insurer for Workmen's Compensation and/or Employers Liability under the respective state's laws, Operator may, at its election, include the risk under its self-insurance program and in that event, Operator shall include a charge at Operator's cost not to exceed manual rates.

12. Other Expenditures

Any other expenditure not covered or dealt with in the foregoing provisions of this Section II, or in Section III, and which is incurred by the Operator in the necessary and proper conduct of the Joint Operations.

III. OVERHEAD**1. Overhead - Drilling and Producing Operations**

- i. As compensation for administrative, supervision, office services and warehousing costs, Operator shall charge drilling and producing operations on either:

- (☒) Fixed Rate Basis, Paragraph 1A, or
() Percentage Basis, Paragraph 1B.

Unless otherwise agreed to by the Parties, such charge shall be in lieu of costs and expenses of all offices and salaries or wages plus applicable burdens and expenses of all personnel, except those directly chargeable under Paragraph 2A, Section II. The cost and expense of services from outside sources in connection with matters of taxation, traffic, accounting or matters before or involving governmental agencies shall be considered as included in the Overhead rates provided for in the above selected Paragraph of this Section III unless such cost and expense are agreed to by the Parties as a direct charge to the Joint Account.

- ii. The salaries, wages and Personal Expenses of Technical Employees and/or the cost of professional consultant services and contract services of technical personnel directly employed on the Joint Property shall () shall not (xx) be covered by the Overhead rates.

A. Overhead - Fixed Rate Basis

- (1) Operator shall charge the Joint Account at the following rates per well per month:

Drilling Well Rate \$ 4000.00
Producing Well Rate \$ 400.00

- (2) Application of Overhead - Fixed Rate Basis shall be as follows:

(a) Drilling Well Rate

- [1] Charges for onshore drilling wells shall begin on the date the well is spudded and terminate on the date the drilling or completion rig is released, whichever is later, except that no charge shall be made during suspension of drilling operations for fifteen (15) or more consecutive days.
- [2] Charges for offshore drilling wells shall begin on the date when drilling or completion equipment arrives on location and terminate on the date the drilling or completion equipment moves off location or rig is released, whichever occurs first, except that no charge shall be made during suspension of drilling operations for fifteen (15) or more consecutive days.
- [3] Charges for wells undergoing any type of workover or recompletion for a period of five (5) consecutive days or more shall be made at the drilling well rate. Such charges shall be applied for the period from date workover operations, with rig, commence through date of rig release, except that no charge shall be made during suspension of operations for fifteen (15) or more consecutive days.

(b) Producing Well Rates

- [1] An active well either produced or injected into for any portion of the month shall be considered as a one-well charge for the entire month.
- [2] Each active completion in a multi-completed well in which production is not commingled down hole shall be considered as a one-well charge providing each completion is considered a separate well by the governing regulatory authority.
- [3] An inactive gas well shut in because of overproduction or failure of purchaser to take the production shall be considered as a one-well charge providing the gas well is directly connected to a permanent sales outlet.
- [4] A one-well charge may be made for the month in which plugging and abandonment operations are completed on any well.
- [5] All other inactive wells (including but not limited to inactive wells covered by unit allowable, lease allowable, transferred allowable, etc.) shall not qualify for an overhead charge.

- (3) The well rates shall be adjusted as of the first day of April each year following the effective date of the agreement to which this Accounting Procedure is attached. The adjustment shall be computed by multiplying the rate currently in use by the percentage increase or decrease in the average weekly earnings of Crude Petroleum and Gas Production Workers for the last calendar year compared to the calendar year preceding as shown by the index of average weekly earnings of Crude Petroleum and Gas Fields Production Workers as published by the United States Department of Labor, Bureau of Labor Statistics, or the equivalent Canadian index as published by Statistics Canada, as applicable. The adjusted rates shall be the rates currently in use, plus or minus the computed adjustment.

B. Overhead - Percentage Basis

(1) Operator shall charge the Joint Account at the following rates:

(a) Development

_____ Percent (%) of the cost of Development of the Joint Property exclusive of costs provided under Paragraph 9 of Section II and all salvage credits.

(b) Operating

_____ Percent (%) of the cost of Operating the Joint Property exclusive of costs provided under Paragraphs 1 and 9 of Section II, all salvage credits, the value of injected substances purchased for secondary recovery and all taxes and assessments which are levied, assessed and paid upon the mineral interest in and to the Joint Property.

(2) Application of Overhead - Percentage Basis shall be as follows:

For the purpose of determining charges on a percentage basis under Paragraph 1B of this Section III, development shall include all costs in connection with drilling, redrilling, deepening or any remedial operations on any or all wells involving the use of drilling crew and equipment; also, preliminary expenditures necessary in preparation for drilling and expenditures incurred in abandoning when the well is not completed as a producer, and original cost of construction or installation of fixed assets, the expansion of fixed assets and any other project clearly discernible as a fixed asset, except Major Construction as defined in Paragraph 2 of this Section III. All other costs shall be considered as Operating.

2. Overhead - Major Construction

To compensate Operator for overhead costs incurred in the construction and installation of fixed assets, the expansion of fixed assets, and any other project clearly discernible as a fixed asset required for the development and operation of the Joint Property, Operator shall either negotiate a rate prior to the beginning of construction, or shall charge the Joint Account for Overhead based on the following rates for any Major Construction project in excess of \$ 25,000.00 :

- A. 5 % of total costs if such costs are more than \$ 25,000.00 but less than \$ 100,000.00 ; plus
 B. 3 % of total costs in excess of \$ 100,000.00 but less than \$1,000,000; plus
 C. 2 % of total costs in excess of \$1,000,000.

Total cost shall mean the gross cost of any one project. For the purpose of this paragraph, the component parts of a single project shall not be treated separately and the cost of drilling and workover wells shall be excluded.

3. Amendment of Rates

The Overhead rates provided for in this Section III may be amended from time to time only by mutual agreement between the Parties hereto if, in practice, the rates are found to be insufficient or excessive.

IV. PRICING OF JOINT ACCOUNT MATERIAL PURCHASES, TRANSFERS AND DISPOSITIONS

Operator is responsible for Joint Account Material and shall make proper and timely charges and credits for all material movements affecting the Joint Property. Operator shall provide all Material for use on the Joint Property; however, at Operator's option, such Material may be supplied by the Non-Operator. Operator shall make timely disposition of idle and/or surplus Material, such disposal being made either through sale to Operator or Non-Operator, division in kind, or sale to outsiders. Operator may purchase, but shall be under no obligation to purchase, interest of Non-Operators in surplus condition A or B Material. The disposal of surplus Controllable Material not purchased by the Operator shall be agreed to by the Parties.

1. Purchases

Material purchased shall be charged at the price paid by Operator after deduction of all discounts received. In case of Material found to be defective or returned to vendor for any other reason, credit shall be passed to the Joint Account when adjustment has been received by the Operator.

2. Transfers and Dispositions

Material furnished to the Joint Property and Material transferred from the Joint Property or disposed of by the Operator, unless otherwise agreed to by the Parties, shall be priced on the following bases exclusive of cash discounts:

A. New Material (Condition A)

- (1) Tubular goods, except line pipe, shall be priced at the current new price in effect on date of movement on a maximum carload or barge load weight basis, regardless of quantity transferred, equalized to the lowest published price f.o.b. railway receiving point or recognized barge terminal nearest the Joint Property where such Material is normally available.
- (2) Line Pipe
 - (a) Movement of less than 30,000 pounds shall be priced at the current new price, in effect at date of movement, as listed by a reliable supply store nearest the Joint Property where such Material is normally available.
 - (b) Movement of 30,000 pounds or more shall be priced under provisions of tubular goods pricing in Paragraph 2A (1) of this Section IV.
- (3) Other Material shall be priced at the current new price, in effect at date of movement, as listed by a reliable supply store or f.o.b. railway receiving point nearest the Joint Property where such Material is normally available.

B. Good Used Material (Condition B)

Material in sound and serviceable condition and suitable for reuse without reconditioning:

- (1) Material moved to the Joint Property
 - (a) At seventy-five percent (75%) of current new price, as determined by Paragraph 2A of this Section IV.
- (2) Material moved from the Joint Property
 - (a) At seventy-five percent (75%) of current new price, as determined by Paragraph 2A of this Section IV, if Material was originally charged to the Joint Account as new Material, or

- (b) at sixty-five percent (65%) of current new price, as determined by Paragraph 2A of this Section IV, if Material was originally charged to the Joint Account as good used Material at seventy-five percent (75%) of current new price.

The cost of reconditioning, if any, shall be absorbed by the transferring property.

C. Other Used Material (Condition C and D)

(1) Condition C

Material which is not in sound and serviceable condition and not suitable for its original function until after reconditioning shall be priced at fifty percent (50%) of current new price as determined by Paragraph 2A of this Section IV. The cost of reconditioning shall be charged to the receiving property, provided Condition C value plus cost of reconditioning does not exceed Condition B value.

(2) Condition D

All other Material, including junk, shall be priced at a value commensurate with its use or at prevailing prices. Material no longer suitable for its original purpose but usable for some other purpose, shall be priced on a basis comparable with that of items normally used for such other purpose. Operator may dispose of Condition D Material under procedures normally utilized by the Operator without prior approval of Non-Operators.

D. Obsolete Material

Material which is serviceable and usable for its original function but condition and/or value of such Material is not equivalent to that which would justify a price as provided above may be specially priced as agreed to by the Parties. Such price should result in the Joint Account being charged with the value of the service rendered by such Material.

E. Pricing Conditions

- (1) Loading and unloading costs may be charged to the Joint Account at the rate of fifteen cents (15¢) per hundred weight on all tubular goods movements, in lieu of loading and unloading costs sustained, when actual hauling cost of such tubular goods are equalized under provisions of Paragraph 5 of Section II.
- (2) Material involving erection costs shall be charged at applicable percentage of the current knocked-down price of new Material.

3. Premium Prices

Whenever Material is not readily obtainable at published or listed prices because of national emergencies, strikes or other unusual causes over which the Operator has no control, the Operator may charge the Joint Account for the required Material at the Operator's actual cost incurred in providing such Material, in making it suitable for use, and in moving it to the Joint Property; provided notice in writing is furnished to Non-Operators of the proposed charge prior to billing Non-Operators for such Material. Each Non-Operator shall have the right, by so electing and notifying Operator within ten days after receiving notice from Operator, to furnish in kind all or part of his share of such Material suitable for use and acceptable to Operator.

4. Warranty of Material Furnished by Operator

Operator does not warrant the Material furnished. In case of defective Material, credit shall not be passed to the Joint Account until adjustment has been received by Operator from the manufacturers or their agents.

V. INVENTORIES

The Operator shall maintain detailed records of Controllable Material.

1. Periodic Inventories, Notice and Representation

At reasonable intervals, Inventories shall be taken by Operator of the Joint Account Controllable Material. Written notice of intention to take inventory shall be given by Operator at least thirty (30) days before any inventory is to begin so that Non-Operators may be represented when any inventory is taken. Failure of Non-Operators to be represented at an inventory shall bind Non-Operators to accept the inventory taken by Operator.

2. Reconciliation and Adjustment of Inventories

Reconciliation of a physical inventory with the Joint Account shall be made, and a list of overages and shortages shall be furnished to the Non-Operators within six months following the taking of the inventory. Inventory adjustments shall be made by Operator with the Joint Account for overages and shortages, but Operator shall be held accountable only for shortages due to lack of reasonable diligence.

3. Special Inventories

Special Inventories may be taken whenever there is any sale or change of interest in the Joint Property. It shall be the duty of the party selling to notify all other Parties as quickly as possible after the transfer of interest takes place. In such cases, both the seller and the purchaser shall be governed by such inventory.

4. Expense of Conducting Periodic Inventories

The expense of conducting periodic Inventories shall not be charged to the Joint Account unless agreed to by the Parties.

EXHIBIT "D"

ATTACHED TO AND MADE A PART OF OPERATING AGREEMENT

ADDITIONAL INSURANCE PROVISIONS

Operator, during the term of this agreement, shall carry insurance for the benefit and at the expense of the parties hereto, as follows:

(A) Workmen's Compensation Insurance as contemplated by the state in which operations will be conducted, and Employer's Liability Insurance with limits of not less than \$100,000.00 per employee.

(B) Public Liability Insurance:
Bodily Injury \$500,000.00 each occurrence.

(C) Automobile Public Liability Insurance:
Bodily Injury \$250,000.00 each person.
\$500,000.00 each occurrence.

Property Damage - \$100,000.00 each occurrence.

Except as authorized by this Exhibit "D", Operator shall not make any charge to the joint account for insurance premiums. Losses not covered by Operator's insurance (or by insurance required by this agreement to be carried for the benefit and at the expense of the parties hereto) shall be charged to the joint account.

EXHIBIT "E"

GAS BALANCING AGREEMENT

The parties to the Operating Agreement to which this agreement is attached own the working interest in the gas rights underlying the lands covered by such agreement (the "Contract Area") in accordance with the percentages of participation as set forth in Exhibit "A" to the Operating Agreement (the "participation percentage").

In accordance with the terms of the Operating Agreement, each party thereto has the right to take its share of gas produced from the Contract Area and market the same. In the event any of the parties hereto collectively owning participation percentages of less than 50% are not at any time taking or marketing their share of gas or have contracted to sell their share of gas produced from the Contract Area to a purchaser which does not at any time while this agreement is in effect take the full share of gas attributable to the interest of such parties, this agreement shall automatically become effective upon the terms hereinafter set forth.

1. During the period or periods when any parties hereto collectively owning participation percentages of less than 50% have no market for their share of gas produced from any proration unit within the Contract Area, or their purchaser does not take its full share of gas produced from such proration unit, other parties collectively owning participation percentages of more than 50% shall be entitled to produce each month 100% of the lesser of a) allowable gas production assigned to such proration unit by applicable state regulatory authority or b) the delivery capacity of gas from such proration unit; provided, however, no party who does not have gas in place shall be entitled to take or deliver to a purchaser gas production in excess of 200% of the lesser of c) its share of the volumes of gas capable of being delivered on a daily basis or d) its share of allowable gas production. All parties hereto shall share in and own the liquid hydrocarbons recovered from such gas by lease equipment in accordance with their respective interests and subject to the Operating Agreement to which this agreement is attached, but the party or parties taking such gas shall own all of the gas delivered to its or their purchaser.

2. On a cumulative basis, each party not taking or marketing its full share of the gas produced shall be credited with gas in place equal to its full share of the gas produced under this agreement, less its share of gas used in lease operations, vented or lost, and less that portion such party took or delivered to its purchaser. The Operator will maintain a current account of gas balance between the parties and will furnish all parties hereto monthly statements showing the total quantity of gas produced, the amount used in lease operations, vented or lost, the total quantity of liquid hydrocarbons recovered therefrom, and the monthly and cumulative over and under account of each party.

3. At all times while gas is produced from the Contract Area, each party hereto will make settlement with the respective royalty owners to whom they are each accountable, just as if each party were taking or delivering to a purchaser its share, and its share only. Each party hereto agrees to hold each other party harmless from any and all claims for royalty payments asserted by royalty owners to whom each party is accountable. The term "royalty owner" shall include owners of royalty, overriding royalties, production payments and other similar interests.

Each party producing and taking or delivering gas to its purchaser shall pay any and all production taxes due on such gas.

4. After notice to the Operator, any party at any time may begin taking or delivering to its purchaser its full share of the gas produced from a proration unit under which it has gas in place less such party's share of gas used in operations, vented or lost. In addition to such share, each party, including the Operator, until it has recovered its gas in place and balanced the gas account as to its interest, shall be entitled to take or deliver to its purchaser a share of gas determined by multiplying 50% of the interest in the current gas production of the party or parties without gas in place by a fraction, the numerator of which is the interest in the proration unit of such party with gas in

place and the denominator of which is the total percentage interest in such proration unit of all parties with gas in place currently taking or delivering to a purchaser.

5. Nothing herein shall be construed to deny any party the right, from time to time, to produce and take or deliver to its purchaser its full share of the allowable gas production to meet the deliverability tests required by its purchaser, provided that said test should be reasonable in length, normally not to exceed 72 hours.

6. If a proration unit ceases to produce gas and/or liquid hydrocarbons in paying quantities before the gas account is balanced, settlement will be made between the underproduced and overproduced parties. In making such settlement, the underproduced party or parties will be paid a sum of money by the overproduced party or parties attributable to the overproduction which said overproduced party received, less applicable taxes theretofore paid, at the applicable price defined below for the delivery of a volume of gas equal to that for which settlement is made. For gas, the price of which is not regulated by federal, state or other governmental agencies, the price basis shall be the price received for the sale of the gas. For gas, the price of which is subject to regulation by federal, state or other governmental authorities, the price basis shall be the rate collected, from time to time, which is not subject to possible refund, as provided by the Federal Energy Regulatory Commission or any other governmental authority, pursuant to final order or settlement applicable to the gas sold from such well, plus any additional collected amount which is not ultimately required to be refunded by such authority, such additional collected amount to be accounted for at such time as final determination is made with respect hereto.

7. Notwithstanding the provisions of ¶6, it is expressly agreed that any underproduced party shall have the optional right, with respect to each proration unit, to receive a cash settlement bringing such underproduced party's gas account into balance at any time and from time to time prior to the final settlement, by first giving each overproduced party 90 days' written notice of demand for cash settlement. If such option is so exercised, settlement shall be made (as of 7:00 o'clock A.M. on the first day of the calendar month following the date of such written demands) within 90 days following the actual receipt of such written demands by the overproduced parties, in the same manner provided for in ¶6. The option provided for in this paragraph may be exercised, from time to time, but only one time in each calendar year.

8. Nothing herein shall change or affect each party's obligation to pay its proportionate share of all costs and liabilities incurred, as its share thereof is set forth in the Operating Agreement.

9. This agreement shall constitute a separate agreement as to each proration unit approved by the applicable regulatory authority for a pool within the Contract Area, but such proration unit shall not include any producing horizon which is not within the vertical limits of said pool. This agreement shall remain in force and effect so long as the Operating Agreement to which it is attached remains in effect, and shall inure to the benefit of and be binding upon the parties hereto, their heirs, successors, legal representatives and assigns.

EXHIBIT "F"

EQUAL EMPLOYMENT OPPORTUNITY PROVISION

During the performance of this contract, the Operator agrees as follows:

- (1) The Operator will not discriminate against any employee or applicant for employment because of race, color, religion, national origin or sex. The Operator will take affirmative action to ensure that applicants are employed, and that employees are treated during employment, without regard to their race, color, religion, national origin or sex. Such action shall include, but not be limited to the following: employment, upgrading, demotion, or transfer, recruitment or recruitment advertising; layoff or termination; rates of pay or other forms of compensation; and selection for training, including apprenticeship. The Operator agrees to post in conspicuous places, available to employees and applicants for employment notices to be provided for the contracting officer setting forth the provisions of this non-discrimination clause.
- (2) The Operator will, in all solicitations or advertisements for employees placed by or on behalf of the Operator, state that all qualified applicants will receive consideration for employment without regard to race, color, religion, national origin or sex.
- (3) The Operator will send to each labor union or representative of workers with which it has a collective bargaining agreement or other contract or understanding, a notice to be provided by the agency contracting officer, advising the labor union or workers' representative of the Operator's commitments under Section 202 of Executive Order 11246 of September 24, 1965, and shall post copies of the notice in conspicuous places available to employees and applicants for employment.
- (4) The Operator will comply with all provisions of Executive Order 11246 of September 24, 1965, and of the rules, regulations, and relevant orders of the Secretary of Labor.
- (5) The Operator will furnish all information and reports required by Executive Order 11246 of September 24, 1965, and by the rules, regulations, and orders of the Secretary of Labor, or pursuant thereto, and will permit access to its books, records, and accounts by the contracting agency and the Secretary of Labor for purposes of investigation to ascertain compliance with such rules, regulations, and orders.
- (6) In the event of the Operator's non-compliance with the non-discrimination clauses of this contract or with any of such rules, regulations, or orders, this contract may be canceled, terminated or suspended in whole or in part and the Operator may be declared ineligible for further Government contracts in accordance with procedures authorized in Executive Order 11246 of September 24, 1965, and such other sanctions may be imposed and remedies invoked as provided in Executive Order 11246 of September 24, 1965, or by rule, regulation, or order of the Secretary of Labor, or as otherwise provided by law.

- (7) The Operator will include the provisions of Paragraphs (1) through (7) in every subcontract or purchase order unless exempted by rules, regulations, or orders of the Secretary of Labor issued pursuant to Section 204 of Executive Order 11246 of September 24, 1965, so that such provisions will be binding upon each subcontractor or vendor. The Operator will take such action with respect to any subcontract or purchase order as the contracting agency may direct as a means of enforcing such provisions including sanctions for non-compliance: Provided, however, that in the event the Operator becomes involved in, or is threatened with, litigation with a subcontractor or vendor as a result of such direction by the contracting agency, the Operator may request the United States to enter into such litigation to protect the interests of the United States.

Operator acknowledges that it may be required to file Standard Form 100 (EEO-I) promulgated jointly by the Office of Federal Contract Compliance, the Equal Employment Opportunity Commission and Plans for Progress with Joint Reporting Committee, Federal Depot, Jeffersonville, Indiana, within thirty (30) days of the date of contract award if such report has not been filed for the current year and otherwise comply with or file such other compliance reports as may be required under Executive Order 11246, as amended and Rules and Regulations adopted thereunder.

Operator further acknowledges that he may be required to develop a written affirmative action compliance program as required by the Rules and Regulations approved by the Secretary of Labor under authority of Executive Order 11246 and supply Non-Operators with a copy of such program if they so request.

CERTIFICATION OF NON-SEGREGATED FACILITIES

Operator assures Non-Operators that it does not and will not maintain or provide for its employees any segregated facilities at any of its establishments, and that it does not and will not permit its employees to perform their services at any location, under its control, where segregated facilities are maintained. For this purpose, it is understood that the phrase "segregated facilities" includes facilities which are in fact segregated on a basis of race, color, religion, or national origin, because of habit; local custom or otherwise. It is further understood and agreed that maintaining or providing segregated facilities for its employees or permitting its employees to perform their services at any location under its control where segregated facilities are maintained is a violation of the equal opportunity clause required by Executive Order 11246 of September 24, 1965.

Operator further understands and agrees that a breach of the assurance herein contained subjects it to the provisions of the Order at 41 CFR Chapter 60 of the Secretary of Labor dated May 21, 1968, and the provisions of the equal opportunity clause enumerated in contracts between the United States of America and Non-Operators.

Whoever knowingly and willfully makes any false, fictitious or fraudulent representation may be liable to criminal prosecution under 18 U. S. C. - 1001 .

DESIGNATION OF POOLED UNIT

KNOW ALL MEN BY THESE PRESENTS:

WHEREAS, the undersigned are the present owners and holders of the oil and gas leases fully described on Exhibit "A" attached hereto, now of record in the Office of the Chaves County Clerk, New Mexico; and

WHEREAS, the oil and gas leases, hereinafter collectively referred to as the "Leases", are owned by various parties, Exhibit "A" also indicates the record owner and recording information of the Leases, as reflected by the records of the County Clerk of Chaves County, New Mexico; and

WHEREAS, all of the Leases contain a pooling provision which permits the pooling thereof by the Lessee; and

WHEREAS, the New Mexico Oil Conservation Commission has established the SE/4 of Section 17, Township 10 South, Range 25 East, N.M.P.M., Chaves County, New Mexico, as the proration unit for Yates Petroleum Corporation's Rose Cannon AOR Com #1 Well, located thereon, or any other well located on said unit, for the production of oil and/or gas and associated hydrocarbons.

NOW, THEREFORE, pursuant to the power granted the undersigned in the above-described Leases, the undersigned do hereby designate and file this Designation of Pooled Unit for the Rose Cannon AOR Com #1 Well, insofar as said Leases cover the Abo Formation, to form a standard proration unit consisting of the following described land in Chaves County, New Mexico, to-wit:

Township 10 South, Range 25 East, N.M.P.M.

Section 17: SE/4

Containing 160.00 acres, more or less.

Additional oil, gas and other mineral leases, or oil and gas leases, or other interests not described on Exhibit "A" hereto may be committed to this Designation of Pooled Unit from time to time, insofar and only insofar, as such additional leases or interests may cover and include interests lying within the SE/4 of Section 17, Township 10 South, Range 25 East, N.M.P.M, Chaves County, New Mexico. Any such commitment shall be effective as of the date of this Designation of Pooled Unit and an appropriate joinder and ratification instrument shall be executed by each party committing a lease or interest to said unit and accepted by Yates Petroleum Corporation, the designated Operator of said pooled unit, or any successor or substitute operator of said pooled unit.

This Designation of Pooled Unit may be executed or ratified by any of the persons owning a leasehold interest, unleased mineral interest, or other interest in lands comprising part of the pooled unit designated herein, and such execution and ratification shall be binding upon all persons executing or ratifying same whether or not all interest owners execute or ratify this instrument. This instrument may be executed in any number of counterparts, each of which shall be considered an original for all purposes.

EXECUTED THIS ____ day of _____, 1994, effective retroactive as of the ____ day of _____, 1994, being the date of completion of the Rose Cannon AOR Com #1 Well

Attest:

YATES PETROLEUM CORPORATION

By: _____
Attorney-in-Fact

Attest:

YATES DRILLING COMPANY

By: _____
Attorney-in-Fact

Attest:

ABO PETROLEUM CORPORATION

By: _____
Attorney-in-Fact

Attest:

MYCO INDUSTRIES, INC.

By: _____
Attorney-in-Fact

Attest:

ENERAG, INC.

By: _____
Attorney-in-Fact

C.W. SANDERS, d/b/a
SANDERS OIL & GAS COMPANY

C.W. Sanders

STATE OF NEW MEXICO

COUNTY OF _____

The foregoing instrument was acknowledged before me this ____ day of _____, 1994, by _____, Attorney-in-fact of Yates Petroleum Corporation, a New Mexico Corporation, for and on behalf of said corporation.

Notary Public

My Commission expires: _____

STATE OF NEW MEXICO

COUNTY OF _____

The foregoing instrument was acknowledged before me this ____ day of _____, 1994, by _____, Attorney-in-fact of Yates Drilling Company, a New Mexico Corporation, for and on behalf of said corporation.

Notary Public

My Commission expires:_____

STATE OF NEW MEXICO

COUNTY OF _____

The foregoing instrument was acknowledged before me this ____ day of _____, 1994, by _____, Attorney-in-fact of ABO Petroleum Corporation, a New Mexico Corporation, for and on behalf of said corporation.

Notary Public

My Commission expires:_____

STATE OF NEW MEXICO

COUNTY OF _____

The foregoing instrument was acknowledged before me this ____ day of _____, 1994, by _____, Attorney-in-fact of Myco Industries, Inc., a New Mexico Corporation, for and on behalf of said corporation.

Notary Public

My Commission expires:_____

STATE OF _____

COUNTY OF _____

The foregoing instrument was acknowledged before me this ____ day of _____, 1994, by _____, of ENERAG, Inc., a _____ Corporation, for and on behalf of said corporation.

Notary Public

My Commission expires:_____

STATE OF NEW MEXICO

COUNTY OF _____

The foregoing instrument was acknowledged before me this ____ day of _____, 1994, by C.W. Sanders.

Notary Public

My Commission expires: _____

LT\C:\WP60\KMC\KMCDOC\DESIGNAT.UNT

Pam Rose Ridge, a married woman dealing in her
sole and separate property

STATE OF _____

COUNTY OF _____

The foregoing instrument was acknowledged before me this ____ day of _____, 1994 by Pam Rose Ridge, a married woman dealing in her sole and separate property.

Notary Public

My Commission expires:_____

Sue Ann Rose Edwards, a married woman dealing
in her sole and separate property

STATE OF _____

COUNTY OF _____

The foregoing instrument was acknowledged before me this ____ day of _____, 1994 by Sue Ann
Rose Edwards, a married woman dealing in her sole and separate property.

Notary Public

My Commission expires:_____

Julia Rose Heald, a married woman dealing in her
sole and separate property

STATE OF _____

COUNTY OF _____

The foregoing instrument was acknowledged before me this ____ day of _____, 1994 by Julia Rose Heald, a married woman dealing in her sole and separate property.

Notary Public

My Commission expires:_____

EXHIBIT A

To Designation of Pooled Unit
Township 10 South, Range 25 East, N.M.P.M.:
Section 17: SE/4

Limited to the Abo Formation
Containing 160 acres, more or less.

Chaves County, New Mexico

LEASE NUMBER	LESSOR	PRESENT LESSEE	LEASE DESCRIPTION	RECORDING INFORMATION	DATE OF LEASE	NET ACRES
1	Hazel Bales Cannon	Yates Petroleum Corporation (70%) Yates Drilling Company (10%) Myco Petroleum Corporation (10%) Myco Industries, Inc. (10%)	Sec.17:E/2SE/4, below 2,000 feet subsurface	February 21, 1990 at Book 75, Page 1028	February 1, 1990	53.3333344
2	Helen Joan Overpeck Lemon	Yates Petroleum Corporation (70%) Yates Drilling Company (10%) Myco Petroleum Corporation (10%) Myco Industries, Inc. (10%)	Sec.17:E/2SE/4, below 2,000 feet subsurface	February 21, 1990 at Book 75, Page 1026	February 1, 1990	2.6666664
3	Florence E. Morgan	Yates Petroleum Corporation (70%) Yates Drilling Company (10%) Myco Petroleum Corporation (10%) Myco Industries, Inc. (10%)	Sec.17:E/2SE/4, below 2,000 feet subsurface	February 21, 1990 at Book 75, Page 1024	February 1, 1990	2.6666664
4	Joseph Kenneth Morgan	Yates Petroleum Corporation (70%) Yates Drilling Company (10%) Myco Petroleum Corporation (10%) Myco Industries, Inc. (10%)	Sec.17:E/2SE/4, below 2,000 feet subsurface	February 21, 1990 at Book 75, Page 1022	February 1, 1990	10.6666664
5	Willis E. Morgan, Jr.	Yates Petroleum Corporation (70%) Yates Drilling Company (10%) Myco Petroleum Corporation (10%) Myco Industries, Inc. (10%)	Sec.17:E/2SE/4, below 2,000 feet subsurface	February 21, 1990 at Book 75, Page 1020	February 1, 1990	10.6666664
6	John Matteson	Enerag, Inc.	Sec.17: W/2SE/4, Among others	March 3, 1994 at Book 191, Page 148	December 12, 1993	11.428571

7	Rosemary Davis, Josephine Marion, Kathryn Robinson, and Betty Calicoat, a/k/a Betty J. Beach	Energag, Inc.	Sec. 17: W/2SE/4, Among others	March 8, 1994 at Book 191, Page 144	January 17, 1994	5.714286
8	National Benevolent Association of the Christian Church	Energag, Inc.	Sec.17: W/2SE/4	July 19, 1989 at Book 65, Page 551	July 25, 1989	11.428571
9	Valorie Sue Freeman	Sanders Oil & Gas Company	Sec.17: W/2SE/4, Among others	Book 236, Page 721	December 17, 1982	5.714286
10	Frank A. Vest	Sanders Oil & Gas Company	Sec.17: W/2SE/4, Among others	July 17, 1989 at Book 61, Page 29	December 30, 1988	5.714286
11	Robert Martin Yriart	Energag, Inc.	Sec.17: W/2SE/4, Among others	March 8, 1994 at Book 191, Page 151	January 22, 1994	1.904762
12	Mary Lynn Rose Robertson	Energag, Inc.	Sec.17: W/2SE/4, Among others	March 8, 1994 at Book 191, Page 142	January 21, 1994	0.952381
13	Benjamin Franklin Rose, III	Sanders Oil & Gas Company	Sec.17: W/2SE/4, Among others	Book 234, Page 745	January 3, 1983	5.714286
14	Tommy L. Rose	Energag, Inc.	Sec.17: W/2SE/4, Among others	November 7, 1994 at Book 214, Page 631	October 10, 1994	0.952381
15	Irwin B. Rose	Sanders Oil & Gas Company	Sec.17: W/2SE/4, Among others	Book 236, Page 97	January 14, 1983	3.809524
16	Elizabeth Ruth Naylor	Sanders Oil & Gas Company	Sec.17: W/2SE/4, Among others	Book 237, Page 876	January 24, 1983	1.904762
17	Kay R. Rose and Michael Stewart Rose	Sanders Oil & Gas Company	Sec.17: W/2SE/4, Among others	November 23, 1993 at Book 181, Page 403	October 25, 1993	7.142858
18	James Stephen Rose	Sanders Oil & Gas Company	Sec.17: W/2SE/4, Among others	March 8, 1994 at Book 198, Page 158	February 1, 1994	4.285714

19	Katherine Switzer Rose	Sanders Oil & Gas Company	Sec.17: W/2SE/4, Among others	Book 240, Page 698	March 23, 1983	0.714286
20	George E. Rose, Sr.	Energag, Inc.	Sec.17: W/2SE/4, Among others	November 7, 1994 at Book 214, Page 634	October 10, 1994	0.952381
21	Mary Rose	Yates Petroleum Corporation (70%) Yates Drilling Company (10%) Myco Petroleum Corporation (10%) Myco Industries, Inc. (10%)	Sec.17: W/2SE/4, Among others	June 15, 1994 at Book 200, Page 591	June 6, 1994	1.428571
22	Carl A. Schellinger and Gloria Schellinger, his wife and Branex Resources, Inc.	Yates Petroleum Corporation (70%) Yates Drilling Company (10%) Myco Petroleum Corporation (10%) Myco Industries, Inc. (10%)	Sec.17: W/2SE/4	June 15, 1994 at Book 200, Page 593	June 6, 1994	5.000000
23	Pam Rose Ridge	Unleased	N/A	N/A	N/A	1.428571
24	Joseph R. Skeen and David C. Skeen	Sanders Oil & Gas Company	Sec.17: W/2SE/4, Among others	Book 243, Page 935	May 27, 1983	0.952381
25	Sue Ann Rose Edwards	Unleased	N/A	July 11, 1983 at Book 244, Page 460	May 5, 1983	1.428571
26	Julia Rose Heald	Unleased	N/A	N/A	N/A	1.428571
TOTAL						160.000000

BEFORE THE OIL CONSERVATION DIVISION

OF THE STATE OF NEW MEXICO

IN THE MATTER OF THE APPLICATION OF :
YATES PETROLEUM CORPORATION FOR : CASE NO. 11210
COMPULSORY POOLING, CHAVES COUNTY, :
NEW MEXICO :
_____ :

CERTIFICATE OF MAILING
AND
COMPLIANCE WITH RULE 1207

In accordance with Division Rule 1207, I hereby certify that on January 24, 1995, February 3, 1995, and February 14, 1995, correspondence transmitting copies of the application filed in and providing notice of the hearing of the above-referenced case were mailed, prior to the hearing set on March 2, 1995, to the leasehold operators and unleased mineral owners listed on Exhibit "A" hereto.

Also attached hereto are copies of said correspondence, with return receipt cards, as Exhibit "B".

Respectfully submitted,

LOSEE, CARSON, HAAS & CARROLL, P.A.

By: Ernest L. Carroll
Ernest L. Carroll
P. O. Drawer 239
Artesia, New Mexico 88211-0239
(505) 746-3505

Attorneys for Yates Petroleum Corp.

STATE OF NEW MEXICO)
: ss.
COUNTY OF EDDY)

SUBSCRIBED AND SWORN TO before me this February 27, 1995.

Shirley J. Haldeman
Notary Public

My commission expires:

11-17-97

YATES PETROLEUM CORP.
BEFORE EXAMINER CATANACH
NMOCD CASE NO. 11210
DATE: 03/02/95
EXHIBIT NO. 7

EXHIBIT A

Sanders Oil & Gas Company
P. O. Box 797005
Dallas, TX 75379

Enerag, Inc.
P. O. Box 1054
Garden City, KS 67846

Ms. Pam Rose Ridge
1006 Birchwood Lane
Mansfield, TX 76063

Ms. Julia Rose Heald
3301 Elm Street
Dallas, TX 75226

Ms. Sue Ann Rose Edwards
3712 Ben Garza Lane, #4
Austin, TX 78749-1508

LAW OFFICES

LOSEE, CARSON, HAAS & CARROLL, P. A.

MARY LYNN BOGLE
 ERNEST L. CARROLL
 JOEL M. CARSON
 DEAN B. CROSS
 JAMES E. HAAS
 A. J. LOSEE
 BARRY D. GEWEKE

300 YATES PETROLEUM BUILDING
 P. O. BOX 1720
 ARTESIA, NEW MEXICO 88211-1720

TELEPHONE
 (505) 746-3505
 TELECOPY
 (505) 746-6316

February 14, 1995

CERTIFIED MAIL
RETURN RECEIPT REQUESTED

Ms. Sue-Ann Rose Edwards
 3712 Ben Garza Lane, #4
 Austin, TX 78749-1508

Re: Application of Yates Petroleum Corporation
 for Compulsory Pooling, Chaves County, New
 Mexico

Dear Ms. Edwards:

This office represents Yates Petroleum Corporation. On January 23, 1995, the above-referenced Application was filed by Yates Petroleum Corporation to produce its Rose Cannon AOR Com #1 Well in the Abo formation underlying Section 17, Township 10 South, Range 25 East, N.M.P.M., Chaves County, New Mexico. A copy of the Application is provided herewith for your information.

Yates has requested a hearing date of March 2, 1995. Be advised that any party wishing to appear must file a prehearing statement by the Friday prior to the date of hearing, and any party wishing to receive other parties' prehearing statements or pleadings must file an entry of appearance. If you do not intend to protest said Application, enclosed you will find a waiver whereby you can make that decision known, along with a return envelope.

If you have any questions, do not hesitate to contact me at the letterhead address.

Very truly yours,

LOSEE, CARSON, HAAS & CARROLL, P.A.

Ernest L. Carroll

Z 061 312 828

**Receipt for
 Certified Mail**

No Insurance Coverage Provided
 Do not use for International Mail
 (See Reverse)

Sent to <i>Sue Ann Rose</i>	
Street and No. <i>Edwards</i>	
City, State and ZIP Code	
Postage	\$
Certified Fee	
Special Delivery Fee	
Restricted Delivery Fee	
Return Receipt Showing to Whom & Date Delivered	
Return Receipt Showing to Whom Date and Addressee's Address	

March 1993

LAW OFFICES

LOSEE, CARSON, HAAS & CARROLL, P. A.

MARY LYNN BOGLE
 ERNEST L. CARROLL
 JOEL M. CARSON
 DEAN B. CROSS
 JAMES E. HAAS
 A. J. LOSEE
 BARRY D. GEWEKE

300 YATES PETROLEUM BUILDING
 P. O. BOX 1720
 ARTESIA, NEW MEXICO 88211-1720

TELEPHONE
 (505) 746-3505
 TELECOPY
 (505) 746-6316

January 24, 1995

CERTIFIED MAIL
RETURN RECEIPT REQUESTED

Ms. Julia Rose Heald
 3301 Elm Street
 Dallas, TX 75226

Re: Application of Yates Petroleum Corporation
 for Compulsory Pooling, Chaves County, New
 Mexico

Dear Ms. Heald:

This office represents Yates Petroleum Corporation. On January 23, 1995, the above-referenced Application was filed by Yates Petroleum Corporation to produce its Rose Cannon AOR Com #1 Well in the Abo formation underlying Section 17, Township 10 South, Range 25 East, N.M.P.M., Chaves County, New Mexico. A copy of the Application is provided herewith for your information.

Yates has requested a hearing date of March 2, 1995. Be advised that any party wishing to appear must file a prehearing statement by the Friday prior to the date of hearing, and any party wishing to receive other parties' prehearing statements or pleadings must file an entry of appearance. If you do not intend to protest said Application, enclosed you will find a waiver whereby you can make that decision known, along with a return envelope.

If you have any questions, do not hesitate to contact me at the letterhead address.

Very truly yours,

LOSEE, CARSON, HAAS & CARROLL, P.A.

Ernest L. Carroll
 Ernest L. Carroll

Z 061 312 800

**Receipt for
 Certified Mail**

No Insurance Coverage Provided
 Do not use for International Mail
 (See Reverse)

Sent to <i>Julia Rose Heald</i>	
Street and to	
P.O., State and ZIP Code	
Postage	\$
Certified Fee	
Special Delivery Fee	
Restricted Delivery Fee	
Return Receipt Showing to Whom & Date Delivered	
Return Receipt Showing to Whom, Date, and Addressee's Address	
TOTAL Postage & Fees	\$
Postmark or Date <i>1/24/95</i>	

Is your RETURN ADDRESS completed on the reverse side?

SENDER:

- Complete items 1 and/or 2 for additional services.
- Complete items 3, and 4a & b.
- Print your name and address on the reverse of this form so that we can return this card to you.
- Attach this form to the front of the mailpiece, or on the back if space does not permit.
- Write "Return Receipt Requested" on the mailpiece below the article number.
- The Return Receipt will show to whom the article was delivered and the date delivered.

3. Article Addressed to:

*Ms. Julia Rose Heald
 3301 Elm Street
 Dallas, TX 75226*

5. Signature (Addressee)

Jaye Smith

6. Signature (Agent)

I also wish to receive the following services (for an extra fee):

- ☐ Addressee's Address
- ☐ Restricted Delivery

Consult postmaster for fee.

4a. Article Number

Z 061 312 800

4b. Service Type

- | | |
|---|---|
| <input type="checkbox"/> Registered | <input type="checkbox"/> Insured |
| <input checked="" type="checkbox"/> Certified | <input type="checkbox"/> COD |
| <input type="checkbox"/> Express Mail | <input type="checkbox"/> Return Receipt for Merchandise |

7. Date of Delivery

8. Addressee's Address (Only if requested and fee is paid)

Thank you for using Return Receipt Service.

LOSEE, CARSON,
HAAS & CARROLL, P.A.

300 AMERICAN HOME BUILDING

P. O. DRAWER 239

ARTESIA, NEW MEXICO 88211-0239

KTH

STICK POST
CERTIFIED MAIL FEE

If you do not want
leaving the receipt and
your receipt number (no

2. If you do not want
address of the office.

RECEIVED
DATE

RECEIVED
DATE

RECEIVED
DATE

6. Save this receipt and

LAW OFFICES

LOSEE, CARSON, HAAS & CARROLL, P. A.

MARY LYNN BOGLE
ERNEST L. CARROLL
JOEL M. CARSON
DEAN B. CROSS
JAMES E. HAAS
A. J. LOSEE
BARRY D. GEWEKE

300 YATES PETROLEUM BUILDING
P. O. BOX 1720
ARTESIA, NEW MEXICO 88211-1720

TELEPHONE
(505) 746-3505
TELECOPY
(505) 746-6316

January 24, 1995

CERTIFIED MAIL
RETURN RECEIPT REQUESTED

Ms. Pam Rose Ridge
1006 Birchwood Lane
Mansfield, TX 76063

Re: Application of Yates Petroleum Corporation
for Compulsory Pooling, Chaves County, New
Mexico

Dear Ms. Ridge:

This office represents Yates Petroleum Corporation. On January 23, 1995, the above-referenced Application was filed by Yates Petroleum Corporation to produce its Rose Cannon AOR Com #1 Well in the Abo formation underlying Section 17, Township 10 South, Range 25 East, N.M.P.M., Chaves County, New Mexico. A copy of the Application is provided herewith for your information.

Yates has requested a hearing date of March 2, 1995. Be advised that any party wishing to appear must file a prehearing statement by the Friday prior to the date of hearing, and any party wishing to receive other parties' prehearing statements or pleadings must file an entry of appearance. If you do not intend to protest said Application, enclosed you will find a waiver whereby you can make that decision known, along with a return envelope.

If you have any questions, do not hesitate to contact me at the letterhead address.

Very truly yours,

LOSEE, CARSON, HAAS & CARROLL, P.A.

Ernest L. Carroll
Ernest L. Carroll

Z 061 312 802

**Receipt for
Certified Mail**

No Insurance Coverage Provided
Do not use for International Mail
(See Reverse)

Sent to: <i>Pam Rose Ridge</i>	
Street and Apt.	
P.O. State and ZIP Code	
Postage	\$
Certified Fee	
Special Delivery Fee	
Restricted Delivery Fee	
Return Receipt Showing to Whom & Date Delivered	
Return Receipt Showing to Whom, Date, and Addressee's Address	
TOTAL Postage & Fees	\$
Postmark or Date <i>1/24/95</i>	

Is your RETURN ADDRESS completed on the reverse side?

SENDER:

- Complete items 1 and/or 2 for additional services.
- Complete items 3, and 4a & b.
- Print your name and address on the reverse of this form so that we can return this card to you.
- Attach this form to the front of the mailpiece, or on the back if space does not permit.
- Write "Return Receipt Requested" on the mailpiece below the article number.
- The Return Receipt will show to whom the article was delivered and the date delivered.

3. Article Addressed to:

*Ms. Pam Rose Ridge
1006 Birchwood Lane
Mansfield, TX 76063*

5. Signature (Addressee)

6. Signature (Agent)

I also wish to receive the following services (for an extra fee):

- ☐ Addressee's Address
- ☐ Restricted Delivery

Consult postmaster for fee.

4a. Article Number

2061312802

4b. Service Type

- | | |
|---|---|
| <input type="checkbox"/> Registered | <input type="checkbox"/> Insured |
| <input checked="" type="checkbox"/> Certified | <input type="checkbox"/> COD |
| <input type="checkbox"/> Express Mail | <input type="checkbox"/> Return Receipt for Merchandise |

7. Date of Delivery

1-30-95

8. Addressee's Address (Only if requested and fee is paid)

LAW OFFICES
**LOSEE, CARSON,
HAAS & CARROLL, P.A.**

300 AMERICAN HOME BUILDING

P. O. DRAWER 239

ARTESIA, NEW MEXICO 88211-0239

KTH

STICK POSTAGE
CERTIFIED MAIL FEE

1. If you want this re-
ceiving the receipt and
your rural carrier, too.
2. If you want to want
address of the office.

3. If you want a return
address for the office.
4. If you want a return
address for the office.

5. If you want a return
address for the office.

6. If you want a return
address for the office.

7. If you want a return
address for the office.

LAW OFFICES

LOSEE, CARSON, HAAS & CARROLL, P. A.

MARY LYNN BOGLE
 ERNEST L. CARROLL
 JOEL M. CARSON
 DEAN B. CROSS
 JAMES E. HAAS
 A. J. LOSEE
 BARRY D. GEWEKE

300 YATES PETROLEUM BUILDING
 P. O. BOX 1720
 ARTESIA, NEW MEXICO 88211-1720

TELEPHONE
 (505) 746-3505

TELECOPY
 (505) 746-6316

January 24, 1995

CERTIFIED MAIL
RETURN RECEIPT REQUESTED

Enerag, Inc.
 P. O. Box 1054
 Garden City, KS 67846

Re: Application of Yates Petroleum Corporation
 for Compulsory Pooling, Chaves County, New
 Mexico

Gentlemen:

This office represents Yates Petroleum Corporation. On January 23, 1995, the above-referenced Application was filed by Yates Petroleum Corporation to produce its Rose Cannon AOR Com #1 Well in the Abo formation underlying Section 17, Township 10 South, Range 25 East, N.M.P.M., Chaves County, New Mexico. A copy of the Application is provided herewith for your information.

Yates has requested a hearing date of March 2, 1995. Be advised that any party wishing to appear must file a prehearing statement by the Friday prior to the date of hearing, and any party wishing to receive other parties' prehearing statements or pleadings must file an entry of appearance. If you do not intend to protest said Application, enclosed you will find a waiver whereby you can make that decision known, along with a return envelope.

If you have any questions, do not hesitate to contact me at the letterhead address.

Very truly yours,

LOSEE, CARSON, HAAS & CARROLL, P.A.

Ernest L. Carroll
 Ernest L. Carroll

7 061 312 803
**Receipt for
 Certified Mail**
 No Insurance Coverage Provided
 Do not use for International Mail
 (See Reverse)

Sent to <i>Enerag, Inc.</i>	
Street and No.	
P.O. State and ZIP Code	
Postage	\$
Certified Fee	
Special Delivery Fee	
Restricted Delivery Fee	
Return Receipt Showing to Whom & Date Delivered	
Return Receipt Showing to Whom, Date, and Addressee's Address	
TOTAL Postage & Fees	\$
Postmark or Date <i>1/24/95</i>	

SENDER:

- Complete items 1 and/or 2 for additional services.
- Complete items 3, and 4a & b.
- Print your name and address on the reverse of this form so that we can return this card to you.
- Attach this form to the front of the mailpiece, or on the back if space does not permit.
- Write "Return Receipt Requested" on the mailpiece below the article number.
- The Return Receipt will show to whom the article was delivered and the date delivered.

3. Article Addressed to:

Enerag, Inc.
P.O. Box 1054
Garden City, KS 67846
Carol Ann

5. Signature (Addressee)

CA No 1 HAM

6. Signature (Agent)

I also wish to receive the following services (for an extra fee):

- ☐ Addressee's Address
 - ☐ Restricted Delivery
- Consult postmaster for fee.

4a. Article Number

2 061 312 803

4b. Service Type

- | | |
|---|---|
| <input type="checkbox"/> Registered | <input type="checkbox"/> Insured |
| <input checked="" type="checkbox"/> Certified | <input type="checkbox"/> COD |
| <input type="checkbox"/> Express Mail | <input type="checkbox"/> Return Receipt for Merchandise |

7. Date of Delivery

1/31/95

8. Addressee's Address (Only if requested and fee is paid)

LOSEE, CARSON,
HAAS & CARROLL, P.A.

P. O. DRAWER 239

K571

1000

LAW OFFICES

LOSEE, CARSON, HAAS & CARROLL, P. A.

MARY LYNN BOGLE
 ERNEST L. CARROLL
 JOEL M. CARSON
 DEAN B. CROSS
 JAMES E. HAAS
 A. J. LOSEE
 BARRY D. GEWEKE

300 YATES PETROLEUM BUILDING
 P. O. BOX 1720
 ARTESIA, NEW MEXICO 88211-1720

TELEPHONE
 (505) 746-3505
 TELECOPY
 (505) 746-6316

February 3, 1995

CERTIFIED MAIL
RETURN RECEIPT REQUESTED

Sanders Oil & Gas Company
 P. O. Box 797005
 Dallas, TX 75379

Re: Application of Yates Petroleum Corporation
 for Compulsory Pooling, Chaves County, New
 Mexico

Gentlemen:

This office represents Yates Petroleum Corporation. On January 23, 1995, the above-referenced Application was filed by Yates Petroleum Corporation to produce its Rose Cannon AOR Com #1 Well in the Abo formation underlying Section 17, Township 10 South, Range 25 East, N.M.P.M., Chaves County, New Mexico. A copy of the Application is provided herewith for your information.

Yates has requested a hearing date of March 2, 1995. Be advised that any party wishing to appear must file a prehearing statement by the Friday prior to the date of hearing, and any party wishing to receive other parties' prehearing statements or pleadings must file an entry of appearance. If you do not intend to protest said Application, enclosed you will find a waiver whereby you can make that decision known, along with a return envelope.

If you have any questions, do not hesitate to contact me at the letterhead address.

Very truly yours,

LOSEE, CARSON, HAAS & CARROLL, P.A.

Ernest L. Carroll
 Ernest L. Carroll

Z 061 312 830

**Receipt for
 Certified Mail**

No Insurance Coverage Provided
 Do not use for International Mail
 (See Reverse)

Sent to <i>Sanders Oil & Gas</i>	
Street and No.	
P.O., State and ZIP Code	
Postage	\$
Certified Fee	
Special Delivery Fee	
Restricted Delivery Fee	
Return Receipt Showing to Whom & Date Delivered	
Return Receipt Showing to Whom, Date, and Addressee's Address	
TOTAL Postage & Fees	\$
Postmark or Date <i>02/03/95</i>	

your RETURN ADDRESS completed on the reverse side?

SENDER:

- Complete items 1 and/or 2 for additional services.
- Complete items 3, and 4a & b.
- Print your name and address on the reverse of this form so that we can return this card to you.
- Attach this form to the front of the mailpiece, or on the back if space does not permit.
- Write "Return Receipt Requested" on the mailpiece below the article number.
- The Return Receipt will show to whom the article was delivered and the date delivered.

3. Article Addressed to:

Sanders Oil & Gas
P.O. Box 797005
Dallas, TX 75379

5. Signature (Addressee)

Ruth Coulter
 6. Signature (Agent)

I also wish to receive the following services (for an extra fee):

1. ☐ Addressee's Address
 2. ☐ Restricted Delivery
 Consult postmaster for fee.

4a. Article Number

2061312830

4b. Service Type

- ☐ Registered ☐ Insured
☒ Certified ☐ COD
☐ Express Mail ☐ Return Receipt for Merchandise

7. Date of Delivery

02/03/95
 8. Addressee's Address (Only if requested and fee is paid)

Thank you for using Return Receipt Service.

PS Form 3800, March 1993

LOSEE, CARSON,
HAAS & CARROLL, P.A.

300 AMERICAN HOME BUILDING

P. O. DRAWER 239

ARTESIA, NEW MEXICO 88211-0239

KTH

STICK
CERTIFIED MAIL
leaving the office
your rural carrier
2 If you do not
address for the a
3
4
5
6
7
8
9
10
11
12
13
14
15
16
17
18
19
20
21
22
23
24
25
26
27
28
29
30
31
32
33
34
35
36
37
38
39
40
41
42
43
44
45
46
47
48
49
50
51
52
53
54
55
56
57
58
59
60
61
62
63
64
65
66
67
68
69
70
71
72
73
74
75
76
77
78
79
80
81
82
83
84
85
86
87
88
89
90
91
92
93
94
95
96
97
98
99
100
101
102
103
104
105
106
107
108
109
110
111
112
113
114
115
116
117
118
119
120
121
122
123
124
125
126
127
128
129
130
131
132
133
134
135
136
137
138
139
140
141
142
143
144
145
146
147
148
149
150
151
152
153
154
155
156
157
158
159
160
161
162
163
164
165
166
167
168
169
170
171
172
173
174
175
176
177
178
179
180
181
182
183
184
185
186
187
188
189
190
191
192
193
194
195
196
197
198
199
200
201
202
203
204
205
206
207
208
209
210
211
212
213
214
215
216
217
218
219
220
221
222
223
224
225
226
227
228
229
230
231
232
233
234
235
236
237
238
239
240
241
242
243
244
245
246
247
248
249
250
251
252
253
254
255
256
257
258
259
260
261
262
263
264
265
266
267
268
269
270
271
272
273
274
275
276
277
278
279
280
281
282
283
284
285
286
287
288
289
290
291
292
293
294
295
296
297
298
299
300
301
302
303
304
305
306
307
308
309
310
311
312
313
314
315
316
317
318
319
320
321
322
323
324
325
326
327
328
329
330
331
332
333
334
335
336
337
338
339
340
341
342
343
344
345
346
347
348
349
350
351
352
353
354
355
356
357
358
359
360
361
362
363
364
365
366
367
368
369
370
371
372
373
374
375
376
377
378
379
380
381
382
383
384
385
386
387
388
389
390
391
392
393
394
395
396
397
398
399
400
401
402
403
404
405
406
407
408
409
410
411
412
413
414
415
416
417
418
419
420
421
422
423
424
425
426
427
428
429
430
431
432
433
434
435
436
437
438
439
440
441
442
443
444
445
446
447
448
449
450
451
452
453
454
455
456
457
458
459
460
461
462
463
464
465
466
467
468
469
470
471
472
473
474
475
476
477
478
479
480
481
482
483
484
485
486
487
488
489
490
491
492
493
494
495
496
497
498
499
500
501
502
503
504
505
506
507
508
509
510
511
512
513
514
515
516
517
518
519
520
521
522
523
524
525
526
527
528
529
530
531
532
533
534
535
536
537
538
539
540
541
542
543
544
545
546
547
548
549
550
551
552
553
554
555
556
557
558
559
560
561
562
563
564
565
566
567
568
569
570
571
572
573
574
575
576
577
578
579
580
581
582
583
584
585
586
587
588
589
590
591
592
593
594
595
596
597
598
599
600
601
602
603
604
605
606
607
608
609
610
611
612
613
614
615
616
617
618
619
620
621
622
623
624
625
626
627
628
629
630
631
632
633
634
635
636
637
638
639
640
641
642
643
644
645
646
647
648
649
650
651
652
653
654
655
656
657
658
659
660
661
662
663
664
665
666
667
668
669
670
671
672
673
674
675
676
677
678
679
680
681
682
683
684
685
686
687
688
689
690
691
692
693
694
695
696
697
698
699
700
701
702
703
704
705
706
707
708
709
710
711
712
713
714
715
716
717
718
719
720
721
722
723
724
725
726
727
728
729
730
731
732
733
734
735
736
737
738
739
740
741
742
743
744
745
746
747
748
749
750
751
752
753
754
755
756
757
758
759
760
761
762
763
764
765
766
767
768
769
770
771
772
773
774
775
776
777
778
779
780
781
782
783
784
785
786
787
788
789
790
791
792
793
794
795
796
797
798
799
800
801
802
803
804
805
806
807
808
809
810
811
812
813
814
815
816
817
818
819
820
821
822
823
824
825
826
827
828
829
830
831
832
833
834
835
836
837
838
839
840
841
842
843
844
845
846
847
848
849
850
851
852
853
854
855
856
857
858
859
860
861
862
863
864
865
866
867
868
869
870
871
872
873
874
875
876
877
878
879
880
881
882
883
884
885
886
887
888
889
890
891
892
893
894
895
896
897
898
899
900
901
902
903
904
905
906
907
908
909
910
911
912
913
914
915
916
917
918
919
920
921
922
923
924
925
926
927
928
929
930
931
932
933
934
935
936
937
938
939
940
941
942
943
944
945
946
947
948
949
950
951
952
953
954
955
956
957
958
959
960
961
962
963
964
965
966
967
968
969
970
971
972
973
974
975
976
977
978
979
980
981
982
983
984
985
986
987
988
989
990
991
992
993
994
995
996
997
998
999
1000
1001
1002
1003
1004
1005
1006
1007
1008
1009
1010
1011
1012
1013
1014
1015
1016
1017
1018
1019
1020
1021
1022
1023
1024
1025
1026
1027
1028
1029
1030
1031
1032
1033
1034
1035
1036
1037
1038
1039
1040
1041
1042
1043
1044
1045
1046
1047
1048
1049
1050
1051
1052
1053
1054
1055
1056
1057
1058
1059
1060
1061
1062
1063
1064
1065
1066
1067
1068
1069
1070
1071
1072
1073
1074
1075
1076
1077
1078
1079
1080
1081
1082
1083
1084
1085
1086
1087
1088
1089
1090
1091
1092
1093
1094
1095
1096
1097
1098
1099
1100
1101
1102
1103
1104
1105
1106
1107
1108
1109
1110
1111
1112
1113
1114
1115
1116
1117
1118
1119
1120
1121
1122
1123
1124
1125
1126
1127
1128
1129
1130
1131
1132
1133
1134
1135
1136
1137
1138
1139
1140
1141
1142
1143
1144
1145
1146
1147
1148
1149
1150
1151
1152
1153
1154
1155
1156
1157
1158
1159
1160
1161
1162
1163
1164
1165
1166
1167
1168
1169
1170
1171
1172
1173
1174
1175
1176
1177
1178
1179
1180
1181
1182
1183
1184
1185
1186
1187
1188
1189
1190
1191
1192
1193
1194
1195
1196
1197
1198
1199
1200
1201
1202
1203
1204
1205
1206
1207
1208
1209
1210
1211
1212
1213
1214
1215
1216
1217
1218
1219
1220
1221
1222
1223
1224
1225
1226
1227
1228
1229
1230
1231
1232
1233
1234
1235
1236
1237
1238
1239
1240
1241
1242
1243
1244
1245
1246
1247
1248
1249
1250
1251
1252
1253
1254
1255
1256
1257
1258
1259
1260
1261
1262
1263
1264
1265
1266
1267
1268
1269
1270
1271
1272
1273
1274
1275
1276
1277
1278
1279
1280
1281
1282
1283
1284
1285
1286
1287
1288
1289
1290
1291
1292
1293
1294
1295
1296
1297
1298
1299
1300
1301
1302
1303
1304
1305
1306
1307
1308
1309
1310
1311
1312
1313
1314
1315
1316
1317
1318
1319
1320
1321
1322
1323
1324
1325
1326
1327
1328
1329
1330
1331
1332
1333
1334
1335
1336
1337
1338
1339
1340
1341
1342
1343
1344
1345
1346
1347
1348
1349
1350
1351
1352
1353
1354
1355
1356
1357
1358
1359
1360
1361
1362
1363
1364
1365
1366
1367
1368
1369
1370
1371
1372
1373
1374
1375
1376
1377
1378
1379
1380
1381
1382
1383
1384
1385
1386
1387
1388
1389
1390
1391
1392
1393
1394
1395
1396
1397
1398
1399
1400
1401
1402
1403
1404
1405
1406
1407
1408
1409
1410
1411
1412
1413
1414
1415
1416
1417
1418
1419
1420
1421
1422
1423
1424
1425
1426
1427
1428
1429
1430
1431
1432
1433
1434
1435
1436
1437
1438
1439
1440
1441
1442
1443
1444
1445
1446
1447
1448
1449
1450
1451
1452
1453
1454
1455
1456
1457
1458
1459
1460
1461
1462
1463
1464
1465
1466
1467
1468
1469
1470
1471
1472
1473
1474
1475
1476
1477
1478
1479
1480
1481
1482
1483
1484
1485
1486
1487
1488
1489
1490
1491
1492
1493
1494
1495
1496
1497
1498
1499
1500
1501
1502
1503
1504
1505
1506
1507
1508
1509
1510
1511
1512
1513
1514
1515
1516
1517
1518
1519
1520
1521
1522
1523
1524
1525
1526
1527
1528
1529
1530
1531
1532
1533
1534
1535
1536
1537
1538
1539
1540
1541
1542
1543
1544
1545
1546
1547
1548
1549
1550
1551
1552
1553
1554
1555
1556
1557
1558
1559
1560
1561
1562
1563
1564
1565
1566
1567
1568
1569
1570
1571
1572
1573
1574
1575
1576
1577
1578
1579
1580
1581
1582
1583
1584
1585
1586
1587
1588
1589
1590
1591
1592
1593
1594
1595
1596
1597
1598
1599
1600
1601
1602
1603
1604
1605
1606
1607
1608
1609
1610
1611
1612
1613
1614
1615
1616
1617
1618
1619
1620
1621
1622
1623
1624
1625
1626
1627
1628
1629
1630
1631
1632
1633
1634
1635
1636
1637
1638
1639
1640
1641
1642
1643
1644
1645
1646
1647
1648
1649
1650
1651
1652
1653
1654
1655
1656
1657
1658
1659
1660
1661
1662
1663
1664
1665
1666
1667
1668
1669
1670
1671
1672
1673
1674
1675
1676
1677
1678
1679
1680
1681
1682
1683
1684
1685
1686
1687
1688
1689
1690
1691
1692
1693
1694
1695
1696
1697
1698
1699
1700
1701
1702
1703
1704
1705
1706
1707
1708
1709
1710
1711
1712
1713
1714
1715
1716
1717
1718
1719
1720
1721
1722
1723
1724
1725
1726
1727
1728
1729
1730
1731
1732
1733
1734
1735
1736
1737
1738
1739
1740
1741
1742
1743
1744
1745
1746
1747
1748
1749
1750
1751
1752
1753
1754
1755
1756
1757
1758
1759
1760
1761
1762
1763
1764
1765
1766
1767
1768
1769
1770
1771
1772
1773
1774
1775
1776
1777
1778
1779
1780
1781
1782
1783
1784
1785
1786
1787
1788
1789
1790
1791
1792
1793
1794
1795
1796
1797
1798
1799
1800
1801
1802
1803
1804
1805
1806
1807
1808
1809
1810
1811
1812
1813
1814
1815
1816
1817
1818
1819
1820
1821
1822
1823
1824
1825
1826
1827
1828
1829
1830
1831
1832
1833
1834
1835
1836
1837
1838
1839
1840
1841
1842
1843
1844
1845
1846
1847
1848
1849
1850
1851
1852
1853
1854
1855
1856
1857
1858
1859
1860
1861
1862
1863
1864
1865
1866
1867
1868
1869
1870
1871
1872
1873
1874
1875
1876
1877
1878
1879
1880
1881
1882
1883
1884
1885
1886
1887
1888
1889
1890
1891
1892
1893
1894
1895
1896
1897
1898
1899
1900
1901
1902
1903
1904
1905
1906
1907
1908
1909
1910
1911
1912
1913
1914
1915
1916
1917
1918
1919
1920
1921
1922
1923
1924
1925
1926
1927
1928
1929
1930
1931
1932
1933
1934
1935
1936
1937
1938
1939
1940
1941
1942
1943
1944
1945
1946
1947
1948
1949
1950
1951
1952
1953
1954
1955
1956
1957
1958
1959
1960
1961
1962
1963
1964
1965
1966
1967
1968
1969
1970
1971
1972
1973
1974
1975
1976
1977
1978
1979
1980
1981
1982
1983
1984
1985
1986
1987
1988
1989
1990
1991
1992
1993
1994
1995
1996
1997
1998
1999
2000
2001
2002
2003
2004
2005
2006
2007
2008
2009
2010
2011
2012
2013
2014
2015
2016
2017
2018
2019
2020
2021
2022
2023
2024
2025
2026
2027
2028
2029
2030
2031
2032
2033
2034
2035
2036
2037
2038
2039
2040
2041
2042
2043
2044
2045
2046
2047
2048
2049
2050
2051
2052
2053
2054
2055
2056
2057
2058
2059
2060
2061
2062
2063
2064
2065
2066
2067
2068
2069
2070
2071
2072
2073
2074
2075
2076
2077
2078
2079
2080
2081
2082
2083
2084
2085
2086
2087
2088
2089
2090
2091
2092
2093
2094
2095
2096
2097
2098
2099
2100
2101
2102
2103
2104
2105
2106
2107
2108
2109
2110
2111
2112
2113
2114
2115
2116
2117
2118
2119
2120
2121
2122
2123
2124
2125
2126
2127
2128
2129
2130
2131
2132
2133
2134
2135
2136
2137
2138
2139
2140
2141
2142
2143
2144
2145
2146
2147
2148
2149
2150
2151
2152
2153
2154
2155
2156
2157
2158
2159
2160
2161
2162
2163
2164
2165
2166
2167
2168
2169
2170
2171
2172
2173
2174
2175
2176
2177
2178
2179
2180
2181
2182
2183
2184
2185
2186
2187
2188
2189
2190
2191
2192
2193
2194
2195
2196
2197
2198
2199
2200
2201
2202
22

South Pecos Slope Abo -- Wells in Township 10S-25E

Item	Well Name	FN/S	FE/W	Ut	Sec	Twn	Rng	Operator	Spud Date	TD	Comp Date	Perfs	IP, Mcf/D	ID Date	Cum MMcf
1	McCrea Fee 2	235N	1695E	B	1	10S	25E	McClellan	4/20/87	4570	5/20/87	4130-4361	564	Aug-87	115
2	McCrea Fee 1	330N	2310W	C	1	10S	25E	McClellan	11/12/81	4490	12/16/81	4240-4351	873	Feb-82	431
3	JJ Federal 1	1980S	660E	I	1	10S	25E	McClellan	4/23/79	4510	5/22/79	4448-4456	1026	Feb-80	107
4	JJ Fed Com 2	1855S	1650W	K	1	10S	25E	McClellan	3/31/89	4560	5/9/89	4291-4307	2594	Jan-90	354
5	Erickson KY St 2	660N	660E	A	2	10S	25E	Yates	12/20/87	4500	3/24/88	4091-4374	577	Mar-88	103
6	Erickson KY State 1	1980N	660E	H	2	10S	25E	Yates	6/22/79	4775	11/10/79	4238-4258	175	Mar-80	167
7	Adell UJ Fed 1	660N	660E	A	7	10S	25E	Yates	6/30/82	4150	9/9/82	3658-3849	613	Oct-90	147
8	Mountain VR Fed 2	1980N	1980W	F	8	10S	25E	Yates	2/6/83	4100	3/7/83	3560-3764	343	Oct-90	92
9	Hargrove AFH 1	1980N	625E	H	8	10S	25E	Yates	1/4/89	4300	1/22/89	3811-3845	3275	Oct-90	368
10	Mountain VR Fed 3	1980S	1980W	K	8	10S	25E	Yates	4/3/83	4150	4/21/83	3758-3774	522	Oct-90	122
11	Mountain VR Fed 1	660S	1650E	O	8	10S	25E	Yates	11/6/82	4350	11/29/92	3792-3809	4245	Oct-90	529
12	Penjack Fed 3	1980N	660E	H	12	10S	25E	McClellan	7/29/87	4680	11/9/87	4362-4377	1181	Sep-87	525
13	Penjack Fed 2	660S	1980E	O	12	10S	25E	McClellan	3/31/87	4710	4/28/87	4381-4421	1218	Oct-87	232
14	Tyrell Fed Com 1	660N	1980W	C	13	10S	25E	McClellan	11/28/82	4700	2/25/83	4231-4411	598	Apr-84	119
15	Tyrell Fed Com 2	1980N	1980E	G	13	10S	25E	McClellan	11/29/84	4690	1/3/85	4257-4377	1168	Feb-85	125
16	Lisa Fed 1	1980S	660W	L	13	10S	25E	McClellan	4/29/84	4549	6/12/84	4047-4443	382	Sep-87	173
17	Nellie T. Lewis 1	660S	1980W	N	13	10S	25E	DeKalb	6/8/46	5650	12/13/46		D & A		
18	Bitter Lake PX St 2	1980N	660W	E	16	10S	25E	Yates	2/18/83	4150	3/8/83	3836-3848	2023	Nov-90	353
19	Bitter Lake PX St 1	660S	660W	M	16	10S	25E	Yates	9/1/82	4500	9/18/82	3841-3855	1800	Nov-90	96
20	Eakin AFB Com 1	330N	2100W	C	17	10S	25E	Yates	4/24/88	4200	6/23/88	3786-3792	775	Oct-90	54
21	Cannon XF 1	1650N	660E	H	17	10S	25E	Yates	12/20/92	4250	1/18/93	3600-3916	1100	Jun-93	143
22	Cannon Bitterlake 1	1980S	660E	I	17	10S	25E	Sanders	4/4/83	4300	1/15/85	3810-3894	2000	Jan-95	2
23	Cannon A Com 1	1980S	660E	I	18	10S	25E	Sanders	4/22/83	4200	5/8/84	3852-3856	10	SIWOPLC	
24	Unruh AFF Fed Com 1	660N	1530E	B	20	10S	25E	Yates	5/21/94	4400	6/28/94	3802-3902	1900	Jun-94	68
25	Suzanne Fed 1	990N	660E	A	23	10S	25E	McClellan	4/20/83	4588	6/28/83	4181-4346	698	Apr-84	59
26	Luke Fed Com 1	1980N	1800W	F	24	10S	25e	McClellan	3/19/82	4630	4/28/82	4244-4274	1237	Sep-87	18
27	Comanche ZU Fed 1	660S	1980W	N	25	10S	25E	Yates	6/29/84	4700	9/6/84	4248-4414	724	Sep-89	173
28	Comanche PQ Fed 2Y	990N	960W	D	26	10S	25E	John Yates Jr	12/18/85	5258	10/13/86	4347-4358	160	SIWOPLC	
29	Rolling Hills YO Fed 1	1450N	660W	E	26	10S	25E	Yates	2/15/84	4600	2/28/84		D & A		
30	Cannon 2	1780S	660W	L	27	10S	25E	Sanders	10/15/85	4336	8/28/86		D & A		
31	Cannon 1Y	680S	1650W	N	27	10S	25E	Sanders	12/26/82	4386	1/27/87	3732-4066	D & A		
32	Mary K 1	660N	775W	D	29	10S	25E	Pedco	1/18/85	4168	4/14/85	3551-3886	200	SIWOPLC	
33	Roswell 1	2140S	2310E	J	29	10S	25E	Sanders	10/26/85	4198	1/15/87	3170-3285	TA		
34	Comanche Hill VE St 1	660N	1980E	B	36	10S	25E	Yates	9/22/82	4750	10/22/82	4412-4447	724	Sep-89	136
													Average Cum Prod =		142

YATES PETROLEUM CORP.
BEFORE EXAMINER CATANACH
NMOCD CASE NO. 11210
DATE: 03/02/95
EXHIBIT NO. 8

2/28/95

dave\excel\RoseCann.xls

Rose Cannon AOR Com 1

Section 17-10S-25E

Chaves County, New Mexico

Date	Choke Size	Tubing Psi	Mcf of Gas
30-Jan	17/64	620	802
31-Jan	17/64	600	866
1-Feb	17/64	595	860
2-Feb	17/64	590	848
3-Feb	17/64	580	841
4-Feb	17/64	575	835
5-Feb	17/64	575	835
6-Feb	17/64	575	911
7-Feb	12/64	750	185
8-Feb	14/64	660	612
9-Feb	13/64	650	586
10-Feb	13/64	680	557
11-Feb	13/64	670	567
12-Feb	13/64	670	567
13-Feb	13/64	670	566
14-Feb	13/64	665	567
15-Feb	13/64	660	557
16-Feb	12/64	780	234
17-Feb	12/64	750	346
18-Feb	Shutin		
19-Feb			
20-Feb			
21-Feb			
22-Feb			
23-Feb			
24-Feb			
25-Feb			
26-Feb			
27-Feb			
28-Feb			
			12142

YATES PETROLEUM CORP.
 BEFORE EXAMINER CATANACH
 NMOCD CASE NO. 11210
 DATE: 03/02/95
 EXHIBIT NO. q

2/28/95

dave\excel\rosecann.xls

YATES PETROLEUM CORP.
BEFORE EXAMINER CATANACH
NMOCD CASE NO. 11210
DATE: 03/02/95
EXHIBIT NO. 10

BITTER LAKES WILDLIFE

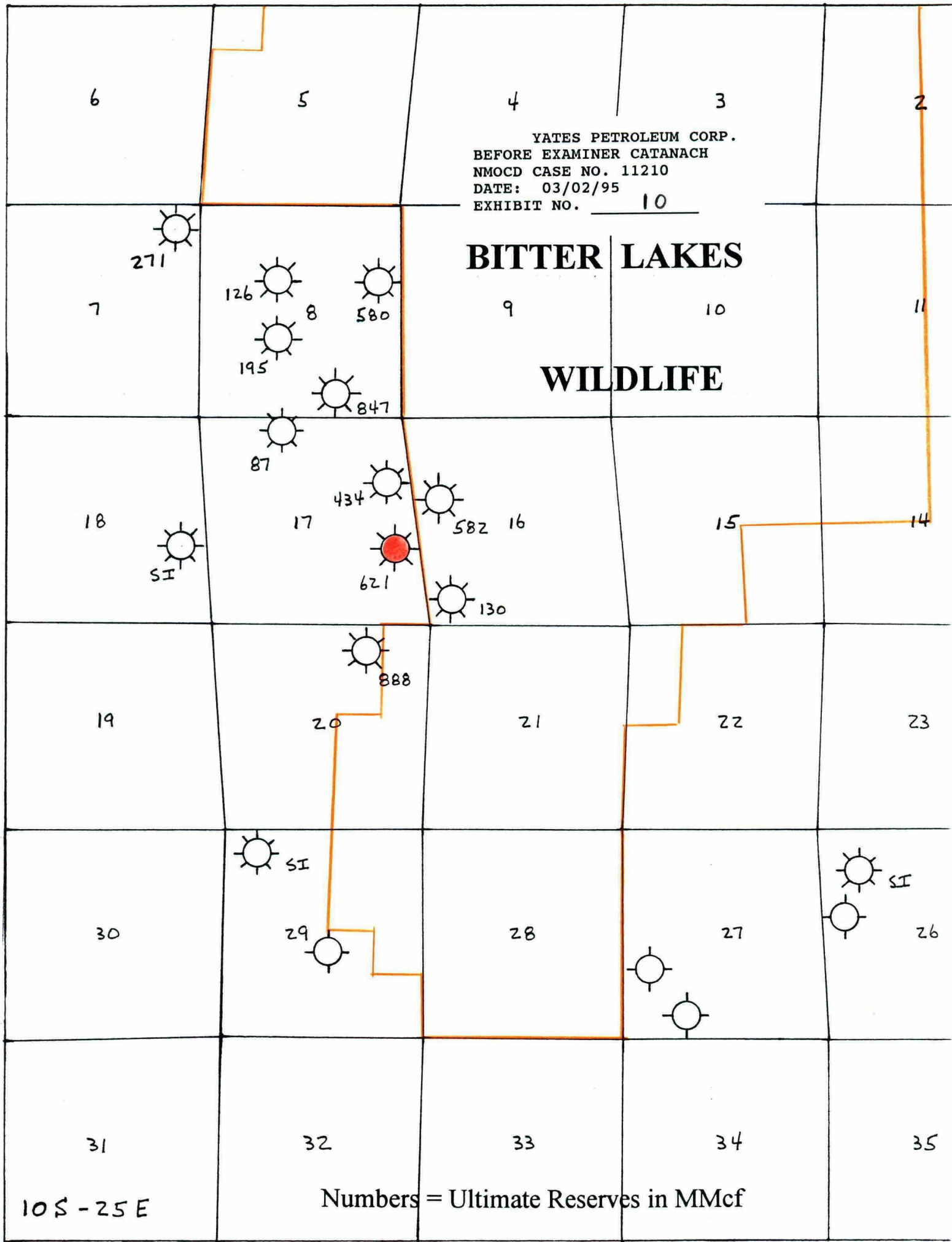

Comparison of Bitter Lake PX #1 and Rose Cannon AOR #1

	<u>Bitter Lake PX #1</u>	<u>Rose Cannon AOR #1</u>
Initial Potential	1800 Mcf/D	2000 Mcf/D
Zone 1 Log	20 feet of 13%	19 feet of 13%
Zone 2 Log	No Pay	9 feet of 9%
Zone 3 Log	4 feet of 13%	6 feet of 10%
Approximate ϕ h	3.12	3.88
Highest Monthly Prod	11,626 Mcf (Dec 90)	10,474 (Feb 95)
Estimated Ultimate Reserves	130 MMcf	621 MMcf

Date: 02/24/95
Time: 16:12:58

PRODUCTION HISTORY

File: A.DSF
Get#:

YATES PETROLEUM CORP.
BEFORE EXAMINER CATANACH
NMOCD CASE NO. 11210
DATE: 03/02/95
EXHIBIT NO. 11 P2

BITTER LAKE PX STATE #1 YPC
F= 673 PECOS SLOPE
P= 10 ABO
M 16-10S-25E CHAVES NM
YPC OPERATED
CASE: 01200-001

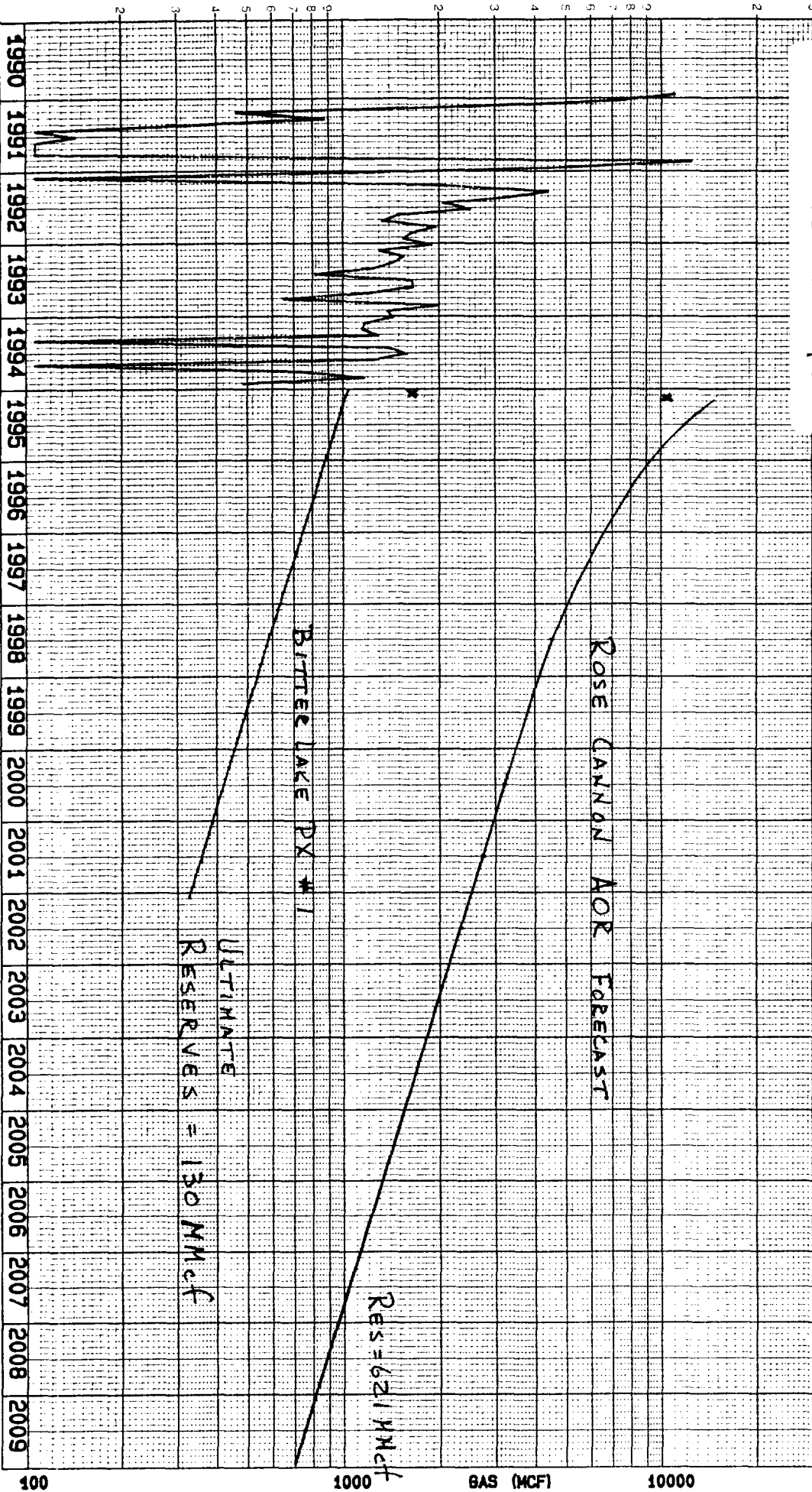

CUMULATIVE OIL (BBL) -

DPC & A

YEARS

SL 20 3 3

CUMULATIVE GAS (MCF) - 65963.

Bitter Lake PX State 1

3800

R₃=0.04

S₃
R₄

4.2
8.2
15.8
13.4
12.3
4.2

3900

9/82

PERF 3841 - 3855 w/ 10 1/2" hole

FRAC 3841 - PASS w/ 1000 gal
7 1/2" acid, 24,000 gal + 5000 # 20

min 1300 Max 1900

Avg 1400 @ 30 BPM

ISDP 550

FSIP 400 in 5 min

FLOWED 1,800 MCF/D

275 # x 1/2"

SLWOPLC

12/82 BHP 1130 psia

8/83 BHP 1136 psia

11/90 tied-in &
first production

YATES PETROLEUM CORP.
 BEFORE EXAMINER CATANACH
 NMOCD CASE NO. 11210
 DATE: 03/02/95
 EXHIBIT NO. 11 p 4

Rose Cannon AOR Com 1

