

Sub No. 21, 1995, 11:35AM
to Appropriate
District Office

UNCOAL ROCKY MOUNTAIN NEW MEXICO
Natural Resources Department

No. 0343 P. 4/8 C-103
1-1-99

DISTRICT I
P.O. Box 1980, Hobbs, NM 88240

DISTRICT II
P.O. Drawer 00, Artesia, NM 88210

DISTRICT III
1000 Rio Brazos Rd., Aztec, NM 87410

OIL CONSERVATION DIVISION
P.O. Box 2088
Santa Fe, New Mexico 87504-2088

WELL API NO. 30-039-25368
5. Indicate Type of Lease STATE <input type="checkbox"/> FEE <input type="checkbox"/>
6. State Oil & Gas Lease No.

SUNDRY NOTICES AND REPORTS ON WELLS
(DO NOT USE THIS FORM FOR PROPOSALS TO DRILL OR TO DEEPEN OR PLUG BACK TO A DIFFERENT RESERVOIR. USE "APPLICATION FOR PERMIT" (FORM C-101) FOR SUCH PROPOSALS.)

1. Type of Well:
OIL WELL ☐ GAS WELL ☒ OTHER

2. Name of Operator
UNION OIL COMPANY OF CALIFORNIA

3. Address of Operator
P.O. Box 2620, Casper, WY 82602 (307) 234-1563 Ext. 116

4. Well Location
Unit Letter E : 1985 Feet From The North Line and 822 Feet From The West Line

Section 36 Township 27N Range 7W NMPM Rio Arriba County

10. Elevation (Show whether DF, RKB, RT, GR, etc.)

7. Lease Name or Unit Agreement Name
RINCON UNIT

8. Well No.
131E

9. Pool name or Wildcat
Basin Dak/Blanco MV/So. Blanco

11. Check Appropriate Box to Indicate Nature of Notice, Report, or Other Data

NOTICE OF INTENTION TO:		SUBSEQUENT REPORT OF:	
PERFORM REMEDIAL WORK <input type="checkbox"/>	PLUG AND ABANDON <input type="checkbox"/>	REMEDIAL WORK <input type="checkbox"/>	ALTERING CASING <input type="checkbox"/>
TEMPORARILY ABANDON <input type="checkbox"/>	CHANGE PLANS <input checked="" type="checkbox"/>	COMMENCE DRILLING OPNS. <input type="checkbox"/>	PLUG AND ABANDONMENT <input type="checkbox"/>
PULL OR ALTER CASING <input type="checkbox"/>		CASING TEST AND CEMENT JOB <input type="checkbox"/>	
OTHER: <u>Location Change</u> <input type="checkbox"/>		OTHER: <input type="checkbox"/>	

12. Describe Proposed or Completed Operations (Clearly state all pertinent details, and give pertinent dates, including estimated date of starting any proposed work) SEE RULE 1103.

See attached proposed operations.

RECEIVED
JUN - 2 1995
OIL CON. DIV.
DIST. 3

I hereby certify that the information shown is true and complete to the best of my knowledge and belief.

SIGNATURE Jim Benson TITLE Drilling Superintendent DATE 5-30-95

TYPE OR PRINT NAME TELEPHONE NO.

(This space for State Use)

APPROVED BY Jim Benson DEPUTY OIL & GAS INSPECTOR, DIST. #3 DATE JUN - 5 1995

CONDITIONS OF APPROVAL, IF ANY:

12. Proposed or Completed Operations:

Rincon Unit #131E was originally staked @ 1145' FNL & 1525' FWL, Section 36, T27N-R7W, Rio Arriba Co., NM, and permitted (State APD approved 4-6-94, APD extension and casing design change approved 1-31-95) as a Basin Dakota/Blanco Mesaverde well.

Unocal requests approval to move the existing Rincon Unit 131E location to 1985' FNL, 822' FWL, Sec. 36, T27N-R7W and complete as a Basin Dakota/Blanco Mesaverde/South Blanco Pictured Cliffs well. Unocal wishes to move the location to take advantage of more favorable sub-surface geological structures; i.e. incorporate the Pictured Cliffs formation into the overall completion of the well. There is only one existing Pictured Cliffs well in the same 1/4 section (Rincon #10), and it is presently shut in and scheduled for P&A later this year.

Unocal also requests approval of a non-standard location for the proposed Rincon Unit 131E. The proposed location does not conform to a standard (Dak./M.V./P.C.) location being approximately 135' too far South. The proposed location cannot be moved to the North due to an existing El Paso Natural Gas lateral line and an existing Arroyo (see attached Pad Layout and topography). Unocal is the sole off-set lease owner/operator.

There will be no changes to the existing approved Drilling/Completion plan (approved Jan 31, 1995.)

NO. 0343 Rev. 6/9/94
Date: 21. 1995 11:36AM
Name: PO Drawer DD, Artesia, NM 8211-0719
District III
1000 Rio Grande Rd., Alamo, NM 87410
District IV
PO Box 2088, Santa Fe, NM 87504-2088

UNOCAL ROCKY MOUNTAIN OIL & Natural Resources Department
OIL CONSERVATION DIVISION
PO Box 2088
Santa Fe, NM 87504-2088

NO. 0343 Rev. 6/9/94
Date: 21. 1995 11:36AM
Name: PO Drawer DD, Artesia, NM 8211-0719
District III
1000 Rio Grande Rd., Alamo, NM 87410
District IV
PO Box 2088, Santa Fe, NM 87504-2088

☒ AMENDED REPORT

WELL LOCATION AND ACREAGE DEDICATION PLAT

* API Number 30-039-25368		* Pool Code 71599/72319/72439		* Pool Name Basin Dak/Blanco Mesaverde/So. Blanco Pictured		
* Property Code 011510		* Property Name RINCON UNIT			* Well Number 131-E	
* OGHID No. 23708		* Operator Name UNOCAL			* Elevation 6614	

10 Surface Location

UL or lot no.	Section	Township	Range	Lot Ida	Feet from the	North/South line	Feet from the	East/West line	County
E	36	27N	7W		1985	NORTH	822	WEST	RIO ARriba

11 Bottom Hole Location If Different From Surface

UL or lot no.	Section	Township	Range	Lot Ida	Feet from the	North/South line	Feet from the	East/West line	County

* Dedicated Acre 320/160	* Joint or Infill Y	* Consolidation Code U	* Order No.
-----------------------------	------------------------	---------------------------	-------------

NO ALLOWABLE WILL BE ASSIGNED TO THIS COMPLETION UNTIL ALL INTERESTS HAVE BEEN CONSOLIDATED
OR A NON-STANDARD UNIT HAS BEEN APPROVED BY THE DIVISION

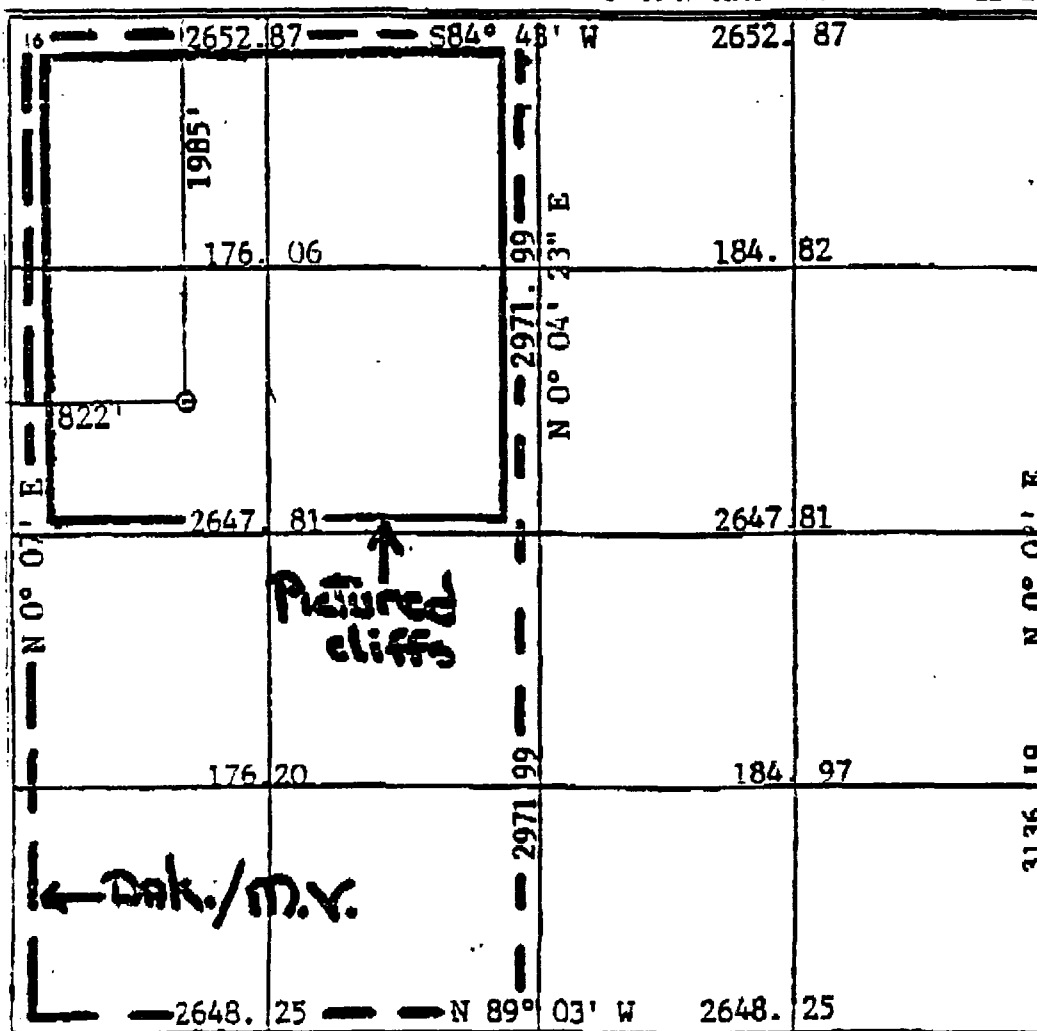

17 OPERATOR CERTIFICATION I hereby certify that the information contained herein is true and complete to the best of my knowledge and belief.	
Signature: <u>Jim Benson</u>	
Printed Name: <u>Drilling Superintendent</u>	
Title: <u>5/25/95</u>	
Date: <u>5/25/95</u>	
18 SURVEYOR CERTIFICATION I hereby certify that the well location shown on this plat was plotted from field notes of equal surveys made by me or under my supervision, and that the same is true and correct to the best of my belief.	
Date of Survey: <u>May 1995</u>	
Signature and Seal of Professional Surveyor: <u>Cecil B. Tullis</u>	
Cecil B. Tullis Certificate Number 9672	

**BEFORE THE
OIL CONSERVATION DIVISION**
Santa Fe, New Mexico

Case No. 11440 Exhibit No. 1
Submitted by: Union Oil Company of California
d/b/a UNOCAL

Hearing Date: December 21, 1995

LARGE FORMAT
EXHIBIT HAS
BEEN REMOVED
AND IS LOCATED
IN THE NEXT FILE

LARGE FORMAT
EXHIBIT HAS
BEEN REMOVED
AND IS LOCATED
IN THE NEXT FILE

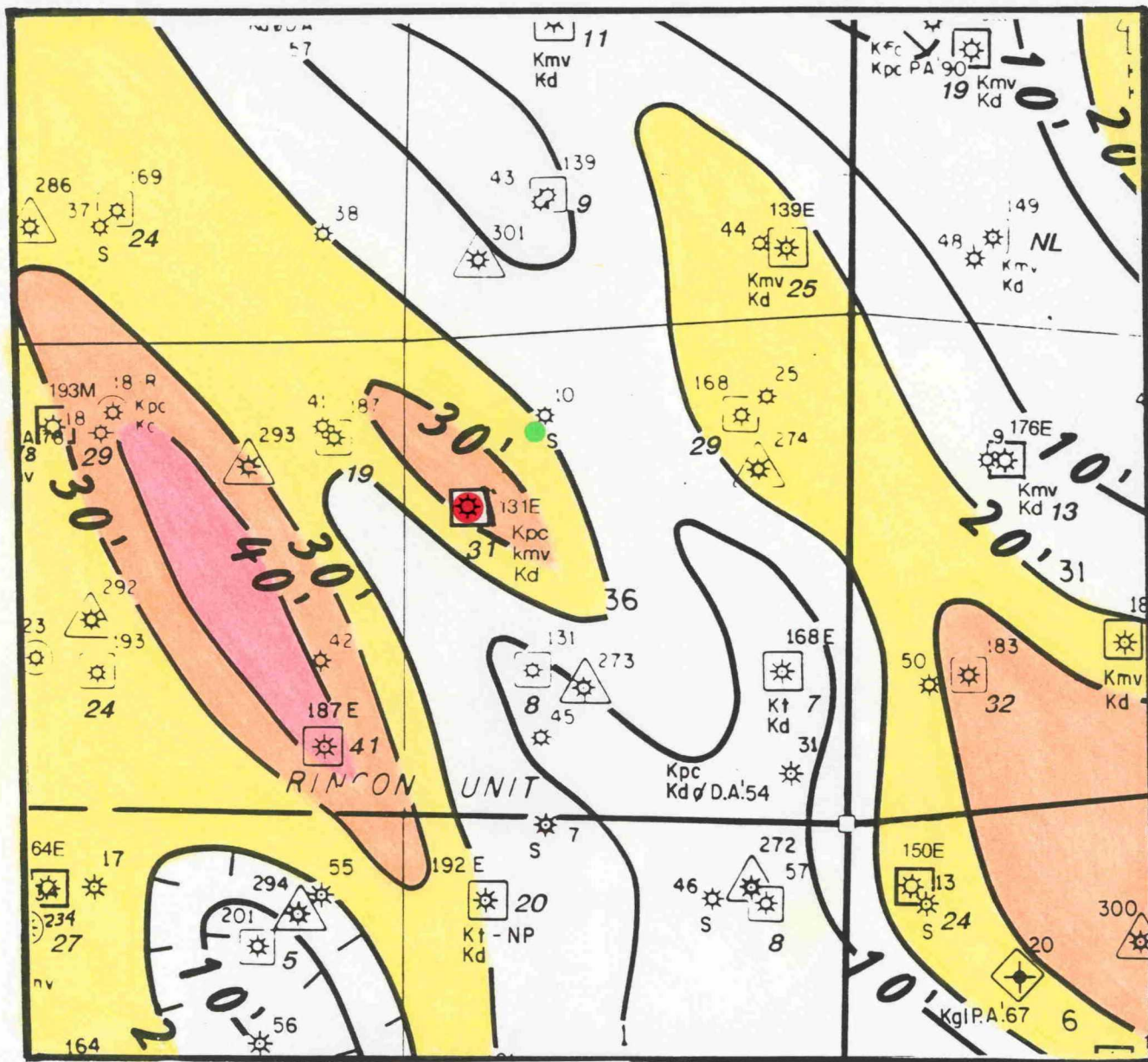

LEGEND

- - Present Location of Rincon 131E
- - Original Location of Rincon 131E

UNOCAL⁷⁶

NORTH AMERICAN OIL & GAS DIVISION
SOUTHWESTERN REGION

RINCON UNIT

RIO ARRIBA COUNTY, NEW MEXICO

POINT LOOKOUT ISOPACH
NET PAY

INTERP. BY: K. KcKeel

SCALE:

CI. C.I.'10'

DRAFT BY: J. HERNANDEZ, Jr

DATE: 04/04/95

FILE NO.

**BEFORE THE
OIL CONSERVATION DIVISION**
Santa Fe, New Mexico

Case No. 11440 Exhibit No. 4
Submitted by: Union Oil Company of California
d/b/a UNOCAL

Hearing Date: December 21, 1995

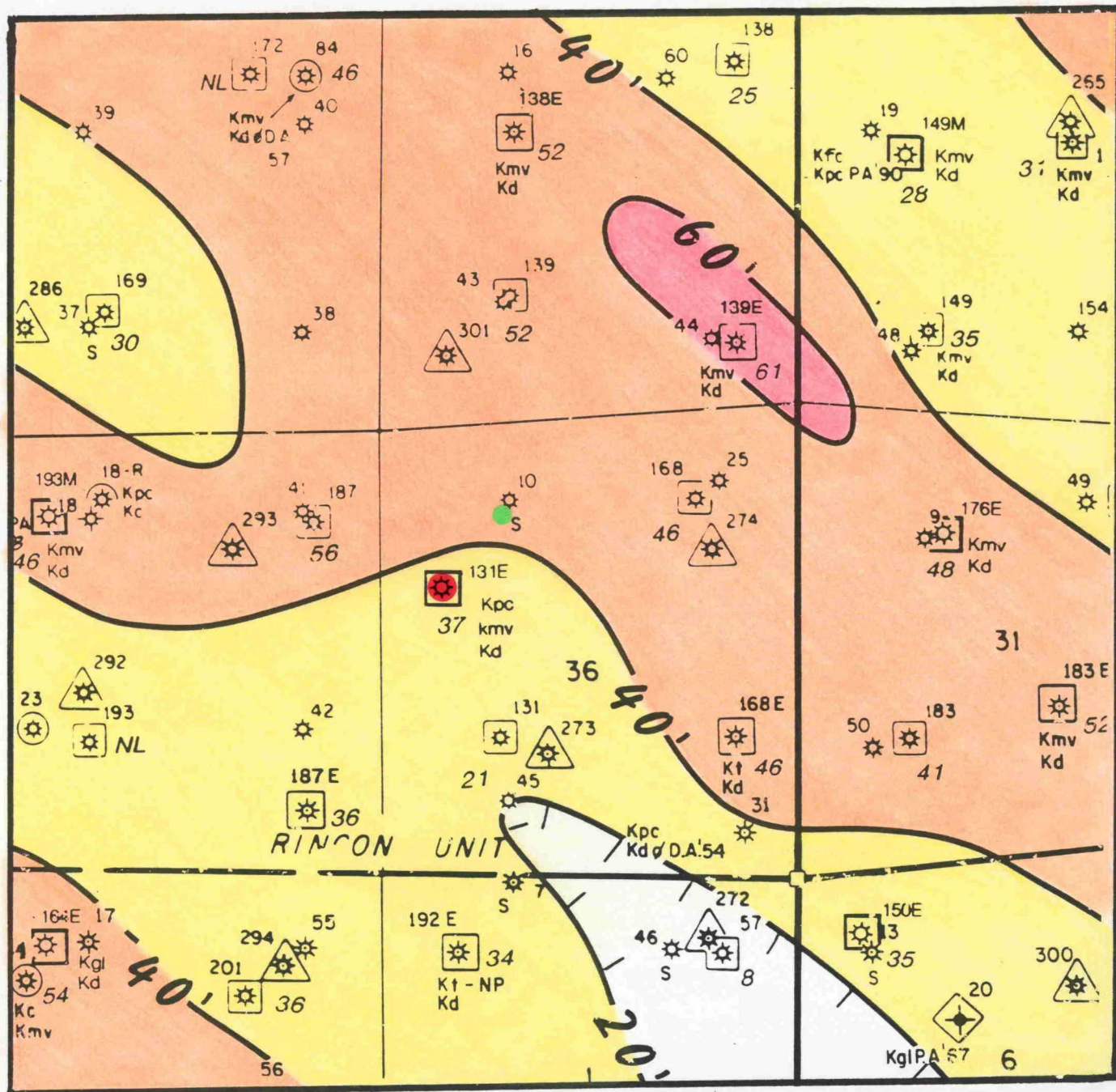

LEGEND

- - Present Location of Rincon 131E
- - Original Location of Rincon 131E

UNOCAL

NORTH AMERICAN OIL & GAS DIVISION
SOUTHWESTERN REGION

RINCON UNIT

RIO ARRIBA COUNTY, NEW MEXICO

ISOPACH

PICTURED CLIFFS

NET PAY

INTERP. BY: K. McKEEL

SCALE:

CI. CI = 20'

DRAFT BY: J. HERNANDEZ

DATE: 10/25/95

FILE NO.

**BEFORE THE
OIL CONSERVATION DIVISION**
Santa Fe, New Mexico

Case No. 11440 Exhibit No. 5
Submitted by: Union Oil Company of California
d/b/a UNOCAL

Hearing Date: December 21, 1995

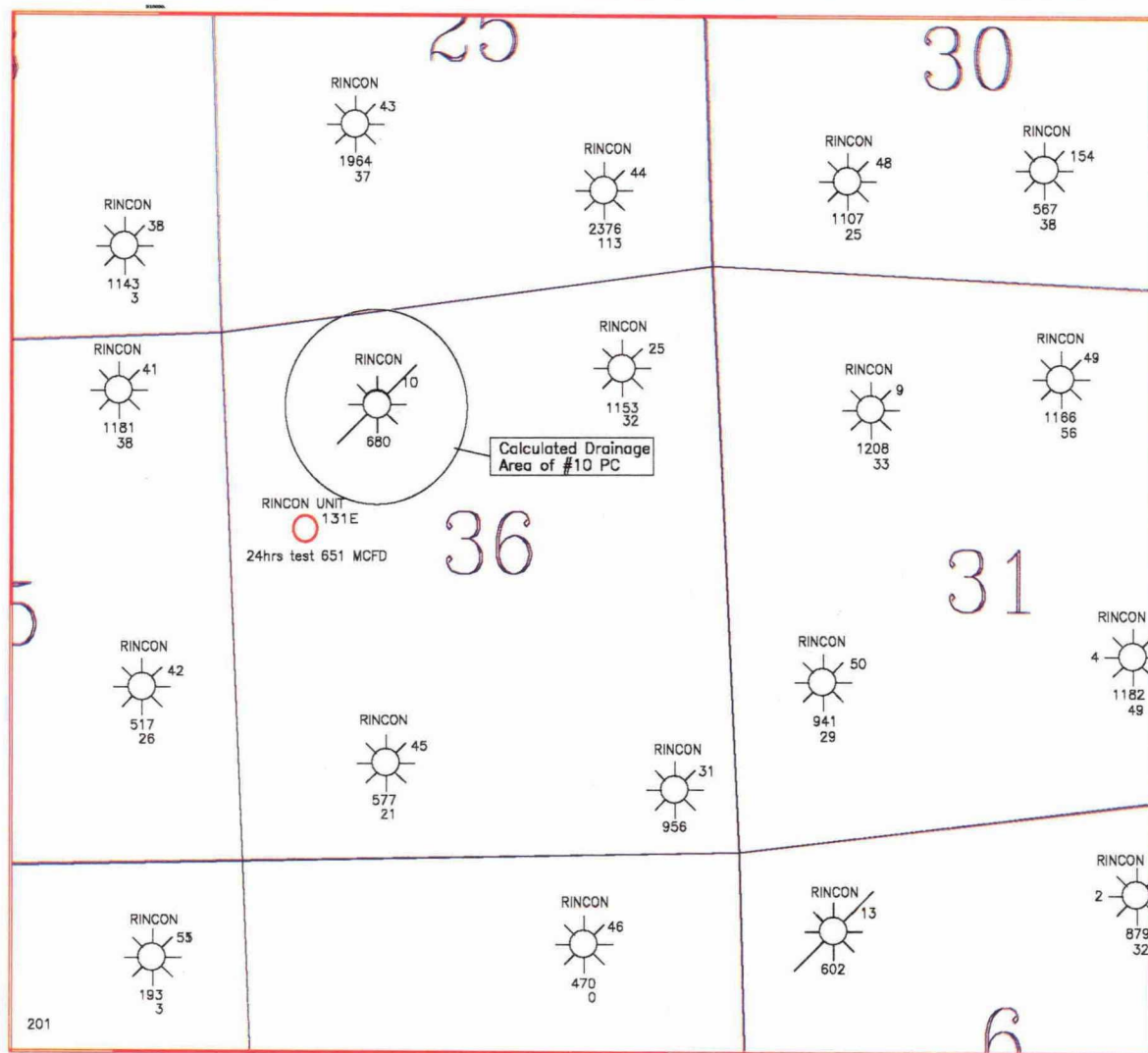

LEGEND:

CUM. PROD. TO 6/95 (MMCF)
CURRENT RATE (MCFD)



Scale 1:24000.

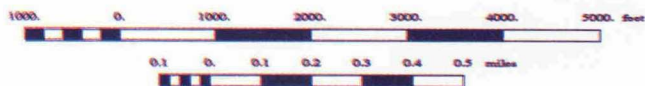

UNOCAL		
PICTURED CLIFFS PRODUCTION MAP		
RINCON UNIT		
Rio Arriba County, New Mexico		
KM		DEC. 1995
	1"=2000'	

**BEFORE THE
OIL CONSERVATION DIVISION**
Santa Fe, New Mexico

Case No. 11440 Exhibit No. 6

Submitted by: Union Oil Company of California
d/b/a UNOCAL

Hearing Date: December 21, 1995

**Volumetric Analysis, Pictured Cliffs Reservoir
NW/4 Section 36-T27N-R7W
Rincon Unit, Rio Arriba County, New Mexico**

Recoverable Gas in NW/4 Section 36:

$$G = 43.56(\phi)(A)(h)(1-S_w)((1/B_{gi})-(1/B_{ga}))$$

using $A = 160$ acres

$G = 1,453$ MMCF

Where: ϕ = Porosity 13%
 A = Area, acres
 h = Thickness, 40 ft
 S_w = Water saturation, 45%
 B_g = Formation volume factor
 P_i = 1100 psia
 P_a = 150 psia
 T = 100 deg F

Ultimate Recovery from Rincon Unit #10: **680 MMCF**

Unrecovered Gas in NW/4 Section 36:

$$1,453 - 680 = \quad \quad \quad \mathbf{773 \text{ MMCF}}$$

Drainage Radius Calculation Rincon Unit #10:

Using formula as above inserting 680 MMCF for G and solving for A:

$A = 75$ acres, drainage radius is 1,020 ft

Summary:

The only legal location (in the NW/4 of Sec. 36) outside the drainage area of the #10 was the extreme SW portion of the SW "drilling window". This area had unsuitable surface features, and therefore an unorthodox location was required.

**BEFORE THE
OIL CONSERVATION DIVISION**
Santa Fe, New Mexico

Case No. 11440 Exhibit No. 7
Submitted by: Union Oil Company of California
d/b/a UNOCAL

Hearing Date: December 21, 1995